



University of
Leicester

Archaeological Services

**An Archaeological Watching Brief
at 10 Rectory Lane,
Appleby Magna,
Leicestershire**

NGR SK 31336 10105

Jennifer Browning



ULAS Report No 2013-102
©2013

**An Archaeological Watching Brief
at 10 Rectory Lane,
Appleby Magna,
Leicestershire
(NGR SK 31336 10105)**

Jennifer Browning

For: Leicestershire County Council

Approved by:

Signed:



Date: 08.06.2013

Name: Patrick Clay

**University of Leicester
Archaeological Services**
University Rd., Leicester, LE1 7RH
Tel: (0116) 2522848 Fax: (0116) 2522614
www.le.ac.uk/ulas

ULAS Report Number 2013-102

©2013

CONTENTS

Summary	3
1. Introduction.....	3
2. Site Description, Topography and Geology.....	4
3. Historical and Archaeological Background.....	4
4. Aims and Objectives	5
5. Methodology.....	5
6. Results.....	5
7. Conclusion	8
8. Archive.....	8
9. Publication	8
10. Bibliography	9
11. Acknowledgements.....	9

FIGURES

Figure 1: Location plan Scale 1:50000	4
Figure 2: Plan showing the footprint of the new dwelling in relation to the extant building (supplied by client) (NTS).....	6
Figure 3: View over footings, looking west from driveway. Note former Wesleyan Chapel in background	6
Figure 4: Section of footing at the rear of plot (north end), showing thicker overburden. Looking north.	7
Figure 5: Section at the south end of the house footprint, showing thinner overburden and root disturbance, looking north	7

An Archaeological Watching Brief at the 10 Rectory Lane, Appleby Magna, Leicestershire (NGR SK 31336 10105)

Jennifer Browning

Summary

An archaeological watching brief was undertaken during groundworks for a new dwelling adjacent to 10 Rectory Lane, Appleby Magna, Leicestershire (NGR SK31336 10105). Despite the location of the development in an archaeologically-sensitive area, adjacent to the former Wesleyan Chapel, no archaeological finds or deposits were encountered during the watching brief. The archive will be held by Leicestershire County Council under the Accession Number X. A66. 2013.

1. Introduction

This report presents the results of an archaeological watching brief carried out in accordance with the National Planning Policy Framework (NPPF), (DCLG 2012) at 10 Rectory Lane, Appleby Magna, Leicestershire (SK 31336 10105), within North West Leicestershire District. The work took place in May 2013 and was undertaken by University of Leicester Archaeological Services on behalf of Mr. and Mrs. Pearce. The watching brief was undertaken in connection with groundworks for a one new dwelling and associated car parking (P.A. 11/00146/OUT).

The application site lies within an area of archaeological potential, as indicated by its close proximity to a building depicted as a Wesleyan Methodist Chapel on the 1st edition Ordnance Survey Map (late 19th century) and location within the historic medieval and post-medieval settlement core. The Principal Planning Archaeologist for Leicestershire County Council therefore recommended that archaeological work should be undertaken to determine if any buried heritage assets were likely to be affected by the proposed development. A strategy for a programme of archaeological attendance, inspection and recording during groundworks was set out in the Written Scheme for Investigation (Clay 2013), hereinafter WSI.

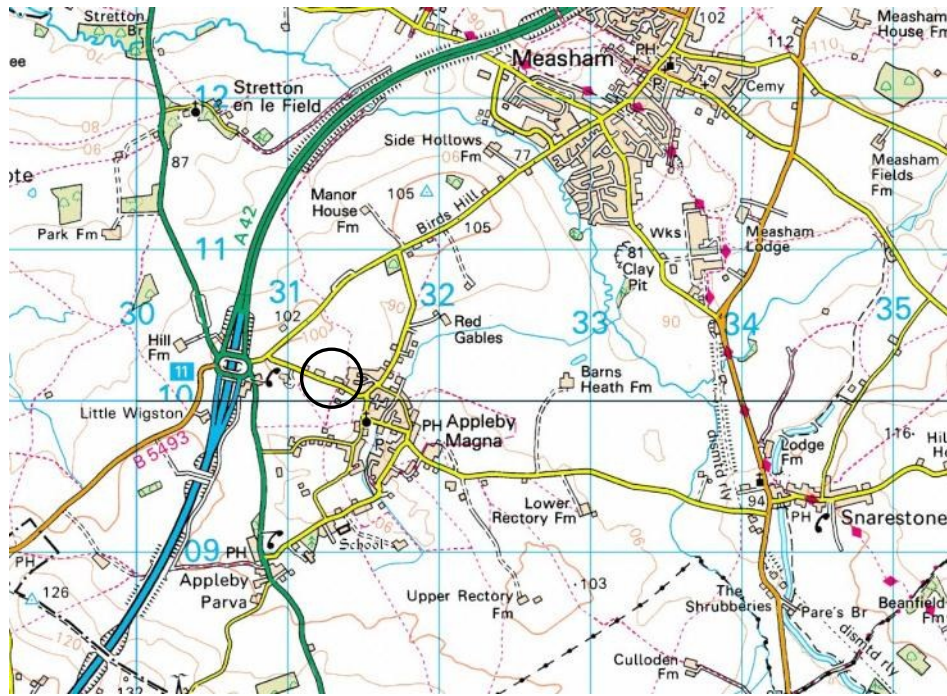

Figure 1: Location plan Scale 1:50000

Reproduced from Landranger 1:50 000 by permission of Ordnance Survey® on behalf of The Controller of Her Majesty's Stationery Office. © Crown copyright. All rights reserved. Licence number AL 100029495.

2. Site Description, Topography and Geology

The development area is located on the western edge of Appleby Magna, on Rectory Lane, which is today occupied by widely-spaced housing. The site is located within the grounds of 10 Rectory Lane, to the west of the existing dwelling and comprises an area of 0.1 ha.

The British Geological Survey of Great Britain indicates that the bedrock geology consists of mudstone and siltstone of the Tarporley Siltstone formation, which was laid down in the Triassic period. No superficial geology is recorded.

(<http://mapapps.bgs.ac.uk/geologyofbritain/home.html> Accessed on 28th May 2013).

3. Historical and Archaeological Background

The site is located directly adjacent to a former Wesleyan Methodist Chapel, now converted into a cottage. The chapel was built in 1840 and was one of three chapels in Appleby. It was mentioned in Kelly's Leicestershire Directory of 1912 but not in the 1925 edition. It is therefore thought to have closed around the time of the First World War, possibly affected by loss of congregation during that conflict (Dunmore 2004).

As it was deemed likely that the proposed development would have a damaging effect on any archaeological deposits, should they exist, an archaeological watching brief was required by the planning authority following an approved written scheme of investigation (ULAS 2013).

4. Aims and Objectives

The purpose of the current archaeological work was:

- To identify the presence/absence of any archaeological deposits.
- To establish the character, extent and date range for any archaeological deposits to be affected by the proposed ground works.
- To record any archaeological deposits to be affected by the ground works.
- To advance understanding of the heritage assets
- To produce an archive and report of any results.

5. Methodology

The work followed the WSI (Clay 2013) and adhered to the Institute for Archaeologists (IfA) *Code of Conduct* (rev. 2010) and adhered to their *Standard and Guidance for Archaeological Watching Briefs* (rev. 2008).

The programme of work consisted of the excavation of foundation trenches within the footprint of the building, using a mini-digger with a toothed bucket. The trenches were visually inspected, hand-cleaned where appropriate and recorded following standard ULAS methods.

6. Results

The site was visited on the 28th May 2013, during the excavation of foundation trenches. The plot for the new dwelling was located west of the existing property (Figure 2). There were hedges to the south and west boundary, the driveway to the east and a brick garage to the north. The ground surface had been stripped and although most of the site had been previously under lawn, the remains of tarmac could be seen at the top of the trenches on the east and north side. The foundation trenches were 0.7m wide and excavated to a depth of 1.1-1.2m.

The overburden consisted of dark greyish brown silty clay loam, with occasional pebbles and rare brick fragments. The depth of this deposit varied across the site; it was thin (*c.* 0.2 to 0.3m thick) at the front of the plot, becoming thicker adjacent to the hedge on the west (0.6m) and at the north end of the site, where it was 0.8m thick, possibly suggesting that the land was levelled at some point. Directly below this deposit was the natural subsoil to the base of the trench; this consisted of clean, dark reddish brown clay, firm in texture with rare pebbles and flints. There was evidence for root disturbance and several former service pipes, cables and land drains, however, no archaeological finds or deposits were observed during the work.

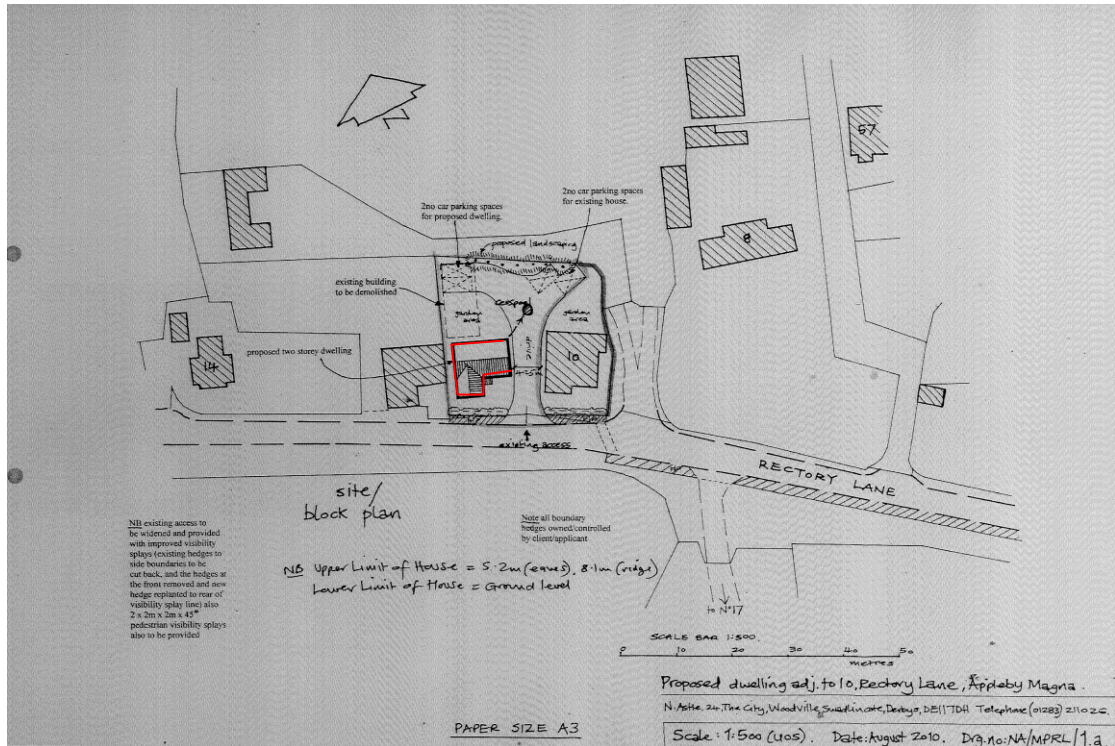

Figure 2: Plan showing the footprint of the new dwelling in relation to the extant building (supplied by client) (NTS)



Figure 3: View over footings, looking west from driveway. Note former Wesleyan Chapel in background



Figure 4: Section of footing at the rear of plot (north end), showing thicker overburden. Looking north.



Figure 5: Section at the south end of the house footprint, showing thinner overburden and root disturbance, looking north

7. Conclusion

Archaeological monitoring was undertaken on the excavation of footings for a single new dwelling on Rectory Lane, Appleby Magna, adjacent to the former Wesleyan Chapel. No archaeological deposits or finds were encountered during the work.

8. Archive

The site archive will be held by Leicestershire County Council HNET, with the Accession No. X A66 2013

The archive contains site notes (watching brief pro forma sheets), digital photographs and photo index.

The report is listed on the Online Access to the Index of Archaeological Investigations (OASIS) held by the Archaeological Data Service at the University of York. Available at: <http://oasis.ac.uk/>

9. Publication

A summary of the work will be submitted for publication in the local archaeological journal *Transactions of the Leicestershire Archaeological and Historical Society* and *Rutland Record* in due course. The report will be added to the Archaeology Data Service's (ADS) Online Access to the Index of Archaeological Investigations (OASIS) database held by the University of York.

OASIS Information

Project Name	10 Rectory Lane, Appleby Magna
Project Type	Archaeological Attendance (Watching Brief)
Project Manager	P. Clay
Project Supervisor	J. Browning
Previous/Future work	-
Current Land Use	Garden
Development Type	Residential
Reason for Investigation	As a condition
Position in the Planning Process	Ongoing
Site Co ordinates	NGR SK 31336 10105
Start/end dates of field work	28.05.2013
Archive Recipient	LCC
Study Area	0.1ha

10. Bibliography

Brown, D., 2008 *Standard and guidance for the preparation of Archaeological Archives* (Institute for Archaeologists)

Clay, P. 2013 *Written scheme of investigation for archaeological attendance, inspection and recording (watching brief) at land adjacent to 10, Rectory Lane, Appleby Magna, Leicestershire (SK 31352 10101)*

Dunmore, R. 2004 *Chapter 25 Chapels: Nonconformists in Appleby* (Accessed 07.06.13)
http://www.applebymagna.org.uk/appleby_history/in_focus25_chapels.htm

Institute for Archaeologists (IfA), (rev. 2012), *Code of Conduct*

Institute for Archaeologists (IfA), (rev. 2008), *Standard and Guidance for Archaeological Watching Briefs*

11. Acknowledgements

The fieldwork was carried out by Jennifer Browning for ULAS. Patrick Clay managed the project. I would like to thank Mr. Pearce for his help and co-operation during the work.

Jennifer Browning
University of Leicester Archaeological Services
University Road
Leicester
LE1 7RH
Tel: 0116 2522848
Fax: 0116 252 2614

ULAS Report No: 2013-102

07/06/2013

Contact Details

Richard Buckley or Patrick Clay
University of Leicester Archaeological
Services (ULAS)
University of Leicester,
University Road,
Leicester LE1 7RH

T: +44 (0)116 252 2848

F: +44 (0)116 252 2614

E: ulas@le.ac.uk

w: www.le.ac.uk/ulas



INVESTOR IN PEOPLE

