



University of
Leicester

Archaeological Services



**An Archaeological Watching
Brief at 1 Tithe Barn Row,
Greetham, Rutland**

NGR: SK 92653 14545

Mathew Morris

**An Archaeological Watching Brief
at 1 Tithe Barn Row, Greetham
Rutland**

NGR: SK 92653 14545

Mathew Morris

For: Ms Rhona Calverley

Planning application no. FUL/2010/00533

Checked by:

Signed:



Date: 31.05.2013

Name: Patrick Clay

University of Leicester

Archaeological Services

University Rd., Leicester, LE1 7RH

Tel: (0116) 2522848 Fax: (0116) 2522614

ULAS Report Number 2013-099

©2013

OAKRM.2014.60

CONTENTS

Summery	1
Introduction	1
Geology and Topography	1
Historical and Archaeological Background	1
Archaeological Aims and Objectives	3
Methodology	3
Results	3
Discussion	3
Bibliography	6
Archive	6
Publication	6
Acknowledgements	7

FIGURES

Figure 1: Location maps with development area highlighted	2
Figure 2: Location plan showing area of work	4
Figure 3: General view of site before excavation of foundation trenches. Looking north	5
Figure 4: Section along northern edge of development area. Looking north	5
Figure 5: Typical dug foundation trench. Looking north-east.	6

TABLES

Table 1: OASIS database entry summary	7
---	---

An Archaeological Watching Brief at 1 Tithe Barn Row, Greetham, Rutland (SK 92653 14545)

Mathew Morris

Summery

An archaeological watching brief was carried out at 1 Tithe Barn Row, Greetham, Rutland (SK 92653 14545) by University of Leicester Archaeological Services (ULAS) on 14 May 2013. The work was carried out on behalf of Ms Rhona Calverley in advance of construction of two new semi-detached dwellings on land adjacent to 1 Tithe Barn Row. Work involved supervision and inspection of machine removed overburden and machine excavated foundation trenches. No archaeological features or deposits were observed and the results of the investigation proved negative. The site archive will be held by Rutland County Museum under the accession number OAKRM.2014.60.

Introduction

This document constitutes the final report for archaeological attendance, inspection and recording (watching brief) carried out at 1 Tithe Barn Row, Greetham, Rutland (SK 92653 14545; Figure 1). The work was carried out on behalf of Ms Rhona Calverley by University of Leicester Archaeological Services (ULAS) on 14 May 2013.

The proposed construction of two semi-detached dwellings on land adjacent to 1 Tithe Barn Row (Planning Application No. FUL/2010/00533) was set back *c.*20m on the east side of Church Lane in the centre of Greetham, approximately 8.5km north-east of Oakham (Figure 2). The total development area covered *c.*656 square metres.

The watching brief was requested by Leicestershire County Council Historic and Natural Environment Team (LCCHNET) as archaeological advisors to the local planning authority, Rutland County Council, in accordance with National Planning Policy Framework (NPPF) Sec. 12: Conserving and Enhancing the Historic Environment (DCLG March 2012), as laid out in the *Written Scheme of Investigation for Archaeological Attendance, Inspection and Recording* (Clay 2012).

Geology and Topography

The British Geological Survey of Great Britain, Sheet 157 (Stamford), indicates that the underlying geology consists of bedrock deposits of ooidal ironstone belonging to the Northampton Sand Formation (BGS 1978). The site lies on a terraced slope *c.*110m above Ordnance Datum (OD) with the ground dropping down from north to south.

Historical and Archaeological Background

The Leicestershire and Rutland Historic Environment Record (HER) indicates that the site lies within an area of archaeological interest inside the historic medieval and post-medieval settlement core of Greetham (HER Ref. MLE9360) south of a site of recorded medieval village earthworks (MLE5336). Approximately 40m to the east of the site is the remains of a stone wall thought to have originally been part of a late medieval/post-medieval tithe barn (MLE19475).

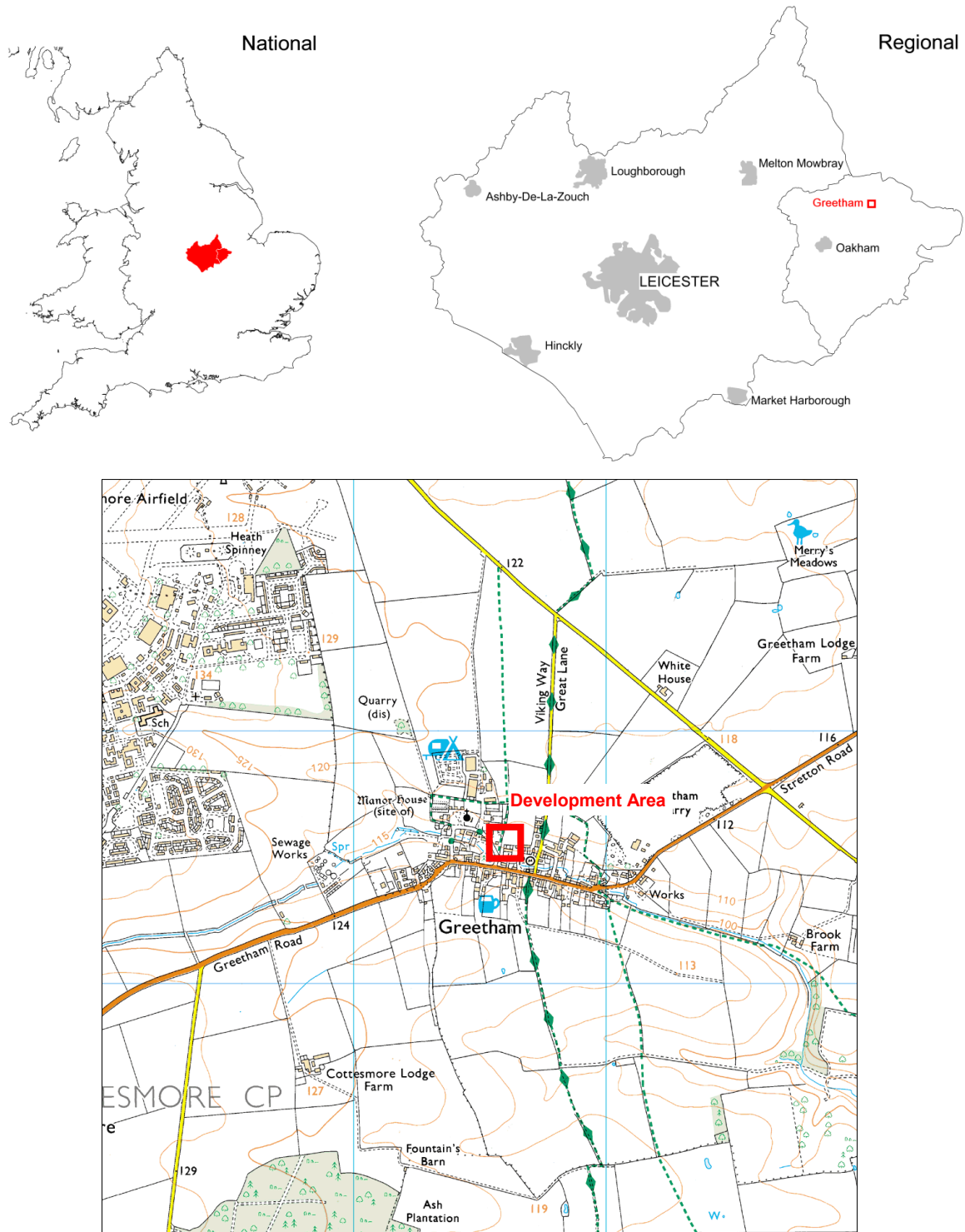

Figure 1: Location maps with development area highlighted

Reproduced from Explorer® 223 Northampton and Market Harborough 1:25,000 OS map by permission of Ordnance Survey® on behalf of The Controller of Her Majesty's Stationary Office. © Crown copyright 2009. All rights reserved. License number AL100029495.

The village is likely to have Anglo Saxon origins and is referred to in the Domesday Book as Greetham. This is thought to refer to, in Old English, 'gravelly homestead or enclosure' (Mills 2011). In 1066 the manor, along with that of Cottesmore, was held by one Goda but after the Norman Conquest it was held by King William I. After 1090, both manors were

granted by William II to the earls of Warwick who possessed them until the late 15th century. Afterwards, the manor passed through a succession of owners (Page 1935, 134-8).

Archaeological Aims and Objectives

The main objectives of the archaeological work were:

- To identify the presence/absence of any archaeological deposits.
- To establish the character, extent and date of any archaeological deposits to be affected by the proposed ground works.
- To record any archaeological deposits to be affected by the ground works.
- To advance understanding of the local heritage assets.
- To produce a report and archive of any results.

Methodology

The project involved the controlled supervision of overburden removal, excavation of foundation trenches and other groundworks associated with the construction of the two proposed semi-detached dwellings by an experienced professional archaeologist to determine the presence/absence of any archaeological remains. This was carried out using a mini-360° mechanical excavator with a c.0.6m wide ditching bucket.

All exposed areas, sections and spoil heaps were visually inspected for features and finds. Any archaeological deposits were hand cleaned, planned, photographed, sample excavated and recorded as appropriate to addressing the objectives of the watching brief. Field notes were recorded on a pro-forma ULAS watching brief record form.

All work followed the *Institute for Archaeologists' (IFA) Code of Conduct* and adhered to their *Standard and Guidance for Archaeological Watching Briefs* and the *Guidelines for Archaeological Work in Leicestershire and Rutland (LMARS)*.

Results

The site of the two new semi-detached dwellings was located on lawn immediately west of 1 Tithe Barn Row (Figure 2). The groundworks involved the reduction of the ground level by c.0.7m on the northern side of the site and by c.0.15m on the southern side of the site (Figure 3). This removed c.0.2m of turf and grey silty topsoil directly overlying the ironstone natural substratum (Figure 4). Although a diffuse/mixed interface between the topsoil and the ironstone was visible there was no apparent subsoil.

No features were visible during the archaeological attendance and the area appeared very sterile with minimal modern debris present in the spoil and no evidence of archaeological activity. The foundation trenches were dug to a minimum depth of c.1m directly into the natural substratum (Figure 5).

Discussion

Overall, no archaeological features, deposits or finds were observed during the course of the work and the result of the investigation proved negative. Much of the ground within the site appeared to have been artificially terraced into the natural slope of the ground (dropping down from north to south), most likely when Tithe Barn Row was built. This has created flat lawns surrounding Tithe Barn Row and would explain the absence of subsoil across the development area. Much of the topsoil, therefore, is most likely imported from elsewhere.

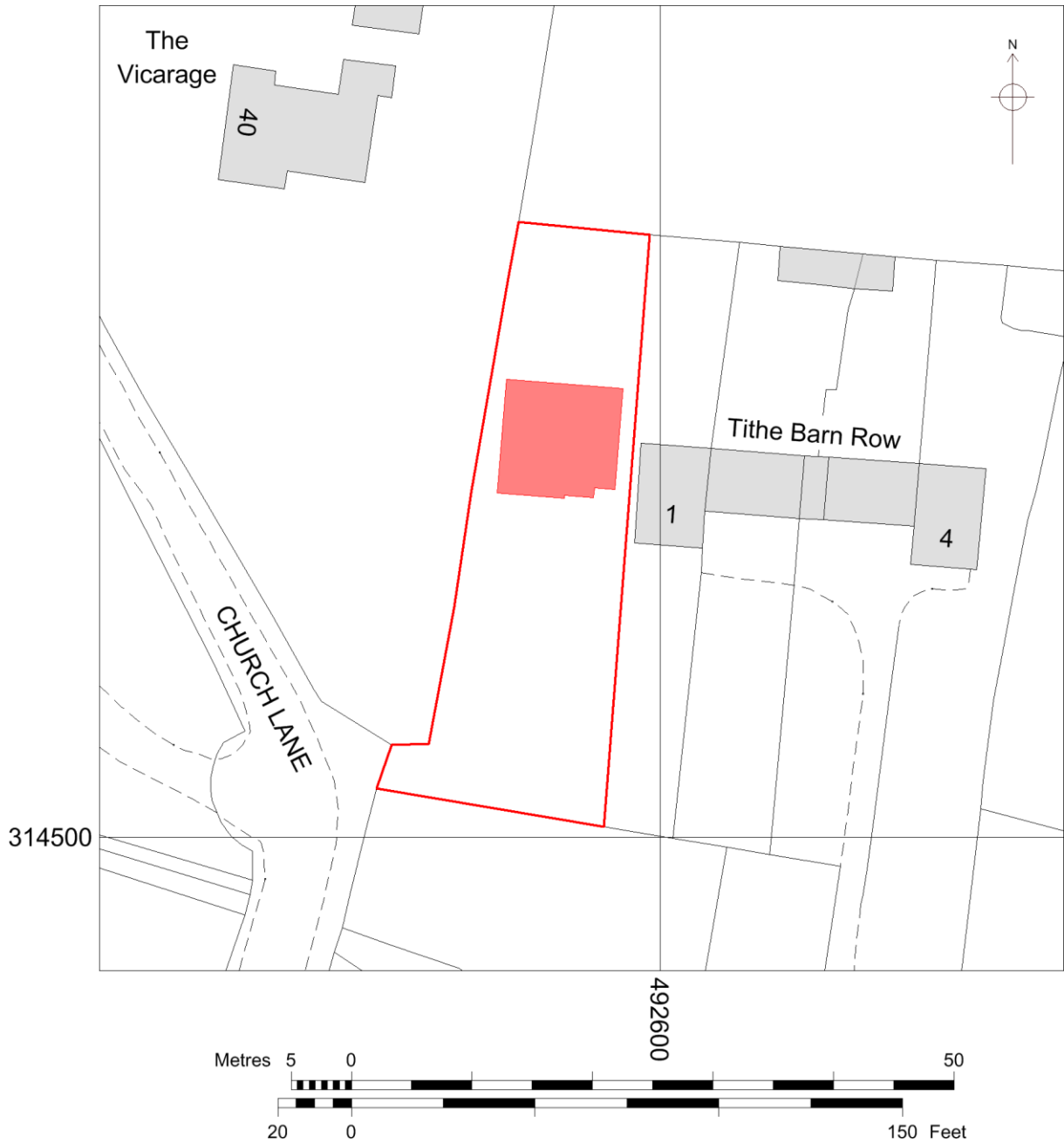

Figure 2: Location plan showing area of work

The development area (c.656 sq m) is outlined in red, with the footprint of the proposed dwellings (c.89 sq m) shaded in.



Figure 3: General view of site before excavation of foundation trenches. Looking north



Figure 4: Section along northern edge of development area. Looking north



Figure 5: Typical dug foundation trench. Looking north-east.

Bibliography

B.G.S., 1978 *England and Wales Sheet 156 Stamford: Bedrock and Superficial Deposits*.
1:50,000 scale geology series

Clay, P., 2012 *Written Scheme of Investigation for archaeological attendance, inspection and recording (watching brief): 1 Tithe Barn Row, Greetham, Rutland (SK 92653 14545)*.
Unpublished ULAS document **11/578**

Mills, A.D., 2011 'Greetham' in *A Dictionary of British Place-Names*. Oxford, Oxford University Press

Page, W. (ed.), 1935 'Greetham' in *A History of the County of Rutland: Volume 2*. Oxford, Oxford University Press, 134-138

Archive

The site archive consists of: 1 A4 watching brief record form
6 digital photographs

The site archive will be held by Rutland County Museum under the accession number OAKRM.2014.60.

Publication

Since 2004 ULAS has reported the results of all archaeological work to the *Online Access to the Index of Archaeological Investigations* (OASIS) database held by the Archaeological Data Service at the University of York (Table 1).

A summary of the work will also be submitted for publication in the local archaeological journal, the *Transactions of the Leicestershire Archaeological and Historical Society*, in due course.

Table 1: OASIS database entry summary

Project Number	universi1-195074
Project Name	1 Tithe Barn Row, Greetham, Rutland
Project Type	Watching Brief
Project Manager	Patrick Clay
Project Supervisor	Mathew Morris
Previous/Future work	No
Current Land Use	Lawn
Development Type	Residential
Reason for Investigation	NPPF Section 12
Position in the Planning Process	As a condition
Site Co-ordinates	SK 92653 14545
Start/end dates of field work	14/05/2013
Archive Recipient	Rutland County Museum, Oakham
Study Area	c.656 sq m

Acknowledgements

Thanks are extended to the client and contractors for their co-operation and assistance on site. Fieldwork was undertaken, and the report written by Mathew Morris. The project was managed for ULAS by Patrick Clay.

Mathew Morris MA AIFA
 Archaeological Services (ULAS)
 School of Archaeology and Ancient History
 University of Leicester
 University Road
 Leicester LE1 7RH

Tel: 0116 252 2848
 Fax: 0116 252 2614
 Email: mlm9@le.ac.uk

31/05/2013

Contact Details

Richard Buckley or Patrick Clay
University of Leicester Archaeological
Services (ULAS)
University of Leicester,
University Road,
Leicester LE1 7RH

T: +44 (0)116 252 2848

F: +44 (0)116 252 2614

E: ulas@le.ac.uk

W: www.le.ac.uk/ulas



INVESTOR IN PEOPLE



THE Awards Winner
2007, 2008, 2009, 2010, 2011, 2012