



UNIVERSITY OF  
**LEICESTER**

Archaeological Services

**An Archaeological  
Evaluation at 46 Main  
Street, Orton-on-the-Hill,  
Twycross, Leicestershire**

**SK 30955 04103**



Adam Clapton

ULAS Report No 2016-010  
©2016

**An Archaeological Evaluation at  
46 Main Street, Orton-on-the-Hill,  
Twycross, Leicestershire  
SK 30955 04103**

**Adam Clapton**

**For: Mrs M Whitehouse**

**Planning Application No. 15/00870/FUL**

Approved by:

Signed: ...



Date: ...19.01.2016.

Name: ...Patrick Clay.

**University of Leicester**  
Archaeological Services  
University Rd, Leicester, LE1 7RH  
Tel: (0116) 252 2848 Fax: (0116) 252 2614

**ULAS Report Number 2016-010**  
©2016

**Accession Number X.A3.2016**

## Contents

Summary.....	1
Introduction.....	1
Site Location, Topography and Geology.....	2
Archaeological Background.....	3
Archaeological Objectives.....	4
Methodology.....	4
Results.....	5
<i>Trench 1</i> .....	6
<i>Trench 2</i> .....	6
Conclusion.....	7
Archive.....	7
Bibliography.....	8
Acknowledgements.....	9
Appendix 1 – Trench Photographs.....	10

## Figures

Figure 1: Site Location (Original Scale 1:25 000).....	3
Figure 2: Location of site on Main Street, Orton-on-the-Hill.....	4
Figure 3: Topographical survey showing location of trenches.....	5
Figure 4: Plans and elevations of proposed development.....	7
Figure 5: Trench 1 looking east.....	10
Figure 6: Trench 2 looking west.....	11

## **An Archaeological Evaluation at 46 Main Street, Orton on the Hill, Twycross, Leicestershire. SK 30955 04103**

**Adam Clapton**

### **Summary**

*An archaeological field evaluation was carried out by University of Leicester Archaeological Services (ULAS) at 46 Main Street, Orton on the Hill, Twycross, Leicestershire SK 30955 04103*

*The work was commissioned by Mrs M Whitehouse in advance of the development of the site for a new residential dwelling. The site which currently serves as a front garden to 46 Main Street, lies close to historic medieval core of Orton on the Hill.*

*Two trenches measuring 9m and 21m in length were excavated within the development area; both were 1.6m in width. The topsoil across the site was shown to be uniform silty-loam, over a subsoil of silty-clay. The natural sub-stratum across the site was pinkish red clay.*

*The archaeological evaluation did not identify any archaeological features, and no artefacts were recovered. Slight evidence of tree root disturbance was detected in Trench 2. The site archive will be deposited with Leicestershire County Council under the accession number X.A3.2016.*

### **Introduction**

University of Leicester Archaeological Services (ULAS) were commissioned by Mrs M Whitehouse to carry out an archaeological evaluation at 46 Main Street, Orton on the Hill, Leicestershire.

This report represents the programme of archaeological trial trenching that was undertaken on January 13th 2016. It follows an archaeological strategy of work set out in the Written Scheme for Investigation (ULAS 2015; hereinafter WSI)

This archaeological work is in accordance with NPPF Section 12: Enhancing and Conserving the Historic Environment.

The work was required as a condition of the planning consent, issued by Hinckley and Bosworth Borough Council, for a new detached dwelling at the site (Planning Application No. 15/00870/FUL). The land is currently a front garden area for 46 Main Street.

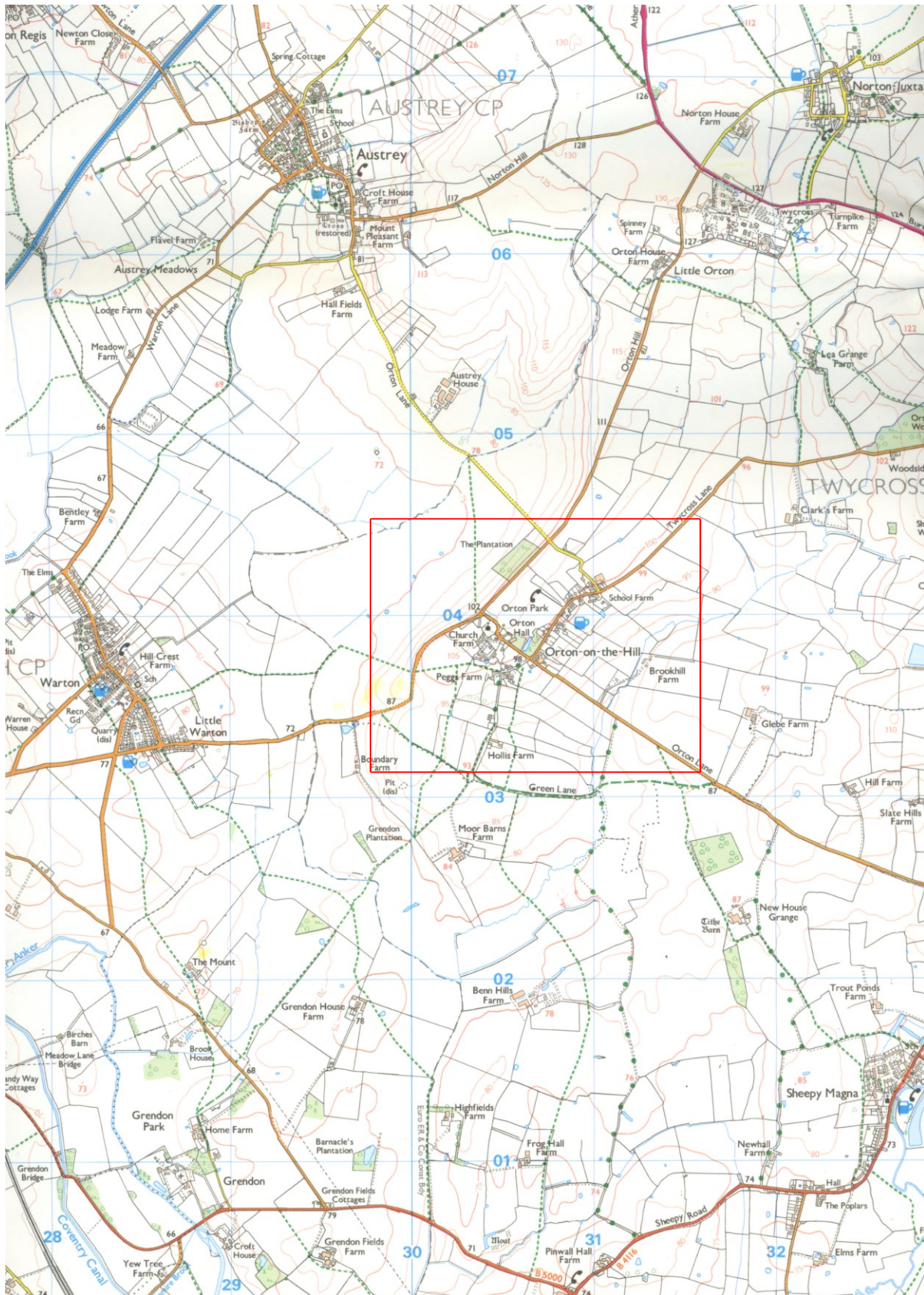

Figure 1 Location of Orton-on-the-Hill

Reproduced from Landranger 1:25 000 by permission of Ordnance Survey® on behalf of The Controller of Her Majesty's Stationery Office. © Crown copyright. All rights reserved. Licence number AL 100029495.

## Site Location, Topography and Geology

The site lies within the village of Orton-on-the-Hill, in the parish of Twycross, Leicestershire (fig 1) at approximately 102m aOD. The site is bounded by dwellings to the east and west and with the adjoining property (46 Main Street) to the south. The development area covers approximately 0.034 hectares.

The underlying bedrock consists of Gunthorpe Member Dolomitic siltstone (British Geological Survey of Britain)

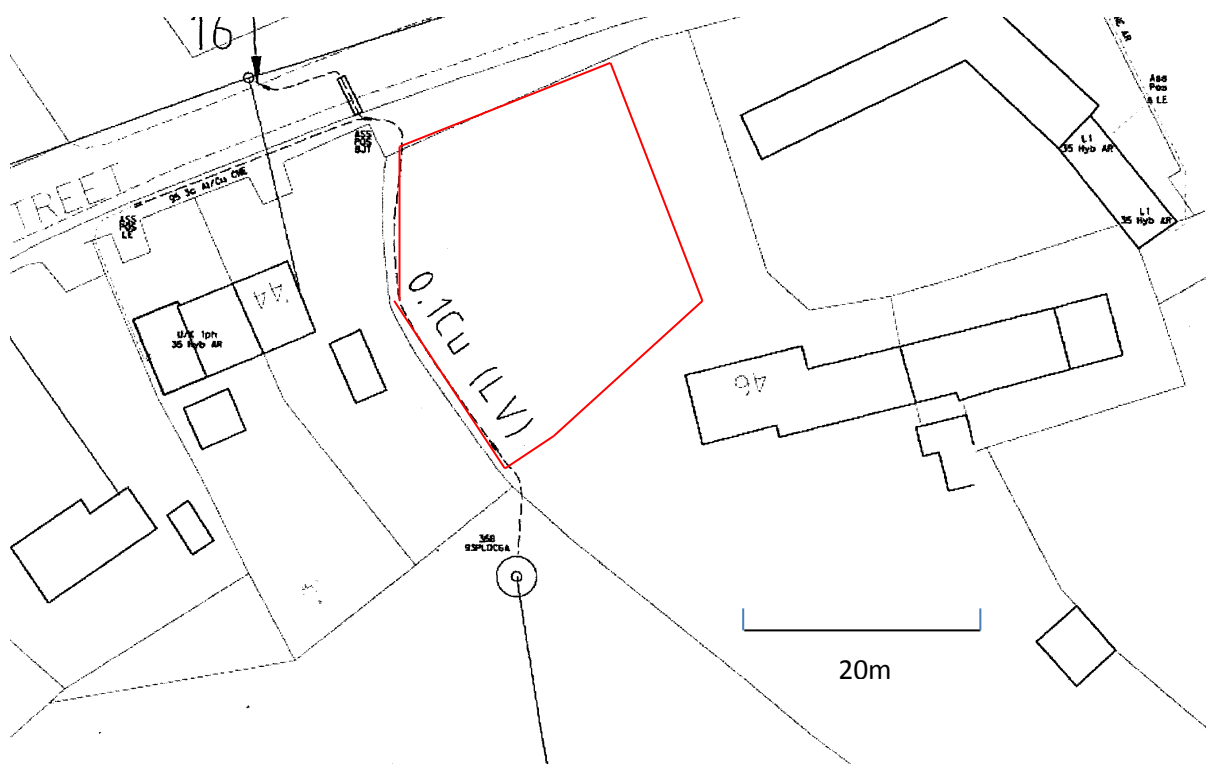

Figure 2: Location of site on Main Street, Orton-on-the -Hill

## Archaeological Background

The Leicestershire Historic Environment Record indicates that the application area lies within the historic medieval core of Orton-on-the-Hill and may contribute to the study of rural medieval settlement and East Midlands Research Strategy 6.7.7.2 (Knight et al. 2012: 94; Lewis 2006). The Leicestershire County Council Natural and Historic Environment Team (LCCNHET) as advisors to the planning authority have requested site investigation and recording commencing with an initial trial trench evaluation.

Groundworks associated with the proposed development are likely to disturb any archaeological remains that may be present, consequently there is a likelihood that buried archaeological remains will be affected by the development

## Archaeological Objectives

The general aims of the evaluation were as follows:

- To determine the location, extent, date, character, condition, significance and quality of any archaeological remains within the development site
- To assess vulnerability/sensitivity of any exposed remains
- To provide sufficient information on the archaeological potential of the site to enable the archaeological implications of the proposed development to be assessed
- To assess the impact of previous land use on the site
- To inform a strategy to avoid or mitigate impacts of the proposed development on surviving archaeological remains
- To produce a site archive for deposition with an appropriate museum and to provide information for accession to the Leicestershire and Rutland Historic Environment Record (HER).

The results of the evaluation will enable reasoned and informed recommendations to be made to the local planning authority and, if appropriate, a suitable mitigation strategy for the proposed development to be formulated.

All work conforms to the requirements of the National Planning Policy Framework (2012). It has been designed in accordance with current best archaeological practice and the appropriate national standards and guidelines including:

- *Management of Archaeological Projects* (English Heritage, 1991);
- *Model Briefs and Specifications for Archaeological Assessments and Field Evaluations* (Association of County Archaeological Officers, 1994);
- *Code of Conduct* (Chartered Institute for Archaeologists, 2014);
- *Standard and Guidance for Archaeological Field Evaluations* (Chartered Institute for Archaeologists, 2014);

## Methodology

Leicestershire County Council, as archaeological advisors to the planning authority requested an archaeological field evaluation to identify and record any archaeological remains of significance and as a consequence a programme of evaluation trenching was undertaken.

A single trench was proposed, providing a 5% sample of the area (WSI fig 2). In the event two trenches were excavated, due to the presence of mature trees, 9m and 21m long by at 1.6m in width (Figure 3).

Topsoil and subsoil was removed by a mechanical excavator (JCB3c) using a toothless ditching bucket (c.1.6m wide), under archaeological supervision. The spoil generated during the evaluation was mounded away from the edges of each trench. Topsoil and subsoil was stored separately. Mechanical excavation ceased at undisturbed natural deposits. The

trenches were recorded at an appropriate scale by measured drawing and photography and were GPS-located to Ordnance Survey National Grid.

A photographic record, utilising high resolution digital data capture, was maintained during the course of the fieldwork and included:

- the site prior to commencement of fieldwork;
- the site during work, showing specific stages of fieldwork;

Upon completion of the evaluation trenching, the largest of the trenches was backfilled while the smaller trench was left open at the developer's request.

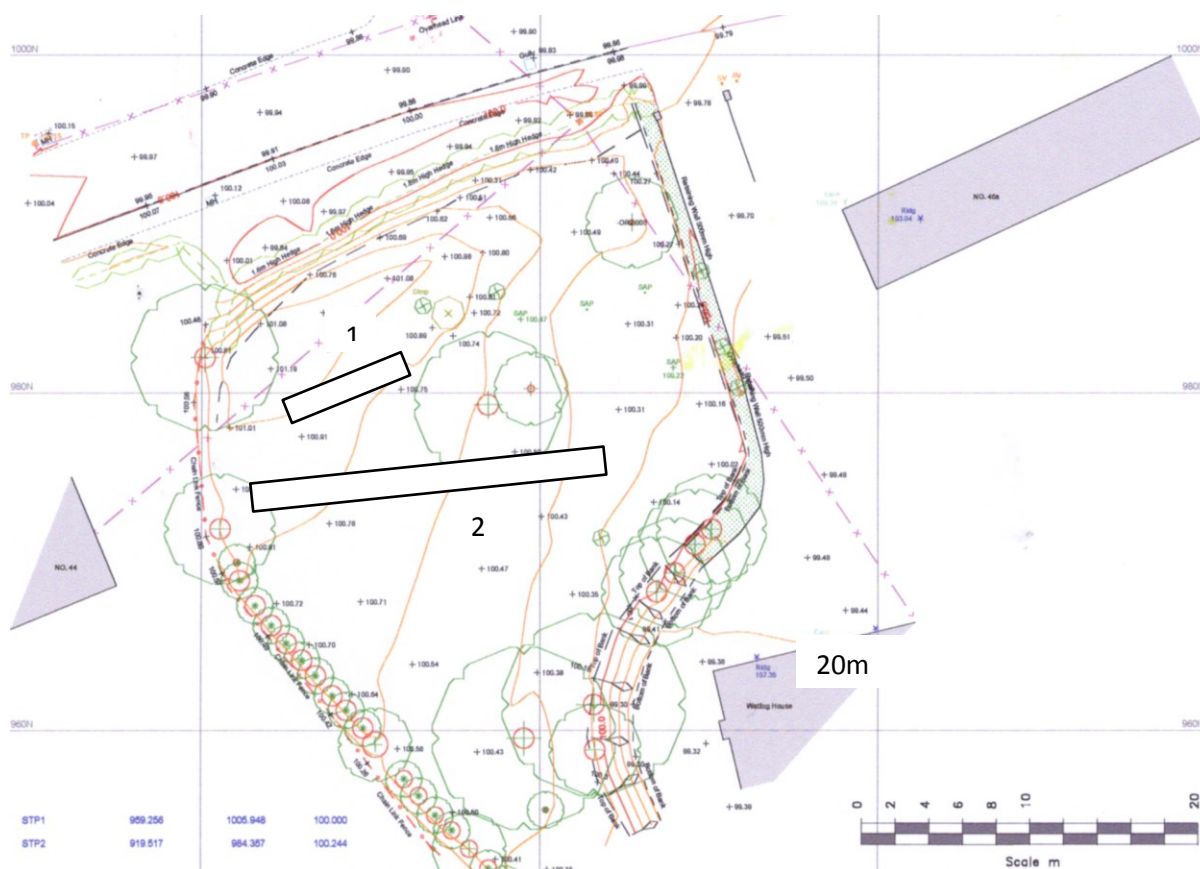

Figure 3: Topographical survey showing location of trenches

## Results

Two trenches were excavated across the area of proposed development. Trench 1 measured 9m in length with Trench 2 measuring 21m in length. Topsoil across both trenches consisted of friable, mid greyish/brown silty-loam with rare small pebbles, below which light-orange brown silty-clay subsoil with rare charcoal flecking was present. The natural subsoil consisted of pinkish red clay.

All measurements were taken from the top of the trench.



### ***Trench 1***

No archaeological features or finds were located.

<b>Interval</b>	<b>W 0m</b>	<b>5m</b>	<b>E 10m</b>
<b>Topsoil Depth</b>	0.44m	0.43m	0.41m
<b>Subsoil Depth</b>	0.14m-	0.11m	0.08m
<b>Top of natural substratum</b>	0.58m	0.54m	0.49m
<b>Base of trench</b>	0.68m	0.57m	0.51m

### ***Trench 2***

No archaeological features or finds were located.

<b>Interval</b>	<b>E 0m</b>	<b>5m</b>	<b>10m</b>	<b>15m</b>	<b>W 21m</b>
<b>Topsoil Depth</b>	0.24m	0.28m	0.33m	0.35m	0.35m
<b>Subsoil Depth</b>	0.10m-	0.09m	0.15m	0.13m	0.15m
<b>Top of natural substratum</b>	0.34m	0.37m	0.48m	0.48m	0.50m
<b>Base of trench</b>	0.38m	0.42m	0.56m	0.53m	0.54m

No archaeological features were identified in Trench 1 or Trench 2. Trench 2 showed slight evidence of tree root disturbance between 11m and 13m from the east end. Photographs of each trench are shown in Appendix 1.

## Conclusion

Despite the potential for archaeology related to the medieval core of Orton-on-the-Hill the evaluation suggests that there are no features or deposits of archaeological origin in the area of the proposed development.



Figure 4 Plans and elevations of proposed development

## Archive

The completed archive will be deposited with Leicestershire County Council under the accession no. X.A3.2016 and contains:

- 2 trench recording sheets
- 1 photographic recording sheet
- CD containing digital photographs and report
- Unbound copy of this report
- Thumbnail print of digital photographs

The report is listed on the Online Access to the Index of Archaeological Investigations (OASIS) held by the Archaeological Data Service at the University of York, under ID: universi1-144988. Available at: <http://oasis.ac.uk/>

<b>ID</b>	<b>OASIS entry summary</b>
Project Name	46 Main Street, Orton on the Hill, Leicestershire
Summary	
Project Type	Evaluation trenches
Project Manager	Patrick Clay
Project Supervisor	Adam Clapton
Previous/Future work	.
Current Land Use	Front garden of 46 Main Street
Development Type	Residential dwelling
Reason for Investigation	NPPF
Position in the Planning Process	Planning Condition
Site Co ordinates	SK 30955 04103
Post-code	CV9 3NN
Height (metres above O.D.)	102aOD
Start/end dates of field work	13/01/2016
Study Area	0.034 hectares
Associated project reference codes	Museum accession X.A3.2016 OASIS ID: universi1-238507

## **Bibliography**

CIfA 2008 *Standards and Guidance for Archaeological Evaluations*

CIfA 2012 *Code of Conduct*

Knight, D.; Vyner, B.; Allen, C.; 2012, *East Midlands Heritage. An Updated Research Agenda and Strategy for the Historic Environment of the East Midlands*. Nottingham Archaeological Monographs 6, University of Nottingham and York Archaeological Trust.

Lewis, C., 2006 'The Medieval Period' in N. J. Cooper (ed) 2006 185 -216.

ULAS. 2015 *Written Scheme of investigation for Archaeological Field Evaluation at Main Street, 46 Orton-on-the-Hill, Leicestershire*

### **Acknowledgements**

The fieldwork was undertaken on behalf of Mrs M Whitehouse and was carried out by Adam Clapton. Patrick Clay managed the project. We would like to thank Neil Keating for providing information and arranging access.

Adam Clapton  
ULAS  
University of Leicester  
University Road  
Leicester LE1 7RH

Tel: 0116 252 2848  
Fax: 0116 252 2614  
Email: [ulas@le.ac.uk](mailto:ulas@le.ac.uk)

14.01.2016

## Appendix 1 – Trench Photographs



**Figure 5: Trench 1 looking east**



**Figure 6: Trench 2 looking west**

## Contact Details

Richard Buckley or Patrick Clay  
University of Leicester Archaeological  
Services (ULAS)  
University of Leicester,  
University Road,  
Leicester LE1 7RH

**T:** +44 (0)116 252 2848

**F:** +44 (0)116 252 2614

**E:** [ulas@le.ac.uk](mailto:ulas@le.ac.uk)

**W:** [www.le.ac.uk/ulas](http://www.le.ac.uk/ulas)



INVESTOR IN PEOPLE



THE QUEEN'S  
ANNIVERSARY PRIZES  
FOR HIGHER AND FURTHER EDUCATION  
2013

