



University of
Leicester

Archaeological Services

**A Photographic Survey of the HORSA
hut at Westfield Junior School,
Westfield Road, Hinckley, Leicestershire
NGR: SP 41970 93244**

Sophie Clarke



ULAS Report No 2014-166.
©2014

**A Photographic Survey of the
HORSA hut at Westfield Junior School,
Westfield Road, Hinckley,
Leicestershire**

NGR: SP 41970 93244

Sophie Clarke

For: Leicestershire County Council

Checked by:

Signed:



Date: 19.09.2014

Name: Patrick Clay

University of Leicester

Archaeological Services

University Rd., Leicester, LE1 7RH

Tel: (0116) 2522848 Fax: (0116) 2522614

ULAS Report Number 2014-166

X.A123.2014 ©2014

CONTENTS

Background	1
Methodology	3
Photographic Survey	4
Archive	10
Publication.....	10
Acknowledgements	10
Bibliography.....	10
Appendix 1: Oasis Record	11

FIGURES

Figure 1. Site Location in Hinckley	1
Figure 2. Plan of Westfield School, with HORSAs hut highlighted (supplied by client; not to scale)	2
Figure 3. Location of figures 4-14 on ground floor plan of Westfield junior School (plan supplied by school; scale approximate).	4
Figure 4. HORSAs canteen, main entrance, looking west.....	4
Figure 5. Canteen exterior, looking south.	5
Figure 6. Looking east towards second HORSAs building, not part of present development scheme.	5
Figure 7. Canteen and kitchen block, looking east.	6
Figure 8. Kitchen block and garden area, looking north.	6
Figure 9. Boiler house, looking south-west.	7
Figure 10. Canteen interior, looking west.	7
Figure 11. Crittal-style windows, looking north-west.	8
Figure 12. Timber shutters to serving hatch, looking south.	8
Figure 13. Kitchen area, looking north towards serving hatch.	9
Figure 14. Kitchen interior, looking east.	9

A Photographic Survey of the HORSА hut at Westfield Junior School, Westfield Road, Hinckley, Leicestershire

Sophie Clarke

NGR: SP 41970 93244

Summary

An photographic survey (English Heritage Level 2) was carried out on the 11th of September 2014 of the HORSА hut at Westfield Junior School, Westfield Road, Hinckley, Leicestershire. The hut is used as the school canteen and kitchen and was constructed circa 1947, as part of the HORSА programme (Hutting Operation for the Raising of the School Leaving Age. The building is due for demolition, as part of the upgrading of the school kitchen. The archive will be deposited with Leicestershire County Council Museums Service under the accession number X.A123.2014.

Background

This document presents the results of a photographic survey of the HORSА hut at Westfield Junior School, Westfield Road, Hinckley, Leicestershire SP 41970 93244.

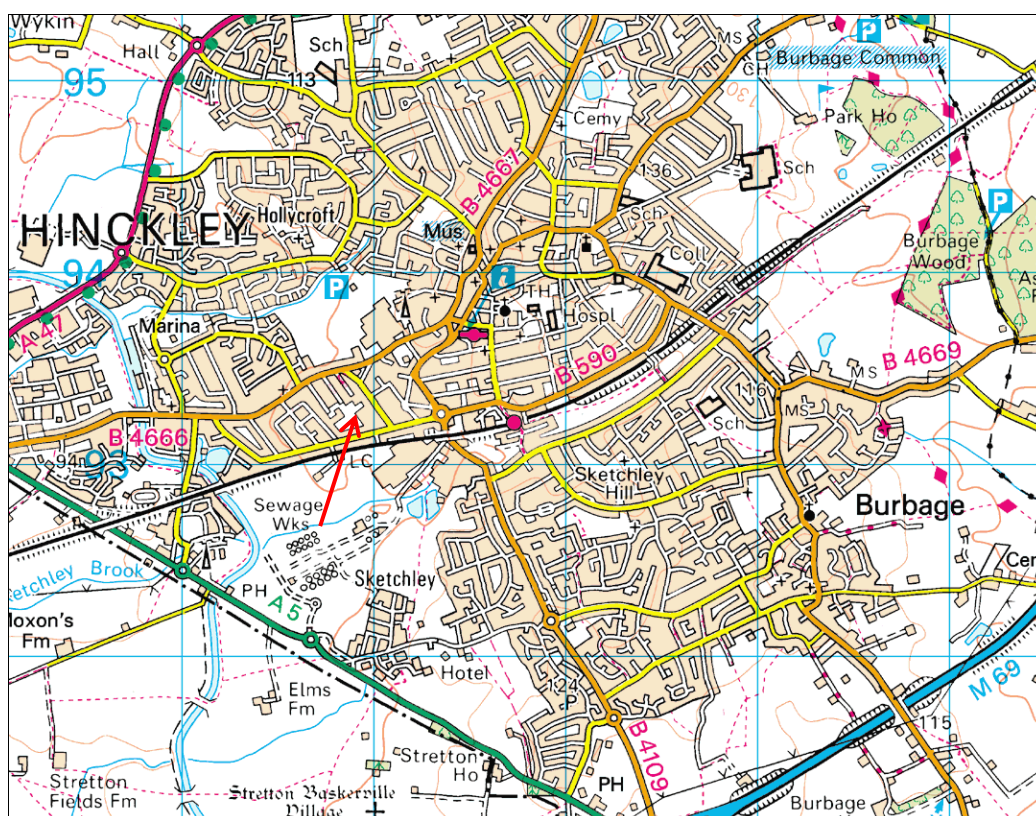

Figure 1. Site Location in Hinckley

Reproduced from Landranger Map 140 (Leicester & Hinckley) by permission of Ordnance Survey® on behalf of The Controller of Her Majesty's Stationery Office. © Crown copyright 2014
All rights reserved. Licence number AL 100029495.

The work was carried out in order to meet the requirements of the brief for an historic building photographic survey, issued by the Senior Planning Archaeologist at Leicestershire County Council, in advance of the redevelopment of the site.

The kitchen and dining block at Westfield Junior School was constructed *circa* 1947, as part of the national HORSAs programme (Hutting Operation for the Raising of the School Leaving Age), which was implemented in response to the 1944 Education Act (the Butler Act). These prefabricated buildings were designed as a temporary solution to a sudden increase in demand for school accommodation during the post-war population boom, when the school leaving age was raised to 15.

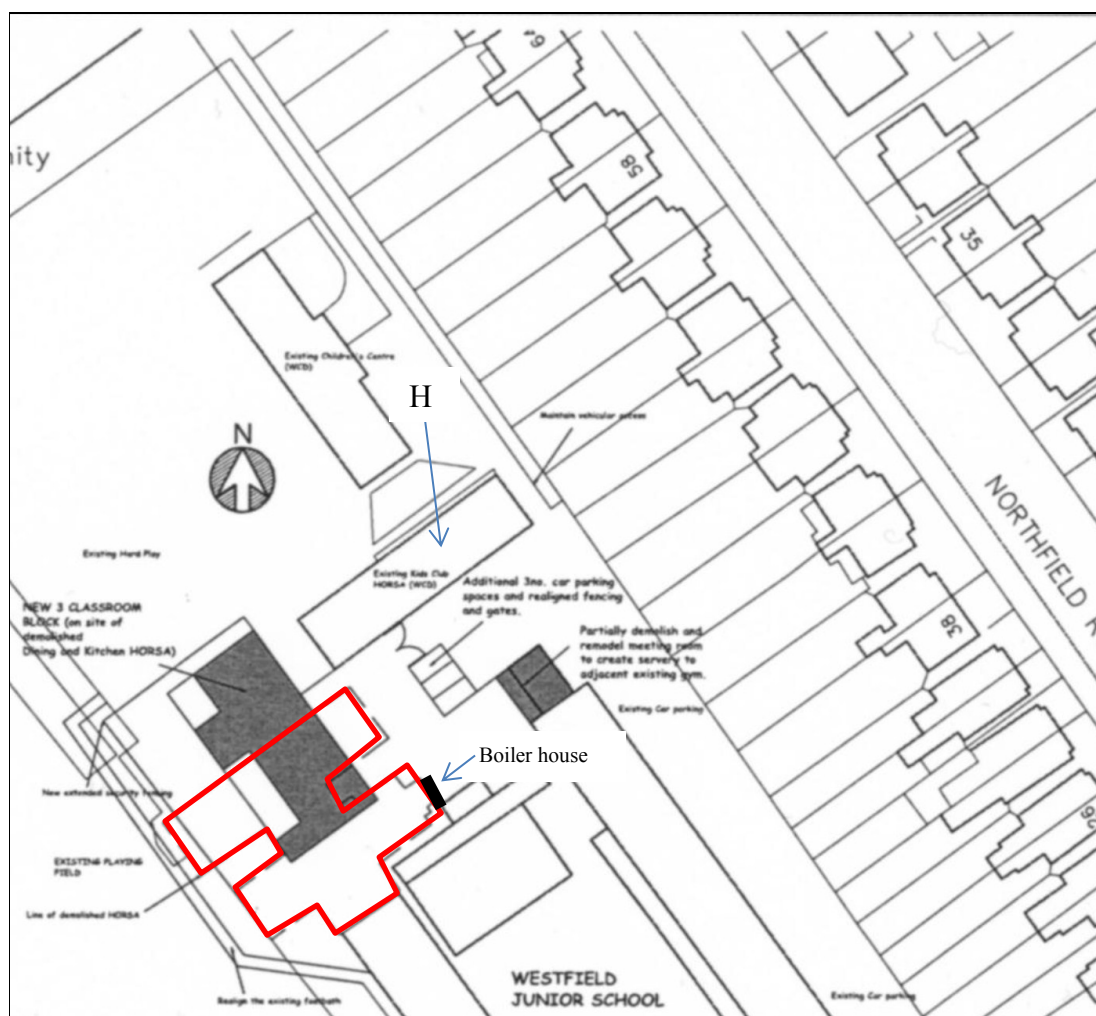

Figure 2. Plan of Westfield School, with HORSAs hut highlighted (supplied by client; not to scale). A second HORSAs Hut not part of the application area is arrowed (H)

Methodology

The photographic record followed the photographic section of Level 2 of English Heritage's *Understanding Historic Buildings* (2006). It included:

Item 1: General view or views of the exterior of the building.

Item 2: The overall appearance of principal rooms and circulation areas.

Item 3: Detailed coverage of the building's exterior appearance.

Item 4: Any external detail, structural or decorative, which is relevant to the building's design, development and use and which does not show adequately on general photographs.

Item 5: The building's relationship to its setting, to other buildings, or to a significant viewpoint.

Item 6: Internal detail, structural and decorative, which is relevant to the building's design, development and use, and which does not show adequately on general photographs.

A summary of the building's type or purpose, historically and at present, its materials and possible date (s).

All work followed the Institute for Archaeologists (IfA) *Code of Conduct* (rev. 2010) and adhered to their *Standard and Guidance for Archaeological Investigation and Recording of Standing buildings or Structures* (2008). In addition, Leicestershire County Council's *Guidelines and Procedures for Archaeological Work in Leicestershire* was adhered to.

The buildings were photographed using a Pentax K-7 digital camera and Pentax P30 35mm film camera. The film used was Ilford HP5 rated at 400asa. Digital images were taken in proprietary RAW format and converted into TIFFs for the archive.

A floor plan was supplied by the school administrator and has been used to locate the archived photographs. Selected photographs from the archive have been reproduced below in order to illustrate the report.

Results

The photographic survey was carried out on the 11th of September 2014 by Sophie Clarke of University of Leicester Archaeological Services (ULAS), following procedure defined by English Heritage guidelines (2006) 'Understanding Historic Buildings: a guide to good recording practice'.

The HORSAs block consists of a prefabricated H-plan structure, of pre-cast concrete set into a steel frame, with asbestos panelled roof and Crittal-style, steel framed windows. At the time of the site visit, the buildings were in use as the school kitchens and dining room, with a small area recently partitioned off for use as a music room.

Photographic Survey

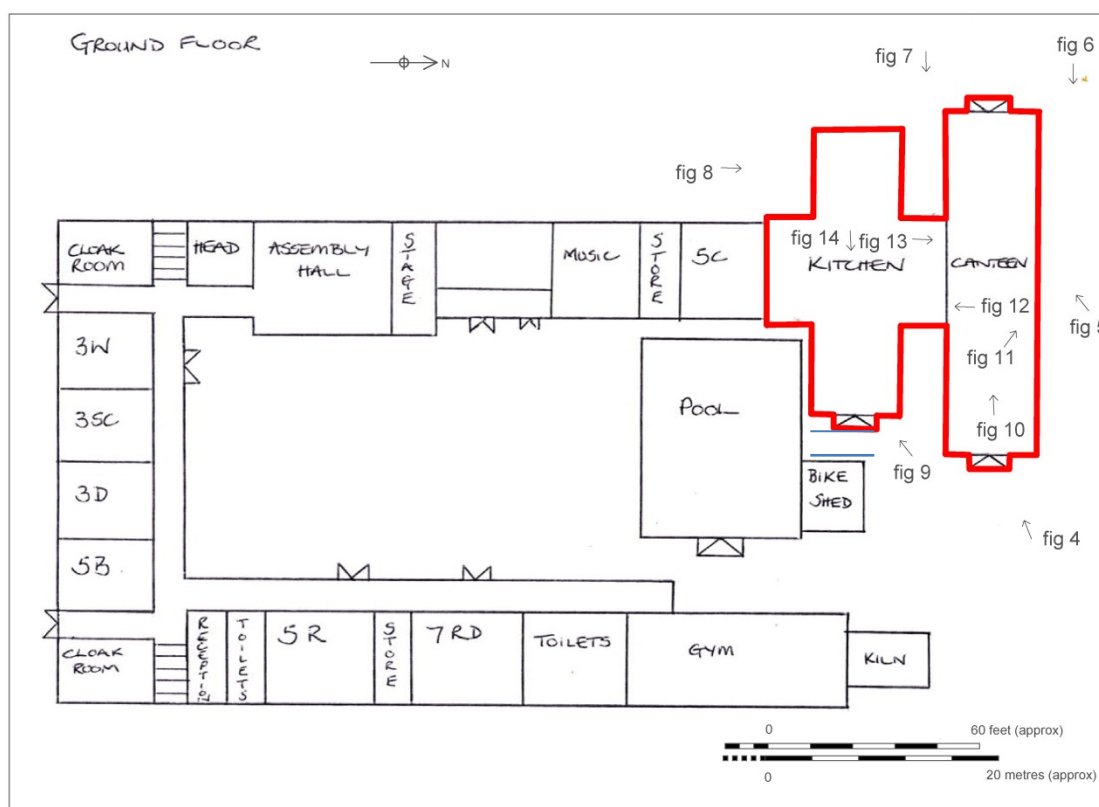

Figure 3. Location of figures 4-14 on ground floor plan of Westfield junior School (plan supplied by school; scale approximate).



Figure 4. HORS A canteen, main entrance, looking west.



Figure 5. Canteen exterior, looking south.



Figure 6. Looking east towards second HORSAs building, not part of present development scheme.



Figure 7. Canteen and kitchen block, looking east.



Figure 8. Kitchen block and garden area, looking north.



Figure 9. Boiler house, looking south-west.



Figure 10. Canteen interior, looking west.



Figure 11. Crittal-style windows, looking north-west.



Figure 12. Timber shutters to serving hatch, looking south.



Figure 13. Kitchen area, looking north towards serving hatch.



Figure 14. Kitchen interior, looking east.

Archive

The archive consists of the digital image files on DVD, digital contact sheets, monochrome film and associated contact prints, a floor plan of the building showing position and direction of all photographs taken and a photographic index. It will be deposited with Leicestershire County Council under the accession number X.A123.2014.

Publication

A version of the summary will appear in *Transactions of the Leicestershire Archaeological and Historical Society* in due course. The report will be added to the Archaeology Data Service's (ADS) Online Access to the Index of Archaeological Investigations (OASIS) database.

Acknowledgements

The project was managed by Dr. Patrick Clay and carried out by Sophie Clarke of ULAS.

Bibliography

Cowan, S., McCulloch, G. and Woodin, T., 2012 *From HORSAs huts to ROSLA blocks: the school leaving age and the school building programme in England, 1943–1972*. *History of Education*, 41 (3). p. 361. ISSN 0046-760X

English Heritage, 2006 *Understanding Historic Buildings*

IfA, 2010 *Code of Conduct*.

IfA, 2008 *Standard and Guidance for Archaeological Investigation and Recording of Standing buildings or Structures*.

Leicestershire County Council, 1997 *Guidelines and Procedures for Archaeological Work in Leicestershire*.

Sophie Clarke

ULAS

University of Leicester

University Road

Leicester LE1 7RH

Tel: 0116 252 2848

Fax: 0116 252 2614

Email:

sjc46@le.ac.uk

19-09-2014

Appendix 1: Oasis Record

INFORMATION REQUIRED	EXAMPLE
Project Name	Westfield Junior School
Project Type	Building survey
Project Manager	Patrick Clay
Project Supervisor	Sophie Clarke
Previous/Future work	unknown
Current Land Use	school
Development Type	school
Reason for Investigation	Pre-planning
Position in the Planning Process	Pre-planning
Site Co ordinates	SP 42007 93217
Start/end dates of field work	September 2014
Archive Recipient	LMARS
Height min/max	not known
Study Area *	0.5 ha
Finds	None

Contact Details

Richard Buckley or Patrick Clay
University of Leicester Archaeological
Services (ULAS)
University of Leicester,
University Road,
Leicester LE1 7RH

T: +44 (0)116 252 2848

F: +44 (0)116 252 2614

E: ulas@le.ac.uk

w: www.le.ac.uk/ulas



INVESTOR IN PEOPLE



**University of
Leicester**
Archaeological Services



THE QUEEN'S
ANNIVERSARY PRIZES
FOR HIGHER AND FURTHER EDUCATION
2013



2013
THE AWARDS
AWARD WINNER
RESEARCH PROJECT OF THE YEAR