

**An archaeological watching brief during the
excavation of foundation trenches at land to the
rear of Quorn Conservative club, Nursery Lane,
Quorn, Leicestershire (SK 562 166)**

Jon Coward

For Quorn Homes Ltd

Planning Application: P/03/2072/2

University of Leicester Archaeological Services

Report no 2005/053

© ULAS 2005

1 Summary

An archaeological watching brief was carried out by ULAS for Quorn Homes Ltd in April 2004 during the construction of foundation trenches for redevelopment at the rear of Quorn Conservative Club, Nursery Lane, Quorn, Leicestershire (SK 562 166). Some wall footings were revealed during the watching brief, but no finds. The archive will be deposited with Leicestershire County Council Museums Service under X.A46.2005

2. Introduction

The site is located on Nursery Lane, Quorn, Leicestershire (SK 562 166), to the rear of the Conservative Club at 40 Station Road (fig 1). The area has been identified as of archaeological potential from information held in the Leicestershire and Rutland Sites and Monuments Record. The site is located in an area containing several examples of medieval archaeology.

3. Aims and Methods

The aim of the watching brief was to record any archaeological evidence revealed by ground disturbance. The watching brief took place in April 2004.

All work adhered to the Institute of Field Archaeologists's *Code of Conduct and Standard and Guidance for Archaeological Watching Briefs* and the *Guidelines and procedures for archaeological work in Leicestershire and Rutland* (Leicestershire Museums Service).

4. Results

Existing buildings had been demolished and much of the site cleared before the commencement of the watching brief. The watching brief covered the excavation of foundation trenches by JCB for the new development, which comprises two small blocks of flats. The foundation trenches for the load bearing walls reached a maximum of 1.3m below ground surface; the interior wall positions were excavated to c.40cms. A larger rectangular pit was excavated in the area of the stairwells of the southern block of flats. Approximately 30 - 40cms of disturbed soil and building debris was revealed by the foundation trenches, over a light brown sandy clay. The lower natural substrata appeared mixed: sandy gravels, sandy clay, and sand were present. No archaeological finds of any antiquity were recovered by the watching brief, the earliest material being occasional 'thin' brick of possible 18th century origin. In three places there was evidence of previous wall footings being present, marked A,

B and C on fig 2. Footing A was the most substantial, and crossed the foundation trench at a right angle, as far as could be told, parallel to the Nursery Lane frontage; footing B could be a return of the same structure. Only one edge of footing C was visible. Footing A was a mixture of chunks of chalk/lime mortar, clinker, and clay soil with granite masonry, more bonding than masonry: in general the footings were not of high constructional quality. Nevertheless, footing A included several large, properly dressed, granite blocks up to 45cms in length. Presumably these were a re-use of material as several fragments of brick or tile were also present, making a construction date of 18th or 19th century likely.

5. Archive

The archive consists of :

- 1 *pro-forma* watching brief record sheet
- 11 colour prints showing the wall footings and nature of the work undertaken
- 1 annotated site plan showing position of archive photos

It will be deposited with Leicestershire County Council Museums Service under accession number X.A46.2005

6. Acknowledgements

The project was carried out by Jon Coward, project management was by Richard Buckley. ULAS would like to thank Monty Katchick of Quorn Homes for his assistance.

7. Illustrations

- 1a,1b: Location of site
- 2: New development and position of wall footings seen
- 3: Section of wall footing

8. Publication

A version of the summary above will be published in *Transactions of the Leicestershire Archaeological and Historical Society* in due course.

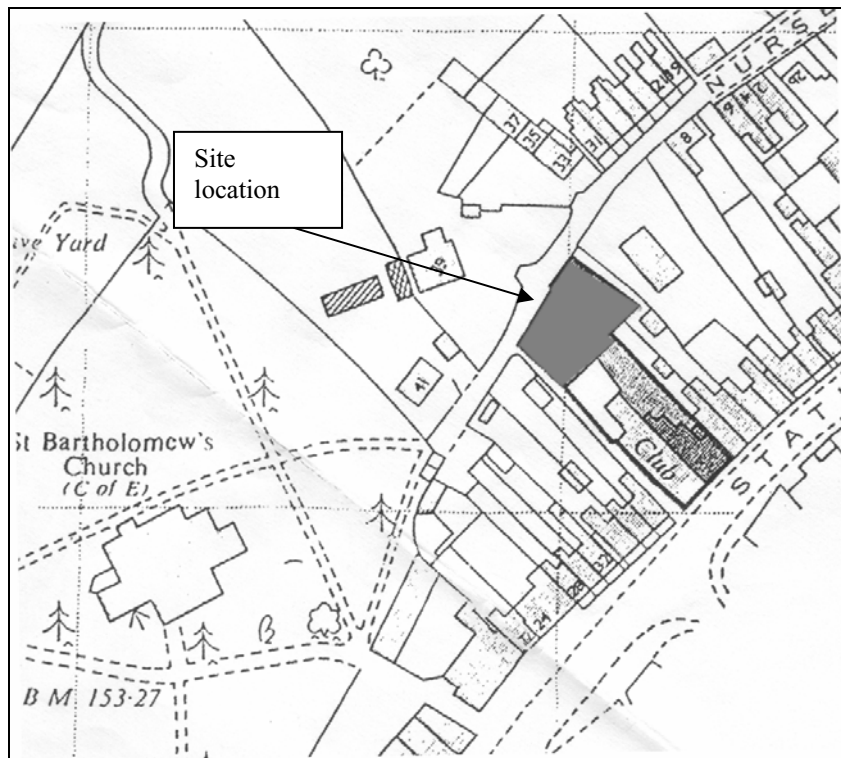
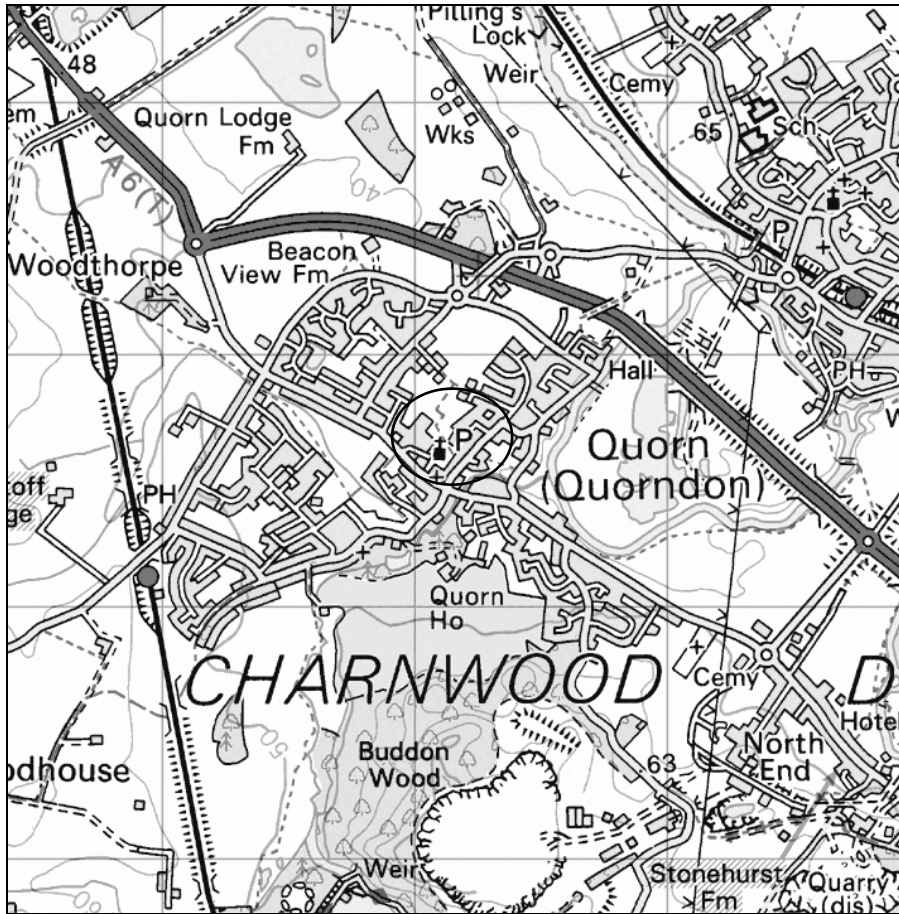

Figs 1a, 1b. Location of Site. © Crown Copyright. All rights reserved. Licence number AL 100021186

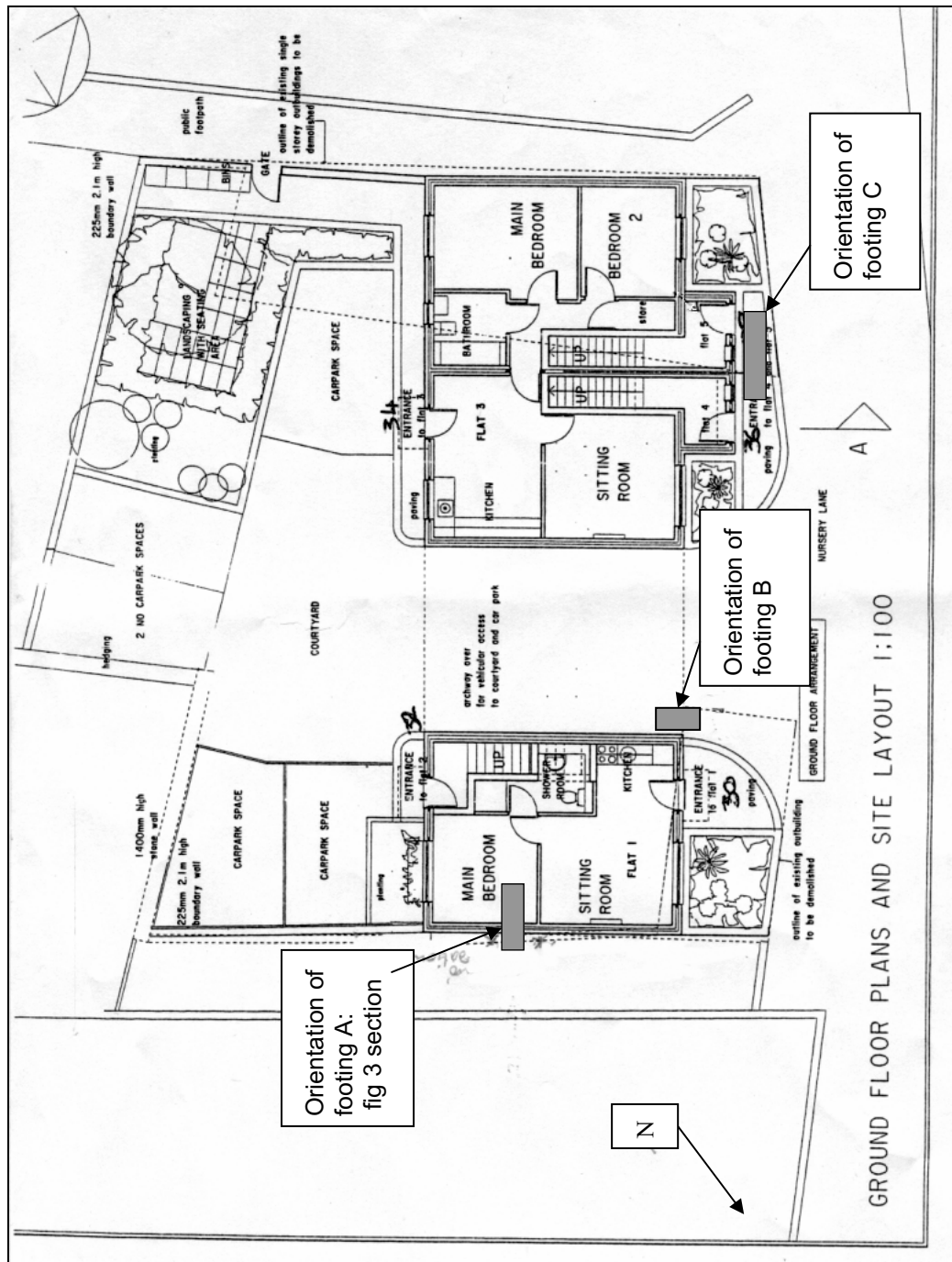

Fig 2

Layout of new development, with position of wall footings

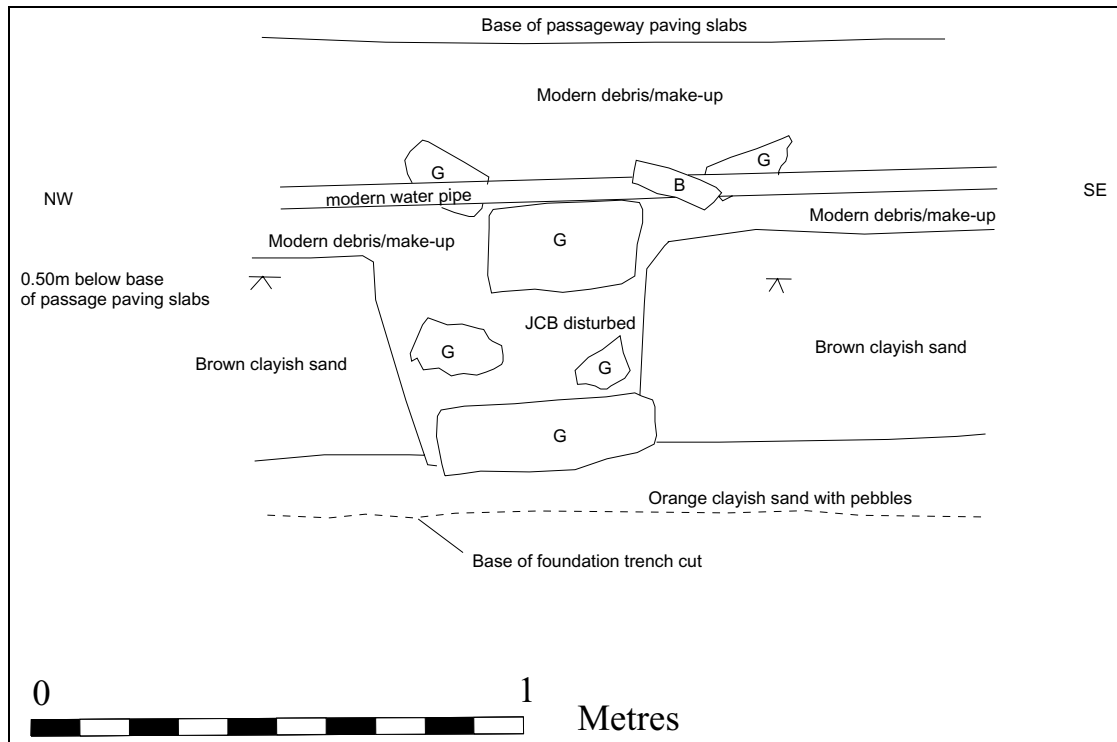

Fig 3 Section through footing A

G = granite, B = brick