

**Archaeological Work at Ridlington Park Farm,
Ridlington, Rutland, (SK 833 019))**

Greg Farnworth-Jones

**Planning Application No. 06/00824/9
For Concept Grain Systems**

Checked by Project Manager

Signed:Date:.....

Name: Patrick Clay

**University of Leicester
Archaeological Services**

University Rd., Leicester, LE1 7RH
Tel: (0116) 2522848 Fax: (0116) 2522614
Website: <http://www.le.ac.uk/ulas/>

**Archaeological Work at Ridlington Park Farm, Ridlington, Rutland
(SK 833 019)**

Contents

1	Summary	1
2	Introduction	1
3	Site Background	1
4	Methodology	3
5	Results	4
6	Conclusion	4
7	Acknowledgements	5
8	Bibliography	5
9	Appendix. Design Specification	6

Figures

Fig.1	Location of Development	2
Fig.2	Location of Development in relation to trial trench	3

**Archaeological Work at Ridlington Park Farm, Ridlington, Rutland
(SK 833 019)**

Greg Farnworth-Jones

1. Summary

Archaeological work was carried out on land at Ridlington Park Farm, Ridlington, Rutland (SK 833 019), on the 31st October 2006. This work was in advance of the proposed construction of a new grain store. This work was carried out on behalf of the client Concept Grain Systems by University of Leicester Archaeological Services. One evaluation trench was excavated by measuring 30m x 1.5m and further ground works were observed. The results of this work were negative. The site archive will be held by Leicestershire County Council, Heritage Services Section, accession number RT07.2006.

2. Introduction

2.1 This document constitutes the archaeological assessment to be carried out on land at Ridlington Park Farm, Ridlington, Rutland (SK 833 019). The archaeological assessment was being undertaken on behalf of Concept Grain Systems by University of Leicester Archaeological Services.

2.2 Concept Grain Systems propose to build a new grain store at Ridlington Park Farm, Ridlington, Rutland (SK 833 019). The Senior Planning Archaeologist of the Historic and Natural Environment Team of Leicestershire County Council, in his capacity as archaeological adviser to the planning authority, requested that an archaeological watching brief of the site area be carried out during the ground works. It was requested that an archaeological trial trench of 30m x 1.5m be excavated prior to the start of the ground works.

3 Site Background

3.1 The Ordnance Survey Geological Survey of Great Britain, Sheet 157 indicates that the underlying geology is likely to consist of Lower Lincolnshire Limestone. The trial trenching confirmed this but also revealed pockets of clay within the limestone.

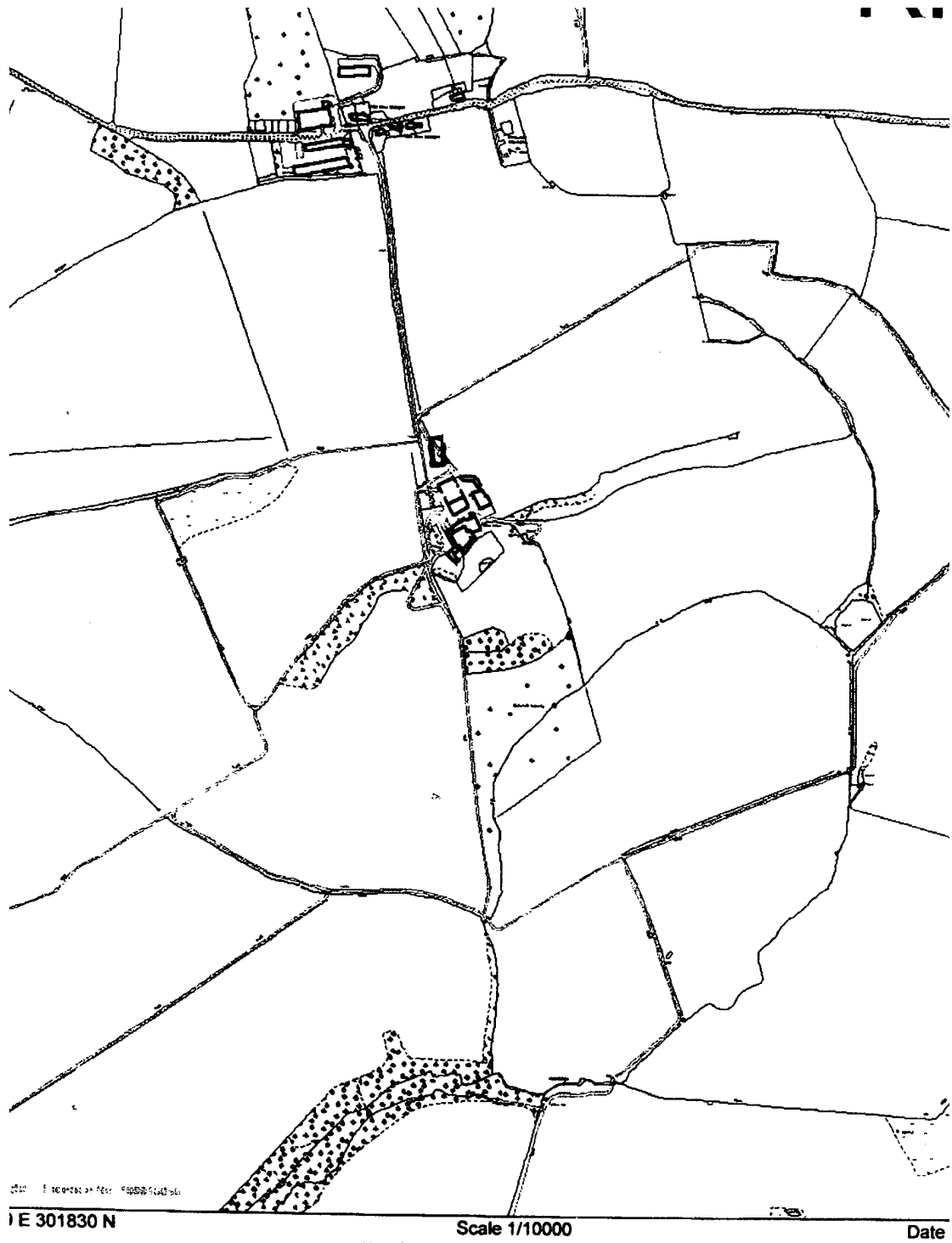

Figure 1 Location of Development.

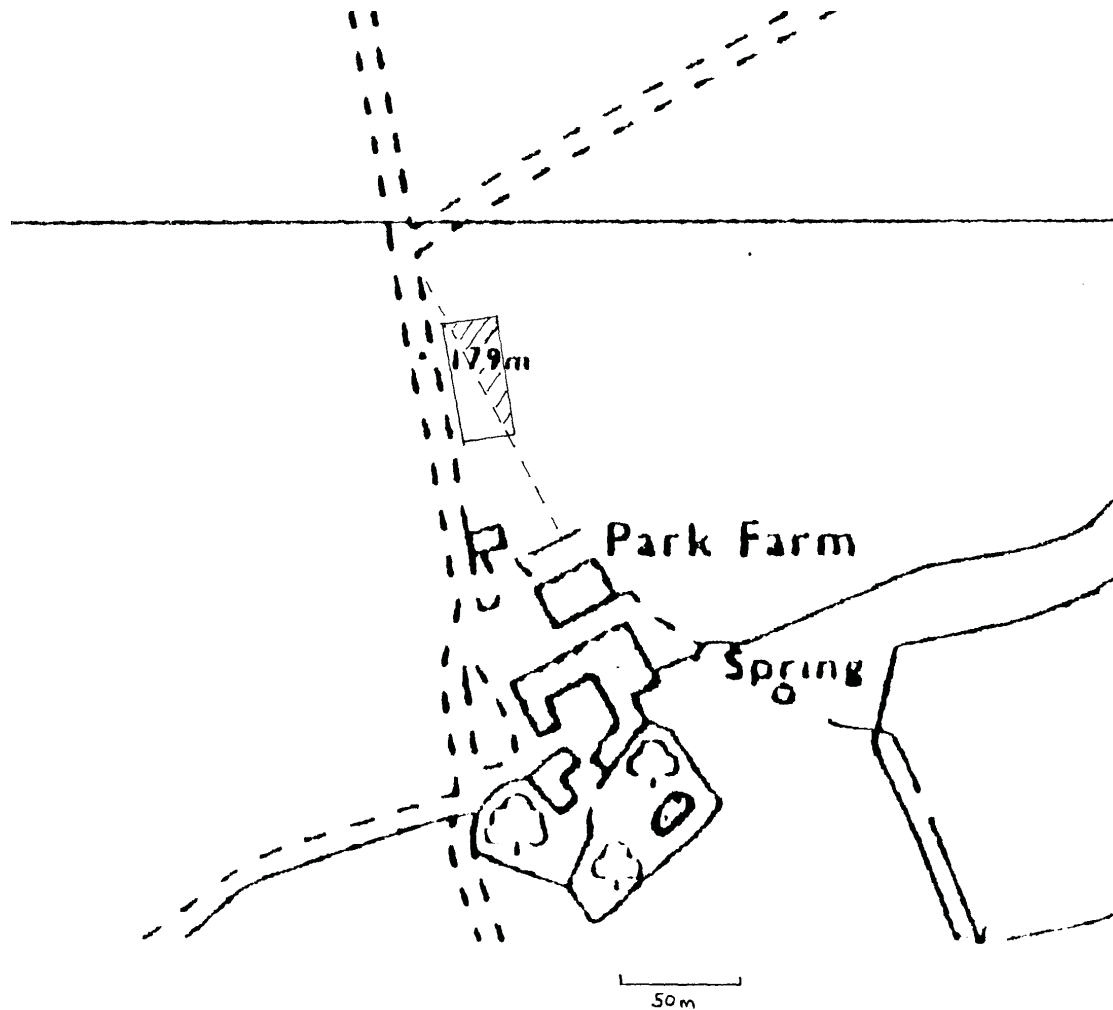

Figure 2 Location of Development Showing location of proposed new grain store in relation area of watching brief within ploughed field (hatched). North to the top

4. Methodology

4.1 All work followed the Institute of Field Archaeologists (IFA) Code of Conduct and adhered to their *Standard and Guidance for Archaeological Field Evaluations*.

4.2 The main objectives of the archaeological work were:

1. To identify the presence/absence of any archaeological deposits.
2. To establish the character, extent and date range for any archaeological deposits to be affected by the proposed ground works.
3. To produce an archive and report of any results.

4.3 The Senior Planning Archaeologist had requested that a *c.* 5 % sample of the area (*c.*40 sq metres) prior to the control and supervision of the ground works. The work followed the *Design Specification for Archaeological work* approved by the Senior Planning Archaeologist as advisor to the planning authority (Clay, 2006). This comprised of a 30m x 1.5m trial trench. In addition to the trial trench the Senior Planning Archaeologist requested the control and supervision of the groundworks.

4.4 Topsoil/modern overburden was removed in level spits, under continuous archaeological supervision, down to the uppermost archaeological deposits or natural. Trenches were excavated to the dimensions of 1m x 1m.

4.5 Trenches were examined by appropriate hand cleaning. Any archaeological deposits or significant natural deposits were planned at an appropriate scale and sample-excavated by hand as appropriate to establishing the stratigraphic and chronological sequence. All plans have been tied into the Ordnance Survey National Grid. Spot heights were taken as appropriate.

4.6 Sections were drawn as appropriate, including records of at least one longitudinal face of each trench.

4.7 Trench locations were recorded using an electronic distance measurer and tied in to the Ordnance Survey National Grid.

5. Results

5.1 Trench 1

Trench 1 Details

<i>Length of Trench</i>	28m
<i>Area of Trench</i>	42sq.m
<i>Surface Level (m OD)</i>	<i>c.</i> 134.3m OD
<i>Base of Trench (m OD)</i>	<i>c.</i> 133.45m OD
<i>Top of Natural (m OD)</i>	<i>c.</i> 133.45m OD

The archaeological evaluation trench was located in the middle of the proposed development area (Fig 2) and was orientated northwest-southeast.

Initial machining revealed mid-light brown clay silt topsoil to a depth of 0.4m. Machining below the topsoil revealed a mid reddish brown silty clay subsoil with >10% gravels. The natural substratum was reached at *c.*0.1m which was revealed to be a light yellow brown boulder clay with mixed gravels <40%. No archaeological features were seen in Trench 1.

During the controlled observations of the further ground works no archaeological features were observed

6 Conclusion

6.1 The archaeological trial trench and subsequent ground works failed to reveal any archaeological deposits. Therefore the results of the archaeological work were negative.

7 Acknowledgements

I would like to thank the clients, Concept Grain Systems, for their assistance and co-operation on site. Patrick Clay, who managed the project and the fieldwork was carried out by the author, all of ULAS.

8 Bibliography

Clay, P., 2006 *Design Specification for archaeological work, Ridlington Park Farm, Ridlington, Rutland (SK 833 019)* ULAS Ref. 06/644

Greg Farnworth-Jones
University of Leicester Archaeological Services
University of Leicester
University Road
Leicester LE1 7RH

Tel: 0116 252 2848
Fax: 0116 252 2614
Email: gj28@le.ac.uk

20.12.2006

9 Appendix Design Specification

UNIVERSITY OF LEICESTER ARCHAEOLOGICAL SERVICES

Design Specification for archaeological work

Ridlington Park Farm, Ridlington, Rutland (SK 833 018)

Planning Application: 06/00824/9

For: Concept Grain Systemss

1 Definition and scope of the specification

1.1 In accordance with Planning Policy Guidelines 16 (PPG16, Archaeology and planning), para.30, this specification provides a written scheme for archaeological attendance, including control and supervision of ground works, as required by the Planning Authority, of any ground works on the site which may disturb areas of archaeological potential in connection with a planning application for the construction of a new grain store at Ridlington Park Farm, Ridlington, Rutland (SK 833 018) for Concept Grain Systems.

1.2 All archaeological work will adhere to the Institute of Field Archaeologist's (IFA) *Code of Conduct and Standard and Guidance for Archaeological Watching Briefs* and the *Guidelines for Archaeological Work in Leicestershire and Rutland (LMARS)*.

2 Background

2.1 Requirement for archaeological work

2.1.1 The archaeological work involves the control and supervision of the groundworks to identify any deposits of archaeological importance as detailed in the advice letter to the planning authority (LCC 03.10.2006).

2.2 Archaeological potential

2.2.1 The development is in a rich archaeological landscape close to known Bronze Age and Roman sites (Beamish 2002; 2005). A Bronze Age settlement was located north of Park Farm (*ibid*) while flint scatters and cropmarks of enclosures lie to the east and of a ring ditch to the west (HER refs LE5660-3).

3 Aims

3.1 Through archaeological observation of existing overburden stripping and groundworks by the client's contractors:

1. To identify the presence/absence of any earlier building phases or archaeological deposits.
2. To establish the character, extent and date range for any archaeological deposits to be affected by the proposed ground works.
3. To record any archaeological deposits to be affected by the ground works.
4. To produce an archive and report of any results.

4 Methods

4.1 The project will involve the observation of overburden removal and other groundworks by an experienced professional archaeologist during the works specified above. Initially trial trenches will be excavated to assess the presence, extent and character of any archaeological deposits. During these ground works, if any archaeological deposits are seen to be present, the archaeologist will record areas of archaeological interest.

4.2 The archaeologist will co-operate at all times with the contractors on site to ensure the minimum interruption to the work.

4.3 Any archaeological deposits located will be hand cleaned and planned as appropriate. Samples of any archaeological deposits located will be hand excavated. Measured drawings of all archaeological features will be prepared at a scale of 1:20 and tied into an overall site plan of 1:100. All plans will be tied into the National Grid using an Electronic Distance Measurer (EDM) where appropriate.

4.4 Archaeological deposits will be excavated and recorded as appropriate to establishing the stratigraphic and chronological sequence of deposits, recognising and excavating structural evidence and recovering economic, artefactual and environmental evidence. Particular attention will be paid to the potential for buried palaeosols and waterlogged deposits in consultation with ULAS's environmental officer.

4.5 All excavated sections will be recorded and drawn at 1:10 or 1:20 scale, levelled and tied into the Ordnance Survey datum. Spot heights will be taken as appropriate.

4.5 Any human remains encountered will be initially left *in situ* and only be removed under a Home Office Licence and in compliance with relevant environmental health regulations. The developer, Leicestershire County Council and the coroner will be informed immediately on their discovery.

4.6 Internal monitoring procedures will be undertaken including visits to the site from the project manager. These will ensure that professional standards are being maintained. Provision will be made for monitoring visits with representatives of the owners, Leicestershire County Council, Heritage Services and Harborough District Council.

4.7 In the event of significant archaeological remains being located during the watching brief there may be the need for contingency time and finance to be provided to ensure adequate recording is undertaken ('Brief' 8.11). On the discovery of potentially significant remains the archaeologist will inform the developer, the Planning Archaeologist at Leicestershire County Council, Heritage Services and the planning authority. If the archaeological remains are identified to be of significance additional contingent archaeological works will be required.

5 Recording Systems

5.1 Individual descriptions of all archaeological strata and features excavated or exposed will be entered onto prepared pro-forma recording sheets.

5.2 A site location plan based on the current Ordnance Survey 1:1250 map, (reproduced with the permission of the Controller of HMSO) will be prepared. This will be supplemented by a plan at 1:200 (or 1:100), which will show the location of the areas investigated.

5.3 A record of the full extent in plan of all archaeological deposits encountered will be made on drawing film, related to the OS grid and at a scale of 1:10 or 1:20. Elevations and sections of individual layers of features should be drawn where possible. The OD height of all principal strata and features will be calculated and indicated on the appropriate plans.

5.4 An adequate photographic record of the investigations will be prepared. This will include black and white prints and colour transparencies illustrating in both detail and general context the principal features and finds discovered. The photographic record will also include 'working shots' to illustrate more generally the nature of the archaeological operation mounted.

5.5 This record will be compiled and fully checked during the course of the watching brief.

5.6 All site records and finds will be kept securely.

6 Report and Archive

6.1 An accession number will be drawn prior to the commencement of the project (Brief 8.1). Following the fieldwork the on-line OASIS form at <http://ads.ahds.ac.uk/project/oasis> will be completed. A report on the investigation will be provided following the groundworks.

6.2 Copies will be provided for the client, Sites and Monuments Record and planning Authority. The copyright of all original finished documents shall remain vested in ULAS and ULAS will be entitled as of right to publish any material in any form produced as a result of its investigations.

6.3 A full copy of the archive as defined in the 'Guidelines for the preparation of excavation archives for long-term storage' (UKIC 1990), and Standards in the Museum care of archaeological collections (MGC 1992) and 'Guidelines for the preparation of site archives and assessments for all finds (other than fired clay objects) (Roman Finds Group and Finds Research Group AD 700-1700 1993) will be presented to Leicestershire County Council, Heritage Services normally within six months of the completion of analysis. This archive will include all written, drawn and photographic records relating directly to the investigations undertaken.

7 Publication

7.1 A summary report will be submitted to a suitable regional or national archaeological journal within one year of completion of fieldwork. A full report will be submitted if the results are of significance.

8 Timetable and Staffing

8.1 The investigation is scheduled to commence during w.c 30.10.2006. An experienced archaeologist will be present during this work. It is proposed to supervise all works, as specified above, initially starting with a 30m trial trench

9 Health and Safety

9.1 ULAS is covered by and adheres to the University of Leicester Statement of Safety Policy and uses the ULAS Health and Safety Manual (revised 2005) with appropriate risks assessments for all archaeological work. A draft Health and Safety statement for this project is in the Appendix. The relevant Health and Safety Executive guidelines will be adhered to as appropriate.

10 Insurance

10.1 All ULAS work is covered by the University of Leicester's Public Liability and Professional Indemnity Insurance. The Public Liability Insurance is with St Pauls Travellers

Policy No. UCPOP3651237 while the Professional Indemnity Insurance is with Lloyds Underwriters (50%) and Brit Insurances (50%) Policy No. FUNK3605.

11. Bibliography

Beamish, M., 2002 *Archaeology of the Wing to Whatborough Hill Trunk Main., Sites 2-10* ULAS Report 2002-099.

Beamish, M., 2005 *Bronze Age settlement at Ridlington, Rutland* Transactions of the Leicestershire Archaeological and Historical Society **79** , 1-26.

MAP 2, *The management of archaeological projects* 2nd edition English Heritage 1991

MGC 1992, *Standards in the Museum Care of Archaeological Collections* (Museums and Galleries Commission)

RFG/FRG 1993, *Guidelines for the preparation of site archives* (Roman Finds Group and Finds Research Group AD 700-1700)

SMA 1993, *Selection, retention and Dispersal of Archaeological Collections. Guidelines for use in England, Wales and Northern Ireland* (Society of Museum Archaeologists)

Patrick Clay
Director
ULAS
University of Leicester
University Road
Leicester LE1 7RH

Tel:0116 252 2848
Fax: 0116 252 2614
Email: pnc3@le.ac.uk

25.10.2006

Appendix

Draft Project Health and Safety Policy Statement

Ridlington Park Farm, Ridlington, Rutland (SK 833 018)

Planning Application: 06/00824/9

For: Concept Grain Systemss

1 Nature of the work

1.1 This statement is for an archaeological watching brief.

1.2 The work will involve observation of groundworks during daylight hours and recording of any underlying archaeological deposits revealed. Overall depth is likely to be c. 0.2-0.5m. This will involve the examination of the exposed surface with hand tools (shovels, trowels etc) and excavation of archaeological features. All work will adhere to the University of Leicester Health and Safety Policy and follow the guidance in the ULAS Health and Safety Manual (2001) together with the following relevant Health and Safety guidelines.

1.3 HSE Construction Information Sheet CS8 Safety in excavations.
HSE Industry Advisory leaflet IND (G)143 (L): Getting to grips with manual handling.
HSE Industry Advisory leaflet IND (G)145 (L): Watch Your back.
CIRIA R97 Trenching practice.
CIRIA TN95 Proprietary Trench Support Systems.
HSE Guidance Note HS(G) 47 Avoiding danger to underground services. HSE Guidance Note GS7 Accidents to children on construction sites

1.4 The Health and Safety policy on site will be reassessed during the evaluation .

1.5 All work will adhere to the contractors' health and safety policy.

2 Risks Assessment

2.1 Working within a building site

Precautions. No work will be undertaken beneath section faces. Loose spoil heaps will not be walked on. Protective footwear will be worn at all times. Hard hats will be worn at all times. A member of staff qualified in First Aid will be present at all times. First aid kit, vehicle and mobile phone to be kept on site in case of emergency.

2.2 Working with plant.

Precautions. Hard hats, protective footwear and hazard jackets will be worn at all times. No examination of the area of stripping will take place until machines have vacated area. Observation of machines will be maintained during hand excavation. Liaison will be maintained with the contractors to ensure programme of machine movement is understood.

2.3 Working within areas prone to waterlogging.

Protective clothing will be worn at all times and precautions taken to prevent contact with stagnant water which may carry Vialls disease or similar.

2.4 Working with chemicals.

If chemicals are used to conserve or help lift archaeological material these will only be used by qualified personnel with protective clothing (i.e a trained conservator) and will be removed from site immediately after use.

2.5 Other risks

Precautions. If there is any suspicion of unforeseen hazards being encountered e.g chemical contaminants, unexploded bombs, hazardous gases work will cease immediately. The client and relevant public authorities will be informed immediately.

2.9 No other constraints are recognised over the nature of the soil, water, type of excavation, proximity of structures, sources of vibration and contamination.

Patrick Clay
25.09.2006

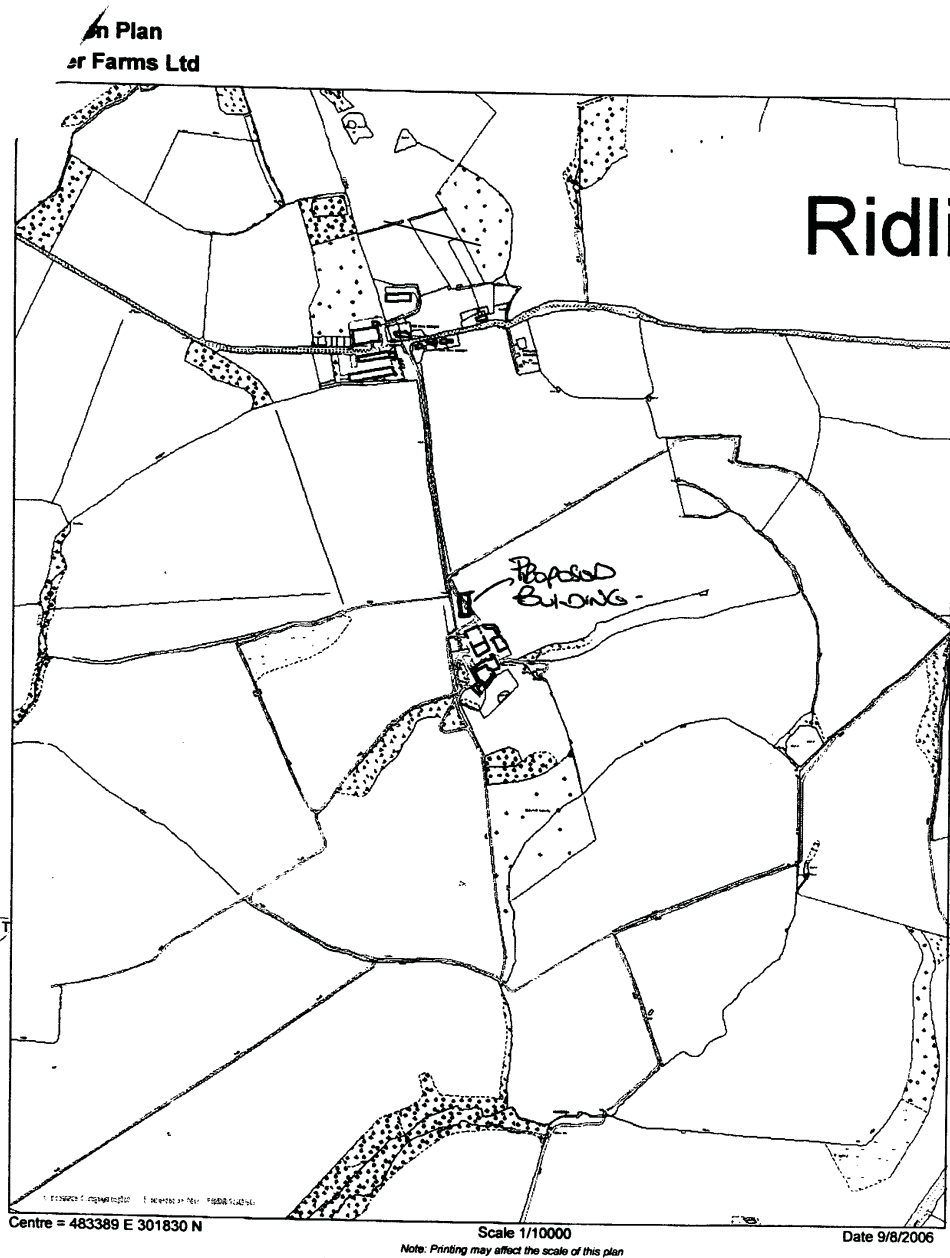

Reproduced from the Ordnance Survey mapping with the permission of the controller of Her Majesty's Stationary Office © Crown Copyright. Unauthorised reproduction infringes Crown Copyright and may lead to prosecution or civil proceedings.

Rutland County Council District Council Licence No. 100018056

MAPS® Aerial Photography Copyright of UK Perspectives
Photography Dates: 23-25/07/99, 10/09/99, 25/08/00



Figure 1 Location of Development.

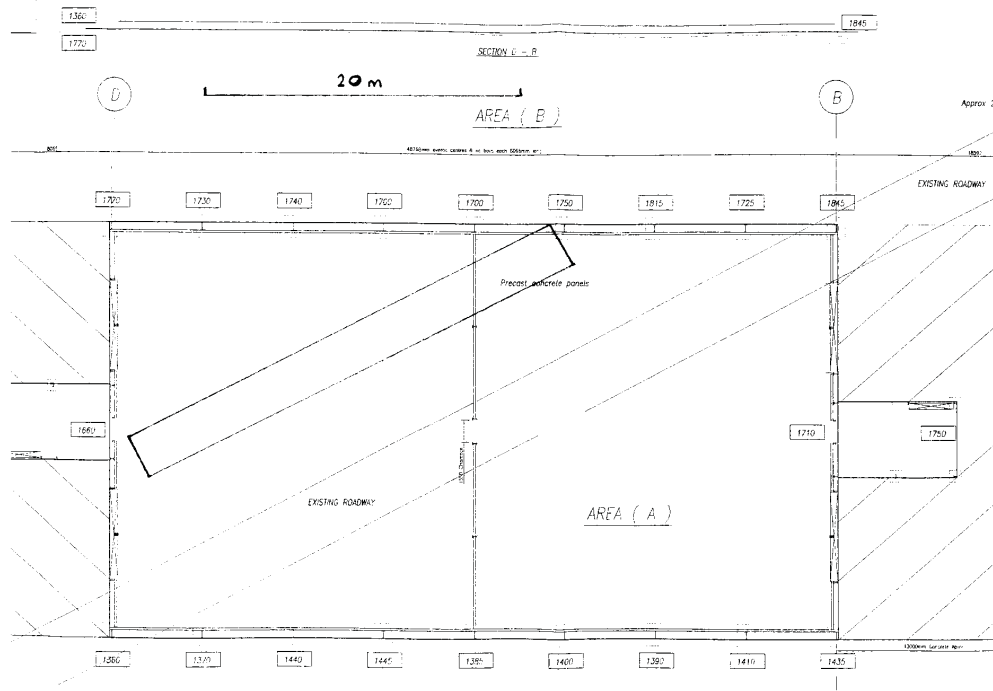

Figure 1 Location of Development Showing Proposed new grain store in relation to trench within ploughed field. North to the left