



UNIVERSITY OF
LEICESTER

Archaeological Services

**An Archaeological Watching Brief for
Land at 23 Lutterworth Road,
Pailton, Rugby,
Warwickshire
CV23 0QE**

NGR: SP 4746 8189

Donald Clark



**ULAS Report No 2022-024
© ULAS 2022**

Site Name: Land at 23 Lutterworth Road, Pailton, Rugby, Warwickshire CV23 0QE

Grid Ref: SP 4746 8189

Author: Donald Clark

Client: MPJ Homes Ltd

Planning Authority: Rugby Borough Council

Planning Refs. R20/0733

ULAS Job No: 22-700

ULAS Report No: 2022-024

Accession Number: T/1894

Filename/Version	Checked by	Date	Notes
2022-024_draft	M.G.Beamish	10/3/2022	Draft to client for comment
2022-024_draft2	M.G.Beamish	18/3/2022	Amended draft for comment
2022-024_final	M.G.Beamish	13/5/2022	Final copy issued, watermark removed

This Report has been prepared solely for the person/party and project for which it has been commissioned and should not be relied upon or used by any other person/party or for any other project without the written consent of ULAS. No part of this report is to be copied in any way without prior written consent. While every effort has been made to provide detailed and accurate information, however, ULAS cannot be held responsible for errors or inaccuracies contained within this report

University of Leicester, Archaeological Services,
University Rd., Leicester, LE1 7RH
Tel: (0116) 2522848
www.le.ac.uk/ulas

© ULAS 2022

OASIS RECORD

PROJECT DETAILS	OASIS ID	universi1- 505249		
	Project Name	An Archaeological Watching Brief for land at 23 Lutterworth Road, Pailton, Rugby, Warwickshire		
	Start/end dates of field work	8/10/2021 – 22/10/2021		
	Previous/Future Work	Trench Evaluation / No		
	Project Type	Watching Brief		
	Site Status			
	Current Land Use	Garden		
	Monument Type/Period	None		
	Significant Finds/Period	None		
	Development Type			
	Reason for Investigation	Other		
	Position in the Planning Process	N/A		
Planning Ref.	R20/0733			
PROJECT LOCATION	Site Address/Postcode	Land at 23 Lutterworth Road, Pailton, Rugby, Warwickshire CV23 0QE		
	Study Area			
	Site Coordinates			
	Height OD	aOD		
PROJECT CREATORS	Organisation	University of Leicester Archaeological Services		
	Project Brief Originator			
	Project Design Originator	University of Leicester Archaeological Services		
	Project Manager	Matt Beamish		
	Project Director/Supervisor	Donald Clark		
Sponsor/Funding Body	Developer			
PROJECT ARCHIVE	Recipient	Physical	Digital	Paper
		N/A		
	ID (Acc. No.)		T/1894	T/1894
Contents	N/A	Digital Photographs PDF_A Report	Site record sheet, photograph index, unbound copy of report	
PROJECT BIBLIOGRAPHY	Type	Grey Literature		
	Title	An Archaeological Watching Brief for land at 23 Lutterworth Road, Pailton, Rugby, Warwickshire CV23 0QE		
	Author	D. Clark		
	Other bibliographic details	University of Leicester Archaeological Services Report No. 2022-024		
	Date	2022		
	Publisher/Place	University of Leicester Archaeological Services		
	Description	A4 pdf A		

CONTENTS

Summary.....	1
Introduction.....	1
Site Location, Geology and Topography.....	1
Historical and Archaeological Background.....	4
Aims and Objectives.....	5
Research Objectives.....	6
Methodology.....	7
Results.....	7
Attendance 8/10/2021.....	7
Attendance 12/10/2021.....	7
Attendance 15/10/2022.....	11
Attendance 22/10/2021.....	13
Discussion and Conclusions.....	15
Archive and Publication.....	15
Acknowledgements.....	15
References and Sources.....	16

FIGURES

Figure 1: Location of Pailton within Warwickshire, West Midlands.....	2
Figure 2: Location of site, provided by client.....	3
Figure 3: Construction layout, provided by client.....	4
Figure 4: Historic Environment Records for Pailton.....	6
Figure 5: Rubble from demolition of bungalow, looking north.....	8
Figure 6: Eastern area of site prepared for reduction, looking north-east.....	8
Figure 7: Reduction of ground level on eastern area of site, looking south-east.....	9
Figure 8: Boundary wall, looking north-east.....	9
Figure 9: East area of site following ground reduction, looking north.....	10
Figure 10: Boundary wall following clearance, looking north-east.....	10
Figure 11: Linear feature [1] looking west.....	11
Figure 12: Boundary wall following clearance, looking south-east.....	11
Figure 13: Western area once cleared of rubble and reduced, looking south-west.....	12
Figure 14: Western area, looking south.....	12
Figure 15: Linear feature [3] looking west.....	13
Figure 16: (Left) proposed development. (Right) position of features revealed during watching brief WB [3] and WB [5] and feature revealed during evaluation (Flavell 2021). Broken line denotes stripped area.....	14

An Archaeological Watching Brief for land at 23 Lutterworth Road, Pailton, Rugby, Warwickshire CV23 0QE (SP 4746 8189)

Donald Clark

Summary

This report details the results of an archaeological watching brief that was carried out by University of Leicester Archaeological Services (ULAS) at 23 Lutterworth Road, Pailton, Rugby, Warwickshire (SP 4746 8189). The work was carried out in October 2021 on behalf of MPJ Homes Ltd during the reduction of ground, prior to construction of small housing development.

Two possible features were identified, a short linear feature in the south-east of site and a curving linear in the north-west, a section was excavated in both, but no dating evidence was recovered

The site archive will be deposited with Warwickshire County Council Museums Service with the accession number T/1894.

Introduction

In accordance with National Planning Policy Framework (NPPF) Section 16 *Conserving and Enhancing the Historic Environment* (MHCLG 2019) this document forms the report for a programme of archaeological mitigation carried out by University of Leicester Archaeological Services (ULAS) on lands at 23 Lutterworth Road, Pailton, Rugby, Warwickshire (NGR: SP 4746 8189).

The work was carried out by University of Leicester Archaeological Services (ULAS) on behalf of MPJ Homes Ltd.

Planning Permission was granted by Rugby Borough Council for the demolition of existing dwelling, formation of a new site access and the erection of four dwellings, two detached garages and associated parking (Planning Ref. R20/0733).

The programme of archaeological works was for control and supervision of the approved groundworks, with contingency provision for additional excavation if necessary, to mitigate the likely archaeological impacts of the scheme.

Site Location, Geology and Topography

Pailton lies above a wide bend of the Smite Brook which flows broadly for a further 10km south-west to join the River Sowe at Binley. The site is at 115m aOD, the local topography of the site is sloping down to the course of the Smite Brook to the north and west at 100m aOD and up to Thwaite Farm to the south at 135m aOD. The M6 lies 1km to the south, and the A5 Watling Street some 5km to the north-east.

The British Geological Survey website lists the superficial geology as Wolston Sand And Gravel which was formed up to 3 million years ago in the Quaternary Period. Bedrock comprises sedimentary bedrocks of the Penarth and Mercia Mudstone Groups which both date from the Triassic period approximately 201 to 250 million years ago.

Soils comprise slightly acid loamy and clayey soils with impeded drainage (Soilscape 8) and freely draining slightly acid loamy soils (Soilscape

6) <http://www.landis.org.uk/soilscapes/> <http://www.landis.org.uk/soilscapes/> last accessed 3/6/2021



Figure 1: Location of Pailton within Warwickshire, West Midlands

Contains OS data © Crown copyright [and database right] 2021



Figure 2: Location of site, provided by client.

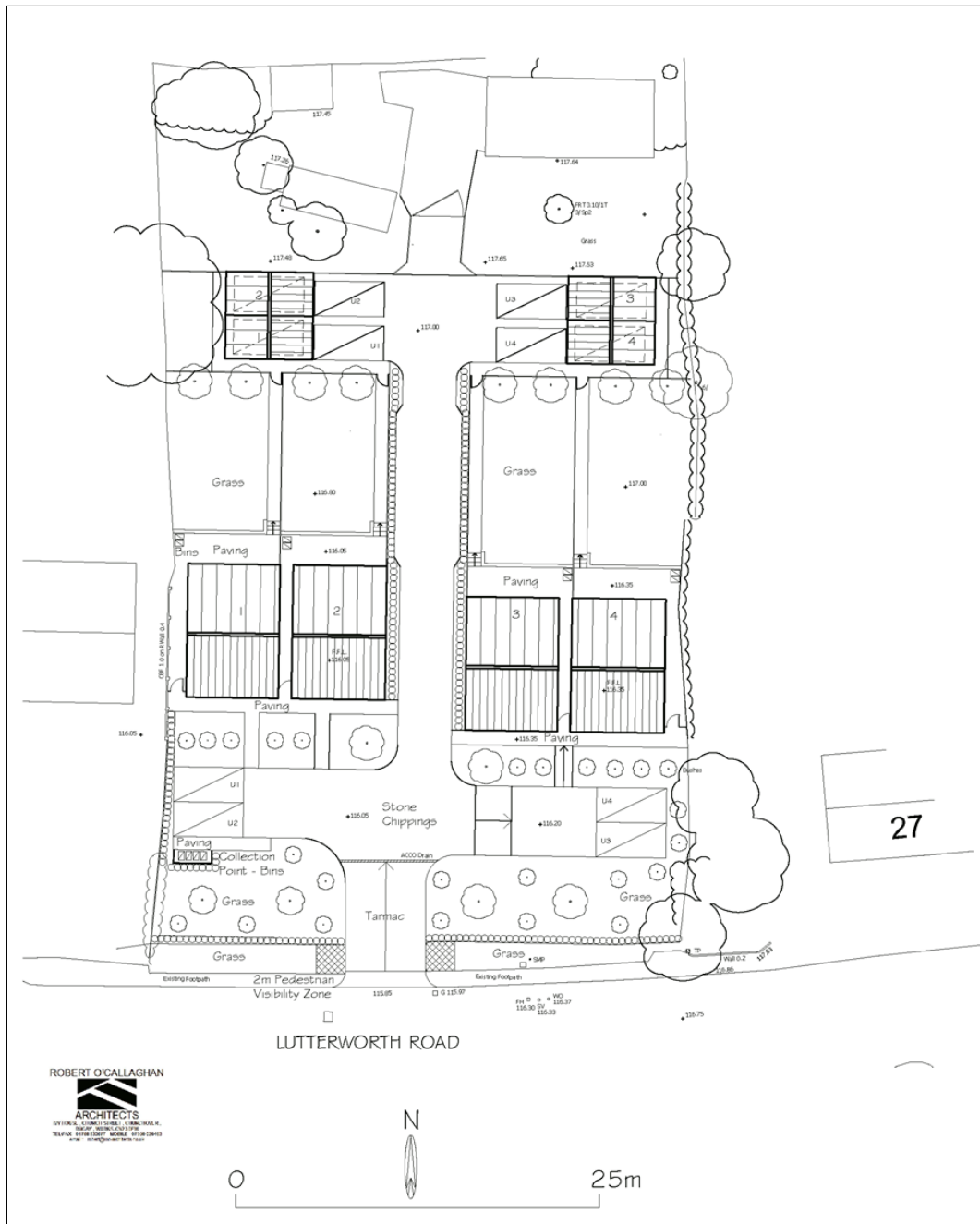

Figure 3: Construction layout, provided by client

Historical and Archaeological Background

The proposed development lies within an area of significant archaeological potential, within the probable extent of the medieval settlement at Pailton (Figure 4MWA9572). In addition, the 1880s Ordnance Survey mapping for this area indicates a number of structures to have been present within the proposed development boundary at that time including one which is marked as a smithy (MWA3555).

There are no Scheduled Monuments within 1km of the development area.

To the immediate south of the development area is the Lutterworth Road which was a Market Harborough to Coventry Turnpike in the 18th and 19th Centuries (MWA4788). To west of the site are a number of Grade II listed buildings: the Church of St Denys (LB1233570), 5 & 7 Coventry Road (LB1233572) and Pailton Hall (LB1233575). For a full list of Historic Environment Records within 1km of the development area see Flavell, 2021, Appendix 2, Tables 1 and 2.

The Record Office for Warwickshire holds a number of documents that may contain relevant information to the development area (Flavell, 2021, Appendix 2, Table 3).

As it was possible that significant buried remains could be affected by the proposed development the Planning Archaeologist recommended an archaeological trench evaluation be undertaken. This was completed in June 2021 and has been reported (Flavell 2021),

In the south of the plot near the frontage with the Lutterworth Road, possible evidence for demolition of structures forming part of the Smithy shown on late 19th Century mapping were recorded. A cobbled surface that may have been contemporary with the usage of the smithy was recorded. An infilled drain and a pit both of probable post medieval date were recorded. In further trenches in the centre and north of the development area, features of probable medieval date were recorded that may be plot boundaries.

Aims and Objectives

The main objectives of the archaeological work were:

- Identify the presence/absence of archaeological features and deposits.
- Record all archaeological features and deposits encountered.
- Sample sufficient of the archaeological features and deposits to establish relative sequence, likely dating and quality of preservation.
- Gather sufficient information to establish the character, extent, form, function and likely status of any surviving archaeological deposits with a view to evaluating their significance and potential to inform the aims and objectives outlined in the WSI.
- To record any archaeological deposits and produce an archive and report of any results.

Within the stated project aims, the principal objective of the recording is to establish the nature, extent, date, depth and significance of the heritage assets within their local and regional context.

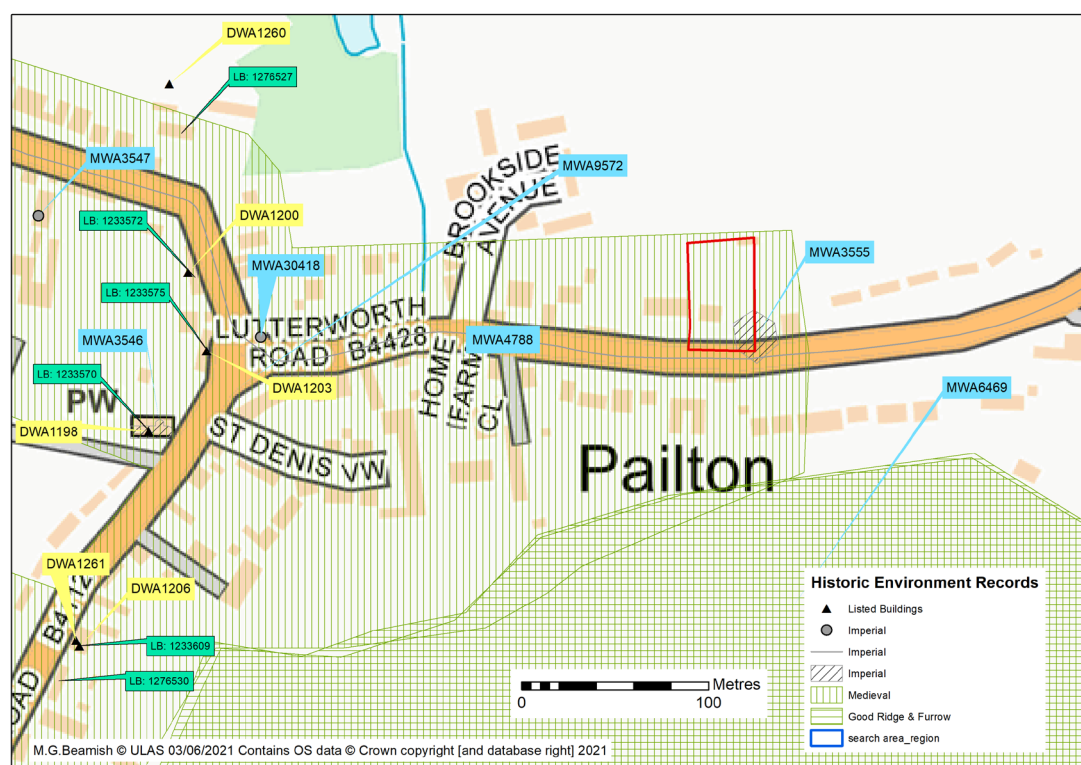

Figure 4: Historic Environment Records for Pailton

Research Objectives

Excavations may contribute to knowledge on rural settlement, landscape and society. Information on the sequence and chronology of boundaries and their relationship to settlements may be recovered and palaeoenvironmental evidence could provide information on agricultural practices and land use. Artefacts can provide evidence for evidence for craft industry and exchange across broad landscape areas.

The presence of a post-medieval Smithy in the proposed area provided an immediate potential for features of this date. It is therefore possible to determine some initial objectives derived from *The Archaeology of the West Midlands: A Framework for Research* (2011), and also the *East Midlands Historic Environment Research Framework* <https://researchframeworks.org/emherf> last accessed 3/6/2021. Medieval smithies have been recorded in Warwickshire at Cawston and Burton Dassett, 8km and 30km to the south of development area respectively (Palmer 2003 and Watts 2011).

Industrial

EM9.2.1: Can we establish a typology of modern buildings, particularly of the twentieth century, and how does this vary regionally?

EM9.7.1: What craft industries existed prior to 1850 and can we identify the remains of associated buildings and other structures?

These research aims have been identified based on the current state of knowledge within the area of the scheme. The research aims will be re-assessed and updated during the course of the fieldwork.

Methodology

All work followed the procedures set out in the approved *Written Scheme of Investigation* (WSI) for the project (Beamish 2021).

All work was carried out in accordance with the Chartered Institute for Archaeologists (CIfA) Standard and Guidance for Archaeological Watching Briefs (2014b, updated 2020) and adhered to their Code of Conduct (2014a revised 2019).

Results

Fieldwork was carried out by ULAS in October 2021.

Date	Site Staff	Description
8/10/2021	DC	Half day attendance to observe ground reduction
12/10/2021	DC	Half day attendance to observe ground reduction
15/10/2021	DC	Half day attendance to observe ground reduction
22/10/2021	DC	Half day attendance to observe ground reduction

Attendance 8/10/2021

On arrival, at 8.15am, a large pile of rubble was situated on the west of the site, where the bungalow had once stood.

The east area of the site had been cleared of overgrowth and was prepared for the reduction.

The 360 excavator, fitted with flat bladed ditching bucket, reduced the ground level in spits under constant observation. The natural ground was observed as a pink clay which changed to pink brown sand towards the north of the site (Figure 7).

The boundary wall located in south-east of site was overgrown and barely visible (Figure 8).

The machine was used in the afternoon to load the rubble on to a succession of lorries and the observation ceased around midday.

Attendance 12/10/2021

On arrival, at 8.30am, the pile of rubble on the west of the site had been reduced, but the area was still not ready for ground reduction.

The reduction of the east area continued and a possible linear feature, WB [1], was investigated (Figure 11). The feature was approx. 3m long, 0.65m wide and 0.34m deep. The feature had vertical sides and a flat base and a section was excavated at the eastern terminus of the feature. The fill (2) consisted of a mid grey brown silty clay with rare rounded pebbles. No dating evidence was recovered.

The boundary wall located in south-east of site had been cleared to allow for photographic recording (Figure 10).

The machine was used in the afternoon to load the remaining rubble on to a succession of lorries and the observation ceased around midday.



Figure 5: Rubble from demolition of bungalow, looking north



Figure 6: Eastern area of site prepared for reduction, looking north-east



Figure 7: Reduction of ground level on eastern area of site, looking south-east

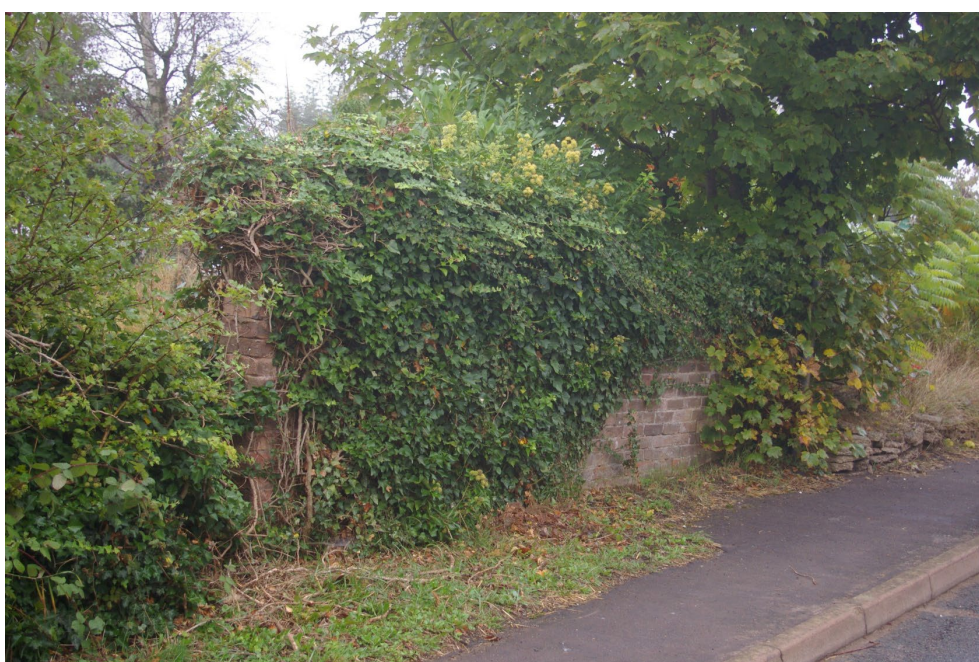

Figure 8: Boundary wall, looking north-east



Figure 9: East area of site following ground reduction, looking north



Figure 10: Boundary wall following clearance, looking north-east



Figure 11: Linear feature [1] looking west



Figure 12: Boundary wall following clearance, looking south-east

Attendance 15/10/2022

On arrival, at 8.30am, the pile of rubble on the west of the site had been cleared and the area prepared for ground reduction.

The reduction of the west area was observed and a possible curving linear feature, WB [3], was investigated (Figure 15). The feature was approx. 3.70m long, 0.72m wide and 0.24m deep. The feature had irregular sides and a section was excavated at the

eastern terminus of the feature. The fill (4) consisted of a mid pink brown sandy clay with rare rounded pebbles. The feature may not be archaeological and no dating evidence was recovered.

The 360 excavator, fitted with flat bladed ditching bucket, reduced the ground level in spits under constant observation. The natural ground was observed as pink brown clay. In some areas the construction level was reached without observing natural ground.

This concluded the reduction of ground level in the west of the area and observation ceased around midday.



Figure 13: Western area once cleared of rubble and reduced, looking south-west



Figure 14: Western area, looking south

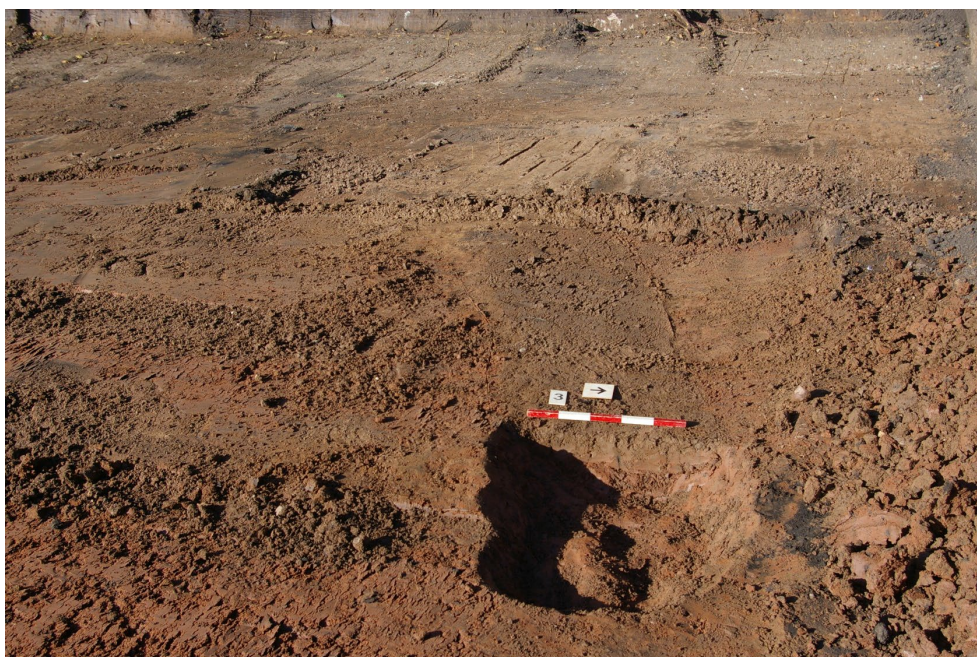

Figure 15: Linear feature [3] looking west

Attendance 22/10/2021

On arrival, at 8.30am, the possible features [1] and [3] were added to survey. An access area from the road was stripped but no further archaeological features were observed. This ended the watching brief.



Figure 16: (Left) proposed development. (Right) position of features revealed during watching brief WB [3] and WB [5] and feature revealed during evaluation (Flavell 2021). Broken line denotes stripped area.

Discussion and Conclusions

ULAS carried out a watching brief for land at 23 Lutterworth Road, Pailton, Rugby, Warwickshire between the 8th and 22nd October 2021. Archaeological attendance was carried out on four separate occasions with clear access available at all times. During the attendance one feature (Evaluation [3] and [5], Fig.16) was observed, this had previously been recorded during evaluation (Flavell 2021). Two additional features, WB [1] and WB [3] (Fig.16), were investigated and added to the surveyed plan of the site. No dating evidence was recovered from the fill of these features, but they were most likely the remains of medieval or post-medieval property boundaries.

The watching brief was undertaken in good conditions, and the archaeology recorded reflects the general low level of survival of deposits in this area.

Archive and Publication

The site archive will be housed with Warwickshire Museums Service with accession number T/1894 and consists of the following:

Site records – watching brief sheet, photo index.

Site photographs – digital, on CD and contact prints.

Unbound Report hard copy and electronic copy (pdf_A).

The University of Leicester Archaeological Services supports the Online Access to the Index of Archaeological Investigations (OASIS) project. The online OASIS data entry has been completed detailing the results of the project and will be digitally accessible through The Archaeological Data Services (<http://archaeologydataservice.ac.uk/>).

Acknowledgements

The author undertook the archaeological watching brief for MPJ Homes Ltd, who managed the groundworks. The project was managed by Matt Beamish who would like to Mike Edwards for commissioning the work.

Donald Clark

ulas@le.ac.uk

Context Number	Description
Cut WB [1]	A short linear feature with steep sides and a flat base
Fill (2)	Fill of WB [1], a mid grey brown silty clay with rare rounded pebbles
Cut WB [3]	A possible curving linear feature with irregular sides and base
Fill (4)	Fill of WB [3], a mid pink brown sandy clay with rare rounded pebbles

References and Sources

- Beamish, M., 2021. Written Scheme of Investigation for an Archaeological Watching Brief at 23 Lutterworth Road, Pailton, Warwickshire. ULAS
- BGS British Geological Survey 2020
- CifA (Chartered Institute for Archaeologists), rev. 2019, *Code of Conduct*.
- CifA (Chartered Institute for Archaeologists), rev. 2020, *Standard and Guidance for Archaeological Watching Briefs*.
- CifA (Chartered Institute for Archaeologists) rev. 2020, *Standard and Guidance for the creation, compilation, transfer and deposition of archaeological archives*.
- Flavell, N., 2021. An Archaeological Evaluation at 23 Lutterworth Road, Pailton, Warwickshire. ULAS Report 2021-098
- LMARS, 2014, *The Transfer of Archaeological Archives to Leicestershire Museums, Arts and Records Service*.
- MHCLG, (Ministry of Housing, Communities and Local Government), 2019, *National Planning Policy Framework*.
- Palmer, N. 2003. Warwickshire (and Solihull) the Medieval Period, West Midlands Regional Research Framework (Seminar 5)
- Watt, S. 2011 *The Archaeology of the West Midlands: A Framework for Research*. Oxbow Books



UNIVERSITY OF
LEICESTER

Archaeological Services

University of Leicester
University Road
Leicester LE1 7RH
UK

t: +44 (0)116 252 2848

f: +44 (0)116 252 2614

e: ulas@le.ac.uk

