

**An Archaeological Watching Brief
on land at the rear of
2, Fleckney Road,
Kibworth Beauchamp,
Leicestershire.
(SP 679 936)**

Leon Hunt

For: Alpha Properties Ltd

Checked by Project Manager

Signed:Date:

Name:

University of Leicester

Archaeological Services

University Rd., Leicester, LE1 7RH

Tel: (0116) 2522848 Fax: (0116) 2522614

ULAS Report No. 2005-043 ©2005

CONTENTS

Summary	1
Introduction.....	1
Site Location and Geology.....	1
Aims and Methods	2
Results.....	2
Conclusion	3
Archive.....	3
Acknowledgements.....	3

ILLUSTRATIONS

Figure 1: Site Location

Figure 2: Site plan

An Archaeological Watching Brief on land to the rear of 2, Fleckney Road, Kibworth Beauchamp, Leicestershire. (SP 679 936).

Leon Hunt

Summary

An archaeological watching brief was undertaken by University of Leicester Archaeological Services (ULAS) at land to the rear of 2, Fleckney Road, Kibworth Beauchamp, Leicestershire (SP 679 936). The site lies within the medieval core of the village and therefore in an area of medieval settlement. The watching brief revealed no archaeological features or finds associated with archaeological features. The archive will be deposited with Leicestershire County Council Heritage Services with accession number X.A222.2004.

Introduction

University of Leicester Archaeological Services (ULAS) was commissioned by Alpha Properties Ltd to carry out a watching brief during the excavation of foundation trenches on land to the rear of 2, Fleckney Road, Kibworth Beauchamp, Leicestershire (SP 679 936). Archaeological work was required as a condition of the planning permission granted by Leicestershire County Council (planning application No. 02/1152/3).

The site lies within the medieval core of the village and therefore in an area of medieval settlement.

The planned development of 7 new dwellings with associated access and parking on the site was seen to have the potential to have a damaging impact on any archaeological remains if present.

A Brief from the Senior Planning Archaeologist (appendix 1: Brief for Archaeological Watching Brief) detailed the need for a watching brief during the ground-works. A Design Specification for a watching brief was prepared by ULAS (appendix 2).

Site Location and Geology

The development site is located in the village of Kibworth Beauchamp, just south of the High Street, within the village centre in Harborough District. The site is situated at NGR SP 679 936 (figure 1). It consists of an area of about 5970 square metres.

The Ordnance Survey Geological Survey of Great Britain (Solid and Drift) Sheet 170 indicates that the underlying geology is likely to consist of Lower Lias clays under boulder clay. The land is level at a height of *c. 118m. OD.*

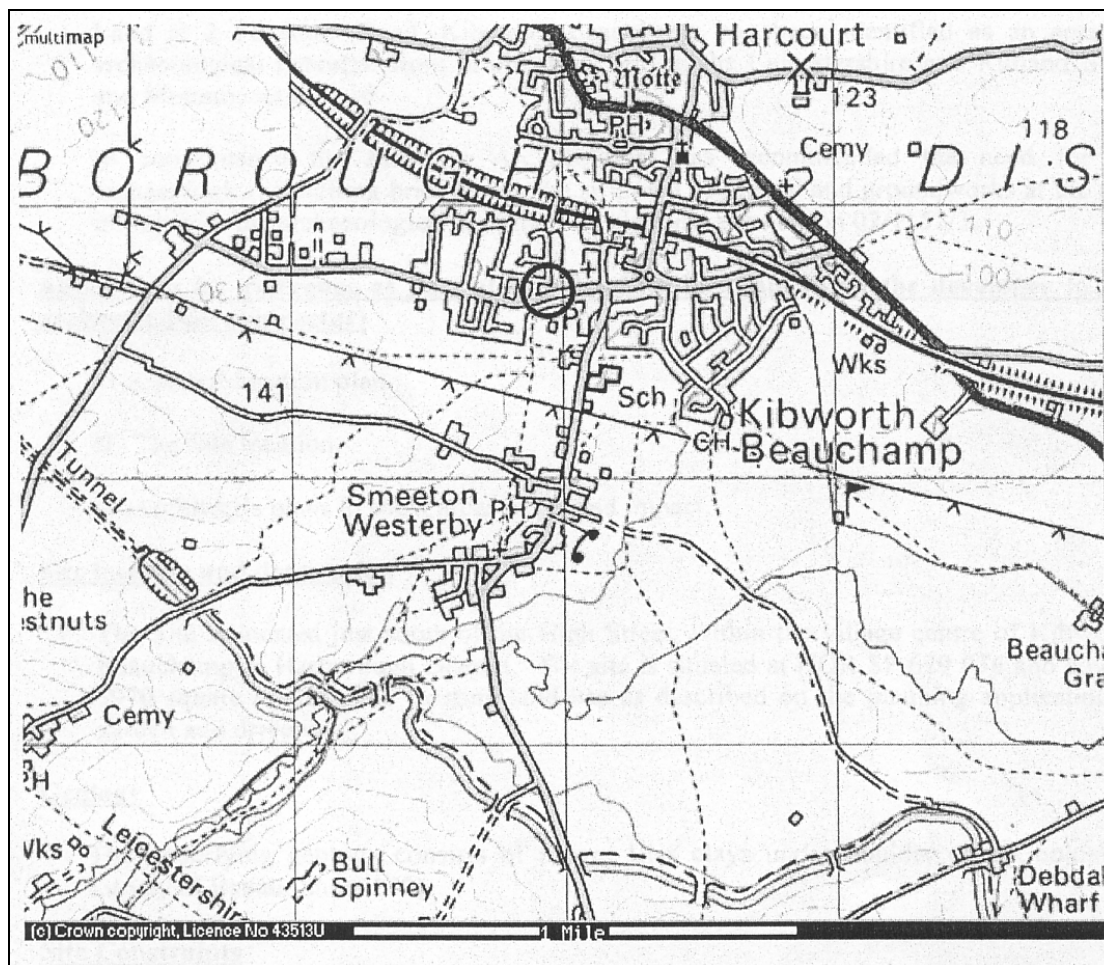

Figure 1: Location map. Licence No. AL100021186

Aims and Methods

The purpose of the watching brief was to ascertain whether archaeological deposits were present. If so, the character, extent and date range of any deposits identified would be established, in order to assess their significance (see Appendices, Design Specification). Recording of these deposits would be carried out as appropriate, and an archive and this report produced. The work followed the Institute of Field Archaeologists (IFA) *Standard and Guidance for Archaeological Watching Briefs*, and adhered to the University's Health and Safety policy.

An archaeologist visited the site on the 19th January, 2nd and 3rd February, 10th June, 27th July, 16th August 2004 and groundworks associated with the development were observed (Fig.2). The spoil heaps were also examined for archaeological finds.

Results

The site was visited on 6 occasions (see above) and the foundations of Plots 1-5 were observed. Throughout these areas the trenches were excavated to a width of 0.6m with

a toothed bucket to a depth of between 1m and 1.7m depending on ground conditions and proximity to existing trees. The average depth was around 1.2m.

The topsoil consisted of c.0.3m of dark brown loam, with few stones. The subsoil was between 0.2-0.5m deep and was an orangey brown silty clay, which overlay the natural yellowish brown clay. Roots heavily disturbed the trenches, where they approached the trees (plot 5).

As no archaeological features were discovered during the excavations of units 1-5 the decision was made not to watch the last two foundation trenches being excavated.

Conclusion

No archaeological features were discovered during this watching brief.

Archive

The archive will be deposited with Leicestershire County Council Heritage Services with accession number X.A222.2004 and consists of the following:

Watching brief record sheets, including sketch plans and section.

1 set of colour slides

1 set of B&W contact prints

1 set of B&W negatives

Acknowledgements

ULAS would like to thank Alpha Properties for their co-operation. James Harvey, Gavin Speed, Andy Hyam and Leon Hunt carried out the watching brief; Richard Buckley was the Project Manager.

Leon Hunt

lh90@le.ac.uk.

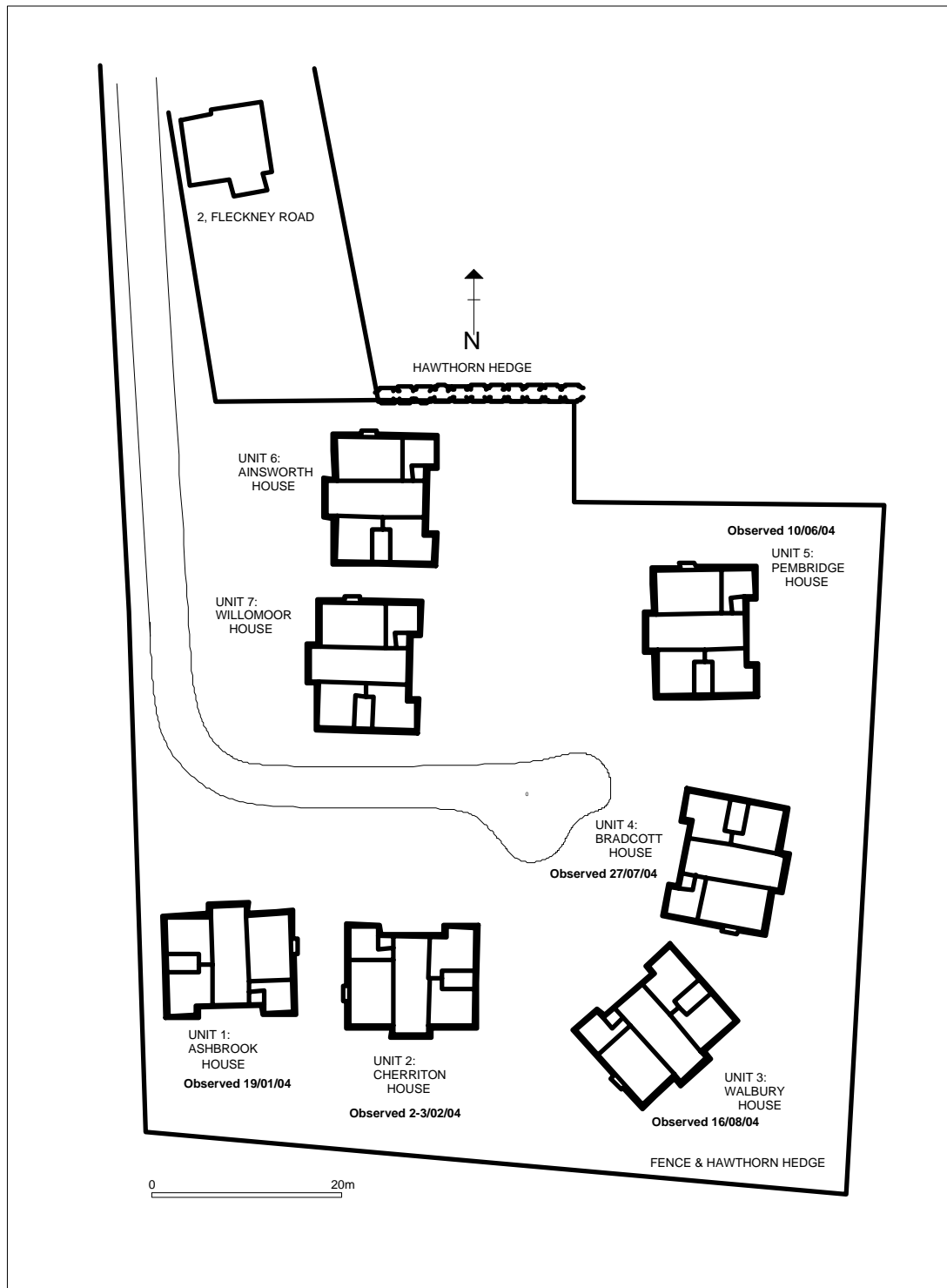

Figure 2: Plan of site showing plots observed during watching brief

APPENDIX 1: BRIEF FOR ARCHAEOLOGICAL WATCHING BRIEF

APPENDIX 2: DESIGN SPECIFICATION FOR ARCHAEOLOGICAL WORK