



**University of  
Leicester**

---

**Archaeological Services**

**An Archaeological Evaluation  
At 32 Desford Road,  
Narborough,  
Leicestershire  
(SP 532 989)**

**Gerwyn Richards**

ULAS Report No 2011-019  
©2011

**An Archaeological Evaluation at  
32 Desford Road, Narborough  
Leicestershire.**

**(NGR SP 532 989)**

**Gerwyn Richards**

Planning Application No: 10/00252/FUL

**For:** James English

Checked by

**Date:** 8<sup>th</sup> February 2011

**Name:** Dr. Roger Kipling

**University of Leicester**

Archaeological Services

University Rd., Leicester, LE1 7RH

Tel: (0116) 2522848 Fax: (0116) 2522614

**ULAS Report Number 2011-019**

**©2011**

**X.A11.2011**

**An Archaeological Evaluation at 32 Desford Road, Narborough, Leicestershire  
(NGR SP 532 989).**

**Contents**

Summary	1
1. Introduction	1
2. Background	1
3. Aims and Methodology	3
4. Results of Trial Trench Evaluation	4
5. Conclusion	4
6. Archive & Publication	4
7. References	4

**Figures**

Figure 1	Site location.	2
Figure 2	Proposed development area in detail.	3
Figure 3	Trench, looking north west.	5
Figure 4	Trench location plan.	6

**An Archaeological Evaluation at 32 Desford Road, Narborough, Leicestershire  
(NGR SP 532 989).**

**Gerwyn Richards**

**Summary**

*University of Leicester Archaeological Services were commissioned by James English to undertake an archaeological evaluation at 32 Desford Road, Narborough, Leicestershire, in advance of the construction of a new residential unit. The proposed development area had been identified as being an area of archaeological potential.*

*A single evaluation trench was machine excavated and recorded within the proposed footprint of the new building. Nothing of archaeological significance was revealed.*

*The archive for the archaeological work will be held by Leicestershire County Council, under the Museums Accession Number X.A11.2011.*

**1. Introduction**

University of Leicester Archaeological Services were commissioned by James English to undertake an archaeological evaluation in advance of the proposed development works at 32 Desford Road, Narborough, Leicestershire (SP 532 989; Fig. 1). The proposed development involves the construction of a single new residential unit within the existing garden, an area of approximately 0.04 hectares. No previous intrusive archaeological work has been carried out within the proposed development area.

**2. Background**

Archaeological evaluation of the site was requested by Leicestershire County Council Historic and Natural Environment Team on behalf of Hinckley and Bosworth District Council via trial trenching.

The Ordnance Survey Geological Survey of Great Britain, Sheet 155 indicates that the underlying geology is likely to consist of Mercia Mudstone Group.

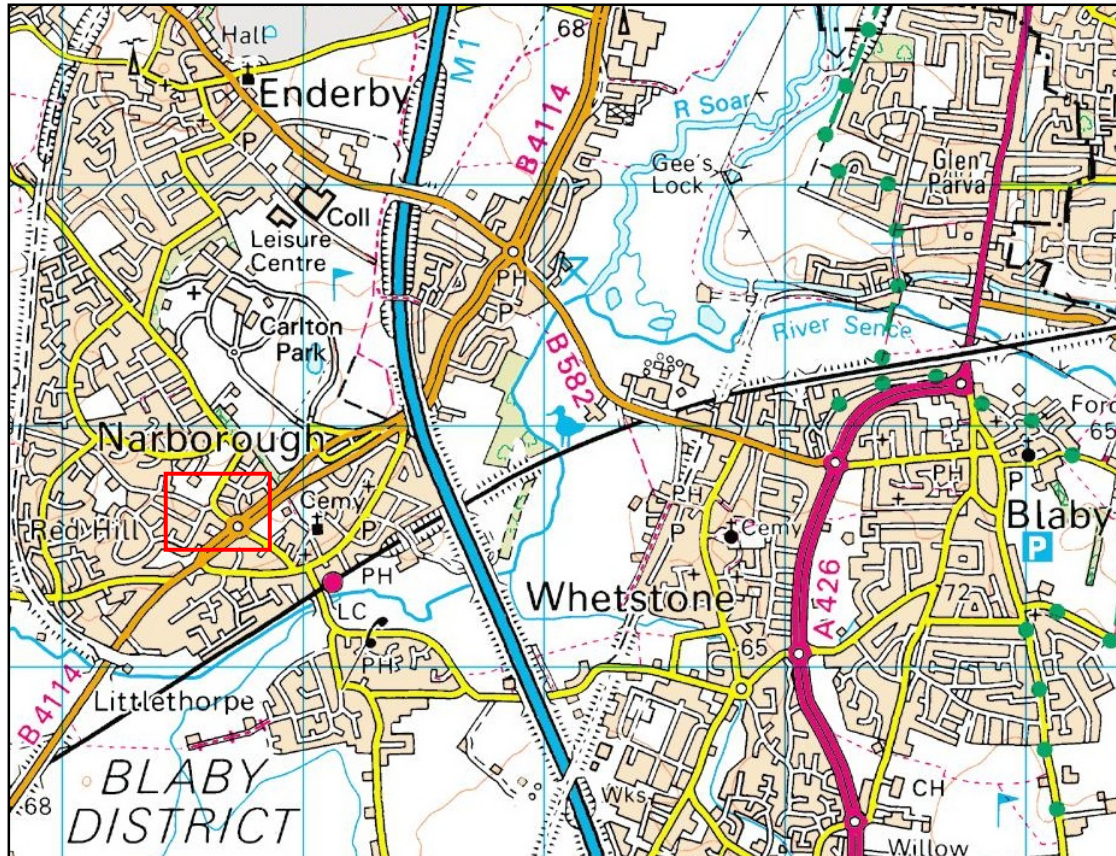

Figure 1: Site location Scale 1:50000

By permission of Ordnance Survey on behalf of The Controller of Her Majesty's Stationery Office. © Crown Copyright 1996. All rights reserved. Licence number AL 100029495.

The proposed development area lies to the north west of the historic settlement core of Narborough. The Historic Environment Record for Leicestershire & Rutland (HER) indicates a number of known archaeological sites within the vicinity of the proposed development area, including the line of the Roman road, the Fosse Way (HER Ref MLE 607) which forms the north western boundary of the proposed development area, now Langham Drive.

Two Neolithic flint axes are known to have been recovered from the vicinity of the excavation, the first found on the site of the Carlton Hayes Hospital (HER Ref MLE7132), the second on the site of Red Hill School (HER Ref MLE7133). Prehistoric worked flint was found at the Mill Lane Allotments (HER Ref MLE7379). A late Iron Age/Roman settlement site has been identified at Johnstone Spinney (HER Ref MLE99), north west of the proposed development area.

A Roman Villa was recorded by watching brief during the construction of Red Hill School in 1983 (HER Ref MLE247).

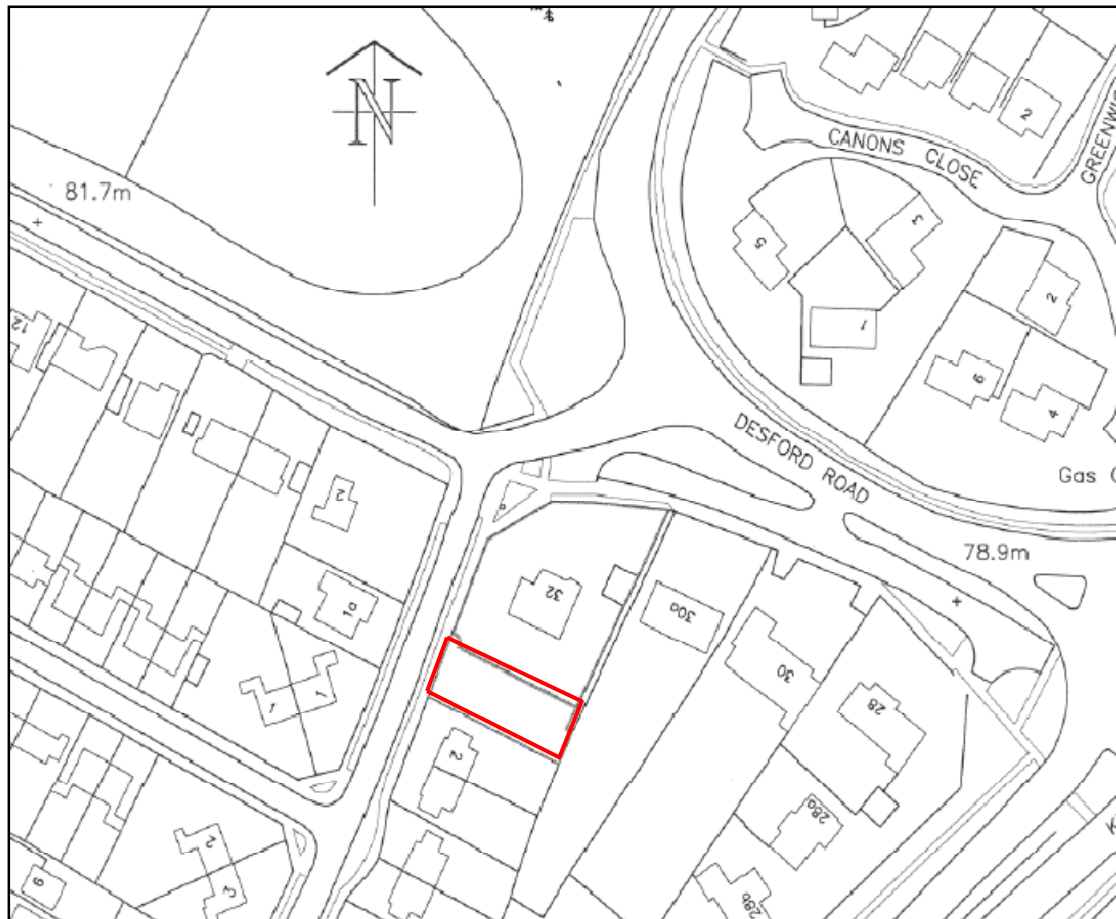

**Figure 2:**  
Proposed development area in detail.

### 3. Aims and Methodology

The main objectives of the evaluation, to be achieved via archaeological trial trenching, were as follows:

- To identify the presence/absence of any archaeological deposits in areas to be affected by the development.
- To provide information on the extent, character, condition and date range of archaeological deposits within the application area.
- To assess the potential impact of the proposed development on any archaeological remains.
- To produce an archive and report of any results.

In consultation with Planning Control Archaeologist it was decided to evaluate the impact of proposed development with the excavation of a single 10m x 1.6m trench (Fig. 3) within the proposed footprint of the new building. The evaluation took place on February 2nd 2011. The trench was excavated by a 0.25 tonne mini digger using a ditching bucket.

The archaeological work addressed the requirements detailed in the letter of advice (LCCHNET) and *Written Scheme of Investigation for archaeological work: 32 Desford Road, Narborough, Leicestershire NGR SP 532 989*. (ULAS 11-588).

#### **4. Results of Trial Trench Evaluation**

The trench was aligned north, north-west to south, south-east approximately 5m east of the Langham Drive frontage on a lawned area (*Figure 4*), the trench was located in order to sample the area of greatest disturbance whilst avoiding the extensive nearby trees. The trench was 10m long and 1.6m wide.

Approximately 0.12m to 0.2m of garden soil was excavated revealing a shallow layer of silty clay subsoil. Beneath the subsoil a horizon of weathered Mercia Mudstone was exposed. Excavation ceased at this level, approximately 0.25m to 0.3m below the existing ground level.

No remains of archaeological significance were found within the trench and it was recorded and released for backfilling.

#### **5. Conclusion**

The proposed development area occupied a promising location within a rich archaeological landscape and bordered the line of the Roman Road, the Fosse Way, but no evidence of archaeological deposits or artefacts were encountered during the course of this evaluation. Despite its proximity to the Roman road, no Roman occupation was encountered. This may be explained by the distance of the proposed development area from the city, and the medieval settlement of Narborough is known to have evolved further to the south and east. The proposed development area therefore remained largely undeveloped and unoccupied until the 20th century.

#### **6. Archive & Publication**

The site archive consists of:

- 1 A3 paper trench location plan
- CD containing 4 digital images
- 1 A4 contact sheet
- 2 Black & White negatives and contact prints
- 1 A4 trench recording sheet
- Unbound copy of this report (ULAS Report Number 2011-019)

The archive will be held at Leicester County Council Museums under the Accession Number X.A11.2011.

A version of the summary (above) will be submitted to the editor of the local journal *Transactions of Leicestershire Archaeological and Historical Society* for inclusion in the next edition.

## 7. References

IfA, 2008 *Code of Conduct*

IfA, 2008 *Standard and Guidance for Archaeological Field Evaluation*

ULAS 2011 *Written Scheme of Investigation for archaeological work: 32 Desford Road, Narborough, Leicestershire NGR SP 532 989.*



**Figure 3** Trench, looking north west.



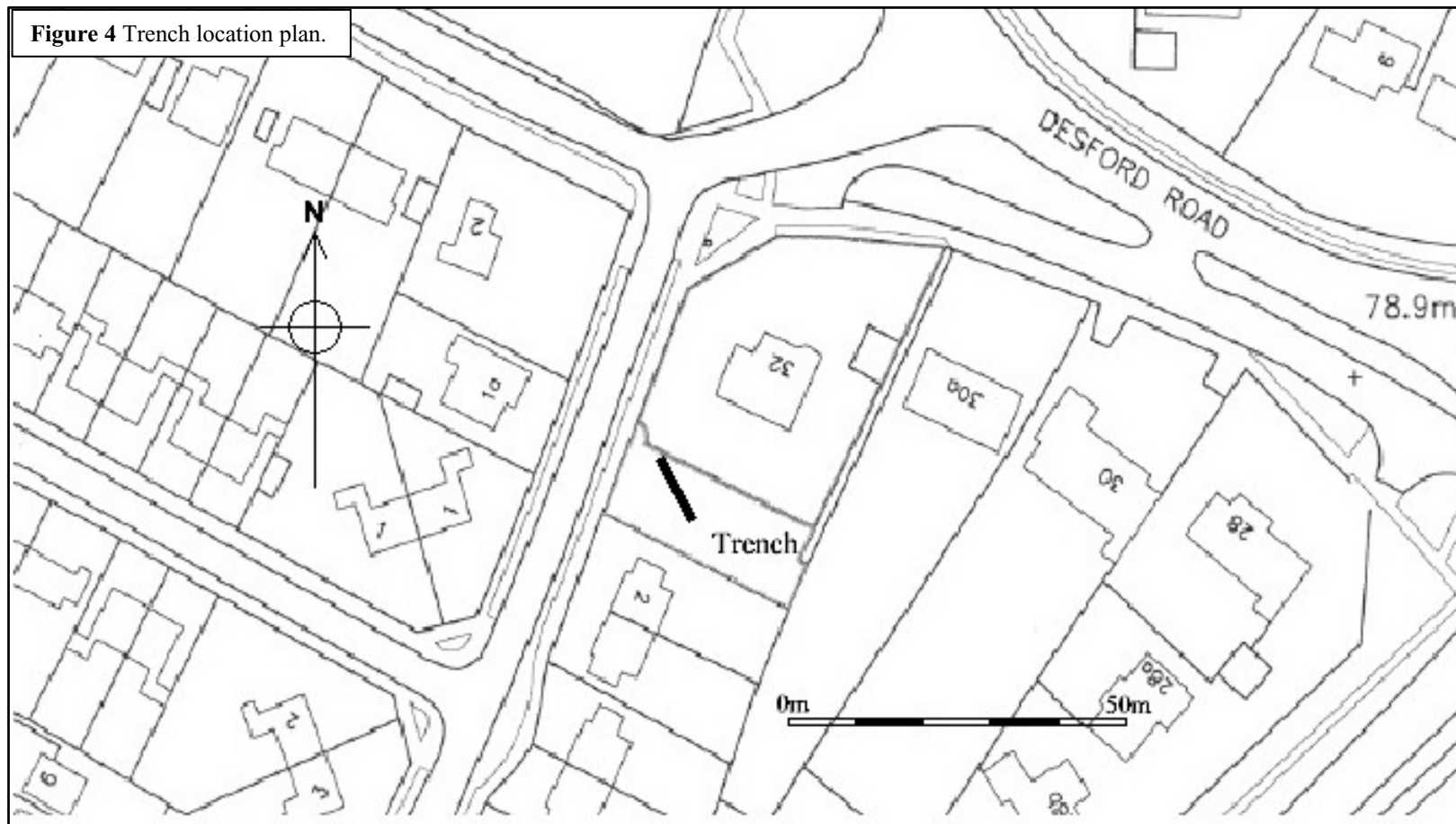

## Contact Details

Richard Buckley or Patrick Clay  
University of Leicester Archaeological  
Services (ULAS)  
University of Leicester,  
University Road,  
Leicester LE1 7RH

**T:** +44 (0)116 252 2848

**F:** +44 (0)116 252 2614

**E:** [ulas@le.ac.uk](mailto:ulas@le.ac.uk)

**w:** [www.le.ac.uk/ulas](http://www.le.ac.uk/ulas)

