

Project Code: LMLY09  
Planning Application Ref No: 07/01107/FUL  
Date of report: May 2010  
Client: BHC Ltd



# LUFFNESS MAINS, EAST LOTHIAN

## Archaeological Evaluation

Jamie Humble  
*MA(Hons)*

## PROJECT SUMMARY SHEET

<i>Client</i>	BHC LTD
<i>National Grid Reference</i>	NT 4823 7983
<i>Address</i>	LUFFNESS MAINS, ABERLADY, EAST LoTHIAN
<i>Parish</i>	ABERLADY
<i>Council</i>	EAST LoTHIAN
<i>Planning Application Ref No</i>	07/01107/FUL
<i>NMRS No</i>	N/A
<i>Oasis No</i>	HEADLAND1-73453
<i>SMR No</i>	N/A
<i>HB/SAM No</i>	N/A
<i>Listing Category</i>	N/A
<i>Project Manager</i>	SIMON STRONACH
<i>Text</i>	JAMIE HUMBLE
<i>Illustrations</i>	JOHN McCARTHY
<i>Typesetting</i>	ANNA SZTROMWASSER
<i>Fieldwork</i>	JAMIE HUMBLE JOHN McCARTHY
<i>Specialists</i>	N/A
<i>Schedule</i>	
<i>Fieldwork</i>	1 <sup>ST</sup> MARCH 2010
<i>Report</i>	MARCH 2010

*Signed off by:* .....

*Simon Stronach BSc(Hons) MIFA, Project Manager*

*Date:*.....

## CONTENTS

1.	INTRODUCTION	1
2.	ARCHAEOLOGICAL BACKGROUND	1
3.	METHODOLOGY	1
4.	RESULTS	3
5.	CONCLUSION	3
6.	REFERENCES	3
APPENDICES		4
	Appendix 1 – Site registers	4
	Appendix 2 – Discovery and Excavation Scotland Entry	6



Reproduced using 2002 OS 1:50000 Landranger Series no 66.  
 Ordnance Survey © Crown copyright 2010 All rights reserved. Licence no AL 100013329

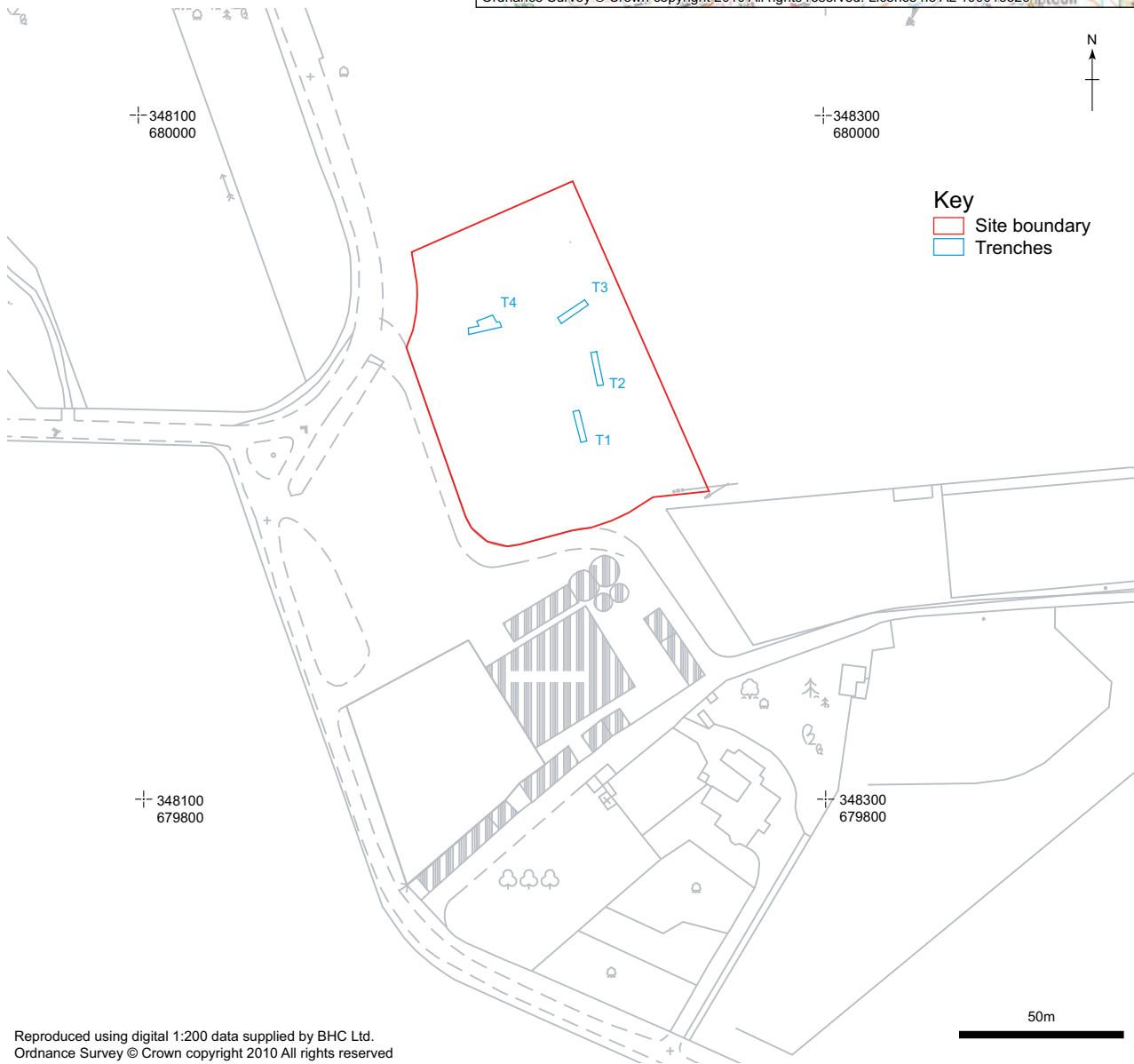

Reproduced using digital 1:2000 data supplied by BHC Ltd.  
 Ordnance Survey © Crown copyright 2010 All rights reserved

**Illus 1**  
 Location of site

# LUFFNESS MAINS, EAST LOTHIAN

## Archaeological Evaluation

by Jamie Humble

*Headland Archaeology Ltd was commissioned by BHC Ltd to undertake a program of archaeological evaluation at Luffness Mains, East Lothian in advance of construction of a new agricultural storage building.*

*The site was deemed to be of archaeological potential as there are numerous cropmark sites relating to prehistoric settlement to the east. Cropmarks of rig and furrow are also preserved in the surrounding area.*

*A total of 4 trenches were excavated across the site. The evaluation revealed a number of features relating to relatively recent agricultural use of the site. These comprised two furrows with three associated drainage ditches sharing the same orientation as two ceramic field drains.*

*No archaeological features or deposits of archaeological significance were identified and it is concluded that prehistoric settlement did not extend into this area.*

### 1. INTRODUCTION

This report presents the findings of a programme of archaeological evaluation conducted at Luffness Mains Farm, East Lothian in connection with a planning condition placed in response to a planning application (07/01107/FUL) by East Lothian Council. The evaluation was intended to provide further information concerning the archaeological potential of the area in question.

The objectives of the evaluation were twofold: firstly to establish if deposits or features of archaeological interest were present on the site and to establish the nature and condition of any such remains. Secondly to provide enough information on any remains to recommend further mitigation measures (excavation) and establish their likely scope.

Headland Archaeology Ltd were commissioned to undertake the work by BHC Ltd and undertook the trenching on the 1st March 2010.

### 2. ARCHAEOLOGICAL

#### BACKGROUND

While no excavation has been carried out in the vicinity of Luffness Mains a great deal of information about the past land use of the area has been revealed through aerial photography.

There are a number of cropmark sites that provide evidence of prehistoric settlement immediately to the east of the evaluation area in the form of enclosed and unenclosed settlement (NT47NE 72) and a ring ditch (NT47NE 25). The land appears to have been divided in

the prehistoric period with enclosures (NT47NE 25, 43) and a pit alignment (NT48SE 55).

There is also a record of prehistoric burials at Luffness House with 3 cists being reportedly found below the entrance hall (NT48SE 1.1) and a further cist found 300 yards to the east of the house (NT48SE 4). A food vessel (NT48SE 17) was discovered in 1882 in Luffness, although the circumstances of the discovery are not known.

Luffness House (NT48SE 1.0) is a 16th century tower house that may incorporate elements of an earlier castle of probable 13th century date. Earlier remains (NT48SE 1.2), which consist of a square fortification defined by a partially infilled ditch, may not relate to this 13th century castle and may have been raised by the French in 1549 to block English supplies to their garrison at Haddington.

Traces of rig and furrow cultivation also appear on aerial photography of Luffness Mains (NT47NE 25).

### 3. METHODOLOGY

The archaeological trial trenches were machine-excavated and covered a sample equivalent to 5% of the area that was to be subsequently stripped of topsoil for construction of a building. The area to be stripped of topsoil covered some 1500m<sup>2</sup> (30 x 50m) within the site boundary (Ilus 1), and a 5% sample comprised some 75m<sup>2</sup>, equivalent to 38m of linear trench using a 2m wide bucket. Trenches were positioned to provide coverage across the proposed building footprint and were informed by on-site factors, primarily two underground services running across the site.

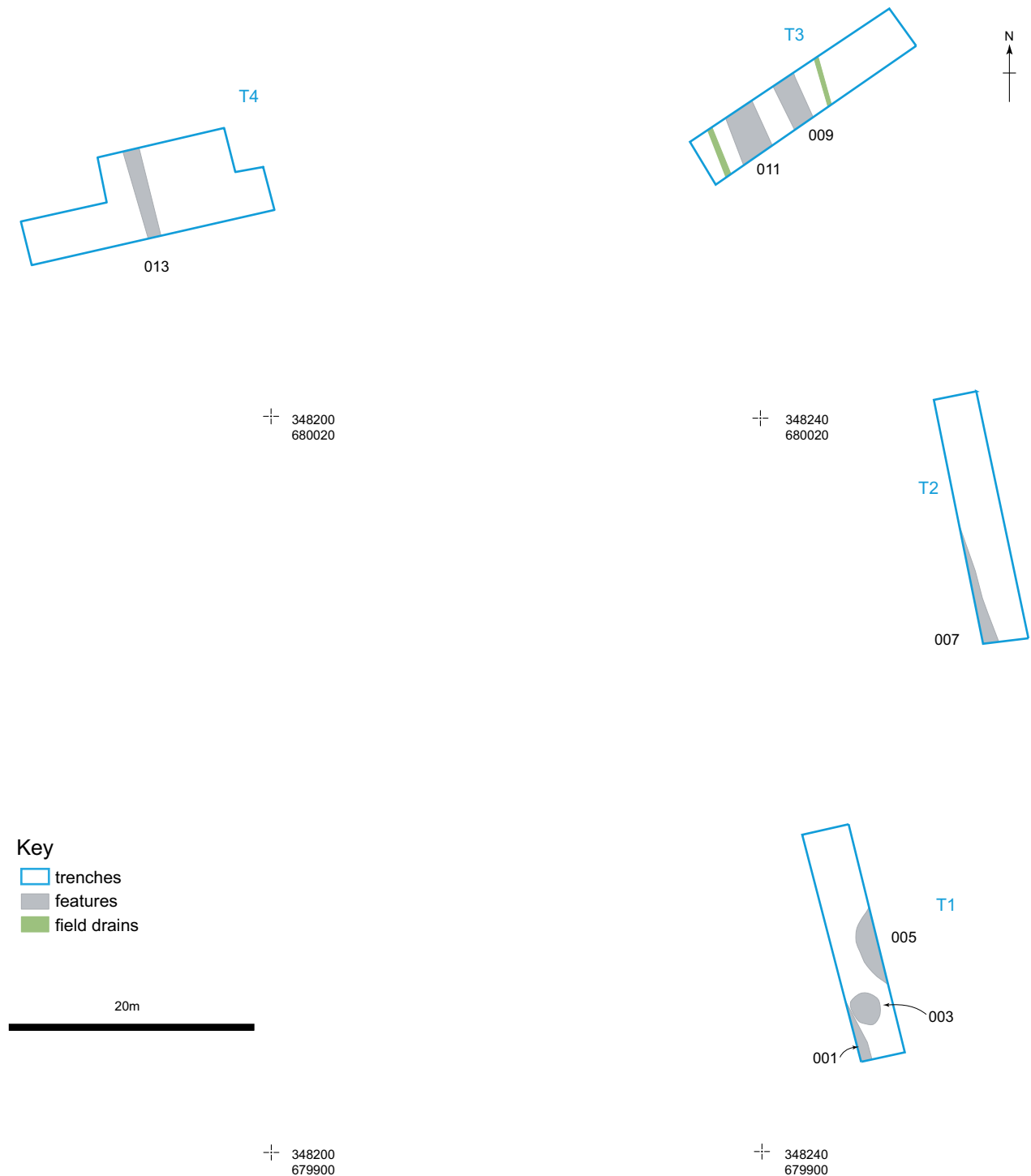

**Illus 2**  
 Location of features

A 360° tracked excavator with a flat-bladed ditching bucket was used to remove topsoil under direct archaeological control. Excavation continued until either clean geological sediments or significant archaeological deposits were encountered. The resulting surfaces were hand cleaned as necessary and investigated for archaeological features. A representative sample, sufficient to meet the objectives of the evaluation, of identified features were investigated by hand and all identified features were recorded. The stratigraphy of each trench was recorded in full.

All contexts were given unique numbers and all recording was undertaken on *pro forma* record cards.

Colour transparency and print photographs were taken and recorded in a photographic register. Record shots of archaeological contexts had a metric scale visible.

An overall site plan was recorded using Total Station survey and related to the National Grid.

#### 4. RESULTS

The following presents a summary of the results detailed records can be found in the appendices.

The evaluation at Luffness Mains revealed several features all of which are interpreted as being of agricultural origin and modern in date (Illus 2). They were all identified beneath topsoil and cut into an underlying geological deposit identified as glacial till.

Running across the site in a northwest to southeast direction were three ditches [001, 007, 013] that are interpreted as open field drains or possibly small boundary ditches. Of these ditches one [013] was initially thought to follow a circular path, and in order to examine this trench 4 was widened to follow 013 to the south. In the widened trench 013 was confirmed as a linear feature running on the same alignment as the other ditches.

Two furrows [009, 011] located in trench 3 followed the same alignment as ditches 001, 007 & 013. These furrows were broad shallow cuts that were flanked on either side by ceramic field drains. These field drains followed the line of the furrows and ditches noted above.

A sheep burial [003] of recent origin was encountered in trench 1, as was a possible curvilinear feature [005].

Investigation of 005 revealed it to be a variation in the underlying glacial till rather than of archaeological origin.

#### 5. CONCLUSION

All the features recorded at Luffness Mains are interpreted as ditches, furrows, drains and an animal burial relating to agricultural use of the area. The ditches, furrows and field drains all follow a northwest-southeast orientation that is reflected in the surrounding field boundaries (Illus 1). For this reason they are thought to relate to relatively recent (post-medieval) land-use.

No evidence was found to suggest that the cropmark prehistoric settlement located to the east extended into the evaluation area.

#### 6. REFERENCES

Headland Archaeology Ltd 2010, *Luffness Mains, East Lothian: Written Scheme of Investigation for archaeological Investigation*

## APPENDICES

### Appendix 1 – Site registers

#### *Trench & Context Register*

*Trench 1* – Length: 10m, Orientation: NW-SE, Average Depth: 0.5m

<b>Context</b>	<b>Description</b>	<b>Depth</b>
Topsoil	Dark brown organic loamy sand	0.50m
001	Linear cut oriented N-S. Measured 1.4m by 0.3m and 0.2m deep. Open field drain	0.2m
002	Grey silty sand. Fill of 001	0.2m
003	Sub-circular cut, measured 0.9m by 0.8m. Modern sheep burial	–
004	Grey silty sand. Fill of 003	–
005	Curvilinear feature, measured 2m by 1m. Natural variation in glacial till	–
006	Mottled grey orange and red sandy silt. Nominal fill of 005 variation in glacial till	–
Natural	Orange brown clayey sand glacial till	–

*Trench 2* – Length: 10m, Orientation: NW-SE, Average Depth: 0.45m

<b>Context</b>	<b>Description</b>	<b>Depth</b>
Topsoil	Dark brown organic loamy sand.	0.45m
007	Linear cut oriented N-S, measured 5m by 0.3m by 0.2m deep. Open field drain.	0.2m
008	Grey sandy silt. Fill of 007.	0.2m
Natural	Orange brown clayey sand glacial till.	–

*Trench 3* – Length: 10m, Orientation: NE-SW, Average Depth: 0.45m

<b>Context</b>	<b>Description</b>	<b>Depth</b>
Topsoil	Dark brown organic loamy sand.	0.45m
009	Linear cut oriented N-S, measured 2m by 1.2m and 0.3m deep. Cut of Furrow.	0.3m
010	Grey sandy silt. Fill of 009.	0.3m
011	Linear cut oriented N-S, measured 2m by 0.8m and 0.45m deep. Cut of furrow.	0.45m
012	Grey silty sand. Fill of 011.	0.45m
Natural	Orange brown clayey sand glacial till.	–

*Trench 4* – Length: 10m, Orientation: NE-SW, Average Depth: 0.4m

<b>Context</b>	<b>Description</b>	<b>Depth</b>
Topsoil	Dark brown organic loamy sand.	0.4m
013	Linear cut oriented N-S, measured 4m by 0.5m and 0.4m deep. Probable open field drain.	0.4m
014	Grey sandy silt. Fill of 013.	0.4m
Natural	Orange brown clayey sand glacial till.	–



**Photographic Register**

---

<b>Photo</b>	<b>Direction</b>	<b>Description</b>
1	-	ID Shot
2	S	Ditch 001
3	S	Sheep burial 003
4	E	Variation in glacial till 005
5	N	Ditch 007
6	S	Furrow 009
7	S	Furrow 011
8	S	Ditch 013
9	E	Trench 4
10	E	Trench 3
11	S	Trench 2
12	S	Trench 1

## Appendix 2 – Discovery and Excavation Scotland Entry

LOCAL AUTHORITY:	East Lothian
PROJECT TITLE/SITE NAME:	Luffness Mains
PROJECT CODE:	LMLY09
PARISH:	Aberlady
NAME OF CONTRIBUTOR(S):	Jamie Humble
NAME OF ORGANISATION:	Headland Archaeology UK Ltd
TYPE(S) OF PROJECT:	Evaluation
NMRS NO(S):	N/A
SITE/MONUMENT TYPE(S):	Furrow, Ditch
SIGNIFICANT FINDS:	None
NGR	NT 4823 7983
START DATE (this season)	1/3/2010
END DATE (this season)	1/3/2010
PREVIOUS WORK (incl. DES ref.)	None
MAIN (NARRATIVE) DESCRIPTION: (May include information from other fields)	<p>An archaeological evaluation was carried out at Luffness Mains, East Lothian in advance of construction of a new agricultural storage building.</p> <p>The site was deemed to be of archaeological potential as there are numerous crop mark sites relating to prehistoric settlement to the east of the site. Crop marks of area of rig and furrow are also preserved in the surrounding area.</p> <p>A total of 4 trenches were excavated across the site. The evaluation revealed a number of features relating to the pre-improvement agricultural use of the site. These comprised of two furrows with three associated drainage ditches sharing the same orientation.</p> <p>No further archaeological features or deposits of an archaeological nature were identified.</p>
PROPOSED FUTURE WORK:	None
ARCHIVE LOCATION (intended/ deposited)	Archive and report to be lodged with NMRS Report to be lodged with East Lothian Council archaeology Service
SPONSOR OR FUNDING BODY:	BHC Ltd
CAPTION(S) FOR ILLUSTRS:	N/A
ADDRESS OF MAIN CONTRIBUTOR:	Headland ArchaeologyUK Ltd 10 Payne Street Glasgow G4 0LF
EMAIL ADDRESS:	jamie.humble@headlandarchaeology.com