

# ARCHAEOLOGICAL MONITORING AND RECORDING

Old Hall, Littleover, Derby

ARS Report No. 2025/051  
OASIS ID: archaeol5-531773



ARCHAEOLOGICAL  
RESEARCH SERVICES LTD  
*Digging with Purpose*

Angel House  
Portland Square  
Bakewell  
DE45 1HB

e: [admin@archaeologicalresearchservices.com](mailto:admin@archaeologicalresearchservices.com)  
w: [www.archaeologicalresearchservices.com](http://www.archaeologicalresearchservices.com)

Evaluation ▪ Excavation ▪ Watching Briefs ▪ All Aspects of Fieldwork  
Environmental Impact Assessment ▪ Desk-Based Assessments ▪ Heritage Statements ▪ Historic Buildings  
Geophysics ▪ Geoarchaeology ▪ Palaeoenvironment ▪ Design and Publication

# Archaeological monitoring and recording at Old Hall, Littleover, Derby

ARS LTD REPORT 2025/051



ARCHAEOLOGICAL  
RESEARCH SERVICES LTD  
*Digging with Purpose*

[www.archaeologicalresearchservices.com](http://www.archaeologicalresearchservices.com)

Connect with us: 

---

**Prepared on behalf of:** Ivygrove Developments Ltd  
**Date of compilation:** June 2025  
**Compiled by:** Nicola Lombardo, Alice Short  
**Checked by:** Rob Atkins  
**Approved for issue by:** Alice Short  
**Planning Reference:** 24/00897/FUL  
**Local Authority:** Derby City Council  
**Site central NGR:** SK 32987 34229  
**OASIS ID:** archaeol5-531773

© Archaeological Research Services Ltd 2025

## EXECUTIVE SUMMARY

---

<b>Project Name:</b>	Old Hall, Littleover, Derby, Derbyshire
<b>Site Code:</b>	THE42025
<b>Planning Authority:</b>	Derby City Council
<b>Planning Reference:</b>	24/00897/FUL
<b>Location:</b>	Old Hall, Burton Road, Derby, DE23 6EH
<b>Parish:</b>	St. Peter's Church, Littleover
<b>Hard Geology:</b>	Mudstone of the Edwalton Member
<b>Superficial Geology:</b>	Diamicton of the Oadby Member
<b>Soil Type:</b>	Soilscape 18, slowly permeable, base-rich loamy and clayey soil
<b>NGR:</b>	SK 32987 34229
<b>Date of Fieldwork:</b>	14/04/2025 – 23/04/2025
<b>Date of Report:</b>	July 2025

Archaeological monitoring and recording was undertaken at the Old Hall, south of Burton Road, Littleover by Archaeological Research Services Ltd (ARS Ltd) on behalf of Ivygrove Developments Ltd (hereafter the Client) during April 2025. The purpose of the monitoring and recording was to record any archaeological and palaeoenvironmental remains that survived on the site according to the Written Scheme of Investigation (WSI) prepared for this work.

The development area was considered by the Local Planning Authority (LPA), Derby City Council (DCC), to have the potential to contain archaeological remains. A scheme of archaeological mitigation was required in compliance with the National Planning Policy Framework (NPPF), as set out in Section 16 '*Conserving and enhancing the historic environment*'. This was to record the archaeology of the site prior to development, and to make this evidence publicly accessible (MHCLG 2024).

The archaeological monitoring and recording conducted within the development area (DA) did not identify any evidence of significant archaeological activity. A single feature was identified in the eastern part of the site, at the north-western edge of the excavation limit for the Garage 3 footprint, which comprised a single-skin brick well. This well was c. 1m in diameter, but no cut for it was seen. The top 16 courses were recorded in the garage footings.

This well was interpreted as likely to be associated with the Old Hall, which was located to the west of the garage footprint, and it likely dates to the 18<sup>th</sup> to mid-19<sup>th</sup> century. There were a number of modern deposits, primarily associated with 19<sup>th</sup> century ground levelling, and modern service installation in the 20<sup>th</sup> century.

# CONTENTS

---

1	Introduction .....	1
1.1	Background and Scope of Work .....	1
1.2	Site Location and Description .....	2
1.3	Geology and Soils .....	2
1.4	Archaeological and Historical Background .....	2
2	Aims And Objectives .....	6
2.1	Research Aims and Objectives .....	6
2.2	Aims and Objectives .....	6
3	Method Statement.....	7
3.2	Professional Standards .....	8
4	Results .....	9
4.1	Overview.....	9
4.2	Results .....	9
5	Finds .....	14
5.1	Introduction.....	14
5.2	Methodology and Condition .....	14
5.3	Ceramic Building Material .....	14
5.4	Discussion .....	14
6	Discussion.....	15
7	Publicity, Confidentiality and Copyright .....	16
8	Statement of Indemnity .....	16
9	Archive .....	16
10	Acknowledgements.....	17
11	References.....	18
APPENDIX I	Context Description Table .....	20
OASIS Form	.....	21

## LIST OF FIGURES

---

Figure 1: Site location. ....	4
Figure 2: Archaeological monitoring and recording location. ....	5
Figure 3: Representative section of Garage 1 looking west, 2 x 1m scale.....	10
Figure 4: Section showing service trench [1003], looking north, 2 x 1m scale.....	10
Figure 5: Red brick well {1008}, looking north-west, 1m scale.....	11
Figure 6: Section showing (1007), looking west, 0.5m x 1m scale. ....	12
Figure 7: Representative section drawings.....	13

# I INTRODUCTION

---

## 1.1 Background and Scope of Work

1.1.1 A planning application 24/00897/FUL was submitted by the Client which proposed alterations to the existing building of the Old Hall, including demolition of the northeast side of the building, and the erection of a single detached garage in its place. Further works included the construction of a second garage block with two double garages on the western part of the site (west of the Old Hall), with the addition of an extended access drive to the rear (south) of the hall.

1.1.2 On the advice of Derbyshire County Council's (DCC) Development Control Archaeologist, archaeological advisor to the Local Planning Authority (LPA) Derby City Council, planning permission was granted conditionally. The Development Control Archaeologist considered the Development Area (DA) to have the potential to contain buried archaeological remains. Condition 4 of the planning decision therefore stated that:

*No development shall take place to undertake any ground works and/ or commence works to erect the garage buildings, until a written scheme of investigation (WSI) for archaeological monitoring, has been submitted to and approved by the Local Planning Authority in writing. For land that is included within the WSI, no development shall take place other than in accordance with the agreed WSI, which shall include the statement of significance and research objectives; and:*

- ◆ *The programme and methodology of site investigation and recording and the nomination of a competent person(s) or organisation to fund the agreed works*
- ◆ *The programme for post-investigation assessment and subsequent analysis, publication & dissemination and deposition of resulting material. This part of the condition shall not be discharged until these elements have been fulfilled in accordance with the programme set out in the WSI.*

*Reason: To ensure that archaeological remains and features are recorded prior to their destruction and to accord with the adopted policies of the Derby City Local Plan Part 1: (Core Strategy) and the saved policies of the adopted City of Derby Local Plan Review as included in this Decision Notice.*

1.1.3 Archaeological Research Services Ltd (ARS Ltd) was commissioned by the Client to undertake archaeological monitoring and recording at the site of the Old Hall (Figure 1), Littleover, centred at NGR SK 32987 34229. The DA redline boundary encompassed a total area of 0.32ha, with the area subject to archaeological monitoring and recording measuring 162m<sup>2</sup> across the three garage footings.

1.1.4 The monitoring and recording comprised the continuous observation of all groundworks and ground reduction related to the excavation of the garage foundations. These comprised the footings for a single detached garage located to the northeast of the Old Hall with another two double garages to the west of the Old Hall.

1.1.5 Works were undertaken in accordance with the Written Scheme of Investigation (WSI) (Green 2025) and took place between 14/04/2025 and 23/04/2025.

## 1.2 Site Location and Description

- 1.2.1 The development area boundary is indicated by the redline polygon depicted on Figure 1. The site is located within the village of Littleover, 4.8km southwest of Derby city centre. The DA is bounded to the north by Burton Road, to the south by Old Hall Road, and the west and east by trees. The site is roughly centred at NGR SK 32987 34229 and is located within a new residential housing development which was the subject of approved planning application 21/00064/FUL.
- 1.2.2 The site is positioned at an elevation of between 101m and 102m above Ordnance Datum (aOD).
- 1.2.3 The area for development extends over 0.32ha and covers the area north and west of the Old Hall. Previously this area contained gardens, garages, and outbuildings associated with the Old Hall.

## 1.3 Geology and Soils

- 1.3.1 The underlying solid geology of the DA consists of Edwalton Member – Mudstone, sedimentary bedrock formed between 237 and 228.4 million years ago during the Triassic period. The superficial geology comprises Oadby Member – Diamicton, a sedimentary superficial deposit formed between 480 and 423 thousand years ago during the Quaternary period (BGS 2025).
- 1.3.2 The soils of the DA are classified as Soilscape 18, slowly permeable seasonally wet slightly acid but base-rich loamy and clayey soils (Cranfield University 2025).

## 1.4 Archaeological and Historical Background

- 1.4.1 The archaeological and historical background of the site is summarised below, and utilises records held by the Derbyshire Historic Environment record (HER) and National Heritage List for England. Further information has been drawn from a desk-based assessment (DBA) conducted by ARS Ltd (Burpoe 2021) in support of a previous planning application for residential development within the wider site redline boundary (21/00064/FUL). Also referenced is a heritage statement (Golemdzhiyska 2021) produced in support of planning application 24/00897/FUL. Records held by the HER are presented as such (MDR12345) and National Heritage List for England numbers are presented as (NHLE12345).

### Prehistoric

- 1.4.2 There is no evidence for prehistoric activity within the development area, however a findspot of a Late Neolithic/Early Bronze Age stone hammer or battleaxe (MDR4597) was recorded c.150m north of the site. An Early Bronze Age cemetery (NHLE1021321), containing nine cremation burials was uncovered alongside an Iron Age pit alignment, c.380m to the west of site (Bacon-Martin and Woodward 2008).

### Roman

- 1.4.3 There is no evidence for Roman activity within the DA. However, the route of an important Roman military road, Rykneld Street (RR18), is located c.153m to the north of the site (running north-east to south-west along the route of the existing Burton Road), which provided direct access across the Midlands connecting to the fort *Derventio* at Little Chester c.3.8km to the northeast. A section of this road is located c.250m north-west of

the site and is scheduled as part of the same listing as the Early Bronze Age cemetery (NHLE1021321).

#### Medieval and Post-medieval

- 1.4.4 During the early medieval period, the land at Littleover was part of the endowment of Burton Abbey. Into the medieval period, the land was granted to Sir Richard Harpur and it was at this time that the construction of Littleover Hall was recorded, the footprint of which lies partially under the northern part of the Old Hall. The original structure was a brick construction of 16<sup>th</sup> century date and included surrounding parkland and gardens (MDR10490), the earliest depiction of which is on the 1768 Enclosure Map of the Manor of Littleover. The property underwent several alterations and re-landscaping to the parklands and gardens throughout the mid-18<sup>th</sup> century. A number of outbuildings surrounding the Hall and a stable block first appear on the 1850 Littleover tithe map, which are further depicted on the earliest Ordnance Survey map of the area in 1883.

#### Modern

- 1.4.5 The Elizabethan Littleover Hall was demolished in the late 19<sup>th</sup> century, and a new Arts and-Crafts style house, Old Hall, was constructed on the footprint of the northern part of the previous Littleover Hall. This structure is still present on the site today (MDR10489). Historical maps for the site indicate that the previous structure stood where the northeastern extent of the DA lies.
- 1.4.6 The site was sold to Harold Walker in 1934, following which the gardens surrounding the site were reduced significantly and the remaining gardens were re-landscaped. During the Second World War, the stables and outbuildings were converted into a decontamination centre in anticipation of gas attacks. In 1954 the Old Hall was sold to Rolls-Royce for use as offices as part of the nuclear programme. During this time, the former stable block was replaced by new offices, and the outbuilding complexes within the northern part of the site were replaced by a large square structure and a long rectangular structure. The access road was also widened.
- 1.4.7 In 1971 the building was sold to Derbyshire County Council for use as a Fire and Rescue Services Headquarters and underwent subsequent extensions to the western elevation of the northern-most building (within the eastern part of the DA) and a large structure was constructed within the eastern part of the site. The southern extent of the DA was converted into residential dwellings, either side of the newly established Hall Park Close.
- 1.4.8 The site underwent several further works from 1992 to 2003, including the removal of the outhouse at the southern extent of the DA and an extension to the north facing extent of the western wing of the building.
- 1.4.9 During archaeological evaluation and excavation at the adjacent site in 2022 (21/00064/FUL) the foundations of the modern fire services building were discovered to have survived below ground level following its demolition. Below these lay the foundations for the previous Rolls-Royce Building. In the southern end of the site a ridged brick surface was uncovered, with bricks laid at a 45° angle, suggestive of a deterrent floor surface alongside a water storage tank which was likely part of plant propagating houses built between 1899 and 1906. In Trench 4 an isolated brick well was recorded, which was not visible on any historic mapping and clearly pre-dated the remains of the Rolls-Royce building (Danter 2021) (Morris and Lister 2022).

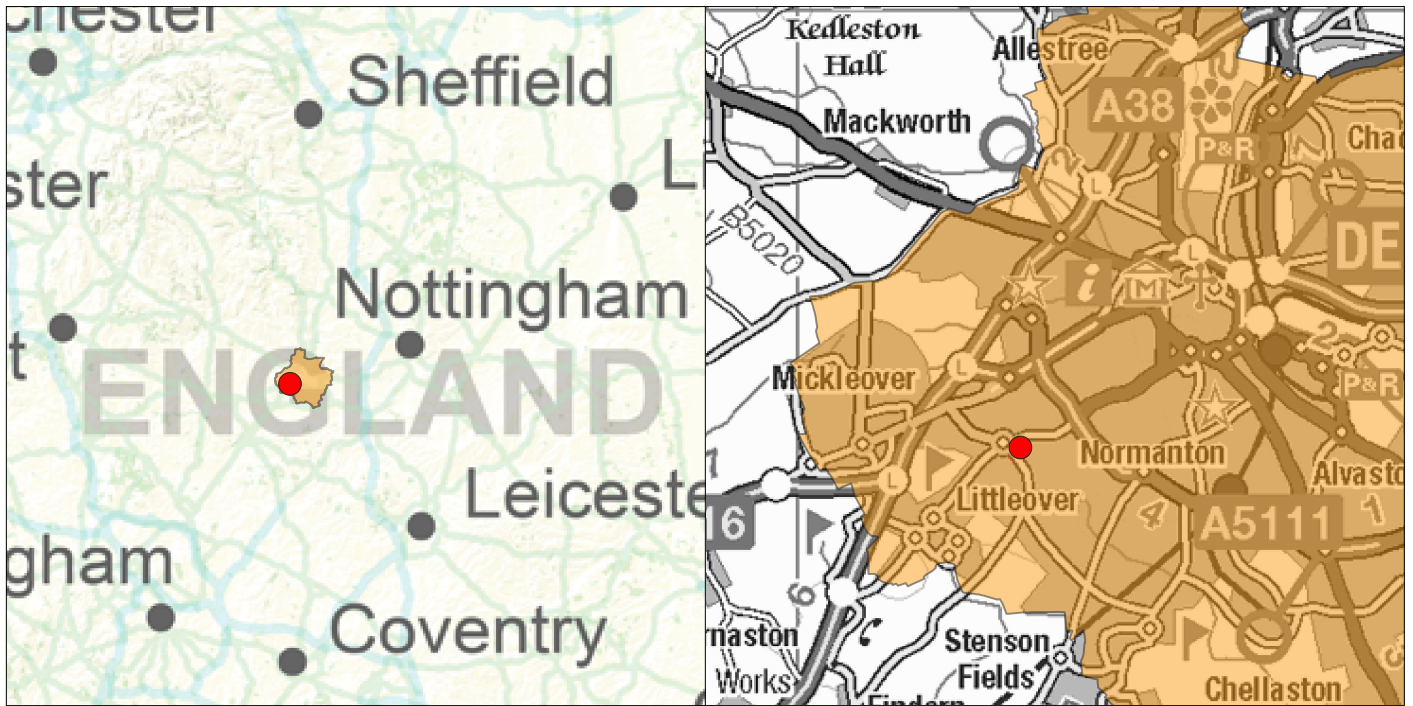

Site name: Old Hall, Littleover, Derby  
 Date: April 2025  
 Drawn by: NL  
 Scale: Varies

- City of Derby
- Areas of watching brief
- Site location
- Red line boundary

**Archaeological Research Services Ltd**  
 Angel House  
 Portland Square  
 Bakewell  
 Derbyshire  
 DE45 1HB  
 Tel: 01629 814540  
 www.archaeologicalresearchservices.com



ARCHAEOLOGICAL  
 RESEARCH SERVICES LTD  
 Digging with Purpose





This drawing: © ARS Ltd  
 Contains Ordnance Survey data.  
 © Crown copyright and database right 2025  
 Map data from <https://openstreetmap.org>

**Figure 1:  
 Site location**

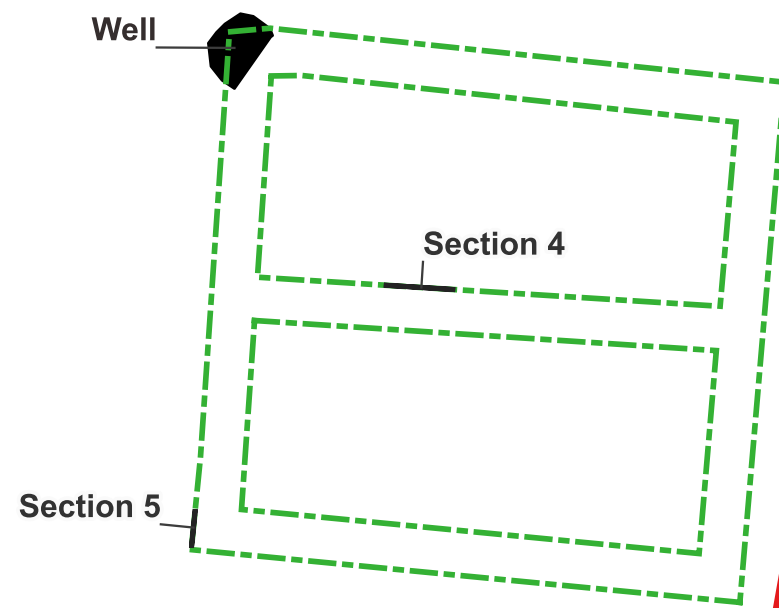
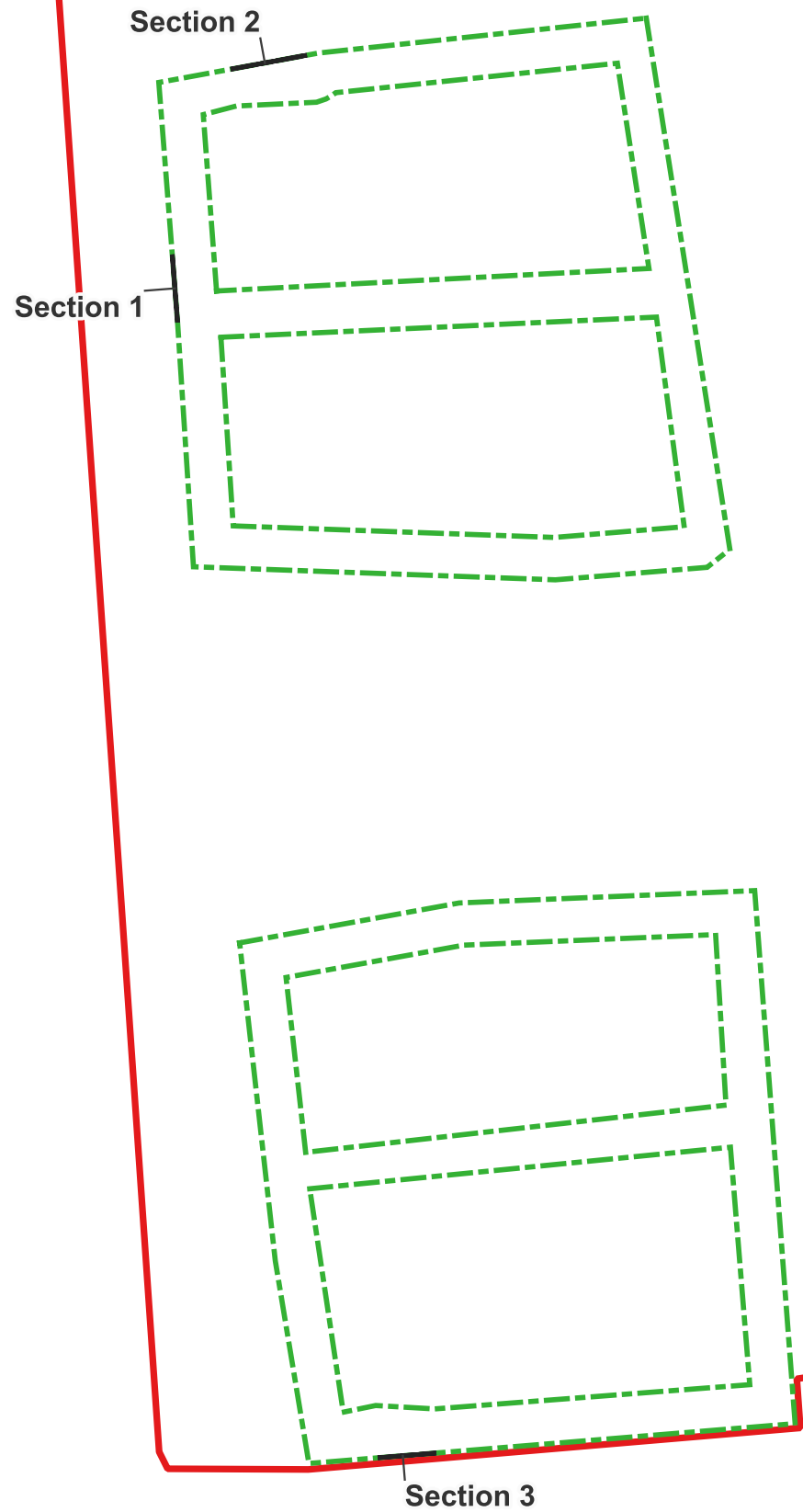

**Figure 2: Areas of excavation**



-  Site boundary
-  Limit Of Excavations
-  Representative sections
-  Well



Site name: Old Hall, Littleover  
Date: April 2025  
Drawn by: N. L.  
Scale: 1:100 @ A3

**Archaeological Research Services Ltd**  
Angel House  
Portland Square  
Bakewell  
Derbyshire  
DE45 1HB



This drawing: © ARS Ltd

Contains Ordnance Survey data.  
© Crown copyright and database right 2025.

Tel: 01629 814540  
www.archaeologicalresearchservices.com

ARCHAEOLOGICAL  
RESEARCH SERVICES LTD  
Digging with Purpose

## 2 AIMS AND OBJECTIVES

---

### 2.1 Research Aims and Objectives

2.1.1 The aim of the fieldwork was ‘to record and enhance understanding of the significance of any heritage assets to be lost during the proposed development in a manner proportional to their importance, and to make this evidence (and any archive generated) publicly accessible’ (MHCLG 2024).

2.1.2 The objectives of the fieldwork were to:

- ◆ Monitor closely all development groundwork that could have been encountered archaeological remains and confer with the archaeological planning advisor to the LPA when archaeological remains have been found;
- ◆ Investigate and record any archaeological features/deposits encountered;
- ◆ Establish a relative chronological sequence and, if possible, recover datable materials from archaeological deposits and features; and,
- ◆ Establish the character, extent, form, function and likely status of the archaeological remains were found;
- ◆ Address relevant research aims and objectives.

### 2.2 Aims and Objectives

2.2.1 The investigations were carried out with a view to addressing objectives suggested by the published research priorities set out for the *East Midlands Historic Environment Research Framework* (Research Frameworks 2025).

2.2.2 The following specific themes were expected to be relevant:

- ◆ Agenda 8.1.6: How could we advance studies of building plans and standing remains, especially where hidden inside later buildings, and of caves and cellars.
- ◆ Agenda 9.2.2: How have building types changed (e.g. adaption of industrial buildings to new uses) and what has been the impact of building regulations;
- ◆ Agenda 9.5.2: What survived of country estates, parks and gardens, how they are distributed, and how they should be classified.

### 3 METHOD STATEMENT

---

- 3.1.1 The methodology for the monitoring and recording is set out in detail in the WSI in section 3.2 (Green 2025). The works subject to archaeological monitoring comprised the excavation of footings for three garages. Two garages were located on the western side of the Old Hall referred as Garage 1 and Garage 2. The third is located to the northeast of the Old Hall, referred to as Garage 3. All footings were excavated to the appropriate design depth of development and any deposits encountered were fully recorded.
- 3.1.2 All mechanical excavation was undertaken under the supervision of an attendant archaeologist who was given the opportunity to stop excavation to investigate potential archaeological features/deposits. Adequate time was allowed for recording any such remains. The stratigraphy of the site was recorded even where no archaeological deposits were identified.
- 3.1.3 The site was accurately tied into the National Ordnance Survey Grid and located at a suitable scale. Survey data of features was collected using survey grade equipment with an accuracy of  $\pm 0.05\text{m}$  (Historic England 2016). Digital data was surveyed with equipment using Real Time Kinematic (RTK) corrections from a Global Navigation Satellite System (GNSS) network. The same equipment was used to record known points on drawn plans and sections and to take spot heights to supplement other available planning/survey techniques as applicable.

#### Machine excavation

- 3.1.4 Excavation was undertaken by a suitable mechanical excavator fitted with a ditching bucket. A breaker was used to remove the concrete on the eastern side.
- 3.1.5 Excavation areas were machined cleanly, sufficient to identify and establish the extent of any archaeological features present. Photographs were taken during the machine works to record the progress.
- 3.1.6 Machine operation ceased once on the western side, when a gravel filled trench was encountered, and once on the eastern side, after the identification of a water well on the north-western corner of the limit of excavation (LOE). Operations continued after investigation and recording was completed.

#### Investigation, Recording and Archiving

- 3.1.7 Five different sectional profiles of the foundation trenches have been produced, and their locations were recorded, to ensure that in the absence of archaeological remains the stratigraphy of the site was fully recorded. All archaeological deposits encountered during the investigation were given a separate context number and fully recorded, including full descriptions recorded on *pro forma* context sheets and on ARS Ltd's digital recording app. Recording followed ARS Ltd's field recording practices (ARS Ltd 2020).
- 3.1.8 Digital photographs form the principal photographic record of the site works. A photographic record was maintained by high resolution digital photography and a register of photographs was maintained throughout the duration of the project. Overall images of the site were taken prior to, during and following completion of site works. Archive images include a north arrow and suitable photographic scale.

- 3.1.9 All excavated spoil was visually scanned to retrieve any artefacts. Limited representative samples of unstratified tiles/CBM from Garages 1 and 2 were retained for specialist assessment, but unfortunately no brick from the well were taken. Decorative concrete wall sections of a modern date recovered from Garage 3 were photographed on site but not retained for assessment.
- 3.1.10 As no significant archaeological finds were recovered, no physical archive will be deposited with Derby Museum and Galleries. The digital archive will be deposited with the Archaeology Data Service (ADS) and prepared in accordance with accepted standards and best practice guidelines (ADS/Digital Antiquity 2011; ADS 2024). The archive will be deposited at the next available opportunity following acceptance of this report.
- 3.1.11 The final approved version of the report in PDF/A format will be submitted to the Derbyshire HER and uploaded to the Online Access to the Index of Archaeological Investigations (OASIS) database, with the ID number archaeo15-531773 (Appendix 2).

## **3.2 Professional Standards**

- 3.2.1 The project has been managed according to the Historic England guidance for research projects (Historic England 2015).
- 3.2.2 The archaeological fieldwork was undertaken in accordance with the Chartered Institute for Archaeologists (CIfA) *Code of Conduct (2022)*, *Standard for archaeological monitoring and recording (2023a)* and *Universal guidance for archaeological monitoring and recording (2023b)*.
- 3.2.3 All works were undertaken in full compliance with the Health and Safety at Work Act 1974 and with the Management of Health and Safety Regulations 1992.
- 3.2.4 A risk assessment RA/2025/31 was produced before commencement of the work and was adhered to throughout the course of the fieldwork.

## 4 RESULTS

---

### 4.1 Overview

- 4.1.1 An overall plan of the monitoring and recording area is presented in Figure 2. A context description table is contained in Appendix I. Plans, section drawings and photographs of the monitoring and recording results are included in this section. Additional digital photographs are contained in the project archive.
- 4.1.2 The overburden across the area subject to the monitoring and recording was machine excavated down to the top of the archaeological horizon or depth of development, whichever was the encountered first, under continuous archaeological supervision. The design depth of the excavations was approximately 1.3m below ground level for the garage foundations. Exception was made on the western limit of excavation (LOE) of all three garages, in which excavation went deeper due to modern activity disturbing all the depositional layers.

### 4.2 Results

- 4.2.1 The footings for the three garages were machine excavated to the depth of development, at roughly 1.3m in depth. All excavations encountered the natural substrate, (1002), at the base of the footings. Garages 1 and 2 are located to the southwest of the Old Hall and Garage 3 is located to the northeast.

#### Garages 1 and 2

- 4.2.2 The natural substrate (1002) was recorded across both garages. It consisted of a fine mid reddish-brown clay, with very few inclusions, but contained occasional small sub-rounded stones.
- 4.2.3 The natural was sealed on the southern side of Garage 2 by a made ground deposit (1005). It comprised a mid reddish brown silty clay and contained a significant quantity of red roof tile debris.
- 4.2.4 Elsewhere the natural was sealed by subsoil (1001). This subsoil deposit, (1001), was up to 0.6m thick and consisted of mid bright greyish brown silty clay, and occasionally included CBM, gravel and clinker fragments (Figure 3).
- 4.2.5 The subsoil was overlaid by a former topsoil (1000), which consisted of mid greyish brown sandy silt, slightly compacted by the presence of roots and grass. This covered the entirety of Garages 1 and 2 to a depth of 0.3m below ground level (bgl).
- 4.2.6 Cutting the topsoil in Garage 1 was a cut of a modern construction trench [1003], which was recorded in the south-west area of the garage (Figure 4 & 7, drawing 2). It measured 0.75m in width and extended beneath the depth of development, and was cut into the natural substrate (1002). It contained one fill (1004), which consisted of a pale brown grey sand and gravel. The same gravel was identified across the surface of the central area of Garage 1, and most of the northern side of Garage 2 sealing the old topsoil layer.



*Figure 3: Representative section of Garage 1 looking west, 2 x 1m scale.*



*Figure 4: Section showing service trench [1003], looking north, 2 x 1m scale.*

### Garage 3

- 4.2.7 The natural substrate (1002) was recorded across Garage 3. The earliest feature or deposit recorded was a red brick well {1008}, located in the north-western corner of the garage footprint. It was c. 1m in diameter, but no cut for it was visible. The machine had removed both a concrete slab and a thin metal sheet, which had been used as a crude cover sealing the well after disuse. The removal of the later covers showed the well was open, with water still at the base and it had not been backfilled after disuse. Above this water table the well had survived to 13m long, up to the height of the present topsoil (Figure 5). The well was constructed of a single skin of unfrogged and unstamped red bricks with no bonding material. The well was largely round, but it was not precisely

made. Most of the bricks were laid stretcher to stretcher, and where needed, bricks were cut into small pieces to fill gap. It is likely that the bottom of the well had been sealed, but this was not the case for most of the well, presumably because it was above the water table. The well cut Edwalton Member (mudstone), which is largely impermeable (See Section 1).

- 4.2.8 As part of the development the well was largely backfilled by the machine operator for health and safety concerns. Only the top 16 courses were left exposed during this work after it had been largely backfilled (Figure 5).



*Figure 5: Red brick well {1008}, looking north-west, 1m scale.*

- 4.2.9 On the western corner, sealing the natural was a made ground deposit (1007). It comprised a coarse mid yellowish brown silty clay with infrequent stone inclusions (Figure 6). The deposit was 0.80-0.90m thick. At the base of the deposit, and recorded in section, was a modern ceramic land drain, orientated north to south (Figure 6).



*Figure 6: Section showing (1007), looking west, 0.5m x 1m scale.*

- 4.2.10 Sealing (1007) was a made ground deposit (1006) which was a dark black brown coarse sandy silt which measured 0.4m thick (.). It contained the remnants of construction waste materials including concrete and plastic fragments, charred wood, and metal fragments.
- 4.2.11 The ground surface of Garage 3 comprised a concrete slab which was previously broken up. Beneath the concrete was a made ground deposit (1006) which was a dark black brown coarse sandy silt which measured 0.4m thick. It contained the remnants of construction waste materials including concrete and plastic fragments, charred wood, and metal fragments.

**Figure 7: Representative section drawings**

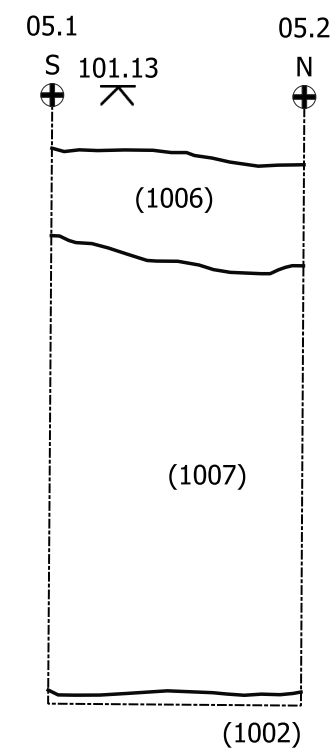
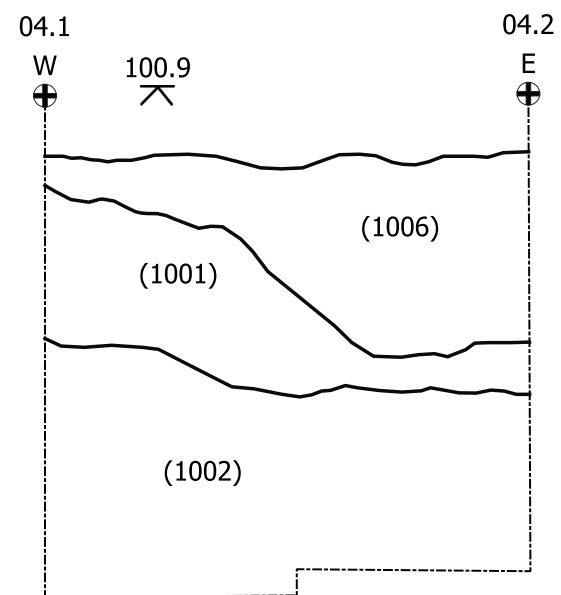
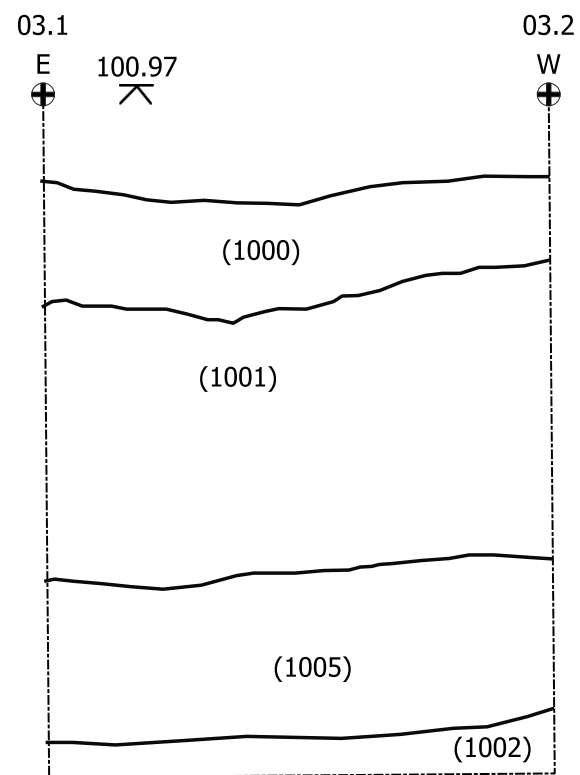
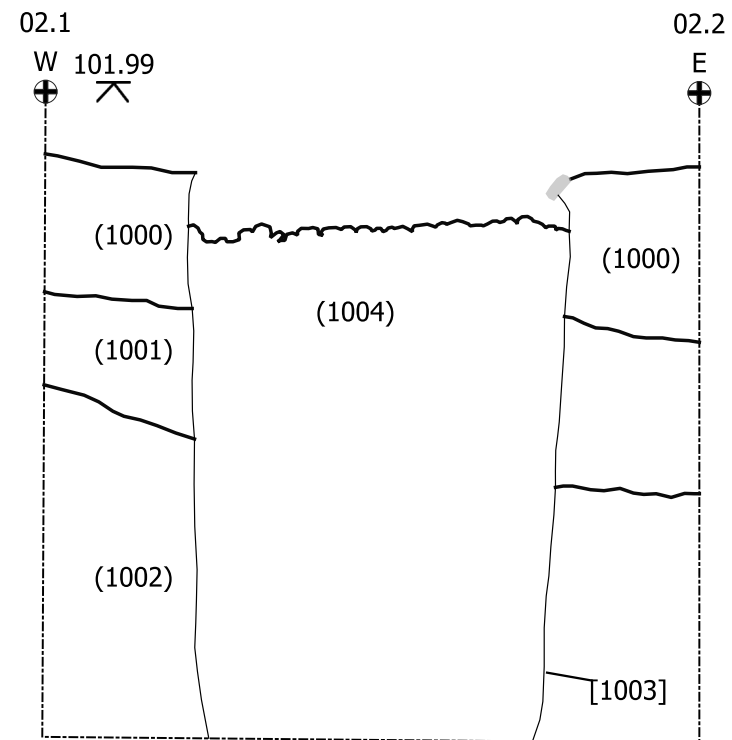
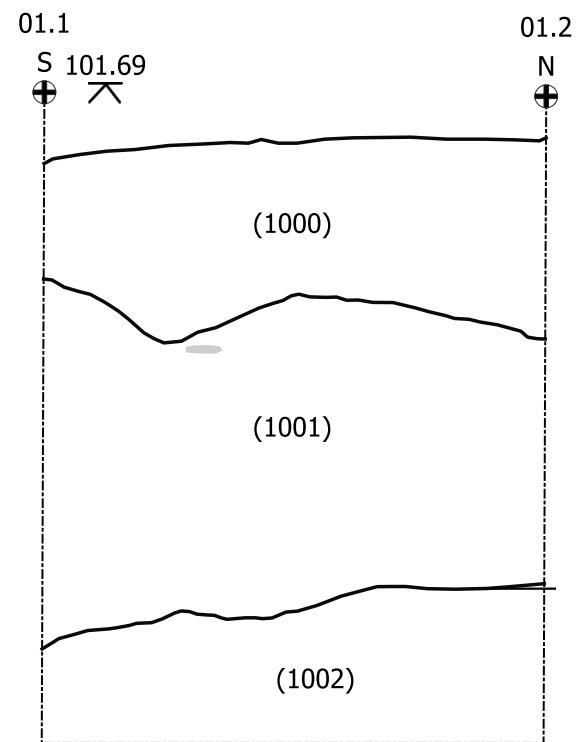

- Edge of Section
- ⊕ Section Drawing Points
- ∧ Spot Heights
- Excavated Cut
- Deposit Interface

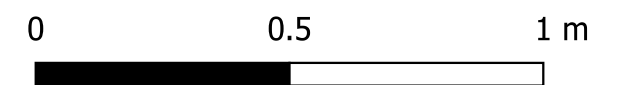

Site name: Old Hall, Littleover  
Date: April 2025  
Drawn by: N.L. E.W.  
Scale: 1:10 @ A3

**Archaeological Research Services Ltd**

Angel House  
Portland Square  
Bakewell  
Derbyshire  
DE45 1HB



This drawing: © ARS Ltd

Contains Ordnance Survey data.  
© Crown copyright and database right 2025.

Tel: 01629 814540  
www.archaeologicalresearchservices.com

ARCHAEOLOGICAL  
RESEARCH SERVICES LTD  
Digging with Purpose

## 5 FINDS

---

Robin Holgate MCIFA

### 5.1 Introduction

5.1.1 An assemblage of ceramic building material was recovered from contexts (1005) and (1006).

### 5.2 Methodology and Condition

5.2.1 The ceramic building material was gently washed with a soft bristled brush and clean water before being left to dry out completely. The material was then repackaged, counted and weighed in grams before being inspected visually, identified and quantified by context.

### 5.3 Ceramic Building Material

5.3.1 A total of 33 fragments of garden edging tiles and roof tile weighing 6,953g in total were recovered, as summarised in Table 1. All these fragments date from the 19<sup>th</sup>-early 20<sup>th</sup> centuries.

Artefact type	Date range	Artefact count by context	
		(1005)	(1006)
Roof tiles	19 <sup>th</sup> -early 20 <sup>th</sup> centuries	30	-
Garden edging tiles	19 <sup>th</sup> -early 20 <sup>th</sup> centuries	-	3
<b>Weight (g)</b>		<b>3,300</b>	<b>3,653</b>
<b>Total count</b>		<b>30</b>	<b>3</b>

Table 1. Ceramic building material.

5.3.2 The garden edging tiles are dark grey in colour and made from Staffordshire Blue clay. Each piece, although broken along the bottom edge, is 228mm in length and has rope top decoration 42mm in diameter.

5.3.3 The handmade roof tile fragments have a hard orange fabric which is smooth on one side and sandy on the other. The largest piece is 90 by 60mm in size. Most pieces are c. 15mm thick, although three pieces are 17mm thick and one piece is from a semi-circular ridge tile with a thickness of 22mm.

### 5.4 Discussion

5.4.1 The assemblage as a whole dates to the 19<sup>th</sup>-early 20<sup>th</sup> centuries. The finds recovered from the site are not unusual in any respect for a site of this nature. None of the finds require conservation and they have limited potential for further analysis to inform the aims or research questions related to the project. It is not recommended that these finds are retained for future analysis or for long-term preservation in a museum and they can therefore be returned to the landowner or discarded as appropriate.

## 6 DISCUSSION

---

- 6.1.1 Archaeological monitoring and recording was conducted at the Old Hall, in the village of Littleover, Derbyshire as a condition of granted planning consent for the construction of three garages (24/00897/FUL).
- 6.1.2 The work was undertaken across the excavation of the foundations uncovered a single isolated well in the north-west corner of Garage 3 Apart from this feature, no other archaeological features were present.
- 6.1.3 This well had been in use seemingly until fairly recently, and after disuse the top of the well was removed, but at ground level the remains of the former well was then covered by a metal sheet and a concrete slab. The water table in the well was recorded at 13m below ground level, showing it had been a very deep structure. The well appears to date to the 18<sup>th</sup> or early 19<sup>th</sup> century, and is likely related to the residence/outbuildings of the Old Hall, which was demolished in the late 19<sup>th</sup> century.
- 6.1.4 The well does not appear on historic OS mapping, making it difficult to contextualize with certainty. However, its position roughly corresponds to being within/on the eastern edge of the immediate grounds of the old Elizabethan Hall and related outbuildings footprint as depicted on earlier cartographic sources, suggesting potential archaeological significance. The hall had several alterations especially from the mid-18<sup>th</sup> century and it is possible that the well was part of this reuse. The diameter size of the well at 1m diameter and its depth strongly implies it was not a soak away.
- 6.1.5 Interestingly, this well shows notable similarities to an isolated well (1074) uncovered in Trench 4 during the 2022 archaeological evaluation and excavation to the north (21/00064/FUL) (Danter 2021) (Morris and Lister 2022), which was similarly unable to clarify interpretation of the feature further. The well recorded in 2022 also appeared without clear historical reference and was not associated with broader structural remains, much like well {1008} recorded during this phase of works.
- 6.1.6 The footprint area of Garages 1 and 2 had been significantly impacted by modern construction trench [1003], and Garage 3 was disturbed by extensive ground levelling (1006) (1007) which had, in effect, removed any trace of possible earlier archaeological activities. The date of the ground levelling is uncertain, but probably dated to the 18<sup>th</sup> and or 19<sup>th</sup> centuries.
- 6.1.7 The archaeological work carried out was successful in achieving the objectives of the fieldwork by archaeologically monitoring all groundworks associated with the construction of the garages, and recording deposits encountered in line with the methodology and standards as outlined in the WSI. As only a single feature of uncertain date was recorded, information significant enough to address specific research aims as stated in the *East Midlands Historic Environment Research Framework* (Research Frameworks 2025) was not available. The outcome of the project was valuable in determining that as a result of modern (20<sup>th</sup> century) landscaping/ground levelling and service installation across the footprint of the Elizabethan Old Hall, no evidence of below ground archaeological remains or structures survived.

## **7 PUBLICITY, CONFIDENTIALITY AND COPYRIGHT**

---

- 7.1.1 Any publicity arising from the production of this document will be handled by the client.
- 7.1.2 ARS Ltd retain the copyright of all documentary, photographic and video material under the Copyright, Designs and Patent Act (1988). This report may not be reproduced in part or in whole without the express permission of ARS Ltd.

## **8 STATEMENT OF INDEMNITY**

---

- 8.1.1 All statements and opinions contained within this report arising from the works undertaken are offered in good faith and compiled according to professional standards. No responsibility can be accepted by the author/s of the report for any errors of fact or opinion resulting from data supplied by any third party, or for loss or other consequence arising from decisions or actions made upon the basis of facts or opinions expressed in any such report(s), howsoever such facts and opinions may have been derived.

## **9 ARCHIVE**

---

- 9.1.1 A paper and digital archive has been prepared by ARS Ltd, consisting of all primary written documents, plans, sections, photographs and electronic data, which will be deposited with the ADS.
- 9.1.2 The archive will be prepared in line with Archaeological Archives: A guide to best practice in creation, compilation, transfer and curation (Brown 2007). The archive will follow the recommendations provided by ClfA's (2020) Standard and Guidance for the creation, compilation, transfer and deposition of archaeological archives and the Society of Museum Archaeologists' (1993) Selection, Retention and Dispersal of Archaeological Collections. Guidelines for use in England, Wales and Northern Ireland.
- 9.1.3 All artefacts and associated material will be cleaned, recorded, properly stored and deposited in the archive.
- 9.1.4 A set of annotated, illustrative pictures of the site, excavation and features is contained within the digital archive.
- 9.1.5 An OASIS online record <http://ads.ahds.ac.uk/project/oasis/> has been initiated and completed for this work and all parts of the OASIS online form completed for submission to the HER. This will include an uploaded pdf version of the entire report. The site has produced a paper and digital archive which will be deposited, along with this report, in digital form with Archaeological Data Service (ADS). In addition, a copy of this report will be deposited with Derbyshire Historic Environment Record (HER).

## **10 ACKNOWLEDGEMENTS**

---

- 10.1.1 ARS Ltd would like to thank Ivygrove Developments Ltd. for commissioning the work, the staff on site for facilitating the work and cooperating with the archaeological staff, and the Development Control Archaeologist for Derbyshire County Council, Reuben Thorpe for advice provided.

## II REFERENCES

---

- ADS/Digital Antiquity. 2011. *Archaeology Data Service/Digital Antiquity Guides to Good Practice*.
- Archaeological Data Service (ADS). 2024. *Guidelines for Depositors*. Available online at: <https://archaeologydataservice.ac.uk/help-guidance/instructions-for-depositors/files-andmetadata/>. Last accessed 27/05/25.
- Bacon-Martin, H. and Woodward, A. 2008. Prehistoric and Roman Derby: Excavations at Littleover, Derby, 2003-4. *Derbyshire Archaeological Journal* 128; 19-39.
- British Geological Survey 2025. Geology of Britain viewer. Available online at: <https://geologyviewer.bgs.ac.uk/> [accessed 14<sup>th</sup> April 2025].
- Brown, D. 2007. *Archaeological Archives: A guide to best practice in Creation, compilation, transfer and curation*. London: Archaeological Archives Forum.
- Burpoe, M. 2021. *Old Hall, Littleover, Derby: Archaeological Desk-Based Assessment*. Unpublished ARS Ltd DBA 2021/32. Bakewell: Archaeological Research Services Ltd.
- Chartered Institute for Archaeologists. 2020. *Standard and Guidance for the collection, documentation, conservation and research of archaeological materials*. Reading, Chartered Institute for Archaeologists.
- Chartered Institute for Archaeologists (CifA) 2022. *Code of Conduct: professional ethics in archaeology*. Reading, Institute for Archaeologists
- Chartered Institute for Archaeologists (CifA). 2023a. *Standard for archaeological monitoring and recording*. Reading, Chartered Institute for Archaeologists
- Chartered Institute for Archaeologists (CifA). 2023b. *Universal guidance for archaeological monitoring and recording*. Reading, Chartered Institute for Archaeologists
- Cranfield University. 2025. *Soilscapes. Cranfield Soil and Agrifood Institute*. Available online at: <http://www.landis.org.uk/soilscapes/> [Accessed 15<sup>th</sup> April 2025].
- Danter, J. 2021. *An Archaeological Evaluation at Old Hall, Littleover, Derby*. Unpublished ARS Ltd report 2021/88. Bakewell: Archaeological Research Services Ltd.
- Golemdzhiyska, T. 2021. *Heritage Statement Addendum – Erection of 14 dwellings at Former DFRS HQ Old Hall, Burton Road*. JMI Planning, unpublished report
- Green, E. 2025. *Written Scheme of Investigation for an Archaeological Watching Brief at The Old Hall, Littleover, Derby*. ARS Ltd, unpublished report
- Historic England. 2015. *Management of Research Projects in the Historic Environment: The MoRPHE Project Managers' Guide*. Historic England
- Historic England. 2016. *Where on earth are we? The Global Positioning System (GPS) in archaeological field survey*. London, Historic England
- Research Frameworks, 2025. *East Midlands Historic Environment Research Framework*. Available online at [East Midlands Historic Environment Research Framework -](#)

[East Midlands Historic Environment Research Framework](#). [Accessed 27 May 2025].

Ministry of Housing, Communities and Local Government (MHCLG). 2024. *National Planning Policy Framework*. London, Ministry of Housing, Communities and Local Government.

Morris, J. and Lister, D. 2022. *An Archaeological Strip, Map, Survey and Excavations at Old Hall, Littleover, Derby*. ARS Ltd Report 2022/161. Bakewell, Derbyshire.

Society of Museum Archaeologists. 1993. *Selection, Retention and Dispersal of Archaeological Collections. Guidelines for use in England, Wales and Northern Ireland*. Society of Museum Archaeologists, London.

United Kingdom Institute for Conservation. 1990. *Guidelines for the Preparation of Archives for Long-Term Storage*.

## APPENDIX I CONTEXT DESCRIPTION TABLE

Context Number	Context Type	Context Description	Length	Width	Depth	Finds
1000	Deposit	Modern topsoil			0.3m	
1001	Deposit	Subsoil			0.3m	
1002	Deposit	Natural substrate				
1003	Cut	Cut of a modern trench		0.75m	>1.3m	
1004	Fill	Fill of a modern trench		0.75m	>1.3m	
1005	Deposit	Depositional layer containing tiles.			0.35m	CBM tiles
1006	Deposit	Upper depositional layer, below concrete			0.4m	Decorative wall segments
1007	Deposit	Lower depositional layer, disturbing natural substrate			0.88m	
1008	Construction feature	Brick – layered water well. Single skin, unfrogged red brick	1.3m	1.5m	>13m	

# OASIS FORM

---

# OASIS Summary for archaeol5-531773

OASIS ID (UID)	archaeol5-531773
Project Name	Archaeological Watching Brief at Old Hall, Littleover, Derby
Sitename	The Old Hall Littleover, Derby
Sitecode	
Project Identifier(s)	ARS24-427
Activity type	Watching Brief
Planning Id	24/00897/FUL
Reason For Investigation	Planning: Post determination
Organisation Responsible for work	Archaeological Research Services Ltd
Project Dates	14-Apr-2025 - 23-Apr-2025
Location	The Old Hall Littleover, Derby NGR : SK 32987 34229 LL : 52.90449025461192, -1.511006008670356 12 Fig : 432987,334229
Administrative Areas	Country : England County/Local Authority : Derby Local Authority District : Derby Parish : Derby, unparished area
Project Methodology	An archaeological watching brief was undertaken at the Old Hall, south of Burton Road, Littleover by Archaeological Research Services Ltd (ARS Ltd) on behalf of Ivygrove Developments Ltd during April 2025. The purpose of the watching brief was to record any archaeological and palaeoenvironmental remains that survived on the site according to the Written Scheme of Investigation (WSI) prepared for this work. The groundworks monitored comprised the excavation of footings trenches of three garages (Garages 1-3). Garages 1 and 2 were located on the western side of Old Hall, with Garage 3 located to the northeast of Old Hall over the footprint of the Elizabethan Old Hall which previously existed on the site (demolished late 19th century).
Project Results	The archaeological watching brief conducted within the development area (DA) did not identify any evidence of significant archaeological activity. A single feature was identified in the eastern part of the site, at the north-western edge of the excavation limit for the Garage 3 footprint, which comprised a single-skin brick well. This was interpreted as likely being associated with the Old Hall directly to the west of the garage footprint, and likely dates to construction in the 18th to mid-19th century. There were a number of modern deposits, primarily associated with 19th century ground levelling, and modern service installation in the 20th century.
Keywords	Well - POST MEDIEVAL - FISH Thesaurus of Monument Types
Funder	Private individual
HER	Derbyshire County Council - unRev - STANDARD
Person Responsible for work	Alice Short
HER Identifiers	HER Monument No - MDR10489, HER Monument No - MDR10490
Archives	Digital Archive - to be deposited with Archaeology Data Service Archive;