



Area 5, LADG05, Larkhill Camp

Archaeological Watching Brief Report





**AREA 5, LADG05,
LARKHILL CAMP,
LARKHILL,
WILTSHIRE**

ARCHAEOLOGICAL WATCHING BRIEF REPORT

Prepared on behalf of:

Mansell Construction Services Limited
Roman House,
Totton,
Southampton
SO40 3XF

By:

Wessex Archaeology
Portway House
Old Sarum Park
SALISBURY
Wiltshire
SP4 6EB

Reference

74407.02

May 2011

DISCLAIMER

THE MATERIAL CONTAINED IN THIS REPORT WAS DESIGNED AS AN INTEGRAL PART OF A REPORT TO AN INDIVIDUAL CLIENT AND WAS PREPARED SOLELY FOR THE BENEFIT OF THAT CLIENT. THE MATERIAL CONTAINED IN THIS REPORT DOES NOT NECESSARILY STAND ON ITS OWN AND IS NOT INTENDED TO NOR SHOULD IT BE RELIED UPON BY ANY THIRD PARTY. TO THE FULLEST EXTENT PERMITTED BY LAW WESSEX ARCHAEOLOGY WILL NOT BE LIABLE BY REASON OF BREACH OF CONTRACT NEGLIGENCE OR OTHERWISE FOR ANY LOSS OR DAMAGE (WHETHER DIRECT INDIRECT OR CONSEQUENTIAL) OCCASIONED TO ANY PERSON ACTING OR OMITTING TO ACT OR REFRAINING FROM ACTING IN RELIANCE UPON THE MATERIAL CONTAINED IN THIS REPORT ARISING FROM OR CONNECTED WITH ANY ERROR OR OMISSION IN THE MATERIAL CONTAINED IN THE REPORT. LOSS OR DAMAGE AS REFERRED TO ABOVE SHALL BE DEEMED TO INCLUDE, BUT IS NOT LIMITED TO, ANY LOSS OF PROFITS OR ANTICIPATED PROFITS DAMAGE TO REPUTATION OR GOODWILL LOSS OF BUSINESS OR ANTICIPATED BUSINESS DAMAGES COSTS EXPENSES INCURRED OR PAYABLE TO ANY THIRD PARTY (IN ALL CASES WHETHER DIRECT INDIRECT OR CONSEQUENTIAL) OR ANY OTHER DIRECT INDIRECT OR CONSEQUENTIAL LOSS OR DAMAGE

QUALITY ASSURANCE

SITE CODE	74407	ACCESSION CODE		CLIENT CODE	
PLANNING APPLICATION REF.	S/2009/1575	NGR		413590 144885	

VERSION	STATUS*	PREPARED BY	APPROVED BY	APPROVER'S SIGNATURE	DATE	FILE
	I	SDT				X:\PROJECTS\74401\REPORT\ 74407_Larkhill_WB_report_Draft

* I= Internal Draft E= External Draft F= Final

**AREA 5, LADG05,
LARKHILL CAMP
WILTSHIRE**

Archaeological Watching Brief Report

Contents

1	INTRODUCTION	1
	1.2 Site Location, Topography and Geology	1
	1.3 Archaeological Background	1
2	AIMS & OBJECTIVES	2
3	WATCHING BRIEF METHODOLOGY	2
	3.1 Introduction	2
	3.2 Fieldwork	2
	3.3 Health and Safety	3
	3.4 Recording	3
4	WATCHING BRIEF RESULTS	3
	4.1 Introduction	3
	4.2 Stratigraphic Sequence	3
5	ENVIRONMENTAL	4
6	CONCLUSIONS	4
7	ARCHIVE	4
8	REFERENCES	4
	APPENDIX 1: OASIS RECORD	5

List of Figures

- Figure 1** Site location and watching brief area.
Plate 1 Area stripped to construction level. View from the south

**AREA 5, LADG05,
LARKHILL CAMP
WILTSHIRE**

Archaeological Watching Brief Report

Summary

Wessex Archaeology was commissioned by Mansells Construction Services Limited to carry out an archaeological watching brief during development works at Area 5, LADG05, Larkhill Camp, Larkhill, Wiltshire centred on NGR 413590 144885.

The watching brief was required by Wiltshire Council during the machine excavation of a temporary works compound, required to facilitate development following the demolition of the former Sergeant's Mess.

Topsoil and made ground deposits were removed with a toothless ditching bucket under constant archaeological supervision. Due to the shallow nature of the construction level the natural geology was not exposed and no archaeological features or finds were identified.

The archaeological potential of the site remains unclear and should further groundworks be proposed in the area, further archaeological works may be necessary.

**AREA 5, LADG05,
LARKHILL CAMP
WILTSHIRE**

Archaeological Watching Brief Report

Acknowledgements

The project was commissioned by Mansells Construction Services Limited and Wessex Archaeology is grateful to Ryan Thompson in this regard. Thanks are also due to Peter Gale of Mansells Construction Services Limited for facilitating the on-site work.

The watching brief was undertaken by Steve Thompson, who also compiled this report. Report illustrations were prepared by Elizabeth James. The project was managed on behalf of Wessex Archaeology by Sue Farr.

**AREA 5, LADG05,
LARKHILL CAMP
WILTSHIRE****Archaeological Watching Brief Report****1 INTRODUCTION**

- 1.1.1 Wessex Archaeology was commissioned by Mansells Construction Services Limited (the Client) to carry out an archaeological watching brief in order to mitigate the impact on any archaeological remains that may be present during development works at Area 5, LADG05, Larkhill Camp, Larkhill, National Grid Reference (NGR) 413590 144885 (hereafter the 'Site').
- 1.1.2 The watching brief was required during groundworks associated with the construction of a temporary site compound adjacent to the former Sergeant's Mess, within an existing grassed area. The Site is located immediately to the north of the Stonehenge World Heritage Site and the Assistant County Archaeologist at Wiltshire Council had advised an archaeological watching brief should be maintained during the works in order to identify and record any archaeological remains that may be present.
- 1.1.3 A Written Scheme of Investigation (WSI, Wessex Archaeology 2011) was produced before the commencement of any intrusive works. This document detailed the methodologies and standards which would be employed during the watching brief and was submitted to Wiltshire Council for approval.

1.2 Site Location, Topography and Geology

- 1.2.1 The Site, which measures approximately 40m by 25m is located in the north-east corner of Larkhill Camp to the north of the Brackenbury Road. The Site is adjacent to the old Sergeant's Mess (and site of the news Mess) to the west, and is bordered by a football ground to the north and by Brind Road to the east. The Site is centred on NGR 413590 144885 (**Figure 1**).
- 1.2.2 The British Geological Survey map for the area (1:50,000 Solid and Drift Series, sheet 298) indicates that the underlying geology of the Site consists of Upper Chalk.

1.3 Archaeological Background

- 1.3.1 The Site is situated immediately to the north of the Stonehenge World Heritage Site within the extensive and highly significant prehistoric funereal and monumental landscape of the Salisbury Plain, featuring many important sites and find spots of a predominantly Neolithic and Bronze Age date.
- 1.3.2 A number of military features have been identified from aerial photographs in close proximity to the Site by the Royal Commission on Historical Monuments and an earlier watching brief on a new football pitch to the north of the Site confirmed additional military features in the vicinity.

- 1.3.3 Knighton Barrow, a Neolithic long barrow, is recorded approximately 1.5km to the south-west of the Site and approximately 500m to the north, Bronze Age tools have been found. In addition, archaeological evaluation within Larkhill Barracks to the east of the Site identified two adjacent pits and a posthole. Although some truncation by later military activity had occurred, both pits produced worked and burnt flint, animal bone and Bronze Age pottery.
- 1.3.4 An archaeological watching brief undertaken by Wessex Archaeology in February 2009 during the formation of a car park within Alanbrooke Barracks to the south and west of the Site revealed evidence of probable prehistoric settlement in the form of approximately twenty-five post holes. Eight of the post holes formed what may be the remains of a sub-circular post built structure, with an internal diameter of 4.6m. A single sherd of Late Bronze Age flint tempered pottery was retrieved from one of the post holes forming this structure. This structure may be bounded to the east by a north-south aligned fence line formed by five post holes. To the east of the fence line, there were five post holes that may be the remnants of a larger post built structure, but this interpretation is tenuous. A small assemblage of pottery, struck flint, burnt flint and animal bone was recovered from the prehistoric post holes.

2 AIMS & OBJECTIVES

- 2.1.1 The objective of the watching brief was to establish within the constraints of the agreed strategy the presence or absence, location, extent, date, character, condition, and depth of any surviving remains which may be affected by the proposed development.

3 WATCHING BRIEF METHODOLOGY

3.1 Introduction

- 3.1.1 All works undertaken during the watching brief were conducted in accordance with the methods and standards outlined within the Written Scheme of Investigation (WA, 2011), and the requirements of the Client and Wiltshire Council.
- 3.1.2 The WSI conformed with current best practice and the guidance outlined in *Management of Research Projects in the Historic Environment (MoRPHE, English Heritage 2006)* and the Institute for Archaeologists' *Standards and Guidance for Archaeological Watching Briefs (IfA 2008)*.

3.2 Fieldwork

- 3.2.1 Topsoil was machine excavated to a depth of approximately 200-300mm before hardcore was imported across the Site. Following the removal of the temporary compound after the construction of a replacement Sergeants Mess, the Site will be returned to grass.
- 3.2.2 All groundworks were monitored during this programme of archaeological monitoring, with all machine excavation undertaken using a toothless grading bucket under constant archaeological supervision. The depth of the

machine strip was determined by the construction required for the area of hard standing.

- 3.2.3 A full photographic record was maintained during the watching brief using digital cameras equipped with an image sensor of not less than 10 megapixels. Digital images will be subject to managed quality control and curation processes which will embed appropriate metadata within the image and ensure long term accessibility of the image set.

3.3 Health and Safety

- 3.3.1 All work was carried out in accordance with Health and Safety at Work *etc.* act of 1974 and the Management of Health and Safety Regulations of 1992 as well as all other relevant Health and safety legislation, regulations and codes of practice in force at the time the work commenced.
- 3.3.2 In advance of the fieldwork, a Risk Assessment was prepared. All staff involved with the project signed and complied with this document.

3.4 Recording

- 3.4.1 All exposed archaeological deposits were recorded using Wessex Archaeology's *pro forma* recording system.
- 3.4.2 During the fieldwork a full photographic record was maintained and included all intrusive excavation, using a digital camera with a 10 mega pixel image sensor. All digital images will be subjected to managed quality control and curation processes, resulting in appropriately embedded metadata within the image to ensure long term accessibility of the image set.

4 WATCHING BRIEF RESULTS

4.1 Introduction

- 4.1.1 No archaeological features were exposed during the intrusive works, and no artefacts were recovered.

4.2 Stratigraphic Sequence

- 4.2.1 Previous disturbance on the Site was noted in isolated areas; a large soakaway and associated drainage runs, were evident from the man-hole covers located in and around the limits of the excavations.
- 4.2.2 Elsewhere across the Site the stratigraphy was broadly consistent and comprised a 0.10m deep redeposited natural chalk layer (**101**) in isolated pockets in the southern part of the area. Where present this overlay the former topsoil and turf (**102**) layers. Following the removal of **101** and **102** (approximately 0.25m deep in total) a made-ground layer of redeposited natural (**103**) containing modern brick, tile and glass was identified. Excavation ceased at the top of this layer and the natural chalk was not exposed.
- 4.2.3 A small test pit was excavated to investigate the depth of **103**, which was revealed to be over 0.25m.

- 4.2.4 Natural chalk geology was not identified during this programme of works and no archaeological finds or features were observed.

5 ENVIRONMENTAL

- 5.1.1 No features or deposits suitable for environmental sampling were identified during the watching brief.

6 CONCLUSIONS

- 6.1.1 Due to the shallow depth of the machine excavation required and the overlying made-ground deposits, any archaeological remains which may survive on Site will not be impacted upon by the formation of the temporary compound.

- 6.1.2 If any remains are present they will have been partially impacted upon by the excavation of the earlier soakaway and drains, which cut through the basal chalk geology as indicated from the fills of the modern features.

7 ARCHIVE

- 7.1.1 The complete archaeological project archive comprising a single A4 folder will be prepared in accordance with Wessex Archaeology Guidelines for a Archive Preparation and in accordance with *Guidelines for the preparation of excavation archives for long term storage* (UKIC 1990)

- 7.1.2 On completion of the project the archive will be deposited with Salisbury and South Wiltshire Museum An accession number will be obtained from the Curator of Archaeology and the archive will be prepared in accordance with the Museums Archive preparation Standards.

- 7.1.3 The archive is currently held at the offices of Wessex Archaeology in Salisbury under the Project Code **74407**.

8 REFERENCES

Wessex Archaeology (2003): *Project Allenby/Connaught: Archaeological Evaluation: The Salisbury Plain Camps: Bulford and Larkhill*. Document Reference 52279.2 Wessex Archaeology: Salisbury.

Wessex Archaeology (2009): *Alanbrooke Barrack, Larkhill Camp Archaeological Watching Brief Report*. Document Reference 70411.05 Wessex Archaeology: Salisbury.

Wessex Archaeology (2011): *Area 5, LADG05, Larkhill Camp, Larkhill, Wiltshire. Project Design for an Archaeological Watching Brief*. Document Reference 74407.01 Wessex Archaeology: Salisbury.

APPENDIX 1: OASIS RECORD
OASIS ID - wessexar1-111096
Versions

View	Version	Completed by	Email	Date
View 1	1	Sue Farr	s.farr@wessexarch.co.uk	30 September 2011

Completed sections in current version

Details	Location	Creators	Archive	Publications
Yes	Yes	Yes	Yes	1/1

Validated sections in current version

Details	Location	Creators	Archive	Publications
No	No	No	No	0/1

File submission and form progress

Grey literature report submitted?	No	Grey literature report filename/s
Images submitted?	No	Image filename/s
Boundary file submitted?	No	Boundary filename
HER signed off?		NMR signed off?

ADCW Larkhill Project Areas

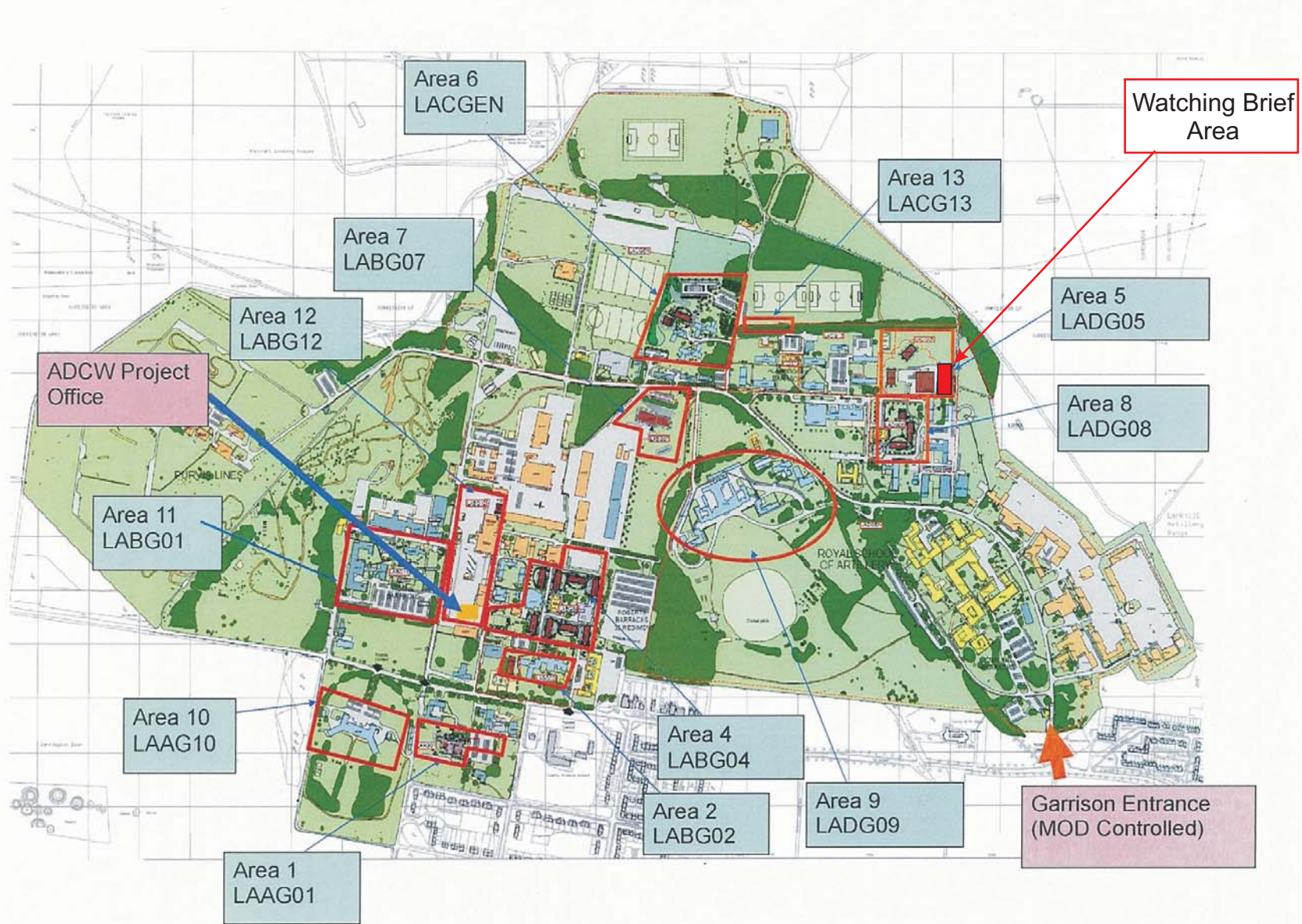

Plan supplied by Client.
This material is for client report only © Wessex Archaeology. No unauthorised reproduction.

Date:	31/05/11	Revision Number:	0
Scale:	N/A	Illustrator:	SEJ
Path:	Y:\PROJECTS\74407\Drawing Office\Report figs\WB\11_05_31\Fig01.cdr		

Site location and watching brief area

Figure 1



Plate 1: Area stripped to construction level. View from the south



WESSEX ARCHAEOLOGY LIMITED.

Registered Head Office: Portway House, Old Sarum Park, Salisbury, Wiltshire SP4 6EB.

Tel: 01722 326867 Fax: 01722 337562 info@wessexarch.co.uk

Regional offices in **Edinburgh, Maidstone and Sheffield**

For more information visit www.wessexarch.co.uk

