



Sutton Place, Sutton Green Nr Guildford, Surrey

Archaeological Evaluation and Walkover Report





**SUTTON PLACE, SUTTON GREEN, NR GUILDFORD,
SURREY**

Archaeological Evaluation and Walkover Report

Prepared for
Gardiner and Theobald LLP
10 South Crescent
London
WC1E 7BD

on behalf of
Sutton Place Property Unit Trust
Sutton Place Estate
Sutton Green
Surrey
GU4 7QN

by:
Wessex Archaeology
Portway House
Old Sarum Park
Salisbury
Wiltshire
SP4 6EB

Report reference: 84660.03

June 2012

DISCLAIMER

The material contained in this report was designed as an integral part of a report to an individual client and was prepared solely for the benefit of that client. The material contained in this report does not necessarily stand on its own and is not intended to nor should it be relied upon by any third party. To the fullest extent permitted by law Wessex Archaeology will not be liable by reason of breach of contract negligence or otherwise for any loss or damage (whether direct indirect or consequential) occasioned to any person acting or omitting to act or refraining from acting in reliance upon the material contained in this report arising from or connected with any error or omission in the material contained in the report. Loss or damage as referred to above shall be deemed to include, but is not limited to, any loss of profits or anticipated profits damage to reputation or goodwill loss of business or anticipated business damages costs expenses incurred or payable to any third party (in all cases whether direct indirect or consequential) or any other direct indirect or consequential loss or damage.

QUALITY ASSURANCE

SITE CODE	84660	ACCESSION CODE		CLIENT CODE	
PLANNING APPLICATION REF.	WO 2011/1070	NGR	NGR 501738, 153804		

VERSION	STATUS*	PREPARED BY	APPROVED BY	APPROVER'S SIGNATURE	DATE	FILE
01	E	SDT	CB			X:\PROJECTS\84660\POST EX\84660_SUTTON PLACE_REPORT.DOC

* I= Internal Draft E= External Draft F= Final

SUTTON PLACE, SUTTON GREEN, NR GUILDFORD, SURREY**Archaeological Evaluation and Walkover Report****Contents**

	Summary	v
	Acknowledgements.....	vi
1	INTRODUCTION	1
	1.1 Project Background	1
	1.2 Site location, topography and geology	1
2	ARCHAEOLOGICAL AND HISTORICAL BACKGROUND	1
	2.1 Introduction.....	1
	2.2 Previous Archaeological Work.....	2
	2.3 Chronological Summary	2
	2.4 Aerial Photographic Review	2
3	AIMS AND METHODS	2
	3.1 Introduction.....	2
	3.2 Archaeological Walkover Survey and Evaluation	2
4	WALKOVER SURVEY METHOD.....	3
5	EVALUATION METHODOLOGY	3
	5.1 Health and Safety	3
	5.2 Service Location	3
	5.3 Fieldwork	3
	5.4 Recording and Survey	3
	5.5 Monitoring.....	4
6	ARCHAEOLOGICAL RESULTS.....	4
	6.1 Introduction.....	4
	6.2 Walkover Survey	4
	6.3 Site-wide Stratigraphy and Geology	4
	6.4 Trial Trench Evaluation Results.....	5
7	ARTEFACTS	5
8	ENVIRONMENTAL EVIDENCE	5
9	CONCLUSIONS	5
10	ARCHIVE.....	6
	10.1 Preparation and Deposition	6
	10.2 Copyright	6
	10.3 Security Copy	6
11	REFERENCES	6
12	APPENDIX 1: TRENCH SUMMARIES	8

SUTTON PLACE, SUTTON GREEN, NR GUILDFORD, SURREY**Archaeological Evaluation and Walkover Report****List of Figures**

- 1 Site Location showing proposed irrigation lake and evaluation trenches.
- 2 Plates 1-6

List of Plates

- 1 Trench 3 from the north showing plough scars (scale 1m, 2m)
 - 2 West facing representative section of Trench 3. (scale 1m)
 - 3 Trench 4 from the east. (scale 1m, 2m)
 - 4 North facing representative section of Trench 4. (scale 1m)
 - 5 Trench 7 from the North east (scale 1m, 2m)
 - 6 South east facing representative section of Trench 7 (scale 1m)
- Front** Machine excavation of Trench 3
Cover
Back Archaeological recording of Trench 5
Cover

SUTTON PLACE, SUTTON GREEN, NR GUILDFORD, SURREY

Archaeological Evaluation and Walkover Report

Summary

Sutton Place Property Unit Trust, through their agent Gardiner and Theobald LLP, commissioned Wessex Archaeology to undertake an archaeological evaluation and walkover survey on land within the Sutton Place Estate, Sutton Green, Surrey centred on NGR 501738, 153804.

The Site lies within the grounds of the early 16th century manor house Sutton Place and adjacent to the floodplain of the River Wey. The Site is the subject of development proposals that comprise construction of an irrigation lake in order to gather additional rainwater to assist in the maintenance of the grounds during dry weather.

The archaeological evaluation comprised the mechanical excavation of nine trenches, each measuring 35m by 1.4m (49 square metres) which were positioned to investigate the potential for buried archaeological remains within the development area. The walkover survey aimed to identify earthworks and evidence of buried remains which could be investigated through trenching.

No earthworks or evidence of buried remains were identified during the walkover survey and no archaeological remains of significance were identified within the trenches.

The underlying geology in the eastern trenches contained material deposited during flood events in the floodplain of the River Wey. It is probable that this difference in the underlying geology accounted for a linear trend observed in the aerial photographs which was interpreted as a natural water channel.

Numerous plough scars of likely post-medieval or modern date were revealed aligned northwest to southeast; parallel to the eastern limit of the Site and a single modern drainage ditch was observed on the same alignment.

A small assemblage of medieval pottery was recovered from the plough soil and this is likely to have been derived from manuring related to possible scattered farmsteads located within the rural landscape close to the line of the Roman road which passes to the south west of the Site.

No archaeological remains of significance will be impacted upon by the proposed development.

The archaeological evaluation was carried out between the 11th and 13th June 2012.

SUTTON PLACE, SUTTON GREEN, NR GUILDFORD, SURREY

Archaeological Evaluation and Walkover Report

Acknowledgements

Wessex Archaeology would like to thank Sutton Place Property Unit Trust who commissioned the archaeological evaluation and walkover survey. Thanks are also due to Gary Jackson Surrey County Council (SCC) Archaeological Officer who monitored the work on behalf of the local authority. The assistance of Kayne Howes of Gardiner and Theobald LLP in facilitating the work is also gratefully acknowledged.

The fieldwork was undertaken by Steve Thompson, Ben Cullen and Tom Burt. This report was compiled by Steve Thompson with the finds assessed by Rachael Seager Smith and the report illustrations prepared by Kenneth Lymer.

The project was managed on behalf of Wessex Archaeology by Caroline Budd.

SUTTON PLACE, SUTTON GREEN, NR GUILDFORD, SURREY

Archaeological Evaluation and Walkover Report

1 INTRODUCTION

1.1 Project Background

1.1.1 Wessex Archaeology (WA) was commissioned by Sutton Place Property Unit Trust (the Client), through their agent Gardiner and Theobald LLP (the Consultant), to undertake an archaeological evaluation and walkover survey on land within the Sutton Place Estate, Sutton Green, Surrey centred on NGR 501738, 153804 (hereafter the Site). The Site (**Figure 1**) is the subject of development proposals that comprise construction of an irrigation lake in order to gather additional rainwater to assist in the maintenance of the grounds during dry weather.

1.1.2 The Site lies within the grounds of the early 16th century manor house Sutton Place and is currently open fields under pasture.

1.1.3 A Project Design (WA 2012) was prepared setting out the methodology employed by Wessex Archaeology to undertake the archaeological works. In format and content it conforms with current best practice and to the guidance outlined in Management of Research Projects in the Historic Environment (English Heritage 2006) and the Institute for Archaeologists' Standards and Guidance for Archaeological Field Evaluation (as amended 2008).

1.2 Site location, topography and geology

1.2.1 The Site is located to the north of Sutton Place House in an area called the Sutton Box Fields, situated three miles to the north east of Guildford. The Site is within an area of flat wet grassland at 26m above Ordnance Datum (maOD), adjacent to the floodplain and bordered by plantation vegetation. The Site covers an area of 1.11 hectares.

1.2.2 The River Wey is located c. 320m to the east of the Site.

1.2.3 The underlying local geology comprises Kempton Park Terrace Gravels overlying London Clay (British Geological Society map sheet 285).

2 ARCHAEOLOGICAL AND HISTORICAL BACKGROUND

2.1 Introduction

2.1.1 As part of the initial pre-planning process, an historic environment assessment of the Site was carried out by Museum of London Archaeology (MOLA). The assessment identified possible, previously unrecorded remains and post-medieval agricultural features of low significance that may be affected by the development proposals (MOLA 2011). The results of this assessment are summarised below (2.2 and 2.3).

2.2 Previous Archaeological Work

- 2.2.1 There have been a limited number of archaeological investigations in the local area of the Site, and those that have been carried out have recorded post-medieval features and negative evidence.

2.3 Chronological Summary

- 2.3.1 The Site and its local area have not been subject to intense development in the past, and as such have had few archaeological investigations carried out. It is potentially a reflection of this, rather than a true indication of the below ground resource, that a limited range of features and associated artefactual material has been recorded.
- 2.3.2 There is no evidence of prehistoric or Roman activity within the area of the Site, although it has been proposed that the Roman road linking Farley Heath and Bagshot runs c.400m south-west of the Site, to the west of Sutton Lake.
- 2.3.3 Throughout the medieval and post-medieval periods the Site lay in the agricultural hinterland of the surrounding small settlements of Sutton and Send, and the larger commercial centres of Guildford and Woking. The adjacent manor house of Sutton Place was built in the early 16th century on a virgin site some distance from an earlier structure which previously fulfilled this function, and historic mapping shows the Site as open fields to the present day.

2.4 Aerial Photographic Review

- 2.4.1 During the preparation of the Project Design (WA 2012) Wessex Archaeology undertook a review of all available aerial photographs of the Site held at the National Monuments Record based in Swindon. Twenty two photographs from collections dating from 1945 to 1994 were studied. No crop/parchmarks indicating the presence of archaeological features were distinguishable from the photographs. However, a linear trend likely to be associated with natural water channels due to the proximity of the River Wey was noted on a north-west to south-east alignment through the centre of the Site (**Figure 1**).

3 AIMS AND METHODS

3.1 Introduction

- 3.1.1 The Project Design (*ibid*) (agreed by the consultant and the Local Authority) was prepared outlining the aims of the trial trench evaluation and walkover survey and the methods by which these aims would be achieved.

3.2 Archaeological Walkover Survey and Evaluation

- 3.2.1 The principal aim of the combined walkover survey and evaluation was to establish the presence or absence of archaeological remains within the proposed development footprint in order to 'gather sufficient information to generate a reliable predictive model of the extent, character, date, state of preservation and depth of burial of important archaeological remains'.

4 WALKOVER SURVEY METHOD

- 4.1.1 A walkover survey of the Site was undertaken prior to the excavation of the evaluation trenches in order to establish the presence of any potential archaeological features (likely to comprise extant earthworks) that may have been present. Identified earthworks were to be mapped using GPS and investigated through the trial trenching following consultation with SCC.

5 EVALUATION METHODOLOGY

5.1 Health and Safety

- 5.1.1 Health and Safety considerations were of paramount importance in conducting all fieldwork and safe working practices override archaeological considerations at all times.
- 5.1.2 All work was carried out in accordance with the Health and Safety at Work etc. Act 1974 and the Management of Health and Safety Regulations 1992, and all other relevant Health and Safety legislation, regulations and codes of practice in force at the time. Wessex Archaeology supplied a copy of their Health and Safety Policy and a Risk Assessment to the Client before the commencement of any fieldwork.

5.2 Service Location

- 5.2.1 All evaluation trench locations were scanned before and during excavation with a Cable Avoidance Tool (CAT) in order to verify the absence of any live underground services.

5.3 Fieldwork

- 5.3.1 All works were undertaken in accordance with the standards set out within the Specification.
- 5.3.2 All works were conducted in compliance with the standards outlined in the Institute for Archaeologist's *Standard and Guidance for Archaeological Evaluations* (IfA 2008), excepting where they are superseded by statements made below.
- 5.3.3 A total of nine trenches were proposed each measuring 30m by 1.6m (48 square metres) however as a 1.4m wide bucket was used the trenches were extended to 35m thus each trench measured 49 square metres.
- 5.3.4 The trenches were machine-excavated under constant archaeological supervision using a 360 degree tracked mechanical excavator fitted with a toothless grading bucket. Machine excavation proceeded until the top or natural deposits were encountered.

5.4 Recording and Survey

- 5.4.1 Wessex Archaeology allocated a unique site code (84660) for all aspects of the project archive. All exposed deposits were recorded using Wessex Archaeology's pro forma recording system.

- 5.4.2 A complete drawn record of excavated archaeological features and deposits was compiled. This includes both plans and sections, drawn to appropriate scales (1:20 for plans, 1:10 for sections), and with reference to a site grid tied to the Ordnance Survey National Grid. The Ordnance Datum (OD) height of all principal features and levels has been calculated and plans/sections have been annotated with OD heights.
- 5.4.3 A full photographic record was maintained using black and white negatives (on 35 mm film) and digital photography. The photographic record illustrates both the detail and the general context of the principal features, finds excavated, and the Site as a whole. The digital photographic record used a digital camera equipped with an image sensor of not less than 10 megapixels. Digital images will be subject to managed quality control and curation processes which will embed appropriate metadata within the image and ensure long term accessibility of the image set.
- 5.4.4 All trenches were surveyed using a Leica GNSS survey system including heights above OS datum (Newlyn). The electronic survey record were periodically downloaded and retained within the site archive, with co-ordinate and/or datum information transposed onto the appropriate paper archives.

5.5 Monitoring

- 5.5.1 During the course of the evaluation the work was monitored by Surrey County Council's Archaeological Officer Gary Jackson.

6 ARCHAEOLOGICAL RESULTS

6.1 Introduction

- 6.1.1 The following sections provide a summary of the information held in the Site archive. Details of individually excavated contexts and features are retained in the Site archive and a detailed tabulated version of these can be found in **Appendix 1**. A range of photographs which illustrate the excavated trial trenches is shown on **Plates 1 to 6**.
- 6.1.2 The following Results Section should be read in conjunction with **Appendix 1**.

6.2 Walkover Survey

- 6.2.1 No earthworks or evidence of buried archaeological remains were identified during the walkover of the area of proposed development. The land gently slopes downhill from west to east, with the location of the proposed irrigation lake on the flat area of the floodplain of the River Wey. As no earthworks were identified the trenches were located as agreed in the Project Design.

6.3 Site-wide Stratigraphy and Geology

- 6.3.1 The stratigraphy of deposits was uniform across the Site with between 0.24m and 0.51m of current turf and plough soil observed and recorded as **101, 201, 301, 401, 501, 601, 701, 801, and 901**. A small assemblage of medieval pottery was recovered from the plough soil of **Trenches 4, 7, and 9**. In **Trenches 1 and 2** a clear subsoil deposit was observed and recorded as **102 and 202**. These deposits sealed the natural geology.

6.3.2 The underlying geology was quite varied however it was clear that the western most trenches were predominately sandy loam with abundant gravels and solid outcrops of gravel; the top of the Kempton Park Terrace Gravels. These gravels contained numerous iron panning and staining. The eastern most trenches were predominately sandy loam with occasional to abundant gravels, representing material deposited during flood events in the floodplain of the River Wey. It is probable that this difference in the underlying geology accounted for the linear trend observed in the aerial photographs which was interpreted as a natural water channel (**Figure 1**). However, no clear feature extents could be defined due to the nature of the channel formation processes.

6.4 Trial Trench Evaluation Results

6.4.1 No archaeological features of significance were observed within the trenches. Numerous plough scars of post-medieval or modern date were revealed aligned northwest to southeast and running with the long axis of the field; parallel to the eastern limit of the Site.

6.4.2 A single modern drainage ditch was observed in Trench 8, this also ran on a northwest to southeast alignment.

7 ARTEFACTS

7.1.1 The only artefacts recovered comprise four pieces of pottery, probably of medieval (12th and 14th centuries AD) date. All four are in coarse, sand-tempered fabrics and were found in ploughsoil contexts in Trenches 4, 7 and 9. As befitting material from the ploughsoil, all are very battered and abraded. The two pieces from Trench 9 appear to be from the slightly sagging base of a jar; the other two are undiagnostic plain body sherds. Sand-tempered pottery was made at a variety of centres in Surrey (eg. at Ashstead, Farnham and the Alice Holt forest, Kingston-upon-Thames, Limpsfield, Abinger and Reigate), supplying both local and London markets, but in the absence of diagnostic forms – or even their original surfaces - these pieces cannot be assigned to particular kilns.

8 ENVIRONMENTAL EVIDENCE

8.1.1 No archaeological features or deposits suitable for environmental sampling were identified during the course of the fieldwork.

9 CONCLUSIONS

9.1.1 The evaluation within Sutton Box Fields within the estate of Sutton Place House was successful in confirming the low potential for archaeological features of significance to be present within the area of the proposed development. The recovery of a small assemblage of medieval pottery from the plough soil is not unusual in this type of rural context. The Site is located some 400m north east from the projected line of a Roman road which passes to the west of Sutton Lake and is potentially located within a rural landscape of scattered farmsteads and field systems (MOLA 2011 6-7)

9.1.2 No archaeological remains will be impacted upon by the proposed development.

10 ARCHIVE

10.1 Preparation and Deposition

- 10.1.1 The project archive will be prepared in accordance with the guidelines outline in Appendix 3 of Management of Archaeological Projects (English Heritage 1991) and in accordance with the UKIC Guidelines for the preparation of excavation archives for long term storage (Walker 1990).
- 10.1.2 The archive is currently held at the offices of Wessex Archaeology in Salisbury under the WA project code **84660**. The completed archive, which will include all paperwork, will on the completion of the all field work and post excavation reporting ultimately, be deposited for permanent storage with the Woking Museum and Arts & Crafts Centre.
- 10.1.3 Digital images will be curated under arrangements agreed between Wessex Archaeology and the Archaeology Data Service (University of York) as part of the submission of an OASIS record for the project.

10.2 Copyright

- 10.2.1 The full copyright of the written/illustrative archive relating to the Site will be retained by Wessex Archaeology Ltd under the Copyright, Designs and Patents Act 1988 with all rights reserved. The Museum, however, will be granted an exclusive licence for the use of the archive for educational purposes including academic research, providing that such use shall be non-profit making, and conforms to the Copyright and Related Rights regulations 2003.

10.3 Security Copy

- 10.3.1 In line with current best practice, on completion of the project a security copy of the paper records will be prepared, in the form of microfilm. The master jackets and one diazo copy of the microfilm will be submitted to the National Monuments Record Centre (Swindon); a second diazo copy will be deposited with the paper records at the Museum, and a third diazo copy will be retained by Wessex Archaeology.

11 REFERENCES

- English Heritage, 2006, *Management of Research Projects in the Historic Environment*
- Institute of Field Archaeologists [IfA], 2008 (revised), *Standards and Guidance for Archaeological Excavations*
- Institute for Archaeologists, *Code of Practice and the Code of Approved Practice for the Regulation of Contractual Arrangements in Field Archaeology*
- MOLA, 2011, Sutton Place, Sutton Green, Near Guildford, Surrey, GU4 7QN: An historic environment assessment
- Walker, K., 1990, *Guidelines for the Preparation of Excavation Archives for Long-Term Storage*, UKIC Archaeology Section

Wessex Archaeology, 2011, Sutton Place, Sutton Green, Near Guildford Surrey. Written Scheme of Investigation: Project Design for an Archaeological Evaluation and Walkover Survey. Report Reference: 84660.01

12 APPENDIX 1: TRENCH SUMMARIES

 Bgl: below ground level
 aOD: above Ordnance Datum

Trench 1	Dimensions :	33.12m by 1.40m by 0.47m	Ground surface level:	26.25m aOD
	Coordinates (NGR):	501689.87, 153854.26 501722.66, 153853.48		
Context	Category	Description	Depth (bgl)	
101	Layer	Plough soil: Dark brown sandy loam with frequent poorly sorted gravel inclusions. Friable and homogenous.	0-0.24m	
102	Layer	Subsoil (or interface with 103): Mid orangish brown silty sand with frequent sub-rounded pieces of gravel sized <0.03m included through out. Friable and homogenous. Darkens to NW end of trench.	0.24-0.42m	
103	Natural	Mid orange gravelly sand with frequent sub-rounded pieces of gravel included.	0.42m+	

Trench 2	Dimensions :	34.70m by 1.40m by 0.41m	Ground surface level:	26.29m aOD
	Coordinates (NGR):	501677.51, 153819.03 501702.64, 153842.00		
Context	Category	Description	Depth (bgl)	
201	Layer	Plough soil: Dark brown sandy loam with moderately frequent sub-rounded pieces of <0.04m sized gravel included.	0-0.34m	
202	Layer	Subsoil/interface with (203): Dark greyish brown gravelly sand with frequent <0.03m gravel pieces included.	0.34-0.41m	
203	Natural	Mottled light yellow/brown gravelly sand with frequent <0,04m sub-rounded gravel inclusions.	0.41m+	

Trench 3	Dimensions :	33.12m by 1.40m by 0.43m	Ground surface level:	26.41m aOD
	Coordinates (NGR):	501739.06, 153852.16 501746.89, 153820.43		
Context	Category	Description	Depth (bgl)	
301	Layer	Plough soil: Mid brown sandy loam with frequent pieces of gravel <0.03m in size included throughout.	0-0.34m	
302	Natural	Mid orangish brown gravelly sand with frequent inclusions of <0.04m pieces of gravel throughout. Lightens to yellowish brown with frequent poorly sorted iron stain inclusions towards the South end of the trench. Softly compacted and heterogeneous.	0.34m+	
		N.B. Plough scars evident running NW-SE across N end of trench and sporadically towards the southern end.		

Trench 4	Dimensions :	34.90m by 1.40m by 0.39m	Ground surface level:	26.46m aOD
	Coordinates (NGR):	501728.59, 153825.60 501695.16153819.04		
Context	Category	Description	Depth (bgl)	
401	Layer	Plough soil: Mid brown sandy loam. Friable and homogenous with frequent small to medium sized >0.10m pieces of gravel and sub-rounded stones included. Single sherd of medieval pottery.	0-0.32m	
402	Natural	Mottled orange/brown gravelly sand with frequent inclusions of <0.10m sized pieces of gravel. Homogenous and softly compacted. Changes to a light greyish yellow sand to the western end of the trench.	0.32m+	

Trench 5	Dimensions :	33.20m by 1.40m by 0.40m	Ground surface level:	26.47m aOD
	Coordinates (NGR):	501710.22, 153795.29 501677.64, 153795.06		
Context	Category	Description	Depth (bgl)	
501	Layer	Plough soil: Dark brown sandy loam with frequent pieces of gravel<0.08m included throughout. Friable and homogenous.	0-0.40m	
502	Void	Void	Void	
503	Natural	Dark blackish brown silty sand with occasional yellowish brown mottles and manganese patches.	0.38m+	
504	Natural	Light yellowish brown gravelly sand with frequent <0.08m pieces of gravel included.	0.32m+	
505	Natural	Mid orange brown gravelly sand with frequent gravel pieces included <0.04m in size	0.32m+	

Trench 6	Dimensions :	33.49m by 1.40m by 0.41m	Ground surface level:	26.54m aOD
	Coordinates (NGR):	501728.17, 153794.76 501758.05, 153809.88		
Context	Category	Description	Depth (bgl)	
601	Layer	Plough soil: Mid brown sandy loam with frequent <0.05m pieces of gravel included throughout. Friable and homogenous.	0-0.38m	
602	Natural	Mid orangish brown gravelly sand with frequent pieces of <0.05m sized gravel included throughout. Softly compacted and homogenous. Evidence of plough scarring in the middle of the trench.	0.38m+	

Trench 7	Dimensions :	34.90m by 1.40m by 0.40m	Ground surface level:	26.55m aOD
	Coordinates (NGR):	501785.37, 153812.09 501760.05, 153789.38		
Context	Category	Description	Depth (bgl)	
701	Layer	Plough soil: Mid brown sandy loam with frequent inclusions of <0.05m gravel included throughout. Two sherds of medieval pottery.	0-0.40m	
702	Natural	Mid orangish brown gravelly sand with moderately frequent inclusions of <0.05m sized pieces of gravel. Lightens to a yellowish brown to the SW end of the trench with occasional gravel patches. N.B. Plough scars evident in the NE end of the trench. Running NE-SW on the same alignment as those in Trench 3.	0.40m+	

Trench 8	Dimensions :	34.72m by 1.40m by 0.42m	Ground surface level:	26.69maOD
	Coordinates (NGR):	501738.37, 153750.00 501729.30, 153782.83		
Context	Category	Description	Depth (bgl)	
801	Layer	Plough soil: Dark brown sandy loam with moderately frequent <0.08m sized pieces of gravel included throughout.	0-0.42m	
802	Natural	Dark orangish brown silty sand with patches of iron panning towards the northern end of the trench and frequent inclusions of <0.05m sized pieces of gravel throughout. Changes to a mid orangish brown gravelly sand at the northern end of the trench in conjunction with the concentration of iron panning.	0.38m+	

Trench 9	Dimensions :	34.10m by 1.40m by 0.51m	Ground surface level:	26.60m aOD
	Coordinates (NGR):	501767.02, 153773.93 501800.55, 153773.74		
Context	Category	Description	Depth (bgl)	
901	Layer	Plough soil: Mid brownish sandy loam with moderately frequent inclusions of <0.02m sized pieces of gravel throughout. Friable and homogenous. Two sherds of medieval pottery found.	0-0.51m	
902	Natural	Mid orangish brown gravelly sand with moderately frequent inclusions of <0.02m sized pieces of gravel throughout. Changes to a mottled mid yellowish brown sand with similar inclusions but additional frequent iron stain flecking throughout towards the North end of the trench. Softly compacted and relatively homogenous. Plough scars in middle of trench aligned NW-SE.	0.40m+	

OASIS DATA COLLECTION FORM: England

[List of Projects](#) | [Manage Projects](#) | [Search Projects](#) | [New project](#) | [Change your details](#) | [HER coverage](#) | [Change country](#) | [Log out](#)

Printable version

OASIS ID: wessexar1-128835

Project details

Project name	SUTTON PLACE IRRIGATION LAKE, SURREY
Short description of the project	Sutton Place Property Unit Trust, through their agent Gardiner and Theobald LLP, commissioned Wessex Archaeology to undertake an archaeological evaluation and walkover survey on land within the Sutton Place Estate, Sutton Green, Surrey centred on NGR 501738, 153804. The archaeological evaluation comprised the mechanical excavation of nine trenches, each measuring 35m by 1.4m, which were positioned to investigate the potential for buried archaeological remains within the development area. The walkover survey aimed to identify earthworks and evidence of buried remains which could be investigated through trenching. No earthworks or evidence of buried remains were identified during the walkover survey and no archaeological remains of significance were identified within the trenches. The archaeological evaluation was carried out between the 11th and 13th June 2012
Project dates	Start: 07-03-2012 End: 21-06-2012
Previous/future work	No / No
Any associated project reference codes	84660 - Contracting Unit No.
Type of project	Field evaluation
Current Land use	Cultivated Land 1 - Minimal cultivation
Monument type	NONE None
Significant Finds	POTTERY Medieval

Project location

Country	England
Site location	SURREY WOKING WOKING SUTTON PLACE IRRIGATION LAKE, SURREY
Postcode	GU4 7QN
Study area	1.00 Hectares
Site coordinates	TQ 017 538 51 0 51 16 25 N 000 32 30 W Point

Project creators

Name of Organisation	Wessex Archaeology
Project brief originator	Consultant

Project design originator	Wessex Archaeology
Project director/manager	Caroline Budd
Project supervisor	S Thompson
Type of sponsor/funding body	Sutton Place Property Unit Trust

Project archives

Physical Archive Exists?	No
Digital Archive recipient	Woking Museum and Arts and Crafts Centre
Digital Contents	"other"
Digital Media available	"Images raster / digital photography","Survey","Text"
Paper Archive recipient	Woking Museum and Arts and Crafts Centre
Paper Contents	"other"
Paper Media available	"Context sheet","Drawing","Plan","Report","Section"

Project bibliography 1

Publication type	Grey literature (unpublished document/manuscript)
Title	SUTTON PLACE, SUTTON GREEN, NR GUILDFORD, SURREY Archaeological Evaluation and Walkover Report
Author(s)/Editor(s)	Thompson, S.
Other bibliographic details	84660
Date	2012
Issuer or publisher	Wessex Archaeology
Place of issue or publication	Salisbury
Description	Grey literature client report
Entered by	J. Sulikowska (j.sulikowska@wessexarch.co.uk)
Entered on	21 June 2012

OASIS:

Please e-mail [English Heritage](mailto:EnglishHeritage@EnglishHeritage.org.uk) for OASIS help and advice

© ADS 1996-2012 Created by [Jo Gilham](#) and [Jen Mitcham](#), email EnglishHeritage@EnglishHeritage.org.uk Last modified Wednesday 9 May 2012

Cite only: <http://www.oasis.ac.uk/form/print.cfm?ID=128835> for this page

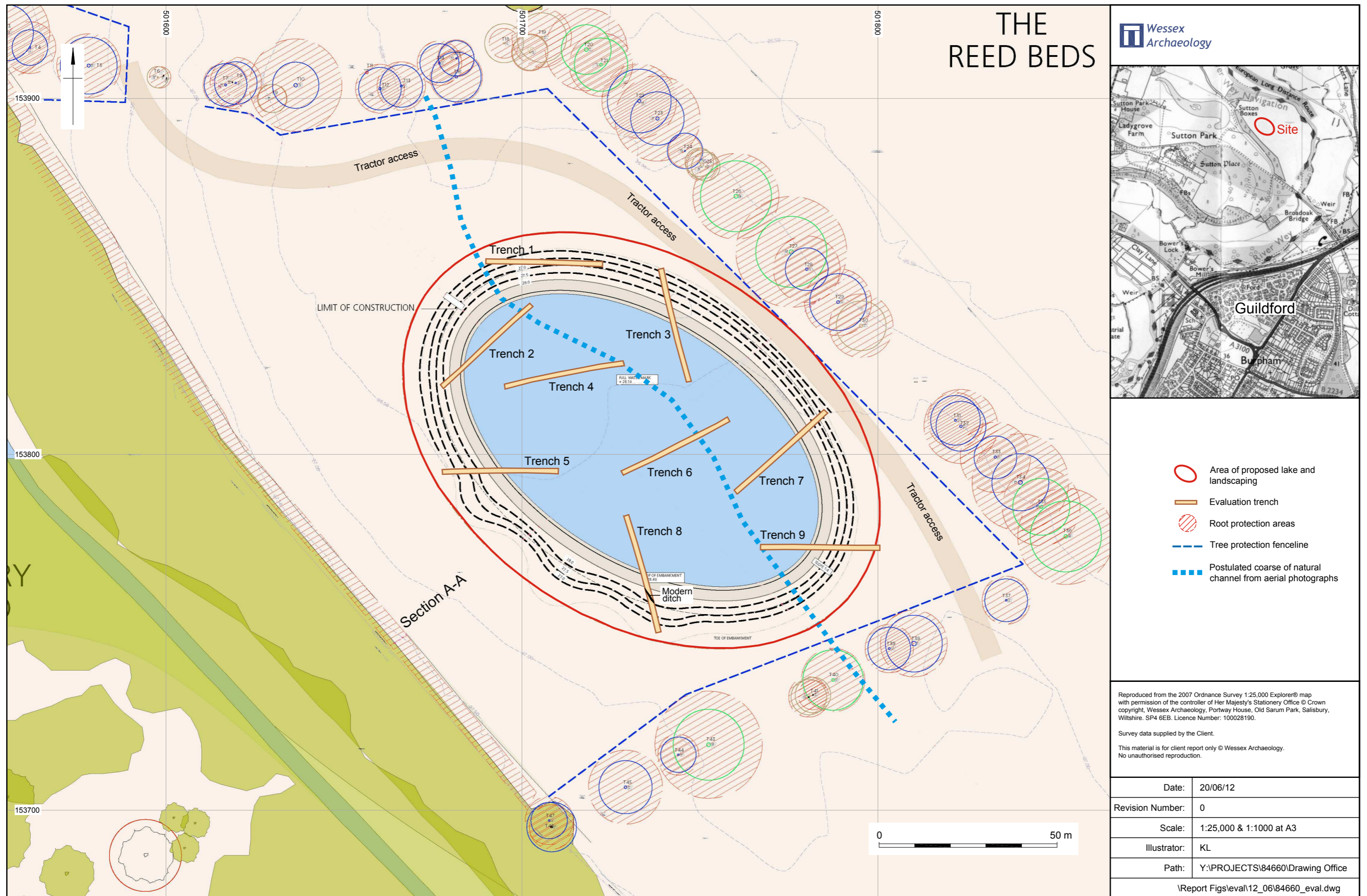

Site location plan showing proposed irrigation lake and evaluation trenches

Figure 1



Plate 1: Trench 3 from the north showing plough scars (scale 1m, 2m)



Plate 2: West facing representative section of Trench 3 (scale 1m)



Plate 3: Trench 4 from the east (scale 1m, 2m)



Plate 4: North facing representative section of Trench 4 (scale 1m)



Plate 5: Trench 7 from the north-east



Plate 6: South-east facing representative section of Trench 7 (scale 1m)



WESSEX ARCHAEOLOGY LIMITED.

Registered Head Office: Portway House, Old Sarum Park, Salisbury, Wiltshire SP4 6EB.

Tel: 01722 326867 Fax: 01722 337562 info@wessexarch.co.uk

Regional offices in **Edinburgh, Rochester and Sheffield**

For more information visit www.wessexarch.co.uk

