



making sense of heritage

# McLaren Production Centre Woking, Surrey

Archaeological Watching Brief Report



Ref: 72743.01  
July 2014



**McLaren Production Centre  
Woking, Surrey**

**Archaeological Watching Brief Report**

**Prepared for:**

Terence O'Rourke Ltd  
Everdene House  
Deansleigh Road  
Bournemouth  
BH7 7DU

**On behalf of:**

McLaren Group Ltd  
McLaren Technology Centre  
Chertsey Road  
Woking  
GU21 4YH

**Prepared by:**

Wessex Archaeology  
Portway House  
Old Sarum Park  
Salisbury  
Wiltshire  
SP4 6EB

[www.wessexarch.co.uk](http://www.wessexarch.co.uk)



**June 2014**

**Report Ref: 72743.03**



## Quality Assurance

<b>Project Code</b>	72743	<b>Accession Code</b>		<b>Client Ref.</b>	
<b>Planning Application Ref.</b>		<b>Ordnance Survey (OS) national grid reference (NGR)</b>	501350, 161480		

Version	Status*	Prepared by	Checked and Approved By	Approver's Signature	Date
v01	I	SF	GSC		08/07/14
File: \\projectserver\wessex\Projects\72743\_Reports					
v02	E	SF	GSC		17/07/14
File: \\projectserver\wessex\Projects\72743\_Reports					
File:					
File:					
File:					

\* I = Internal Draft; E = External Draft; F = Final

## DISCLAIMER

THE MATERIAL CONTAINED IN THIS REPORT WAS DESIGNED AS AN INTEGRAL PART OF A REPORT TO AN INDIVIDUAL CLIENT AND WAS PREPARED SOLELY FOR THE BENEFIT OF THAT CLIENT. THE MATERIAL CONTAINED IN THIS REPORT DOES NOT NECESSARILY STAND ON ITS OWN AND IS NOT INTENDED TO NOR SHOULD IT BE RELIED UPON BY ANY THIRD PARTY. TO THE FULLEST EXTENT PERMITTED BY LAW WESSEX ARCHAEOLOGY WILL NOT BE LIABLE BY REASON OF BREACH OF CONTRACT NEGLIGENCE OR OTHERWISE FOR ANY LOSS OR DAMAGE (WHETHER DIRECT INDIRECT OR CONSEQUENTIAL) OCCASIONED TO ANY PERSON ACTING OR OMITTING TO ACT OR REFRAINING FROM ACTING IN RELIANCE UPON THE MATERIAL CONTAINED IN THIS REPORT ARISING FROM OR CONNECTED WITH ANY ERROR OR OMISSION IN THE MATERIAL CONTAINED IN THE REPORT. LOSS OR DAMAGE AS REFERRED TO ABOVE SHALL BE DEEMED TO INCLUDE, BUT IS NOT LIMITED TO, ANY LOSS OF PROFITS OR ANTICIPATED PROFITS DAMAGE TO REPUTATION OR GOODWILL LOSS OF BUSINESS OR ANTICIPATED BUSINESS DAMAGES COSTS EXPENSES INCURRED OR PAYABLE TO ANY THIRD PARTY (IN ALL CASES WHETHER DIRECT INDIRECT OR CONSEQUENTIAL) OR ANY OTHER DIRECT INDIRECT OR CONSEQUENTIAL LOSS OR DAMAGE.



# McLaren Production Centre Woking, Surrey

## Archaeological Watching Brief Report

### Contents

Summary.....	iii
Acknowledgements.....	iv
<b>1 INTRODUCTION.....</b>	<b>1</b>
1.1 Project background .....	1
1.2 The Site.....	1
<b>2 ARCHAEOLOGICAL BACKGROUND .....</b>	<b>2</b>
2.1 Introduction .....	2
<b>3 METHODOLOGY.....</b>	<b>2</b>
3.1 Aims and objectives .....	2
3.2 Fieldwork methodology .....	2
<b>4 ARCHAEOLOGICAL RESULTS .....</b>	<b>3</b>
4.1 Natural deposits and soil sequences .....	3
<b>5 ARTEFACTUAL EVIDENCE .....</b>	<b>3</b>
<b>6 ENVIRONMENTAL EVIDENCE .....</b>	<b>3</b>
<b>7 CONCLUSION.....</b>	<b>3</b>
<b>8 STORAGE AND CURATION.....</b>	<b>4</b>
8.1 Museum .....	4
8.2 Archive .....	4
8.3 Discard policy.....	4
8.4 Copyright.....	4
8.5 Security Copy.....	4
<b>9 REFERENCES.....</b>	<b>4</b>
<b>APPENDIX 1 – TEST PIT TABLES .....</b>	<b>6</b>
<b>APPENDIX 2 – OASIS FORM.....</b>	<b>9</b>



**Figures**

Figure 1: Site and test pit location plan

**Plates**

Plate 1: South facing representative section of Test Pit 6

Plate 2: North-west facing representative section of Test Pit 10



# McLaren Production Centre Woking, Surrey

## Archaeological Watching Brief Report

### Summary

Wessex Archaeology was commissioned by McLaren Group Ltd through their agent Terence O'Rourke Ltd to undertake an archaeological watching brief on land at the McLaren Technology Centre, Woking, Surrey. The archaeological watching brief comprised of monitoring the excavation of 10 geotechnical test pits which were located on the proposed building development. The work was undertaken the 23<sup>rd</sup> to 24<sup>th</sup> June 2014.

No evidence of any archaeological features were found during the watching brief however test pits 8, 9 and 10 did display signs of modern disturbance which may have been associated with the landscaping of the grounds of the McLaren Production Centre (MPC) building.



# McLaren Production Centre Woking, Surrey

## Archaeological Watching Brief Report

### Acknowledgements

Wessex Archaeology would like to thank John Trehy of Terence O'Rourke Ltd for commissioning the work on behalf of McLaren Group Ltd. The help and assistance of Tom (Hydrock) was greatly appreciated during the ground works was greatly appreciated. We would also like to thank Gary Jackson and Alex Eggington of the Surrey County Council Heritage Conservation Team for their assistance throughout the project.

The field work was undertaken by Simon Flaherty, who also wrote this report. The report illustrations were drawn by Linda Coleman and Nancy Dixon. The project was managed on behalf of Wessex Archaeology by Gareth Chaffey.



# McLaren Production Centre Woking, Surrey

## Archaeological Watching Report

### 1 INTRODUCTION

#### 1.1 Project background

- 1.1.1 Wessex Archaeology (WA) were commissioned by McLaren Group Ltd (the Client), through their agent Terence O'Rourke Ltd (the Consultant), to undertake an archaeological watching brief on land at the McLaren Technology Centre, Woking, Surrey, centred on National Grid Reference (NGR) 501350, 161480 (hereafter 'the Site') (**Figure 1**).
- 1.1.2 The Site is subject of development proposals that comprise construction of two further buildings to the north and west of the current McLaren Production Centre (MPC) building. The buildings are understood to comprise a wind tunnel and a special operations building. Each building is multi storey and contains at least one basement level.
- 1.1.3 The watching brief was required in order to provide a means of preservation by record of any archaeological remains which may exist in the area of archaeological potential, as identified through a programme of trial trench evaluation carried out on the Site (WA 2010a).
- 1.1.4 A Written Scheme of Investigation (WSI) for the watching brief (WA 2014) was prepared by Wessex Archaeology and submitted to, and approved by, the Heritage Conservation Team, of Surrey County Council, prior to the start of the fieldwork. The watching brief was undertaken in accordance with the Institute for *Archaeologist's Guidance for Archaeological Watching Brief* (as amended in 2008).
- 1.1.5 The fieldwork was undertaken from 23rd to 24th June 2014

#### 1.2 The Site

- 1.2.1 The Site is located on the gently undulating ground, which generally slopes down from north to south, from a high point in the north west of 32m above Ordnance Datum (aOD) to 23m aOD at the southern edge of the Site.
- 1.2.2 The Site is located to the south of the McLaren Technology Centre (MTC), and covers an area of approximately 34.59 hectares. The footprint of the proposed MPC development comprises an area of 3.8 ha situated to the south-east of the overall Site (**Figure 1**).
- 1.2.3 Immediately to the south of the McLaren Technology Centre the Site is currently covered in soft landscaping, while the land to the west is utilised as arable fields. A former landfill site lies towards and within the southern boundary of the Site.
- 1.2.4 The underlying local geology is listed as the Bagshot Beds and Claygate Beds with alluvium possibly present above these strata (Geological Survey of Great Britain 1:50,000 map sheet 269).





## 2 ARCHAEOLOGICAL BACKGROUND

### 2.1 Introduction

- 2.1.1 A detailed archaeological and historical background for the site has been compiled and presented previously (WA 2014), and as such will not be repeated here.
- 2.1.2 In summary, Surrey Council Archaeological Unit recorded evidence from the Mesolithic or Early Neolithic through to the post-medieval periods within the area of the MPC (SCAU 1997, 1998a and 1998b).
- 2.1.3 Investigations by Wessex Archaeology (WA 2009, 2010a & 2010b) identified the presence of two Iron Age gullies forming a track or drove way and a pit that contained a single sherd of Iron Age pottery. The low number of features and paucity of dating suggests these features were on the periphery of any archaeological focus.
- 2.1.4 The eastern area of the Site was shown to have been extensively landscaped resulting in a severe impact on any surviving archaeological remains. A former land fill was located within the southern boundary of the Site; in this area there were also several layers of modern made ground.

## 3 METHODOLOGY

### 3.1 Aims and objectives

- 3.1.1 The aims of the watching brief were:
- *to determine the presence or absence of archaeological remains, and should remains be present, to ensure their preservation by record to the highest possible standard;*
  - *to confirm the approximate date or date range of the remains, by means of artefactual or other evidence;*
  - *to determine or confirm the approximate extent of any remains;*
  - *to determine the condition and state of preservation of the remains;*
  - *to determine the degree of complexity of the horizontal and/or vertical stratigraphy present; and*
  - *to prepare a report on the results of the watching brief.*

### 3.2 Fieldwork methodology

- 3.2.1 The watching brief was conducted according to the agreed WSI (WA 2014) and comprised the excavation of ten geotechnical trial pits each measuring approx 3m x 0.6m in size (see **Appendix 1** for details). The location of these trenches has been indicated in **Figure 1**. All proposed test pits were excavated.
- 3.2.2 Prior to machining, the test pit locations were scanned by Hydrock using a cable tracing device. The test pits were excavated under constant archaeological supervision using a backhoe mechanical excavator employing a toothless ditching bucket. The turf, topsoil and subsoil were stored separately to facilitate appropriate backfilling and consolidation of each trench following the completion of recording.



- 3.2.3 All potential features and deposits of possible archaeological origin were partially excavated to ascertain their nature and function and were fully recorded using WA's *pro forma* record sheets. All deposits were assigned a unique number.
- 3.2.4 A full photographic record was maintained using colour slide, black and white and digital photography. Digital photography adhered to the National Monument Records Digital Imaging Guidelines. A full graphic record was maintained. The site drawings were drawn at an appropriate scale, typically 1:10 for sections and 1:20 for plans.
- 3.2.5 Site survey was carried out using a Leica Viva series GNSS unit using the OS National GPS Network through an RTK network with a 3D accuracy of 30mm or below. All survey data was recorded using the OSGB36 British National Grid coordinate system.

## 4 ARCHAEOLOGICAL RESULTS

### 4.1 Natural deposits and soil sequences

- 4.1.1 The deposit sequence varied slightly between **Test Pits 1 to 7**. The topsoil consisted of a mid brownish grey silty sand and varied in thickness between 0.23m to 0.37m. **Test Pits 2 and 3** contained a subsoil that was between 0.12m and 0.2m thick respectively and consisted of a mid brown silty clay sand. The natural geology was encountered at a depth of 0.23m to 0.53m and consisted of a light yellow brown clay sand.
- 4.1.2 **Test Pits 8, 9 and 10** were the subject of disturbance likely to be associated with the construction of the McLaren Production Centre and subsequent phases of landscaping. All had a layer of topsoil as described above between 0.19m and 0.27m in thickness. This overlies a light yellow brown clay sand redeposited natural layer varying in thickness between 0.08m and 0.28m. **Test Pit 8** contained a mid grey brown silty sand layer of redeposited topsoil that contained Ceramic Building Material (C.B.M) between 0.29m-0.40m. This overlaid the natural. **Test Pit 9** contained a made ground layer that started at 0.58m below ground level (bgl) and continued to the full depth of the trench at 4.1m (bgl). Natural was encountered at a depth of 1.10m in the western corner of the trench. **Test Pit 10** contained made ground from a depth of 0.35m-1.8m. Below this there appeared to be natural deposit **1004** however at a depth of 2.5m-2.8m a mid grey brown silty sand was encountered. Accurate recording of the deposit was not possible due to its depth within the test pit. It may represent a lens within the natural geology. From 2.8m a layer **1006** identical to **1004** was encountered.

## 5 ARTEFACTUAL EVIDENCE

- 5.1.1 A single piece of burnt flint was recovered from the top soil of **Test Pit 4**, although not definitively prehistoric it may suggest a low level of prehistoric activity around the site

## 6 ENVIRONMENTAL EVIDENCE

- 6.1.1 No material suitable for environmental analysis was present within the monitored areas.

## 7 CONCLUSION

- 7.1.1 No archaeological remains were encountered during the watching brief. The area around **Trenches 1 to 7** appear to be undisturbed by modern construction activity. However **Trenches 8, 9 and 10** located on the southern edge of the site show signs of modern disturbance most likely due to the construction of the McLaren Production Centre located to the south of the Site.



## 8 STORAGE AND CURATION

### 8.1 Museum

8.1.1 It is recommended that the project archive resulting from the excavation be deposited with **Woking Museum and Arts and Crafts Centre**. The Museum has agreed in principle to accept the project archive on completion of the project, under the accession code **72743**. Deposition of any finds with the Museum will only be carried out with the full agreement of the landowner.

### 8.2 Archive

8.2.1 The complete site archive, which will include paper records, photographic records, graphics, artefacts, ecofacts and digital data, will be prepared following the standard conditions for the acceptance of excavated archaeological material by **Woking Museum and Arts and Crafts Centre**, and in general following nationally recommended guidelines (SMA 1995; IfA 2009; Brown 2011; ADS 2013). Details of the archaeological watching brief will also be entered into the online "OASIS" database maintained by the Archaeological Data Service (ADS). A copy of the OASIS entry has been included in this report (**Appendix 2**).

8.2.2 All archive elements will be marked with the **72743**, and a full index will be prepared. The physical archive comprises the following:

- *1 file/document case of paper records & A3/A4 graphics*

### 8.3 Discard policy

8.3.1 Wessex Archaeology follows the guidelines set out in *Selection, Retention and Dispersal* (Society of Museum Archaeologists 1993), which allows for the discard of selected artefact and ecofact categories which are not considered to warrant any future analysis. Any discard of artefacts will be fully documented in the project archive.

8.3.2 The discard of environmental remains and samples follows nationally recommended guidelines (SMA 1993; 1995; English Heritage 2002).

### 8.4 Copyright

8.4.1 The full copyright of the written/illustrative archive relating to the site will be retained by Wessex Archaeology Ltd under the *Copyright, Designs and Patents Act 1988* with all rights reserved. The Museum, however, will be granted an exclusive licence for the use of the archive for educational purposes, including academic research, providing that such use shall be non-profitmaking, and conforms to the *Copyright and Related Rights regulations 2003*.

### 8.5 Security Copy

8.5.1 In line with current best practice (e.g. Brown 2011), on completion of the project a security copy of the written records will be prepared, in the form of a digital PDF/A file. PDF/A is an ISO-standardised version of the Portable Document Format (PDF) designed for the digital preservation of electronic documents through omission of features ill-suited to long-term archiving.

## 9 REFERENCES

ADS 2013, *Caring for Digital Data in Archaeology: a guide to good practice*, Archaeology Data Service & Digital Antiquity Guides to Good Practice



- Brown, D.H., 2011, *Archaeological archives; a guide to best practice in creation, compilation, transfer and curation*, Archaeological Archives Forum (revised edition)
- English Heritage, 2002, *Environmental Archaeology; a guide to theory and practice of methods, from sampling and recovery to post-excavation*, Swindon, Centre for Archaeology Guidelines
- IfA 2008. *Standard and Guidance for an archaeological watching brief*, Institute for Archaeologists
- IfA 2009. *Standard and Guidance for the creation, compilation, transfer and deposition of archaeological archives*, Institute for Archaeologists
- SMA 1993. *Selection, Retention and Dispersal of Archaeological Collections*, Society of Museum Archaeologists
- SMA 1995. *Towards an Accessible Archaeological Archive*, Society of Museum Archaeologists
- Surrey County Archaeological Unit, 1997. An Archaeological Evaluation of the Proposed Development Site at Mizens Farm, Woking, Surrey. Unpublished client report.
- Surrey County Archaeological Unit, 1998a. Additional Trial Trenching for the Archaeological Evaluation of the Proposed Development Site at Mizens Farm, Woking, Surrey. Unpublished client report.
- Surrey County Archaeological Unit, 1998b. An Archaeological Watching Brief at Mizens Farm, Chertsey Road, Woking, Surrey. Unpublished client report.
- Surrey County Archaeological Unit, 1999. An Archaeological Watching Brief at the Proposed Development at Mizens Farm, Woking, Surrey. Unpublished client report.
- Wessex Archaeology, 2009. McLaren Production Centre, Woking, Surrey; Archaeological Watching Brief Report. Unpublished client report ref 72740.03.
- Wessex Archaeology, 2010a. McLaren Production Centre, Woking, Surrey; Archaeological Evaluation Report. Unpublished client report ref 72741.03.
- Wessex Archaeology, 2010b. McLaren Production Centre, Woking, Surrey; Archaeological Watching Brief Report. Unpublished client report ref 72742.03.
- Wessex Archaeology, 2014. McLaren Production Centre, Woking Surrey, Written Scheme of Investigation for an Archaeological Watching Brief. Unpublished client report ref 72743.01



## APPENDIX 1 – TEST PIT TABLES

bgl = below ground level

TEST PIT 1			Type:	Machine excavated
Dimensions: 2.85m x 0.60m		Max. depth: 3m	Ground level: 27.07m aOD	
Context	Description		Depth bgl (m)	
101	Topsoil	Mid grey brown silty sand with occasional, sub rounded- rounded, moderately sorted gravel/pebbles that are < 40mm in size	0-0.37m	
102	Natural	Light brown yellow clay sand mainly sand with rare-occasional gravel/pebbles < 60mm, sub rounded and moderately sorted	0.20-0.50m	

TEST PIT 2			Type:	Machine excavated
Dimensions: 2.83m x 0.62m		Max. depth: 3m	Ground level: 27.14m aOD	
Context	Description		Depth bgl (m)	
201	Topsoil	Mid grey brown silty sand with occasional, sub rounded- rounded gravel/pebbles <60mm moderately sorted.	0-0.31m	
202	Subsoil	Mid brown clay sand with occasional sub rounded-rounded, moderately sorted, occasional pebbles. A possible sub soil only located with in this Trial Pit and it might be a slightly stained top layer of natural.	0.31m-0.42m	
203	Natural	Mid brown yellow clay sand with occasional rounded gravels/pebbles <60mm mod sorted. At a depth of 0.76m the natural becomes more clayey.	0.42m+	

TEST PIT 3			Type:	Machine excavated
Dimensions: 2.55m x 0.65m		Max. depth: 2.6m	Ground level: 27.26m aOD	
Context	Description		Depth bgl (m)	
301	Topsoil	Mid grey brown sandy silt with gravel/pebble inclusions <70mm, rounded, occasional, moderately sorted	0-0.32m	
302	Subsoil	Mid brown silty clay sand with occasional gravel/pebbles <60mm, sub rounded-rounded, moderately sorted	0.32m-0.52m	
303	Natural	Mid yellow brown sand clay with gravel/pebble inclusions <60mm sub rounded- rounded, moderately sorted, occasional.	0.52m+	

TEST PIT 4			Type:	Machine excavated
Dimensions: 2.10m x 0.65m		Max. depth: 3.25m	Ground level: 26.85m aOD	
Context	Description		Depth bgl (m)	
401	Topsoil	Mid grey brown silty sand with rare sub rounded gravel/pebble inclusions<60mm, rare, sub rounded, mod sorted. Contained a single piece of burnt flint.	0 – 0.3mm	
402	Natural	Mid brown yellow clay sand, clear from the top soil. Gravel/pebble inclusions rounded, <80mm moderately sorted rare-occasional	0.3m+	

TEST PIT 5			Type:	Machine excavated
Dimensions: 2.20m x 0.65m		Max. depth: 2.3m	Ground level: 28.04 aOD	
Context	Description		Depth bgl (m)	
501	Topsoil	Mid grey brown silty clay with rare, sub rounded gravel/pebbles <50mm, moderately sorted. Clear from the natural.	0-0.32m	
502	Natural	Mid yellow brown clay with sands. It contained rare-occasional , rounded gravel/pebbles <80mm moderately sorted	0.32m+	



<b>TEST PIT 6</b>			<b>Type:</b>	Machine excavated
<b>Dimensions:</b> 3.9m x 0.60m		<b>Max. depth:</b> 4m	<b>Ground level:</b> 28.81m aOD	
<b>Context</b>	<b>Description</b>		<b>Depth bgl (m)</b>	
601	Topsoil	Mid grey brown silty sand with rare gravel/pebbles <50mm sub rounded moderately sorted. It contained a single piece of pottery	0-0.31m	
602	Natural	Light yellow brown clay sand with no inclusions	0.31m+	

<b>TEST PIT 7</b>			<b>Type:</b>	Machine excavated
<b>Dimensions:</b> 2.9m x 0.7m		<b>Max. depth:</b> 2.90m	<b>Ground level:</b> 28.35m aOD	
<b>Context</b>	<b>Description</b>		<b>Depth bgl (m)</b>	
701	Topsoil	Mid grey brown silty sand with gravel/pebble inclusions <60mm, sub rounded- rounded, moderately sorted.	0-0.23m	
702	Natural	Mid yellow clay sand with rare gravel/pebbles inclusions < well sorted <60mm, rounded, well sorted. Slightly diffuse interface it may have been the subject of previous interventions/landscaping.	0.23m+	

<b>TEST PIT 8</b>			<b>Type:</b>	Machine excavated
<b>Dimensions:</b> 3.70m		<b>Max. depth:</b> 4m	<b>Ground level:</b> 28.09m aOD	
<b>Context</b>	<b>Description</b>		<b>Depth bgl (m)</b>	
801	Topsoil	Mid grey brown silty sand with rare gravel/pebbles inclusions, occasional, moderately sorted, <40mm	0-0.19m	
802	Layer	Redeposited natural layer light yellow brown clay sand with rare gravel/pebble inclusions <50mm, moderately sorted, sub rounded- rounded.	0.19m-0.29m	
803	Layer	Redeposited top soil layer mid grey brown silty sand with gravel/pebble inclusions <50mm, sub rounded – rounded, occasional. It contained Modern C.B.M (not retained) <30mm, sub rounded poorly sorted, occasional.	0.29m-0.4m	
804	Natural	Light yellow brown clay sand with gravel <50mm sub rounded, moderately sorted, occasional- moderate density.	0.4m+	

<b>TEST PIT 9</b>			<b>Type:</b>	Machine excavated
<b>Dimensions:</b> 3.9m x 0.6m		<b>Max. depth:</b> 04.1m	<b>Ground level:</b> 31.00m aOD	
<b>Context</b>	<b>Description</b>		<b>Depth bgl (m)</b>	
901	Topsoil	Mid grey brown silty sand with gravel/pebble inclusions <60mm, sub rounded- rounded, poorly sorted, occasional density.	0-0.3m	
902	Layer	Redeposited natural layer light yellow brown sandy clay. No inclusions.	0.3-0.58m	
903	Layer	Made ground- modern. Mid brown grey silty sand with modern detritus including plastic mesh and C.B.M (not retained) <90mm sub angular- sub rounded, occasional. Gravel/pebble inclusions <60mm sub angular-sub rounded. The layer may be a feature as natural encountered in west corner at 1.10 but this layer carried on beyond the 4.1m depth of the trench. Possibly associated with the erection of the current buildings on the site. Possibly part of a rubbish dump.	0.58m-4.1m+	
904	Natural	Light yellow brown clay sand with no inclusions. The natural is only present within the west corner of the trench and appears to be truncated through by made ground layer 903.	1.10m+	



<b>TEST PIT 10</b>			<b>Type:</b>	Machine excavated
<b>Dimensions:</b> 3.95m x 0.6m		<b>Max. depth:</b> 4m	<b>Ground level: 30.76m aOD</b>	
<b>Context</b>	<b>Description</b>			<b>Depth bgl (m)</b>
1001	Topsoil	Mid grey brown sand silt with occasional pebble/gravel inclusions <60mm, subrounded & moderately sorted.		0-0.27m
1002	Layer	Mid yellow brown silty clay sand no inclusions. Mixed redeposited natural layer.		0.27m-0.35m
1003	Layer	Made ground Mid brown grey silty sandy clay with modern detritus inclusions including complete bricks occasional and plastic mesh and not retained		0.35m-1.8m
1004	Layer	Light yellow brown clay sand no inclusions		1.8m-2.5m
1005	Layer	Mid grey brown silty? Sand no inclusions difficult to tell what it was due to the depth of the test pit but it may have been a lens in the natural.		2.5m-2.8m
1006	Layer	Light Yellow brown clay sand with no inclusions it is identical to 1004		2.8m+



## APPENDIX 2 – OASIS FORM

OASIS ID: wessexar1-184837

### Project details

Project name	McLaren Production Centre
Short description of the project	Wessex Archaeology was commissioned by McLaren Group Ltd through their agent Terence O'Rourke Ltd to undertake an archaeological watching brief on land at the McLaren Technology Centre, Woking, Surrey. The archaeological watching brief comprised of monitoring the excavation of 10 geotechnical test pits which were located on the proposed building development. The work was undertaken the 23rd to 24th June 2014. No evidence of any archaeological features were found during the watching brief however test pits 8, 9 and 10 did display signs of modern disturbance which may have been associated with the landscaping of the grounds of the McLaren Production Centre (MPC) building.
Project dates	Start: 23-06-2014 End: 24-06-2014
Previous/future work	Yes / Not known
Any associated project reference codes	72743 - Sitecode
Type of project	Recording project
Site status	None
Current Land use	Industry and Commerce 1 - Industrial
Monument type	NONE None
Significant Finds	NONE None
Investigation type	"Test-Pit Survey"
Prompt	Direction from Local Planning Authority - PPG16

### Project location

Country	England
Site location	SURREY WOKING WOKING McLaren Production Centre
Postcode	GU21 4YH
Study area	0 Hectares
Site coordinates	TQ 01250 61816 51.3458894813 -0.546057731708 51 20 45 N 000 32 45 W Point
Height OD / Depth	Min: 23.00m Max: 32.00m

### Project creators

Name of Organisation	Wessex Archaeology
----------------------	--------------------





Project brief originator	Terence O'Rourke Ltd
Project design originator	Wessex Archaeology
Project director/manager	Gareth Chaffey
Project supervisor	Simon Flaherty
Type of sponsor/funding body	Developer
Name of sponsor/funding body	McLaren Group Ltd

### Project archives

Physical Archive Exists?	No
Digital Archive recipient	Woking Museum and Arts and Crafts Centre
Digital Archive ID	72743
Digital Contents	"none"
Digital Media available	"Images raster / digital photography", "Survey", "Text"
Paper Archive recipient	Woking Museum and Arts and Crafts Centre
Paper Archive ID	72743
Paper Contents	"none"
Paper Media available	"Context sheet", "Diary", "Notebook - Excavation", "Research", "General Notes", "Plan", "Report", "Survey "

### Project bibliography 1

Publication type	Grey literature (unpublished document/manuscript)
Title	McLaren Production Centre, Woking, Surrey: Archaeological Watching Brief Report
Author(s)/Editor(s)	Flaherty, S
Other bibliographic details	72743.03
Date	2014



Issuer or publisher      Wessex Archaeology

Place of issue or  
publication              Wessex Archaeology, Salisbury

Description              A4 illustrated client report.

---

Entered by                Gareth Chaffey (g.chaffey@wessexarch.co.uk)

Entered on                17 July 2014

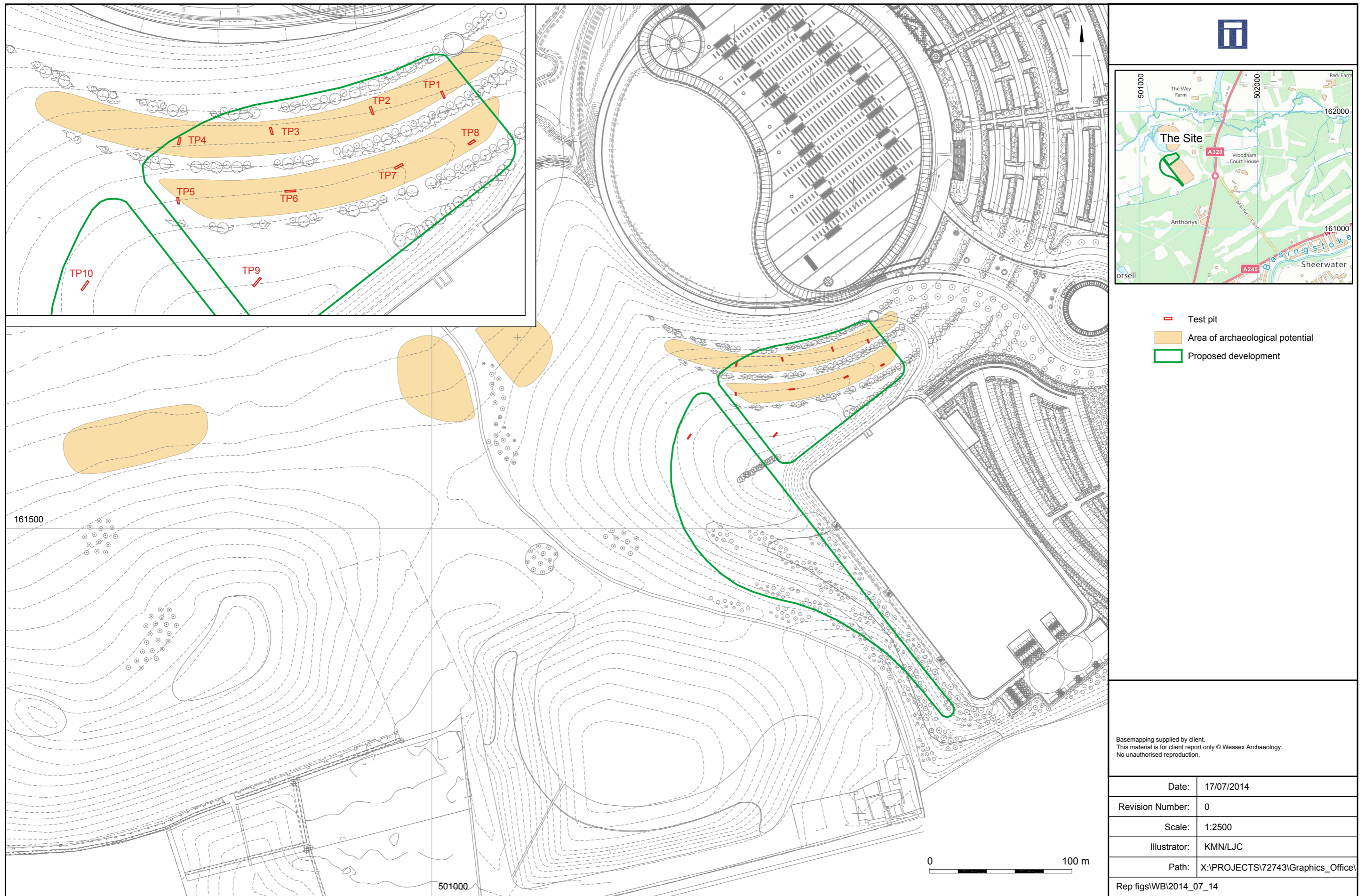

Basemapping supplied by client.  
 This material is for client report only © Wessex Archaeology.  
 No unauthorised reproduction.

Date:	17/07/2014
Revision Number:	0
Scale:	1:2500
Illustrator:	KMN/LJC
Path:	X:\PROJECTS\72743\Graphics_Office\
Rep figs\WB\2014_07_14	

Site and test pit location plan

Figure 1



Plate 1: South facing representative section of Test pit 6



Plate 2: North west facing representative section of Test pit 10

	This material is for client report only © Wessex Archaeology. No unauthorised reproduction.			
	Date:	14/07/2014	Revision Number:	0
	Scale:	N/A	Illustrator:	ND
	Path:	X:\PROJECTS\72743\Graphics_Office\Rep figs\WB\2014_07_14\72743_Plates		



Wessex Archaeology Ltd registered office Portway House, Old Sarum Park, Salisbury, Wiltshire SP4 6EB  
Tel: 01722 326867 Fax: 01722 337562 info@wessexarch.co.uk www.wessexarch.co.uk



Wessex Archaeology Ltd is a company limited by guarantee registered in England, company number 1712772. It is also a Charity registered in England and Wales, number 287786; and in Scotland, Scottish Charity number SC042630. Our registered office is at Portway House, Old Sarum Park, Salisbury, Wiltshire SP4 6EB.