



making sense of heritage

Land off Camps Road Bartlow Cambridgeshire

Archaeological Evaluation Report



Planning Reference: S/0843/15/FL
HER Event Number: ECB 4521
Ref: 110050.01
October 2015



**Land off Camps Road
Bartlow
Cambridgeshire**

Archaeological Evaluation Report

Prepared for:

Rachel May
Bartlow Park
Camps Road
Bartlow
Cambridge
Cambridgeshire
CB21 4PP

HER Event Number: ECB 4521

Prepared by:

Wessex Archaeology
Bridgewood House
8 Laker Road
Rochester Airport Industrial Estate
Rochester
Kent
ME1 3QX

www.wessexarch.co.uk

October 2015

WA Report Ref. 110050.01



Quality Assurance

Project Code	110050	HER Event Number	ECB 4521	Client Ref.	NA
Planning Application Ref.	S/0843/15/FL	Ordnance Survey (OS) national grid reference (NGR)	TL 5885 4518		

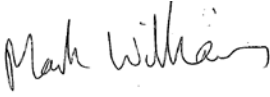
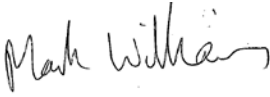
Version	Status*	Prepared by	Checked and Approved By	Approver's Signature	Date
v01	I	<i>J Lathan</i>	<i>D Britchfield</i>		29/07/2015
File:	R:\PROJECTS\110050_Reports\v01				
v02	E	<i>J Lathan</i>	<i>M Williams</i>		28/09/2015
File:	R:\PROJECTS\110050_Reports\v02				
v03	F	<i>D Britchfield</i>	<i>M Williams</i>		16/10/2015
File:	R:\PROJECTS\110050_Reports\v03				
File:					
File:					

* I = Internal Draft; E = External Draft; F = Final

DISCLAIMER

THE MATERIAL CONTAINED IN THIS REPORT WAS DESIGNED AS AN INTEGRAL PART OF A REPORT TO AN INDIVIDUAL CLIENT AND WAS PREPARED SOLELY FOR THE BENEFIT OF THAT CLIENT. THE MATERIAL CONTAINED IN THIS REPORT DOES NOT NECESSARILY STAND ON ITS OWN AND IS NOT INTENDED TO NOR SHOULD IT BE RELIED UPON BY ANY THIRD PARTY. TO THE FULLEST EXTENT PERMITTED BY LAW WESSEX ARCHAEOLOGY WILL NOT BE LIABLE BY REASON OF BREACH OF CONTRACT NEGLIGENCE OR OTHERWISE FOR ANY LOSS OR DAMAGE (WHETHER DIRECT INDIRECT OR CONSEQUENTIAL) OCCASIONED TO ANY PERSON ACTING OR OMITTING TO ACT OR REFRAINING FROM ACTING IN RELIANCE UPON THE MATERIAL CONTAINED IN THIS REPORT ARISING FROM OR CONNECTED WITH ANY ERROR OR OMISSION IN THE MATERIAL CONTAINED IN THE REPORT. LOSS OR DAMAGE AS REFERRED TO ABOVE SHALL BE DEEMED TO INCLUDE, BUT IS NOT LIMITED TO, ANY LOSS OF PROFITS OR ANTICIPATED PROFITS DAMAGE TO REPUTATION OR GOODWILL LOSS OF BUSINESS OR ANTICIPATED BUSINESS DAMAGES COSTS EXPENSES INCURRED OR PAYABLE TO ANY THIRD PARTY (IN ALL CASES WHETHER DIRECT INDIRECT OR CONSEQUENTIAL) OR ANY OTHER DIRECT INDIRECT OR CONSEQUENTIAL LOSS OR DAMAGE.



Land off Camps Road Bartlow Cambridgeshire

Archaeological Evaluation Report

Contents

Summary	3
Acknowledgements.....	4
1 INTRODUCTION.....	5
1.1 Project background	5
2 THE SITE, LOCATION & GEOLOGY	5
3 ARCHAEOLOGICAL AND HISTORICAL BACKGROUND.....	6
3.1 Introduction	6
3.2 Archaeological Background.....	6
3.3 Previous Archaeological Works within the Area.....	6
<i>Geophysical Survey</i>	6
4 AIMS.....	7
4.1 Archaeological Evaluation	7
5 METHODOLOGY.....	7
5.1 Introduction	7
5.2 Health and Safety.....	8
5.3 Service Location.....	8
5.4 Fieldwork Programme	8
5.5 Recording.....	9
6 RESULTS	9
6.1 Introduction	9
6.2 Stratigraphic sequence.....	9
6.3 Archaeological Results.....	9
7 FINDS AND ENVIRONMENTAL SAMPLES.....	10
8 DISCUSSION.....	10
8.1 Archaeological Narrative	10
8.2 Conclusion	11
8.3 STORAGE AND CURATION.....	11
8.4 Museum	11
8.5 Preparation of Archive.....	11



8.6	Discard Policy	11
8.7	Security Copy.....	12
8.8	Copyright.....	12
9	REFERENCES.....	13
10	APPENDIX 1: TRENCH TABLES.....	14
11	APPENDIX 2: OASIS FORM	16

Figures

- Figure 1: Site Location and Trench Layout
Figure 2: Trench Plans

Plates

- Plate 1: Trench 1 viewed from the northeast
Plate 2: Trench 1 southeast facing representative section
Plate 3: Southwest facing section of ditch 105
Plate 4: East facing view of wall 107
Plate 5: Trench 2 viewed from the southeast
Plate 6: Trench 2 southwest facing representative section
Plate 7: South facing section of ditch 204
Plate 8: Trench 3 viewed from the east
Plate 9: Trench 3 south facing representative section
Plate 10: Trench 4 viewed from the southeast
Plate 11: Trench 4 southwest facing representative section



Land off Camps Road Bartlow Cambridgeshire

Archaeological Evaluation Report

Summary

Wessex Archaeology was commissioned by Mrs Rachel May to carry out an archaeological trial trench evaluation on land off Camps Road, Bartlow, Cambridgeshire (TL 5885 4518).

In accordance with the Written Scheme of Investigation the archaeological work consisted of four trial trenches, one measuring 50m x 1.5m, two measuring 30m x 1.5m and one measuring 10m x 1.5m. These trenches were located over the areas of impact for the construction of a new stable block and a field shelter. Trenches were located to examine the archaeological potential of anomalies identified in a geophysical survey conducted by Archaeological Prospection Services (2007).

The field work was undertaken between the 27th and 29th of July 2015.

The archaeological evaluation identified two boundary ditches and a modern brick wall. Within the western extent of Trench 1 the first ditch was aligned on a north-south orientation which correlated with results from a geophysical survey previously carried out on the Site. The geophysical report suggested that this feature represents a driveway ditch although this could not be confirmed due to the absence of a second parallel ditch. Within the eastern extent of Trench 1 made ground (was recorded at depths of 0.11m-0.35m below the existing ground level (60.2m aOD) and contained modern bricks and the remains of what appeared to be a wall. The wall was east-west aligned and consisted of a single course of frogged bricks bedded onto the subsoil and most likely represents the remains of the original house, which burnt down in the 1960's.

The second ditch, which was located within southeastern extent of Trench 2 had been disturbed by animal activity and was recorded on a north-south orientation. The geophysical survey suggested that a junction between a northeast-southwest orientated linear and an east-west linear within this trench would be present although neither of these features were identified and linear **203** did not correlate with the geophysical results.

Trench 3 and Trench 4 contained no archaeological find or features.



Land off Camps Road Bartlow Cambridgeshire

Archaeological Evaluation Report

Acknowledgements

This project was commissioned by Mrs Rachel May and Wessex Archaeology is grateful to her in this regard. Wessex Archaeology would also like to thank Gemma Stewart of the Historic Environment Team at Cambridgeshire County Council for her assistance throughout the works and for her attendance on site. Thanks are also extended to Henry May for his assistance throughout the project.

The project was managed by David Britchfield, Project Manager. The fieldwork was undertaken by Joanne Lathan and Andrew Souter.

The report was researched and compiled by Joanne Lathan and edited by Mark William, Team Leader WA London & South East, with illustrations by Jo Condliffe.



Land off Camps Road Bartlow Cambridgeshire

Archaeological Evaluation Report

1 INTRODUCTION

1.1 Project background

- 1.1.1 Wessex Archaeology has been commissioned by Mrs Rachel May, to carry out an archaeological trial trench evaluation on land off Camps Road, Bartlow, Cambridgeshire (the Site).
- 1.1.2 This evaluation forms part of an archaeological assessment of the Site, which aimed at providing archaeological information to aid in the planning process.
- 1.1.3 Planning consent has been granted for the construction of a new stable block, outdoor arena, store, field shelter and an access road and requires that a programme of archaeological work be undertaken in association with the implementation of the consent (Planning Application Number: S/0843/15/FL Condition 4) which states that;

No development shall take place on the application site until the implementation of a programme of archaeological work has been secured in accordance with a written scheme of investigation which has been submitted to and approved in writing by the Local Planning Authority.

(Reason - To secure the provision of archaeological excavation and the subsequent recording of the remains in accordance with Policy CH/2 of the adopted Local Development Framework 2007.)

- 1.1.4 The scope of the archaeological work required has been informed by a *Brief for Archaeological Evaluation* prepared by the Historic Environment Team (HET) at Cambridgeshire County Council (2015) and comprises an archaeological trial trench evaluation.
- 1.1.5 The evaluation comprised four archaeological evaluation trenches, one measuring 50m x 1.5m, two measuring 30m x 1.5m and one measuring 10m x 1.5m. The fieldwork was undertaken between the 27th July 2015 and 29th of July 2015.

2 THE SITE, LOCATION & GEOLOGY

- 2.1.1 The Site currently consists of a single irregular field within Bartlow Park, bounded to the north and east by thick tree lines, to the south by the River Granta and to the west by the remaining areas of Bartlow Park.



- 2.1.2 The Bedrock in the Site area is Cretaceous sedimentary chalk of the Lewes Nodular and Seaford Chalk formations. Directly to the south of the Site in the 'valley' of the River Granta this bedrock is overlaid by Alluvium, Clay, Silt, Sand and Gravel.

3 ARCHAEOLOGICAL AND HISTORICAL BACKGROUND

3.1 Introduction

- 3.1.1 The Cambridgeshire Historic Environment Record (CHER) was consulted and results within a 1km radius around the Site are provided below.

3.2 Archaeological Background

- 3.2.1 There is a concentration of prehistoric finds within a 1km radius of the Site, dating from the Mesolithic through to the Late Bronze Age, primarily focused around the barrow cemetery to the south west. Flint tools recovered from within the 1km radius are two Palaeolithic hand axes, a Mesolithic tranchet axe, a Neolithic-Late Bronze Age flint arrowhead and a collection of other lithic implements.
- 3.2.2 The Scheduled Monument of Bartlow Hills Romano British barrow cemetery lies to the south west of the Site at grid references TL 58619 44877 and TL 58662 44963 contains six barrows forming two parallel lines running north/south (NHLE Ref: 1018974). Investigations in the 19th century identified inhumation and cremation burials, some in coffins, along with a large number of grave goods. The cemetery dates from the late 1st to early 2nd century AD and is part of a larger funerary complex that includes a monumental tomb or mausoleum. A Romano-British or Anglo Saxon cemetery was found in the mid-19th century 100m to the north east of the barrow cemetery. Further Romano-British inhumations and cremations were found slightly further north during an evaluation in the early 21st century. Possible foundations were also discovered during the evaluation (Beauchamp & Macaulay 2004).
- 3.2.3 A Romano-British villa was identified to the south west of the Site at grid reference TL 5870 4499 within 100 yards of the barrow cemetery (CHER Ref: 06164) during excavations in the 1850s. An evaluation in 2012 and 2013 uncovered further evidence of Romano-British settlement to the north west of the villa (Quinn & Stoakley 2012).
- 3.2.4 The village of Bartlow to the west of the Site contains a number of post-medieval buildings and gardens, indicating that the settlement was populated throughout the post-medieval period.
- 3.2.5 The Saffron Walden railway, which was opened in 1865 and closed in 1964, ran on an east/west alignment to the south of the Site. Several buildings and assets of the railway are recorded on the CHER, although the line itself is recorded as having been dismantled. A WWII ammunition dump is located to the south of the Site on the far side of the Saffron Walden railway.

3.3 Previous Archaeological Works within the Area

Geophysical Survey

- 3.3.1 A magnetometer survey was conducted by Archaeological Prospection Services (2007) in the Bartlow area in 2006 as part of a project to understand the wider context of the Roman cemetery. The survey uncovered a range of evidence suspected of being related to the previously recorded Romano-British Villa and *tumuli*. Within the Site itself the survey identified a number of features. Two linear features are recognised, one north/south one east/west, believed to represent field boundaries shown on early ordnance survey maps



with a double ditched feature, possibly a drove way, running parallel to a north/south feature. The soil surveyed was found to be very differently on either side of the east/west feature, possibly indicating that the southern area was flooded by the River Granta and that the feature was a flood defence.

- 3.3.2 A large, largely rectilinear enclosure is present in the centre of the field which may have been associated with a settlement or stock enclosure of Iron Age or Romano-British origin. In the north western corner of the enclosure it intercepts with the possible drove way and two smaller sub-circular features. A further two linear features are present in the northern half of the field and may represent a continuation of the enclosure to the north.

4 AIMS

4.1 Archaeological Evaluation

- 4.1.1 The principal aim of the archaeological evaluation was to record the location, extent, date, nature, character and significance of archaeological remains as may exist on the Site and to report on the results of the evaluation so that an informed decision on their subsequent treatment can be made, in light of the impact of the proposed development.

- 4.1.2 The **principle** aims of the archaeological work was:

- *to establish whether any archaeological remains of prehistoric date, principally Palaeolithic, Mesolithic, Neolithic and Bronze Age, are present within the Site;*
- *to establish whether archaeological remains of Roman and/or Saxon date are present within the Site;*
- *to assess whether remains of medieval and/or post medieval are located within the Site and to characterise them; and*
- *To establish, where possible the impact caused during the development of the school grounds.*

- 4.1.3 The objectives of the evaluation were therefore to:

- *provide further information concerning the presence/absence, date, nature and extent of any buried archaeological remains and to investigate and record all archaeological features revealed during the evaluation;*
- *to investigate and characterise geophysical anomalies within the proposed development area;*
- *provide further information concerning the presence/absence, nature and extent of any alluvium, buried palaeosol or 'B' horizon revealed during the evaluation;*
- *establish a broad phased plan of the archaeology revealed during the evaluation;*
- *investigate the function of any structural remains and the activities taking place within and close to the Site; and*
- *in the event that archaeological remains are found, to inform and provide information for any future mitigation for the Site in compliance with the planning condition.*

5 METHODOLOGY

5.1 Introduction

- 5.1.1 The evaluation and the presentation of this report was undertaken in accordance with the methodology set out in the WSI (Wessex Archaeology 2015) and carried out in



compliance with the standards outlined in the Institute for Archaeologists' *Standard and guidance for Archaeological Field Evaluation* (CIfA 2015) and the *Brief for Archaeological Evaluation* produced by CCC (2015)

5.2 Health and Safety

- 5.2.1 Health and Safety considerations was of paramount importance in conducting all fieldwork.
- 5.2.2 All work was carried out in accordance with the *Health and Safety at Work etc. Act 1974* and the *Management of Health and Safety Regulations 1992*, and all other relevant Health and Safety legislation, regulations and codes of practice in force at the time.
- 5.2.3 Wessex Archaeology supplied a copy of their Health and Safety Policy and a Risk Assessment to the Client before the commencement of fieldwork. The Risk Assessment was read and understood by all staff attending the Site before any groundwork commences.

5.3 Service Location

- 5.3.1 Before excavation began the Client provided information regarding the presence of any below/above ground services. The Site was walked over and inspected to visually identify, where possible, the location of above and below ground services.
- 5.3.2 All evaluation trench locations were scanned by suitably trained WA staff before and during excavation with a Cable Avoidance Tool (CAT) in order to verify the absence of any live underground services.

5.4 Fieldwork Programme

- 5.4.1 In accordance with the WSI (Wessex Archaeology 2015), the evaluation comprised the excavation of four evaluation trenches; one measuring 50m x 1.5m, two measuring 30m x 1.5m and one measuring 10m x 1.85m located within areas of proposed impact as shown on **Figure 1**. This trench layout was aimed to target possible features indicated by the geophysical survey (APS 2006).
- 5.4.2 The trenches were laid out using GPS in accordance with the pattern given in **Figure 1** and the trench locations were tied in to the Ordnance Survey.
- 5.4.3 The trial trenches were excavated using a JCB excavator using a toothless bucket and under constant supervision by Wessex Archaeology. Topsoil and subsoil were stored separately on either side of each individual trench and reinstated in the correct order.
- 5.4.4 All spoil excavated was scanned visually for artefacts and scanned with a metal detector.
- 5.4.5 Machine excavation will proceed to a depth at which the top of archaeological levels, or the top of natural deposits, are exposed, whichever is the higher.
- 5.4.6 With the exception of Trench 4 trenches received a secondary inspection after a minimum 24 hours to allow for possible additional features to weather. Trench 4 was excavated to a depth of 1.2m and therefore required backfilling due to the presence of livestock within the immediate area It was however inspected by the County Archaeological Officer before backfilling commenced.

5.5 Recording

- 5.5.1 All exposed archaeological deposits were recorded using Wessex Archaeology's *pro forma* recording system.
- 5.5.2 A complete drawn record of excavated archaeological features and deposits was compiled. This includes both plans and sections, drawn to appropriate scales (1:20 for plans, 1:10 for sections), and with reference to a site grid tied to the Ordnance Survey National Grid. The Ordnance Datum (OD) height of all principal features and levels was calculated and plans/sections annotated with OD heights.
- 5.5.3 A full photographic record was maintained using digital photography. The photographic record illustrates both the detail and the general context of all features and finds excavated and the Site as a whole.

6 RESULTS

6.1 Introduction

- 6.1.1 This section presents the results of the archaeological evaluation. Detailed descriptions of the trenches are included in **Appendix 1**.

6.2 Stratigraphic sequence

- 6.2.1 The stratigraphic sequence identified within the trenches varied across the site. Within Trench 1 and sealed by topsoil (**101**) within in the eastern extent of the trench, a layer of made ground was present which consisted largely of modern broken brick fragments (**102**) surrounding the remains of a wall (**107**). Within the western extent of the trench the stratigraphic sequence comprised chalk natural (**104**) with abundant flint inclusions, overlain by grey brown silty subsoil (**103**) sealed by dark brown silty clay topsoil (**101**). This deposit model was also recorded within Trench 2 (**201**, and Trench 3 (**Appendix 1**).
- 6.2.2 Within Trench 4, the most southern trench and closest to the river, mid-yellow brown silty clay alluvium (**402**) was sealed by the topsoil (**401**). Natural geology was not identified as the trench depth had exceeded safe working limits.

6.3 Archaeological Results

- 6.3.1 Within Trench 1 (**Plates 1-4**) north-south orientated ditch **105** measured 0.9m wide and 0.23m deep and with concave sides and base it contained a single fill **106** and extended beyond the limit of excavation (**Figure 2**). Identified within the geophysical survey this feature was interpreted as part of a north-south orientated field boundary. No finds were recovered from the fill and so provenance could be determined. Within the eastern extent of Trench 1 made ground (**102**) was recorded at depths of 0.11m-0.35m below the existing ground level (60.2m aOD) and contained modern bricks and the remains of what appeared to be a wall. Wall (**107**) comprised an east-west aligned single course of frogged bricks bedded onto the subsoil (**103**) within made ground (**102**) formed from what may be the debris from the remains of the original house, which burnt down in the 1960's. The wall and made ground was beyond the limits of the 2007 geophysical survey (see 3.3.1 above).
- 6.3.2 Within Trench 2 (**Plates 5-7**) a northwest-southeast orientated ditch [**204**] was present which measured 0.61m in width with a depth of 0.29m continuing beyond the limits of excavation. This ditch had a stepped eastern side and a flat base (**Plate 7**) and contained



a single fill comprising light grey brown chalky silt with moderate, medium sized chalk and flint inclusions (**205**). Although having been interpreted as a field boundary (Eckardt et al 2007:26) no finds were recovered and the feature was not dated. Historic mapping does not indicate a field boundary within this area suggesting that it predates early Ordnance Survey mapping (1st Edition; 1845). Natural chalk was identified at a level of approximately 58.9m aOD.

6.3.3 No archaeological finds of features were identified within Trench 3 which exposed natural chalk at a level of 59.7m aOD (**Plates 8-9**).

6.3.4 No archaeological finds of features were identified within Trench 4 which exposed alluvium at a level of 51.8m aOD (**Plates 10-11**).

7 FINDS AND ENVIRONMENTAL SAMPLES

7.1.1 No finds were identified within any of the features recorded within the evaluation trenches.

7.1.2 No features or deposits suitable for environmental sampling were identified during the archaeological evaluation.

8 DISCUSSION

8.1 Archaeological Narrative

8.1.1 A consistent stratigraphic sequence was recorded across the majority of the Site comprising topsoil overlying subsoil and natural chalk with an average depth of 0.65m below the existing ground level. Within the southern extent of the Site alluvial encroachment from the adjacent river had sealed the natural solid chalk geology which would have sealed any early archaeological features, should they be present.

8.1.2 Three features of archaeological were recorded within the northern extent of the Site. Two ditches on parallel north-south alignments produced no dating material so establishing a provenance is difficult. The ditch within Trench 1 appears to correlate with a field boundary/droeway ditch shown on Ordnance Survey mapping (Eckardt et al 2007: Figure 35) and with geophysical results from the same study (2007: Figure 36a & 36B) suggesting a post-medieval-modern date. However as the ditch in Trench 2 does not appear in any of the historical maps of the Site it can be assumed that it predates the 1840's, the earliest example of historic mapping available. An anomaly identified on the geophysical survey within this trench could not be identified in the evaluation.

8.1.3 The single course of brickwork within Trench 1 does not correlate with any historical mapping. Within the eastern extent of the trench the subsoil was sealed by a layer of made ground resulting from modern building debris (**102**) which was edged/bounded by the single course irregular wall which may suggest the construction of a flat base for a possible working area.

8.1.4 With regards to the geophysical survey it is clear that archaeological features have been identified. That said there are occasions where features were suggested and not present and where features were present and not suggested. The geophysical survey results on this site should be treated with caution.



8.2 Conclusion

- 8.2.1 The evaluation has been successful in fulfilling the primary aims and objectives of the WSI (WA 2015) and Brief (Cambridgeshire County Council 2015). Natural geological horizons have been shown to survive intact, largely on the periphery of the Site, at a depth of approximately 0.5m-0.8m below the existing ground level. Within the northern area of the Site archaeological remains are limited to two undated north-south orientated ditches and an east-west orientated brick wall. Within the southern extent of the Site alluvial deposits were exposed to a depth of c.1.2m below the existing ground level where excavation ceased.
- 8.2.2 This evaluation has therefore assessed the archaeological potential of land proposed for development. The results from this work will be used to aid and inform the Archaeological Officer (LCC) of any further archaeological mitigation measures that may be necessary in connection with the development proposals.

8.3 STORAGE AND CURATION

8.4 Museum

- 8.4.1 It is recommended that the project archive resulting from the evaluation be deposited with Cambridgeshire County Council's Historic Environment Team (CHET) under the CHER Event Number **ECB 4521**. Deposition of any finds with a museum will only be carried out with the full agreement of the landowner.

8.5 Preparation of Archive

- 8.5.1 The complete site archive, which will include paper records, photographic records, graphics, artefacts, and digital data, will be prepared following the standard conditions for the acceptance of excavated archaeological material by an appropriate museum, and in general following nationally recommended guidelines (SMA 1995; IfA 2013; Brown 2011; ADS 2013). All archive elements will be marked with the Site code, and a full index will be prepared.
- 8.5.2 The physical archive comprises the following:
- 1 files/document cases of paper records & A3/A4 graphics
- 8.5.3 An OASIS form will be completed at <http://ads.ahds.ac.uk/projects/oasis> for inclusion in the ADS database (**Appendix 2**). This will include an electronic copy of this report in PDF format which will be accessible six months after deposition.

8.6 Discard Policy

- 8.6.1 Wessex Archaeology follows the guidelines set out in *Selection, Retention and Dispersal* (Society of Museum Archaeologists 1993), which allows for the discard of selected artefact and ecofact categories which are not considered to warrant any future analysis. In this instance, the quantity of finds recovered is very small, but as little stratified archaeological evidence has as yet been recovered from the area, then it is recommended that these finds are retained for long-term curation.
- 8.6.2 The discard of environmental remains and samples follows nationally recommended guidelines (SMA 1993; 1995; Historic England 2015).



8.7 Security Copy

- 8.7.1 In line with current best practice (e.g. Brown 2011), on completion of the project a security copy of the written records will be prepared, in the form of a digital PDF/A file. PDF/A is an ISO-standardised version of the Portable Document Format (PDF) designed for the digital preservation of electronic documents through omission of features ill-suited to long-term archiving.

8.8 Copyright

- 8.8.1 This report, and the archive generally, may contain material that is non-Wessex Archaeology copyright (e.g. Ordnance Survey, British Geological Survey, Crown Copyright), or the intellectual property of third parties, which we are able to provide for limited reproduction under the terms of our own copyright licences, but for which copyright itself is non-transferrable by Wessex Archaeology. Users remain bound by the conditions of the Copyright, Designs and Patents Act 1988 with regard to multiple copying and electronic dissemination of the report.
- 8.8.2 Wessex Archaeology retains full copyright of any report under the *Copyright, Designs and Patents Act 1988* with all rights reserved; excepting that it hereby provides an exclusive licence to the Client for the use of the report by the Client in all matters directly relating to the project as described in the specification. Any document produced to meet planning requirements can be copied for planning purposes by the Local Planning Authority.
- 8.8.3 Wessex Archaeology will assign copyright to the Client upon written request but retains the right to be identified as the author of all project documentation and reports as defined in the *Copyright, Designs and Patents Act 1988* (Chapter IV, s.79).



9 REFERENCES

- Archaeology Data Service (ADS) 2013: *Caring for Digital Data in Archaeology: a guide to good practice*, Archaeology Data Service & Digital Antiquity Guides to Good Practice
- Beauchamp, C & Macaulay, S 2004: *Romano-British Burials at Bartlow Park, Cambridgeshire: An Archaeological Evaluation* for Cambridgeshire County Council
- Brown, D H, 2011: *Archaeological archives; a guide to best practice in creation, compilation, transfer and curation*, Archaeological Archives Forum (revised)
- Cambridgeshire City Council Historic Environment Team 2015 *Brief for Archaeological Evaluation, Barlow Park, Camps Road, Bartlow*
- Chartered Institute for Archaeologists (CIfA) 2014: *Standards and Guidance for Archaeological Field Evaluation*, Institute for Archaeologists
- Chartered Institute for Archaeologists (CIfA) 2014: *Standard and Guidance for the creation, compilation, transfer and deposition of archaeological archives*, Institute for Archaeologists
- Eckardt H, Hay S, Thornley D, Fry R & Bay K 2007: *Contextualising the Roman Rural Cemetery at Barlow, Cambridgeshire* CHER 20196
- Historic England 2015: *Management of Research Projects in the Historic Environment (MoRPHE)*
- Historic England 2015: *Management of Archaeological Projects*
- Quinn, S & Stoakley, M 2012: *The Walled Garden, Bartlow Park, Camps Road, Bartlow, Cambridgeshire CB12 4PP: An Archaeological Evaluation* for Archaeological Solutions
- Society of Museum Archaeologists (SMA) 1993: *Selection, Retention and Dispersal of Archaeological Collections*, Soc. Mus. Archaeol.
- Society of Museum Archaeologists (SMA) 1995: *Towards an Accessible Archaeological Archive*, Soc. Mus Archaeol.
- Walker, K 1990: *Guidelines for the Preparation of Excavation Archives for Long-Term Storage*, UK Inst. Conserv. Archaeol. Sect.
- Watkinson, D and Neal, V 1998: *First Aid for Finds*, Rescue and United Kingdom Institute for Conservation Archaeology Section, 3rd Edition



10 APPENDIX 1: TRENCH TABLES

Trench 01	Dimensions :	50m x 1.5m x 0.75m	Ground surface level:	59.993m aOD
	Centre line Coordinates (NGR):	558888.56, 254197.97 558841.86, 245179.91		
Context No.	Category	Description	Depth	
101	Topsoil	Dark grey brown clay loam with rare sub angular and flint inclusions Strat: Seals 102	0-0.11m bgl	
102	Made-ground	Made ground, modern bricks with dark grey clay loam and rooting. East hlf of trench only. Strat: sealed by 101, seals 103	0.11- 0.36m bgl	
103	Subsoil	Light grey brown silt with moderate chlk inclusions and heavy rooting. Strat: sealed by 102, seals 103	0.36- 0.68m bgl	
104	Natural	Weathered chalk with abundant flint inclusions Strat: cut by 105	0.68m+bgl	
105	Ditch	Cut of N-S running ditch with concave sides and base. Measures 0.9m wide 1.5m+ long and 0.23m deep. Single secondary fill 106. Strat: cuts 104 and sealed by 106	0.23m deep	
106	Secondary Fill	Fill of 105. Light yellow brown sitly clay with abundant small andular chalk and common rounded flint inclusions Strat: seals 105	0.23m thick	
107	wall	N-S running wall 1 course thick, edge of mageground layer laid directly ontop of subsoil. Strat: seals 103, sealed by101	0.25m thick	
Comments:				

Trench 02	Dimensions :	29.78m x 1.5m x 0.52m	Ground surface level:	58.904m aOD
	Centre line Coordinates (NGR):	558924.90, 245169.49 558946.69, 245149.17		
Context No.	Category	Description	Depth	
201	Topsoil	Dark grey brown clay loam with rare flint and very rare CBM inclusions with heavy rooting. Strat: Seals 202	0-0.26m bgl	
202	Subsoil	Light grey brown silty clay with occasional small flint inclusions. Strat: sealed by 201, seals 203	0.26- 0.37m bgl	
203	Natural	Weathered chalk with abundant flint inclusions Strat: sealed by 202, seals 207	0.37m+ bgl	
204	Ditch	N-S running ditch 0.61m wide, 1.7m+ long and 0.29m deep with single secondary fill Strat: sealed by 205, cuts 203	0.29m deep	
205	Secondary Fill	Fill of ditch 204, light grey brown chalky silt with	0.29m	



		moderate, medium sized chalk and flint inclusions Strat: seals 204	thick
Comments:			

Trench 03	Dimensions :	29.43m x 1.5m x 0.52m	Ground surface level:	59.954m aOD
	Centre line Coordinates (NGR):	558969.08, 245162.74 558991.06, 245157.47		
Context No.	Category	Description	Depth	
301	Topsoil	Dark grey brown silty sand loam with rare flint inclusions and heavy rooting Strat: Seals 302	0-0.27m bgl	
302	Subsoil	Light grey brown silty clay with occasional small flint inclusions. Strat: sealed by 301, seals 303	0.27-0.36m bgl	
303	Natural	Weathered chalk with abundant flint inclusions Strat: sealed by 302, seals	0.36m+ bgl	
Comments:				

Trench 04	Dimensions :	9.63m x 1.5m x 1.2m	Ground surface level:	50.79m aOD
	Centre line Coordinates (NGR):	558962.70, 244972.35 558969.56, 244965.52		
Context No.	Category	Description	Depth	
401	Topsoil	Dark grey brown silty clay loam with rare sub angular and angular flints Strat: Seals 402	0-0.2m bgl	
402	Alluvium	Light yellow brown alluvial clay with rare rooting Strat: sealed by 401	0.2-1.2m bgl	
Comments: Trench shortened due to live service at southern end of Trench				



11 APPENDIX 2: OASIS FORM

OASIS DATA COLLECTION FORM: England

[List of Projects](#) | [Manage Projects](#) | [Search Projects](#) | [New project](#) | [Change your details](#) | [HER coverage](#) | [Change country](#) | [Log out](#)

[Printable version](#)

OASIS ID: wessexar1-219241

Project details

Project name Land off Camps Road, Bartlow, Cambridgeshire Evaluation
Short description of the project Four trench archaeological evaluation on land at Bartlow Park, Cambridgeshire. Testing geophysical results as part of planning conditions for a new stable block and field shelter. Two un date N-S orientated ditches were identified, the first in trench one, matching geophysical survey results may be part of a N-S orientated drove way. No finds recovered. The second in trench two, not corresponding with the geophysical results, also no finds recovered.
Project dates Start: 27-07-2015 End: 29-07-2015
Previous/future work Yes / No
Any associated project reference codes 110050 - Sitecode
Any associated project reference codes ECB 4521 - Museum accession ID
Type of project Field evaluation
Site status None
Current Land use Other 5 - Garden
Monument type DITCH Uncertain
Methods & techniques "Targeted Trenches"
Development type Estate management (i.e. maintenance of existing structures and landscape by capital works and on-going maintenance)
Prompt Planning condition
Position in the planning process Not known / Not recorded

Project location

Country England
Site location CAMBRIDGESHIRE CAMBRIDGE CAMBRIDGE Camps Road, Bartlow
Postcode CB21 4PP
Site coordinates TL 5885 4518 52.0817013162 0.318495261511 52 04 54 N 000 19 06 E Point



Height OD / Min: 50.79m Max: 59.99m
Depth

Project creators

Name of Organisation Wessex Archaeology
Project brief originator Mrs R. May
Project design originator² Wessex Archaeology
Project director/manager Dave Britchfield
Project supervisor Joanne Lathan

Project archives

Physical Archive Exists? No
Physical Archive recipient Unknown
Physical Archive ID 110050
Digital Archive recipient Unknown
Digital Archive ID 110050
Digital Media available "Database","GIS","Images raster / digital photography","Survey","Text"
Paper Archive recipient Unknown
Paper Archive ID 110050
Paper Media available "Context sheet","Correspondence","Diary","Drawing","Map","Notebook - Excavation',' Research',' General Notes","Photograph","Plan","Report","Section","Survey "
Entered by joannelathan (j.lathan@wessexarch.co.uk)
Entered on 30 July 2015

OASIS:

Please e-mail Historic England for OASIS help and advice
© ADS 1996-2012 Created by Jo Gilham and Jen Mitcham, email Last modified Wednesday 9 May 2012
Cite only: <http://www.oasis.ac.uk/form/print.cfm> for this page

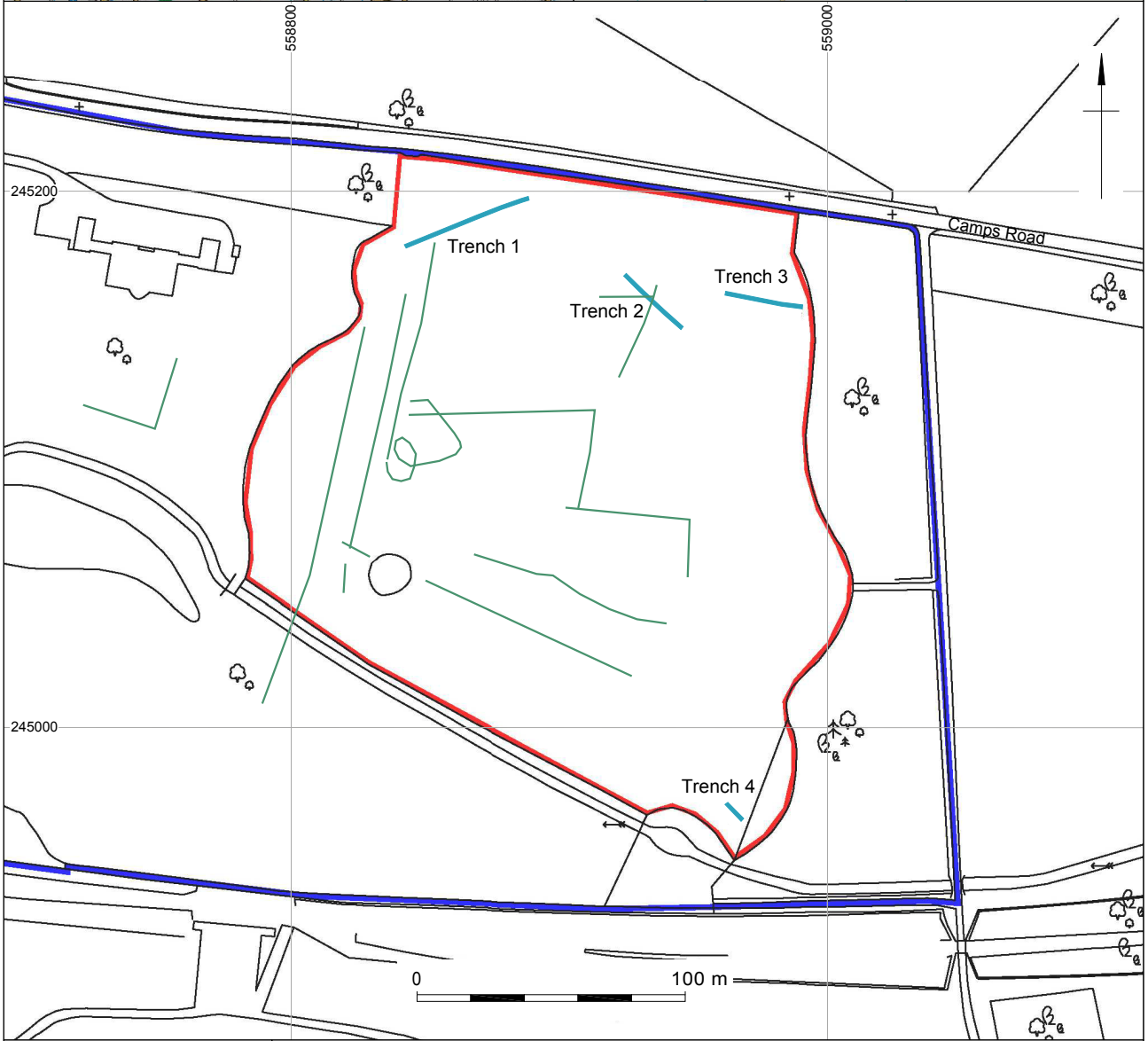
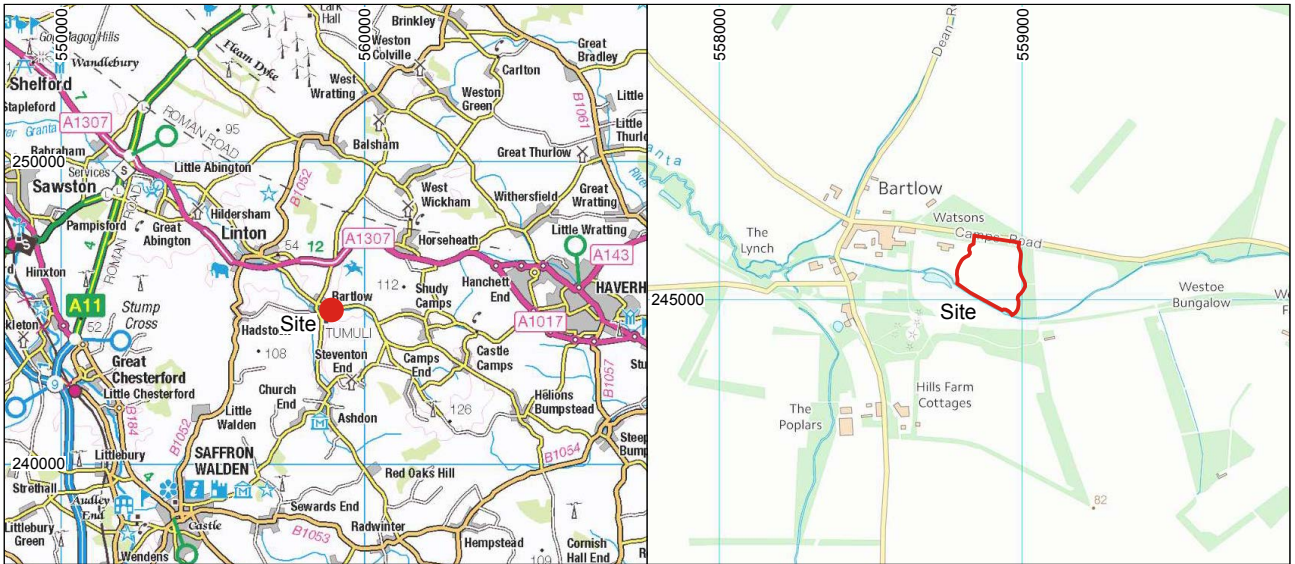

- ▭ Site Boundary
- ▭ Land Ownership Boundary
- ▭ Evaluation Trench
- ▭ Geophysical Anomaly



Digital data supplied by the Client.
 Contains Ordnance Survey data © Crown Copyright and database right 2015.
 This material is for client report only © Wessex Archaeology. No unauthorised reproduction.

Date:	18/08/2015	Revision Number:	0
Scale:	1:2,500 @ A4	Illustrator:	JC
Path:	R:\PROJECTS\110050\Graphics_Office\Rep figs\Eval\2015_08_17\110050_Eval.dwg		

Site location

Figure 1

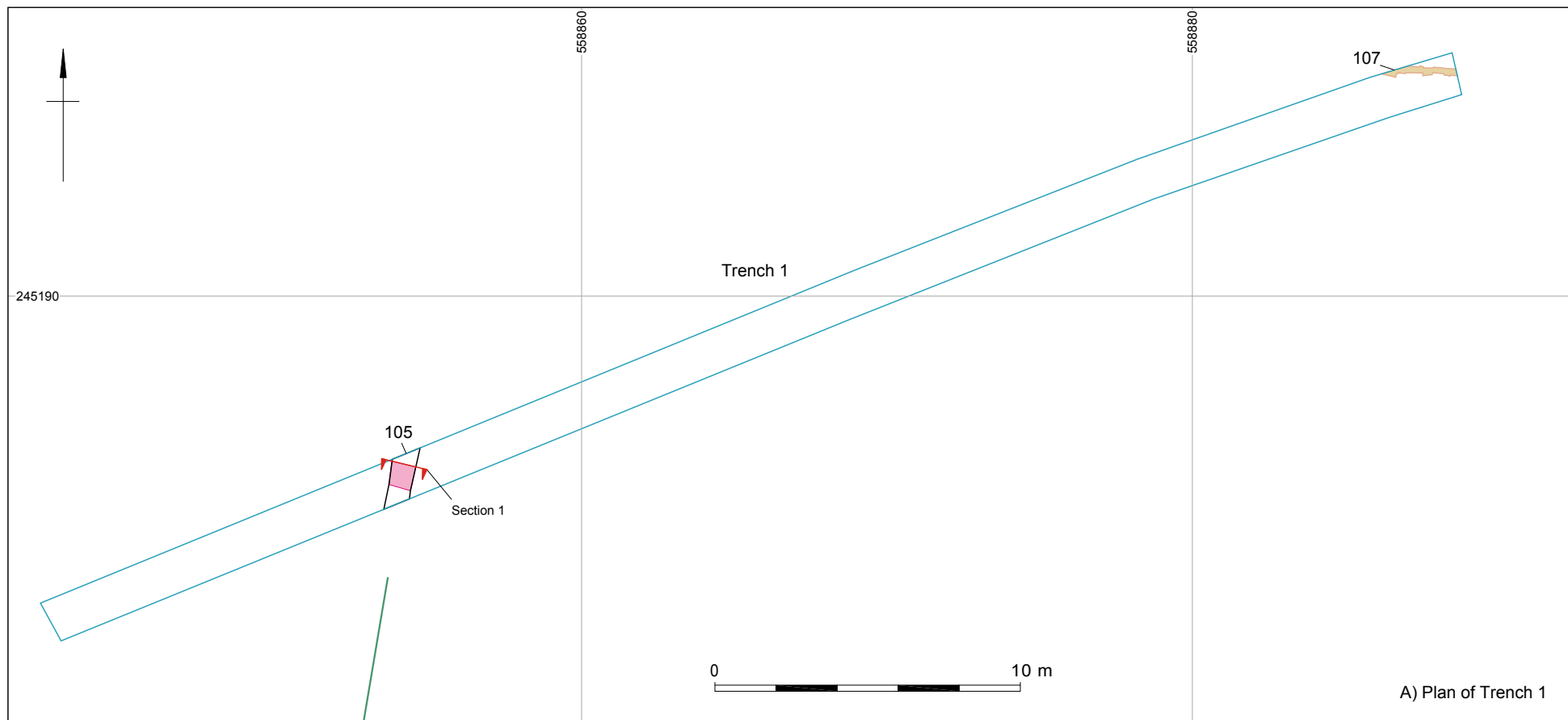

A) Plan of Trench 1

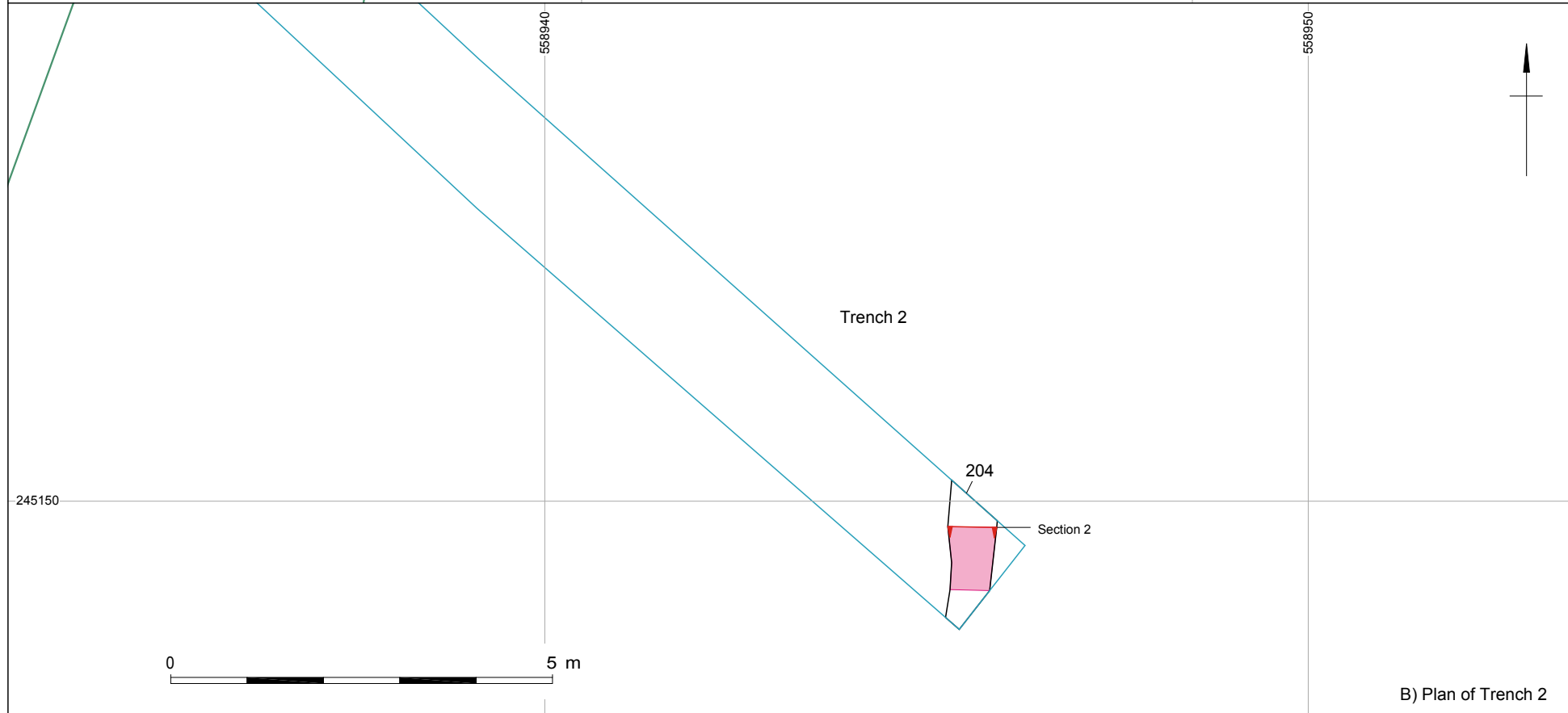
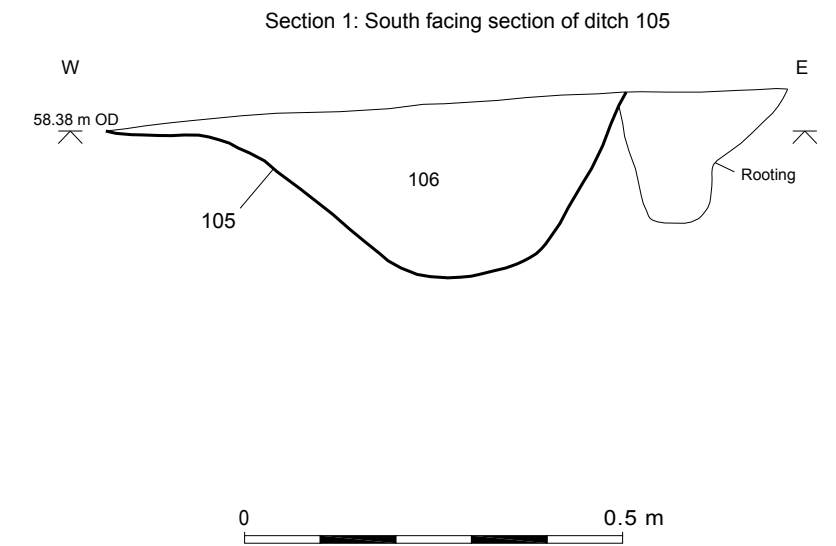

B) Plan of Trench 2

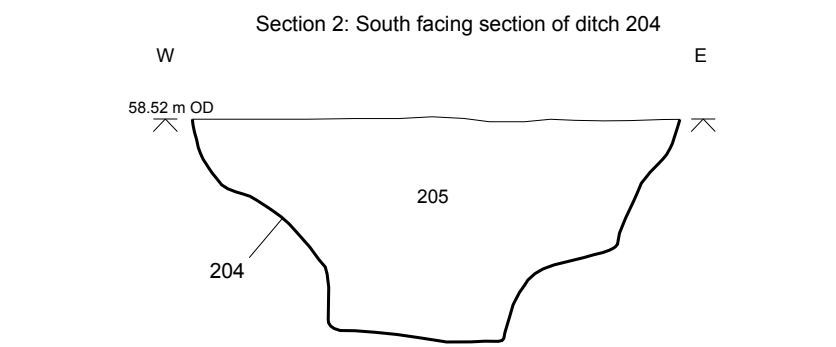

- Evaluation Trench
- Archaeology
- Wall
- Excavated Slot
- Section Line
- Geophysical Anomaly

This material is for client report only © Wessex Archaeology. No unauthorised reproduction.

Date:	16/10/2015	Revision Number:	1
Scale:	Plan A) 1:200 & Plan B) 1:80 @ A3 Sections 1:10 @ A3	Illustrator:	JC
Path:	R:\PROJECTS\110050\Graphics_Office\Rep figs\Eval\2015_10_16\110050_Eval.dwg		

Trench Plans

Figure 2



Plate 1: Trench 1 viewed from the northeast



Plate 2: Trench 1 southeast facing representative section



Plate 3: Southwest facing section of ditch 105



Plate 4: East facing view of wall 107



Plate 5: Trench 2 viewed from the southeast



Plate 6: Trench 2 southwest facing representative section



This material is for client report only © Wessex Archaeology.
No unauthorised reproduction.

Date:	18/08/2015	Revision Number:	0
Scale:	N/A	Illustrator:	JC
Path:	R:\PROJECTS\110050\Graphics_Office\Rep figs\Eval\2015_08_17\110050_Plates.cdr		



Plate 7: South facing section of ditch 204



Plate 8: Trench 3 viewed from the east



Plate 9: Trench 3 south facing representative section



Plate 10: Trench 4 viewed from the southeast



Plate 11: Trench 4 southwest facing representative section



This material is for client report only © Wessex Archaeology.
No unauthorised reproduction.

Date:	18/08/2015	Revision Number:	0
Scale:	N/A	Illustrator:	JC
Path:	R:\PROJECTS\110050\Graphics_Office\Rep figs\Eval\2015_08_17\110050_Plates.cdr		



Wessex Archaeology Ltd registered office Portway House, Old Sarum Park, Salisbury, Wiltshire SP4 6EB
Tel: 01722 326867 Fax: 01722 337562 info@wessexarch.co.uk www.wessexarch.co.uk



Wessex Archaeology Ltd is a company limited by guarantee registered in England, company number 1712772. It is also a Charity registered in England and Wales, number 287786; and in Scotland, Scottish Charity number SC042630. Our registered office is at Portway House, Old Sarum Park, Salisbury, Wiltshire SP4 6EB.