

**BUTLERS COTTAGE,
BECKHAMPTON**

BC99

NGR: SU 0877 6880

ARCHAEOLOGICAL WATCHING BRIEF

June 2004
Report No. 354
Author: D. Mayer



ARCHAEOLOGICAL CONSULTANCY, MANAGEMENT & FIELD SERVICES

CONTENTS

- 1 INTRODUCTION
- 2 PROJECT BACKGROUND
- 3 AIMS
- 4 METHODOLOGY
- 4 RESULTS

FIGURE LIST

- Figure 1 Location Plan
- Figure 2 Site Plan
- Figure 3 Sections

1 INTRODUCTION

1.1 This document sets out the details of an archaeological watching brief undertaken at Butler's Cottage, Beckhampton, Marlborough (NGR: 000000). The project was undertaken in accordance with the *Standards for Archaeological Assessment and Field Evaluation in Wiltshire* (WCC 1995), *Standard and Guidance for Archaeological Watching Briefs* issued by the Institute of Field Archaeologists (1994) and *Archaeological Guidance Paper 4: Archaeological Watching Briefs: (guidelines)* issued by English Heritage (London Region).

1.2 The watching brief was undertaken by Clare King BA under the direction of Mr R. King BA MIFA who has wide experience of performing, monitoring and managing fieldwork projects throughout Britain, and is a member of the Institute of Field Archaeologists (AoC Archaeological Field Practice).

2 PROJECT BACKGROUND

2.1 The archaeological works were undertaken in response to an application by Mr R P Clarke to excavate a hole to contain a sewage pump and a trial hole to ascertain whether the existing foundations at the cottage would support a second floor. The archaeological condition was imposed in the event that the groundworks might reveal previously unknown archaeological features or deposits.

2.2 Butler's Cottage is situated within an area recognised as being of high archaeological significance. The present building is Listed Grade II.

3 AIMS

3.1 The aims of the archaeological recording were to gather high quality data from the direct observation of archaeological deposits in order to provide sufficient information to establish the nature, extent, preservation and potential of any surviving archaeological remains.

4.2 These aims were achieved through pursuit of the following specific objectives:

- i) to define and identify the nature of archaeological deposits on site, and date these where possible;
- ii) to attempt to characterize the nature of the archaeological sequence and recover as much information as possible about the spatial patterning of features present on the site;
- iii) where possible to recover a well dated stratigraphic sequence and recover coherent artefact, ecofact and environmental samples.

4 METHODOLOGY

4.1 All groundworks were monitored and recorded (where health and safety considerations permitted) in order to identify any archaeological deposits that might be present. All site recording was undertaken in accordance with Foundations Archaeology Technical Manual 3 (Excavation Manual).

5 RESULTS

5.1 The holes were excavated to an average depth of 0.3m. The stratigraphy consisted of a 0.08m thick layer of concrete overlying a dark brown/black, loamy soil containing modern brick. Part of The groundworks were not sufficiently deep to reach the natural substrate.

5.2 No archaeologically significant features were identified within either hole. aligned section of the trench.

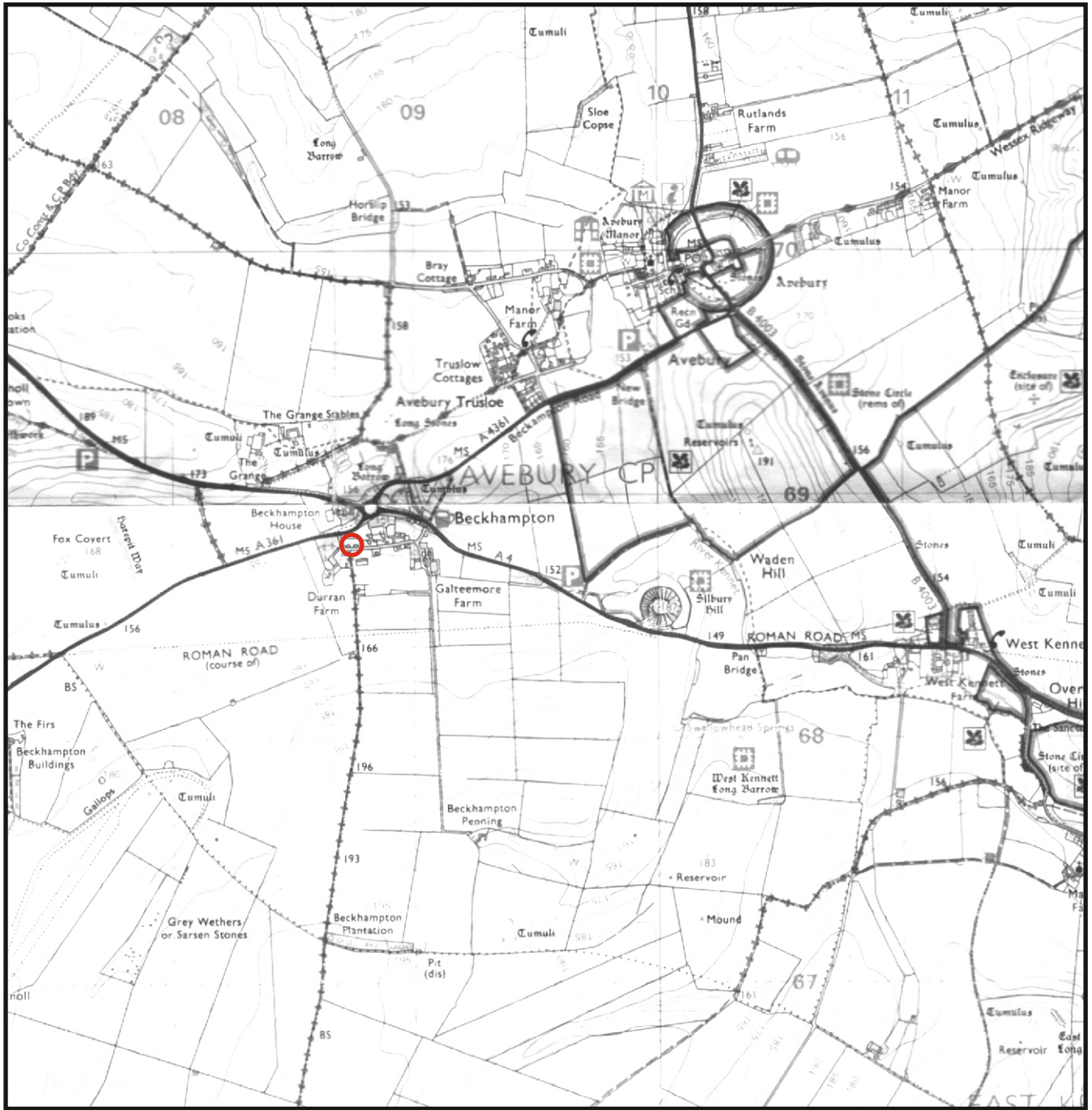

© Crown Copyright
 Reproduced under licence AL523064A

FIGURE 1: Site Location

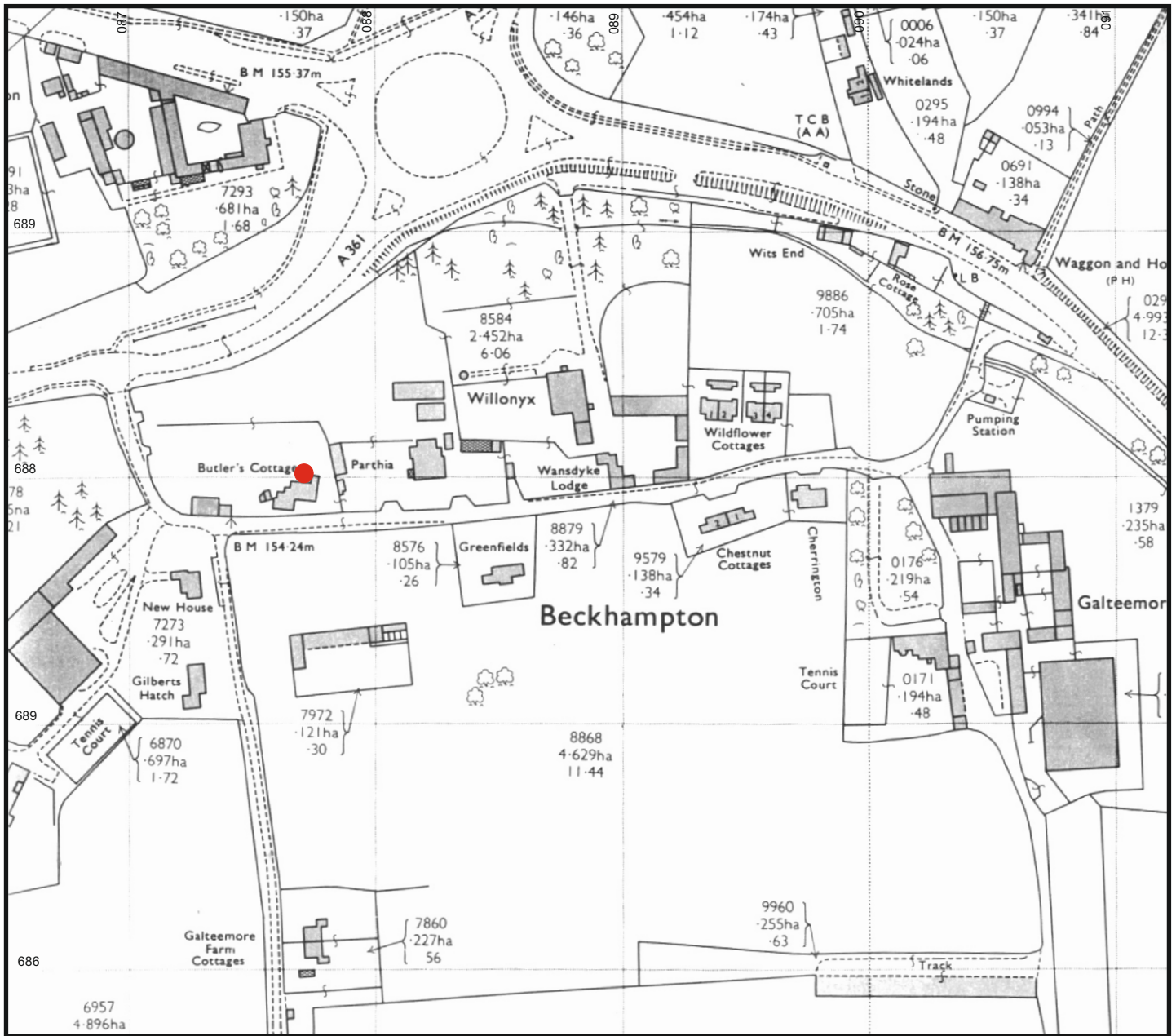

© Crown Copyright
 Reproduced under licence AL523064A



FIGURE 2: Study Area Location

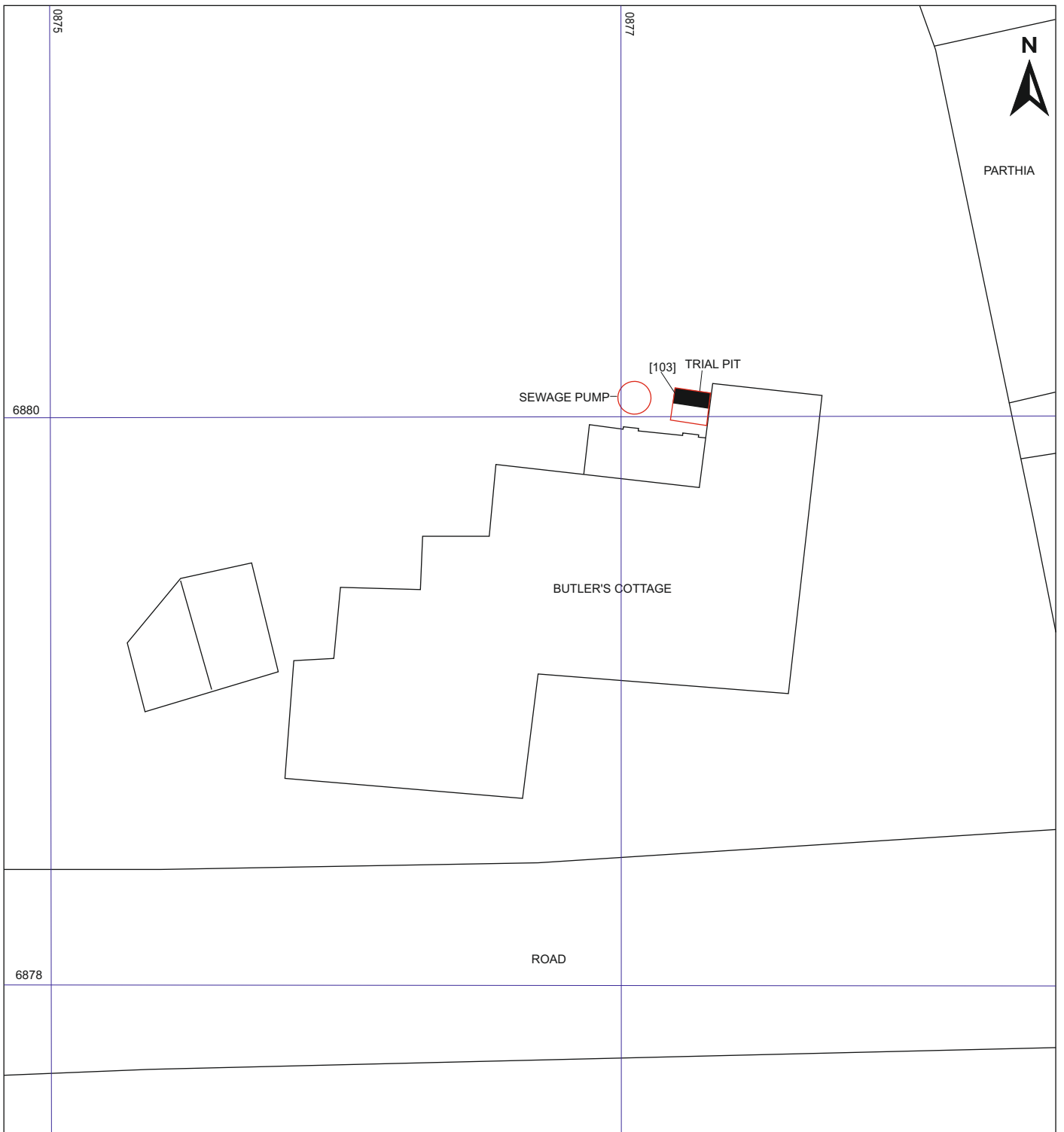

FIGURE 3: Pit Locations