



## Feature recording (1.1)

1C20WRBTT / 43 / 55 / 5505 / Small linear

Complete

Score	5.17%	Failed items	0	Actions	0
-------	-------	--------------	---	---------	---

Site 1C20WRBTT, HS2-C,  
Northamptonshire

Field number 43

Trench number 55

In the following provide a very brief description of the feature , eg, pit, grave, linear transect cut. This will be used in the archaeological report

### Feature description

Small linear

FeatureID= This is the parent context number of the feature, for example the pit which contains the pit fills, the grave cut that contains the coffin , fills and skeleton. A feature may comprise a single context for example un-bounded spread, in which case the Feature ID and the single context number recorded below would be the same. FEATUREID IS A WHOLE NUMBER DO NOT USE DECIMALS

Feature ID (Parent context) 5505

### Feature photos



Photo 1

## Feature dimensions in meters

Length

Width 1.32

Depth 0.3

Diameter

## Feature sketch plan

Sketch plan: This should be broadly representative of the feature and any relevant surroundings. You may sketch the feature and/or its relation to other notable features on the site . If a sketch is done, indicate on the scale area (top right of sheet) the rough scale of your drawing and add a north arrow, but remember this is a sketch not a measured plan. Press the 'Annotate' button to begin a drawing

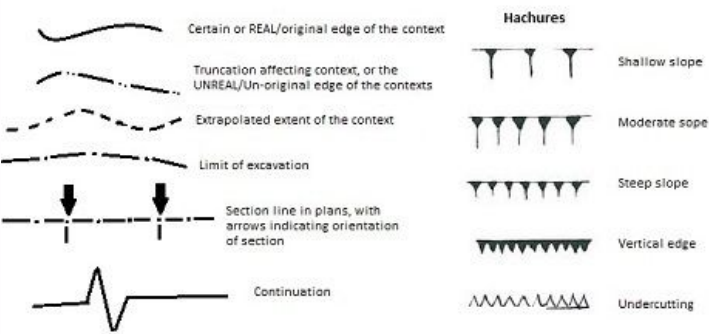

- 7703 Cut numbers - bold text
- 7702 Fills & deposits numbers - regular text
- 7632 Structure numbers - regular underlined text
- 7654 Section numbers - italic text
- 7654 Sample number regular Orange
- 7865 Find numbers regular blue
- 8765 Monolith sample numbers regular green

Sketch

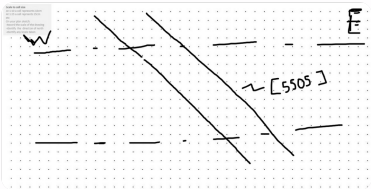

Section recording

Record here the direction the section is facing

Section facing	N
Levels OD Top	
Levels OD Bottom	
Section photos	
Section sketch	

Sketch of section: This drawing should represent an accurate profile of a cut feature or elevation of an upstanding feature and the relative depth, or height, along with the relationships of cuts, fills layers and structures. A simple example section is shown here with attention drawn to the vertically measured points to draw profile and fill surfaces.

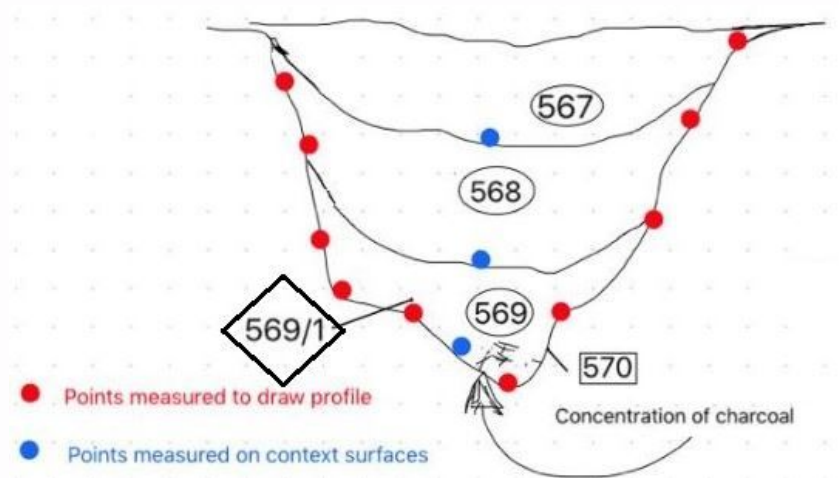

Use the Arrette drawing app installed on this iPad to make the drawing. Ensure that the ends of your section line and their alignment are shown, and please use a thicker lines for the parent context profiles and/or structures (e.g. facing of a wall), and thinner ones for other context divisions. Once you have finished your drawing in the Arrette app, Click project > Click on current doc, and set document name to be that of the parent context (s) shown, separated by a space e.g. 123 134. Finally click 'Share'>'JPEG to your photos', to add the images to the photo roll on that iPad. Once done come back to this audit and upload your newly created JPEG

#### Upload section sketch

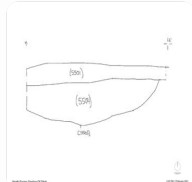

Photo 2

#### Comments

Recorded by	A.R.K
Record date	15 Jan 2021 08:53 GMT
Account name (leave)	Mpad 5

## Stratigraphy and constituent contexts

5.17%

Stratigraphy and constituent contexts

Enter here all the stratigraphic (not physical) relationships in this feature as pairs of upper and lower contexts. Use the green button to enter as many pairs as required. Contexts are always WHOLE NUMBERS do not use decimals

## Stratigraphic relationships in this feature

### Stratigraphic relationships in this feature 1

Upper context	5501
---------------	------

Lower context	5502
---------------	------

### Stratigraphic relationships in this feature 2

Upper context	5504
---------------	------

Lower context	5505
---------------	------

### Stratigraphic relationships in this feature 3

Upper context	5503
---------------	------

Lower context	0
---------------	---

## Contexts making up this feature

5.17%

### Contexts making up this feature 1

4.94%

Context number	5504
----------------	------

These are the other contexts with which this context is in contact or is the same as

### Physical relationships

Fills	5505
-------	------

Filled by
-----------

Cuts
------

Cut by
--------

Overlies
----------

Overlain by	5502
-------------	------

Abutts
--------

Part of
---------

Same as
---------

## Description and interpretation

Your interpretation is a simple elaboration on the basic interpretation if absolutely necessary.

### Your interpretation

Small linear ditch

Your discussion. Here you can explain why you have come to this conclusion, if the rationale is not self evident. It is the most important of your responses

### Your discussion

A small linear ditch to the east of a larger boundary [5509]

### Context dimensions

Record this only if the context's dimensions differ markedly from those of the features a whole. As a minimum, record the depth of fills

#### Length

Width 0.94

Depth 0.3

#### Diameter

### Context sketch plan

Record this only if the contexts plan differs markedly from that of the feature as a whole

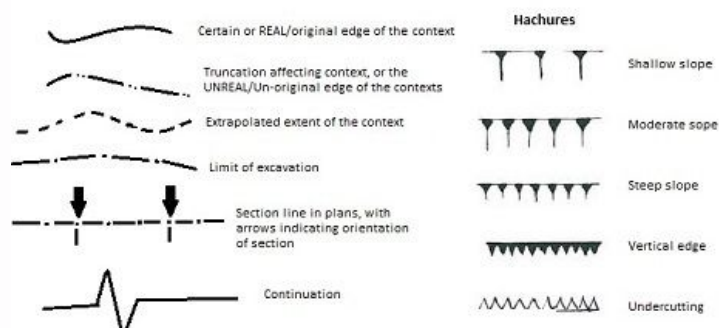

**7703** Cut numbers - bold text

7702 Fills & deposits numbers - regular text

7632 Structure numbers - regular underlined text

*7654* Section numbers - italic text

7654 Sample number regular Orange

7865 Find numbers regular blue

8765 Monolith sample numbers regular green

## Sketch

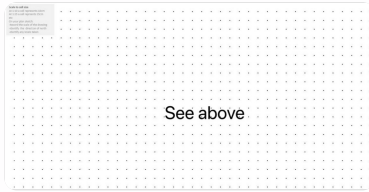

## Context type

Fill or deposit

## Context composition

4.94%

This section has three components, a) The soil matrix of which the context comprises and it's degree of compaction, b) major inclusions and c) minor inclusions.

Soil matrix. Choose the composition of the soil present. example. refer to the diagram if necessary. For contexts almost entirely composed of find or environmental material , choose other, and note the material in the succeeding sections.

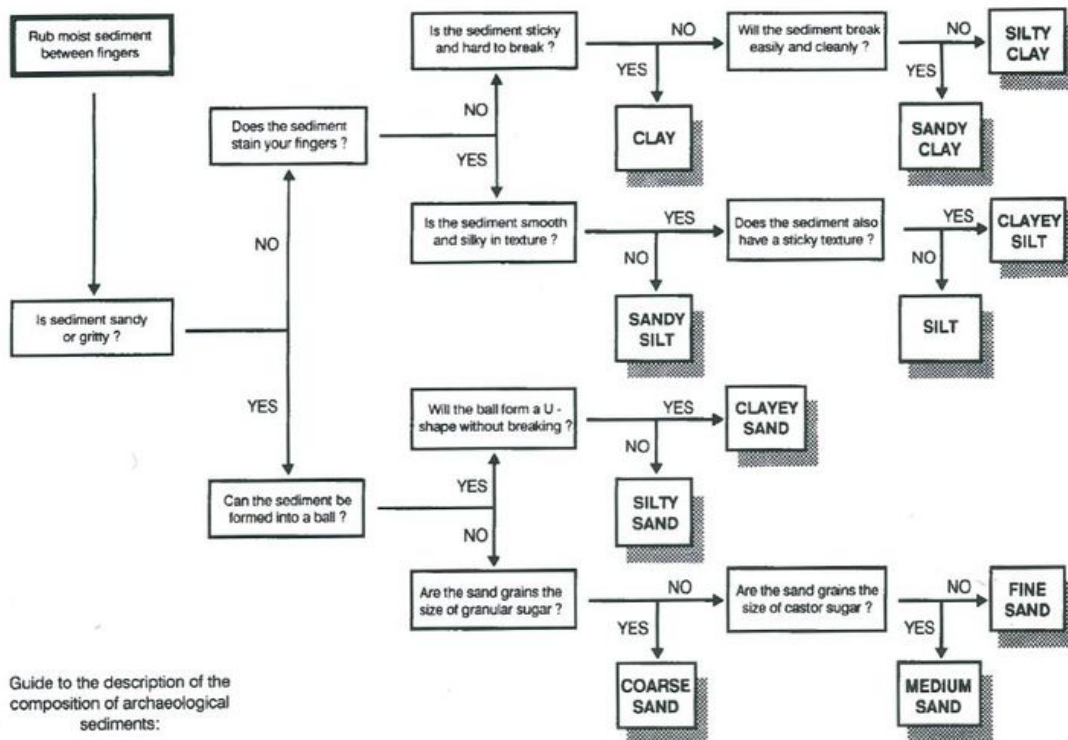

## Soil composition

Clayey silt

Soil consistency describes properties of the deposit when handled. Sandy deposits are cemented , compact or loose, while more clayey and silty deposits are typically firm, plastic or friable.

- ▶ A deposit which is **cemented** requires a mattock to excavate and clumps cannot be broken by hand once they have been removed.
- ▶ A deposit which is **compact** requires a mattock to excavate but clumps can be broken by hand once they have been removed.
- ▶ A deposit which is **loose** can be excavated with a trowel or hoe.
- ▶ A deposit which is **hard** cannot be moulded and a clump will break, rather than bend, when enough force is applied.
- ▶ A deposit which is **firm** can be moulded by hand under strong pressure.
- ▶ A deposit which is **plastic** can be easily moulded and bent.
- ▶ A deposit which is **friable** cannot be moulded and will crumble under pressure.

#### Soil consistency

Firm

Major inclusions are finds and environmental materials which make up more than 10 % of the context and will typically be bagged up as bulk finds. Tick all that apply and if necessary add a note to the inclusion description.

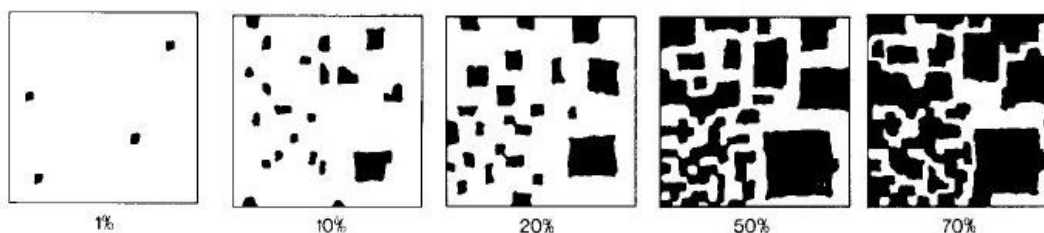

#### Major artefactual inclusions

#### Major environmental or natural inclusions

Minor Inclusion are find or environmental elements that make up less than 10% tick all that apply, and if necessary add a note to the inclusion description.

#### Minor artefactual inclusions

#### Minor environmental or natural inclusions

#### Degree of sorting

3.99%

Sorting is a measure of the frequency with which particles of the same size occur.

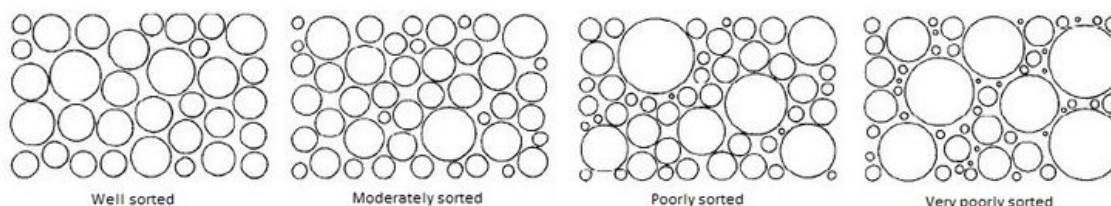

#### Sorting

Moderately

Sizing - use the sliders to indicate the diameter in mm from the smallest to the largest

**Smallest stone size(mm)**

**5**

From 5 to 200

**Largest stone size(mm)**

**10**

From 5 to 200

**Colours**

100%

**Main colour**

Brown

**Colour hue**

Yellowish

**Colour tone**

Mid

**Other colour notes**

Boundary to the next horizon. This should always refer to the lower boundary of the deposit that is described, and not the upper, since the latter may have been truncated

**Boundary edge**

Clear - change occurs within 25-60mm

**Boundary character**

Smooth - boundary surface is plane with few irregularities

**Contexts making up this feature 2**

100%

**Context number**

**5505**

These are the other contexts with which this context is in contact or is the same as

**Physical relationships**

**Fills**

**Filled by**

5504

**Cuts**

Natural 5503

**Cut by**

**Overlies**

**Overlain by**

**Abutts**

**Part of**

**Same as**

**Description and interpretation**

Your interpretation is a simple elaboration on the basic interpretation if absolutely necessary.

**Your interpretation**

A diagonal linear through trench 055



Your discussion. Here you can explain why you have come to this conclusion, if the rationale is not self evident. It is the most important of your responses

Your discussion

Has only one fill. Perhaps linked to the larger enclosure ditch next to it [5509].

Context dimensions

Record this only if the context's dimensions differ markedly from those of the features a whole. As a minimum, record the depth of fills

Length

Width0.94

Depth0.3

Diameter

Context sketch plan

Record this only if the contexts plan differs markedly from that of the feature as a whole

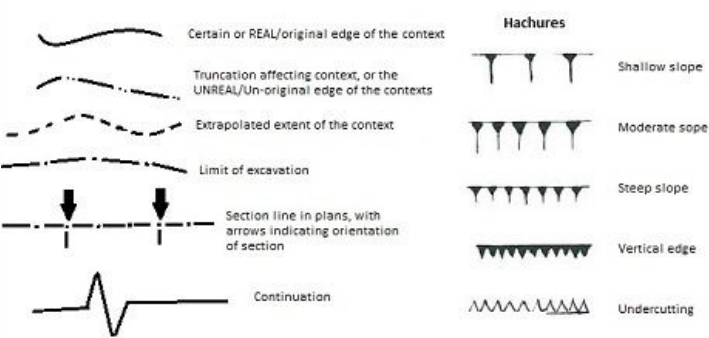

- 7703 Cut numbers - bold text
- 7702 Fills & deposits numbers - regular text
- 7632 Structure numbers - regular underlined text
- 7654 Section numbers - italic text
- 7654 Sample number regular Orange
- 7865 Find numbers regular blue
- 8765 Monolith sample numbers regular green

Sketch

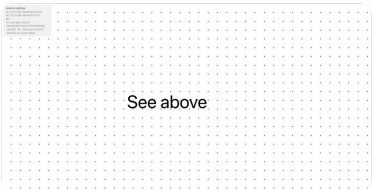

Context type

Cut

## Shape of the cut

100%

### Shape in plan

Linear-straight

### Orientation

SENW

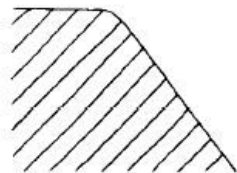

Sharp

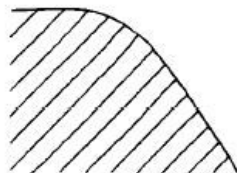

Gradual

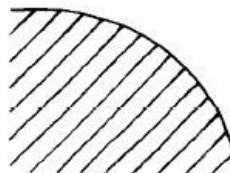

Not perceptible

### Break of slope - top

Sharp

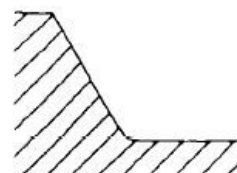

Sharp

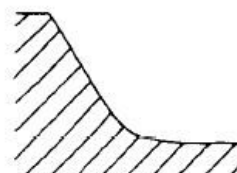

Gradual

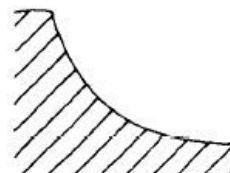

Not perceptible

### Break of slope - base

Gradual

### Profile type

Irregular

### Side form

Vertical



A tapered point



A tapered blunt point



A tapered rounded point



Vertical sides and a flat base



Vertical sides and an undulating base



Undulating sides and base

### Base form

Rounded

If a cut does not have it's original form and is truncated by later feature(s), tick this box and record something in the further notes field a note to say where and if possible, what is truncating it

### Truncated

No

### Further notes

## Record administration and sign off

### Record administration and sign off

IMPORTANT - This recording sheet should only have it's 'Person approving this record' and 'Date approved ' fields filled in when no more edits are necessary. Once this is done the sheet is then ingested into the Oracle system and any subsequent edits will need to be done therein.

Excavated by	A.R.K
Date excavation started	14 Jan 2021
Person approving this record	SAF
Date approved	17 Jan 2021

## Appendix

Appendix



Photo 1

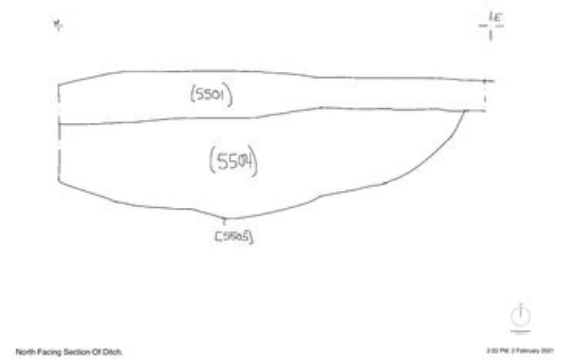

Photo 2