

HERITAGE NETWORK



Land North of HIGH STREET Paulerspury, Northamptonshire

HN937

ARCHAEOLOGICAL MONITORING REPORT

THE HERITAGE NETWORK LTD

Registered with the Institute of Field Archaeologists as an Archaeological Organisation

Archaeological Director: David Hillelson, BA MIFA

Land North of
HIGH STREET
Paulerspury, Northamptonshire

Project Ref.: HN937
LPA ref.: S/2010/0575/OUT

Archaeological Monitoring Report

Prepared on behalf of Taylor French Developments.

By

James Snee, BSc (HONS), AIFA

Report no. 727

June 2012

© The Heritage Network Ltd

11 FURMSTON COURT, ICKNIELD WAY, LETCHWORTH SG6 1UJ
TEL: (01462) 685991 FAX: (01462) 685998

Contents

	Summary.....	Page i
Section 1	Introduction.....	Page 1
Section 2	Fieldwork	Page 2
Section 3	Discussion.....	Page 4
Section 4	Schedule of site visits	Page 5
Section 5	Bibliography.....	Page 5
Section 5	Illustrations	<i>following</i> Page 6
Appendix	OASIS Data Entry.....	Page 7

The cover photograph shows the site prior during groundworks, looking west

Acknowledgements

The fieldwork for this project was carried out by James Snee. The report text and illustrations were prepared by James Snee, and edited by David Hillelson.

The Heritage Network would like to express its thanks to Taylor French Developments, the owners of the site, and Liz Mordue, Planning Archaeologist for Northamptonshire County Council, for their co-operation and assistance in the execution of this project.

Summary

Site name and address:	Land North of High Street, Paulerspury, Northamptonshire, NN12 7NA		
County:	Northamptonshire	District:	South Northamptonshire
Village/town:	Paulerspury	Parish:	Paulerspury
Planning reference:	S/2010/0575/OUT	NGR:	SP 71805 45570
Client name and address:	Taylor French Developments, George House, High Street, Tring, HP 23 4AF		
Nature of work:	Residential	Former land use:	Agricultural
Site status:	n/a	Reason for investigation:	Direction of LPA
Position in planning process:	Post-determination	Project brief originator:	Local Authority
Size of affected area:	3055 m ²	Size of area investigated:	813 m ²
Site Code:	HN937	Accession no.:	n/a
Organisation:	Heritage Network	Site Director:	David Hillelson
Project type, methods etc.:	Monitoring	Archive recipient:	unknown
Start of work	30/04/2012	Finish of work	23/05/2012
Related HER Nos:	n/a	Periods represented:	None
Oasis UID	heritage1-105600	Significant finds:	None
Monument types:	None		
Physical archive:	n/a		
Previous summaries/reports:	n/a		

Synopsis:

In response to a condition on the planning consent for the construction of five dwellings with associated garages, services and access road on land north of High Street, Paulerspury, Northamptonshire, the Heritage Network was commissioned by the developer to undertake a programme of archaeological monitoring of the development groundworks.

It was considered that the investigation had the potential to contribute to a number of regional research aims, including an increased understanding of the origins, form and development of Paulerspury as a dispersed medieval settlement, the processes of settlement desertion and shrinkage and the form and extent of Romano-British occupation in Paulerspury.

No archaeological features, deposits or artefacts were revealed during the course of the project.

1. Introduction

1.1 This report has been prepared on behalf of Taylor French Developments, as part of a programme of archaeological monitoring of a development site located on land north of High Street, Paulerspury, Northamptonshire.

1.2 Planning permission for the development (ref: S/2010/0575/OUT), granted by South Northamptonshire Council (SNC), was subject to an archaeological condition issued in line with the Department of Communities and Local Government's *Planning Policy Statement 5* (PPS5), since superseded by the *National Planning Policy Statement Framework* (NPPF). The extent of the work was defined in a *Brief for a Programme of Archaeological Strip, Map and Sample Investigation and Publication on Land to the North of the High Street, Paulerspury, Northamptonshire* issued by the planning department of Northamptonshire County Council, acting as advisers to the SNC.

1.3 Paulerspury is a village situated approximately 4.5km SE of Towcester in South Northamptonshire. The study area is located to the north of the High Street, west of the junction with Tews End Lane and covers a triangular plot of open ground, centred on NGR SP 71805 45570 (Figure 1). The site is bounded to the southeast by numbers 104-108 High Street, to the east by number 102a High Street and to the north by the Rectory and open fields.

1.4 The study area lies within a dispersed settlement of medieval origins, with possible remains of Romano-British settlement in the vicinity.

1.5 The development of the site involved the construction of five houses, public open space, new vehicular access and associated drainage and landscaping works.

2. Fieldwork

SITE TOPOGRAPHY AND GEOLOGY

2.1 Paulerspury lies in an area of open agricultural land, on the brow of a northeast facing promontory. The study area is located in the core of the village at a height of 125m AOD. It is centred at NGR SP 71805 45570.

2.2 Locally the soils belong to the Hanslope Association (411d), described as *Slowly permeable calcareous clayey soils. Some slowly permeable non-calcareous clayey soils.* (SSEW 1983). The underlying geology consists of Blisworth Limestone Formation – Limestone, overlain by Till (www.bgs.ac.uk/opengeoscience).

METHODOLOGY

2.3 Fieldwork consisted of a series of site visits to supervise the excavation of the access road, a soakaway and foundation trenches for five dwellings and associated garages (Figure 2, Plate 1).

2.4 The line of the access road was reduced using a tracked 360-degree excavator with a 2m wide toothless bucket; the soakaway and foundation trenches were machined using the same excavator, fitted with a 1.2m or 0.60m wide toothed bucket as appropriate.

2.5 All recording work was carried out in accordance with the approved Project Design, current health and safety legislation, and both IfA and ALGAO standards.

MONITORING AND RECORDING

Stratigraphy

2.6 The stratigraphy, which was uniform across the site, consisted of a lower deposit of grey clay (10YR 5/1) clay with moderate chalk fragments, which was observed up to 0.9m deep. This was overlain by approximately 1m of yellowish brown (10YR 5/8) clay, covered by 0.20m of yellowish brown (10YR 5/6) clayey silt subsoil. The uppermost deposit was 0.20m of dark greyish brown (10YR 3/2) sandy clayey silt topsoil (Plate 2).

Access Road Strip

2.7 The access road was reduced by approximately 0.50m at the junction with High Street, and 0.30m at the west end of the development, revealing the yellowish brown clayey silt subsoil (Plates 1 - 2). The southern end of the access road, close to High Street, had been disturbed by former gardens and recently demolished outbuildings.

2.8 No features, deposits or artefacts of archaeological significance were revealed in this area.

Soakaway

2.9 A rectangular soakaway, 1.2m in width and 12m in length, was located along the northern edge of the site, parallel to the northern boundary, and measured 1.7m deep at the west end and 1.3m at the east end. The sections revealed the stratigraphy described above (Plate 3).

2.10 No archaeological features, deposits or artefacts were revealed in the soakaway.

Footings trenches

2.11 The footings trenches for the five new dwellings and for three garages were excavated to depths between 1.6m and 2.3m below existing ground level. Their sections revealed the stratigraphy described above (Plates 4 – 8).

2.12 No archaeological features, deposits or artefacts were revealed in the footings trenches.

3. Discussion

ARCHAEOLOGICAL SETTING

3.1 Northamptonshire County Council HER was consulted on 26 July 2011 and a total of 67 monument records, 24 event records and 12 listed building records were found within a radius of 500m from the proposed development.

3.2 Casual finds of pottery and other material has suggested that Romano-British occupation existed in a number of places around Paulerspury. To the west of the present investigation site, in an area of grassland adjacent to the parish church, finds of coins and pottery (HER 4761/0/0) and a Romano-British ditch (HER 4761/0/1) may indicate the presence of a settlement from this period. Further coins were discovered to the south, close to Park Lane (HER 9529/0/0).

3.3 To the east of the proposed development, at Longcroft Lane, are a number of areas of possible Romano-British activity including settlement (HER 4757) and quarrying (HER 8323). Between the two is an area of undated iron working (HER 4756/1).

3.4 Paulerspury is mentioned in the Domesday survey of 1086 AD (Morris 1979) and appears to be a dispersed medieval settlement, possibly made up of a number of agricultural centres linked by a network of early roads or hollow ways (HER 4760). In the area around the medieval parish church, there are a number of earthworks that are indicative of medieval settlement, individual structures and property boundaries (HER 4760/1). The shrinkage of medieval villages is a common phenomenon and is believed to have been caused by the combination of a number of local factors, which have to be examined and understood in each individual case.

3.5 To the north of the development site is a hollow way (HER 4760/0/18), that originally ran from Tew's End Lane to Pury End Road. The road was abandoned in 1728 and its west end is shown on the 1st edition Ordnance Survey map as an earthwork.

CONCLUSIONS

3.6 It was considered that the investigation had the potential to contribute to a number of regional research aims, including an increased understanding of the origins, form and development of Paulerspury as a dispersed medieval settlement, the processes of settlement desertion and shrinkage and the form and extent of Romano-British occupation in Paulerspury.

3.7 No archaeological features, deposits or artefacts were revealed during the course of the present project.

Confidence Rating

3.8 Conditions on site were generally acceptable for the identification and recording of any potential archaeological remains, and as such there are no circumstances which would lead to a confidence rating for the work which was less than *High*.

4. Schedule of site visits

Date	Staff	Hours	Comments
30/4/12	JGS	8	Monitoring of access road strip.
1/5/12	JGS	3	Monitoring of access road strip.
2/5/12	JGS	4	Monitoring of access road strip.
3/5/12	JGS	6	Monitoring excavation of soakaway.
15/5/12	JGS	4	Monitoring excavation of Plot 1.
16/5/12	JGS	4	Monitoring excavation of Plot 5.
17/5/12	JGS	3	Monitoring excavation of Plot 4.
21/5/12	JGS	3	Monitoring excavation of Plot 3 and garage plots.
23/5/12	JGS	3	Monitoring excavation of Plot 2 and garage plots.

5. Bibliography

Cooper, N.J. (ed) 2006, *The Archaeology of the East Midlands*, Leicester Archaeology Monographs. 13

Dept. of Communities and Local Government, 2010, *Planning Policy Statement 5: Planning for the Historic Environment*. (TSO)

Dept. of Communities and Local Government, 2012, *The National Planning Policy Framework*. (TSO)

English Heritage, 1991, *Management of Archaeological Projects*. (HBMC)

English Heritage, 2006, *Management of Research Projects in the Historic Environment: The MoRPHE Project Managers' Guide*. (HBMC)

English Heritage, 2010, *Historic Environment Planning Practice Guide*. (HBMC)

Heritage Gateway, www.heritagegateway.org.uk

Institute for Archaeologists, 2008, *Standard and Guidance for an Archaeological Watching Brief*. (IfA)

Knight, D., Vyner, B. & Allen, C. forthcoming, *Research Agenda and Strategy for the Historic Environment of the East Midlands*

Morris, J. 1979, *Domesday Book; Northamptonshire*. Phillimore, Chichester.

6. Illustrations

Figure 1	Site Location
Figure 2	Site Layout
Plate 1	Access road strip at site entrance, looking north.
Plate 2	West end of access road strip, looking south.
Plate 3	Excavation for soakaway, looking east.
Plate 4	Plot 1 during excavation, looking east.
Plate 5	Footing trenches for plot 2, looking northwest.
Plate 6	Footing trenches for plot 3, looking northeast.
Plate 7	Footing trenches for plot 4, looking southeast.
Plate 8	Footing trenches for plot 5, looking north.

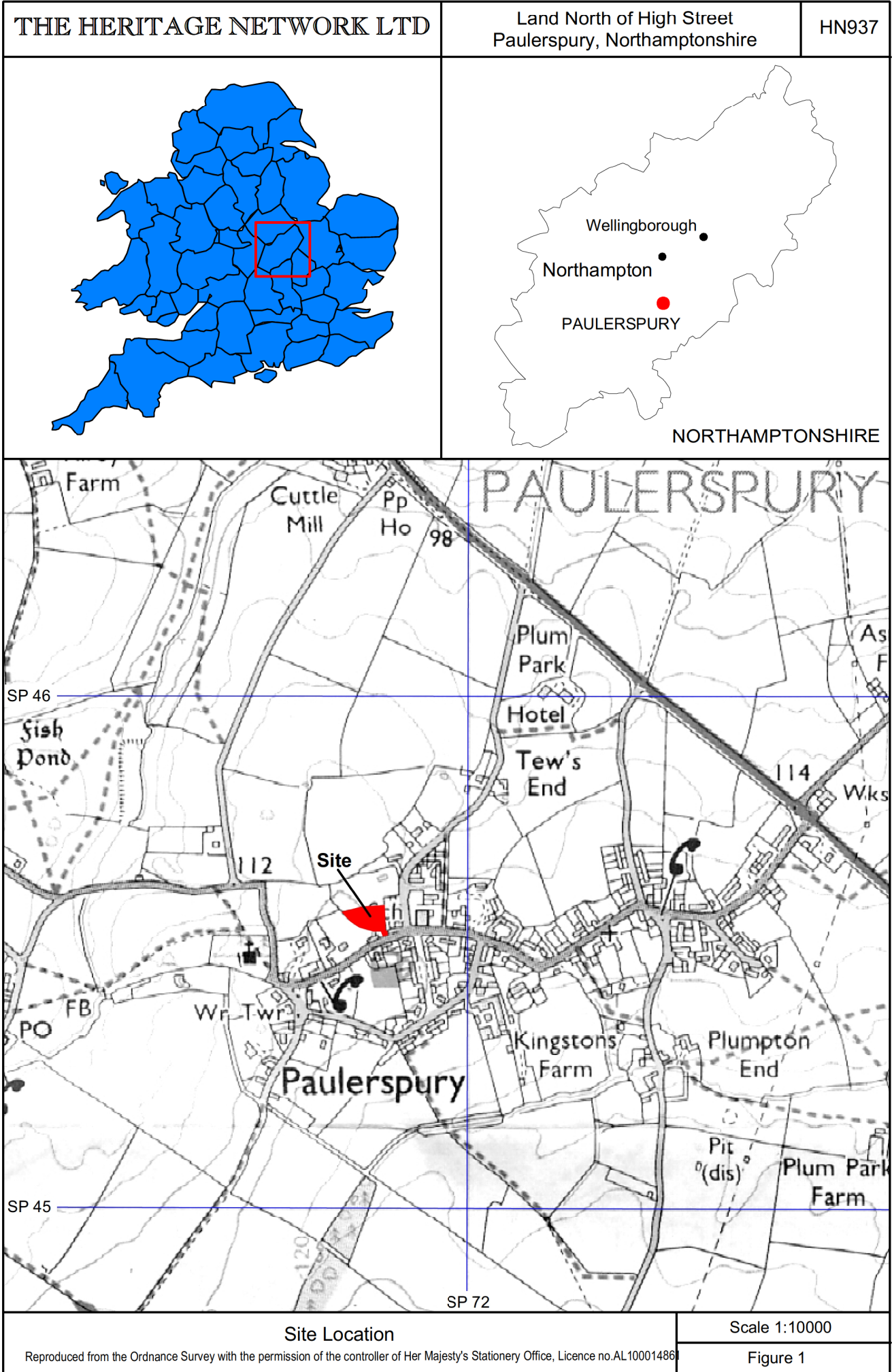

THE HERITAGE NETWORK LTD

Land North of High Street, Paulerspury, Northamptonshire

HN937

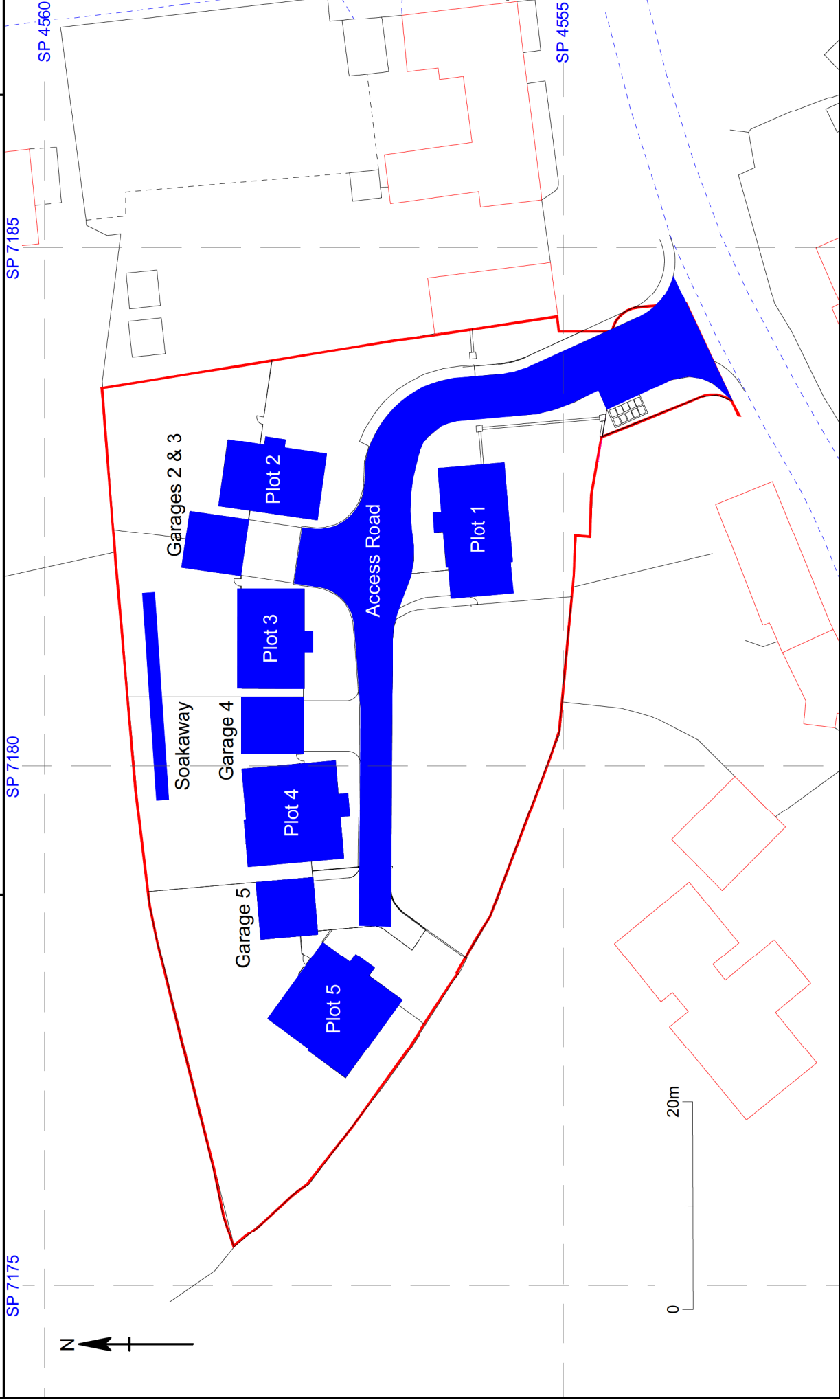

Site Layout

Scale 1:500
Figure 2



Plate 1: Access road strip at site entrance, looking north.



Plate 2: West end of access road strip, looking south.



Plate 3: Excavation for soakaway, looking east.



Plate 4: Plot 1 during excavation, looking east.



Plate 5: Footing trenches for plot 2, looking northwest.



Plate 6: Footing trenches for plot 3, looking northeast.



Plate 7: Footing trenches for plot 4, looking southeast.



Plate 8: Footing trenches for plot 5, looking north.

Appendix

OASIS ID: heritage1-105600	
Project details	
Project name	Paulerspury, land to north of High Street
Short description of the project	In response to a condition on the planning consent for the construction of five dwellings with associated garages, services and access road on land north of High Street, Paulerspury, Northamptonshire, the Heritage Network was commissioned by the developer to undertake a programme of archaeological monitoring of the development groundworks. It was considered that the investigation had the potential to contribute to a number of regional research aims, including an increased understanding of the origins, form and development of Paulerspury as a dispersed medieval settlement, the processes of settlement desertion and shrinkage and the form and extent of Romano-British occupation in Paulerspury. No archaeological features, deposits or artefacts were revealed during the course of the present project.
Project dates	Start: 30-04-2012 End: 23-05-2012
Previous/future work	No/Not known
Associated project reference codes	HN937 - Contracting Unit No.
Type of project	Recording project
Site status	None
Current Land use	Cultivated Land 1 - Minimal cultivation
Monument type	NONE None
Significant Finds	NONE None
Methods & techniques	'Watching Brief'
Development type	Housing
Prompt	Direction from Local Planning Authority - PPS
Position in the planning process	Post determination
Project location	
Country	England
Site location	NORTHAMPTONSHIRE SOUTH NORTHAMPTONSHIRE PAULERSPURY Land north of High Street
Postcode	NN12 7NA
Study area	813.00 Square metres
Site coordinates	SP 71805 45570 52 0 52 06 12 N 000 57 05 W Point
Height OD / Depth	Min: 125.00m Max: 125.00m
Project creators	
Name of Organisation	Heritage Network
Project brief originator	Local Authority Archaeologist and/or Planning Authority/advisory body
Project design originator	Heritage Network
Project director	David Hillelson
Project supervisor	James Snee
Type of sponsor/funding body	Development Corporation
Name of sponsor/funding body	Taylor French Developments
Project archives	
Physical Archive Exists?	No

Digital Archive recipient	Not Known
Digital Media available	'Images raster / digital photography','Text'
Paper Archive recipient	Not Known
Paper Media available	"Diary","Photograph"
Project bibliography 1	
Publication type	Grey literature (unpublished document/manuscript)
Title	Land North of HIGH STREET Paulerspury, Northamptonshire
Author(s)/Editor(s)	Snee, J.
Other bibliographic details	Heritage Network Report no. 727
Date	2012
Issuer or publisher	Heritage Network
Place of issue or publication	Letchworth Garden City
Description	A4 booklet, comb bound, green cover, 8 pages, 2 figures, 8 plates