



HERITAGE NETWORK



A21 LAMBERHURST BY-PASS Forstal Farm Bund

HN419

Archaeological Evaluation Report



THE HERITAGE NETWORK LTD

Registered with the Institute of Field Archaeologists as an Archaeological Organisation

Archaeological Director: David Hillelson, BA MIFA

A21 LAMBERHURST BY-PASS

Forstal Farm Bund

HN443

Archaeological Evaluation

Prepared on behalf of URS Corporation Ltd

by

David Hillelson, BA MIFA

Report no.227

March 2004

© The Heritage Network Ltd

12 ROYSTON ROAD, BALDOCK, HERTS. SG7 6NT

TEL: (01462) 893288 FAX: (01462) 893562

Contents

	Summary.....	Page i
Section 1	Introduction.....	Page 1
Section 2	Fieldwork	Page 2
Section 3	Discussion & Conclusion	Page 4
Section 4	Bibliography.....	Page 5
Section 5	Illustrations	<i>following</i> Page 5
Appendix 1	Trench record forms	<i>following</i> Page 6

Acknowledgements

The fieldwork for this project was carried out by Chris Turner and Mark Winter. The report text and illustrations were prepared by David Hillelson.

The Heritage Network would like to express its thanks to: Ron Henry, URS Corporation; Nigel Steer and Matt Childs, May Gurney; Peter Lingwood, CEC; and Casper Johnson, KCC Heritage Conservation Group, for their co-operation and assistance in the execution of this project.

Summary

Site name and address:	A21 Lamberhurst Bypass: Forstal Farm Bund		
County:	Kent	District:	West Kent
Village/town:	Lamberhurst	Parish:	Lamberhurst
Planning reference:	TW/03/1910	NGR (site centre):	568450 136970
Client name and address:	May Gurney Construction, Trowse, Norwich NR14 8SZ		
Nature of work:	Landscaping	Present land use:	Agriculture
Size of affected area:	2.25 hectares	Size of area investigated:	1020m ²
Site Code:	HN443	Other reference:	
Organisation:	Heritage Network	Site Director:	David Hillelson
Type of work:	Evaluation	Curating Museum:	Tunbridge Wells Museum
Start of work	02/04/2004	Finish of work	03/04/2004
Related SMR Nos:	n/a	Periods represented:	Modern
Previous summaries/reports:	Barber 1992; Turner and Saunders 2003		

Synopsis: In response to a condition placed on the planning permission for landscaping works at Forstal Farm, Lamberhurst, Kent, adjacent to the route of the A21 Lamberhurst Bypass, the Heritage Network was commissioned by May Gurney Construction, to undertake a programme of archaeological evaluation of the affected area.

Ten evaluation trenches were excavated, totalling 1020m². Modern ploughmarks and/or field drains were identified, but no archaeological features, deposits or artefacts.

1. Introduction

1.1 This report has been prepared on behalf of URS Corporation and May Gurney as part of a programme of archaeological works undertaken in advance of the construction of an earth bund adjacent to the new A21 Lamberhurst Bypass at Forstal Farm, Lamberhurst, Kent. Planning permission for the construction (ref. TW/03/1910) has been granted by Kent County Council subject to an archaeological condition issued in accordance with the provisions set out in the Department of the Environment's Planning Policy Guidance Note 16. The scope of the work was defined in consultation with the Heritage Conservation Group at Kent County Council (KCC), and detailed in the Heritage Network's approved Project Design dated November 2003.

1.2 The bund will lie along the eastern side of the new bypass route from its junction with the A262, running south for approximately 500m. The northern section of the bund lies within Field Plot 7 (centred on NGR 568350 137250) as defined in the Heritage Network's Archaeological Management Plan prepared for the bypass construction scheme. The southern section lies within Field Plot 11 (centred on NGR 568450 136970). It is the intention of the contractors to strip the topsoil from the study area before importing material from elsewhere on the bypass route to create the bund.

1.3 As part of the advance works for the bypass construction, potential earthworks were investigated in Plot 7 and interpreted as being of natural origin. The whole plot was later stripped of topsoil under archaeological supervision, but no archaeological features or deposits were identified. Further potential earthworks were investigated in Plot 11 which have also been interpreted as being of natural origin.

1.4 Because of the general paucity of archaeological data concerning the early settlement of this part of the Weald, and because of the likely impact of the topsoil stripping operation on any underlying archaeological remains, the Heritage Conservation Group at KCC considered that the archaeological potential of Plot 11 should be investigated further to assess the presence or absence of features, deposits and artefacts.

1.5 The aim of the present project has been to identify and record any archaeological features and deposits which may be uncovered; and to retrieve artefactual and ecofactual elements which would allow the date, character, and significance of the site to be assessed, subject to the limitations of reasonable safety and practicality.

1.6 The present Evaluation Report details the findings of the fieldwork and will be submitted to the Heritage Conservation Group at KCC. The report will allow them to consider whether the topsoil stripping can go ahead unhindered, whether further intervention is required, or whether the bund should be built up from the existing surface to allow for the protection in situ of identified archaeological remains.

2. Fieldwork

SITE TOPOGRAPHY AND GEOLOGY

2.1 The site is situated on land which slopes down from north-east to south-west towards the floodplain of the river Teise, between the 65m and the 45m contours. The field was previously laid to arable.

2.2 The underlying geology of the site is formed for the most part of Wadhurst Clay, the top metre of which commonly weathers to a stiff red clay. In the south-eastern quadrant of the site, the geology changes to fine grained sandstones and siltstones which form the Ashdown Beds.

METHODOLOGY

2.3 In accordance with Heritage Conservation Group *Brief*, a total of 1020m² of the 2.55 ha development site was sampled, representing a 4% sample by area. The trenches were located in a regular grid pattern across the site, with adjacent trenches laid out at right angles to each other to maximise the opportunities for isolating linear features.

2.4 A total of ten trial trenches were excavated, one measuring 60 x 2m and the remainder 50 x 2m. They were laid out by EDM and have been related to the Ordnance Survey national grid.

2.5 Within each trench, topsoil and overburden was removed down to the first potential archaeological horizon under close archaeological supervision, using a 360° tracked excavator fitted with a 2m toothless ditching bucket.

2.6 Spoil was visually scanned in order to assess the presence and survival of artefactual material in the overburden. A metal detector was also used.

2.7 Key information for each trench was recorded on standard pro-forma record cards which have been included in Appendix 1.

RESULTS

Stratigraphy

2.8 The stratigraphy was broadly similar across all ten trenches. It consisted of:

- topsoil of dark grey brown (10 YR 4/2) silty clay, measuring between 0.18 and 0.30m in depth;
- a subsoil of grey brown (10 YR 5/4) silty clay, measuring between 0.08m in depth (trenches 1-2);
- a subsoil of grey reddish brown (2.5 Y 5/4) silty clay, measuring between 0.10 and 0.20m in depth (trenches 3-10);
- undisturbed natural of yellow (10 YR 7/6) stiff clay mottled with grey (trenches 1-2);
- undisturbed natural of reddish brown (5 YR 5/3) stiff clay mottled with grey (trenches 3-10).

Archaeological features and deposits

2.9 Land drains and/or plough marks were observed in all the excavated trenches.

2.10 No archaeological features or deposits were observed.

Concordance of finds

2.11 No artefacts were identified or recovered from any trench, suggesting an absence of archaeological activity on this site.

3. Discussion & Conclusion

3.1 Fieldwalking of the Lamberhurst Bypass route in 1992, by the Field Archaeology Unit of the Institute of Archaeology, University of London, revealed no significant archaeological evidence within the present field. Two undiagnostic sherds, which were considered to be of probable medieval date, were collected, but nothing further.

3.2 The investigation of possible earthwork features in the same field, by the Heritage Network in 2003, also failed to reveal any significant archaeological evidence.

3.3 In the course of the present evaluation, no archaeological features, deposits or artefacts were identified.

Conclusion

3.4 The evaluation of the site suggests that any human activity in the vicinity in the past was ephemeral, leaving little or no surviving physical evidence.

3.5 The overall risk that the proposed development will encounter or disturb archaeological remains of any significance may be considered to be Very Low.

Confidence Rating

3.6 The field team employed on the evaluation were familiar with the site and with the ground conditions before the start of works. The prevailing weather conditions were acceptable for the identification of potential features and deposits, and for their investigation, being dry but overcast. There were no circumstances which would lead to a confidence rating for the work which was less than High.

4. Bibliography

Barber, L, 1992, *An Archaeological Evaluation of the Proposed Route of the Lamberhurst Bypass, Kent*. Institute of Archaeology, UCL

Hillelson, D, 2003 *A21 Lamberhurst Bypass – Forstal Farm Bund*. Project Design: Archaeological Evaluation. Heritage Network.

Johnson, C, 2003 *Specification for the Archaeological Evaluation of land at Forstal Farm, Lamberhurst, Kent*. Kent County Council.

Turner, C & Saunders, G, 2003 *A21 Lamberhurst Bypass: Phase 1 Archaeological Evaluation Report*. Heritage Network.

5. Illustrations

Figure 1 Site location

Figure 2 Trench layout

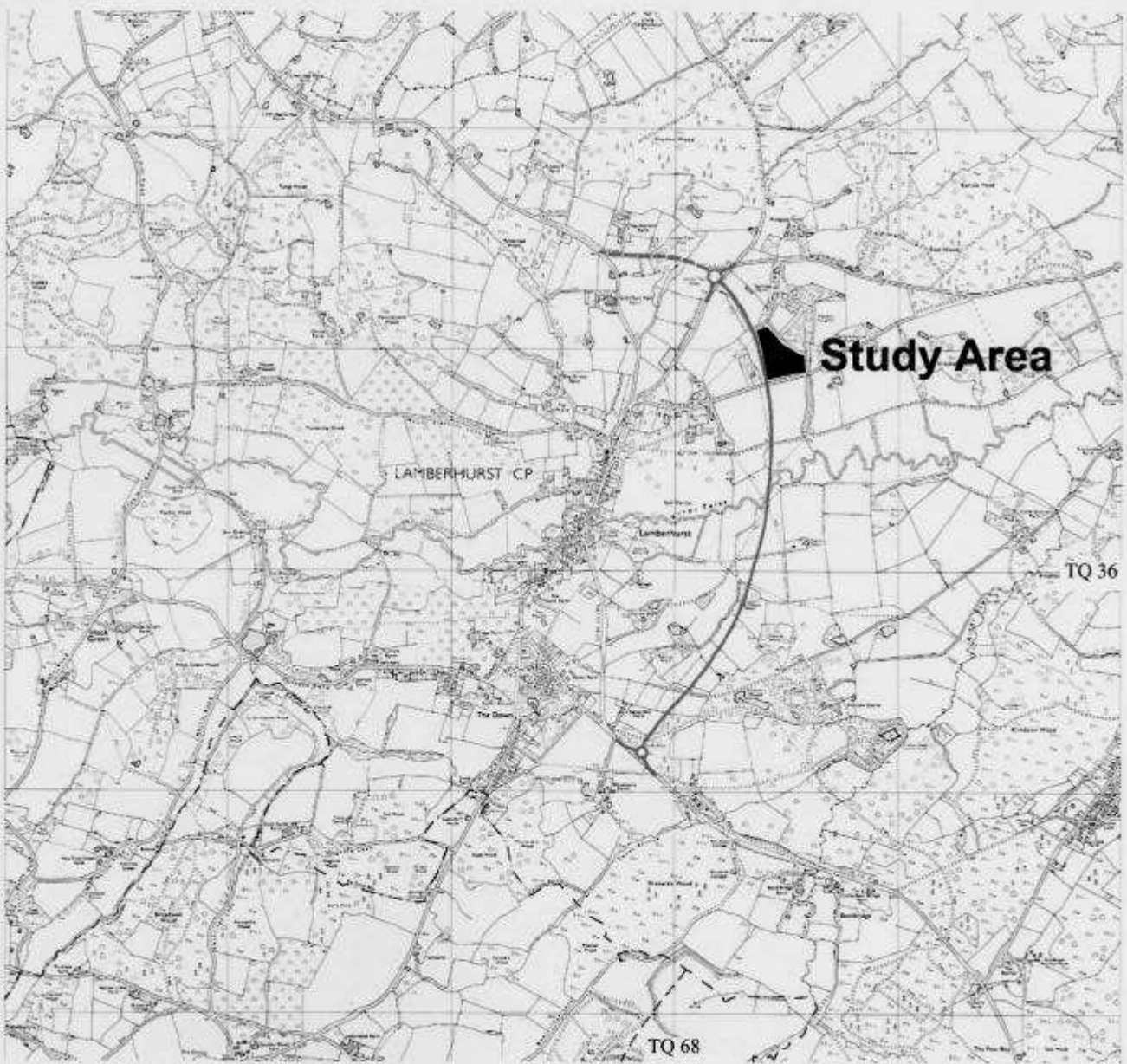
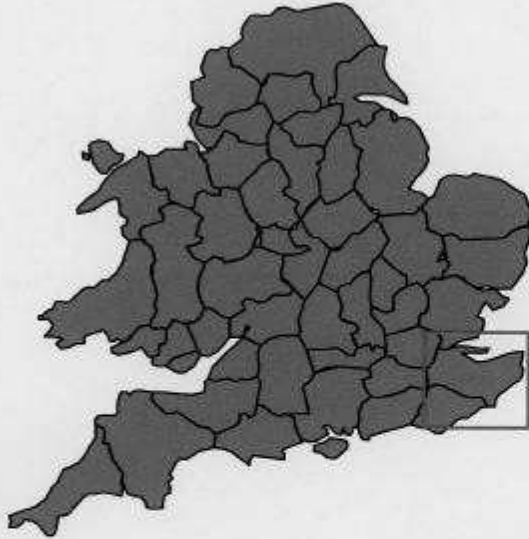

Site Location

Scale 1:30000

Figure 1

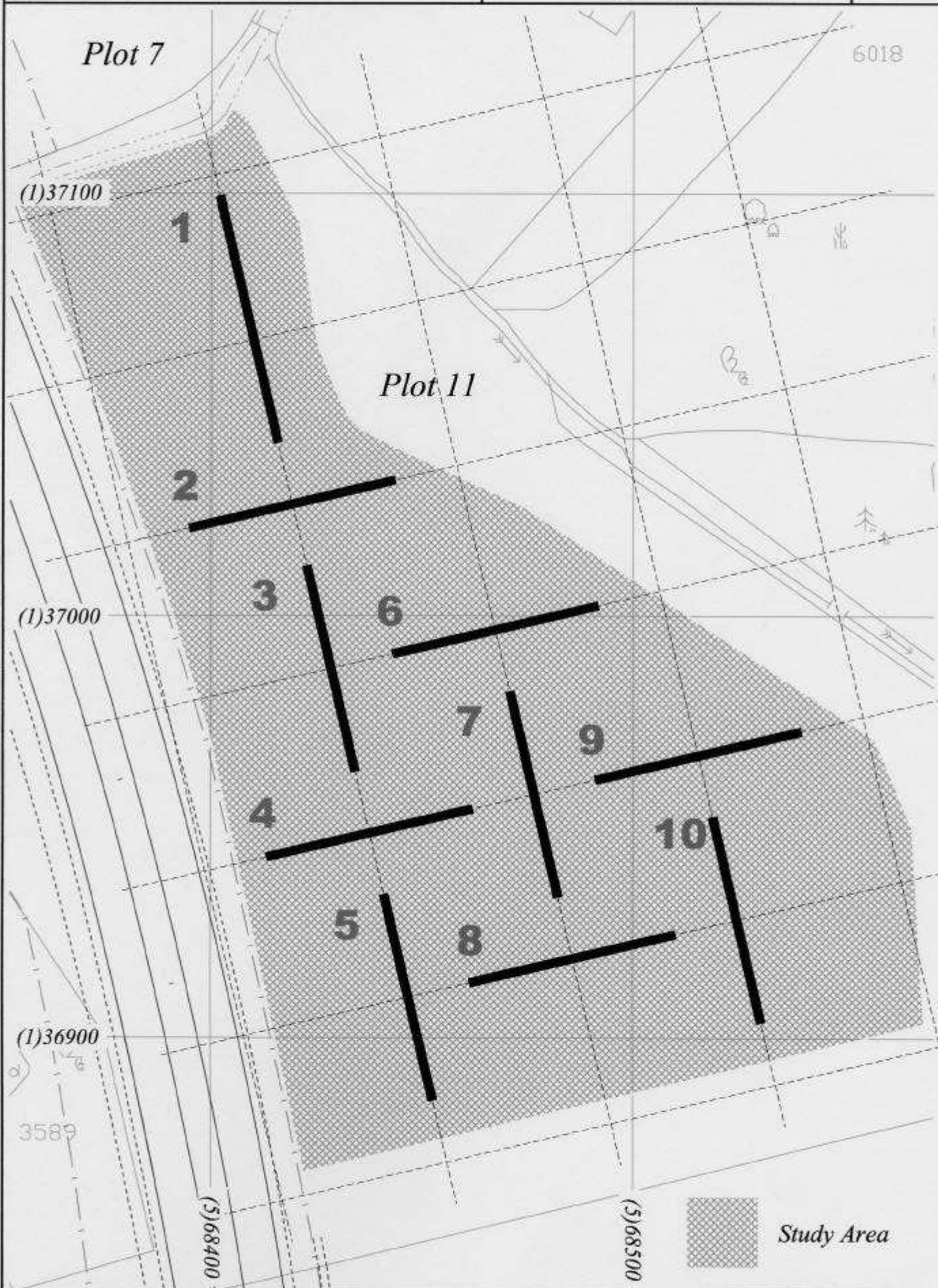

Trench Layout

Scale 1:1250

Figure 2

Appendix 1

Trench Record Forms

SITE CODE 443	Site Name	Sub-division	Orientation	TRENCH No 1
	Length	Width	Depth	
	Machine Type	Bucket Size		
	FORESTAL FARM BUND	-	NNW-SSE	
	60M	2 m	0.40m	
	360°	2 m		

Topsoil/ Overburden				
Colour	Composition			Depth
DARK COLOUR BROWN	SILT			0.29
10YR 4/2				
Subsoil				
Colour	Composition			Depth
GREY BROWN	SILT CLAY			0.08m
10YR 5/4				
Natural				
Colour	Composition			Depth
10YR 7/6	STIFF CLAY MOTTLED WITH GREY			-
Observations (circle)	Archaeology	Root activity	Structure	Contaminatio
	Bur'd horizon	Burrows	Services	Flooding
			Unstable	Blank
			Other: LAND BOUND	
			PLUGH	

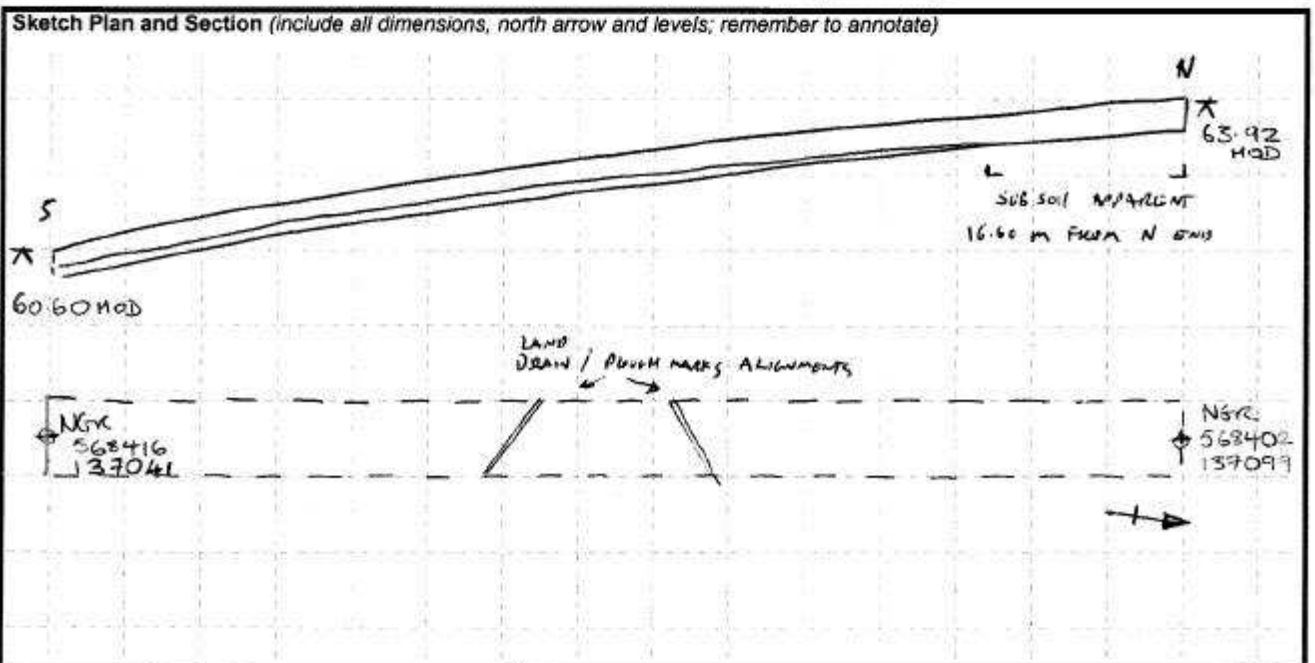

Discussion and interpretation

- **BLANK - NO ARCHAEOLOGY**
- **TRUE ROOT ACTIVITY**

Contexts	-			Signature	CT
Finds	-			Date	3/3/04
Plan no.	-	Photo (b/w)	-	Checked	[Signature]
Section no.	-	Photo (colour)	-	Cont.	
Levelled	<input checked="" type="checkbox"/>	Located	<input checked="" type="checkbox"/>	Samples	<input checked="" type="checkbox"/>
Weather conditions	OVERCAST				

SITE CODE 443	Site Name FORSTAL FARM RIND	Sub-division —	Orientation ENE - WSW	TRENCH No 2
	Length 50m	Width 2M	Depth 0.40	
	Machine Type 3600	Bucket Size 2M		

Topsoil/ Overburden						
Colour Dark Grey Brown 10YR 4/2	Composition SILTY CLAY	Depth 0.26				
Subsoil						
Colour Grey Brown 10YR 5/4	Composition SILTY CLAY	Depth 0.08				
Natural						
Colour 10YR 7/6	Composition SILTY CLAY MOTTLED WITH GREY	Depth —				
Observations (circle)	Archaeology	Root activity	Structure	Contaminatio	Unstable	Other: LAMS
	Bur'd horizon	Burrows	Services	Flooding	Blank	PLOUGH

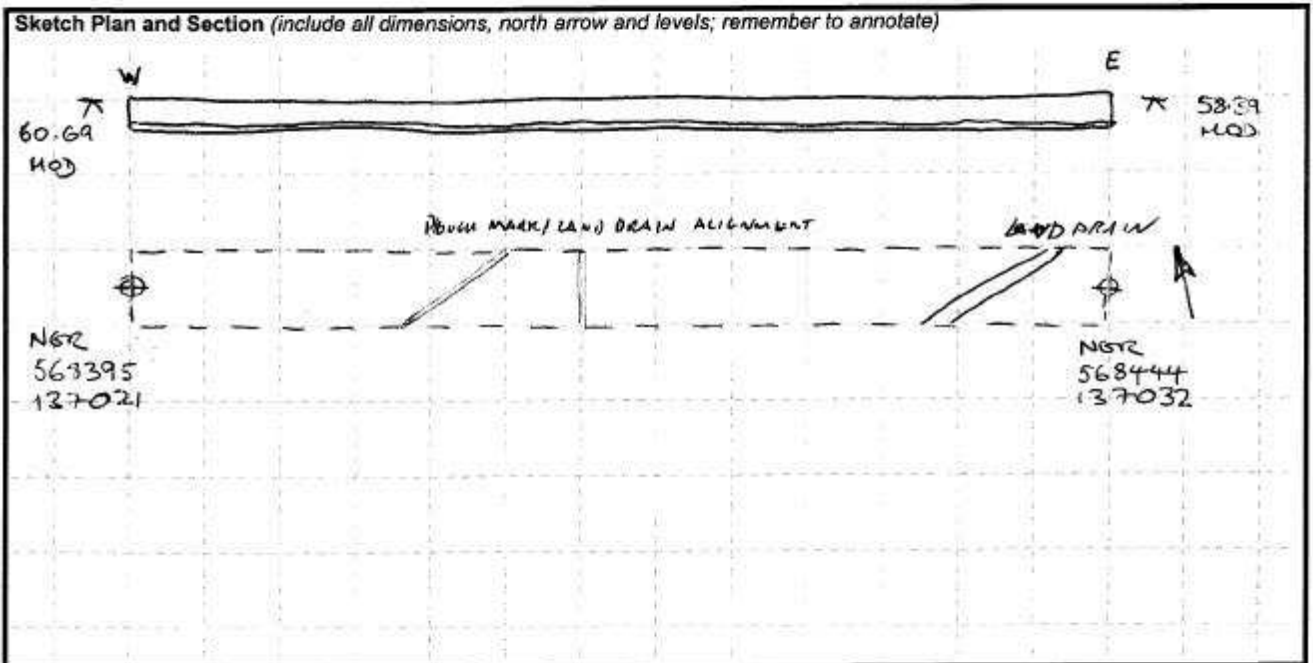

Discussion and interpretation

• **BLANK - NO ARCHAEOLOGY**

Contexts	—			Signature	CT
Finds	—			Date	3/3/04
Plan no.	—		Photo (b/w)	<input checked="" type="checkbox"/>	Checked
Section no.	—		Photo (colour)	<input checked="" type="checkbox"/>	or
Levelled <input checked="" type="checkbox"/>	Located <input checked="" type="checkbox"/>	Samples	—		Cont.
Weather conditions OVERCAST					

SITE CODE 443	Site Name FORSTAL FARM BUND		Sub-division —	Orientation NNW-SSE	TRENCH No 3
	Length 50M	Width 2M	Depth 0.27-0.36		
	Machine Type 360°		Bucket Size 2M		

Topsoil/ Overburden						
Colour DARK GREY BROWN	Composition SILTY CLAY				Depth 0.20	
Subsoil						
Colour GREY REDDISH BROWN	Composition SILTY CLAY				Depth 0.10	
Natural						
Colour LIGHT BROWN	Composition CLAY WITH GREY MOTTLES				Depth —	
Observations (circle)	Archaeology	Root activity	Structure	Contaminatio	Unstable	Other: LAND DRAIN
	Bur'd horizon	Burrows	Services	Flooding	Blank	Plough

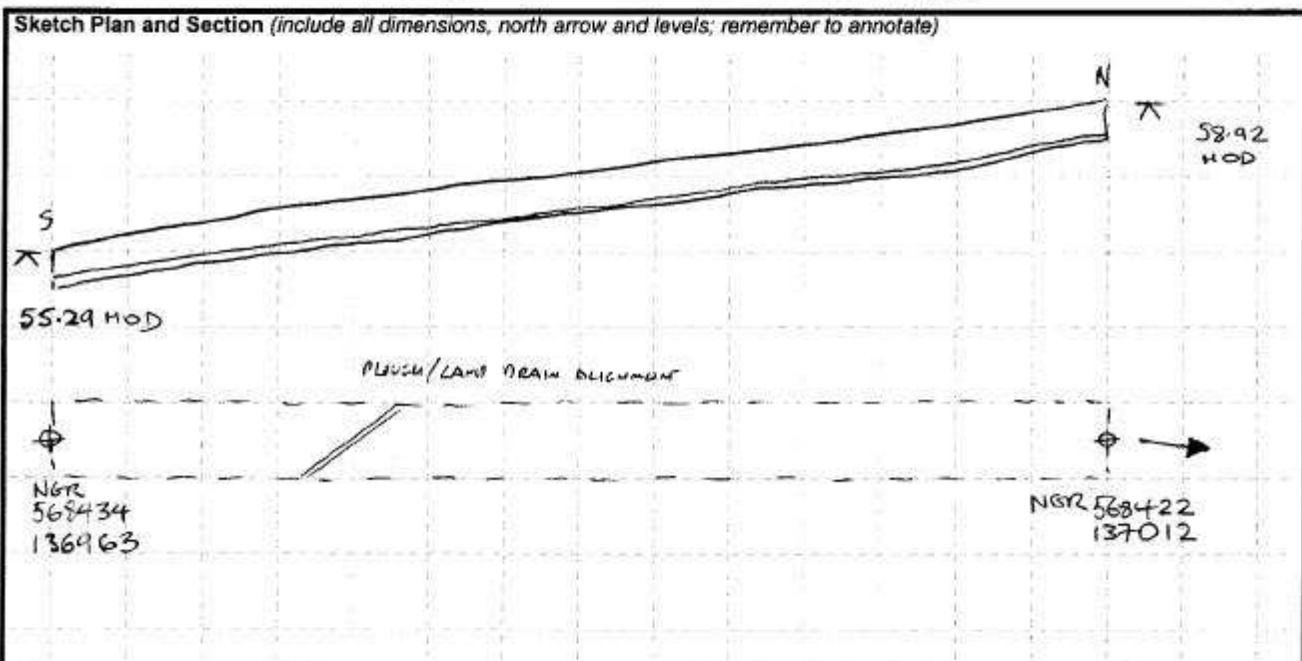

Discussion and interpretation	
• BLANK - NO ARCHAEOLOGY	

Contexts		-	
Finds		-	
Plan no.	-	Photo (b/w)	<input checked="" type="checkbox"/>
Section no.	-	Photo (colour)	<input checked="" type="checkbox"/>
Levelled <input checked="" type="checkbox"/>	Located <input checked="" type="checkbox"/>	Samples	-
Weather conditions OVERCAST			Signature CT
			Date 4/3/04
			Checked d
			Cont.

SITE CODE 443	Site Name	Sub-division	Orientation	TRENCH No 4
	FORSTAL FARM BUND		ENE-WSW	
	Length 50M	Width 2M	Depth 0.35	
	Machine Type 360°	Bucket Size 2M		

Topsoil/ Overburden								
Colour DARK GREY BROWN	Composition		Depth					
10 YR 4/2	SILT CLAY		0.18					
Subsoil								
Colour GREY REDDISH BROWN	Composition		Depth					
Z.5 7 S/4	SILT CLAY		0.10					
Natural								
Colour REDDISH BROWN	Composition		Depth					
#5Y 5/3	CLAY WITH GREY MOTTLES		-					
Observations (circle)	Archaeology	Root activity	Structure	Contaminatio	Unstable	Other:		
	Bur'd horizon	Burrows	Services	Flooding	Blank			

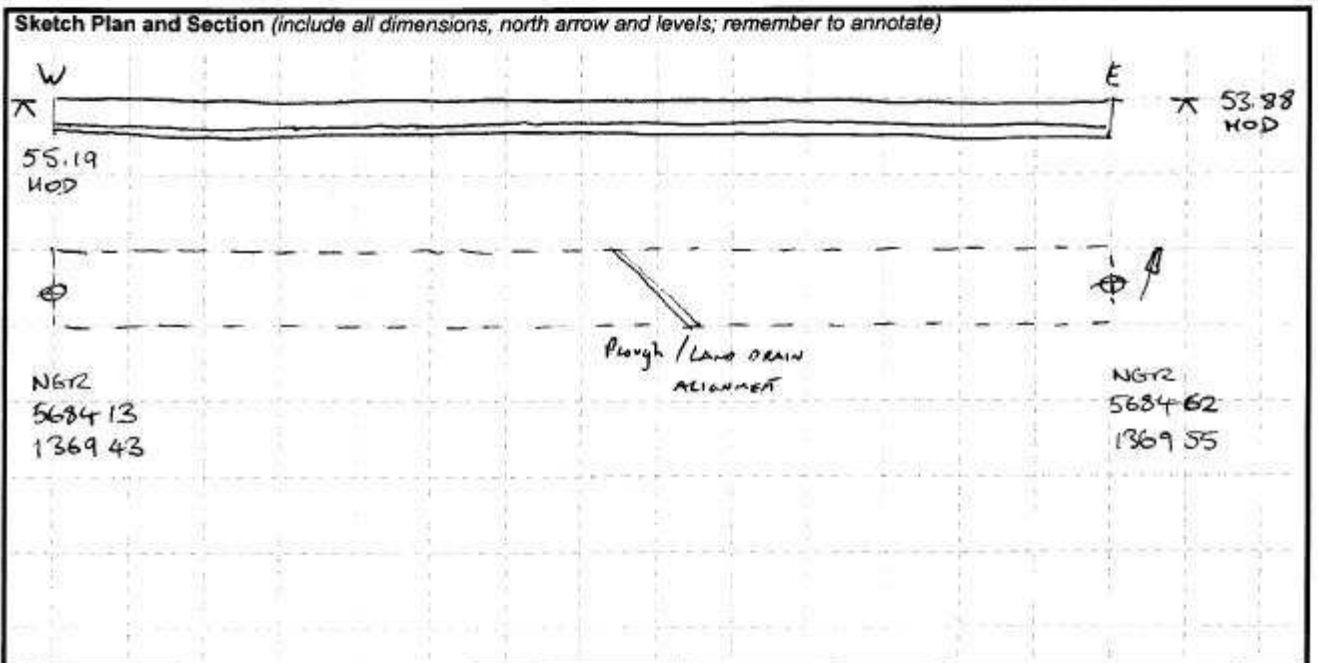

Discussion and interpretation

BLANK - NO ARCHAEOLOGY

Contexts	-			Signature	CT
Finds	-			Date	4/3/04
Plan no.	-	Photo (b/w)	<input checked="" type="checkbox"/>	Checked	<input checked="" type="checkbox"/>
Section no.	-	Photo (colour)	<input checked="" type="checkbox"/>	Cont.	
Levelled	<input checked="" type="checkbox"/>	Located	<input checked="" type="checkbox"/>	Samples	-
Weather conditions	OVERCAST				

SITE CODE 443	Site Name FORSTAL FARM BOND	Sub-division ---	Orientation NNW-SSE	TRENCH No 5
	Length 8.50M	Width 2M	Depth 0.40	
	Machine Type 360°	Bucket Size 2M		

Topsoil/ Overburden						
Colour dark grey brown 10YR 4/2	Composition silt clay				Depth 0.18-0.25	
Subsoil						
Colour grey brown 2.5 Y 5/4	Composition silt clay				Depth 0.12	
Natural						
Colour reddish brown + light brown 5Y 8/3 + 10YR 7/6	Composition clay with gravel				Depth ---	
Observations (circle)	Archaeology	Root activity	Structure	Contaminatio	Unstable	Other: land drain
	Burd horizon	Burrows	Services	Flooding	Blank	

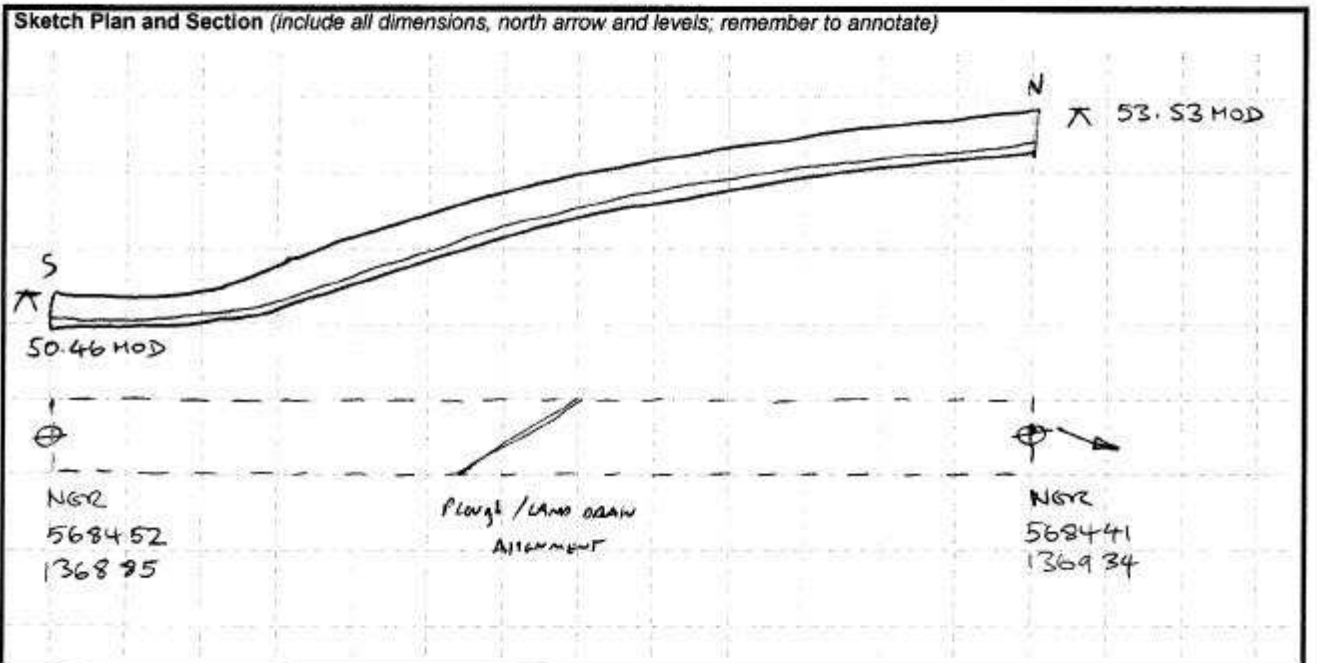

Discussion and interpretation

• **BLANK - NO ARCHAEOLOGY**

Contexts	-		
Finds	-		
Plan no.	Photo (b/w)	<input checked="" type="checkbox"/>	Signature CT
Section no.	Photo (colour)	<input checked="" type="checkbox"/>	Date 4/3/04
Levelled <input checked="" type="checkbox"/>	Located <input checked="" type="checkbox"/>	Samples -	Checked [initials]
Weather conditions OVERCAST			Cont.

SITE CODE 443	Site Name FURSTAL FARM BUND		Sub-division —	Orientation ENE - WSW	TRENCH No 6
	Length 50 m	Width 2 m	Depth 0.45		
	Machine Type 360°		Bucket Size 2 m.		

Topsoil/ Overburden								
Colour DARK GREY BROWN 10 YR 4/2		Composition SILT CLAY		Depth 0.30				
Subsoil								
Colour REDDISH BROWN 2.5 Y 5/4		Composition SILT CLAY		Depth 0.17				
Natural								
Colour LIGHT BROWN 5 Y 5/3		Composition CLAY + GREY MOTTLES		Depth —				
Observations (circle)	Archaeology	Root activity	Structure	Contaminatio	Unstable	Other:
	Burd horizon	Burrows	Services	Flooding	Blank	Plough

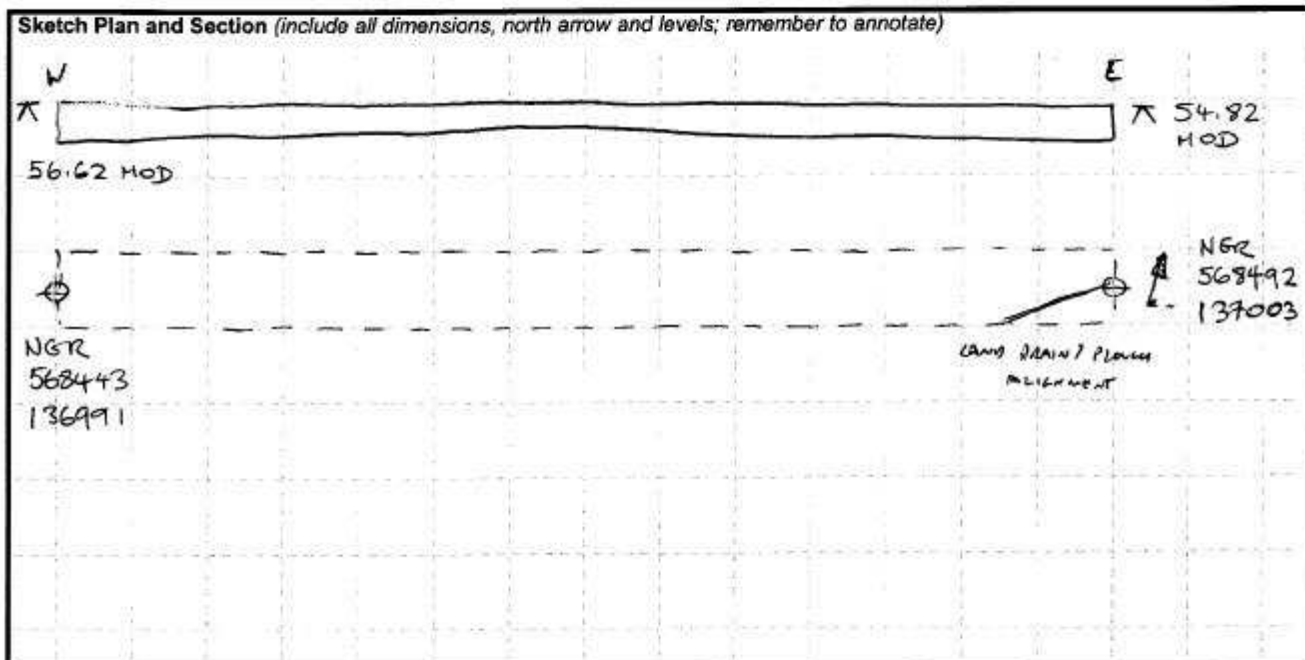

Discussion and interpretation

• BLANK - NO ARCHAEOLOGY

Contexts	—			Signature	CT
Finds	—			Date	4/3/04
Plan no.	—	Photo (b/w)	—	Checked	J
Section no.	—	Photo (colour)	—	Cont.	
Levelled <input checked="" type="checkbox"/>	Located <input checked="" type="checkbox"/>	Samples	—		
Weather conditions					OVER CAST

SITE CODE 443	Site Name	Sub-division	Orientation	TRENCH No 7
	FORSTAL FARM BUND.		NNW-SSE	
	Length 50 m	Width 2m	Depth 0.50	
	Machine Type 360'	Bucket Size 2m		

Topsoil/ Overburden								
Colour DARK GREY BROWN	Composition	Depth						
70 YR 4/2	SILT + CLAY	0.18						
Subsoil								
Colour REDDISH BROWN	Composition	Depth						
2.5 Y 5/4	SILTY CLAY	0.20						
Natural								
Colour LIGHT REDDISH BROWN	Composition	Depth						
5 Y 5/3	CLAY + GREY MOTTLES	-						
Observations (circle)	Archaeology	Root activity	Structure	Contaminatio	Unstable	Other:		
	Bur'd horizon	Burrows	Services	Flooding	Blank	CLAY DRAG		

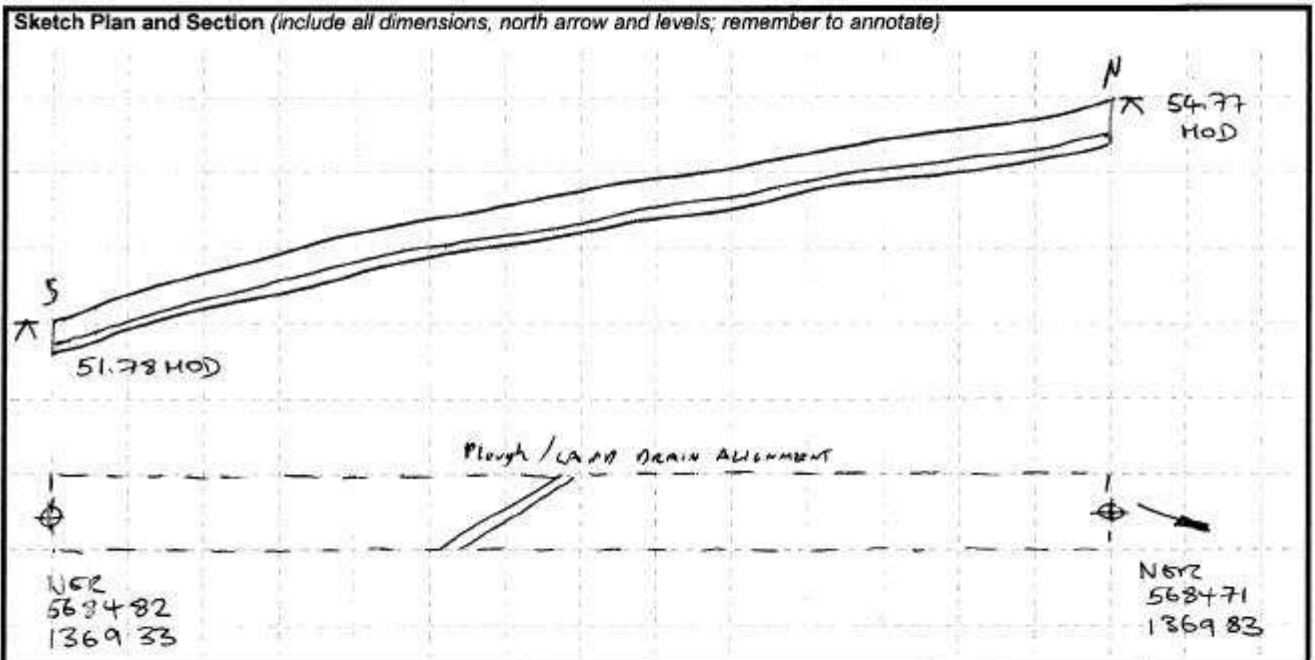

Discussion and interpretation

BLANK - NO ARCHAEOLOGY.

Contexts	-			Signature	CT
Finds	-			Date	4/3/04
Plan no.	-	Photo (b/w)	-	Checked	[initials]
Section no.	-	Photo (colour)	-	Cont.	
Levelled	<input checked="" type="checkbox"/>	Located	<input checked="" type="checkbox"/>	Samples	-
Weather conditions	OVERCAST.				

SITE CODE 443	Site Name FONSTAL FARM BUND		Sub-division —	Orientation ENE-WSW	TRENCH No 8
	Length 50m	Width 2m	Depth 0.44		
	Machine Type 360°		Bucket Size 2m		

Topsoil/ Overburden						
Colour DARK GREY BROWN 10YR 4/2		Composition SILTY CLAY		Depth 0.26		
Subsoil						
Colour ROOBYN BROWN 2.5Y 5/4		Composition SILTY CLAY		Depth 0.13-0.20		
Natural						
Colour LIGHT BROWN 5Y 5/3		Composition CLAY + GREY MOTTLES		Depth —		
Observations (circle)	Archaeology	Root activity	Structure	Contaminatio	Unstable	Other: LANG. DRAW
	Bur'd horizon	Burrows	Services	Flooding	Blank	Plough

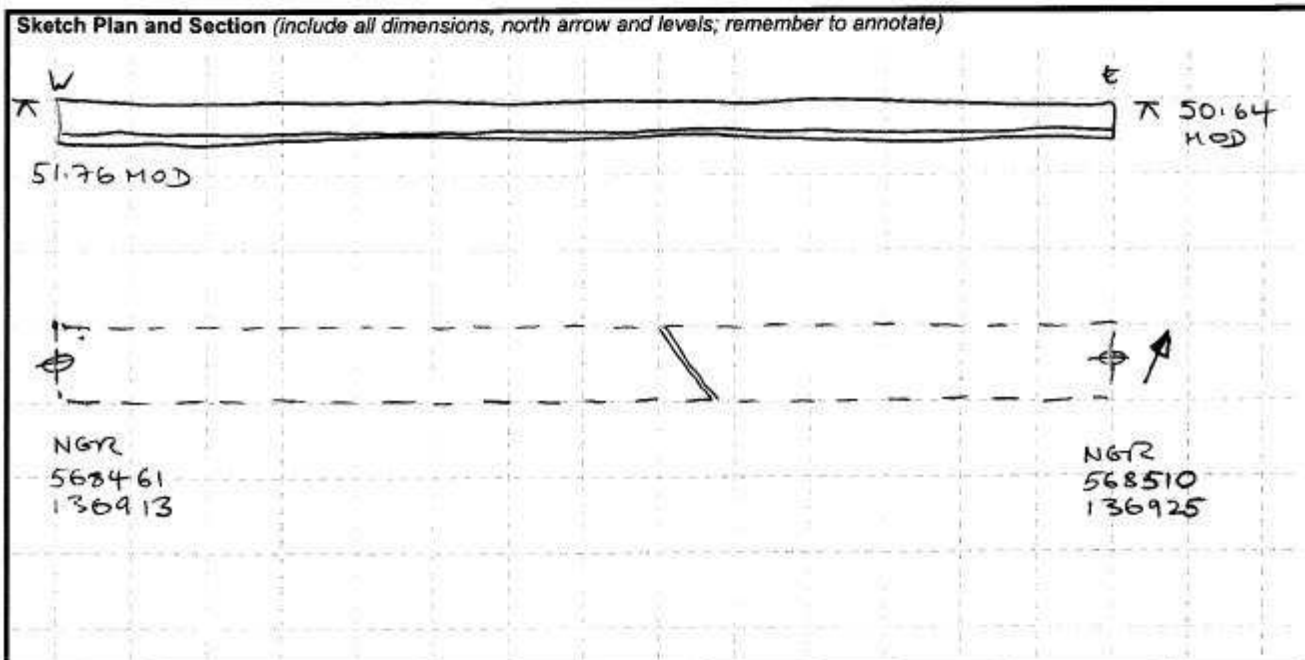

Discussion and interpretation

• **BLANK - NO ARCHAEOLOGY**

Contexts	—				
Finds	—				
Plan no.	—		Photo (b/w)	✓	
Section no.	—		Photo (colour)	✓	
Levelled	✓	Located	✓	Samples	—
Weather conditions	OVERCAST				Signature CT
					Date 4/5/04
					Checked CT
					Cont.

SITE CODE 443	Site Name FORESTAC FARM BUND		Sub-division -	Orientation ENE-WSW	TRENCH No 9
	Length 50 m	Width 2m	Depth 0.42		
	Machine Type		Bucket Size 2m		

Topsoli/ Overburden							
Colour DARK GREY BROWN 10 YR 4/2		Composition SILT CLAY			Depth 0.25		
Subsoil							
Colour REDDISH BROWN 2.5 Y 5/4		Composition SILT CLAY			Depth 0.10 - 0.15		
Natural							
Colour LIGHT BROWN 5 Y 5/3		Composition CLAY + GREY MOTTLES			Depth -		
Observations (circle)	Archaeology	Root activity	Structure	Contaminatio	Unstable	Other:	Plough
	Bur'd horizon	Burrows	Services	Flooding	Blank	LAND OWN	

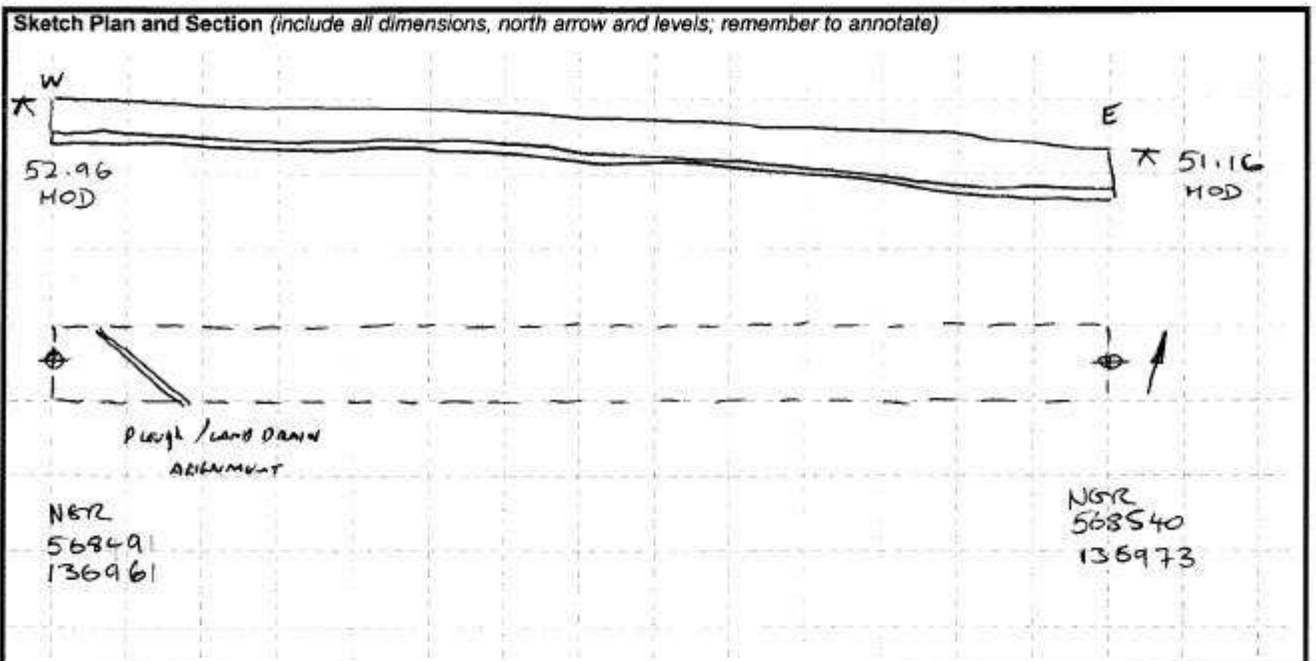

Discussion and interpretation	
BLANK - NO ARCHAEOLOGY	

Contexts		-	
Finds		-	
Plan no.		Photo (b/w)	Signature CT
Section no.		Photo (colour)	Date 4/3/04
Levelled <input checked="" type="checkbox"/>	Located <input checked="" type="checkbox"/>	Samples -	Checked J
Weather conditions OVERCAST			Cont.

SITE CODE 443	Site Name	Sub-division	Orientation	TRENCH No 10
	FORSTAL FARM BUND.		NNW-SSE	
	Length 50m	Width 2.00 m	Depth 0.40	
	Machine Type 360°	Bucket Size 2.00m		

Topsail/ Overburden							
Colour DARK ORGY BROWN	Composition	Depth					
107R 4/2	SILTY CLAY	0.25					
Subsoil							
Colour ROSY BROWN	Composition	Depth					
2.57 S/4	SILTY CLAY	0.09 - 0.15					
Natural							
Colour LIGHT BROWN	Composition	Depth					
S7 S/3	CLAY + GREY MOTTLES	-					
Observations (circle)	Archaeology	Root activity	Structure	Contam'tion	Unstable	Other: LAND DRAIN	
	Bur'd horizon	Burrows	Services	Flooding	Blank	PLUGH	

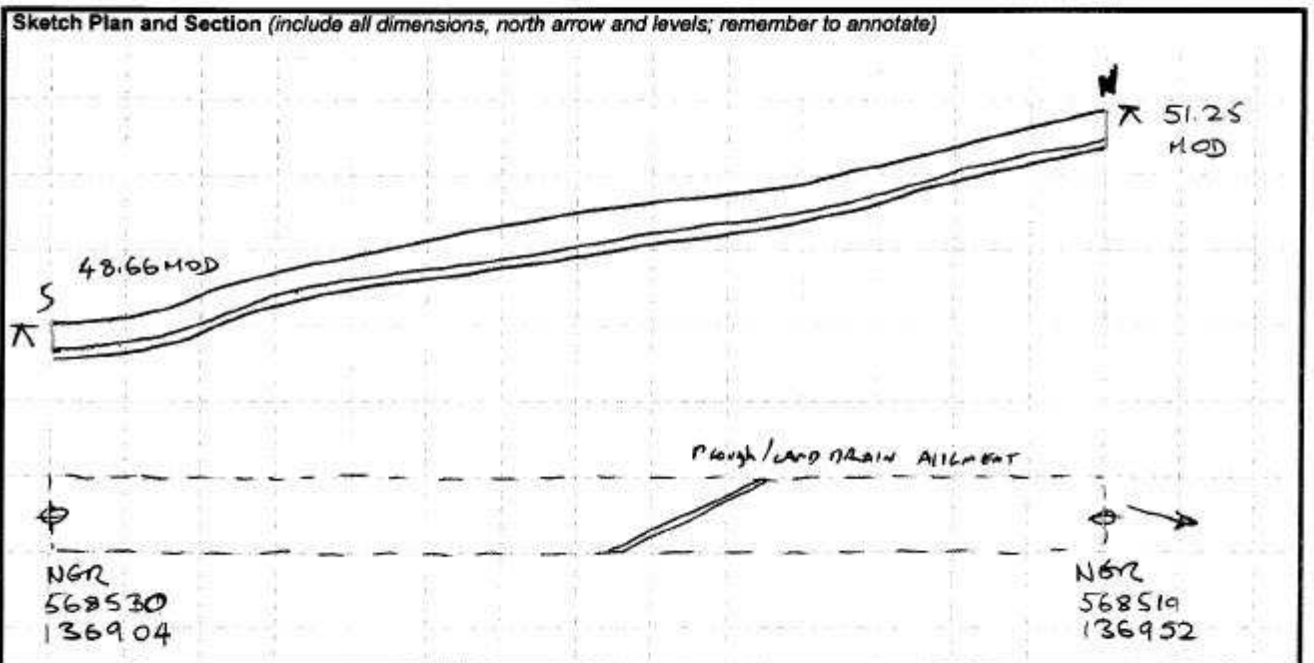

Discussion and interpretation

• **BLANK - NO ARCHAEOLOGY**

Contexts	-			Signature	CT
Finds	-			Date	4/3/04
Plan no.		Photo (b/w)	<input checked="" type="checkbox"/>	Checked	J
Section no.		Photo (colour)	<input checked="" type="checkbox"/>	Cont.	
Levelled <input checked="" type="checkbox"/>	Located <input checked="" type="checkbox"/>	Samples	<input type="checkbox"/>		
Weather conditions	OVERCAST.				