

HERITAGE NETWORK



**43 QUEEN STREET
Hitchin, Hertfordshire.**

HN498

Archaeological Monitoring Report



THE HERITAGE NETWORK LTD

Registered with the Institute of Field Archaeologists as an Archaeological Organisation

Archaeological Director: David Hillelson, BA MIFA

43 QUEEN STREET
Hitchin, Herts.

HN498

Archaeological Monitoring Report

Prepared on behalf of Pegasus Retirement Homes Ltd

by

David Kaye, BA PIFA
Abigail Rothwell, BSC PIFA
&
Chris Turner, BSC

Report No.304

January 2006

© The Heritage Network Ltd

11 FURMSTON COURT, ICKNIELD WAY, LETCHWORTH SG6 1UJ
TELEPHONE: (01462) 685991 FAX: (01462) 685998

Contents

	Summary.....	Page i
Section 1	Introduction.....	Page 1
Section 2	Site Narrative	Page 3
Section 3	Discussion.....	Page 9
Section 4	Bibliography	Page 10
Section 5	Illustrations	<i>following</i> Page 11
Appendix 1	Recorded Burial Data	
Appendix 2	Inventory of Artefacts	
Appendix 3	Photographic Register	
Appendix 4	Records from the Cemetery Clearance, c.1970	
Appendix 5	Unmarked Graves from Church Records	
Appendix 6	Marked Graves from Church Records	

The cover photograph shows the exhumation of a lead coffin

Acknowledgements

The fieldwork for this project was carried out by Chris Turner, Geoff Saunders, David Kaye, Abigail Rothwell, Alison Hudson and Adam Lee. Additional specialist support was provided by Peter Mitchell, Karen McHale and the staff of Burial Ground Services (UK) Ltd. The text and illustrations for the report were prepared by David Kaye, Abigail Rothwell, and Chris Turner. The report was edited by David Hillelson.

The Heritage Network would like to express its thanks to the directors and staff of Pegasus Retirement Homes Ltd; Peter Tanner, Tanner and Tilley Planning Ltd; Stuart Cox, Tweeds Construction Consultancy; the staff of Benson NHC Ltd; the staff of SDC Ltd; the staff of Kane Haulage Ltd; Peter Wilson, Plant Hire; Carole Casey and Neil Fairey, NHDC; Alan Sills, Principal Environmental Health Officer, NHDC; the staff of John O'Conner (GM) Ltd; The Rev. Philip Turner, Christ Church, Hitchin; and Stewart Bryant and Jonathan Smith, County Archaeology Office, Hertfordshire County Council, for their co-operation and assistance in the execution of this project.

Summary

Site name and address:	Land at 43 Queen Street, Hitchin		
County:	Hertfordshire	District:	North Herts
Village/town:	Hitchin	Parish:	Hitchin
Planning reference:	01/01092/1	NGR:	TL 18125 28837
Client name and address:	Pegasus Retirement Homes Ltd, Cheltenham, GL53 7LE		
Nature of work:	Housing	Present land use:	Offices & Car Park
Size of affected area:	c.2360m ²	Area investigated:	c.2360m ²
Site Code:	HN498	Other reference:	N/a
Organisation:	Heritage Network	Site Director:	David Hillelson
Type of work:	Excavation	Archive location:	North Herts Museums
Start of work	23 rd November 2004	Finish of work	14 th July 2005
Related SMR Nos.:	N/a	Periods represented:	Post-medieval/Victorian
Previous summaries/reports:	Ashworth 2002 (HN report no.165), Saunders 2004 (HN report no.251)		

Synopsis:

In response to an archaeological condition placed on the planning permission for the construction of retirement apartments on the above site, the Heritage Network was commissioned by the developers to fulfil the planning authority's requirements on their behalf. The commission extended to the clearance of a post-medieval and Victorian burial ground under the terms of a licence issued by the Home Office under the Disused Burial Grounds (Amendment) Act 1981.

A desk-based archaeological assessment of the site carried out by the Heritage Network in September 2002 demonstrated that the site held a low potential for the preservation of archaeological remains from the prehistoric and Roman periods, but a more significant potential for preservation from the Anglo-Saxon period onwards. A burial ground, associated with the Congregational Chapel that formerly occupied the site, was believed to have been largely cleared in the late 1960s, before the construction of a modern office block.

An archaeological evaluation carried out by the Heritage Network in August 2004 demonstrated that a number of post-medieval and Victorian burials survived intact across the site. In addition, the presence of sherds of 8th to 14th century pottery, in residual contexts, confirmed that there was late Saxon and medieval activity in the vicinity of the site, although no features attributable to these periods were identified.

The present programme of archaeological monitoring and recording was carried out intermittently between November 2004 and July 2005. No archaeological features or deposits pre-dating the post-medieval period were identified. However, in the course of the project, a total of 276 graves from the post-medieval burial ground were identified and recorded. These included 1 vault, 43 brick graves, and 232 simple inhumations. From these graves the remains of 344 individuals were exhumed, including 2 from the vault, 47 from brick graves, and 8 which had been interred in lead coffins. In addition, a communal grave that was created following the earlier clearance of the site, was found to contain the disarticulated remains of approximately 45 individuals, and a further two individuals contained in lead coffins.

A number of the graves had identifying inscriptions, the earliest of which dates to 1775 and was located in the north-west corner of the burial ground. The remaining inscriptions span the period from 1828 to 1864. Those which were readable demonstrate an age range for the individuals between 3 and 85 years, although at least one burial appeared to be that of a new born baby. Most of the later burials were located in a strip 11m wide on the south side of the site, which represents an extension to the cemetery dating to the 1820s.

All the investigation, recording and exhumation works were undertaken by Heritage Network staff in association with specialists from BGS UK Ltd. The work was carried out with due regard to the health, safety and welfare of individuals working on site and of the general public, under the supervision of the local authority's Environmental Health Officer. All the exhumed remains have been reburied in Hitchin's municipal cemetery located in St John's Road, with the agreement of the minister from Christ Church, Hitchin, as the successor to the Queen Street Congregational Chapel.

1. Introduction

1.1 This report has been prepared on behalf of *Pegasus Retirement Homes Ltd*, as part of a programme of archaeological work associated with the development of land at 43 Queen Street, Hitchin, Herts. The planning permission for the development (ref. 01/01092/1), granted by the North Hertfordshire District Council (NHDC), has been subject to a standard archaeological condition, in accordance with the provisions of the Department of the Environment's *Planning Policy Guidance Note 16* (PPG16). The scope of the required work followed the model *Design Brief for Archaeological Monitoring and Recording* issued by the *County Archaeology Office* (CAO) of Hertfordshire County Council, acting as advisers to NHDC, with specific provisions outlined in correspondence from the CAO dated 5/10/2004 (ref. JGS/01/1092-4). A full specification for the programme of archaeological works was contained in the Heritage Network's approved Project Design dated November 2004.

1.2 The study area is located on the south-eastern edge of the historic core of the town, centred on NGR TL 18125 28837 (Figure 1). It is bounded by Queen Street on the west, the Hitchin British Schools Museum complex (41-42 Queen Street) on the north, Storehouse Lane on the east, and Cannon House and Hazeldene on the south. The redevelopment involves the construction of retirement apartments.

1.3 A desk-based archaeological assessment of the site carried out by the Heritage Network in September 2002 demonstrated that the site held a low potential for the preservation of archaeological remains from the prehistoric and Roman periods, and a more significant potential for preservation from the Anglo-Saxon period onwards. The site may lie within the cemetery zone of the recently identified Anglo-Saxon settlement area to the north, and also lies within a post-medieval burial ground which is believed to have been partially cleared in the late 1960s under the guidance of Mr H.C. Jenkins (Ashworth, 2002).

1.4 An evaluation of the site was carried out by the Heritage Network in August 2004. The aim of the evaluation was to consider the location, extent, date, character, condition, significance and quality of any remains that are liable to be threatened by the development, and to provide a local and regional, archaeological and historical context for any such remains, in accordance with the current published regional research agenda (Glazebrook 1997, Brown and Glazebrook 2000), if they were discovered.

1.5 The results of the fieldwork indicated that the site had been significantly disturbed between the post-medieval period and the present not only by the post-medieval cemetery but also by modern construction, and by service pipes at the front of the site. However, residual fragments of Anglo-Saxon and medieval pottery were recovered. The evaluation clearly demonstrated the presence of intact post-medieval burials on the site, confirming that the clearance of the burials in the 1960s was not complete.

1.6 On the basis of the results of the advance works, the present project had two principal aims:

- to record and remove all post-medieval and Victorian human remains in accordance with the licence issued by the Home Office under the Disused Burial Grounds (Amendment) Act 1981;

- to identify and record any archaeological features and deposits which might be uncovered and retrieve artefactual and ecofactual elements which would allow the date, character, and significance of the site to be assessed in accordance with the current published regional research agenda (Glazebrook 1997, Brown and Glazebrook 2000), subject to the limitations of reasonable safety and practicality.

1.7 The present report is intended to complete the record of the project, and, together with the re-interment of the remains recovered, the publication of a note recording the results of the project in *Hertfordshire's Past and Present*, and the deposition of the site archive with the North Hertfordshire Museum Service, to complete the requirements of the planning condition.

2. Site Narrative

TOPOGRAPHY AND GEOLOGY

2.1 Hitchin lies in the valley of the River Hiz, with the land rising on both eastern and western sides of the river. Both Windmill Hill, on the eastern side of the town, and West Hill, opposite it, rise to heights of approximately 90m AOD.

2.2 The town lies in the centre of the Hitchin Gap, a glacially derived deep cutting. The solid geology is Lower Chalk, with a deep drift covering of fluvio-glacial sands and gravels of the Anglian phase of the Quaternary period. The chalk bedrock is present at considerable depths below the fluvio-glacial deposits. Locally the soils are derived from the St Albans Association and comprise a brown earth derived from the underlying sands and gravels.

2.3 The present site lies on the east side of the Hiz valley on ground rising from 66.65m AOD on the street frontage, to 74.50m AOD on the boundary with Storehouse Lane. The underlying geology across the site is predominantly sand.

SITE BACKGROUND

2.4 A desk-based archaeological assessment of the site was undertaken by the Heritage Network in 2002 (Ashworth, 2002). This demonstrated that the site had a moderate potential for the preservation of archaeological remains from the Anglo-Saxon period onwards. The assessment also showed that the site had been previously occupied by an Independent Meeting House (later recorded as a Congregational Chapel) and its associated burial ground. It was considered likely that the use of the southern part of the site as a graveyard, and its subsequent clearance in the late 1960s, would have removed any earlier archaeological evidence from substantial parts of the site. The reported discovery of undisturbed human remains during the construction of Sodexo House suggested that the clearance of the post-medieval cemetery was limited and it was therefore considered likely that further intact burials would survive on the site.

2.5 As part of the subsequent evaluation of the site, four trenches were dug to form a sample of approximately 3.5% of the affected area. The three trenches, which lay within the boundary of the former graveyard, revealed at least 27 undisturbed grave cuts and 1 brick grave, clearly indicating that the original clearance of the site had not been carried out thoroughly.

METHODOLOGY

2.6 Although it had been intended that the archaeological work would be carried out alongside the construction programme, for reasons of practicality it was decided that all the archaeological clearance would take place in advance of the principal groundworks. Because it was not possible to remove the spoil from the site, the site was divided into blocks of varying sizes, which were cleared and subsequently backfilled in sequence.

2.7 The fieldwork was carried out in two phases, with the bulk of it being carried out between November 2004 and January 2005. The remaining work, a narrow strip on the

southern side of the site, was completed in June 2005, once the southern boundary wall had been removed and piling put in place which allowed deep excavation to be carried out safely at the very edge of the site.

2.8 The machining was carried out under close archaeological supervision with a wheeled 360° excavator fitted with a 1.5m toothless bucket. Works started in the south-east corner of the site and continued systematically in a north-easterly direction, before progressing down the site towards the street frontage..

2.9 Once grave cuts had been identified, they were investigated rapidly to ascertain the depth of the remains, and then excavated using trowels and hand shovels. Each grave and its contents were recorded, and the human remains and any personal items and coffin furniture were then boxed for reburial.

2.10 All work was carried out in accordance with the Heritage Network's approved *Project Design*, the Home Office licence issued under the Disused Burial Grounds (Amendment) Act 1981, current health and safety legislation, and IFA standards. The work was carried out under the supervision of the Environmental Health officer of NHDC, and the services of exhumation specialists, BGS UK Ltd, were retained to manage the opening of any sealed brick graves, and the safe removal of any remains, including lead coffins, where a potential health hazard had been identified.

MEDIEVAL AND EARLIER REMAINS

2.11 Although some fragments of Anglo-Saxon pottery were recovered in the course the evaluation of the present site (Saunders, 2004), and Anglo-Saxon remains were identified on the Jeeves Yard development to the north (Davis, 2001), no archaeological features or deposits which predate the use of the site as a burial ground were encountered during the current phase of work. It is possible that the intensive use of the site between the 17th and 19th centuries destroyed earlier remains, or that the material recovered during the evaluation was redeposited from elsewhere in the vicinity.

BUILDINGS

2.12 Documentary evidence shows that the original Independent Meeting House was erected on the site in 1690. The burial ground, which was established to the south, continued in use until the late 19th century. In 1853, the congregation resolved to build a new chapel to the east, and the old building was converted to a schoolroom. In 1869, however, it was demolished, and new schoolrooms were built on to the chapel. These buildings survived until the late 1960s. A photograph of the original meeting house forms part of the Latchmore Collection in Hitchin Museum (Plate 1), but all traces of the building appear to have been destroyed by the later chapel and subsequent office block (Figure 3).

2.13 The remains of the foundations for the later 19th century chapel were recorded on the northern side of the site (Figure 4; Plate 2). The brick built building measured 11.50m in width but only the eastern 16m survived, the remainder having been destroyed by terracing for the footprint of the later office block. Fragments of tin glazed crockery were recovered from the vicinity, bearing the inscription "Congregational Church Hitchin" (Plate 3).

GRAVES

2.14 In the course of clearing the site, a total of 276 graves were identified and the remains of 344 individuals were exhumed (Figure 4; Appendix 1). The remains of five further individuals [36], [40], [44], [46] and [248] were observed and recorded but had to be left *in situ* because they fell both outside the impact area of the development (Figure 2) and well within the canopy of the mature trees bordering the site to the east. Amongst the graves, 43 brick graves were recorded containing a total of 47 individuals, and a single vault was recorded containing 2 individuals (Figure 5). Four complete lead coffins and two fragmentary lead coffins were also removed from the brick graves. The remainder of the graves were inhumations placed directly in the ground, apart from a communal grave located against the southern boundary of the site, which contained the remains of individuals exhumed in the late 1960s, prior to the construction of the later office block.

Brick Graves and Vaults

2.15 The vault (Plates 5 - 8) was of brick construction having a single chamber, measuring approximately 4 x 2.8m (13' x 9'), with a stepped access on the eastern side measuring 1.6 x 2.6m (5'4" x 8'6"). The steps led to an arched opening into the vault itself which was bricked up after the last coffin had been deposited. The inside was painted white in common with many of the brick graves, and there was a shelf on the northern side which would have supported one or more coffins. The vault appeared to have been largely cleared as there were coffin lids and wood debris scattered throughout. Nevertheless, one adult skeleton and other bone fragments were recovered.

2.16 A total of 43 brick graves were recorded containing 47 individuals. It is likely that further brick graves were destroyed in the course of the clearance of the site in the late 1960s, when it appears that only the upper chambers of multi-storeyed family graves were removed.

2.17 Most of the brick graves were of a similar form, measuring approximately 2.52m (8'4") long, and 1.06m (3'6") at the widest point, reducing to 0.71m (2'4") at either end (Plate 9). The height of each chamber was 0.70-0.80m (2'4" - 2'8") and all were white-washed inside. In general, the lower chambers were separated by a slab, with the uppermost chambers having a vaulted brick roof. Uniquely, grave [61] included a slab with an inscription reading "W:W:1830" (Plate 10). All other slabs were blank.

2.18 Variations to the normal pattern include brick grave [87], which had small brick extensions at either end of the main chamber containing infant burials (Plate 11), and brick grave [227], which was built over the vaulted roof of a lower chamber and had a tiled floor (Plate 12).

2.19 Two other structures are notable: contexts [41] and [121]. Both appeared to have been designed to enclose three brick graves side by side, though in the case of structure [41], the centre plot was never used, and in the case of structure [121], the third grave, [129], appears to have been a later extension to the two original graves.

Inhumations

2.20 Most of the cut graves for the inhumations were approximately 1.78m (5'10") in length, and 0.64m (2'1") in width at the head, reducing to 0.49m (1'7") at the feet. Apart from 8 lead coffins and 1 iron coffin, all the other burials were in wooden coffins. At least 9 of the coffins were decorated with copper alloy studs. Three coffins, graves [01], [03] and [65], appeared to have been constructed with planks fitted to square iron hoops, like a square barrel.

2.21 Of the 294 skeletons from simple cut graves, 156 (53%) were in a good state of completeness and either in good or fair condition, though there was no significant correlation between condition and either location or depth of burial (Figures 6 & 8). The most significant factor for the survival of the skeleton appeared to be the presence or absence of a coffin plate (Figure 7; Plate 13). For burials in which a coffin plate had been present, the bones of the upper chest were absent or had almost completely decayed. However, the rest of the skeletal elements were present. Differential preservation within a burial was also observed when copper alloy shroud pins were present. In these cases the survival of shroud fragments and/or hair was common.

Cemetery Clearance

2.22 A report compiled in June 1970 by H.C.Jenkins (HALS NR8/7/22), in association with the clearance of the site, provides a plan of the burial ground with the gravestones numbered (Figure 11), a key to the numbered gravestones, an alphabetical list of burials with headstones (Appendix 6), and a chronological list of all burials without headstones (Appendix 5).

2.23 The remains recovered during the cemetery clearance of the late 1960s are recorded as having been buried in a communal grave close to the southern boundary of the site. This proved to be one of the deepest features excavated with its base located 2.99m below the existing surface. The remains of at least 45 disarticulated individuals were recovered from this location together with a further 2 lead coffins (Plate 14).

2.24 An inscription recovered from one of the lead coffins suggests that it originated in the Wilshere family plot, grave [121]. The other lead coffin almost certainly originated in the upper level of a brick grave or vault, as no lead coffins were found interred.

2.25 The Jenkins report appears to suggest that 84 marked graves were identified and cleared. However, the remains recovered from the communal grave only amount to approximately 45 individuals, leaving a further 39 unaccounted for. The majority of the bones in the communal grave seemed to be in good condition and it may be that less robust remains have not survived. Most of the gravestones appear to have been broken up and reburied during the clearance.

CEMETERY LAYOUT AND DENSITY

2.26 The site plan provided in the Jenkins report of 1970 is only a schematic representation of the relative positions of the graves and is not drawn to scale (Figure 11). Nevertheless, it would appear to indicate that the earliest burials were located in the north-east corner of the site, later extending to the south then the west.

2.27 The majority of brick graves were located in the north-eastern quadrant of the site, clustered around vault [43]. The cut graves were broadly laid out in rows running parallel with the site boundaries. Due to overcrowding, in some parts of the burial ground the established rows appear to have broken down. Intercutting graves are fairly common across the whole site, even the vault being built over an earlier brick grave [104]. Brick graves [63] & [72] were cut on either side of grave [98] leaving incomplete and disarticulated remains (including skull, pelvis and other bone fragments) in the 0.28m gap in between.

2.28 The density of the burials is noticeably greater in the north-western quadrant of the site indicating that space was becoming increasingly scarce at the turn of the 19th century. Undoubtedly as a result of this, the cemetery was extended southwards by 11m, probably in the late 1820s but definitely before 1845, incorporating the adjacent plot to the south. This increased the available space by nearly 500m² and provided space for a further 71 individual burials. Despite the pressure on space in the original burial ground, it remained in use, simultaneously with the southern extension, until 1864. The cemetery was closed well before the extension reached its capacity.

2.29 The depth of burials varied across the site with the shallowest being at the western end of the original plot (Figure 8). Some remodelling of the site is likely to have taken place when Sodexho House was built, c. 1970, with levels at the western end being truncated to allow vehicle access to the rear of the site. Many of the graves at the higher, eastern end of the site are 1.7 to 2m deep suggesting they are at, or close to, their original depth from the surface.

DATING

2.30 Although the graveyard is likely to have been in use from the late 17th century, the earliest marked grave is recorded as dating to 1722 in the Jenkins report. Coffin plates recorded as part of the present project give a date range between 1775 and 1864.

2.31 The Jenkins report indicates an increase in the number of deaths between the late 1830s and the late 1850s. The figures may indicate an ageing congregation or a general increase in the size of the congregation. Alternatively, outbreaks of cholera are known to have been prevalent in Hitchin during that period, and a programme to improve the water supply and sewer construction was instigated in 1849, in response to a report by William Ranger, the London health inspector. A combination of overcrowding and inadequate sanitation caused a high mortality rate which led to part of Queen Street being named Dead Street. The improvement works were completed in 1854.

2.32 A list of unmarked graves from 1837 onwards, compiled from church records for the Jenkins report, contains 141 names (Appendix 5). In the course of the present project, 291 individuals were recorded from, apparently, unmarked graves. It is possible that the balance date to the period between 1690 and 1836. A record of burials between 1786 and 1836 is believed to be held by the National Archives at Kew, but has not been consulted for the present project. A list of marked graves from 1837 onwards is included as Appendix 6.

2.33 The later list, contained in the Jenkins report appears to contain some anomalies. For example, no burials are recorded for a two-year period between 1847 and 1848. Nevertheless, a copper alloy coffin plate, recovered in the course of the present works from grave [152], had

the inscription “James Coleman Died May 13th 1848 Aged 53”. According to the church records, James Coleman died in 1849. The lack of records for this period is explained by a hiatus between incumbents.

2.34 The only other person named in the church records whose burial has been positively identified is Sarah Joiner. She was buried in grave [171], with a coffin plate reading “Sarah Joiner Died 1850 Aged 61 Years”.

ARTEFACTS AND UNUSUAL FEATURES

2.35 A complete inventory of artefacts, including coffin plates and coffin furniture, found in the graves is included as Appendix 2. All artefacts were reinterred with the remains of the individuals with whom they had been buried.

2.36 Evidence of copper alloy shroud pins was found in 19 of the burials. Apart from fragments of shrouds, four burials included buttons, two burials included hair-slides, and a set of spring mounted dentures was recovered from grave [105] (Plate 16). A further set of dentures were observed in the communal grave, [76].

2.37 The occupants of neighbouring graves [145] and [156] had been the subject of a post-mortem craniotomy (Plate 15). This is a process whereby the skull cap is sawn across transversely in order to gain access to the brain as part of the autopsy procedure. The Anatomy Act of 1832 legalised the post-mortem process allowing doctors to dissect donated and unclaimed bodies. Burial [145] was dated to 1849. The precise reason for the craniotomies is unclear but it was around this time that post-mortem findings were first used as evidence in English courts of law.

3. Discussion

3.1 The desk-based assessment of the site at 43 Queen Street, and its subsequent evaluation, suggested that the redevelopment of the site might disturb remains of Anglo-Saxon date, and would certainly encounter post-medieval human remains deposited in the disused burial ground which occupied the site.

3.2 On the basis of this information, the planning consent for the construction of retirement apartments on the site was subject to an archaeological condition requiring the monitoring of all groundworks and the recording and removal of any archaeological remains encountered. Additionally, under the provisions of a licence from the Home Office, issued under the provisions of the Disused Burial Grounds (Amendment) Act 1981, all human remains associated with the former Queen Street Congregational Church burial ground were to be removed from the site with due care and attention to decency, and reinterred without undue delay in an appropriate alternative burial ground.

3.3 The construction methodology required the terracing of the footprint of the new buildings into the natural slope which rises on the east side of Queen Street. As a result of an unforeseen delay in the construction programme, access to the site was made available for the archaeological works in advance of the groundworks. Consequently, the whole site was systematically investigated and largely cleared without disruption to the clients' timetable.

3.4 Although records indicate that the post-medieval burial ground had been cleared in the late 1960s, it quickly became apparent that this clearance had been limited to the removal of grave markers from the site, and those burials which occurred at a limited depth from the surface. In the course of the present project, the remains of at least 349 individuals were recovered, ranging in age from infant to 85 years. Of the total, the remains of approximately 45 individuals were removed from a communal grave established near the southern boundary of the site to accommodate the remains cleared in the late 1960s. Fourteen of the graves occurred within the footprint of the 1970s office block which occupied the northern half of the site, and all but one of these contained human remains.

3.5 The foundations of the 19th century Congregational Chapel were also recorded, beneath the footprint of the 1970s office block in the northern half of the site. No remains of the earlier 17th century Independent Meeting House were encountered.

3.6 No archaeological features or deposits predating the use of the site as a burial ground were encountered. It is assumed that the intensive nature of the site's later use would have destroyed or significantly disturbed any such remains.

3.7 On the completion of the site works, all the human remains, personal items and associated coffin furniture from the burial ground were moved to Hitchin's municipal cemetery in St John's Road and reinterred.

4. Bibliography

Ashworth, H. 2002. *43 Queen Street, Hitchin, Herts. Desk-based Archaeological Assessment*. Heritage Network, September 2002.

Davis, S. Sept 2001. *40 Queen Street, Hitchin, Archaeological Evaluation Report*. MoLAS Report.

Fleck, A. & Poole, H. 1999. *Old Hitchin*. Phillimore & Co. Ltd, Chichester.

Hillelson, D. 2002. *43 Queen Street, Hitchin, Herts. Project Design: Archaeological Evaluation*. Heritage Network, October 2002.

Jenkins, H. 1970. *Queen Street Congregational Church, Hitchin, Burial Ground (Formerly Back Street Independent Meeting House)* Unpublished typescript, Hertfordshire Archives

Miles, A. July 2001. *40 Queen Street, Hitchin: An Archaeological Impact Assessment*. MoLAS Report.

Saunders, G. 2004. *43 Queen Street, Hitchin, Herts. Archaeological Evaluation Report*. Heritage Network, September 2004.

5. Illustrations

Figure 1.....	Site location
Figure 2.....	Area investigated
Figure 3.....	Known buildings
Figure 4.....	Site layout
Figure 5.....	Brick graves
Figure 6.....	Condition of remains
Figure 7.....	Inscription plates
Figure 8.....	Depth of graves
Figure 9.....	Age of individuals
Figure 10.....	Burials per grave
Figure 11.....	Plan of burial ground, June 1970

Plate 1.....	Original Independent Meeting House
Plate 2.....	Foundations of 19 th century chapel
Plate 3.....	Tin glazed crockery
Plate 4.....	General view of site, looking E
Plate 5.....	Opening Vault 42, looking N
Plate 6.....	General View of Vault 42, looking N
Plate 7.....	Vault 42, interior looking N
Plate 8.....	Vault 42, interior looking N
Plate 9.....	Brick Grave 57
Plate 10.....	Brick Grave 61, with inscription
Plate 11.....	Brick Grave 87, looking W
Plate 12.....	Brick Grave 227, looking W
Plate 13.....	Detail of coffin plate from Grave 136
Plate 14.....	Remains reintered in communal grave 76
Plate 15.....	Craniotomy from Brick Grave 145
Plate 16.....	Dentures Removed from Brick Grave 105

THE HERITAGE NETWORK LTD

43 Queen Street, Hitchin

HN498

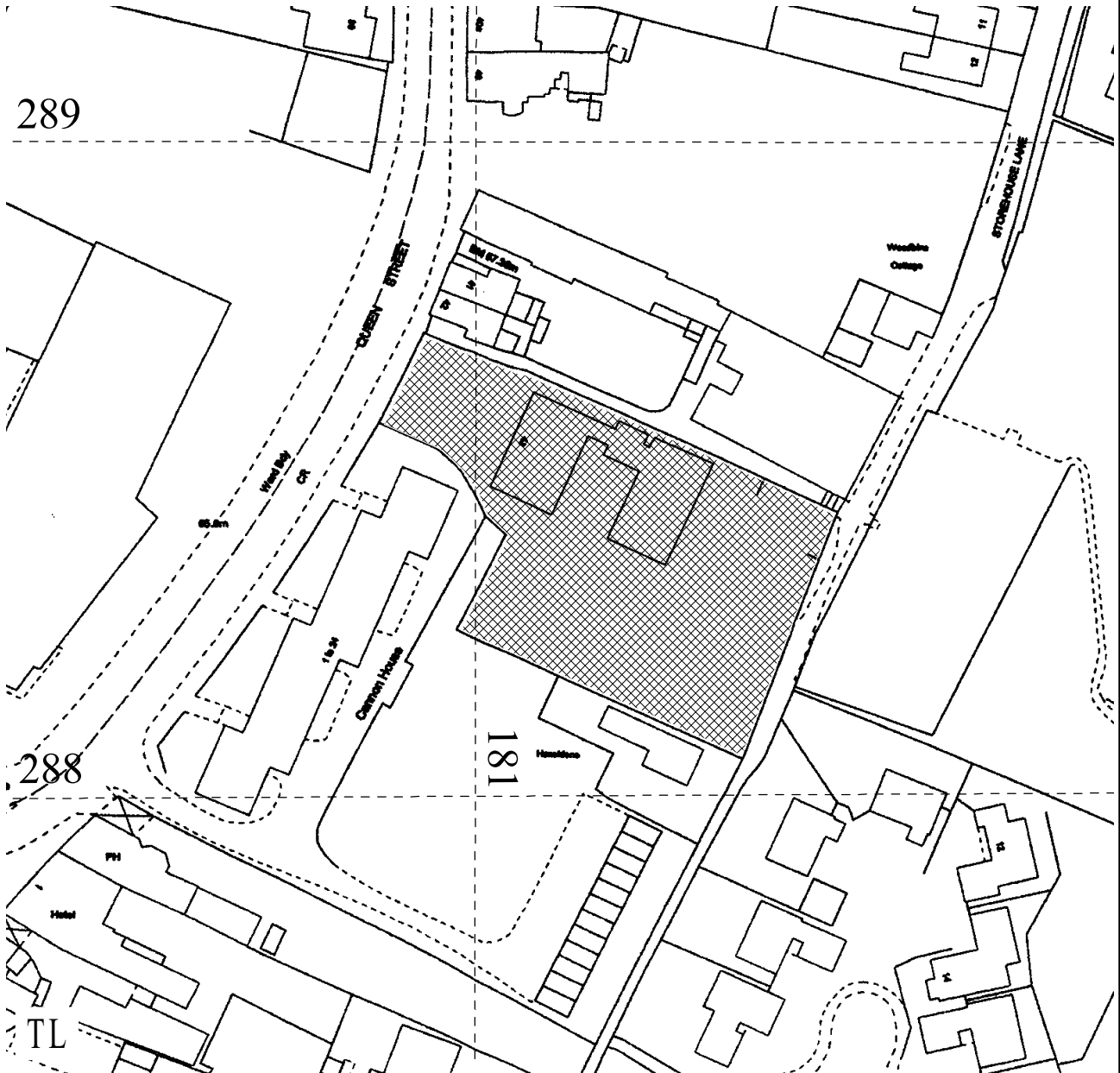
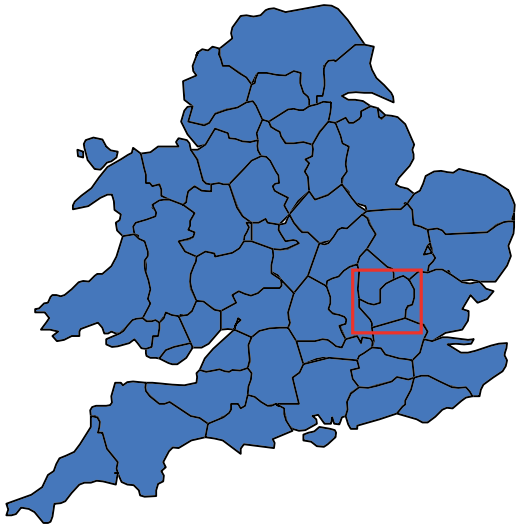

Site Location

Scale 1:1250

Reproduced from the Ordnance Survey with the permission of the controller of Her Majesty's Stationery Office, Licence no.AL100014861

Figure 1

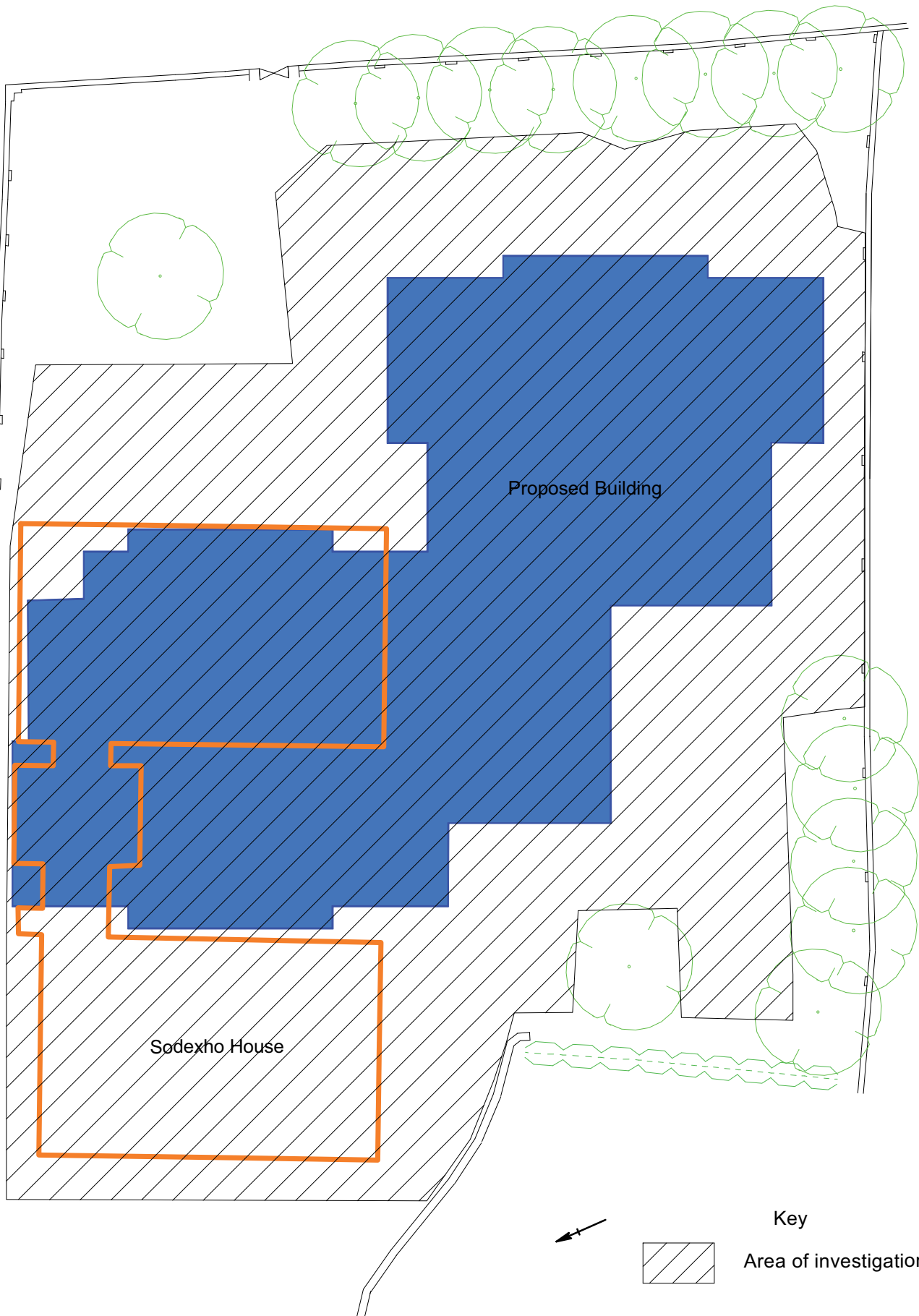



Area Investigated

Scale 1:250

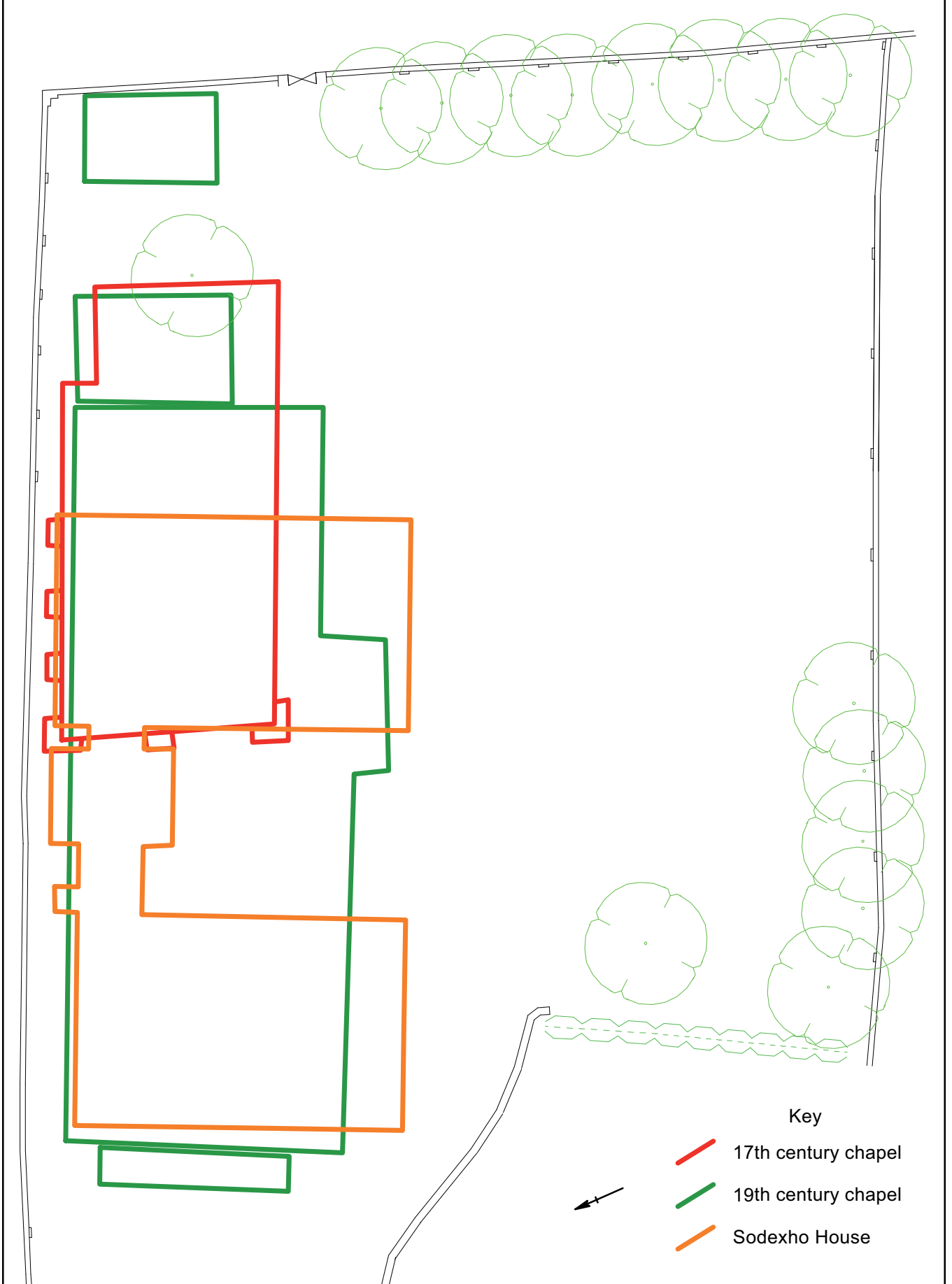
Figure 2



Key

-  17th century chapel
-  19th century chapel
-  Sorexho House



Known Buildings

Scale 1:250

Figure 3



43 Queen Street
Hitchin

HN 498

Site Layout

Early 19th Century
Boundary

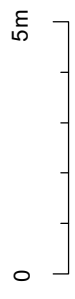

Scale 1:200

Figure 4

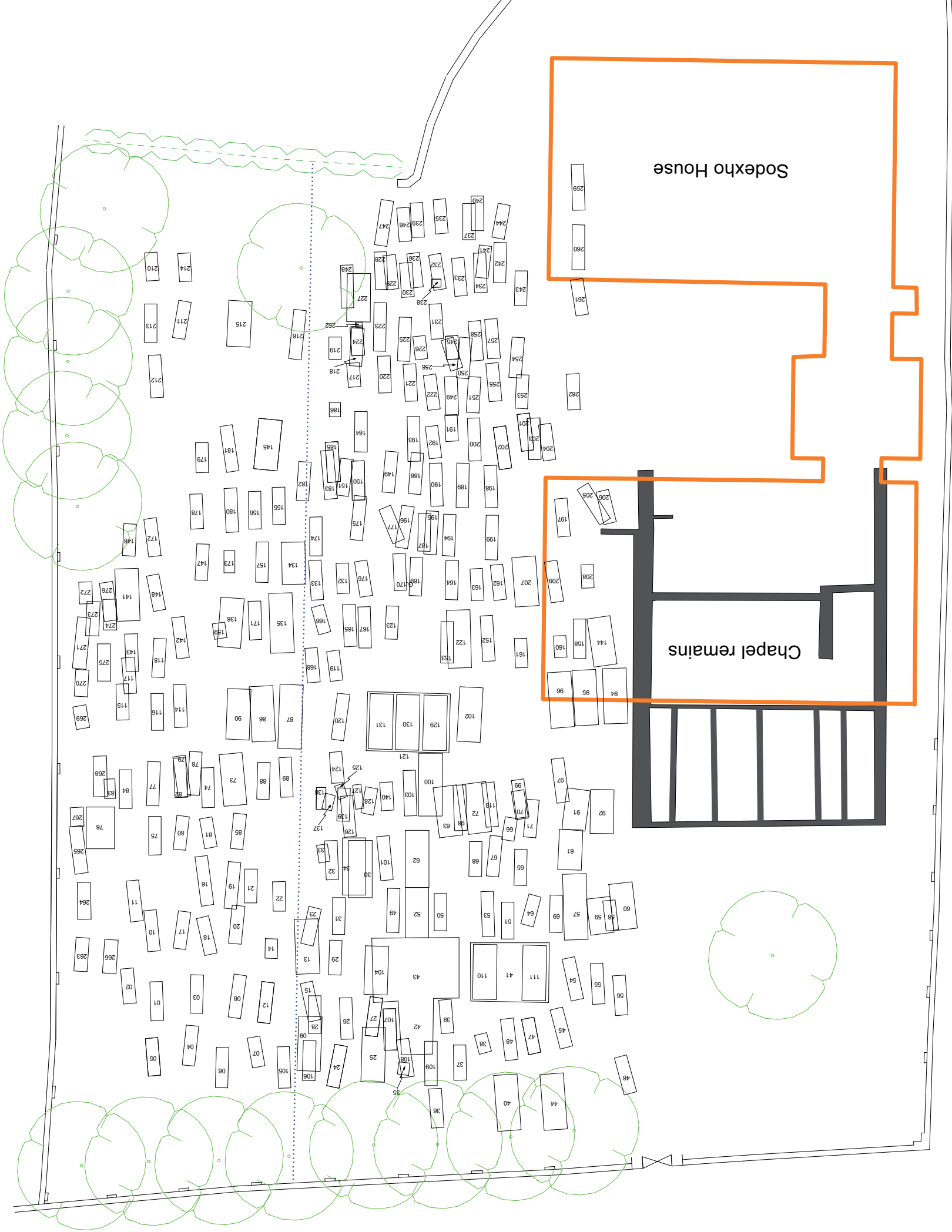



Brick graves

Scale 1:250

Figure 5

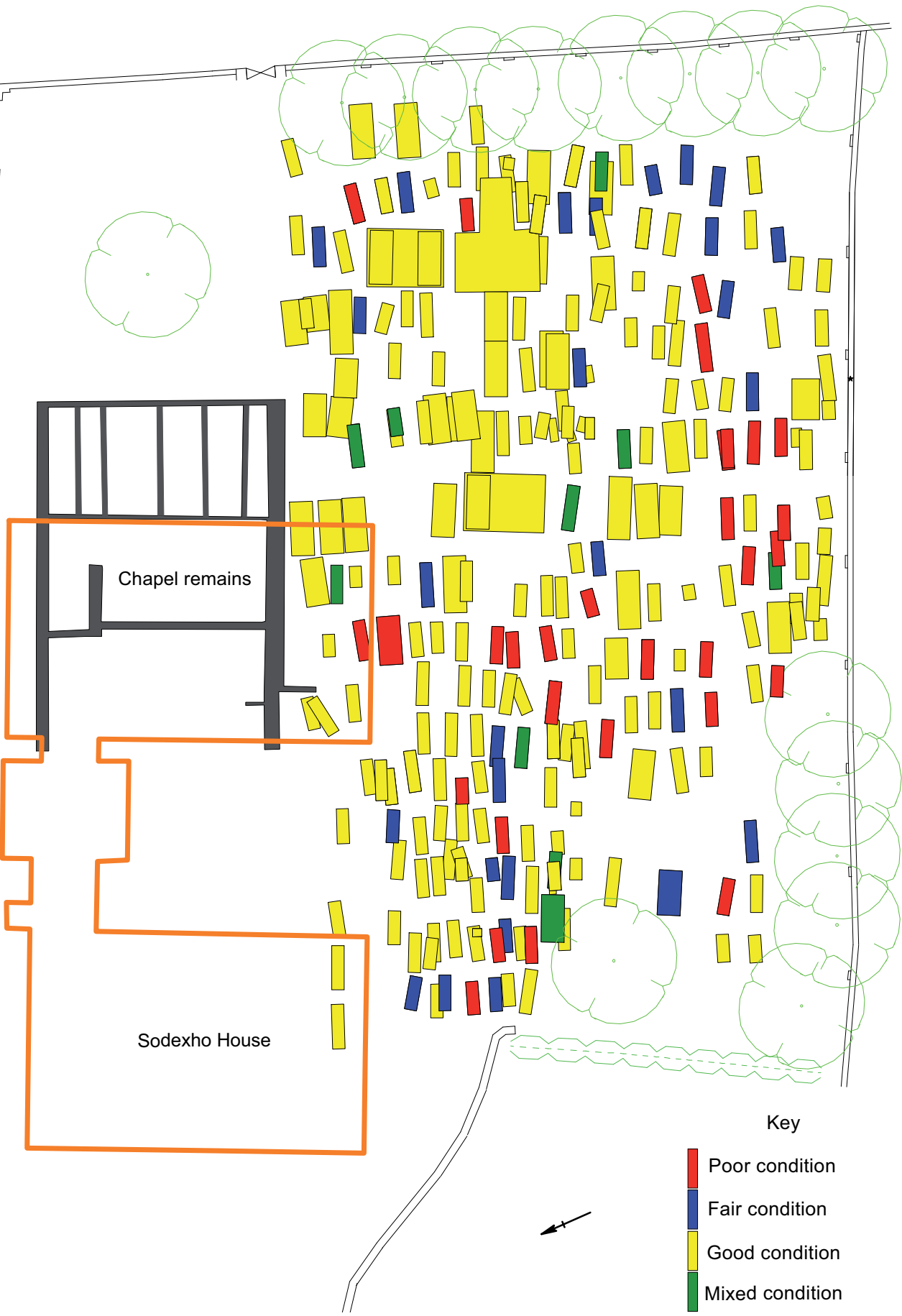

Key

- Poor condition
- Fair condition
- Good condition
- Mixed condition

Condition of remains

Scale 1:250

Figure 6

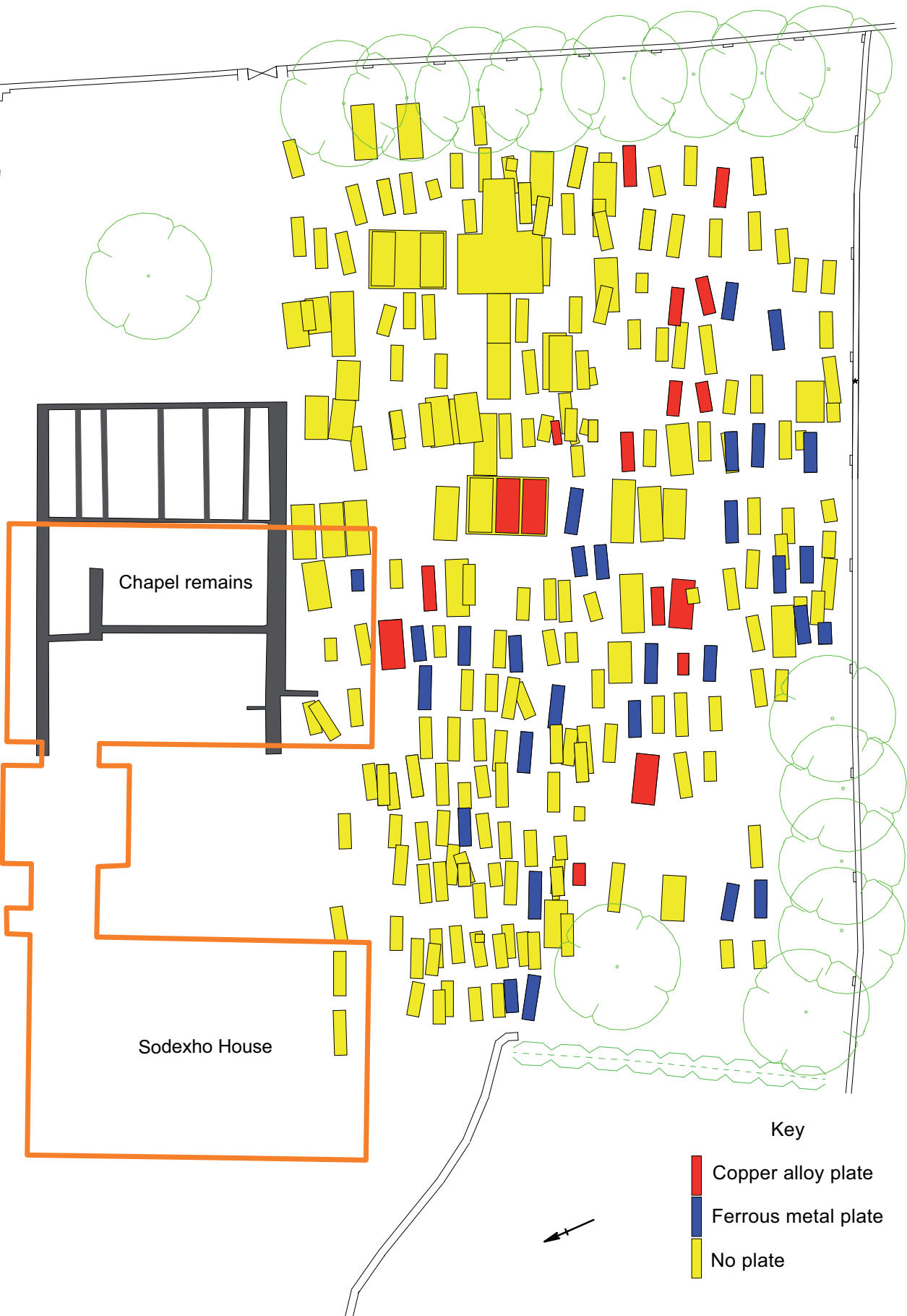

Chapel remains

Sodexho House

Key

- Copper alloy plate
- Ferrous metal plate
- No plate

Inscription plates

Scale 1:250

Figure 7

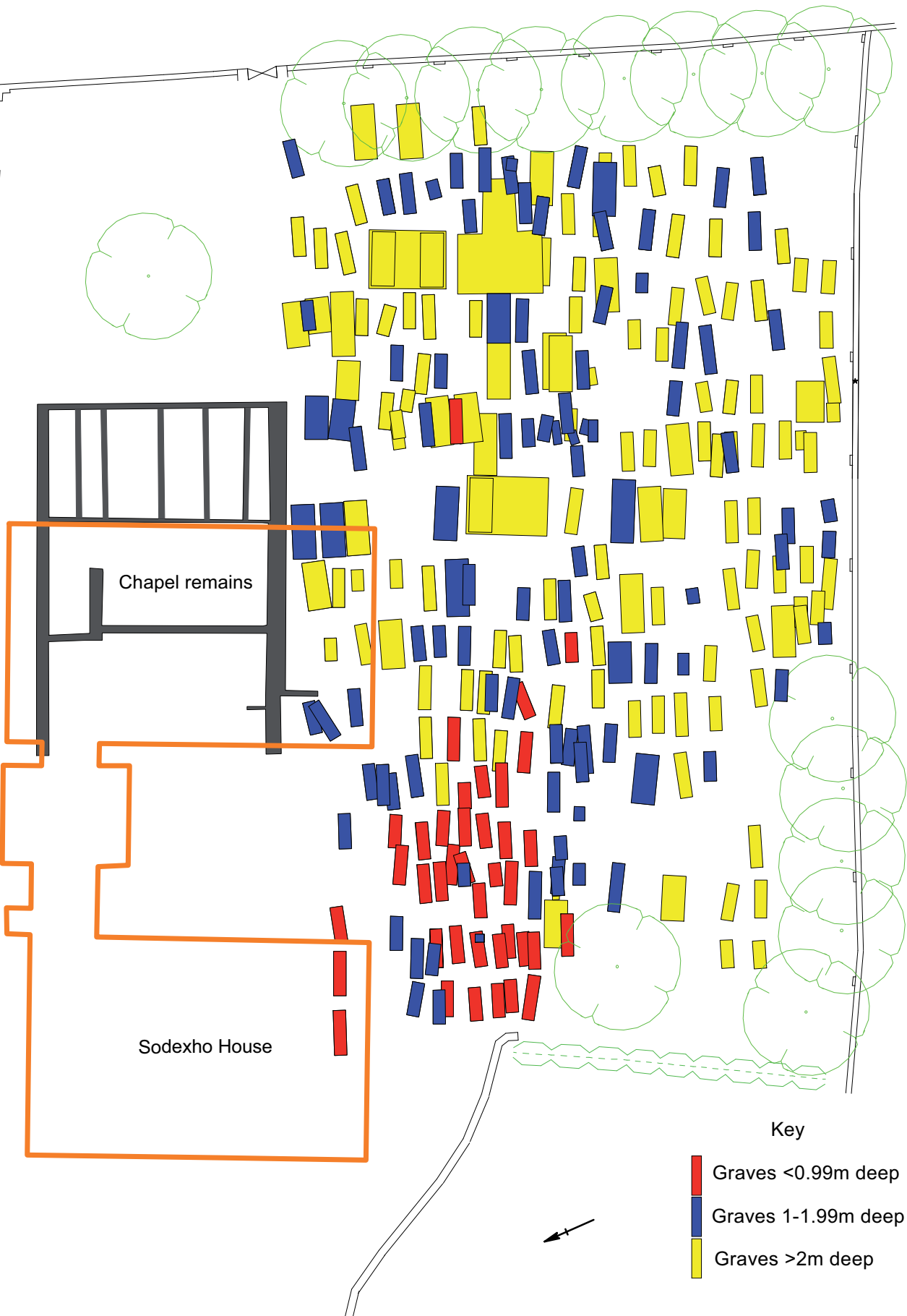

Chapel remains

Sodexho House

Key

- Graves <0.99m deep
- Graves 1-1.99m deep
- Graves >2m deep

Depth of graves

Scale 1:250

Figure 8

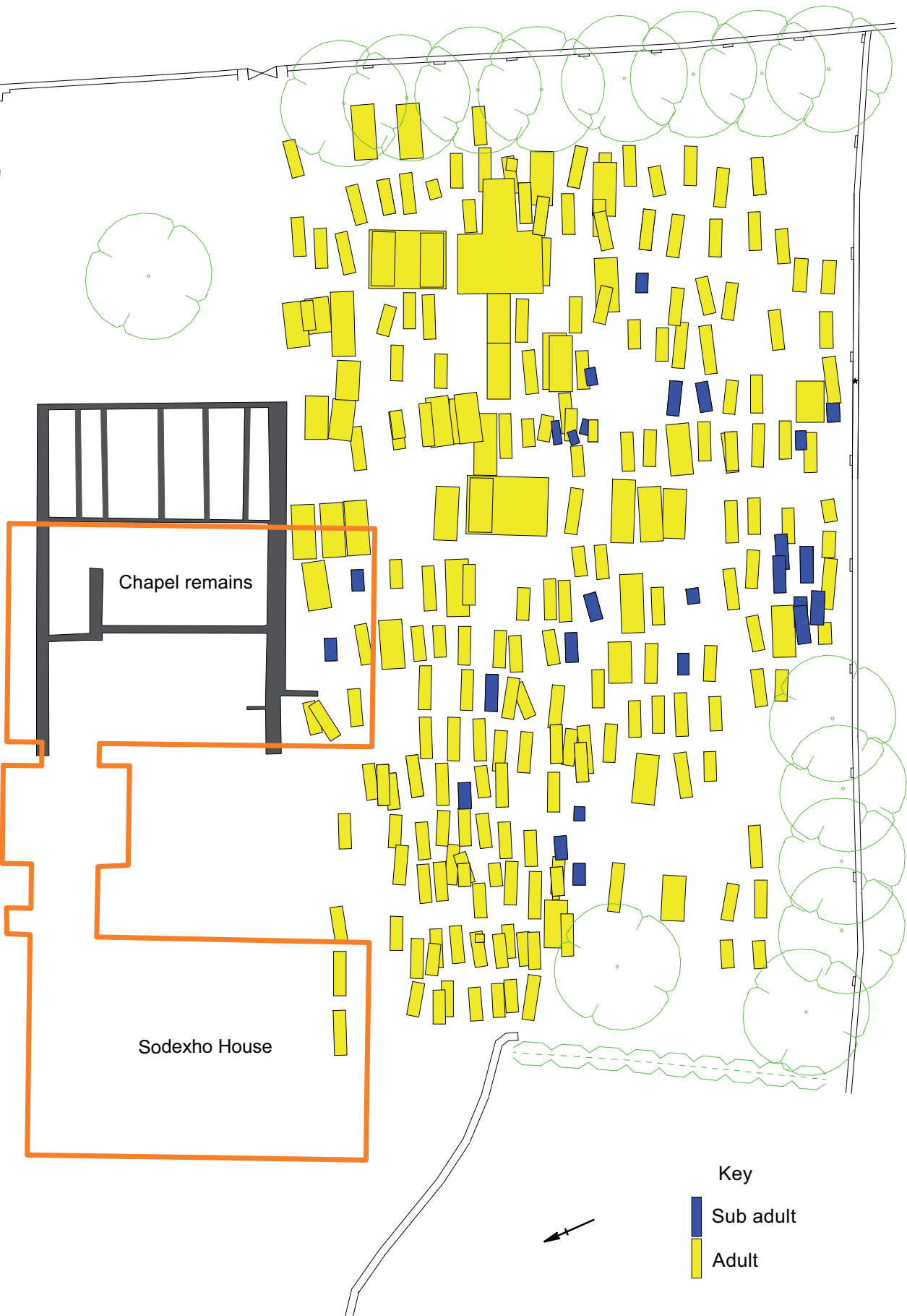

Key

Sub adult

Adult

Age of individual

Scale 1:250

Figure 9

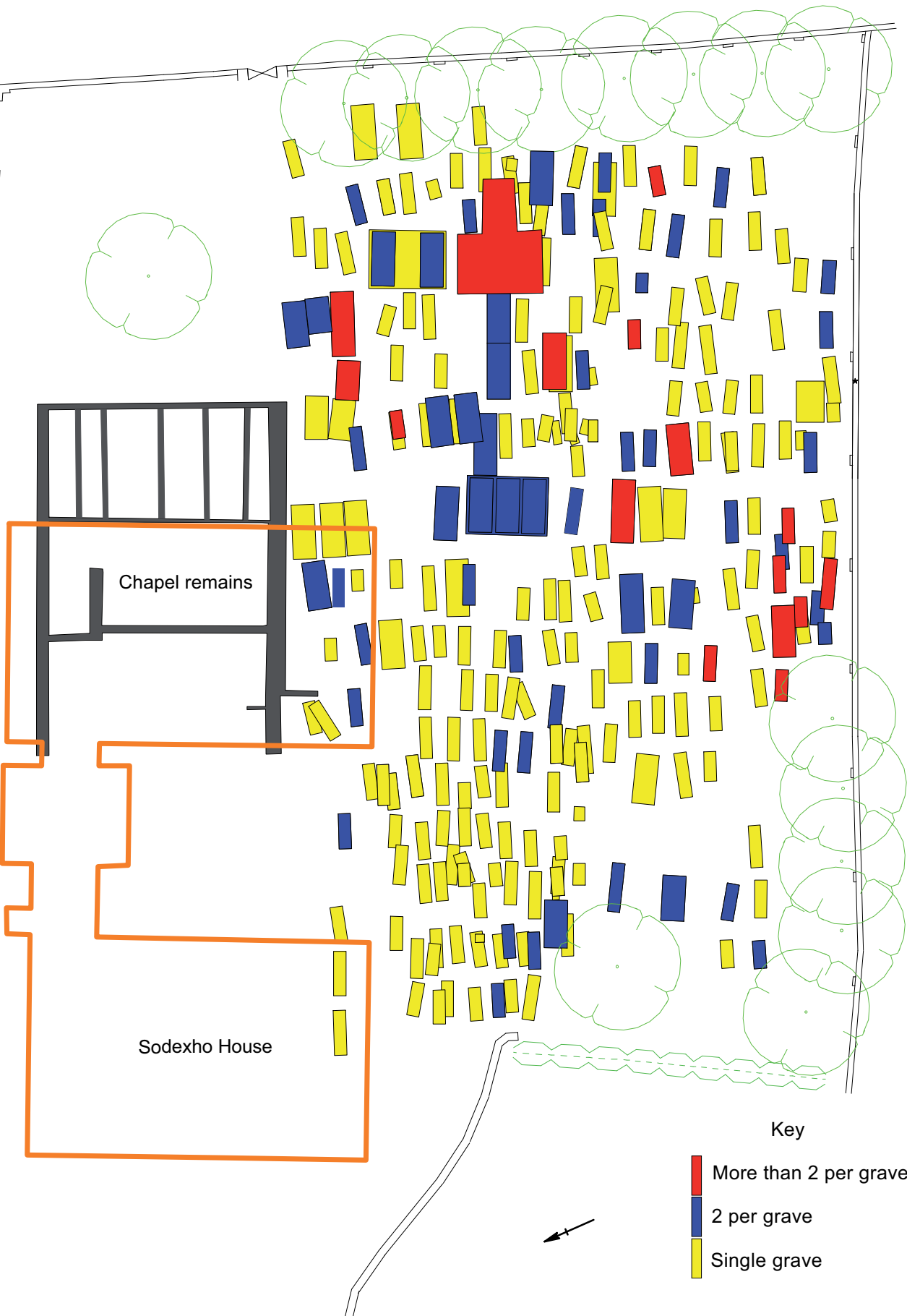

Key

- More than 2 per grave
- 2 per grave
- Single grave

Burials per grave

Scale 1:250

Figure 10

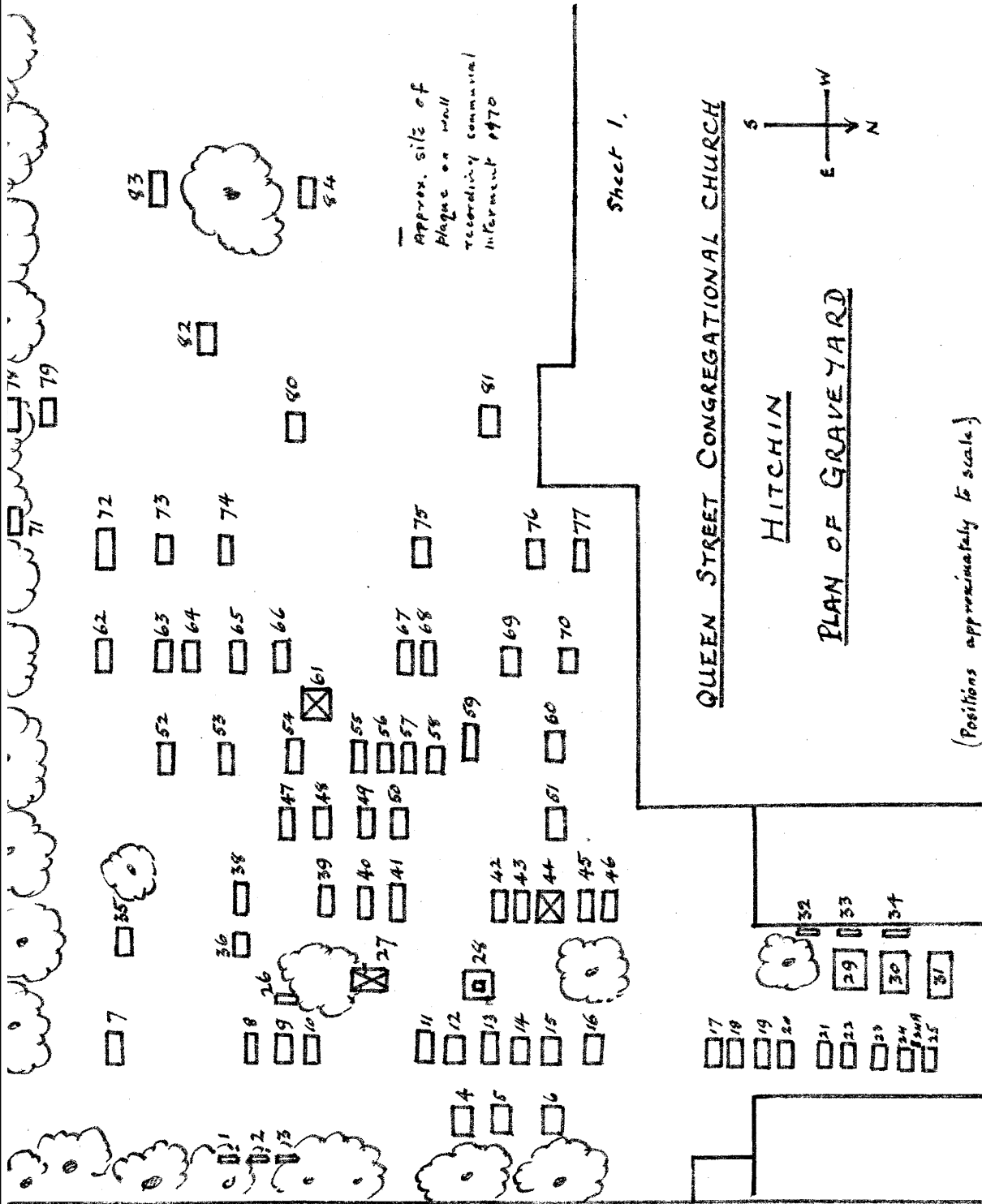

Plan of burial ground prepared by H.C. Jenkins, June 1970

(HALS ref. NR87/22)

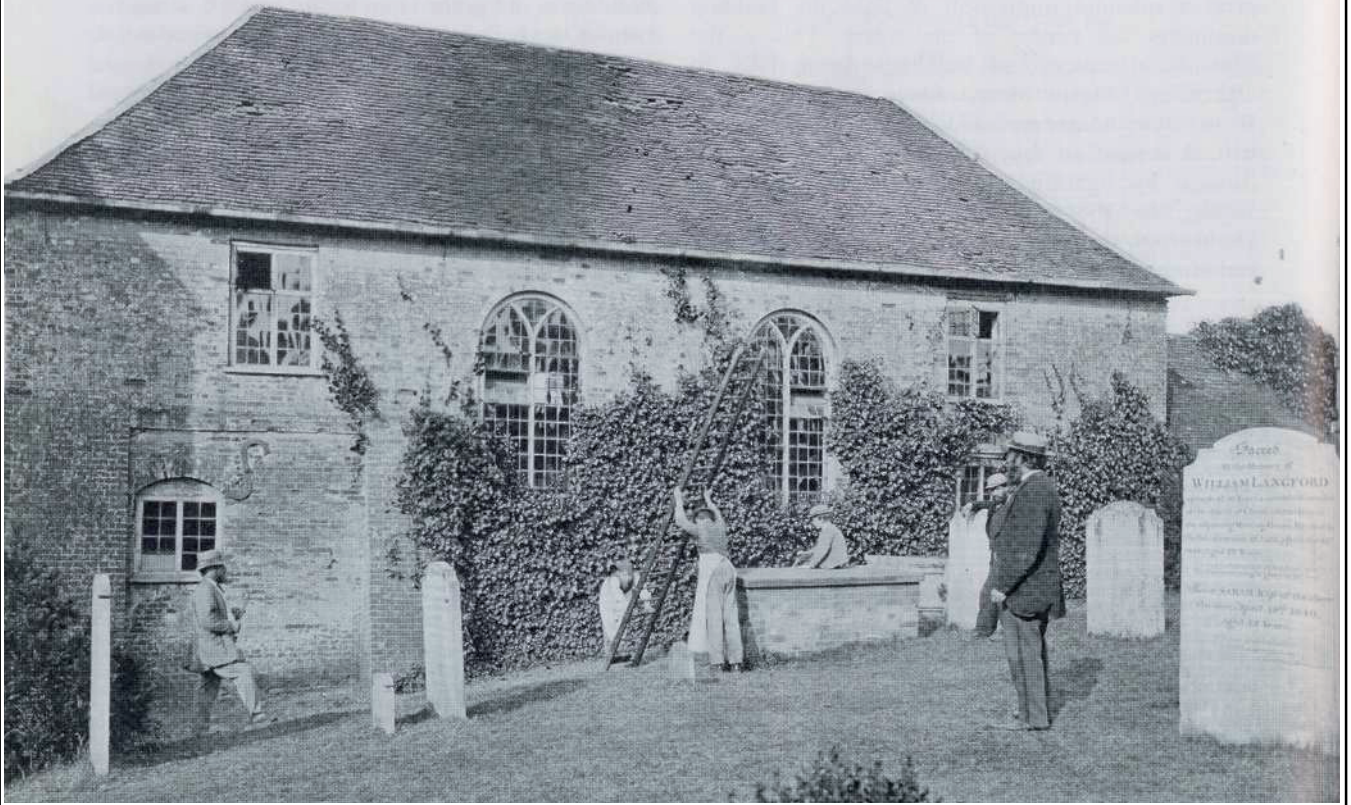

Plate 1: The original Independent Meeting House before its demolition in 1869

Latchmore Collection, Hitchin Museum



Plate 2: Foundations of 19th century Congregational Chapel, looking N



Plate 3: Tin glazed crockery inscribed "Congregational Church Hitchin"



Plate 4: General view of site, looking E



Plate 5: Opening Vault 42, looking N



Plate 6: General view of Vault 42, looking N



Plate 7: Vault 42, interior looking N



Plate 8: Vault 42, interior looking N



Plate 9: Brick grave 57



Plate 10: Brick grave 61, with inscription



Plate 11: Brick grave 87, looking W



Plate 12: Brick grave 227, facing W

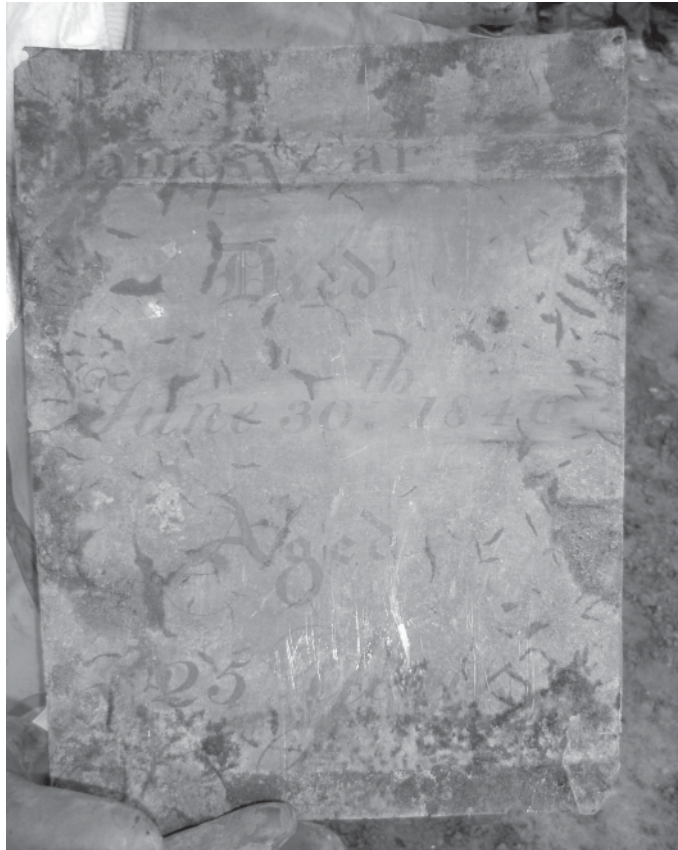

Plate 13: Detail of coffin plate from Grave 136
"James Cart[er], Died June 30th 1840, Aged 25 years"



Plate 14: Remains reinterred in communal grave 76



Plate 15: Craniotomy, from Brick grave 145



Plate 16: Dentures from Brick grave 105

Appendix 1: Recorded Burial Data

Grave Number	Skeleton Number	Type	NGR (TL) Easting	NGR (TL) Northing	Length	Depth from surface	Height	Completeness	Condition
1	1	Grave	18134.13	28813.76	1.80m	1.91m	n/a	Good	Good
2	2	Grave	18132.89	28812.89	1.56m	1.89m	n/a	Fair	Fair
3	3	Grave	18134.60	28815.51	1.73m	1.98m	n/a	Good	Fair
4	4	Grave	18136.53	28814.30	1.78m	1.97m	n/a	Good	Fair
4	5	Grave	18136.53	28814.30	1.78m	1.97m	n/a	Good	Good
5	6	Grave	18136.34	28812.52	1.74m	1.82m	n/a	Fragmentary	Good
6	7	Grave	18138.08	28815.12	1.82m	1.90m	n/a	Good	Fair
7	8	Grave	18138.04	28816.86	1.37m	1.88m	n/a	Fragmentary	Good
7	9	Grave	18138.04	28816.86	1.37m	1.88m	n/a	Good	Fair
7	10	Grave	18138.04	28816.86	1.37m	1.88m	n/a	Good	Fair
8	11	Grave	18135.44	28817.15	1.95m	1.72m	n/a	Good	Good
8	14	Grave	18136.25	28818.17	1.95m	1.72m	n/a	Good	Good
9	295	Brick Grave	18138.76	28819.23	2.46m	1.97m	0.71m	Good	Good
10	12	Grave	18131.19	28814.86	1.84m	1.97m	n/a	Good	Good
11	13	Grave	18129.60	28814.69	1.84m	1.98m	n/a	Good	Good
12	15	Grave	18136.19	28818.24	1.86m	1.74m	n/a	Good	Fair
13	16	Brick Grave	18134.72	28820.89	2.48m	2.54m	0.84m	Fair	Good
14	17	Grave	18134.21	28819.34	0.89m	1.61m	n/a	Good	Good
14	19	Grave	18134.21	28819.34	0.89m	1.61m	n/a	Good	Good
15	18	Grave	18137.18	28820.00	1.80m	1.44m	n/a	Fair	Good
16	20	Grave	18130.08	28817.91	2.21m	1.59m	n/a	Good	Powdered
17	21	Grave	18131.71	28816.08	1.70m	2.24m	n/a	Good	Fair
18	22	Grave	18132.39	28816.99	1.73m	2.40m	n/a	Good	Poor
19	23	Grave	18130.79	28819.00	2.09m	1.62m	n/a	Good	Good
20	24	Grave	18132.51	28818.45	1.72m	2.18m	n/a	Good	Good
21	25	Grave	18131.21	28819.71	1.50m	2.07m	n/a	Good	Good
22	26	Grave	18132.13	28820.73	1.34m	2.40m	n/a	Good	Good
22	27	Grave	18132.13	28820.73	1.34m	2.40m	n/a	Good	Good
22	28	Grave	18132.13	28820.73	1.34m	2.40m	n/a	Good	Good
23	29	Grave	18134.06	28821.43	1.72m	1.60m	n/a	Fragmentary	Good
24	30	Grave	18140.16	28819.96	1.89m	1.41m	n/a	Good	Poor
25	31	Brick Grave	18140.39	28821.66	2.46m	2.60m	1.03m	Fragmentary	Good
26	33	Grave	18138.42	28821.16	1.89m	2.22m	n/a	Good	Fair
26	34	Grave	18138.42	28821.16	1.89m	2.22m	n/a	Good	Good
27	32	Grave	18138.79	28822.37	1.73m	1.80m	n/a	Fair	Fair
28	35	Grave	18137.70	28819.89	1.71m	2.17m	n/a	Fair	Good
28	36	Grave	18137.70	28819.89	1.71m	2.17m	n/a	Fair	Fair
29	37	Grave	18135.68	28821.88	1.55m	1.74m	n/a	Good	Good
30	296	Brick Grave	18132.49	28824.60	2.59m	2.73m	2.21m	Fragmentary	Poor
31	38	Grave	18134.05	28822.75	1.66m	1.54m	n/a	Good	Good
32	39	Grave	18131.61	28823.57	1.77m	1.61m	n/a	Good	Good
32	40	Grave	18131.61	28823.57	1.77m	1.61m	n/a	Good	Fair
33	41	Grave	18131.24	28823.26	0.83m	2.41m	n/a	Fair	Good
34	297	Brick Grave	18132.25	28824.33	2.55m	2.39m	0.48m	Fragmentary	Poor
35	42	Grave	18141.57	28822.54	0.56m	1.02m	n/a	Good	Good
36	43	Grave	18143.76	28823.21	>0.30m	1.36m	n/a	n/a	n/a
37	44	Grave	18142.37	28824.99	1.57m	1.32m	n/a	Good	Good
38	45	Grave	18141.98	28826.29	0.88m	1.55m	n/a	Fragmentary	Good
39	46	Grave	18140.18	28825.32	1.54m	1.59m	n/a	Good	Good
39	52	Grave	18140.18	28825.32	1.54m	1.59m	n/a	Good	Poor
40	298	Brick Grave	18144.83	28826.14	>0.30m	n/a	n/a	n/a	n/a
41	n/a	Brick Structure	18139.57	28828.80	2.66m	2.02m	1.76m	n/a	n/a
42	n/a	Vault Entrance	18140.01	28823.92	2.43m	n/a	n/a	n/a	n/a
43	299	Vault	18137.74	28824.94	2.77m	2.61m	2.59m	Fair	Fair
43	300	Vault	18137.74	28824.94	2.77m	2.61m	2.59m	Fragmentary	Poor
44	301	Brick Grave	18145.76	28828.08	>0.30m	n/a	n/a	n/a	n/a
45	47	Grave	18142.79	28829.76	1.82m	1.40m	n/a	Fragmentary	Good

Grave Number	Skeleton Number	Type	NGR (TL) Easting	NGR (TL) Northing	Length	Depth from surface	Height	Completeness	Condition
45	48	Grave	18142.79	28829.76	1.82m	1.40m	n/a	Good	Poor
46	49	Grave	18145.92	28831.54	>0.30m	1.32m	n/a	n/a	n/a
47	50	Grave	18142.56	28828.41	1.65m	1.70m	n/a	Fair	Good
48	51	Grave	18142.31	28827.44	1.88m	1.88m	n/a	Good	Fair
49	53	Grave	18134.85	28825.11	1.98m	1.35m	n/a	Good	Good
50	54	Grave	18135.82	28827.01	1.68m	1.55m	n/a	Fair	Good
51	55	Grave	18137.39	28829.61	1.66m	1.25m	n/a	Good	Good
52	302	Brick Grave	18135.34	28826.07	2.23m	1.91m	0.99m	Fragmentary	Poor
53	56	Grave	18136.76	28828.92	2.02m	1.69m	n/a	Good	Good
54	57	Grave	18141.06	28831.20	1.97m	1.94m	n/a	Good	Good
55	58	Grave	18141.74	28832.08	1.82m	1.83m	n/a	Fair	Fair
56	59	Grave	18142.64	28832.84	1.80m	1.83m	n/a	Good	Good
57	303	Brick Grave	18138.07	28832.70	2.96m	2.50m	2.37m	Fragmentary	Poor
58	60	Grave	18139.18	28833.89	1.37m	1.17m	n/a	Fair	Good
59	304	Brick Grave	18139.03	28833.46	1.62m	2.43m	1.27m	Fair	Fair
60	305	Brick Grave	18138.97	28834.63	2.10m	2.10m	1.03m	Fragmentary	Poor
61	306	Brick Grave	18135.67	28833.52	1.78m	2.44m	1.90m	Fair	Fair
62	307	Brick Grave	18133.15	28827.07	2.55m	2.35m	1.77m	Fair	Fair
63	308	Brick Grave	18131.80	28829.20	2.28m	2.37m	1.65m	Fair	Fair
63	309	Brick Grave	18131.80	28829.20	2.28m	2.37m	1.65m	Fair	Fair
64	61	Grave	18137.45	28830.78	1.37m	1.71m	n/a	Fragmentary	Good
65	62	Grave	18135.48	28831.15	1.64m	1.76m	n/a	Good	Good
66	63	Grave	18133.76	28831.35	1.01m	1.36m	n/a	Fragmentary	Good
67	64	Grave	18134.52	28830.31	1.81m	1.47m	n/a	Good	Good
68	65	Grave	18134.34	28829.45	1.57m	1.20m	n/a	Good	Good
69	66	Grave	18138.10	28831.70	1.66m	1.27m	n/a	Good	Fair
70	67	Grave	18132.90	28832.30	1.29m	2.01m	n/a	Fair	Good
70	69	Grave	18132.90	28832.30	1.29m	2.01m	n/a	Good	Poor
70	70	Grave	18132.90	28832.30	1.29m	2.01m	n/a	Good	Good
71	68	Grave	18133.66	28832.50	1.69m	1.83m	n/a	Good	Good
72	310	Brick Grave	18132.16	28830.43	2.27m	2.37m	1.11m	Fragmentary	Poor
73	311	Brick Grave	18126.38	28821.01	2.36m	2.57m	2.06m	Fair	Fair
73	312	Brick Grave	18126.38	28821.01	2.36m	2.57m	2.06m	Fair	Fair
74	71	Grave	18126.38	28819.82	1.80m	1.89m	n/a	Good	Good
75	72	Grave	18127.32	28816.77	1.72m	2.00m	n/a	Good	Fair
76	n/a	Mass grave	18126.01	28814.72	1.84m	2.99m	n/a	n/a	n/a
77	73	Grave	18125.17	28817.65	1.98m	2.21m	n/a	Good	Powdered
78	74	Grave	18125.60	28819.54	1.98m	1.56m	n/a	Fair	Good
79	75	Grave	18125.48	28818.84	1.87m	1.50m	n/a	Fragmentary	Powdered
80	76	Grave	18127.73	28817.88	1.53m	1.76m	n/a	Good	Good
81	77	Grave	18128.22	28818.98	1.36m	2.11m	n/a	Good	Good
82	78	Grave	18125.44	28818.92	1.80m	2.39m	n/a	Fair	Poor
83	79	Grave	18124.58	28815.77	0.89m	2.59m	n/a	Fragmentary	Good
84	80	Grave	18124.89	28816.42	1.75m	2.64m	n/a	Good	Poor
85	81	Grave	18128.73	28820.21	1.60m	1.57m	n/a	Poor	Good
86	313	Brick Grave	18124.37	28823.47	2.55m	2.45m	0.71m	Fair	Fair
87	314	Brick Grave	18125.03	28824.51	2.89m	1.88m	1.01m	Fair	Fair
87	315	Brick Grave	18125.03	28824.51	2.89m	1.88m	1.01m	Fair	Fair
87	316	Brick Grave	18125.03	28824.51	2.89m	1.88m	1.01m	Fair	Fair
88	82	Grave	18127.20	28822.18	1.68m	2.04m	n/a	Good	Good
88	84	Grave	18127.20	28822.18	1.68m	2.04m	n/a	Good	Good
89	83	Grave	18127.48	28823.18	1.78m	2.20m	n/a	Good	Good
89	85	Grave	18127.48	28823.18	1.78m	2.20m	n/a	Fair	Poor
90	317	Brick Grave	18123.92	28822.49	2.30m	2.65m	0.60m	Fair	Fair
91	318	Brick Grave	18134.15	28834.47	1.85m	1.58m	0.61m	n/a	n/a
92	319	Brick Grave	18134.68	28835.53	1.98m	1.36m	0.37m	Fragmentary	Poor
93	n/a	Church Foundations	18123.62	28847.91	n/a	1.39m	n/a	n/a	n/a
94	128	Brick Grave	18130.19	28838.28	2.49m	1.51m	0.12m	Fragmentary	Good
95	n/a	Brick Grave	18129.66	28836.99	2.52m	1.51m	0.14m	n/a	n/a
96	127	Brick Grave	18129.37	28835.90	2.50m	1.51m	0.11m	Fragmentary	Good
97	86	Grave	18132.70	28834.39	2.00m	1.38m	n/a	Fair	Good

Grave Number	Skeleton Number	Type	NGR (TL) Easting	NGR (TL) Northing	Length	Depth from surface	Height	Completeness	Condition
97	87	Grave	18132.70	28834.39	2.00m	1.38m	n/a	Fragmentary	Good
98	88	Grave	18131.98	28829.83	2.00m	0.86m	n/a	Fragmentary	Good
99	89	Grave	18132.68	28832.39	1.77m	2.07m	n/a	Fragmentary	Good
100	320	Brick Grave	18130.32	28829.03	2.84m	2.17m	1.63m	n/a	n/a
101	90	Grave	18132.59	28825.71	2.01m	1.82m	n/a	Good	Good
102	321	Brick Grave	18128.23	28831.98	2.46m	1.97m	1.41m	Fair	Fair
103	91	Grave	18130.36	28827.99	2.07m	1.45m	n/a	Fair	Good
104	322	Brick Grave	18136.98	28823.19	2.16m	2.36m	0.38m	Fair	Fair
105	92	Grave	18139.28	28817.64	1.87m	2.71m	n/a	Good	Good
106	93	Grave	18139.52	28818.79	1.77m	3.11m	n/a	Good	Good
106	94	Grave	18139.52	28818.79	1.77m	3.11m	n/a	Fragmentary	Good
107	95	Grave	18139.77	28822.73	1.89m	1.57m	n/a	Good	Good
108	96	Grave	18141.26	28822.81	1.73m	1.53m	n/a	Good	Good
109	97	Grave	18141.88	28823.80	1.97m	1.70m	n/a	Good	Good
110	323	Brick Grave	18139.13	28827.68	2.46m	2.02m	1.68m	Fragmentary	Poor
111	324	Brick Grave	18140.11	28829.71	2.46m	2.02m	1.68m	Fragmentary	Poor
112	n/a	Cut	18139.64	28828.70	n/a	3.20m	2.96m	n/a	n/a
113	98	Grave	18132.38	28831.07	2.01m	1.40m	n/a	Fragmentary	Good
114	99	Grave	18122.46	28820.22	1.93m	2.29m	n/a	Good	Powdered
114	101	Grave	18122.46	28820.22	1.93m	2.29m	n/a	Good	Powdered
115	100	Grave	18121.29	28817.91	1.62m	1.93m	n/a	Poor	Poor
115	102	Grave	18121.29	28817.91	1.62m	1.93m	n/a	Good	Fair
115	103	Grave	18121.29	28817.91	1.62m	1.93m	n/a	Good	Fair
116	104	Grave	18122.36	28819.16	1.64m	2.61m	n/a	Good	Good
117	105	Grave	18120.29	28818.67	1.59m	1.85m	n/a	Good	Powdered
117	121	Grave	18120.29	28818.67	1.59m	1.85m	n/a	Good	Good
118	123	Grave	18120.12	28820.22	1.74m	2.62m	n/a	Good	Powdered
119	106	Grave	18123.75	28827.28	1.35m	1.28m	n/a	Good	Good
120	107	Grave	18126.00	28826.58	2.11m	2.49m	n/a	Fragmentary	Good
120	113	Grave	18126.00	28826.58	2.11m	2.49m	n/a	Good	Good
121	n/a	Brick Structure	18127.52	28829.20	2.70m	2.06m	1.64m	n/a	n/a
122	325	Brick Grave	18124.94	28832.93	2.64m	1.64m	1.25m	Fair	Fair
123	108	Grave	18123.05	28830.43	1.52m	1.01m	n/a	Good	Good
124	109	Grave	18128.03	28825.40	1.41m	1.85m	n/a	Fragmentary	Good
125	110	Grave	18129.04	28825.18	0.66m	1.66m	n/a	Good	Good
126	111	Grave	18130.21	28825.04	1.83m	1.79m	n/a	Fair	Good
127	112	Grave	18129.57	28825.79	1.10m	1.72m	n/a	Good	Good
128	114	Grave	18129.96	28826.16	1.18m	1.73m	n/a	Fair	Good
129	326	Brick Grave	18127.93	28830.29	2.47m	2.06m	1.64m	Fair	Fair
130	327	Brick Grave	18127.38	28829.31	2.47m	2.03m	1.61m	Fair	Fair
131	328	Brick Grave	18126.91	28828.14	2.49m	2.03m	1.61m	Fair	Fair
132	115	Grave	18120.27	28829.27	1.35m	0.91m	n/a	Good	Good
133	116	Grave	18119.88	28828.10	1.80m	1.04m	n/a	Good	Good
134	329	Slab Grave	18118.71	28827.57	1.91m	1.31m	0.48m	Fair	Fair
135	330	Brick Grave	18120.96	28825.93	2.69m	2.45m	1.38m	Fair	Fair
136	331	Brick Grave	18119.98	28823.88	2.24m	2.56m	1.59m	Fair	Fair
137	117	Grave	18129.24	28824.48	0.71m	1.80m	n/a	Good	Good
138	118	Grave	18128.96	28824.22	0.97m	1.74m	n/a	Good	Good
139	119	Grave	18129.57	28825.06	1.49m	2.03m	n/a	Good	Good
140	120	Grave	18130.10	28827.00	1.29m	1.88m	n/a	Good	Good
141	332	Brick Grave	18116.99	28820.13	2.36m	3.30m	1.78m	n/a	n/a
142	122	Grave	18119.77	28821.48	1.87m	2.20m	n/a	Good	Good
143	124	Grave	18119.38	28819.23	1.71m	2.68m	n/a	Fragmentary	Good
143	125	Grave	18119.38	28819.23	1.71m	2.68m	n/a	Good	Good
143	126	Grave	18119.38	28819.23	1.71m	2.68m	n/a	Good	Good
144	333	Brick Grave	18127.64	28838.68	2.21m	1.37m	1.27m	Fair	Fair
145	334	Brick Grave	18113.38	28828.72	2.29m	1.63m	1.08m	Fair	Fair
146	129	Grave	18114.77	28821.25	1.43m	1.85m	n/a	Fragmentary	Powdered
146	130	Grave	18114.77	28821.25	1.43m	1.85m	n/a	Good	Fair
146	131	Grave	18114.77	28821.25	1.43m	1.85m	n/a	Good	Good
147	132	Grave	18117.05	28823.81	1.62m	2.27m	n/a	Good	Poor

Grave Number	Skeleton Number	Type	NGR (TL) Easting	NGR (TL) Northing	Length	Depth from surface	Height	Completeness	Condition
147	143	Grave	18117.05	28823.81	1.62m	2.27m	n/a	Good	Good
147	144	Grave	18117.05	28823.81	1.62m	2.27m	n/a	Good	Good
148	142	Grave	18117.43	28821.35	1.62m	2.61m	n/a	Good	Good
149	133	Grave	18116.90	28833.19	1.87m	0.95m	n/a	Fair	Fair
149	134	Grave	18116.90	28833.19	1.87m	0.95m	n/a	Good	Good
150	135	Grave	18116.58	28831.75	1.75m	1.13m	n/a	Good	Good
150	136	Grave	18116.58	28831.75	1.75m	1.13m	n/a	Good	Fair
150	137	Grave	18116.58	28831.75	1.75m	1.13m	n/a	Fragmentary	Good
151	138	Grave	18116.26	28831.24	1.67m	1.18m	n/a	Good	Good
152	139	Grave	18125.57	28834.06	2.05m	1.73m	n/a	Good	Fair
153	140	Grave	18124.89	28832.32	1.88m	1.88m	n/a	Good	Good
153	141	Grave	18124.89	28832.32	1.88m	1.88m	n/a	Good	Good
154	n/a	Church Foundations	18123.62	28847.91	n/a	1.39m	0.32m-0.56m	n/a	n/a
155	145	Grave	18116.15	28828.00	1.66m	2.04m	n/a	Good	Good
156	146	Grave	18115.85	28826.96	1.69m	2.25m	n/a	Good	Good
157	147	Grave	18118.19	28826.26	1.84m	1.89m	n/a	Fragmentary	Poor
157	151	Grave	18118.19	28826.26	1.84m	1.89m	n/a	Fair	Good
158	148	Grave	18127.28	28837.82	1.77m	1.94m	n/a	Fragmentary	Good
158	149	Grave	18127.28	28837.82	1.77m	1.94m	n/a	Good	Good
159	150	Grave	18120.16	28823.18	0.69m	1.10m	n/a	Fragmentary	Good
160	152	Grave	18127.21	28836.89	0.98m	2.24m	n/a	Fair	Good
161	153	Grave	18126.78	28835.17	1.32m	2.28m	n/a	Fragmentary	Good
162	154	Grave	18123.39	28835.54	1.59m	1.51m	n/a	Good	Good
163	155	Grave	18123.10	28834.67	1.42m	1.20m	n/a	Fair	Good
164	156	Grave	18122.39	28833.71	1.78m	1.09m	n/a	Good	Good
165	157	Grave	18122.35	28828.62	1.89m	1.30m	n/a	Good	Good
166	158	Grave	18121.66	28827.57	1.26m	1.12m	n/a	Good	Poor
167	159	Grave	18122.76	28829.23	1.87m	1.65m	n/a	Good	Good
168	160	Grave	18123.35	28826.34	1.56m	1.40m	n/a	Good	Fair
169	161	Grave	18121.60	28832.29	1.72m	1.35m	n/a	Good	Poor
170	162	Grave	18121.14	28831.71	1.64m	1.03m	n/a	Good	Poor
170	163	Grave	18121.14	28831.71	1.64m	1.03m	n/a	Good	Good
171	164	Grave	18120.42	28824.88	1.73m	2.56m	n/a	Good	Good
172	165	Grave	18115.08	28822.22	1.73m	2.48m	n/a	Good	Good
173	166	Grave	18117.51	28824.92	1.00m	1.74m	n/a	Good	Good
174	167	Grave	18118.07	28828.94	1.76m	1.29m	n/a	Fair	Good
175	168	Grave	18118.16	28831.04	1.98m	1.08m	n/a	Fair	Poor
175	169	Grave	18118.16	28831.04	1.98m	1.08m	n/a	Good	Good
176	170	Grave	18120.17	28830.11	1.61m	1.02m	n/a	Good	Poor
177	171	Grave	18119.05	28832.27	1.64m	0.94m	n/a	Good	Good
178	172	Grave	18114.09	28824.50	1.57m	2.65m	n/a	Good	Powdered
179	173	Grave	18112.76	28825.71	1.35m	1.69m	n/a	Good	Good
180	174	Grave	18115.46	28825.96	1.99m	2.65m	n/a	Good	Fair
181	175	Grave	18112.91	28827.02	2.08m	2.35m	n/a	Good	Good
182	176	Grave	18115.61	28829.49	1.74m	1.54m	n/a	Good	Powdered
183	177	Grave	18115.90	28830.59	2.19m	1.84m	n/a	Good	Good
184	178	Grave	18114.69	28832.76	1.82m	1.04m	n/a	Good	Good
185	179	Grave	18115.40	28831.06	1.81m	1.81m	n/a	Good	Good
186	180	Grave	18113.28	28832.08	0.64m	1.01m	n/a	Good	Good
187	181	Grave	18119.92	28833.47	1.71m	1.02m	n/a	Good	Good
188	182	Grave	18117.38	28834.22	1.85m	1.09m	n/a	Good	Fair
188	183	Grave	18117.38	28834.22	1.85m	1.09m	n/a	Good	Good
189	184	Grave	18118.74	28835.91	1.98m	0.86m	n/a	Good	Good
190	185	Grave	18118.22	28834.84	1.93m	1.00m	n/a	Good	Good
191	186	Grave	18116.20	28836.53	1.18m	0.59m	n/a	Fragmentary	Poor
192	188	Grave	18116.53	28835.49	1.47m	0.81m	n/a	Good	Good
193	190	Grave	18115.89	28834.78	2.04m	0.91m	n/a	Fair	Fair
194	189	Grave	18120.50	28834.43	1.85m	1.20m	n/a	Fair	Good
195	191	Grave	18120.09	28833.80	1.93m	1.47m	n/a	Good	Good
196	187	Grave	18119.44	28832.76	1.90m	1.23m	n/a	Good	Good
197	192	Grave	18122.00	28839.40	1.72m	1.11m	n/a	Fragmentary	Good

Grave Number	Skeleton Number	Type	NGR (TL) Easting	NGR (TL) Northing	Length	Depth from surface	Height	Completeness	Condition
197	193	Grave	18122.00	28839.40	1.72m	1.11m	n/a	Fragmentary	Good
198	194	Grave	18119.38	28836.99	1.90m	1.09m	n/a	Good	Good
199	195	Grave	18121.40	28836.14	2.02m	2.18m	n/a	Good	Good
200	199	Grave	18117.07	28837.26	1.93m	n/a	n/a	Fragmentary	Good
201	196	Grave	18117.70	28839.49	1.66m	1.23m	n/a	Fair	Fair
202	197	Grave	18118.01	28838.22	1.92m	1.33m	n/a	Good	Good
203	198	Grave	18118.18	28839.76	1.85m	1.22m	n/a	Good	Good
204	200	Grave	18118.59	28840.19	1.64m	1.06m	n/a	Fragmentary	Good
205	201	Grave	18121.99	28840.91	1.88m	1.11m	n/a	Fair	Good
206	202	Grave	18122.38	28841.37	1.50m	1.17m	n/a	Fair	Good
207	203	Brick Grave	18123.86	28836.71	2.34m	2.46m	0.63m	Good	Powdered
208	204	Grave	18124.86	28839.31	1.05m	1.60m	n/a	Good	Good
209	205	Grave	18124.44	28837.83	1.86m	2.56m	n/a	Good	Poor
209	206	Grave	18124.44	28837.83	1.86m	2.56m	n/a	Good	Poor
210	207	Grave	18104.02	28827.27	1.27m	2.19m	n/a	Good	Good
210	208	Grave	18104.02	28827.27	1.27m	2.19m	n/a	Good	Good
211	209	Grave	18106.70	28827.56	1.68m	2.40m	n/a	Fair	Poor
211	210	Grave	18106.70	28827.56	1.68m	2.40m	n/a	Good	Fair
212	211	Grave	18108.57	28825.36	1.92m	3.22m	n/a	Fair	Fair
213	212	Grave	18106.29	28826.15	1.73m	2.12m	n/a	Good	Good
214	213	Grave	18104.62	28828.62	>0.30m	2.54m	n/a	Good	Good
215	215	Brick Grave	18107.95	28829.89	2.07m	2.19m	1.30m	Fragmentary	Fair
215	222	Brick Grave	18107.95	28829.89	2.07m	2.19m	1.30m	Fragmentary	Fair
216	214	Grave	18109.49	28831.94	2.25m	1.55m	n/a	n/a	Good
217	216	Grave	18112.19	28833.52	1.07m	1.02m	n/a	Good	Good
218	217	Grave	18111.15	28834.14	1.70m	1.13m	n/a	Fragmentary	Fair
218	218	Grave	18111.15	28834.14	1.70m	1.13m	n/a	Good	Good
219	219	Grave	18110.76	28833.25	1.00m	1.03m	n/a	Good	Good
220	220	Grave	18112.74	28834.77	1.68m	0.79m	n/a	Good	Good
221	221	Grave	18113.55	28835.70	1.68m	0.85m	n/a	Fair	Poor
222	223	Grave	18114.38	28836.39	1.59m	0.85m	n/a	Good	Good
223	224	Grave	18110.78	28835.47	2.18m	1.00m	n/a	Good	Good
224	225	Grave	18110.91	28834.27	1.31m	1.25m	n/a	Fragmentary	Good
225	226	Grave	18111.74	28836.24	1.98m	0.79m	n/a	Good	Fair
226	227	Grave	18112.30	28836.76	1.05m	0.80m	n/a	Fair	Fair
227	263	Brick Grave	18109.08	28835.18	2.18m	2.36m	0.56m	Fragmentary	Powdered
227	264	Brick Grave	18109.08	28835.18	2.18m	2.36m	1.21m	Good	Powdered
228	228	Grave	18108.39	28836.58	1.70m	0.70m	n/a	Fragmentary	Poor
228	229	Grave	18108.39	28836.58	1.70m	0.70m	n/a	Good	Poor
229	230	Grave	18108.66	28836.97	1.55m	0.86m	n/a	Good	Good
230	231	Grave	18109.37	28837.45	1.54m	0.94m	n/a	Good	Fair
230	232	Grave	18109.37	28837.45	1.54m	0.94m	n/a	Good	Good
231	236	Grave	18111.53	28837.91	1.57m	0.99m	n/a	Good	Good
232	237	Grave	18109.64	28838.84	1.61m	0.92m	n/a	Good	Good
233	238	Grave	18110.08	28839.72	1.73m	0.90m	n/a	Good	Good
234	234	Grave	18110.37	28840.61	1.78m	0.81m	n/a	Fair	Good
235	235	Grave	18107.29	28840.02	1.54m	0.58m	n/a	Good	Poor
236	233	Grave	18109.02	28838.01	1.55m	0.96m	n/a	Fragmentary	Poor
237	239	Grave	18108.06	28841.08	1.64m	0.80m	n/a	Good	Fair
238	240	Grave Pit	18109.99	28838.62	0.38m	1.12m	n/a	Good	Poor
239	241	Grave	18107.04	28839.05	1.57m	0.88m	n/a	Good	Fair
239	242	Grave	18107.04	28839.05	1.57m	0.88m	n/a	Good	Good
240	243	Grave	18107.84	28841.61	1.56m	1.22m	n/a	Fragmentary	Good
241	244	Grave	18110.00	28840.96	1.44m	1.07m	n/a	Fragmentary	Good
242	245	Grave	18110.27	28841.65	1.82m	1.17m	n/a	Good	Good
243	246	Grave	18111.75	28842.00	1.56m	1.24m	n/a	Fragmentary	Good
244	247	Grave	18108.67	28842.46	1.55m	1.30m	n/a	Fragmentary	Fair
245	251	Grave	18112.88	28838.09	1.07m	1.81m	n/a	Fragmentary	Good
246	248	Grave	18106.97	28838.40	1.52m	0.63m	n/a	Good	Good
247	249	Grave	18106.51	28837.63	2.06m	0.89m	n/a	Good	Good
248	250	Grave	18108.43	28834.90	1.92m	0.96m	n/a	Good	Good

Grave Number	Skeleton Number	Type	NGR (TL) Easting	NGR (TL) Northing	Length	Depth from surface	Height	Completeness	Condition
249	252	Grave	18114.94	28837.13	1.77m	0.80m	n/a	Good	Good
250	253	Grave	18113.52	28838.40	1.84m	0.95m	n/a	Good	Good
251	254	Grave	18115.25	28838.07	1.62m	0.85m	n/a	Good	Good
252	255	Grave	18110.22	28834.67	1.48m	2.00m	n/a	Fragmentary	Good
253	256	Grave	18116.04	28840.10	1.52m	0.95m	n/a	Good	Fair
253	257	Grave	18116.04	28840.10	1.52m	1.15m	n/a	Good	Fair
254	258	Grave	18114.57	28840.52	1.82m	0.92m	n/a	Good	Good
255	259	Grave	18115.10	28839.14	1.71m	0.85m	n/a	Fragmentary	Good
256	260	Grave	18113.24	28837.92	1.43m	0.92m	n/a	Fair	Good
257	261	Grave	18113.32	28839.88	1.77m	0.99m	n/a	Fragmentary	Good
258	262	Grave	18116.06	28840.11	1.77m	0.89m	n/a	Fragmentary	Good
259	265	Grave	18108.72	28846.25	2.06m	0.64m	n/a	Good	Good
260	266	Grave	18111.20	28845.10	2.02m	0.45m	n/a	Fair	Good
261	267	Grave	18113.21	28844.25	1.65m	0.24m	n/a	Fair	Good
262	268	Grave	18117.04	28842.19	1.63m	1.51m	n/a	Fair	Good
262	269	Grave	18117.04	28842.19	1.63m	1.51m	n/a	Fair	Good
263	270	Grave	18130.59	28811.56	1.52m	2.54m	n/a	Good	Good
263	274	Grave	18130.59	28811.56	1.52m	2.54m	n/a	Good	Poor
264	271	Grave	18128.77	28812.59	1.66m	2.88m	n/a	Good	Good
264	272	Grave	18128.77	28812.59	1.66m	2.88m	n/a	Fair	Fair
265	n/a	Mass Grave	18126.58	28813.32	2.15m	3.38m	n/a	n/a	n/a
266	273	Grave	18131.55	28812.62	1.51m	2.37m	n/a	Fair	Poor
267	275	Grave	18125.20	28813.87	0.87m	2.12m	n/a	Fair	Fair
268	276	Grave	18123.98	28815.58	1.82m	2.81m	n/a	Fair	Fair
268	277	Grave	18123.98	28815.58	1.82m	2.81m	n/a	Poor	Poor
269	278	Grave	18121.19	28815.92	1.02m	1.90m	n/a	Fair	Poor
270	279	Grave	18119.80	28816.57	1.21m	1.73m	n/a	Good	Poor
271	280	Grave	18118.16	28817.32	1.21m	2.01m	n/a	Poor	Fair
271	281	Grave	18118.16	28817.32	1.21m	2.01m	n/a	Poor	Fair
271	282	Grave	18118.16	28817.32	1.21m	2.01m	n/a	Poor	Fair
271	283	Grave	18118.16	28817.32	1.21m	2.01m	n/a	Fair	Fair
271	284	Grave	18118.16	28817.32	1.21m	2.01m	n/a	Fair	Fair
272	285	Grave	18116.17	28818.43	0.99m	1.91m	n/a	Poor	Good
272	286	Grave	18116.17	28818.43	0.99m	1.91m	n/a	Poor	Poor
273	287	Grave	18117.37	28818.24	1.54m	2.19m	n/a	Good	Good
273	288	Grave	18117.37	28818.24	1.54m	2.19m	n/a	Good	Fair
274	289	Grave	18117.52	28819.01	1.39m	2.31m	n/a	Good	Good
274	290	Grave	18117.52	28819.01	1.39m	2.31m	n/a	Fair	Fair
274	291	Grave	18117.52	28819.01	1.39m	2.31m	n/a	Poor	Poor
274	293	Grave	18117.52	28819.01	1.39m	2.31m	n/a	Fair	Good
275	292	Grave	18119.37	28817.87	1.68m	2.49m	n/a	Poor	Poor
276	294	Grave	18116.96	28819.20	1.74m	2.70m	n/a	Poor	Poor

Appendix 2: Inventory of Artefacts

Grave Number	Skeleton Number	Type	Root Activity	Wood	Coffin Nails	Coffin Handles	Metal Straps	Shroud Pins	Buttons	Cu alloy Coffin Studs	Dentures	Clothing Decoration	Metal Rings	Hair Combs	Plate	Lead Coffin	Adult	Inscription	Comments
1	1	Grave	No	Yes	Yes	No	Yes	No	No	No	No	No	No	No	No	No	Yes		
2	2	Grave	No	Yes	Yes	No	No	No	No	No	No	No	No	No	No	No	Yes		
3	3	Grave	No	Yes	No	No	Yes	No	No	No	No	No	No	No	No	No	Yes		
4	4	Grave	No	Yes	No	No	No	No	No	No	No	No	No	No	Yes	No	Yes	Cu alloy plate; "Ann Game? Died 14th Dec? 1834 Aged 79 Years"	
4	5	Grave	No	Yes	Yes	Yes	No	No	No	No	No	No	No	No	No	No	Yes	Gravestone fragment in fill of grave 4 read HG 1828 AG 1834	
5	6	Grave	No	Yes	Yes	110	No	No	No	No	No	No	No	No	No	No	Yes		Truncated by Geotechnical pit
6	7	Grave	No	Yes	Yes	Yes	No	No	No	No	No	No	No	No	No	No	Yes		
7	8	Grave	No	No	No	No	No	No	No	No	No	No	No	No	No	No	Yes		
7	9	Grave	No	Yes	Yes	Yes	No	No	No	No	No	No	No	No	No	No	Yes		
7	10	Grave	No	Yes	Yes	Yes	No	No	No	No	No	No	No	No	No	No	Yes		
8	11	Grave	Yes	Yes	Yes	Yes	No	No	No	No	No	No	No	No	No	No	Yes		
8	14	Grave	Yes	Yes	Yes	Yes	No	No	No	No	No	No	No	No	No	No	Yes		
9	295	Brick Grave	n/a	n/a	n/a	n/a	n/a	n/a	n/a	n/a	n/a	n/a	n/a	n/a	No	No	Yes		
10	12	Grave	Yes	Yes	Yes	No	No	Yes	No	No	No	No	No	No	No	No	Yes		
11	13	Grave	No	Yes	Yes	Yes	No	No	No	No	No	No	No	No	Yes	No	Yes	Fe plate writing illegible	
12	15	Grave	Yes	Yes	Yes	No	No	No	No	No	No	No	No	No	No	No	Yes		
13	16	Brick Grave	n/a	n/a	n/a	n/a	n/a	n/a	n/a	n/a	n/a	n/a	n/a	n/a	No	No	Yes	Two grave stone fragments found in fill, the first read "Affectionate Remembrance Louisa the beloved wife of William Braund of this town, who died 28th November 1857 In the 62nd year of her age. Also Friedrich, Son of the above who died 2nd October 187? in the 12th year of his age and of the two children interred ?po? who died...?" The second fragment read "LB 1855 WB 1866"	Disarticulated in brick grave back fill,
14	17	Grave	No	Yes	Yes	No	No	No	No	No	No	No	No	No	No	No	Yes		
14	19	Grave	No	Yes	Yes	No	No	No	No	No	No	No	No	No	No	No	Yes		
15	18	Grave	Yes	Yes	Yes	Yes	Yes	No	No	No	No	No	No	No	No	No	Yes		
16	20	Grave	Yes	Yes	Yes	Yes	No	No	No	No	No	No	No	No	No	No	Yes		Shroud material survived
17	21	Grave	Yes	Yes	Yes	Yes	No	No	No	No	No	No	No	No	Yes	No	Yes	Coffin plate fragment read "En? ... Sey? ... Died... 13 ... 8.8m"	Left tibia & fibula showed a compressed fracture, bone was fully mended
18	22	Grave	Yes	Yes	Yes	Yes	No	No	No	No	No	No	No	No	Yes	No	Yes	Cu alloy plate; "Elizabeth Pitt born September ?? 1819 Died April 12th 1???" (1853)	
19	23	Grave	Yes	Yes	Yes	No	No	No	No	No	No	No	No	No	No	No	Yes		
20	24	Grave	No	No	No	Yes	No	No	No	No	No	No	No	No	Yes	No	Yes	Cu alloy plate; "John Smith Died June 7th 1831 Aged 76"	
21	25	Grave	Yes	Yes	Yes	Yes	No	No	No	No	No	No	No	No	No	No	Yes		
22	26	Grave	Yes	Yes	Yes	Yes	No	No	No	No	No	No	No	No	No	No	Yes		
22	27	Grave	Yes	Yes	Yes	No	No	No	No	No	No	No	No	No	No	No	Yes		
22	28	Grave	Yes	Yes	Yes	Yes	No	No	No	No	No	No	No	No	No	No	Yes		
23	29	Grave	Yes	No	Yes	Yes	No	No	No	No	No	No	No	No	No	No	Yes		

43 Queen Street, Hitchin

Archaeological Monitoring Report

Grave Number	Skeleton Number	Type	Root Activity	Wood	Coffin Nails	Coffin Handles	Metal Straps	Shroud Pins	Buttons	Cu alloy Coffin Studs	Dentures	Clothing Decoration	Metal Rings	Hair Combs	Plate	Lead Coffin	Adult	Inscription	Comments
24	30	Grave	No	No	Yes	No	No	No	No	No	No	No	No	No	No	No	Yes		
25	31	Brick Grave	n/a	n/a	n/a	n/a	n/a	n/a	n/a	n/a	n/a	n/a	n/a	n/a	No	No	Yes	Fragment of gravestone found in backfill read "to the memory of Elizabeth, Widow of William Beck Gent (Daughter of John Kimpton and Elizabeth His Wife) She Departed this life 11th June 1837 Mary Kimpton"	
26	33	Grave	Yes	Yes	Yes	Yes	No	No	No	No	No	No	No	No	No	No	Yes		
27	34	Grave	Yes	Yes	Yes	No	No	No	No	No	No	No	No	No	No	No	Yes		
28	32	Grave	No	No	Yes	No	No	No	No	No	No	No	No	No	No	No	Yes		
29	35	Grave	No	No	No	No	No	No	No	No	No	No	No	No	No	No	Yes		
30	36	Grave	No	No	No	No	No	No	No	No	No	No	No	No	No	No	Yes		
31	37	Grave	Yes	No	Yes	Yes	No	No	No	No	No	No	No	No	No	No	Yes		
32	296	Brick Grave	n/a	n/a	n/a	n/a	n/a	n/a	n/a	n/a	n/a	n/a	n/a	n/a	n/a	n/a	Yes		
33	38	Grave	Yes	Yes	Yes	No	No	No	No	No	No	No	No	No	No	No	Yes		
34	39	Grave	Yes	Yes	Yes	Yes	No	No	No	No	No	No	No	No	No	No	Yes		
35	40	Grave	Yes	Yes	Yes	No	No	No	No	No	No	No	No	No	No	No	Yes		
36	41	Grave	Yes	Yes	Yes	No	No	No	No	No	No	No	No	No	No	No	Yes		
37	33	Brick Grave	n/a	n/a	n/a	n/a	n/a	n/a	n/a	n/a	n/a	n/a	n/a	n/a	n/a	n/a	No		
38	297	Brick Grave	n/a	n/a	n/a	n/a	n/a	n/a	n/a	n/a	n/a	n/a	n/a	n/a	n/a	n/a	No		
39	42	Grave	No	No	Yes	No	No	No	No	No	No	No	No	No	No	No	No		Burial left in situ as under preserved tree area
40	43	Grave	Yes	No	No	No	No	No	No	No	No	No	No	No	No	No	Yes		
41	44	Grave	Yes	Yes	Yes	No	No	No	No	No	No	No	No	No	No	No	Yes		
42	45	Grave	Yes	Yes	Yes	No	No	No	No	No	No	No	No	No	No	No	Yes		
43	46	Grave	Yes	No	Yes	No	No	No	No	No	No	No	No	No	No	No	Yes		
44	47	Grave	Yes	Yes	Yes	Yes	No	No	No	No	No	No	No	No	No	No	Yes		
45	48	Grave	Yes	No	Yes	No	No	No	No	No	No	No	No	No	No	No	Yes		
46	49	Grave	Yes	Yes	Yes	No	No	No	No	No	No	No	No	No	No	No	Yes		
47	50	Grave	Yes	Yes	Yes	No	No	No	No	No	No	No	No	No	No	No	Yes		
48	51	Grave	Yes	Yes	Yes	No	No	Yes	No	Yes	No	No	No	No	No	No	Yes		
49	52	Grave	Yes	Yes	Yes	No	No	No	No	No	No	No	No	No	No	No	Yes		
50	53	Grave	Yes	Yes	Yes	No	No	No	No	No	No	No	No	No	No	No	Yes		
51	54	Grave	Yes	No	No	No	No	No	No	No	No	No	No	No	No	No	Yes		
52	55	Grave	No	No	No	No	No	No	No	No	No	No	No	No	No	No	Yes		
53	56	Brick Grave	n/a	n/a	n/a	n/a	n/a	n/a	n/a	n/a	n/a	n/a	n/a	n/a	n/a	n/a	Yes		
54	302	Brick Grave	n/a	n/a	n/a	n/a	n/a	n/a	n/a	n/a	n/a	n/a	n/a	n/a	n/a	n/a	Yes		
55	57	Grave	Yes	Yes	Yes	No	No	No	No	No	No	No	No	No	No	No	Yes		
56	58	Grave	Yes	No	Yes	No	No	No	No	No	No	No	No	No	No	No	Yes		
57	59	Grave	Yes	No	Yes	No	No	No	No	No	No	No	No	No	No	No	Yes		
58	303	Brick Grave	n/a	n/a	n/a	n/a	n/a	n/a	n/a	n/a	n/a	n/a	n/a	n/a	n/a	n/a	Yes		
59	60	Grave	Yes	No	Yes	No	No	No	No	No	No	No	No	No	No	No	Yes		
60	304	Brick Grave	n/a	n/a	n/a	n/a	n/a	n/a	n/a	n/a	n/a	n/a	n/a	n/a	n/a	n/a	Yes		
61	305	Brick Grave	n/a	n/a	n/a	n/a	n/a	n/a	n/a	n/a	n/a	n/a	n/a	n/a	n/a	n/a	Yes		
62	306	Brick Grave	n/a	n/a	n/a	n/a	n/a	n/a	n/a	n/a	n/a	n/a	n/a	n/a	n/a	n/a	Yes		
63	307	Brick Grave	n/a	n/a	n/a	n/a	n/a	n/a	n/a	n/a	n/a	n/a	n/a	n/a	n/a	n/a	Yes		
64	308	Brick Grave	n/a	n/a	n/a	n/a	n/a	n/a	n/a	n/a	n/a	n/a	n/a	n/a	n/a	n/a	Yes		
65	309	Brick Grave	n/a	n/a	n/a	n/a	n/a	n/a	n/a	n/a	n/a	n/a	n/a	n/a	n/a	n/a	Yes		
66	61	Grave	Yes	No	Yes	No	No	No	No	No	No	No	No	No	No	No	Yes		
67	62	Grave	No	No	Yes	No	Yes	No	No	Yes	No	No	No	No	No	No	Yes		
68	63	Grave	Yes	No	Yes	No	No	No	No	No	No	No	No	No	No	No	Yes		

Grave Number	Skeleton Number	Type	Root Activity	Wood	Coffin Nails	Coffin Handles	Metal Straps	Shroud Pins	Buttons	Cu alloy Coffin Studs	Dentures	Clothing Decoration	Metal Rings	Hair Combs	Plate	Lead Coffin	Adult	Inscription	Comments
67	64	Grave	Yes	No	Yes	Yes	No	No	No	No	No	No	No	No	No	No	Yes		
68	65	Grave	Yes	No	Yes	Yes	No	No	No	No	No	No	No	No	No	No	Yes		
69	66	Grave	Yes	Yes	Yes	Yes	No	No	No	No	No	No	No	No	No	No	Yes		
70	67	Grave	Yes	No	Yes	Yes	No	No	No	No	No	No	No	No	No	No	Yes		
70	70	Grave	Yes	No	Yes	Yes	No	No	No	No	No	No	No	No	No	No	Yes		
71	68	Grave	Yes	No	Yes	No	No	No	No	No	No	No	No	No	No	No	Yes		Right tibia & fibula showed a compressed fracture, bone was fully mended
72	310	Brick Grave	n/a	n/a	n/a	n/a	n/a	n/a	n/a	n/a	n/a	n/a	n/a	n/a	No	No	Yes		
73	311	Brick Grave	n/a	n/a	n/a	n/a	n/a	n/a	n/a	n/a	n/a	n/a	n/a	n/a	No	No	Yes		
73	312	Brick Grave	n/a	n/a	n/a	n/a	n/a	n/a	n/a	n/a	n/a	n/a	n/a	n/a	No	No	Yes		
74	71	Grave	Yes	No	Yes	No	No	No	No	No	No	No	Yes	No	No	No	Yes		
75	72	Grave	Yes	Yes	Yes	No	No	No	No	No	No	No	No	No	No	No	Yes		
76	n/a	Mass grave	No	Yes	No	Yes	No	No	No	No	Yes	No	No	No	Yes	No	Yes	A total of 45 skulls, as well as other bone fragments, were removed, suggesting at least this number of individuals. A Cu alloy plate was also found within the mass grave it read "Mrs Sussana Langford Died Jan 14 1864 Aged 85". The plaque marking the hallowed spot were reinterred in a common grave in the year 1970 the relics of those of a past age whose tombs were situated in the area now used as a car park formerly the burial ground of the back street independant meeting house 1690-1855"	The dentures where found within a small ceramic box.
77	73	Grave	Yes	No	No	Yes	No	No	No	No	No	No	No	No	Yes	No	Yes	Fe plate writing illegible. Elaborate Handle plates	
78	74	Grave	Yes	No	Yes	Yes	No	No	No	No	No	No	No	No	No	No	Yes		
79	75	Grave	Yes	No	Yes	Yes	No	No	No	No	No	No	No	No	No	No	Yes		
80	76	Grave	Yes	Yes	Yes	Yes	No	Yes	No	No	No	No	No	No	No	No	Yes		Sternum was curved
81	77	Grave	Yes	Yes	Yes	No	No	No	No	No	No	No	No	No	Yes	No	No	Cu alloy plate; " Lydia Day Died 21st February 1833 aged 17 years"	
82	78	Grave	Yes	No	No	No	No	No	No	No	No	No	No	No	Yes	No	Yes	Fe plate writing illegible.	
83	79	Grave	No	No	No	No	No	No	No	No	No	No	No	No	No	No	No		
84	80	Grave	No	No	No	Yes	No	No	No	No	No	No	No	No	No	No	Yes	Elaborate handle plates depicting cherubs & wings	
85	81	Grave	Yes	Yes	No	Yes	No	No	No	No	No	No	No	No	Yes	No	No	Cu alloy plate: " John Smith Died 20th March 1833 Aged 20 Years"	
86	313	Brick Grave	n/a	n/a	n/a	n/a	n/a	n/a	n/a	n/a	n/a	n/a	n/a	n/a	No	No	Yes		
87	314	Brick Grave	n/a	n/a	n/a	n/a	n/a	n/a	n/a	n/a	n/a	n/a	n/a	n/a	No	No	Yes		The grave also contained two smaller brick graves at either end of the grave orientated N-S. These contained infant burials.

Grave Number	Skeleton Number	Type	Root Activity	Wood	Coffin Nails	Coffin Handles	Metal Straps	Shroud Pins	Buttons	Cu alloy Coffin Studs	Dentures	Clothing Decoration	Metal Rings	Hair Combs	Plate	Lead Coffin	Adult	Inscription	Comments
87	315	Brick Grave	n/a	n/a	n/a	n/a	n/a	n/a	n/a	n/a	n/a	n/a	n/a	n/a	No	No	No		Infant burial orientated N-S
87	316	Brick Grave	n/a	n/a	n/a	n/a	n/a	n/a	n/a	n/a	n/a	n/a	n/a	n/a	No	No	No		Infant burial orientated N-S
88	82	Grave	Yes	Yes	Yes	Yes	No	No	No	No	No	No	No	No	No	No	Yes		Lower spine fused at front
88	84	Grave	Yes	Yes	Yes	Yes	No	No	No	No	No	No	No	No	No	No	Yes		
89	83	Grave	No	Yes	Yes	Yes	No	No	No	No	No	No	No	No	Yes	No	Yes	Fe plate writing illegible.	
89	85	Grave	No	Yes	Yes	Yes	No	No	No	No	No	No	No	No	Yes	No	Yes	Cu alloy plate; "Tho ^s Housdon Died Nov 29th 1833 Aged 44 Years"	
90	317	Brick grave	n/a	n/a	n/a	n/a	n/a	n/a	n/a	n/a	n/a	n/a	n/a	n/a	No	No	Yes		
91	318	Brick grave	n/a	n/a	n/a	n/a	n/a	n/a	n/a	n/a	n/a	n/a	n/a	n/a	No	No	Yes		
92	319	Brick grave	n/a	n/a	n/a	n/a	n/a	n/a	n/a	n/a	n/a	n/a	n/a	n/a	No	No	Yes		
94	128	Brick Grave	n/a	n/a	n/a	n/a	n/a	n/a	n/a	n/a	n/a	n/a	n/a	n/a	No	No	Yes		
94	128	Brick Grave	No	No	No	No	No	No	No	No	No	No	No	No	No	No	Yes		
95	n/a	Brick grave	n/a	n/a	n/a	n/a	n/a	n/a	n/a	n/a	n/a	n/a	n/a	n/a	No	No	Yes		
96	127	Brick Grave	n/a	n/a	n/a	n/a	n/a	n/a	n/a	n/a	n/a	n/a	n/a	n/a	No	No	Yes		
96	127	Brick Grave	No	No	No	Yes	No	No	No	No	No	No	No	No	No	No	Yes		
97	86	Grave	No	No	No	No	No	No	No	No	No	No	No	No	No	No	Yes		
97	87	Grave	No	No	No	No	No	No	No	No	No	No	No	No	No	No	Yes		
98	88	Grave	No	No	Yes	No	No	No	No	No	No	No	No	No	No	No	Yes		
99	89	Grave	No	No	No	No	No	No	No	No	No	No	No	No	No	No	Yes		
100	320	Brick Grave	n/a	n/a	n/a	n/a	n/a	n/a	n/a	n/a	n/a	n/a	n/a	n/a	No	No	Yes		
101	90	Grave	No	No	Yes	No	No	No	No	No	No	No	No	No	No	No	Yes		
102	321	Brick Grave	n/a	n/a	n/a	n/a	n/a	n/a	n/a	n/a	n/a	n/a	n/a	n/a	No	No	Yes		
103	91	Grave	No	No	Yes	No	No	No	No	No	No	No	No	No	No	No	Yes		
104	322	Brick Grave	n/a	n/a	n/a	n/a	n/a	n/a	n/a	n/a	n/a	n/a	n/a	n/a	No	No	Yes		
105	92	Grave	Yes	Yes	Yes	Yes	No	No	No	No	Yes	No	No	No	Yes	No	Yes	Cu alloy plate; " Mary Thorpe Died Dec 25th 1851 Aged 43 years"	Dentures were spring loaded, some hair survives
106	93	Grave	Yes	Yes	No	Yes	No	No	No	No	No	No	No	No	No	No	Yes		
106	94	Grave	Yes	Yes	No	Yes	No	No	No	No	No	No	No	No	No	No	Yes		
107	95	Grave	Yes	No	Yes	No	No	No	No	No	No	No	No	No	No	No	Yes		
108	96	Grave	Yes	No	Yes	No	No	No	No	No	No	No	No	No	No	No	Yes		
109	97	Grave	Yes	No	Yes	No	No	No	No	No	No	No	No	No	No	No	Yes		
110	323	Brick Grave	n/a	n/a	n/a	n/a	n/a	n/a	n/a	n/a	n/a	n/a	n/a	n/a	No	No	Yes		
111	324	Brick Grave	n/a	n/a	n/a	n/a	n/a	n/a	n/a	n/a	n/a	n/a	n/a	n/a	No	No	Yes		
113	98	Grave	No	No	No	No	No	No	No	No	No	No	No	No	No	No	Yes		
114	99	Grave	Yes	Yes	Yes	No	No	No	No	No	No	No	No	No	Yes	No	Yes	Fe plate writing illegible.	
114	101	Grave	Yes	Yes	Yes	Yes	No	No	No	No	No	No	No	No	Yes	No	Yes	Fe plate writing illegible.	
115	100	Grave	Yes	No	Yes	No	No	No	No	No	No	No	No	No	No	No	Yes		
115	102	Grave	Yes	No	Yes	No	No	No	No	No	No	No	No	No	No	No	Yes		
115	103	Grave	Yes	No	Yes	No	No	No	No	No	No	No	No	No	No	No	Yes		
116	104	Grave	No	No	Yes	No	No	No	No	No	No	No	No	No	No	No	Yes		
117	105	Grave	No	No	Yes	No	No	Yes	No	No	No	No	No	No	No	No	No		
117	121	Grave	No	No	Yes	No	No	No	No	No	No	No	No	No	No	No	No		
118	123	Grave	Yes	No	Yes	No	No	No	No	No	No	No	No	No	No	No	No		
119	106	Grave	Yes	No	Yes	No	No	No	No	No	No	No	No	No	Yes	No	Yes	Fe plate writing illegible.	
120	107	Grave	No	No	Yes	No	No	No	No	No	No	No	No	No	No	No	Yes		
120	113	Grave	No	No	Yes	No	No	No	No	No	No	No	No	No	Yes	No	Yes	Fe plate writing illegible.	
122	325	Brick Grave	n/a	n/a	n/a	n/a	n/a	n/a	n/a	n/a	n/a	n/a	n/a	n/a	No	Yes	Yes		Two decorated metal crosses, possibly part of clothing
123	108	Grave	No	No	Yes	Yes	No	No	No	No	No	Yes	No	No	No	No	Yes		
124	109	Grave	No	No	Yes	No	No	No	No	No	No	No	No	No	No	No	Yes		

Grave Number	Skeleton Number	Type	Root Activity	Wood	Coffin Nails	Coffin Handles	Metal Straps	Shroud Pins	Buttons	Cu alloy Coffin Studs	Dentures	Clothing Decoration	Metal Rings	Hair Combs	Plate	Lead Coffin	Adult	Inscription	Comments
125	110	Grave	No	No	Yes	Yes	No	Yes	No	No	No	No	No	No	No	No	No		
126	111	Grave	No	No	Yes	No	No	No	No	No	No	No	No	No	No	No	Yes		
127	112	Grave	No	No	Yes	Yes	No	No	No	No	No	No	No	No	Yes	No	No	Cu alloy plate; "Josiah Turner Died Nov 4th 1843 Aged 4 years"	
128	114	Grave	No	No	Yes	Yes	No	No	No	No	No	No	No	No	No	No	Yes		
129	326	Brick Grave	n/a	n/a	n/a	n/a	n/a	n/a	n/a	n/a	n/a	n/a	n/a	n/a	No	No	Yes		
130	327	Brick Grave	n/a	n/a	n/a	n/a	n/a	n/a	n/a	n/a	n/a	n/a	n/a	n/a	Yes	Yes	Yes	"William Wilshere, Died Oct 15th 1853, Aged 68 Years"	
131	328	Brick Grave	n/a	n/a	n/a	n/a	n/a	n/a	n/a	n/a	n/a	n/a	n/a	n/a	Yes	Yes	Yes	"Arabella Wilshere 1816"	
132	115	Grave	No	No	Yes	Yes	No	No	No	No	No	No	No	No	No	No	No		
133	116	Grave	No	No	Yes	Yes	No	No	No	No	No	No	No	No	No	No	Yes		
134	329	Slab Grave	n/a	n/a	n/a	n/a	n/a	n/a	n/a	n/a	n/a	n/a	n/a	n/a	No	No	Yes		
135	330	Brick Grave	n/a	n/a	n/a	n/a	n/a	n/a	n/a	n/a	n/a	n/a	n/a	n/a	No	No	Yes		
136	331	Brick Grave	n/a	n/a	n/a	n/a	n/a	n/a	n/a	n/a	n/a	n/a	n/a	n/a	Yes	No	Yes	"James Cart, Died June 30th 1840, Aged 25 years" Pos Carter	
137	117	Grave	No	No	Yes	Yes	No	Yes	No	No	No	No	No	No	No	No	No		
138	118	Grave	No	No	Yes	Yes	No	No	Yes	No	No	No	No	No	No	No	No		
139	119	Grave	No	No	Yes	Yes	No	No	No	No	No	No	No	No	No	No	Yes		
140	120	Grave	No	No	Yes	Yes	No	No	No	No	No	No	No	No	No	No	Yes		Buried in short coffin as the individual was missing their lower legs
141	332	Brick Grave	n/a	n/a	n/a	n/a	n/a	n/a	n/a	n/a	n/a	n/a	n/a	n/a	No	No	Yes		
142	122	Grave	No	No	Yes	Yes	No	No	Yes	No	No	No	No	No	No	No	Yes		
143	124	Grave	No	No	Yes	No	No	No	No	No	No	No	No	No	No	No	Yes		
143	125	Grave	No	No	Yes	No	No	No	No	No	No	No	Yes	No	No	No	No		Cu alloy rings 1cm diameter
143	126	Grave	No	No	Yes	No	No	No	No	No	No	No	No	No	Yes	No	Yes		
144	333	Brick Grave	n/a	n/a	n/a	n/a	n/a	n/a	n/a	n/a	n/a	n/a	n/a	n/a	No	No	Yes	Fe plate writing illegible.	
145	334	Brick Grave	n/a	n/a	n/a	n/a	n/a	n/a	n/a	n/a	n/a	n/a	n/a	n/a	Yes	No	Yes	"William Rogers, Born Aug 6th 1809, Died June 16th 1849"	The top of the individuals skull had been removed possibly for some type of autopsy. The individual also had a large head injury that had partially healed
146	129	Grave	No	No	Yes	No	No	No	No	No	No	No	No	No	No	No	Yes		
146	130	Grave	No	No	Yes	No	No	No	No	No	No	No	No	No	No	No	Yes		
146	131	Grave	No	No	Yes	No	No	Yes	Yes	No	No	Yes	No	No	No	No	Yes		
147	132	Grave	No	No	Yes	Yes	No	No	No	No	No	No	No	Yes	Yes	No	No	Fe plate writing illegible	
147	143	Grave	No	No	Yes	Yes	No	No	No	No	No	No	No	No	No	No	Yes		
147	144	Grave	No	No	Yes	Yes	No	No	No	No	No	No	No	No	No	No	Yes		
148	142	Grave	No	No	Yes	Yes	No	No	No	No	No	No	No	No	No	No	Yes		
149	133	Grave	No	No	Yes	Yes	No	No	No	No	No	No	No	No	No	No	Yes		
149	134	Grave	No	No	Yes	Yes	No	No	No	No	No	No	No	No	Yes	No	Yes	Fe plate writing illegible	
150	135	Grave	No	No	Yes	No	No	Yes	No	No	No	No	No	No	No	No	No		
150	136	Grave	No	No	Yes	No	No	No	No	No	No	No	No	No	Yes	No	Yes	Fe plate writing illegible	
150	137	Grave	No	No	Yes	No	No	No	No	No	No	No	No	No	No	No	Yes		Disarticulated at feet of Skeleton [136]
151	138	Grave	No	No	No	No	No	No	No	No	No	No	No	No	No	No	Yes		
152	139	Grave	Yes	Yes	No	Yes	No	No	No	No	No	No	No	No	Yes	No	Yes	Cu alloy plate; "James Coleman Died May 13th 1848 Aged 53"	
153	140	Grave	No	No	No	No	No	No	No	No	No	No	No	No	No	No	Yes		
153	141	Grave	No	No	No	No	No	No	No	No	No	No	No	No	No	No	Yes		

Grave Number	Skeleton Number	Type	Root Activity	Wood	Coffin Nails	Coffin Handles	Metal Straps	Shroud Pins	Buttons	Cu alloy Coffin Studs	Dentures	Clothing Decoration	Metal Rings	Hair Combs	Plate	Lead Coffin	Adult	Inscription	Comments
155	145	Grave	No	No	Yes	Yes	No	No	No	No	No	No	No	No	Yes	No	Yes	Fe plate writing illegible	
156	146	Grave	No	No	Yes	Yes	No	No	No	No	No	No	No	No	No	No	Yes		The top of the individuals skull had been removed possibly for some type of autopsy. The individual also had a large head injury that had partially healed
157	147	Grave	No	Yes	Yes	Yes	No	No	No	No	No	No	No	No	Yes	No	Yes	Fe plate writing illegible	
158	148	Grave	No	Yes	Yes	No	No	No	No	No	No	No	No	No	No	No	Yes		
159	149	Grave	No	No	Yes	No	No	No	No	No	No	No	No	No	No	No	Yes		
160	150	Grave	No	No	Yes	Yes	No	No	No	No	No	No	No	No	No	No	No		
161	152	Grave	No	No	Yes	Yes	No	No	No	No	No	No	No	No	Yes	No	No	Fe plate writing illegible	Handles had a cherub design and the coffin had decorative metal strips
162	153	Grave	No	No	No	Yes	No	No	No	No	No	No	No	No	No	No	Yes		
163	154	Grave	No	No	Yes	Yes	No	No	No	No	No	No	No	No	Yes	No	Yes	Fe plate writing illegible	
164	155	Grave	No	No	Yes	Yes	No	No	No	No	No	No	No	No	No	No	Yes		
165	156	Grave	No	No	Yes	Yes	No	No	No	No	No	No	No	No	Yes	No	Yes	Fe plate writing illegible	
166	157	Grave	No	No	Yes	No	No	Yes	No	No	No	No	No	No	No	No	Yes		
167	158	Grave	No	No	Yes	Yes	No	No	No	No	No	No	No	No	No	No	No		Handles had a cherub design
168	159	Grave	No	No	Yes	Yes	No	No	No	No	No	No	No	No	No	No	Yes		
169	160	Grave	No	No	Yes	Yes	No	No	No	No	No	No	No	No	Yes	No	Yes	Fe plate writing illegible	
170	161	Grave	No	No	Yes	Yes	No	No	No	No	No	No	No	No	No	No	Yes		
171	162	Grave	No	No	Yes	Yes	No	Yes	No	No	No	No	No	No	Yes	No	Yes	Fe plate writing illegible	
172	163	Grave	No	No	Yes	Yes	No	No	No	No	No	No	No	No	No	No	Yes		
173	164	Grave	No	Yes	Yes	Yes	No	No	No	No	No	No	No	No	Yes	No	Yes	Cu alloy plate; " Mrs Sarah Joyner Died 1850 Aged 61 Years	
174	165	Grave	No	No	Yes	No	No	No	No	No	No	No	No	No	No	No	Yes		
175	166	Grave	No	No	Yes	No	No	No	No	No	No	No	No	No	Yes	No	No	Cu alloy plate; " William Rogers Died 11th Jan 1834 aged 3 years 9 months	
176	167	Grave	No	No	Yes	No	No	No	No	No	No	No	No	No	No	No	Yes		
177	168	Grave	No	No	Yes	Yes	No	No	No	No	No	No	No	No	No	No	Yes		
178	169	Grave	No	No	Yes	Yes	No	No	No	No	No	No	No	No	Yes	No	Yes	Fe plate writing illegible	
179	170	Grave	No	No	Yes	Yes	No	No	No	No	No	No	No	No	No	No	Yes		
180	171	Grave	No	No	Yes	Yes	No	No	No	No	No	No	No	No	No	No	Yes		
181	172	Grave	No	No	Yes	Yes	No	No	No	No	No	No	No	No	No	No	Yes		
182	173	Grave	No	No	Yes	No	No	No	No	No	No	No	No	No	No	No	Yes		
183	174	Grave	No	Yes	Yes	Yes	No	No	No	No	No	No	No	No	No	No	Yes		Complete Fe top to coffin
184	175	Grave	No	No	Yes	Yes	No	No	No	No	No	No	No	No	No	No	Yes		
185	176	Grave	No	No	Yes	No	No	No	No	No	No	No	No	No	No	No	Yes		
186	177	Grave	No	No	Yes	No	No	No	No	No	No	No	No	No	No	No	Yes		
187	178	Grave	No	No	Yes	Yes	No	No	No	No	No	No	No	No	No	No	Yes		The individual had a worn pelvic joint
188	179	Grave	No	No	Yes	Yes	No	No	No	No	No	No	No	No	No	No	Yes		
189	180	Grave	No	No	Yes	Yes	No	No	No	No	No	No	No	No	No	No	Yes		
190	181	Grave	No	No	Yes	No	No	Yes	No	No	No	No	No	No	No	No	No		
191	182	Grave	No	No	Yes	Yes	No	No	No	No	No	No	No	No	No	No	No		
192	183	Grave	No	No	Yes	Yes	No	Yes	No	No	No	No	No	No	No	No	Yes		
193	184	Grave	No	No	Yes	Yes	No	No	No	No	No	No	No	No	No	No	Yes		
194	185	Grave	Yes	No	Yes	No	No	No	No	No	No	No	No	No	No	No	Yes		

Grave Number	Skeleton Number	Type	Root Activity	Wood	Coffin Nails	Coffin Handles	Metal Straps	Shroud Pins	Buttons	Cu alloy Coffin Studs	Dentures	Clothing Decoration	Metal Rings	Hair Combs	Plate	Lead Coffin	Adult	Inscription	Comments
190	185	Grave	No	No	Yes	Yes	No	No	No	No	No	No	No	No	No	No	Yes		
191	186	Grave	No	No	Yes	No	No	No	No	No	No	No	No	No	No	No	Yes		
192	188	Grave	No	No	Yes	No	No	No	No	No	No	No	No	No	No	No	Yes		
193	190	Grave	No	No	Yes	No	No	Yes	No	No	No	No	No	No	No	No	Yes		
194	189	Grave	No	No	No	No	No	No	No	No	No	No	No	No	No	No	Yes		
195	191	Grave	No	No	Yes	Yes	No	No	No	No	No	No	No	No	No	No	Yes		
196	187	Grave	No	No	Yes	Yes	No	No	No	No	No	No	No	No	No	No	Yes		
197	192	Grave	No	No	Yes	No	No	No	No	No	No	No	No	No	No	No	Yes		
197	193	Grave	No	No	Yes	No	No	No	No	No	No	No	No	No	No	No	Yes		
198	194	Grave	No	No	Yes	No	No	Yes	No	No	No	No	No	No	No	No	Yes		
199	195	Grave	No	No	Yes	Yes	No	No	No	No	No	No	No	No	Yes	No	No	Fe plate writing illegible	
200	199	Grave	No	No	No	No	No	No	No	No	No	No	No	No	No	No	Yes		Individual recovered from geotechnical survey pit, there is no longer any sign of the original grave
201	196	Grave	No	No	Yes	Yes	No	No	No	No	No	No	No	No	No	No	Yes		
202	197	Grave	Yes	No	Yes	Yes	No	No	No	No	No	No	No	No	No	No	Yes		
203	198	Grave	Yes	No	Yes	No	No	Yes	No	No	No	No	No	No	Yes	No	No	Fe plate writing illegible	
204	200	Grave	No	No	No	No	No	No	No	No	No	No	No	No	No	No	No		
205	201	Grave	No	No	Yes	Yes	No	No	No	Yes	No	No	No	No	No	No	Yes		
206	202	Grave	No	No	No	No	No	No	No	No	No	No	No	No	No	No	Yes		
207	203	Brick Grave	n/a	n/a	n/a	n/a	n/a	n/a	n/a	n/a	n/a	n/a	n/a	n/a	No	No	Yes	Cu alloy plate; "Ann. Arnould Died Feb 19th 1828 Aged 49 years"	
207	203	Brick Grave	No	Yes	Yes	Yes	No	No	No	No	No	No	No	No	Yes	No	Yes		
208	204	Grave	No	No	Yes	No	No	No	No	No	No	No	No	No	No	No	No		
209	205	Grave	No	No	Yes	Yes	No	No	No	No	No	No	No	No	No	No	No		
209	206	Grave	No	No	Yes	Yes	No	No	No	No	No	No	No	No	No	No	Yes		
210	207	Grave	Yes	No	Yes	Yes	No	No	No	No	No	No	No	No	No	No	Yes		
210	208	Grave	Yes	No	Yes	Yes	No	No	No	No	No	No	No	No	No	No	No		
211	209	Grave	Yes	Yes	Yes	Yes	No	No	No	No	No	No	No	No	No	No	Yes		
211	210	Grave	Yes	Yes	Yes	Yes	No	No	No	No	No	No	No	No	No	No	Yes	Fe plate writing illegible	grave contained a larger amount of Hair, possibly a wig
212	211	Grave	Yes	Yes	Yes	No	No	No	No	No	No	No	No	No	No	No	Yes		
213	212	Grave	Yes	Yes	Yes	Yes	No	No	Yes	No	No	No	No	No	Yes	No	Yes	Fe plate writing illegible	
214	213	Grave	No	No	Yes	Yes	No	No	No	No	No	No	No	No	No	No	Yes		The individual had extra bone growth on their right ulna
215	215	Brick Grave	n/a	n/a	n/a	n/a	n/a	n/a	n/a	n/a	n/a	n/a	n/a	n/a	No	No	Yes		
215	222	Brick Grave	n/a	n/a	n/a	n/a	n/a	n/a	n/a	n/a	n/a	n/a	n/a	n/a	No	No	Yes		
215	222	Brick Grave	No	No	Yes	Yes	No	No	No	No	No	No	No	No	No	No	Yes		
216	214	Grave	Yes	No	No	No	No	No	No	No	No	No	No	No	No	No	Yes		Burial left in situ as under preserved tree area
217	216	Grave	No	No	Yes	Yes	No	No	No	No	No	No	No	No	No	No	Yes		
218	217	Grave	No	No	Yes	Yes	No	No	No	No	No	No	No	No	No	No	Yes		
218	218	Grave	No	No	Yes	Yes	No	No	No	No	No	No	No	No	No	No	Yes		
219	219	Grave	No	No	Yes	Yes	No	No	No	No	No	No	No	No	Yes	No	No	Cu alloy plate writing illegible	
220	220	Grave	No	No	No	No	No	No	No	No	No	No	No	No	No	No	Yes		
221	221	Grave	No	No	Yes	Yes	No	No	No	No	No	No	No	No	No	No	Yes		
222	223	Grave	No	No	Yes	No	No	No	No	No	No	No	No	No	No	No	Yes		
223	224	Grave	No	No	Yes	Yes	No	No	No	No	No	No	No	No	No	No	Yes		
224	225	Grave	No	No	Yes	Yes	No	No	No	No	No	No	No	No	No	No	Yes		
225	226	Grave	No	No	Yes	Yes	No	No	No	No	No	No	No	No	No	No	Yes		

Grave Number	Skeleton Number	Type	Root Activity	Wood	Coffin Nails	Coffin Handles	Metal Straps	Shroud Pins	Buttons	Cu alloy Coffin Studs	Dentures	Clothing Decoration	Metal Rings	Hair Combs	Plate	Lead Coffin	Adult	Inscription	Comments
226	227	Grave	No	No	Yes	No	No	No	No	No	No	No	No	No	No	No	Yes		
227	263	Brick Grave	n/a	n/a	n/a	n/a	n/a	n/a	n/a	n/a	n/a	n/a	n/a	n/a	No	No	Yes		
227	263	Brick Grave	No	Yes	Yes	No	No	No	No	No	No	No	No	No	Yes	No	Yes	Fe plate writing illegible	
227	264	Brick Grave	n/a	n/a	n/a	n/a	n/a	n/a	n/a	n/a	n/a	n/a	n/a	n/a	No	No	Yes		
227	264	Brick Grave	No	Yes	Yes	Yes	No	No	No	No	No	No	No	No	Yes	No	Yes	Fe plate writing illegible, Handles had a cherub design	
228	228	Grave	No	No	Yes	Yes	No	No	No	No	No	No	No	No	No	No	Yes		
228	229	Grave	No	No	Yes	Yes	No	No	No	No	No	No	No	No	No	No	Yes		
229	230	Grave	No	No	Yes	No	No	No	No	No	No	No	No	No	No	No	Yes		
230	231	Grave	No	No	Yes	Yes	No	No	No	No	No	No	No	No	No	No	No		
230	232	Grave	No	No	Yes	Yes	No	No	No	No	No	No	No	No	No	No	Yes		
231	236	Grave	No	No	Yes	Yes	No	No	No	No	No	No	No	No	No	No	Yes		
232	237	Grave	No	No	Yes	Yes	No	No	No	No	No	No	No	No	No	No	Yes		
233	238	Grave	No	No	Yes	Yes	No	No	No	No	No	No	No	No	Yes	No	Yes	Fe plate writing illegible	
234	234	Grave	No	No	No	No	No	No	No	No	No	No	No	No	No	No	Yes		
235	235	Grave	No	No	Yes	No	No	No	No	No	No	No	No	No	No	No	Yes		
236	233	Grave	No	No	Yes	No	No	No	No	No	No	No	No	No	No	No	Yes		
237	239	Grave	No	No	Yes	Yes	No	No	No	No	No	No	No	No	No	No	Yes		
238	240	Grave Pit	No	No	No	No	No	No	No	No	No	No	No	No	No	No	Yes		Disarticulated remains
239	241	Grave	No	No	Yes	Yes	No	No	No	No	No	No	No	No	No	No	Yes		
239	242	Grave	No	No	Yes	Yes	No	No	No	No	No	No	No	No	No	No	Yes		
240	243	Grave	No	No	Yes	No	No	No	No	No	No	No	No	No	No	No	Yes		
241	244	Grave	No	No	Yes	No	No	No	No	No	No	No	No	No	No	No	Yes		
242	245	Grave	No	No	Yes	No	No	No	No	No	No	No	No	No	No	No	Yes		
243	246	Grave	No	No	Yes	No	No	No	No	No	No	No	No	No	No	No	Yes		
244	247	Grave	No	No	No	No	No	No	No	No	No	No	No	No	No	No	Yes		
245	251	Grave	No	No	Yes	No	No	No	No	No	No	No	No	No	No	No	Yes		
246	248	Grave	No	No	Yes	Yes	No	No	No	No	No	No	No	No	Yes	No	Yes	Fe plate writing illegible	
247	249	Grave	No	No	Yes	Yes	No	No	No	No	No	No	No	No	Yes	No	Yes	Fe plate writing illegible	
248	250	Grave	No	No	No	No	No	No	No	No	No	No	No	No	No	No	Yes		
249	252	Grave	No	No	Yes	Yes	No	Yes	No	No	No	No	No	No	Yes	No	Yes	Fe plate writing illegible	
250	253	Grave	No	No	Yes	Yes	No	No	Yes	No	No	No	No	No	No	No	Yes		
251	254	Grave	No	No	Yes	No	No	Yes	No	No	No	No	No	No	No	No	Yes		
252	255	Grave	No	No	No	No	No	No	No	No	No	No	No	No	No	No	Yes		
253	256	Grave	No	No	Yes	Yes	No	No	No	No	No	No	No	No	No	No	Yes		
253	257	Grave	No	No	Yes	Yes	No	No	No	No	No	No	No	No	No	No	Yes		
254	258	Grave	No	No	Yes	Yes	No	No	No	No	No	No	No	No	No	No	Yes		
255	259	Grave	No	No	Yes	Yes	No	No	No	No	No	No	No	No	No	No	Yes		
256	260	Grave	No	No	No	No	No	No	No	No	No	No	No	No	No	No	Yes		
257	261	Grave	No	No	No	No	No	No	No	No	No	No	No	No	No	No	Yes		
258	262	Grave	No	No	Yes	Yes	No	Yes	No	No	No	No	No	No	No	No	Yes		
259	265	Grave	No	No	Yes	Yes	No	Yes	No	No	No	No	No	No	No	No	Yes		
260	266	Grave	No	No	Yes	No	No	No	No	No	No	No	No	No	No	No	Yes		
261	267	Grave	No	No	Yes	No	No	No	No	No	No	No	No	No	No	No	Yes		
262	268	Grave	No	No	Yes	Yes	No	No	No	No	No	No	No	No	No	No	Yes		
262	269	Grave	No	No	Yes	Yes	No	No	No	No	No	No	No	No	No	No	Yes		
263	270	Grave	Yes	No	Yes	No	No	No	No	Yes	No	No	No	No	No	No	Yes		
263	274	Grave	Yes	No	Yes	No	No	No	No	Yes	No	No	No	No	No	No	Yes		
264	271	Grave	Yes	No	Yes	No	No	No	No	Yes	No	No	No	No	No	No	Yes		
264	272	Grave	No	No	No	Yes	No	No	No	No	No	No	No	No	No	No	Yes		
265	n/a	Mass Grave	n/a	n/a	n/a	n/a	n/a	n/a	n/a	n/a	n/a	n/a	n/a	n/a	Yes	Yes	Plates on lead coffins read "Elizabeth H...ey, Born 1783, Died 1803" & "Mr John Wlshire, Died 21st Oct 1836, in his 81st year"		
266	273	Grave	Yes	No	Yes	No	No	No	No	No	No	No	No	No	No	No	Yes		
267	275	Grave	Yes	No	Yes	No	No	No	No	No	No	No	No	No	No	No	Yes		

Grave Number	Skeleton Number	Type	Root Activity	Wood	Coffin Nails	Coffin Handles	Metal Straps	Shroud Pins	Buttons	Cu alloy Coffin Studs	Dentures	Clothing Decoration	Metal Rings	Hair Combs	Plate	Lead Coffin	Adult	Inscription	Comments
268	276	Grave	Yes	Yes	Yes	No	No	No	No	No	No	No	No	No	Yes	No	Yes	Fe plate writing illegible	
268	277	Grave	Yes	Yes	Yes	No	No	No	No	No	No	No	No	No	Yes	No	Yes		Grave contained a large amount of Hair
269	278	Grave	Yes	No	Yes	No	No	No	No	No	No	No	No	No	No	No	Yes		
270	279	Grave	Yes	Yes	Yes	No	No	No	No	Yes	No	No	No	No	No	No	Yes		
271	280	Grave	Yes	Yes	Yes	Yes	No	No	No	No	No	No	No	No	No	No	Yes		
271	281	Grave	Yes	Yes	Yes	Yes	No	No	No	No	No	No	No	No	No	No	Yes		
271	282	Grave	Yes	Yes	Yes	Yes	No	No	No	No	No	No	No	No	No	No	Yes		
271	283	Grave	Yes	Yes	Yes	Yes	No	No	No	No	No	No	No	No	No	No	Yes		
271	284	Grave	Yes	Yes	Yes	Yes	No	No	No	No	No	No	No	No	No	No	Yes		
272	285	Grave	Yes	Yes	Yes	No	No	No	No	No	No	No	No	No	No	No	Yes		
272	286	Grave	Yes	Yes	Yes	No	No	No	No	No	No	No	No	No	Yes	No	Yes	Fe plate read "...48 years...187?"	
273	287	Grave	No	Yes	Yes	No	No	No	No	Yes	No	No	No	No	No	No	Yes		
273	288	Grave	No	Yes	Yes	No	No	No	No	Yes	No	No	No	No	No	No	Yes		Handles had a cherub design
274	289	Grave	Yes	Yes	Yes	No	No	No	No	No	No	No	No	No	No	No	Yes		
274	290	Grave	Yes	Yes	Yes	No	No	No	No	No	No	No	No	No	No	No	Yes		
274	291	Grave	Yes	Yes	Yes	No	No	No	No	No	No	No	No	No	No	No	Yes		
274	293	Grave	Yes	Yes	Yes	Yes	No	No	No	No	No	No	No	No	No	No	Yes		
275	292	Grave	Yes	Yes	Yes	Yes	No	No	No	No	No	No	No	No	Yes	No	Yes	Fe plate writing illegible	
276	294	Grave	Yes	No	Yes	No	No	No	No	No	No	No	No	No	Yes	No	Yes	Fe plate writing illegible	

Appendix 3: Photographic Register

Reference	Type	Description	Direction
HN498 - 001	Brick Grave	BGS in Brick Grave 102	E
HN498 - 002	Brick Grave	Brick Grave	E
HN498 - 003	Brick Grave	Bottom Grave of Brick Grave 52	N
HN498 - 004	Brick Grave	Bottom Grave of Brick Grave 52	N
HN498 - 005	Brick Grave	Breaking into Brick Grave 25	/
HN498 - 006	Brick Grave	Breaking into Brick Grave 136	/
HN498 - 007	Brick Grave	Breaking into Brick Grave 100	/
HN498 - 008	Brick Grave	Brick Grave 09	E
HN498 - 009	Brick Grave	Brick Grave 111	E
HN498 - 010	Brick Grave	Brick Grave 122	E
HN498 - 011	Brick Grave	Brick Grave 122	E
HN498 - 012	Brick Grave	Brick Grave 131	E
HN498 - 013	Brick Grave	Brick Grave 135	E
HN498 - 014	Brick Grave	Brick Grave 136	E
HN498 - 015	Brick Grave	Brick Grave 136	/
HN498 - 016	Brick Grave	Brick Grave 136	/
HN498 - 017	Brick Grave	Brick Grave 136	/
HN498 - 018	Brick Grave	Brick Grave 141	W
HN498 - 019	Brick Grave	Brick Grave 141	W
HN498 - 020	Brick Grave	Brick Grave 141	W
HN498 - 021	Brick Grave	Brick Grave 145	E
HN498 - 022	Brick Grave	Brick Grave 207	W
HN498 - 023	Brick Grave	Brick Grave 207	E
HN498 - 024	Brick Grave	Brick Grave 207	W
HN498 - 025	Brick Grave	Brick Grave 215	S
HN498 - 026	Brick Grave	Brick Grave 227	SW
HN498 - 027	Brick Grave	Brick Grave 227	S
HN498 - 028	Brick Grave	Brick Grave 227	SW
HN498 - 029	Brick Grave	Brick Grave 227	E
HN498 - 030	Brick Grave	Brick Grave 227	S
HN498 - 031	Brick Grave	Brick Grave 227	S
HN498 - 032	Brick Grave	Brick Grave 227	W
HN498 - 033	Brick Grave	Brick Grave 227	E
HN498 - 034	Brick Grave	Brick Grave 227	SW
HN498 - 035	Brick Grave	Brick Grave 227	SW
HN498 - 036	Brick Grave	Brick Grave 227	S
HN498 - 037	Brick Grave	Brick Grave 227 -Detail	/
HN498 - 038	Brick Grave	Brick Grave 227	SW
HN498 - 039	Brick Grave	Brick Grave 227	S
HN498 - 040	Brick Grave	Brick Grave 25	W
HN498 - 041	Brick Grave	Brick Grave 30	E
HN498 - 042	Brick Grave	Brick Grave 52 - Detail	/
HN498 - 043	Brick Grave	Brick Grave 57 - Detail	/
HN498 - 044	Brick Grave	Brick Grave 57	E
HN498 - 045	Brick Grave	Brick Grave 57	E
HN498 - 046	Brick Grave	Brick Grave 57	E
HN498 - 047	Brick Grave	Brick Grave 57	E
HN498 - 048	Brick Grave	Brick Grave 57	/
HN498 - 049	Brick Grave	Brick Grave 59	E
HN498 - 050	Brick Grave	Brick Grave 60	E
HN498 - 051	Brick Grave	Brick Grave 60	W
HN498 - 052	Brick Grave	Brick Grave 60	W
HN498 - 053	Brick Grave	Brick Grave 61- Inscription WW 1830	E
HN498 - 054	Brick Grave	Brick Grave 61- Inscription WW 1830	E
HN498 - 055	Brick Grave	Brick Grave 61- Inscription WW 1830	E
HN498 - 056	Brick Grave	Brick Grave 61	E
HN498 - 057	Brick Grave	Brick Grave 61- Inscription WW 1830	E
HN498 - 058	Brick Grave	Brick Grave 61- Inscription WW 1830	E
HN498 - 059	Brick Grave	Brick Grave 62	N
HN498 - 060	Brick Grave	Brick Grave 62	N

Reference	Type	Description	Direction
HN498 - 061	Brick Grave	Brick Grave 62	N
HN498 - 062	Brick Grave	Brick Grave 63	W
HN498 - 063	Brick Grave	Brick Grave 73	E
HN498 - 064	Brick Grave	Brick Grave 86	W
HN498 - 065	Brick Grave	Brick Grave 87, Showing addition for infant burial	NW
HN498 - 066	Brick Grave	Brick Grave 87, Showing addition for infant burial	N
HN498 - 067	Brick Grave	Brick Grave 87	W
HN498 - 068	Brick Grave	Brick Grave 87, Showing addition for infant burial	W
HN498 - 069	Brick Grave	Brick Grave 90	E
HN498 - 070	Brick Grave	Brick Grave 90	E
HN498 - 071	Brick Grave	Plate from Brick Grave 145	/
HN498 - 072	Brick Grave	Brick Grave Structure 41	NW
HN498 - 073	Brick Grave	Brick Grave Structure 41	NE
HN498 - 074	Brick Grave	Brick Grave 129, 130 & 131	E
HN498 - 075	Brick Grave	Brick Grave 129, 130 & 131	E
HN498 - 076	Brick Grave	Brick Grave 130 & 131	E
HN498 - 077	Brick Grave	Brick Grave 130 & 131	SW
HN498 - 078	Brick Grave	Brick Grave 52 & 62	N
HN498 - 079	Brick Grave	Brick Grave 59 & 60	W
HN498 - 080	Brick Grave	Brick Grave 61 & 91	E
HN498 - 081	Brick Grave	Brick Grave 72 & 63	S
HN498 - 082	Brick Grave	Brick Grave 72 & 63	S
HN498 - 083	Brick Grave	Brick Grave 86 & 87	SW
HN498 - 084	Brick Grave	Brick Grave 57	E
HN498 - 085	Brick Grave	Brick Grave 57	E
HN498 - 086	Brick Grave	Brick Grave 135	E
HN498 - 087	Brick Grave	Brick Grave 136	W
HN498 - 088	Brick Grave	Brick Grave 25	E
HN498 - 089	Brick Grave	Brick Grave 25	W
HN498 - 090	Brick Grave	Brick Grave 25	W
HN498 - 091	Brick Grave	Brick Grave 09	E
HN498 - 092	Brick Grave	Brick Grave 62 - Detail of Skeleton	/
HN498 - 093	Brick Grave	Brick Grave 215	S
HN498 - 094	Brick Grave	Brick Grave 73	NW
HN498 - 095	Brick Grave	Brick Grave 121	NE
HN498 - 096	Brick Grave	Brick Grave 215	W
HN498 - 097	Brick Grave	Brick Grave 215 - Detail	/
HN498 - 098	Brick Grave	Brick Grave 215	W
HN498 - 099	Brick Grave	Brick Grave 215	E
HN498 - 100	Brick Grave	Brick Grave 215	W
HN498 - 101	Brick Grave	Brick Grave 227	W
HN498 - 102	Brick Grave	Brick Grave 227	SW
HN498 - 103	Brick Grave	Brick Grave 227	SE
HN498 - 104	Brick Grave	Brick Grave 227	SE
HN498 - 105	Brick Grave	Brick Grave 227	S
HN498 - 106	Brick Grave	Brick Grave 227	S
HN498 - 107	Brick Grave	Brick Grave 73	S
HN498 - 108	Brick Grave	Brick Grave 50	N
HN498 - 109	Brick Grave	Brick Grave 61	E
HN498 - 110	Brick Grave	Brick Grave 136	/
HN498 - 111	Brick Grave	Brick Grave 135 - Inside	/
HN498 - 112	Brick Grave	Brick Grave 136 - Inside	/
HN498 - 113	Brick Grave	Brick Grave 110	E
HN498 - 114	Brick Grave	Brick Grave 09	E
HN498 - 115	Brick Grave	Brick Grave 111	S
HN498 - 116	Brick Grave	Brick Grave 62	N
HN498 - 117	Brick Grave	Brick Grave 136	/
HN498 - 118	Brick Grave	Brick Grave 61	E
HN498 - 119	Brick Grave	Brick Grave 227- Detail	/
HN498 - 120	Brick Grave	Brick Grave 227	E
HN498 - 121	Brick Grave	Brick Grave 227	W
HN498 - 122	Brick Grave	Brick Grave 227	SW
HN498 - 123	Brick Grave	Vault & Brick Grave 52 & 62	E

Reference	Type	Description	Direction
HN498 - 124	Brick Grave	Brick Grave 135	E
HN498 - 125	Brick Grave	Brick Grave 215	W
HN498 - 126	Brick Grave	Brick Grave 215 -Detail	/
HN498 - 127	Brick Grave	Brick Grave 215 -Detail	/
HN498 - 128	Brick Grave	Brick Grave 215	E
HN498 - 129	Brick Grave	Brick Grave 215	E
HN498 - 130	Brick Grave	Brick Grave 215	W
HN498 - 131	Brick Grave	Brick Grave 72 & 63	W
HN498 - 132	Brick Grave	Brick Grave 72	W
HN498 - 133	Chapel Remains	Chapel 154 mid section east wall close up	/
HN498 - 134	Chapel Remains	Chapel 154 mid section east wall close up	/
HN498 - 135	Chapel Remains	Chapel 154 mid section	N
HN498 - 136	Chapel Remains	Chapel 154 mid section	N
HN498 - 137	Chapel Remains	Chapel 154 mid section	SE
HN498 - 138	Chapel Remains	Chapel 154 mid section	SE
HN498 - 139	Chapel Remains	Chapel 154 mid section	SW
HN498 - 140	Chapel Remains	Chapel 154 mid section	SW
HN498 - 141	Chapel Remains	Chapel 154 mid section	S
HN498 - 142	Chapel Remains	Chapel 154 mid section	W
HN498 - 143	Chapel Remains	Chapel 154 mid section	W
HN498 - 144	Chapel Remains	Chapel 154 mid section North wall close up	E
HN498 - 145	Chapel Remains	Chapel Walls	NE
HN498 - 146	Chapel Remains	Chapel Walls	SE
HN498 - 147	Chapel Remains	Chapel Walls	N
HN498 - 148	Chapel Remains	Chapel Walls	N
HN498 - 149	Chapel Remains	Chapel Walls	N
HN498 - 150	Chapel Remains	Chapel Walls	E
HN498 - 151	Chapel Remains	Chapel Walls	E
HN498 - 152	Chapel Remains	Chapel Walls	E
HN498 - 153	Chapel Remains	Chapel Walls	E
HN498 - 154	Chapel Remains	Chapel Walls	NE
HN498 - 155	Chapel Remains	Chapel Walls	NE
HN498 - 156	Chapel Remains	Chapel Walls	E
HN498 - 157	Chapel Remains	Chapel Walls	N
HN498 - 158	Chapel Remains	Chapel Walls	W
HN498 - 159	Chapel Remains	Chapel Walls	E
HN498 - 160	Chapel Remains	Chapel Walls	N
HN498 - 161	Chapel Remains	Chapel Walls	N
HN498 - 162	Chapel Remains	Chapel Walls	NW
HN498 - 163	Chapel Remains	Chapel Walls	NE
HN498 - 164	Chapel Remains	Chapel Walls	NW
HN498 - 165	Chapel Remains	Chapel-Sodexho Interface	N
HN498 - 166	Chapel Remains	Chapel-Sodexho Interface	N
HN498 - 167	Chapel Remains	Chapel-Sodexho Interface	N
HN498 - 168	Chapel Remains	Chapel-Sodexho Interface	/
HN498 - 169	Chapel Remains	Thickness of Chapel Wall	/
HN498 - 170	Coffins & Skeletons	1970 Reinterment Plaque	/
HN498 - 171	Coffins & Skeletons	Craniotomy from Brick Grave 145	/
HN498 - 172	Coffins & Skeletons	Craniotomy from Brick Grave 145	/
HN498 - 173	Coffins & Skeletons	Close up of wooden coffin	/
HN498 - 174	Coffins & Skeletons	Close up of wooden coffin	/
HN498 - 175	Coffins & Skeletons	Close up of wooden coffin	/
HN498 - 176	Coffins & Skeletons	Close up of wooden coffin	/
HN498 - 177	Coffins & Skeletons	Coffin Plate from Brick Grave 136	/
HN498 - 178	Coffins & Skeletons	Dentures From Brick Grave 105	/
HN498 - 179	Coffins & Skeletons	Grave 179	W
HN498 - 180	Coffins & Skeletons	Grave 179	W
HN498 - 181	Coffins & Skeletons	Grave 179	W
HN498 - 182	Coffins & Skeletons	General View of Grave Cuts	SE
HN498 - 183	Coffins & Skeletons	Iron Coffin form Grave 119	W
HN498 - 184	Coffins & Skeletons	Iron Coffin form Grave 119	W
HN498 - 185	Coffins & Skeletons	Iron Coffin form Grave 119	W
HN498 - 186	Coffins & Skeletons	Iron Coffin form Grave 119	W

Reference	Type	Description	Direction
HN498 - 187	Coffins & Skeletons	Iron Coffin form Grave 119	W
HN498 - 188	Coffins & Skeletons	Iron Coffin form Grave 119	W
HN498 - 189	Coffins & Skeletons	Skull and Dentures from Grave 105	W
HN498 - 190	Coffins & Skeletons	Skull and Dentures from Grave 105	W
HN498 - 191	Coffins & Skeletons	Skull in baulk, Grave 225	W
HN498 - 192	Coffins & Skeletons	Skull in baulk, Grave 225	W
HN498 - 193	Coffins & Skeletons	Excavation of Grave 275	SW
HN498 - 194	Coffins & Skeletons	Excavation of Grave 275	SW
HN498 - 195	Coffins & Skeletons	Excavation of Grave 275	W
HN498 - 196	Coffins & Skeletons	Excavation of Grave 275	NW
HN498 - 197	Demolition	Demolition of Sodexho	NE
HN498 - 198	Demolition	Demolition of Sodexho	N
HN498 - 199	Demolition	Demolition of Sodexho	NW
HN498 - 200	Demolition	Demolition of Sodexho	N
HN498 - 201	General Views & Working Shots	BGS at Brick Grave 13	N
HN498 - 202	General Views & Working Shots	Working Shot	S
HN498 - 203	General Views & Working Shots	Working Shot	N
HN498 - 204	General Views & Working Shots	Excavation of Grave 179	W
HN498 - 205	General Views & Working Shots	Excavation of Grave 179	W
HN498 - 206	General Views & Working Shots	Excavation of Grave 179	W
HN498 - 207	General Views & Working Shots	Working Shot	N
HN498 - 208	General Views & Working Shots	Working Shot	N
HN498 - 209	General Views & Working Shots	BGS Working Shot	W
HN498 - 210	General Views & Working Shots	BGS Working Shot	E
HN498 - 211	General Views & Working Shots	BGS Working Shot	N
HN498 - 212	General Views & Working Shots	BGS Working Shot	/
HN498 - 213	General Views & Working Shots	BGS Working Shot	E
HN498 - 214	General Views & Working Shots	BGS Working Shot	N
HN498 - 215	General Views & Working Shots	Working Shot -In Snow	S
HN498 - 216	General Views & Working Shots	Working Shot -In Snow	S
HN498 - 217	General Views & Working Shots	Working Shot	N
HN498 - 218	General Views & Working Shots	Working Shot	N
HN498 - 219	General Views & Working Shots	Working Shot	N
HN498 - 220	General Views & Working Shots	Working Shot	E
HN498 - 221	General Views & Working Shots	Working Shot	N
HN498 - 222	General Views & Working Shots	Working Shot - Brick Grave Demolition	W
HN498 - 223	General Views & Working Shots	Working Shot	E
HN498 - 224	General Views & Working Shots	Working Shot	E
HN498 - 225	General Views & Working Shots	Working Shot	N
HN498 - 226	General Views & Working Shots	Working Shot	W
HN498 - 227	General Views & Working Shots	Working Shot	E
HN498 - 228	General Views & Working Shots	General View - Machining	E
HN498 - 229	General Views & Working Shots	General View	E
HN498 - 230	General Views & Working Shots	General View	E
HN498 - 231	General Views & Working Shots	Working Shot	S
HN498 - 232	General Views & Working Shots	BGS Working Shot	N
HN498 - 233	General Views & Working Shots	BGS Working Shot	E
HN498 - 234	General Views & Working Shots	General View	E
HN498 - 235	General Views & Working Shots	General View	E
HN498 - 236	General Views & Working Shots	General View	W
HN498 - 237	General Views & Working Shots	General View	E
HN498 - 238	General Views & Working Shots	General View	E
HN498 - 239	General Views & Working Shots	General View	E
HN498 - 240	General Views & Working Shots	General View - Machining	SW
HN498 - 241	General Views & Working Shots	General View - Machining	SW
HN498 - 242	General Views & Working Shots	General View - Machining	SW
HN498 - 243	General Views & Working Shots	General View - Machining	W
HN498 - 244	General Views & Working Shots	General View - Removing Tank	N
HN498 - 245	General Views & Working Shots	Working Shot	E
HN498 - 246	General Views & Working Shots	Working Shot	E
HN498 - 247	General Views & Working Shots	Working Shot	E
HN498 - 248	General Views & Working Shots	General View - Backfilling	E
HN498 - 249	General Views & Working Shots	General View - Backfilling	E

Reference	Type	Description	Direction
HN498 - 250	General Views & Working Shots	General View	NW
HN498 - 251	General Views & Working Shots	General Site Shot	SE
HN498 - 252	General Views & Working Shots	General Site Shot	E
HN498 - 253	General Views & Working Shots	General Site Shot	E
HN498 - 254	Lead Coffins	BGS Removing Reinterred Lead Coffin	S
HN498 - 255	Lead Coffins	Reinterred Lead Coffins Location	/
HN498 - 256	Lead Coffins	Lead Plate Inscription from Reinterred Coffin	/
HN498 - 257	Lead Coffins	Lead Plate Inscription from Reinterred Coffin	/
HN498 - 258	Lead Coffins	Cleared Lead in Brick Grave 59	E
HN498 - 259	Lead Coffins	BGS Clearing Lead From Brick Grave 110	S
HN498 - 260	Lead Coffins	Lead From Brick Grave 110	/
HN498 - 261	Lead Coffins	Lead From Brick Grave 131 - Close up	/
HN498 - 262	Lead Coffins	Lead From Brick Grave 131- in the container	/
HN498 - 263	Lead Coffins	Lead From Brick Grave 131- in the container	/
HN498 - 264	Lead Coffins	Lead From Brick Grave 131	E
HN498 - 265	Lead Coffins	Lead From Brick Grave 110	/
HN498 - 266	Lead Coffins	Lead From Brick Grave 110	E
HN498 - 267	Lead Coffins	Lead From Brick Grave 62	/
HN498 - 268	Lead Coffins	Lead in Brick Grave 130	S
HN498 - 269	Lead Coffins	Lead in Brick Grave 130	/
HN498 - 270	Lead Coffins	Lead in Brick Grave 130	/
HN498 - 271	Lead Coffins	Lead in Brick Grave 59	E
HN498 - 272	Lead Coffins	Lead in Brick Grave 60	E
HN498 - 273	Lead Coffins	BGS Removing Lead Coffin	/
HN498 - 274	Lead Coffins	Lead From Brick Grave 131	/
HN498 - 275	Lead Coffins	Lead in Brick Grave 62	E
HN498 - 276	Lead Coffins	Lead within the Container	/
HN498 - 277	Lead Coffins	Lead within the Container	/
HN498 - 278	Lead Coffins	Preparing to Lift a Lead Coffin	/
HN498 - 279	Lead Coffins	Lifting a Lead Coffin	NW
HN498 - 280	Lead Coffins	Preparing to Lift a Lead Coffin	/
HN498 - 281	Lead Coffins	BGS Removing a Lead	/
HN498 - 282	Lead Coffins	BGS Removing a Lead	/
HN498 - 283	Lead Coffins	Lead Coffin Within Brick Grave 130	/
HN498 - 284	Lead Coffins	Lead Coffin Within Brick Grave 130	/
HN498 - 285	Lead Coffins	Lead Coffin Within Brick Grave 130	/
HN498 - 286	Lead Coffins	Lead Coffin Within Brick Grave 130	/
HN498 - 287	Lead Coffins	Lead Coffin Within Brick Grave 130	/
HN498 - 288	Lead Coffins	Lead Coffin Within Brick Grave 130	/
HN498 - 289	Mass Grave	Mass Reinterment, Grave 76	S
HN498 - 290	Mass Grave	Mass Reinterment, Grave 76	E
HN498 - 291	Mass Grave	Mass Reinterment, Grave 76	E
HN498 - 292	Mass Grave	Mass Reinterment, Grave 76	E
HN498 - 293	Mass Grave	Mass Reinterment, Grave 76	E
HN498 - 294	Mass Grave	Mass Reinterment, Grave 76	S
HN498 - 295	Mass Grave	Mass Reinterment, Grave 76 - Machining	/
HN498 - 296	Mass Grave	Mass Reinterment, Grave 76 - Bone Collection	E
HN498 - 297	Mass Grave	Mass Reinterment, Grave 76 - Bone Collection	/
HN498 - 298	Mass Grave	Mass Reinterment, Grave 76 - Bone Collection	E
HN498 - 299	Reburial	Reburial of Remains	NW
HN498 - 300	Reburial	Reburial of Remains	E
HN498 - 301	Reburial	Reburial of Remains	/
HN498 - 302	Reburial	Reburial of Remains - Hitchin's municipal cemetery	/
HN498 - 303	Reburial	Reburial of Remains - Hitchin's municipal cemetery	/
HN498 - 304	Reburial	Reburial of Remains - Hitchin's municipal cemetery	/
HN498 - 305	Reburial	Reburial of Remains - Hitchin's municipal cemetery	/
HN498 - 306	Reburial	Reburial of Remains - Hitchin's municipal cemetery	/
HN498 - 307	Reburial	Reburial of Remains - Hitchin's municipal cemetery	/
HN498 - 308	Reburial	Reburial of Remains - Hitchin's municipal cemetery	/
HN498 - 309	Reburial	Reburial of Remains - Hitchin's municipal cemetery	/
HN498 - 310	Reburial	Reburial of Remains - Hitchin's municipal cemetery	/
HN498 - 311	Reburial	Reburial of Remains - Hitchin's municipal cemetery	/
HN498 - 312	Reburial	Reburial of Remains - Hitchin's municipal cemetery	/

Reference	Type	Description	Direction
HN498 - 313	Reburial	Reburial of Remains - Hitchin's municipal cemetery	/
HN498 - 314	Reburial	Reburial of Remains - Hitchin's municipal cemetery	/
HN498 - 315	Reburial	Reburial of Remains - Hitchin's municipal cemetery	/
HN498 - 316	Reburial	Reburial of Remains - Hitchin's municipal cemetery	/
HN498 - 317	Reburial	Reburial of Remains - Hitchin's municipal cemetery	/
HN498 - 318	Reburial	Reburial of Remains - Hitchin's municipal cemetery	/
HN498 - 319	Reburial	Reburial of Remains - Hitchin's municipal cemetery	/
HN498 - 320	Reburial	Reburial of Remains - Hitchin's municipal cemetery	/
HN498 - 321	Reburial	Reburial of Remains - Hitchin's municipal cemetery	/
HN498 - 322	Reburial	Reburial of Remains - Hitchin's municipal cemetery	/
HN498 - 323	Reburial	Reburial of Remains - Hitchin's municipal cemetery	/
HN498 - 324	Reburial	Reburial of Remains - Hitchin's municipal cemetery	/
HN498 - 325	Reburial	Reburial of Remains - Hitchin's municipal cemetery	/
HN498 - 326	Reburial	Reburial of Remains - Hitchin's municipal cemetery	/
HN498 - 327	Reburial	Reburial of Remains - Hitchin's municipal cemetery	/
HN498 - 328	Reburial	Reburial of Remains - Hitchin's municipal cemetery	/
HN498 - 329	Reburial	Reburial of Remains - Hitchin's municipal cemetery	/
HN498 - 330	Reburial	Reburial of Remains - Hitchin's municipal cemetery	/
HN498 - 331	Reburial	Reburial of Remains - Hitchin's municipal cemetery	/
HN498 - 332	Reburial	Reburial of Remains - Hitchin's municipal cemetery	/
HN498 - 333	Reburial	Reburial of Remains - Hitchin's municipal cemetery	/
HN498 - 334	Reburial	Reburial of Remains - Hitchin's municipal cemetery	/
HN498 - 335	Reburial	Reburial of Remains - Hitchin's municipal cemetery	/
HN498 - 336	Reburial	Reburial of Remains - Hitchin's municipal cemetery	/
HN498 - 337	Reburial	Reburial of Remains - Hitchin's municipal cemetery	/
HN498 - 338	Reburial	Reburial of Remains - Hitchin's municipal cemetery	/
HN498 - 339	Reburial	Reburial of Remains - Hitchin's municipal cemetery	/
HN498 - 340	Vault	BGS Breaking into Vault (42)	N
HN498 - 341	Vault	BGS in Vault (42)	N
HN498 - 342	Vault	BGS in Vault (42)	N
HN498 - 343	Vault	BGS in Vault (42)	N
HN498 - 344	Vault	BGS Removing Remains	NE
HN498 - 345	Vault	Demolition of the Vault	S
HN498 - 346	Vault	Demolition of the Vault	S
HN498 - 347	Vault	Demolition of the Vault	S
HN498 - 348	Vault	Demolition of the Vault	S
HN498 - 349	Vault	Demolition of the Vault	S
HN498 - 350	Vault	Demolition of the Vault	S
HN498 - 351	Vault	Demolition of the Vault	S
HN498 - 352	Vault	Demolition of the Vault	W
HN498 - 353	Vault	Demolition of the Vault	W
HN498 - 354	Vault	Demolition of the Vault	W
HN498 - 355	Vault	Demolition of the Vault	W
HN498 - 356	Vault	Demolition of the Vault	W
HN498 - 357	Vault	Demolition of the Vault	W
HN498 - 358	Vault	Demolition of the Vault	W
HN498 - 359	Vault	Demolition of the Vault	W
HN498 - 360	Vault	Demolition of the Vault	W
HN498 - 361	Vault	Coffin Debris inside the Vault	/
HN498 - 362	Vault	BGS Removing Remains	N
HN498 - 363	Vault	BGS Breaking into Vault (42)	N
HN498 - 364	Vault	BGS Breaking into Vault (42)	N
HN498 - 365	Vault	Exposed North Side of Vault (42)	S
HN498 - 366	Vault	Interior of Vault (42)	S
HN498 - 367	Vault	Interior of Vault (42)	S
HN498 - 368	Vault	Exposed North Side of Vault (42)	S
HN498 - 369	Vault	Interior of Vault (42)	N
HN498 - 370	Vault	Tent Covering Vault Entrance	NE
HN498 - 371	Vault	BGS Removing Remains	NW
HN498 - 372	Vault	BGS Removing Remains	N
HN498 - 373	Vault	Interior of Vault (42)	N
HN498 - 374	Vault	General View of BGS & Vault	E

Appendix 4: Records from Cemetery Clearance, c.1970

(alphabetical by surname)

Grave Number	Corresponding HN Grave	First Name	Surname	Date	Comments
78		William	?rd	1857	
78		Sarah	?rd		
84	227		Adams		daughter of Walter and Ann Adams
46		Joseph	Banks	1796	
46		Ann	Banks	1800	
46		Edward	Banks	1800	
10	25	Elizabeth	Beck	1838	widow of William Beck, Gent. Daughter of John Kimpton
74		Mary	Blinkhorn	1842	sister of Charles Jackson
26		John	Blow	1784	
36	13	Louisa	Braund	1855	wife of William Braund
36	13	Frederick	Braund	1842	Son of Louisa Braund
36			Braund		one of two children who died in infancy
36			Braund		
36		William	Braund		husband of Louisa Braund
72		William	Braybrooke	1856	
22		Ebenezer	Browne	1845	
22		Frances Mary	Browne	1850	sister of Ebenzer Browne
25		Charles	Browne	1812	son of Richard Browne
25		Richard	Browne	1822	
25		Frances	Browne	1823	wife of Richard Browne?
73	136	James	Carter	1840	
73		William	Carter	1851	father of James Carter
73		Dere	Carter	1857	mother of James Carter
81		John	Carter	1857	
81		Mary	Carter	1828	
47		Ann	Clarkson	1816	
50		Joseph	Clarkson	1852	
67		Isaac	Connell		gent
80		Mary	Crawley	1819	
78		Mary	Deacon		
42		John	Dearmer	1770	
19		Sleap	Dermer	1741	
19		Ann	Dermer	1757	
34		John	Dermer	1764	
34		Elizabeth	Dermer		
48		James	Dermer	1804	
55		John	Dermer	1851	
56		Ann	Dermer	1825	daughter of John and Ann Dermer
57		John	Dermer	1792	
57		Ann	Dermer	1797	
58		William	Dermer	1821	
44		Mary	Duncliffe	1786	wife of Isaac Duncliffe
44		Lydia	Duncliffe	1791	wife of Isaac Duncliffe
44		Ann	Duncliffe	1815	wife of Isaac Duncliffe
65		Keziah	Estwick	1835	
65		Ann	Estwick	1855	wife of William Estwick
4		Issaac	Field	1809	
4		Elizabeth	Field	1810	wife of Issaac Field
5		Susanna	Field	1800	
5		Thomas	Field		infants of Susanna Field
5		Sybella	Field		infants of Susanna Field
6		Mary	Field	1841	
6		John	Field	1841	
23		John	Field	1825	
23		Mary	Field	1829	
83	215	John	Foot	1855	
83	215	Sarah	Foot	1856	
71		Elizabeth	Forster	1838	children of John and Mary Forster
71		Hester Lydia	Forster	1842	children of John and Mary Forster
71		Arthur Chantrey	Forster	1842	children of John and Mary Forster
71		Samuel Allen	Forster	1842	children of John and Mary Forster
71		Emma	Forster	1843	children of John and Mary Forster

Grave Number	Corresponding HN Grave	First Name	Surname	Date	Comments
56		Elizabeth	Gallagher	1853	
7	4	Henry	Gane	1828	
7	4	Ann	Gane	1834	
69		Joseph	Green	1816	
69		Susannah	Green		
49		John	Griffiths	1795	
49		Ebenezer	Griffiths	1794	
49		Mary	Griffiths	1788	daughter
61	121 (reburied 265)	Elizabeth	Hailey	1863	daughter of John Wilshere
61		Frances	Hawkins		
63		James	Heath	1851	
63		Mary	Heath	1853	
84	227	Mary	Hewes	1852	
84	227	Samuel	Hewes		
45		Edward	Hickman	1791	
45		Sarah	Hickman	1760	
21		John	Hill	1745	a minister in London
24		John	Hill	1745	see grave 21
20		Edward	Hitchin	1725	son of Edward Hitchin
32		Edward	Hitchin	1745	
53	89	Thomas	Housden	1833	
66		Fanny	Impey	1854	
66		Samuel	Impey	1850	brother of Fanny Imprey
64		Ann	Jackson	1851	wife of George Jackson
74		Charles	Jackson	1838	
74			Jackson		one of two children died in infancy
74			Jackson		one of two children died in infancy
1		Elizabeth	Kimpton	1761	
2		John	Klmp-ton	1777	
10		Mary	Kimpton		infants of Elizabeth Beck?
10		Elizabeth	Kimpton		infants of Elizabeth Beck?
75		William	Langford	1828	
75		Sarah	Langford	1840	wife of William Langford
75	(reburied in mass grave 76)	Susannah	Langford	1864	daughter in law of William Langford
75		William	Langford	1864	son of William Langford
59		John	Mansell		
51		Sarah	Muddel	1849	
40		George	Paternoster	1796	
41		George	Paternoster	1784	
17		Thomas	Pettitt	1743	
17		Hanah	Pettitt	1751	wife of thomas Pettitt
18		Thomas	Pettitt	1743	
35	18	Elizabeth	Pitt	1853	
24		William	Plumer	1722	
12		Dinah	Prentice	1786	
79		Elizabeth	Robinson	1845	
82	145	William	Rogers	1849	
43		John	S	1777	
52		Joseph	Seymour	1833	
52		William	Seymour	1856	
52		Mary	Seymour	1864	wife of William Seymour
52			Seymour		one of five children died in infancy
52			Seymour		one of five children died in infancy
52			Seymour		one of five children died in infancy
52			Seymour		one of five children died in infancy
52			Seymour		one of five children died in infancy
53		Mary Ann	Shreeves	1846	
29		John	Simpson	1765	the younger
30		Elizabeth	Simpson		mother of John Simpson
33		Mary	Simpson		wife of John Simpson
77		Charles	Sloper	1825	reverend
77		Sarah Ann	Sloper	1838	daughter of Charles Sloper
77		Sarah	Sloper	1843	second wife of Charles Sloper
39		John	Stevens		
62		Thomas	Sugars	1847	
62		Mary	Sugars	1847	

Grave Number	Corresponding HN Grave	First Name	Surname	Date	Comments
47		John	Tapp	1816	
47		Elizabeth	Tapp	1836	
79		Mary	Taylor	1857	mother of Elizabeth Robinson
3		Ann	Thorpe		wife of Richard Thorpe
8		Richard	Thorpe	1843	
8		Elizabeth	Thorpe	1864	
9	105	Mary	Thorpe	1851	
54		Joseph	Turner	1835	children of Joseph and Mary Turner
54		Martha Elizabeth	Turner	1837	children of Joseph and Mary Turner
54		Emma	Turner	1839	children of Joseph and Mary Turner
54	127	Josia	Turner	1843	children of Joseph and Mary Turner
31		Susannah	Vincent	1779	
31		Thomas	Vincent	1779	
31		Nathaniel	Vincent	1816	
70		Edward	Waby	1809	
70		Mary	Waby		wife of Edward Waby
70		Anna	Waby	1845	daughter of Edward Waby
51		William	Warren	1830	
51		Sarah	Warren	1844	
76		Mary	Wayne	1844	
76		Josiah Bull	Wayne	1847	
76			Wayne		one of five children died in infancy
76			Wayne		one of five children died in infancy
76			Wayne		one of five children died in infancy
76			Wayne		one of five children died in infancy
76			Wayne		one of five children died in infancy
60		James	Wiggs	1777	
68		William	Williams	1817	reverend
68		Love	Williams		
68		William	Williams		
68		Lewis	Williams	1848	
68		Jane	Williams	1818	
11		Mary	Wilshere	1794	widow of John Wilshere
13		Sarah	Wilshere	1784	wife of John Wilshere
14		Elizabeth	Wilshere	1773	daughter of William and Susannah Wilshere
15		Susannah	Wilshere	1771	daughter of Susannah Wilshere
16		Sarah	Wilshere	1773	daughter of William and Susannah Wilshere
16		George	Wilshere		child of William and Susannah Wilshere, which died in infancy
16		Jas.	Wilshere		child of William and Susannah Wilshere, which died in infancy
16		Jas.	Wilshere		child of William and Susannah Wilshere, which died in infancy
16		Frances	Wilshere		child of William and Susannah Wilshere, which died in infancy
27		Lora	Wilshere	1847	wife of Thomas Wilshere
27		Ann	Wilshere	1843	
27		Thomas	Wilshere	1851	
27		Thomas	Wilshere	1840	
27		Mary	Wilshere	1851	june
28			Wilshere		one of 10 children of William and Ann from 1773, 74, 75, 89 onwards
28			Wilshere		one of 10 children of William and Ann from 1773, 74, 75, 89 onwards
28			Wilshere		one of 10 children of William and Ann from 1773, 74, 75, 89 onwards
28			Wilshere		one of 10 children of William and Ann from 1773, 74, 75, 89 onwards
28			Wilshere		one of 10 children of William and Ann from 1773, 74, 75, 89 onwards
28			Wilshere		one of 10 children of William and Ann from 1773, 74, 75, 89 onwards
28			Wilshere		one of 10 children of William and Ann from 1773, 74, 75, 89 onwards
28			Wilshere		one of 10 children of William and Ann from 1773, 74, 75, 89 onwards
28			Wilshere		one of 10 children of William and Ann from 1773, 74, 75, 89 onwards
28			Wilshere		one of 10 children of William and Ann from 1773, 74, 75, 89 onwards
61	121 (reburied 265)	John	Wilshere	1836	
61	131	Arabella	Wilshere		wife of John Wilshere
61	130	William	Wilshere	1853	son of John Wilshere
37					no stone
38		Elizabeth		180?	

Appendix 5: Unmarked graves from church records

Date	First Name	Surname	Comments
1837	James	Elliman	Recorded by Rev. John A. Wayne in small church book
1838	William	Mardling	
1839	George	Best Mowbray	
	Lydia	Merritt	
	Lydia	Parcell	
	Janet	McVey	
	Sarah	Joiners	
	George	Creasey	
	Ruth	Parkin	
	James	Arnold	
	Robert	Slater	
1840	Ezekiel	Buckle	
	Timothy	Tuffnell	
	Elizabeth	Frost	
1841	Sophia	Pack	
	Evan	Mathews	
	Mary	Jordan	
	Samual	Chalkley	
1842	Elizabeth	Tuffnell	
	John	Frost	
	Mary Ann	Foot	and infant
	Samual	Underwood	
	James	Beach	
	Thomas	Stanton	
1843	Emma	Whitmore	and infant
	John	Estwick	
	Janet	Steele	
	Mary	Davies	
1844	James	Jordan	
	Sarah	Hine	
	Mary	Shepherd	
	Elizabeth	Harvey	
	Gustavus Luther	Allen	
1845	James	Foot	
	Robert	Leatherbarrow	
	Alice	Smith	
	Abraham	Fells	
	Elizabeth	Robinson	
	Sarah	Rogers	
	Elizabeth	Crowther	
	John	Thrussell	
	Henry James	Carter	
1846	Ellen	Gregory	
	Richard	Bullard	
	Elizabeth	Crawley	
	Rachel	Hobbs	
	Catherine	Hyde	
1849	William	Martin	Recorded by Rev. F.W. Heathcote in large church book
	Jesse	Estwick	
	James	Grummett	
	Hephzibah	Taylor	
	James	Coleman	
	George	Stracey	
	Henry	Froy	
	Joseph	Chapman	
	Elizabeth	Cotton	
	James	Chalkley	
	Elizabeth	Gentle	
	John	Back	

Date	First Name	Surname	Comments
	Ann	Bullard	
	Luther	Jordan	
1850	Elizabeth	Estwick	
	George Caleb	Watts	
	Frances	Tracey	
	Herbert	Breed	
	Eliza	Estwick	
	Sarah	Carter	
	Elizabeth	Kingham	
	Elizabeth	Steeley	
	Ann	Bullard	
	Samual	Clements	
	Lucy	Harris	
	Daniel	Cotton	
	Sarah	Joiner	
	Sarah	Seymour	
	William	Forster	
	Sarah Ann	Day	
1851	Sarah	Jordan	
	?	Wilding	
	Mary Ann	Stanton Carter	
	Hannah	Primmitt	
	Caleb	Corley Watts	
	George	Kimpton	
	Martha	Issitt	Recorded by Rev. W. Griffiths in large church book
	Naomi	Parkins	
	Sarah	Brown	
	Jane	Tansley	
1852	Amos	Paine	
	Mary	Winch	
	Thomas	Deacon	
	Thomas	Merritt	
	Mary	Creasey	
	Charles	Mayo	
	George	Mayo	
	Hannah	Law	
	George	Parcell	
	Sarah	Cotton	
	Stephen	Norfolk	
	James	Norfolk	
	Frederick William	Brown	
	Thomas Charles	Harris	
	Sarah Ann	Ashton	
	John	Rogers	
	John	Muirhead	
1853	John	Course	
	William	Morgan	
	Maria	Day	
	Harriet	Rudd	
	George	Forsett Creasey	
	James	Foot	
	William	Tansley	
1854	George	Marriott	
	Ellen	Deacon	
	John	Day	
	Thomas	Parcell	
	Ruth	Foster	
	Ann	Saunders	
	Henry	Wells	
	Ann	Buckingham	

Date	First Name	Surname	Comments
	Arthur	Coleman	
	Hannah	Dawes	
	Mary	Kimpton	
	James	Morgan	
1855	George	Taylor	
	Daniel	Pilgrim	
	Sarah	Pettengell	
	John	Douglas	
	Emma	Day	
	Elizabeth	Clements	
	John	Lawson Bailey	
	William	Westwood	
	Sarah	Taylor	
	Aniko Selma	Tuck	
	Elizabeth	Stanton	
	Edwin John	Wykes	
	John	Green	
1856	Ann	Rogers	
	Mary	Foster	
	Charles	Taylor	
	Hannah	Pack	
1857	Frances	Wilding	
	Ellen	Day	

Appendix 6: Marked graves from church records

Grave Number	First Name	Surname	Date	Comments
1	Elizabeth	Kimpton	1761 / ? 1791	
2	John	Kimpton	1777	
3	Ann	Thorpe		Wife of Richard Thorpe
4	Isaac	Field	? 1809	Elizabeth, his wife, 1810
5	Susanna	Field	1800	Thomas & Sybella (in infancy)
6	Mary	Field	1841	John Field 1841
7	Henry	Gane	1828	Ann Gane 1834
8	Richard	Thorpe	1843	Elizabeth Thorpe 1864
9	Mary	Thorpe	1851	
10	Elizabeth	Beck	1838	Widow of Wm Beck, daughter of John & Elizabeth Kimpton. Also of Mary Kimpton
11	Mary	Wilshere	1794	Widow of John Wilshere
12	Dinah	Prentice	1786	
13	Sarah	Wilshere	1784	Widow of John Wilshere
14	Elizabeth	Wilshere	1773	Daughter of Wm and Susannah Wilshere
14a				"W" (probably displaced end stone of one of the Wilshere graves)
15	Susannah	Wilshere	1171	Daughter of Susannah Wilshere. Also Martha, another daughter
16	Sarah	Wilshere	1773	Daughter of Wm and Susannah Wilshere. Also of 4 children who died in infancy, George, James, James & Frances
17	Thomas	Pettitt	1743	
17	Hannah	?	1751	
18	Thomas	Pettitt	1743	
18	Hannah	his wife		
19	Sleap	Dermer	? 1741	
19	Ann	Dermer	1757	
20	Edward	Hitchin	1725	Son of Edward Hitchin
21	John	Hill	1745	(a minister in London)
22	Ebenezer	Browne	1845	
22	Frances Mary	Baron	1850	His sister
23	John	Field	1825	
23	Mary	Field	1829	
24	William	Plumer	1722	
25	John	Hill	? 1745	See No 21
26	John	Blow	1784	
27	A Wilshere Vault			
27	Lora		1847	
27	Ann		1843	
27	Thomas		? 1851	
27	Thomas		1840	
27	Mary		1851	Wife of Thomas
27				Mostly illegible but east side notes 10 children of William and Ann in the years 1773; '74; '74; '75; '89 etc
29	John	Simpson	1765	The Younger
30				Illegible but Elizabeth Simpson is known to be buried near her son
31	Susannah	Vincent	1779	
31	Thomas	Vincent	? 1779	
31	Nathaniel	Vincent	1818	
32	Edward	Hitchin	? 1745	
33	Mary	Simpson		Wife of John
34	John	Dermer		
34	Elizabeth	Dermer	1764	
35	Elizabeth	Pitt	1853	
36	Louisa	Braund	1855	

Grave Number	First Name	Surname	Date	Comments
36	Frederick (son)	Braund	1842	
36	William (father)	Braund	1865	2 children who died in infancy
37				No stone
38	Elizabeth		180(?)	
39	John	? Stevens		
40	George	Paternoster	? 1796	
41	George	Paternoster	? 1784	
42	John	Dearmer	? 1770	
43	John	Simpson	177(7)	
44	Mary	Duncliffe	1786	
44	Lydia	Duncliffe	1791	
44	Ann	Duncliffe	1815	Wives of Isaac Duncliffe 1819
45	Edward	Hickman	1791	
45	Sarah	Hickman	? 1760	
46	Joseph	Banks	1796	
46	Ann	Banks	1800	
46	Edward	Banks	1800	
47	John	Tapp	1816	
47	Ann	Clarkson	1816	
47	Elizabeth	Tapp	1836	
48	James	Dermer	? 1804	
49	John	Griffiths	1795	
49	Ebenezer	Griffiths	1794	
49	Mary	Griffiths	1788	Daughter
50	Joseph	Clarke	1852	
51	William	Warren	1830	
51	Sarah	Warren	1844	
51	Sarah	Muddel	1849	
52	Joseph	Seymour	1833	
52	William	Seymour	1856	
52	Mary	Seymour	1864	Wife of William children who died in infancy Also five
53	Thomas	Housden	1833	
53	Mary Ann	Shreeves	1846	
54	Joseph	Turner	1835	
54	Martha Elizabeth	Turner	1837	
54	Emma	Turner	1839	
54	Josiah	Turner	1843	Children of Joseph and Mary Turner
55	John	Dermer	? 1851	
56	Ann	Dermer	1825	Daughter of John and Ann Dermer
56	Elizabeth	Gallagher	1853	
57	John	Dermer	1792	
57	Ann	Dermer	1797	
58	William	Dermer	1821	
59	John	Mansell or Marshall		
60	James	Wiggs	1777	
61	A Wilshere Vault			
61	John	Wilshere	1836	
61	Arabella	Wilshere	1853	Wife of John
61	Francis	Hawkins		
61	William	Wilshere	1853	Son of John
61	Elizabeth	Hailey	1863	Daughter of John
62	Thomas	Sugar	1847	
62	Mary	Sugar	1847	
63	James	Heath	1851	
63	Mary	Heath	1853	

Grave Number	First Name	Surname	Date	Comments
64	Ann	Jackson	1851	Wife of George Jackson
65	Kezia	Estwick	1835	
65	Ann	Estwick	? 1855	Wife of William Estwick
66	Fanny	Impey	1854	
66	Samual	Impey	1850	Brother of Fanny
67	Isaac	Con(nell)?		Gent
68	Rev. William	Williams	? 1817	
68	Love	Williams		
68	William Lewis	Williams	1848	
68	Jane	Williams	? 1818	
69	Joseph	Green	181(6)	
69	Susannah	Green		
70	Edward	Waby	1809	
70	Mary	Waby		His wife
70	Anna	Waby	? 1845	His daughter
71	Eliza	Forster	1838	
71	Hester Lydia	Forster	1842	
71	Arthur Chantrey	Forster	1842	
71	Samual Allen	Forster	1842	
71	Emma	Forster	1843	Also five children of John and Mary Forster
72	William	Braybrooks	1856	
72	?	?	?	
73	James	Carter	1840	
73	William	Carter	1851	His father
73	Dere	Carter	1857	His mother
74	Charles	Jackson	1838	Also two children who died in infancy
74	Mary	Blinkhorn	1842	His sister
75	William	Langford	1828	
75	Sarah	Langford	1840	His wife
75	Susannah	Langford	1864	His daughter
75	William	Langford	1864	His son
76	Mary	Wayne	1844	
76	Josiah Bull	Wayne	1847	Also five children who died in infancy
77	Rev. Charles	Sloper	1825	
77	Sarah Ann	Sloper	1838	His daughter
77	Sarah	Sloper	1853	His second wife
78	William	? rd (?)	1857	
78	Sarah	?	?	
78	Mary	Deacon	?	
79	Elizabeth	Robinson	1845	
79	Mary	Taylor	1857	Her mother
80	Mary	Crawley	18(1)9	
81	John	Carter	1857	
81	Mary	Carter	? 1828	
82	William	Rogers	1849	
83	John	Foot	1855	
83	Sarah	Foot	1856	
84	Mary	Hewes	1852	
84	Samual	Hewes	?	Daughter of Walter and Ann Adams