

Land to the r/o 'Shipwrights', Baldock Road, Cottered, Herts.

HN1035

Report No. 850

Site name and address:	r/o 'Shipwrights', Baldock Road, Cottered, Herts.		
County:	Hertfordshire	District:	East Herts
Village/town:	Cottered	Parish:	Cottered
Planning reference:	3/12/0973/FP	NGR:	TL 31990 29230
Client name and address:	Mr & Mrs B. Pitman, 'Shipwrights', Baldock Road, Cottered, Herts.		
Nature of work:	Archaeological Monitoring	Previous land use:	Field
Site Status:	Area of Archaeological Significance	Reason for investigation:	Direction of local planning authority (NPPF)
Position in planning process:	Post-determination	Project brief originator:	County Archaeologist
Size of affected area:	c. 106m ²	Size of area investigated:	c. 106m ²
HN Ref:	HN1035	HER enquiry no:	230/12
Organisation:	Heritage Network	Site Director:	David Hillelson
Project type, methods etc.	O/R	Archive Recipient:	Hertford Museum
Start of work	21/01/2014	Finish of work	21/01/2014
Related HER Nos:	n/a	Periods represented:	None
Oasis UID:	heritage1-137938	Significant finds:	None
Monument types:	None		
Physical archive:	None		
Previous summaries/reports:	n/a		

Introduction:

In response to a condition on the planning consent for the demolition and replacement of existing stables and hay barn on land to the rear of 'Shipwrights', Baldock Road, Cottered, Herts, the Heritage Network was commissioned to undertake a programme of archaeological monitoring of the development groundworks.

Narrative:

The study area is located in a field to the rear of 'Shipwrights', which lies on the south side of Baldock Road, centred at NGR TL 31990 29230 (Figure 1).

The works for the present project consisted of ground reduction across the area of the new building. The new structure is L-shaped in plan, with the northern range measuring 9.30m in length by 5m in width and the southern range 11m in length by 5m in width. The ground was reduced by 0.40m across the northern half of the area, and by 0.60m at the southern end.

Discussion:

The exposed stratigraphy comprised dark grey (2.5Y 4/1) friable silty sandy clay topsoil, 0.25m in depth, which overlay the yellow (2.5R 8/6) sandy clay natural.

The documented evidence indicates that the site lies in an area of archaeological interest. The site lies partly within *Area of Archaeological Significance no.35* (AAS35), as identified in the District Local Plan, which encompasses the historic core of Cottered. A number of medieval buildings and sites lie close to the site. The location of the proposed new stables is immediately adjacent to the boundary of a medieval moated site and later house called The Lordship.

Slight evidence for early medieval activity was revealed during archaeological monitoring at the neighbouring property, Shipwrights Cottage (HER 13135) in 2005. Three sherds of pottery, dating from the 10th - 12th centuries were recovered from a small pit to the rear of the house (Saunders & Hillelson 2006). Considerable quantities of Hertfordshire greyware, dating from between the 12th and 14th centuries, were also collected from the overburden at the same site. The evidence indicates medieval activity in the immediate vicinity.

No features, deposits or finds of archaeological significance were encountered during the course of these works.

Illustrations:

Figure 1 Site Location

Figure 2 Site layout

Plate 1 General view across the site prior to the start of groundworks, looking SW

Plate 2 View across the site after the ground reduction, looking NW

Helen Ashworth, BA (HONS) AIFA

March 2014

(Revision A – 27/03/2014)

THE HERITAGE NETWORK LTD

Land to the r/o Shipwrights,
Baldock Road, Cottered, Herts.

HN1035

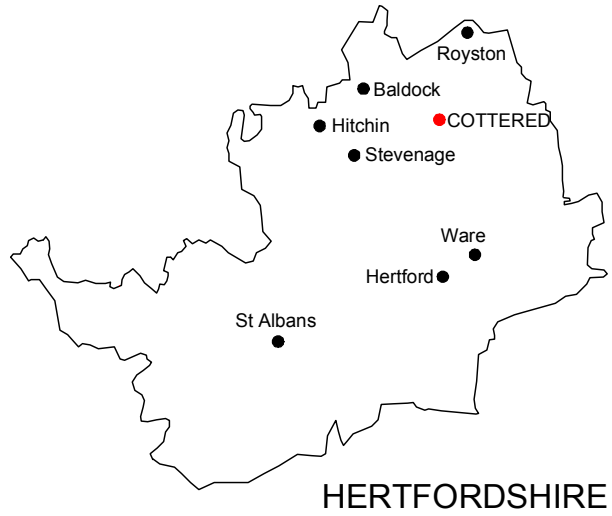
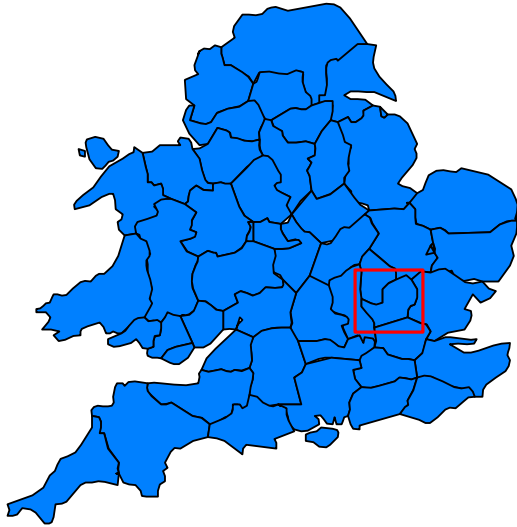

HERTFORDSHIRE

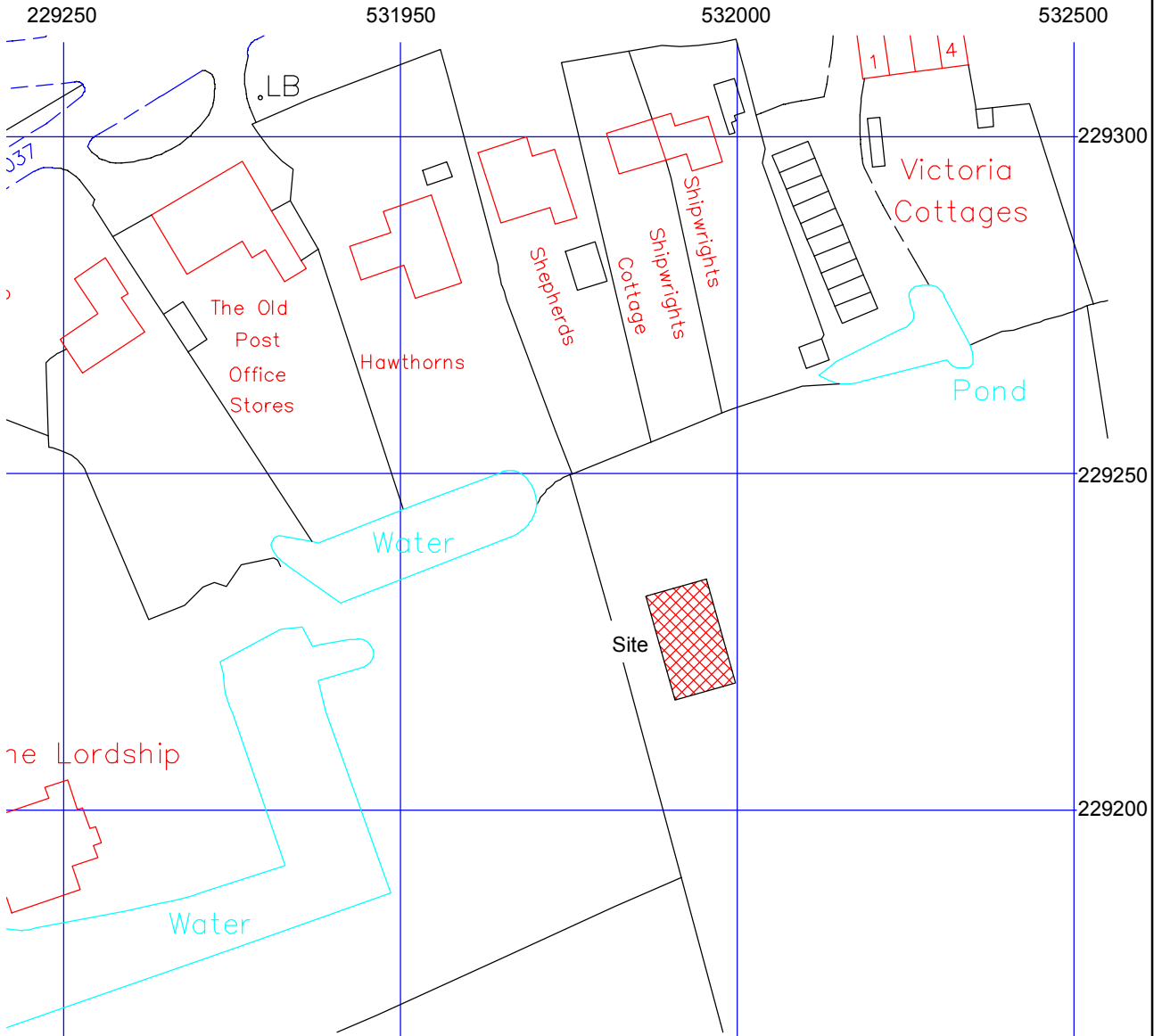

Site Location

Scale 1:1000

Ordnance Survey (c) Crown Copyright 2014. All rights reserved. Licence number 100022432

Figure 1

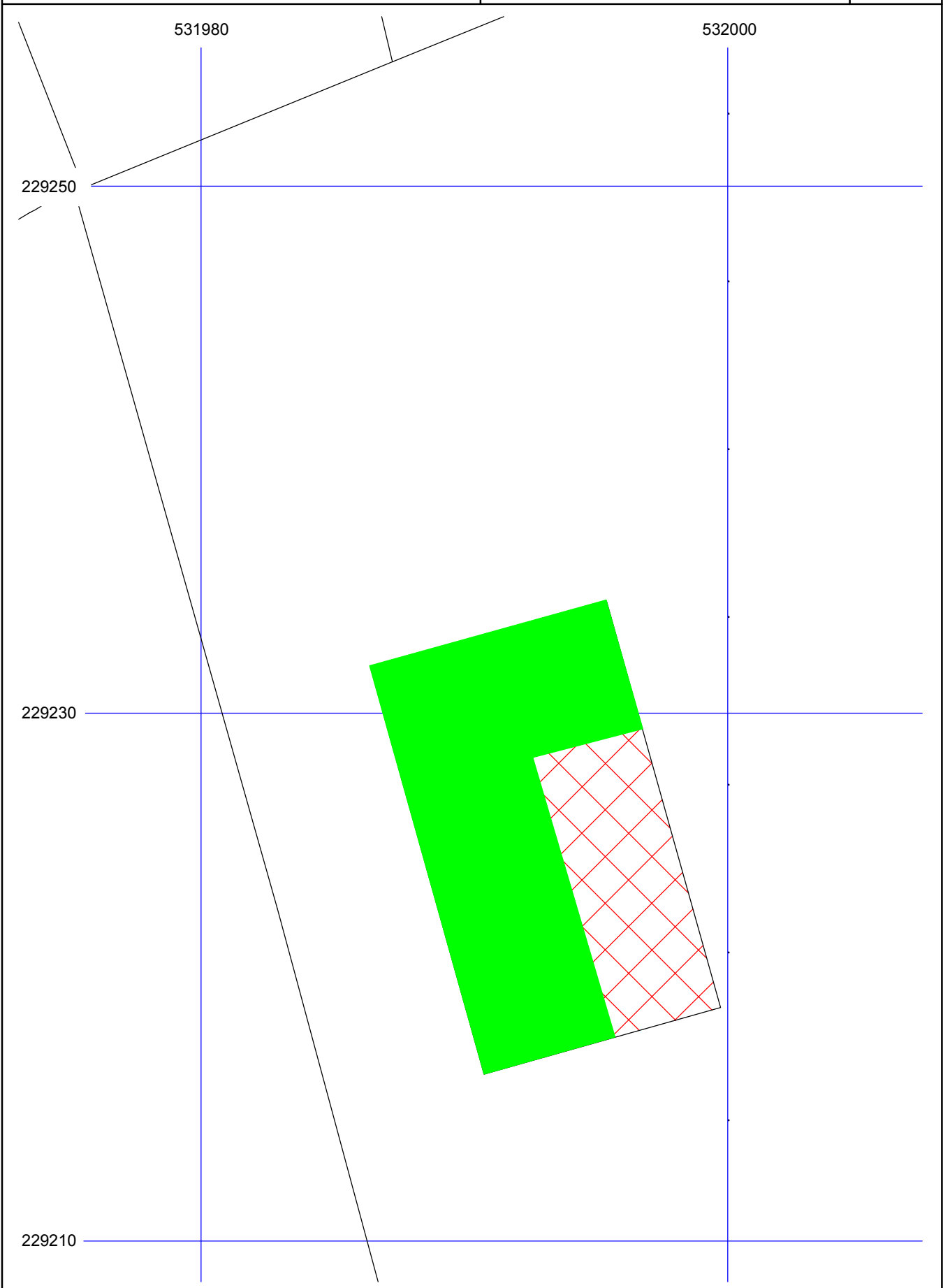

Site layout

Scale 1:250



Plate 1: General view across the site prior to the start of the groundworks, looking SW



Plate 2: View across the site after ground reduction, looking NW