

26 Ayot Green, Ayot St Peter, Herts.

HN1160

Report No.914

Site name and address:	26 Ayot Green, Ayot St Peter, Herts, AL6 9AB		
County:	Hertfordshire	District:	Welwyn Hatfield
Village/town:	Ayot Green	Parish:	Ayot St Peter
Planning reference:	N6/2014/0926/FP	NGR:	TL 22129 14185
Client name and address:	Mr & Mrs Miller, as above		
Nature of work:	New extensions	Present land use:	Existing extensions and garage
Site Status:	AAS No. 57	Reason for investigation:	Direction of local planning authority (NPPF)
Position in planning process:	Post-determination (as a condition)	Project brief originator:	None
Size of affected area:	35m ²	Size of area investigated:	19.20m ²
Site Code:	HN1160	HER reference:	154/14
Organisation:	Heritage Network	Site Director:	David Hillelson
Project type, methods etc.	Observation and Recording	Archive Recipient:	Welwyn Hatfield Museum Service/OASIS/ADS
Start of work	28/01/2015	Finish of work	04/02/2015
Related HER Nos:	None	Periods represented:	None
Oasis UID:	heritage1-189856	Significant finds:	None
Monument types:	None		
Physical archive:	None		
Previous summaries/reports:	n/a		

Narrative:

This report has been prepared at the request of Mr and Mrs Miller, to complete a scheme of archaeological work carried out as part of a programme of development at 26 Ayot Green, Ayot St Peter, Herts, AL6 9AB. Planning permission for the demolition of existing extensions to the house, and their replacement on the same footprint, and for the division of the existing double garage (ref: N6/2014/0926/FP), was granted by Welwyn Hatfield Borough Council Council (WHBC) subject to an archaeological condition issued in line with the Department of Communities and Local Government's National Planning Policy Framework (NPPF).

The study area is centred on NGR TL 22129 14185. It is located at the north end of Ayot Green, on the east side of Ayot St Peter Road (Figure 1). The site is bounded by the road to the west, by no.24 Ayot Green to the south and no.22 Ayot Green to the east. It lies within Area of Archaeological Significance No. 57, as identified on the Welwyn Hatfield District Plan, dated 2005, encompassing the historic settlement at Ayot Green, which dates from the 17th century or earlier and contains the potential for medieval and post-medieval remains.

The groundworks consisted of machine excavated footings trenches, on the eastern side of the house and a service trench to the north-west of the house (Figure 2). The footings trenches were excavated using a 360⁰ tracked mini-digger; the service trench was excavated by hand.

Footings trenches

Three trenches were excavated at the eastern end of the house, adjacent to the existing garage and on the footprint of a former extension. They measured between 4.50m and 5.50m in length, 0.85m in width and 1.15m in depth (Plate 1). The stratigraphy exposed in the sections consisted of a layer of dark greyish brown (10YR 4/2) friable sandy clay topsoil, 0.20m in depth, containing occasional fragments of post-medieval brick and tile (Plate 2). Below this was a layer of brownish yellow (10YR 6/6) friable sandy clay subsoil, 0.15m in depth, which directly overlay the natural yellowish brown (10YR 5/4) sticky clay.

No archaeological features, deposits or finds were encountered in this area.

Service trench

This was located to the north-west of the house and ran on a NNE to SSW alignment. It measured 9.50m in length, 0.60m in width and 0.85m in depth (Plate 3). The stratigraphy exposed in the sections comprised a layer of dark yellowish brown (10YR 4/4) friable sandy clay topsoil, 0.35m in depth, containing moderate rounded and sub-angular flints (Plate 4). Below this was a layer of yellowish brown (10YR 5/4) silty sand, 0.20m in depth, containing moderate rounded and sub-angular flints, which directly overlay the natural brownish yellow (10YR 6/6) sticky clay.

No archaeological features, deposits or finds were encountered in this area.

Discussion:

Cartographic evidence shows that the northern boundary to the present property has existed since at least 1878. The 1st edition 25" Ordnance Survey map shows that it was marked by a line of mature trees at that date (www.old-maps.co.uk). The property was located in the north-western corner of a large sub-rectangular field to the rear of properties facing the green. A pond is shown in the north-west corner of the field, to the north-west of the present house. The pond appears on the map of 1884, but is not marked on the OS map of 1898, or subsequent maps, suggesting it had been backfilled in the late 1880s or early 1890s (ibid). The mapping appears to show that the present house was built between 1964 and 1971 (ibid).

The groundworks for the present development did not encounter any evidence for archaeological activity on the site. The sections in the footings and service trenches revealed layers of relatively undisturbed topsoil and subsoil above the natural clay.

Illustrations:

Figure 1	Site Location
Figure 2	Site Layout
Plate 1	Footings for new extension, looking NE
Plate 2	Footings trenches, indicative section, looking NE
Plate 3	Service trench, looking N
Plate 4	Service trench, indicative section, looking NW

Helen Ashworth BA (HONS) ACIFA)
February 2015

THE HERITAGE NETWORK LTD

26 Ayot Green, Ayot St Peter, Herts.

HN1160

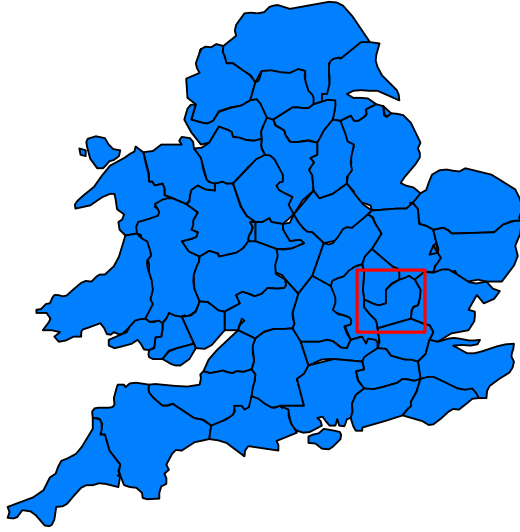

HERTFORDSHIRE

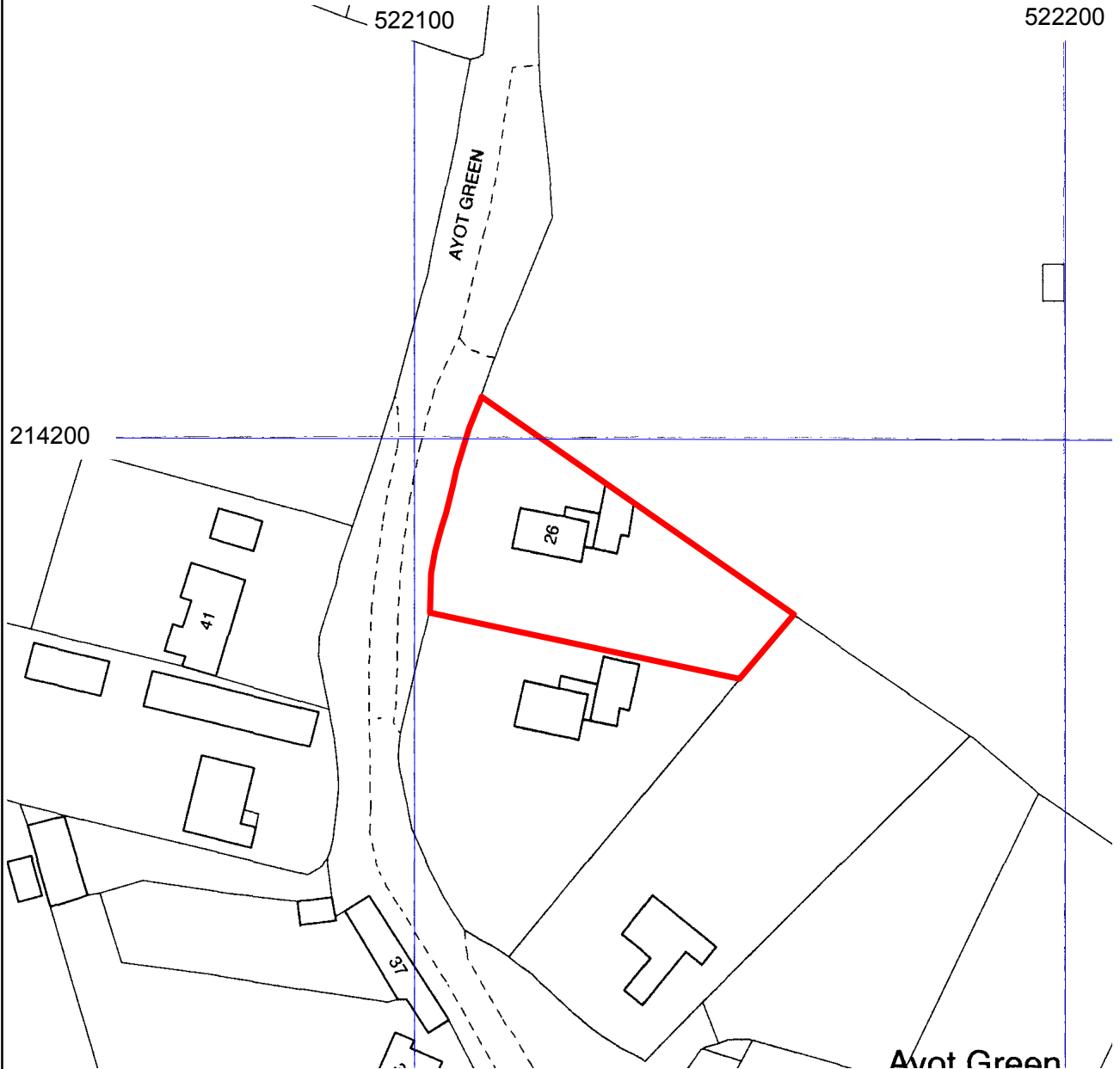

Site Location

Scale 1:1000

(Reproduced from the Ordnance Survey with the permission of the controller of Her Majesty's Stationery Office, Licence no.AL100014861)

Figure 1

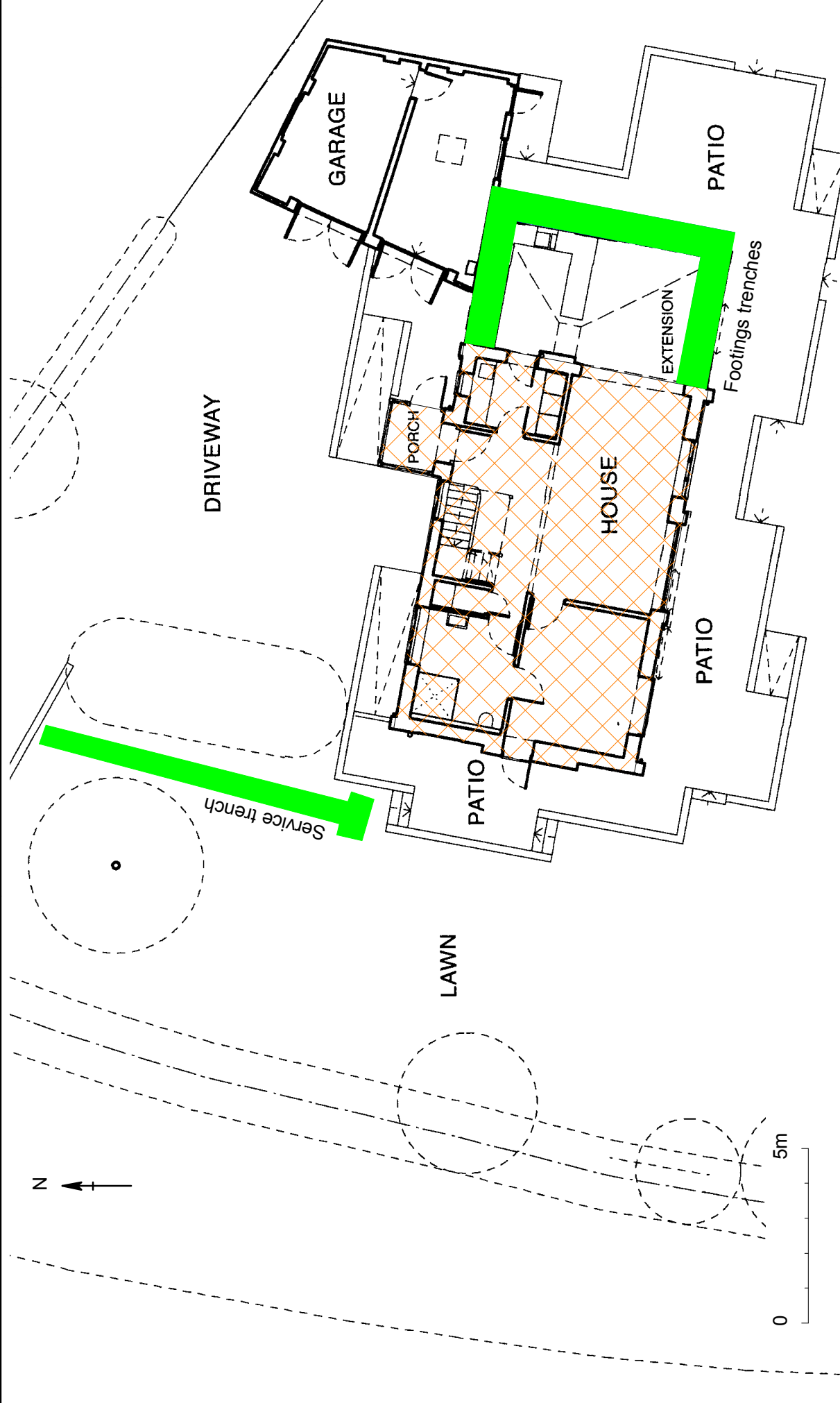

Site layout



Plate 1: Footings for new extension, looking NE



Plate 2: Footings trenches, indicative section, looking NE



Plate 3: Service trench, looking N



Plate 4: Service trench, indicative section, looking NW

OASIS DATA COLLECTION FORM: England

[List of Projects](#) | [Manage Projects](#) | [Search Projects](#) | [New project](#) | [Change your details](#) | [HER coverage](#) | [Change country](#) | [Log out](#)

[Printable version](#)

OASIS ID: heritage1-189856

Project details

Project name 26 Ayot Green, Ayot St. Peter, Welwyn

Short description of the project This report has been prepared at the request of the owners, to complete a scheme of archaeological work carried out as part of a programme of development at 26 Ayot Green, Ayot St Peter, Herts, AL6 9AB. The groundworks consisted of machine excavated footings trenches, on the eastern side of the house and a service trench to the north-west of the house. The footings trenches were excavated using a 3600 tracked mini-digger; the service trench was excavated by hand. No archaeological features, deposits or finds were encountered in any area. Cartographic evidence shows that the northern boundary to the present property has existed since at least 1878.

Project dates Start: 28-01-2015 End: 04-02-2015

Previous/future work No / No

Any associated project reference codes HN1160 - Contracting Unit No.

Type of project Recording project

Site status Local Authority Designated Archaeological Area

Current Land use Other 3 - Built over

Monument type NONE None

Significant Finds NONE None

Investigation type ""Watching Brief""

Prompt National Planning Policy Framework - NPPF

Project location

Country England

Site location HERTFORDSHIRE WELWYN HATFIELD AYOT ST PETER 26 Ayot Green

Postcode AL6 9AB

Study area 35 Square metres

Site coordinates TL 22129 14185 51.812478662277 -0.228160135343 51 48 44 N 000 13 41 W Point

Project creators

Name of Organisation: Heritage Network
 Project brief originator: None
 Project design originator: Helen Ashworth
 Project director/manager: David Hillelson
 Project supervisor: Robin Densem
 Type of sponsor/funding body: Landowner

Project archives

Physical Archive Exists?: No
 Digital Archive recipient: OASIS / ADS
 Digital Contents: "other"
 Digital Media available: "Images raster / digital photography","Text"
 Paper Archive Exists?: No

Project bibliography 1

Publication type: Grey literature (unpublished document/manuscript)
 Title: 26 Ayot Green, Ayot St Peter, Herts: monitoring report
 Author(s)/Editor(s): Ashworth, H.
 Other bibliographic details: Report no.914
 Date: 2015
 Issuer or publisher: Heritage Network
 Place of issue or publication: Letchworth, Herts.
 Description: A4 pamphlet, 2 pages, 2 figures, 4 plates

Entered by: Jenny Heinzelmann (jh@heritagenetwork.co.uk)
 Entered on: 16 May 2018

OASIS:

THE HERITAGE NETWORK LTD

Attendance Record

Site Name:	26 AYOT GREEN, AYOT ST PETER, HERTS	HN ref:	HN/160.
		Site Code:	

Recorder(s):	R.G. DUNN	Arrive time:	8.15	Return travel:	1 HOUR
Date:	4/2/2015	Depart time:	3 11.10	Total hours:	

Reported to:	KAMIL (OF CAMS) + RAFAEL	Position:	FOREMAN
Purpose of visit:	WB.		

Photograph film no	COCOUR DIG 18 BW #575
--------------------	-----------------------

Staff on site:	RGD
----------------	-----

Observations:	
---------------	--

RGD left home 8.00am, 0 miles
 arrived site 8.15am, 7.7 miles.

RGD left site 11.10am, OX 11.40.

T2 planned, more photo, section drawn, + trench record sheet.

RGD explained to Kala, CAMS project manager, that it was up to AJH as to whether gas man, to start digging 20/2/15, was monitored or not.

Sheet	1	of	1
Additional records:			
Text sheet(s)			
Sketch sheet(s)			
Context form(s)			
A2 Scale dwng(s)			✓
A3 Scale dwng(s)			
Weather:	LOW.	Photographs	✓

THE HERITAGE NETWORK LTD

Attendance Record

Site Name:	26 AYOT GREEN	HN ref:	HN 1160.
		Site Code:	

Recorder(s):	R. G. Densem	Arrive time:	8.15	Return travel:	1 HOUR
Date:	3/2/2015	Depart time:	8.45	Total hours:	

Reported to:	KAMIL	Position:	CAMS FOREMAN
Purpose of visit:	WB.		

Photograph film no	COLOUR DIGITAL & BW # 575
Staff on site:	R G Densem
Observations:	RGD observed T2 open. Took photos
	Agreed with Kamil Foreman to come back tomorrow
	& Reind: track will still be open & there is a
	need for RGD now, today, at HOLLWELL, HN 1149.

	Sheet	1	of	1
	Additional records:			
	Text sheet(s)			
	Sketch sheet(s)			
	Context form(s)			
	A4 Scale dwng(s)			
	A3 Scale dwng(s)			
Weather:	COLD, SNOW ON GROUND	Photographs		<input checked="" type="checkbox"/>

Site Name:	26 AYOT GREEN, AYOT ST PETER	HN ref:	HN/160.
		Site Code:	

Recorder(s):	R.G. DENSON	Arrive time:	8.00	Return travel:	1 HOUR
Date:	2-2-2015	Depart time:	9.45.	Total hours:	3

Reported to:	RAFAŁ KUNA CAMS	Position:	PROJECT MANAGER
Purpose of visit:	w.b. - monitoring trench 2, foul sewer		

Photograph film no	COLOUR DIGITAL.
Staff on site:	RGD
Observations:	
<p>Left home 7.45. 0 miles. Arrived site 8.00; 7.7 miles 0.9 mile 9.15, 22.2 miles.</p> <p>RGD traced plans 2 & 3. took photos of start of digging by hand by contractors (CAMS) N12, foul sewer trench. c. 0.2m of material with a ? (g shield, not collected).</p> <p>RGD agreed with Rafał for RGD to return tomorrow.</p>	

Sheet	1	of	1
Additional records:			
Text sheet(s)			
Sketch sheet(s)			
Context form(s)			
A4 Scale dwng(s)			
A2 Scale dwng(s)			✓
Weather:	COLD - OVERCAST.	Photographs	✓

Site Name:	26 AYOT GREEN, AYOT ST PETER	HN ref:	HN1160
		Site Code:	

Recorder(s):	R.G. DOWEN	Arrive time:	8.01	Return travel:	1.0
Date:	28-1-2015	Depart time:	2.15	Total hours:	4

Reported to:	RAFAC KUNA CAMS	Position:	PROJECT MANAGER
Purpose of visit:	wb. Monitoring trench 1: extension for kitchen & dining room		

Photograph film no	COLOUR DIGITALS BW # 575.
--------------------	---------------------------

Staff on site:	RGD.
----------------	------

Observations:	
---------------	--

RGD left home 7.43am 0 miles
 arrived site 8.01 7.9 miles, arrived home 2.30,
 left site 2.15pm 7.9 miles still home:

[Faint, illegible handwritten notes]

Rajal says after today, next diggout is a drain
 Run down (c. 20?m) & c. 1m+ deep, on Monday 2 Feb.
 I think there are further works: work, & another drain
 run & National Grid (electricity?).

WB Today - 'U' shaped trench dug for new kitchen - topsoil, subsoil, rubble Plan 1 & section 1 drawn, & trench 1 & trench record sheet done.	Sheet	1	of	1
	Additional records:			
	Text sheet(s)			
	Sketch sheet(s)			
	Context form(s)			
	A4 Scale dwng(s)			
	A2 Scale dwng(s)			✓
	Photographs			✓
Weather:	RAIN/OVERCAST			

NO FINDS OR FEATURES,

Site Name / Code 26 AYOT GREEN, AYOT ST PETER / HN 1160						Page No. 1	
Sheet	Drawing No.	Section / Plan	Sheet size	Scale	Details	Drawn by	Date
1		1	A2	1:50	T.1.	RGD	28/1/15
2		2	A2	1:200	TRACING OF ARCHITECT'S PLAN	RGD	2/2/15
2		3	A2	1:100	T2 location on TRACING OF ARCHITECT'S PLAN	RGD	2/2/15
SHEET	DRAW NO	SECTION					
1		1	A2	1:10	section T.1, located on plan 1	RGD	28/1/15
2		2	A2	1:10	section T2, located on plan 3	RGD	2/2/15

Sheet 1

Site Name / Code 26 AYOT GREEN, AYOT ST PETER / HN 1160						
Site	Shot Number	Details	View	Date	Time	Initials
HN1160	1	? convex slabs	L. SE	28/1/15	10.45	RGD
	2		LSE			
	3	working shot T1	L.N		10.50	
	4	↓	↓			
	5	↓	L.N			
	6	↓	↓			
	7		L.W		10.55	
	8		↓			
	9		L.W			
	10		L.W			
	11	N. ARROW ALIGNED WITH SCALES	L.E			
	12	ON WEST				
	13	T.1 WITH SCALES (N. ARROW ALIGNED W)	L.W		12.10	
	14	↓	L.W			
	15	↓	L.SW			
	16	↓	↓			
	17	T1. section 1m scale	L.W		12.25	
	18	N. ARROW ALIGNED W				
	19	↓	↓			
	20	↓	↓			
	21	T2 WORKING SHOT	L.N	2/2/15	9.15	RGD
	22	↓	↓			
	23	↓	L.NE			
	24	↓	↓			
	25	T.2	L.N	3/2/15	8.30	RGD
	26	↓	↓			
	27	↓	L.S	4/1	8.45	
	28	↓	↓			
	29	↓	↓			
	30	↓	↓			
	31	T2	L.N	4/2/15	8.45	RGD
	32	↓	↓			
	33	↓	L.S			
	34	↓	↓			
	35	↓	↓			
	36	T2 section	L.W		9.30	
	37	↓	↓			
	38	↓	↓			

Sheet 2

Site Name / Code 26 AYOT GREEN, HERTS / HN1160. (AYOT ST PETER)						
Site	Shot Number	Details	View	Date	Time	Initials
HN1160	39	VARIOUS SHOTS RE TAKEN		5/2/15		RGD
	40	IN RELATION TO				
	41	CONSIDERING WHETHER				
	42	GAS MAIN TRENCH				
	43	NEEDS TO BE				
	44	MONITORED				
	45					
	46					
	47					
	48					
	49	PLAN SHOWING TO BE				
	50	PLAN SHOWING TO BE				
	51	RETAINED & NEW FOUL SEWER				
	52					

SITE CODE HN1160	Site Name	26 AYON GREEN, AYOT ST PETER	Sub-division	T.1.	Orientation	E-W.	TRENCH No 1.
	Length	23M	Width	0.85m	Depth	1.25m 1.15m	
	Machine Type	360° TRACKED 1.6TON	Bucket Size	0.6m x 0.3m			

Topsoil/Overburden								
Colour	10YR 4/2 DARK GREYISH BROWN	Composition	FRAGILE SANDY CLAY, RARE MODERATE RED BRICKS & THIN TIC FRAGS, CLASTS				Depth	0.2m THICK
Subsoil								
Colour	10YR 6/6 BROWNISH YELLOW	Composition	FRAGILE, STERILE, SANDY CLAY				Depth	0.15m THICK
Natural								
Colour	10YR 5/4 YELLOWISH BROWN	Composition	CLAY, STICKY & COMPACT.				Depth	> 0.8m THICK
Observations (circle)	Archaeology	Root activity	Structure	Contamination	Unstable	Mod truncation	Other:	
	Bur'd horizon	A. Burrows	Services	Flooding	Blank	Plough mark		

Sketch Plan and Section (include all dimensions, north arrow and levels; remember to annotate)

TOPSOIL HAS MODERATE ^{SUB-ANGULAR} ROUNDED FLINT TO 3CMS
~~SUBSOIL HAS RARE ROUNDED FLINT TO 3CMS~~

See plan & section 1 on sheet 1

SEE PLAN 1 FOR DIMENSIONS

MEASURED SECTION ON SHEET 1 (FORWARD)

Discussion and interpretation

TOPSOIL IS UNDATED BUT WAS PROBABLY THE GARDEN DEPOSIT IN USE WITH ~~THE~~ 1950'S BUILT 26 AYON GREEN. SUBSOIL & NATURAL ARE STERILE

Contexts	—			Signature	R. J. Danson
Finds	—			Date	28/11/2015
Plan no.	1	Photo (b/w)	<input checked="" type="checkbox"/>	Checked	
Section no.	1	Photo (colour)	<input checked="" type="checkbox"/>	Cont.	
Levelled	<input checked="" type="checkbox"/>	Located	<input checked="" type="checkbox"/>		
Weather conditions	OVERCAST				
Samples	<input checked="" type="checkbox"/>				

SITE CODE HN1160	Site Name 26 AYOT GREEN, NERTS	Sub-division	Orientation N-S	TRENCH No 2
	Length 9.5m	Width 0.6m	Depth 0.85m	
	Machine Type HAND DUG BY CAMS	Bucket Size N/A.		

Topsoil/ Overburden							
Colour 10YR 4/4 DARK YELLOWISH BROWN.	Composition FRIABLE SANDY CLAY, NO FINDS, MODERATE ROUNDED & SUB-ANGULAR FLINT TO 3CM				Depth THICKNESS 0.35m		
Subsoil							
Colour 10YR 5/4 YELLOWISH BROWN	Composition STERILE ROUNDED & SUB-ANGULAR FLINT TO 4CMS, AND GRITTY SILTY SANDS				Depth THICKNESS 0.20m		
Natural							
Colour 10YR 6/6 REDDISH YELLOW	Composition ROUNDED & SUB-ANGULAR FLINT TO 4CMS & CLAYEY SILT. SEE STICKY				Depth THICKNESS 0.30m.		
Observations (circle)	Archaeology	Root activity <input checked="" type="checkbox"/>	Structure	Contamination	Unstable	Mod truncation	Other:
	Bur'd horizon	A. Burrows	Services	Flooding	Blank <input checked="" type="checkbox"/>	Plough mark

Sketch Plan and Section (include all dimensions, north arrow and levels; remember to annotate)

SEE PLAN 3
SEE SECTION 2

Discussion and interpretation

BLANK.

Contexts	-			Signature	R. G. W. [unclear]
Finds	-			Date	4/2/15.
Plan no.	3	Photo (b/w)	<input checked="" type="checkbox"/>	Checked	
Section no.	2	Photo (colour)	<input checked="" type="checkbox"/>	Cont.	
Levelled	<input checked="" type="checkbox"/>	Located	<input checked="" type="checkbox"/>	Samples	X
Weather conditions	COLD, OVERCAST THEN BRIGHT				