

11 The Granary, Arlesey, Bedfordshire.

HN1436

Report No.1152

| | | | |
|--------------------------------------|--|-----------------------------------|--|
| Site name and address: | 11 The Granary, Arlesey, Bedfordshire. | | |
| County: | Bedfordshire | District: | Central Bedfordshire |
| Village/town: | Arlesey | Parish: | Arlesey |
| Planning reference: | CB/17/02762/FULL | NGR: | TL 1926 3606, |
| Client name and address: | Mr Paul Murtagh, 11 The Granary, Arlesey, Bedfordshire, SG15 6SH | | |
| Nature of work: | Residential Development | Present land use: | Garden |
| Site Status: | None | Reason for investigation: | Direction of local planning authority (NPPF) |
| Position in planning process: | As a condition | Project brief originator: | Local Authority |
| Size of affected area: | c.77m ² | Size of area investigated: | 18.93m ² |
| Site Code: | HN1436 | Museum reference: | BEDFM 2018.39 |
| Organisation: | Heritage Network | Site Director: | David Hillelson |
| Project type, methods etc. | Monitoring | Archive Recipient: | Higgins Museum, Bedford |
| Start of work | 23/07/2018 | Finish of work | 14/08/2018 |
| Related HER Nos: | None | Periods represented: | Modern |
| Oasis UID: | heritage1-319903 | Significant finds: | None |
| Monument types: | None | | |
| Physical archive: | None | | |
| Previous summaries/reports: | None | | |

Introduction:

In response to a planning condition the Heritage Network was commissioned by the landowner to undertake a programme of archaeological monitoring on the development groundworks at 11 The Granary, Arlesey, Bedfordshire. Planning permission for the development (CB/17/02762/FULL) was granted by Central Bedfordshire Council (CBC), subject to a standard archaeological condition issued under the provisions set out in the Department of Communities and Local Government's *National Planning Policy Framework* (NPPF). A full specification for the work carried out is contained in the Heritage Network's approved *Project Design* (Turner 2018).

The site is situated on the northern side of The Granary, a modern estate on the western side of the High Street. No. 11 is centred on NGR TL 1926 3606 (Figure 1). The site lies in the valley of the River Hiz, on ground that slopes gently to the west towards the river, which flows approximately 400m to the west. It is located within the known medieval core of Arlesey and is bordered by private residences to the north and east, by a turning head and parking to the west and by the estate access road to the south.

Fieldwork:

The proposed development entails the construction of a single storey side and rear extension to the existing building. The present investigation involved monitoring the excavation of the footing trenches for the new extension.

Footings Trenches

The trenches bounded an area of c.50.37m² and varied in length between 9m and 3.9m. They measured 0.5m in width and were excavated to a maximum depth of 1m (Figure 2).

The sections revealed a similar stratigraphy comprising layers of modern made ground varied in depth between 0.2m and over 1m (Figure 3). The made ground, which consisted of several layers of concrete, gravel, hardcore and rubble, was greater in depth on the western side of the site. These deposits directly overlay the light

yellowish brown, soft sandy clay, which was encountered in the southern trench and at the eastern side of the site at depths of between 0.2m and 0.79m below the present ground level (Plates 1 – 5).

A number of modern services were noted within the footings trenches (Plates 1 & 5).

No archaeological features, deposits or finds were encountered within the footing trenches.

Soakaway

A soakaway was excavated to the south-east of the new extension (Figure 2). It measured 1.9m in length, 1.6m in width and was excavated to a depth of 1m (Plate 6). The stratigraphy was similar to that observed in the footings trenches, comprising layers of hardcore and rubble which directly overlay the natural substrate (Figure 3). The clay was observed at 0.48m below the present ground level.

No archaeological features, deposits or finds were encountered within the soakaway.

The soakaway was backfilled immediately after excavation as it was decided to use existing services, rather than excavate new ones.

Discussion:

Late 19th and 20th century OS mapping shows that until the late 20th century the site formed part of Moorlands Farm (Old Maps 2019). It formed part of a small yard to the north of the main farmyard until the early 20th century. Between 1901 and 1922 the site was occupied by a long narrow building range which survived until the 1990s. No remains relating to the structure that formerly occupied the site were encountered during the present works, but layers of probable demolition rubble were observed at the western end of the footings trenches.

The monitoring of the development groundworks for the present project revealed a stratigraphic sequence consisting of various layers of modern overburden directly overlying the natural. It was observed that these were deeper at the western end of the site. The lack of top- and subsoils indicates that the site has been subject to significant ground reduction. Some reduction may have occurred in the early 20th century, to level the ground for the farm building, but the removal of all evidence for this structure from the site suggests that some further ground reduction was carried out when The Granary estate was built. The greater depth of made ground at the western end of the site may reflect the natural slope of the ground.

No archaeological features, deposits or finds were encountered during the course of the present investigation and no evidence for activity pre-dating the late 20th century was noted. No information was gained that could be considered to contribute to the research aims for the project, as defined in the approved Project Design.

Illustrations:

| | |
|----------|--|
| Figure 1 | Site Location |
| Figure 2 | Site Plan |
| Figure 3 | Sections |
| Plate 1 | Trench A, indicative section, looking NE |
| Plate 2 | Trench B, indicative section, looking N |
| Plate 3 | Trench C, indicative section, looking N |
| Plate 4 | Junction between Trenches D & E, looking W |
| Plate 5 | Trench E, looking W |
| Plate 6 | Soakaway, looking NW |

Bibliography

Turner, C. 2018 *11 The Granary, Arlesey, Bedfordshire: Archaeological Project Design*. Heritage Network

Old-Maps 2019 Historic Ordnance Survey mapping. Available from <https://www.old-maps.co.uk>. Accessed 16 January 2019.

Mark Sycamore BA ACIfA
December 2018

THE HERITAGE NETWORK LTD

11 The Granary, Arlesey, Beds

HN1436

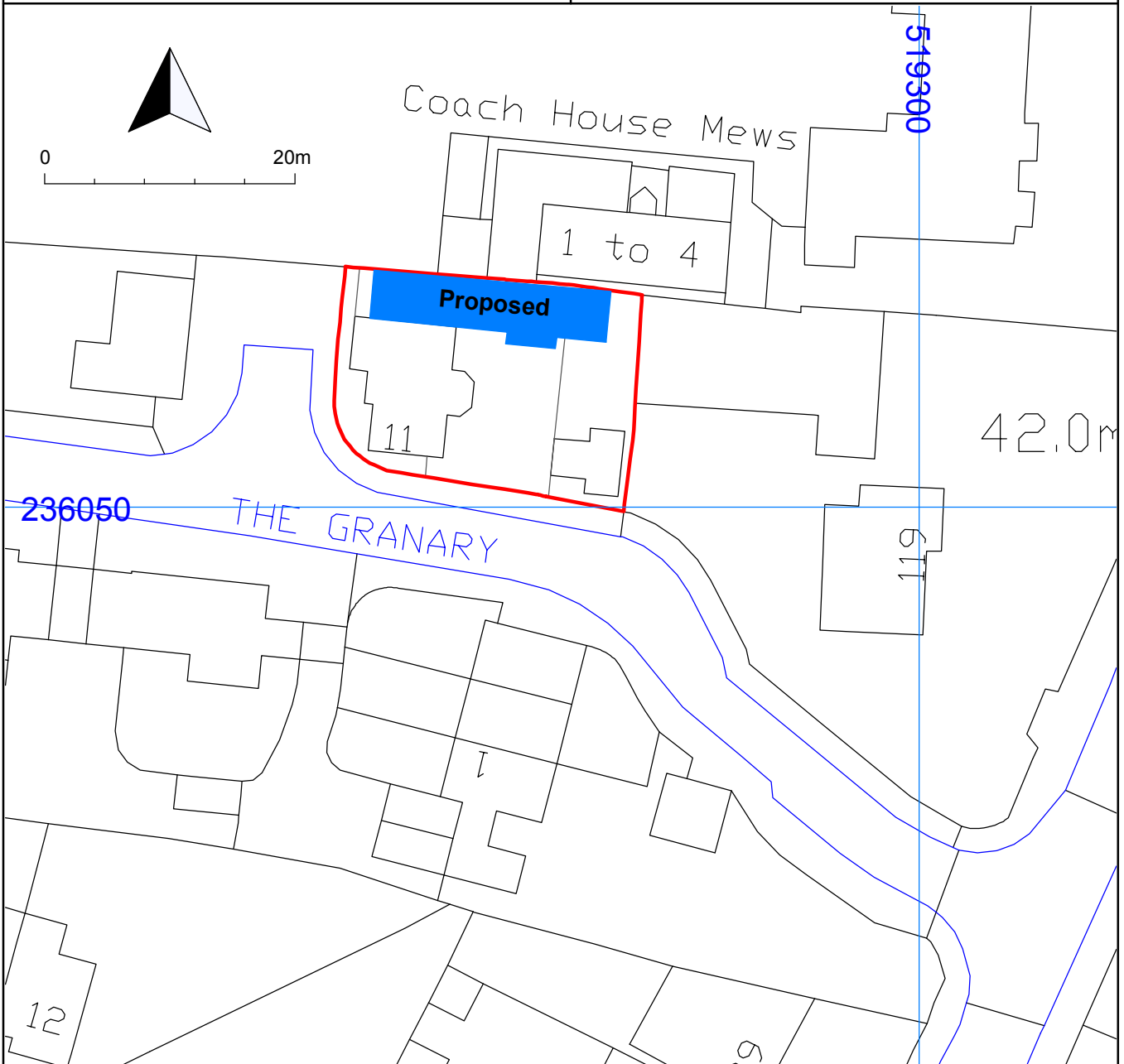
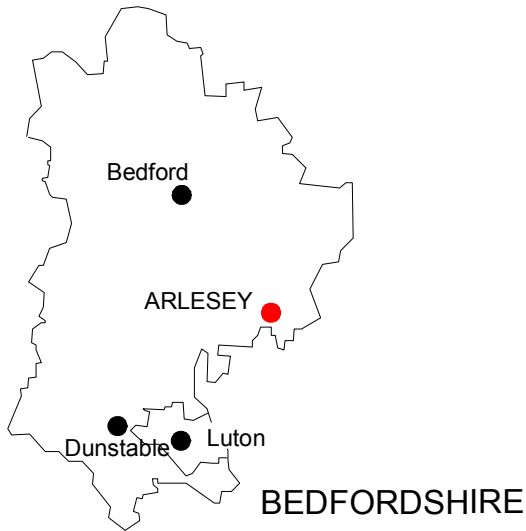

Site location and layout

Scale 1:500

Ordnance Survey (c) Crown Copyright 2017. All rights reserved. Licence number 100022432

Figure 1

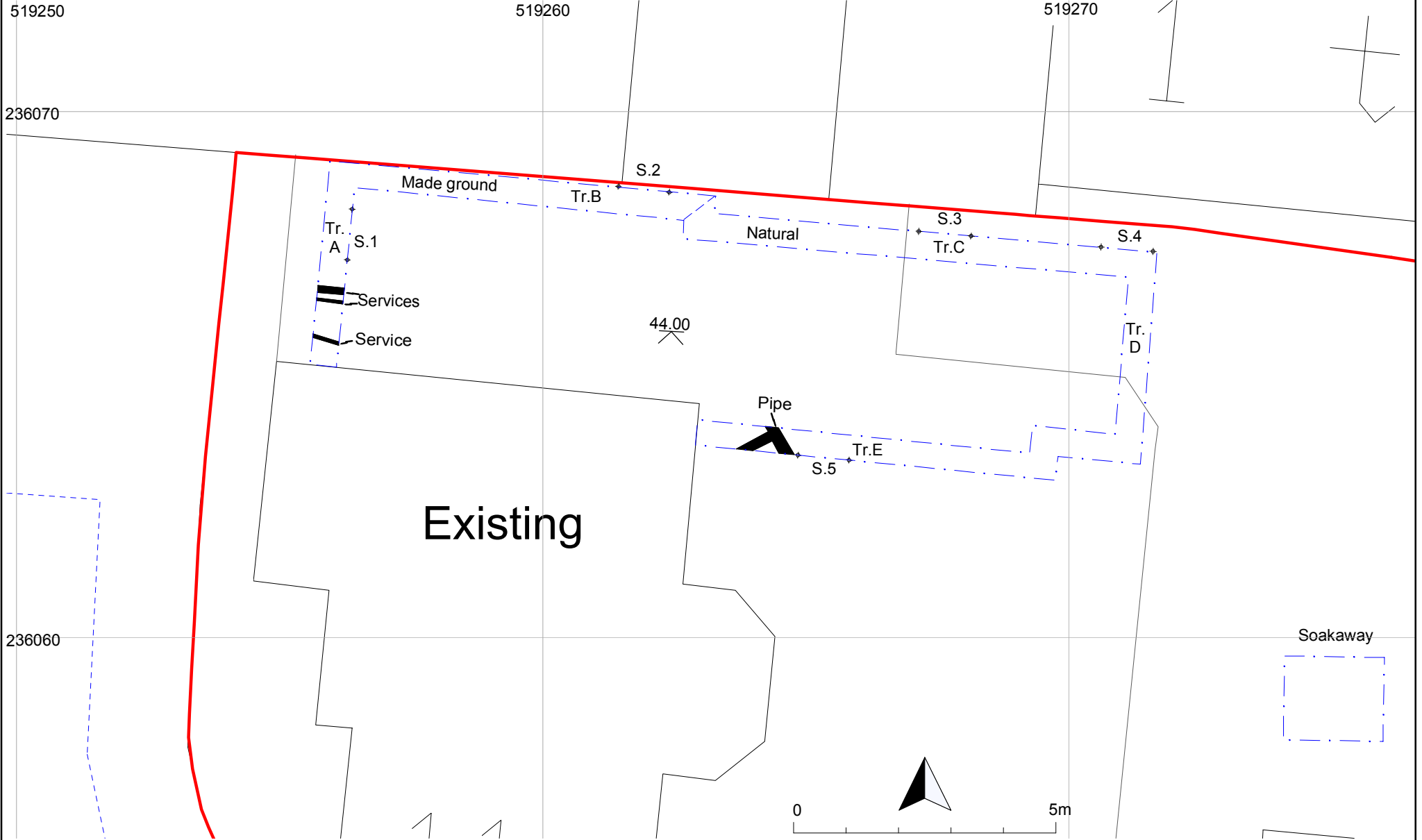

Footings Plan

Scale 1:75

Figure 2

Section 1

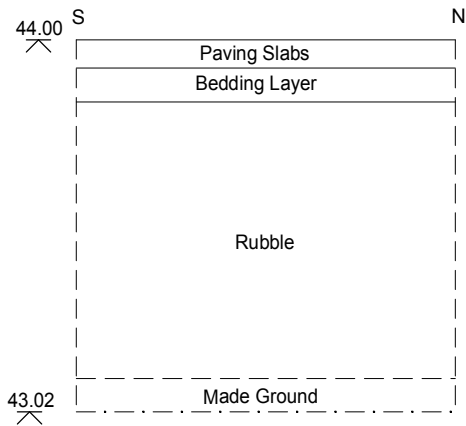

Section 2

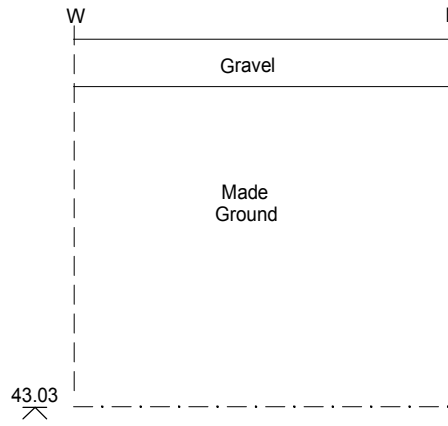

Section 3

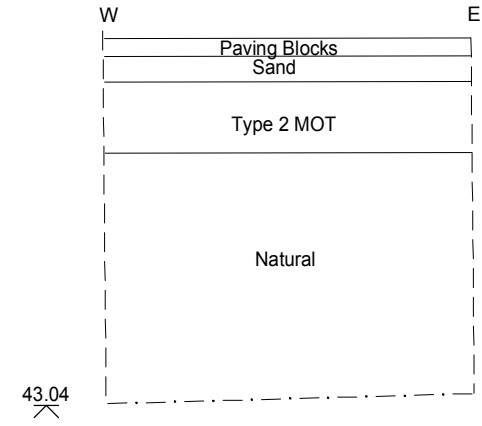

Section 4

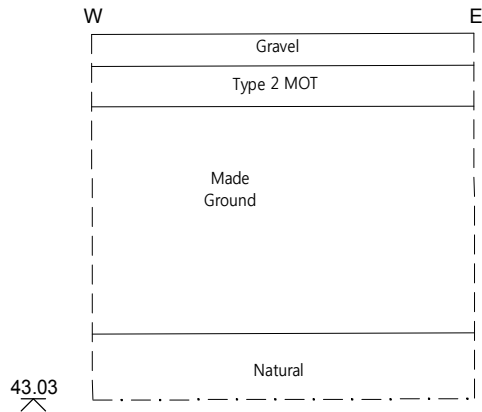

Section 5

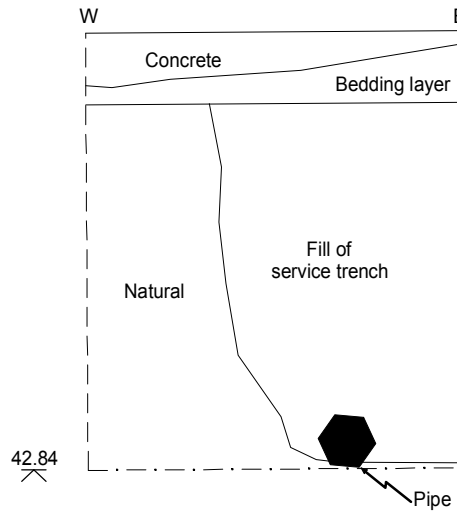

Soakaway

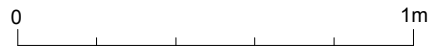
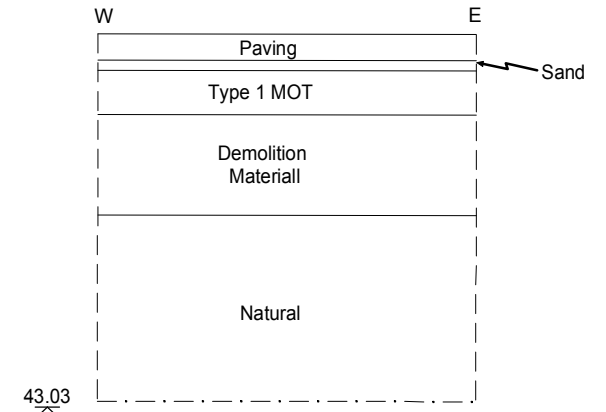

Sections

Scale 1:20

Figure 3



Plate 01 - Trench A, indicative section looking NE



Plate 02 - Trench B, indicative section, looking N



Plate 03 - Trench C, indicative section looking N



Plate 04 - Junction between Trenches D & E, looking SW



Plate 05 - Trench E, looking W



Plate 06 - Soakaway, looking NW

THE HERITAGE NETWORK LTD

Attendance Record

| | | | |
|------------|--------------------------------|------------|------|
| Site Name: | 11 THE GARDENS, MILEPOST, BRIS | HN ref: | 1436 |
| | | Site Code: | |

| | | | | | |
|--------------|---------|--------------|-------|----------------|------|
| Recorder(s): | DRP | Arrive time: | 14:00 | Return travel: | 0.5W |
| Date: | 25/7/18 | Depart time: | 16:30 | Total hours: | |

| | | | |
|-------------------|-------------------------|-----------|--|
| Reported to: | | Position: | |
| Purpose of visit: | d/r on Farmy (Milepost) | | |

| | | | |
|--------------------|---|-------------|--------|
| Photograph film no | — | | |
| Staff on site: | DRP | | |
| Observations: | ARRIVED AT 14:00 TO COMMENCE W/B ON CROUCHWOOD. PLAN TODAY IS A CONTINUATION OF STRIP RECORDING. | | |
| | PM | | |
| | STARTED MAKING ANOTHER SECTION OF TRENCH ON THE SOUTH SIDE OF SITE. MAKING REMOVED MORE OF THE SAME STRAT FOUND ON THE WEST SIDE OF SITE. TRENCH E1 - MADE PASTO - 0.2m NAT: → 1m MADE CREW - 0.9m | | |
| | THE WEST END OF TRENCH REVEALED MADE CREW, THE EAST END REVEALED NATURAL. UNFORTUNATELY DUE AT THE CHANGE A MODERN PLASTIC SERVICE HAD DESTROYED THE RELATIONSHIP. | | |
| | | Sheet | 1 of 1 |
| | Additional records: | | |
| | Text sheet(s) | | |
| | Sketch sheet(s) | | ✓ |
| | Context form(s) | | |
| | A4 Scale dwng(s) | | |
| | A3 Scale dwng(s) | | |
| Weather: | HOT | Photographs | ✓ |

| | | | |
|---------------------|--|--------------|---------|
| SITE CODE HN1436 | Site Name Arlesey 11 the Granary | Sub-division | CONTEXT |
|---------------------|--|--------------|---------|

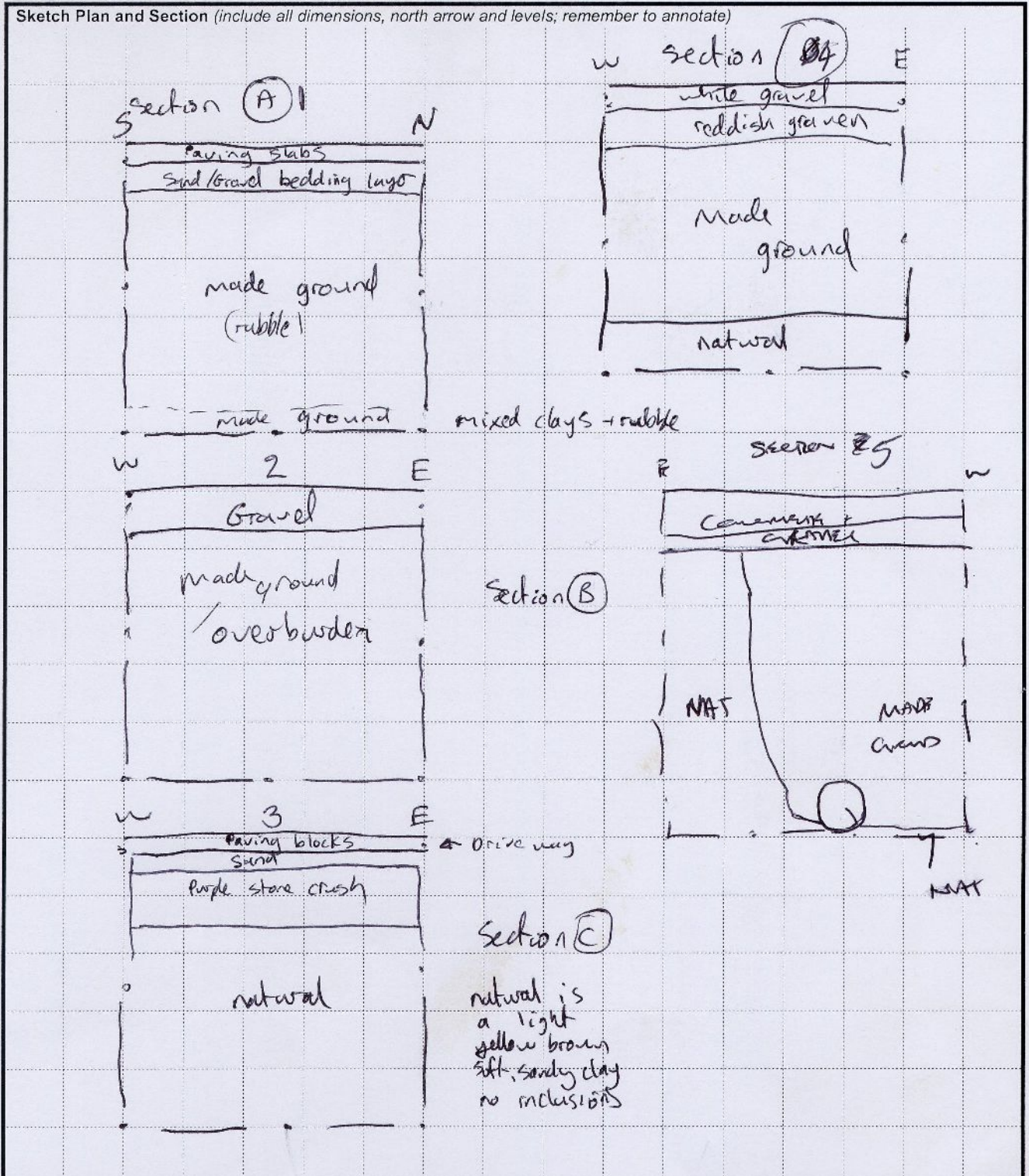

| | | | |
|-------------------------------|---------|----|--|
| Discussion and interpretation | | | |
| indicative section | | | |
| Scale | 1:20 | | |
| Signature | MS | | |
| Date | 23/7/18 | | |
| Checked | Sheet | of | |

SHEET 2

| | | | |
|---------------------|--|--------------|---------|
| SITE CODE HN1436 | Site Name Aneseey 11 The Granary | Sub-division | CONTEXT |
|---------------------|--|--------------|---------|

Sketch Plan and Section (include all dimensions, north arrow and levels; remember to annotate)

Plan #1

3.5M

Section D

NW corner of site

| | | | |
|-------------------------------|---------|----|--|
| Discussion and interpretation | | | |
| Plan: Footing trench | | | |
| Scale | 1:20 | | |
| Signature | MS | | |
| Date | 23/7/18 | | |
| Sheet | | of | |
| Checked | | | |

| | | | |
|------------------------------------|------------------------------------|--------------|---------|
| SITE CODE HN1436 HN1436 | Site Name Arlesey 11 the Grange | Sub-division | CONTEXT |
|------------------------------------|------------------------------------|--------------|---------|

Sketch Plan and Section (include all dimensions, north arrow and levels; remember to annotate)

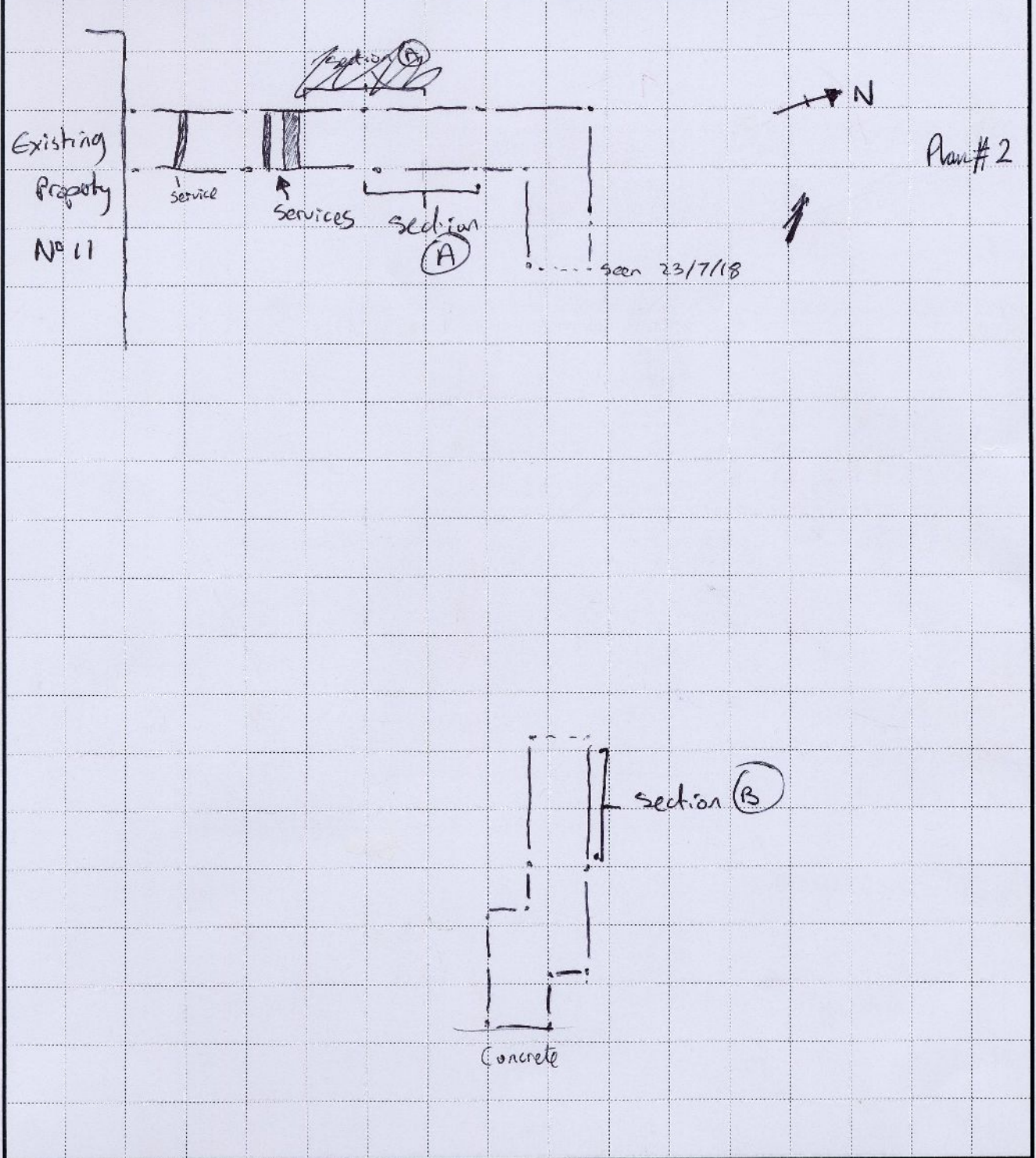

Discussion and interpretation

Plan of Footing trench

| | |
|-----------|---------|
| Scale | 1:50 |
| Signature | MS |
| Date | 23/7/18 |
| Checked | |

Sheet of

| | | | |
|---------------------|---------------------------|---|---------|
| SITE CODE HN1436 | Site Name 11 Mt Curran | Sub-division 11 Mt Curran | CONTEXT |
|---------------------|---------------------------|---|---------|

Sketch Plan and Section (include all dimensions, north arrow and levels; remember to annotate)

Plan # 3

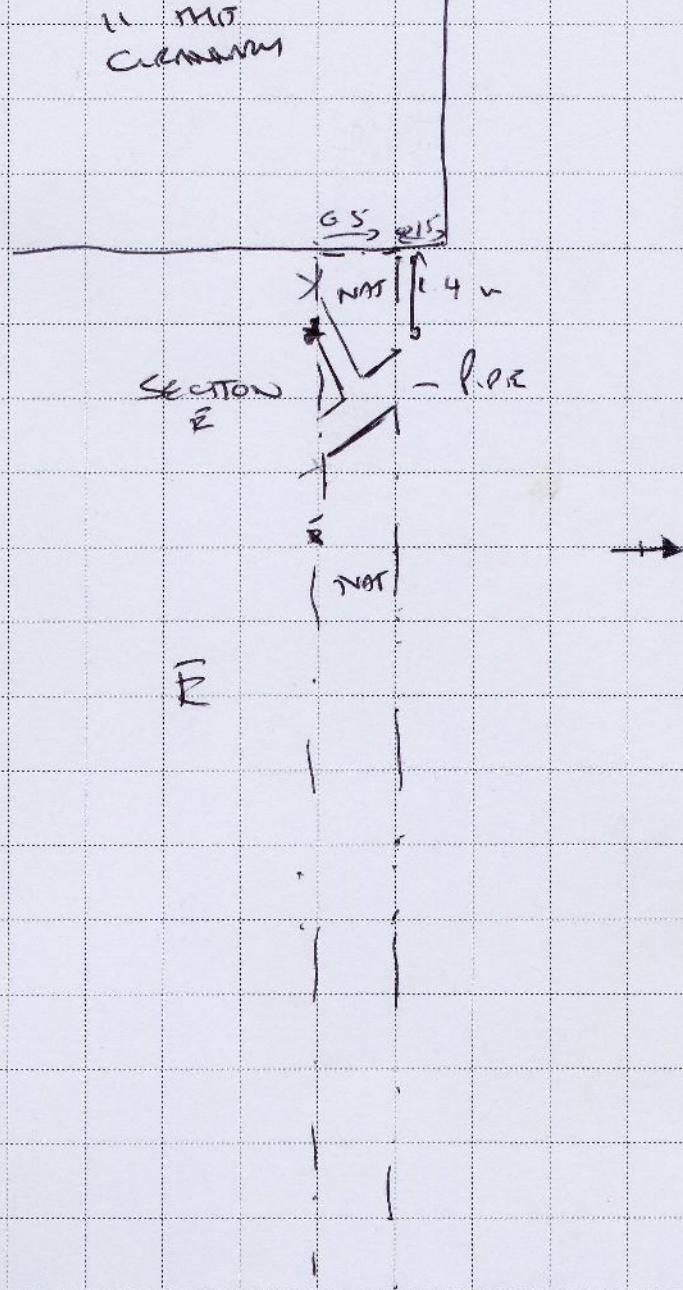

Discussion and interpretation

footing trench; south side of site

| | |
|-----------|------------|
| Scale | 1:20 |
| Signature | <i>DOB</i> |
| Date | 25/7/18 |
| Checked | |

| | | | |
|-------|---|----|---|
| Sheet | 1 | of | 1 |
|-------|---|----|---|

| | | | |
|-----------------------------|---|---------------------|----------------|
| SITE CODE HN 1436 | Site Name 11 The Granary, Arlesey | Sub-division | CONTEXT |
|-----------------------------|---|---------------------|----------------|

Sketch Plan and Section (include all dimensions, north arrow and levels; remember to annotate)

HN 1436

| | | | |
|--------|-----|-----|----------------------|
| Photos | 1+2 | L.W | trench west |
| | 3+4 | L.N | trench between C + D |
| | 5-6 | L.N | between B + C |

Section #6

Section #7

| | | | |
|--------------------------------------|---|----|-----------|
| Discussion and interpretation | | | |
| | | | Scale |
| | | | Signature |
| | | | Date |
| | | | Checked |
| Sheet | 1 | of | 1 |

THE HERITAGE NETWORK LTD

11 The Granary, Arlesey, Beds

HN1436

Plan #4

1 to

A

B

C

D

Proposed

concrete slab

E

hit concrete footing

Soakaway

Existing

11

GRANARY

20m

Site plan

Scale 1:150

Figure 2

11, The Granary, Arlesey

SHEET 7

| | | | |
|------------------------------------|---|---|---------|
| SITE CODE HN1436 HN1436 | Site Name 11, The Granary, Arlesey | Sub-division Soakaway Soakaway | CONTEXT |
|------------------------------------|---|---|---------|

Sketch Plan and Section (include all dimensions, north arrow and levels; remember to annotate)

Soakaway Section #8
 approx 1m deep 1.9m x 1.6m



Discussion and interpretation

14/11/18 MS

| | |
|-----------|----------|
| Scale | 1:20 |
| Signature | M.S. |
| Date | 26/10/18 |
| Checked | |

Sheet \ of \

Images Register

Site Code:

BEDFM2018.39

HN1436 11 The Granary, Arlesey, Beds.

| Image Ref No | Description | View | B and W Neg No | B & W Contact | Digital - Archival Master | Digital - Edited | Date Taken | Taken By | Copyright | Publications |
|--------------|--|------|-------------------|------------------|------------------------------|---------------------|---------------|----------|---------------------|-----------------------------------|
| HN1436_001 | Trench A: indicative section | E | n/a | n/a | | | 23.07.18 | MS | Heritage Network | Sycamore, M., 2018: Plate 1 |
| HN1436_004 | Trench A | SW | n/a | n/a | | | 23.07.18 | MS | Heritage Network | |
| HN1436_005 | Trench B: indicative section | N | n/a | n/a | | | 23.07.18 | MS | Heritage Network | Sycamore, M., 2018: Plate 2 |
| HN1436_007 | Trench C | N | n/a | n/a | | | 23.07.18 | MS | Heritage Network | |
| HN1436_010 | Trench D | N | n/a | n/a | | | 23.07.18 | MS | Heritage Network | |
| HN1436_011 | Trench E | W | n/a | n/a | | | 25.07.18 | DRP | Heritage Network | Sycamore, M., 2018: Plate 5 |
| HN1436_013 | Trench E continuation | S | n/a | n/a | | | 26.07.18 | MS | Heritage Network | |
| HN1436_014 | General view: working shot: Trench E continuation | E | n/a | n/a | | | 26.07.18 | MS | Heritage Network | |
| HN1436_015 | Working shot: Trench E continuation | SE | n/a | n/a | | | 26.07.18 | MS | Heritage Network | |
| HN1436_016 | General view: working shot: Trench D | E | n/a | n/a | | | 26.07.18 | MS | Heritage Network | |
| HN1436_018 | Trench C | W | n/a | n/a | | | 31.07.18 | DRP | Heritage Network | |
| HN1436_020 | Trench C: east end | N | n/a | n/a | | | 31.07.18 | DRP | Heritage Network | |
| HN1436_021 | Trench C: indicative section | N | n/a | n/a | | | 31.07.18 | DRP | Heritage Network | Sycamore, M., 2018: Plate 3 |

| | | | | | | | | | | |
|------------|---------------------------------|----|-----|-----|--|--|----------|-----|------------------|-----------------------------|
| HN1436_023 | Junction between trenches D & E | W | n/a | n/a | | | 03.08.18 | DRP | Heritage Network | |
| HN1436_024 | Junction between trenches D & E | SW | n/a | n/a | | | 03.08.18 | DRP | Heritage Network | Sycamore, M., 2018: Plate 4 |
| HN1436_026 | Soakaway | S | n/a | n/a | | | 14.11.18 | MS | Heritage Network | |
| HN1436_028 | Soakaway | NW | n/a | n/a | | | 14.11.18 | MS | Heritage Network | Sycamore, M., 2018: Plate 6 |



HN1436_021



HN1436_023



HN1436_024



HN1436_026



HN1436_028



HN1436_001



HN1436_004

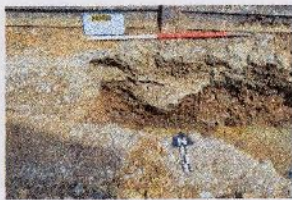

HN1436_005



HN1436_007



HN1436_010



HN1436_011



HN1436_013



HN1436_014



HN1436_015



HN1436_016



HN1436_018



HN1436_020

| Site Name / Code | | | | | | |
|--------------------------------|-------------|--------------------------------|------|----------|------|----------|
| 11 The Granary, Arlesey, Beds. | | | | | | |
| Site | Shot Number | Details | View | Date | Time | Initials |
| HN1436 | 1 | footing trench section (A) | L-E | 23/7/18 | | MS |
| | 2 | ↓ | ↓ | ↓ | | ↓ |
| | 3 | Plan footing trench | L-SW | ↓ | | ↓ |
| | 4 | ↓ | ↓ | ↓ | | ↓ |
| HN1436 | 5 | footing trench section (B) | L-N | 23/7/18 | | MS |
| | 6 | ↓ | ↓ | ↓ | | ↓ |
| | 7 | footing trench section (C) | ↓ | ↓ | | ↓ |
| HN1436 | 8 | ↓ | ↓ | ↓ | | ↓ |
| | 9 | footing trench section D | L-N | 23/7/18 | | MS |
| HN1436 | 10 | ↓ | ↓ | ↓ | | ↓ |
| | 11 | trench E not there? | L-W | 25/7/18 | PM | DP |
| | 12 | trench E - Section not there | L-S | ↓ | ↓ | ↓ |
| | 13 | trench E continuation | L-S | 26/7/18 | | MS |
| HN1436 | 14 | ↓ | ↓ | ↓ | | ↓ |
| | 15 | general site shots | L-NE | ↓ | | ↓ |
| | 16 | ↓ | L-SE | ↓ | | ↓ |
| | 17 | ↓ | L-E | ↓ | | ↓ |
| HN1436 | 18 | footing trench | L-W | 31/7/18 | r | DP |
| | 19 | ↓ | ↓ | ↓ | | ↓ |
| | 20 | d.d not come out | ↓ | ↓ | | ↓ |
| | 21 | footing trench (northern) | L-N | ↓ | | ↓ |
| | 22 | ↓ | ↓ | ↓ | | ↓ |
| HN1436 | 23 | ↓ | ↓ | ↓ | | ↓ |
| | 24 | footing trench (southern) | L-W | 3/8/18 | | DP? |
| HN1436 | 25 | ↓ | L-SW | ↓ | | ↓ |
| | 26 | soakaway | L-S | 14/11/18 | | MS |
| | 27 | ↓ | ↓ | ↓ | | ↓ |
| | 28 | ↓ | L-NW | ↓ | | ↓ |
| | 29 | ↓ | ↓ | ↓ | | ↓ |