

THE HERITAGE NETWORK LTD

Registered with the Institute of Field Archaeologists as an Archaeological Organisation
Archaeological Director: David Hillelson, BA MIFA

45-47 SOUTH STREET Bishops Stortford, Herts.

HN345

Archaeological Monitoring Report

Prepared on behalf of Danescroft Commercial Developments Ltd

by

Hannah Firth, MA

Report No.176

January 2003

© The Heritage Network Ltd

12 ROYSTON ROAD, BALDOCK, HERTS. SG7 6NT
TELEPHONE: (01462) 893288 FAX: (01462) 893562

Contents

	Summary	Page i
Section 1	Introduction	Page 1
Section 2	Fieldwork	Page 2
Section 3	Discussion	Page 3
Section 4	Schedule of Site Visits	Page 3
Section 5	Illustrations	<i>following</i> Page 3

Acknowledgements

The fieldwork and preparation of the illustrations for this project was undertaken by Karin Semmelmann. The report was edited by David Hillelson.

The Heritage Network would like to express thanks to David Lipsey, Transformation Architects; and Jonathan Smith, County Archaeology Office, Hertfordshire County Council, for their co-operation and assistance.

Summary

Site name and address:	45-47 South Street, Bishops Stortford		
County:	Hertfordshire	District:	East Hertfordshire
Village/town:	Bishops Stortford	Parish:	Bishops Stortford
Planning reference:	3/01/0307	NGR:	TL 48895 21065
Client name and address:	Danescroft Commercial Developments Ltd, 17 Cilfford Street, London, W1		
Nature of application:	Redevelopment	Present land use:	Car park
Size of application area:	1325m ²	Size of area investigated:	42.25m ²
Site Code:	HN 345	Other reference:	n/a
Organisation:	The Heritage Network	Site Director:	David Hillelson
Type of work:	Monitoring & Recording	Finds location/Museum:	Hertford Museum
Start of work:	9th October 2002	Finish of work:	9th October 2002
Related SMR Nos.:	n/a	Periods represented:	Modern
Previous summaries/reports:	n/a		

Synopsis: As the result of a condition on the planning permission for the redevelopment of a site at 45-47 South Street, Bishops Stortford, Hertfordshire, the Heritage Network was commissioned by the developers to undertake the archaeological monitoring on the groundworks.

The site lies within the core of the medieval town of Bishops Stortford, as defined by the East Hertfordshire District Plan. In the course of the project, the area affected by the development groundworks was reduced from that proposed in the original planning application, to a small area to the rear of no. 45 South Street. The excavation of two footing trenches in this location only revealed a modern dump layer. No evidence of medieval or post-medieval features was found.

1 Introduction

1.1 This report has been prepared at the request of *Danescroft Commercial Developments Ltd* as a specification for the archaeological monitoring and recording of development groundworks at 45-47 South Street, Bishops Stortford, Herts. The planning permission for the development (ref. 3/01/0307), granted by the East Hertfordshire District Council (EHDC), was subject to an archaeological condition which has been met by following the provisions set out in the *Design Brief for Archaeological Monitoring and Recording* prepared by the County Archaeology Office (CAO) of Hertfordshire County Council (ref. JS 26/11/01). The work followed the specification set out in the Heritage Network's Project Design dated March 2002.

1.2 The planning permission for the development, centred on NGR TL 48895 21058 (see Figure 1), proposed alterations to the existing building layout and the construction of an extension to the rear. In the course of the project, the area affected by the development groundworks was reduced from that originally proposed, to a small area to the rear of no. 45 South Street.

1.3 The site lies in the centre of Bishops Stortford, within *Area of Archaeological Significance* no. 114 (AAS114) as designated in the East Hertfordshire District Local Plan. This defines the core of the medieval town which was established as a borough from at least 1306. There was considered to be a possibility that Medieval and Post-medieval remains would be disturbed in the course of the groundworks for the development.

1.4 The aim of the monitoring programme has been to identify and record any archaeological features and deposits which might have been uncovered, and to retrieve artefactual and ecofactual elements which would allow date, character, and significance of the site to be assessed, subject to the limitations of reasonable safety and practicality.

1.5 The present report details the findings of the fieldwork programme and sets them in their archaeological and historical context. The report will be submitted to the planning authority and the archive will be deposited with Hertford Museum and this will complete the requirements of the planning condition.

2 Fieldwork

METHODOLOGY

2.1 Due to a change in the scope of the project, the only area of the site which required monitoring was the rear of 45 South Street.

2.2 The revised area consisted of two trenches forming a L-shape, aligned on an east-west axis immediately to the rear of 45 South Street (see Figure 2). Trench 1 measured approximately 1 metre by 6.5 metres, and trench 2 measured approximately 1 metre by 4 metres. Both trenches were dug by hand.

2.3 Archaeological monitoring of the groundworks was carried out in accordance with the requirements of the LPA Design Brief and followed the Heritage Network's approved Project Design.

MONITORING AND RECORDING

2.4 The trenches were excavated to a depth of 1.42 metres. Modern services were observed in both trenches, however no archaeological features were identified in either trench.

2.5 At a depth of approximately 0.35metres from the ground surface, a chalk layer measuring 0.08 metres was present in both trenches. This was overlying a layer of black peaty clay, this measured 0.30 metres in depth, and contained fragments of modern ceramic building material, animal bone and stone. Beneath this was a wet, brown, sandy hoggin.

2.6 No artefacts or ecofacts were recovered from either trench.

3 Discussion

3.1 The present project was initiated to investigate the possible survival of archaeological remains relating to the Medieval and Post-medieval Bishops Stortford, which is known to have been established as a borough from at least 1306.

3.2 Due to the revision of the development plans, a much reduced area was available for investigation, and while a modern dump layer was revealed, no archaeological remains dating to the medieval or post-medieval period were discovered.

4 Schedule of Site Visits

Date	Staff	Hours	Comments
09/10/02	KS	3	Inspect footing trenches

5 Illustrations

Figure 1 Site location plan

Figure 2 Trench location

THE HERITAGE NETWORK LTD

45-47 South Street,
Bishops Stortford

HN345

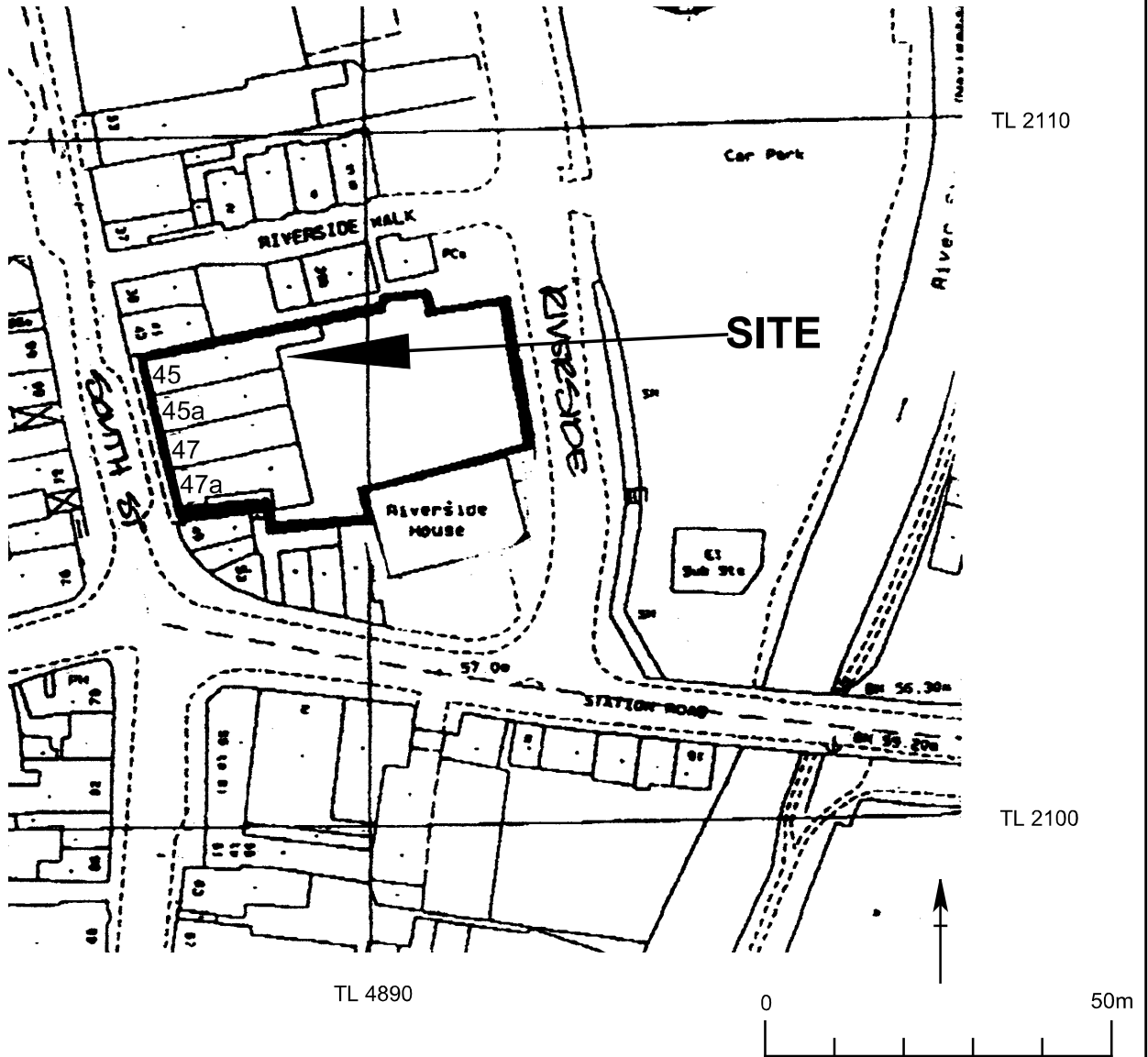
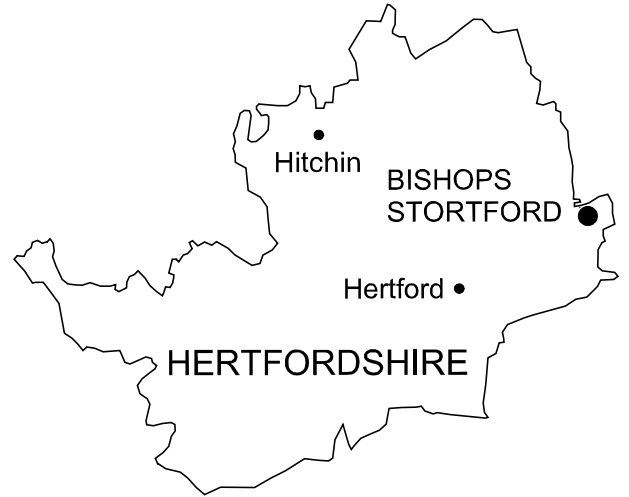
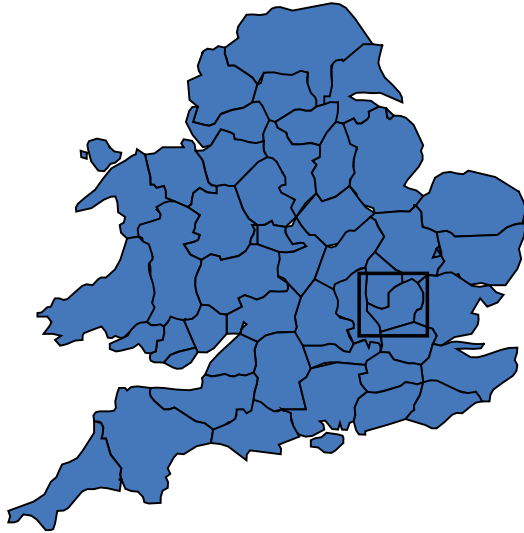

Site Location

Scale 1:1000

Plan based upon the Ordnance Survey with the sanction of the Controller of H M Stationery Office, Crown Copyright Reserved. Licence No. AL100014867

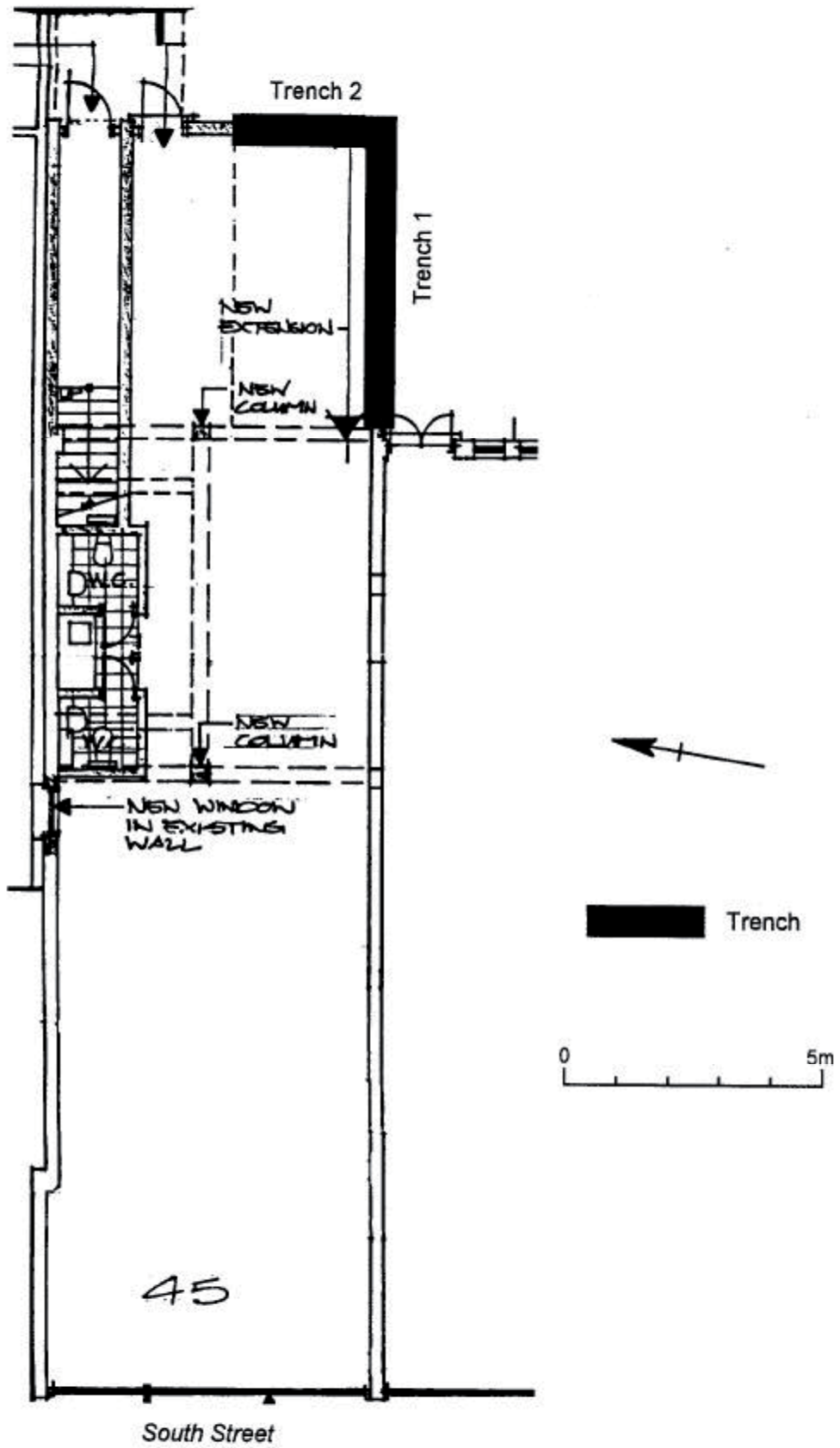

Trench location

Scale 1:125

Figure 2