

# Ambrey Archaeology Ltd

## Archaeological evaluation of land at Eastington Hall, Longdon Heath, Upton upon Severn, Worcester WSM81999

Tom Rogers

With a contribution by Rob Hedge

Version 1

Date: 9<sup>th</sup> October 2025

Planning ref. M/24/01784/HP

Event no. WSM81999

Contact: Tom Rogers, [ambreyarchtom@outlook.com](mailto:ambreyarchtom@outlook.com), 01568 780918

Ambrey Archaeology, Yarpole, Herefordshire, HR6 0BJ

## Summary

An archaeological evaluation was carried out by Ambrey Archaeology of land at Eastington Hall, Longdon Heath, Upton upon Severn, Worcestershire. It was carried out at the request of Pete Brown of Benjamin + Beauchamp Architects Ltd, whose client is applying for permission from Malvern Hills District Council for the construction of a new swimming pool at the site within a new pool building, pool plant, adjoining family room connected to an existing 17<sup>th</sup> century barn via a glazed link.

Eastington Hall is a Grade I listed, timber-frame manor house with Medieval origins that stands in substantial grounds in the south-west part of Worcestershire, around 1.8km north of Longdon and 2.5km south-west of Upton upon Severn.

A desk-based assessment of the site had identified a potential for the survival of buried deposits relating to a group of farm buildings which stood in the location of the proposed development from the early 19<sup>th</sup> century until the 1940s. A geophysical survey was also undertaken which identified the survival of buried foundations and surfaces relating to the farm buildings and a possible slurry pit.

To the north of Eastington Hall, an area of earthworks is thought to represent the location of the former Medieval settlement of Eastington. A consultee comment on the application prepared by Malvern Hills District Council confirmed that, following the requirements of current national and local planning policy, an archaeological evaluation of the site should be carried out prior to determination to assess the survival of buried remains.

The evaluation was undertaken in September 2025. Three trenches were excavated in the locations of the proposed development, currently an area of garden divided by walls and flagstone paths.

In one T-shaped trench, several foundations were present which relate to the former locations of the walls of one of the farm buildings known from a photograph to have been an open fronted single storey shed. The function of a further brick feature with an adjacent drain running at an angle to the former building is not known. It is clear from anomalies of the geophysical survey that these features extend beyond the limits of the trench.

No significant archaeological features were recorded in the two further trenches, both of which are in areas thought to have been landscaped for the creation of the garden following demolition of the buildings, one having been lowered and the other built up with made ground. Artefacts recovered from topsoil and subsoil in the trenches are post Medieval and of little significance.

No features or artefacts relating to the adjacent Medieval settlement were uncovered and it is concluded either that the settlement did not continue into this area, or that such remains were removed by the construction and demolition of the farm buildings and subsequent landscaping.

## Contents

1. Background.....	4
2. Aims .....	4
3. Site location and topography.....	5
4. Archaeological context.....	7
5. Methods.....	9
5.1 Fieldwork.....	9
5.2 Post excavation works .....	9
6. Results.....	9
6.1 Stratigraphic analysis.....	9
6.2 Assessment of Artefacts by Rob Hedge .....	11
6.2.1 Summary .....	11
6.2.2 Introduction .....	11
6.2.3 Methodology.....	11
6.2.4 Quantification.....	11
6.2.5 Analysis.....	12
6.2.6 Discussion.....	12
6.2.7 Conclusion .....	12
7. Discussion .....	13
8. Acknowledgements.....	14
9. Bibliography.....	15

Figures 4-10

Plates

Appendices

## 1. Background

This report describes the results of an archaeological evaluation carried out by Ambrey Archaeology at Eastington Hall, Longdon Heath, Upton upon Severn, Worcestershire (SO 83073 38184). It was carried out at the request of Pete Brown of Benjamin + Beauchamp Architects Ltd, whose client is applying for permission to Malvern Hills District Council (MHDC) for the construction of a new swimming pool at the site within a new pool building, pool plant, adjoining family room connected to the existing 17<sup>th</sup> century barn via a glazed link (ref. M/24/01784/HP).

Eastington Hall is a Grade I listed building containing fabric of Medieval date. A desk-based assessment of the site has been prepared (Elmwood Heritage 2024), which identified a potential for the survival of buried deposits relating to farm buildings which once stood in the area of the proposed development. A geophysical survey was also undertaken (Sumo Services 2024), which identified the survival of buried foundations and surfaces relating to the farm buildings and a possible slurry pit. To the north of Eastington Hall, an area identified as the location of the deserted Medieval settlement of Eastington which partially survives as earthworks, is recorded on the Worcestershire Historic Environment Record.

A consultee comment on the application prepared by Aidan Smyth Archaeology and Planning Advisor to MHDC confirmed that, following the requirements of current national and local planning policy, an archaeological evaluation of the site should be carried out prior to determination to assess the survival of buried remains.

A Written Scheme of Investigation (WSI) for the evaluation was submitted and approved by MDC prior to works (AA 2025).

## 2. Aims

The purpose of the evaluation (ClfA 2014) was to gain information about the archaeological resource within a given area or site (including its presence or absence, character, extent, date, integrity, state of preservation and quality), in order to make an assessment of its merit in the appropriate context, leading to one or more of the following:

- a. the formulation of a strategy to ensure the recording, preservation or management of the resource
- b. the formulation of a strategy to mitigate a threat to the archaeological resource
- c. the formulation of a proposal for further archaeological investigation within a programme of research

### 3. Site location and topography

Eastington Hall is a Grade I listed, timber-frame manor house that stands in substantial grounds in the south-west part of Worcestershire, around 1.8km north of Longdon and 2.5km south-west of Upton upon Severn (SO 83073 38184, Fig 1).

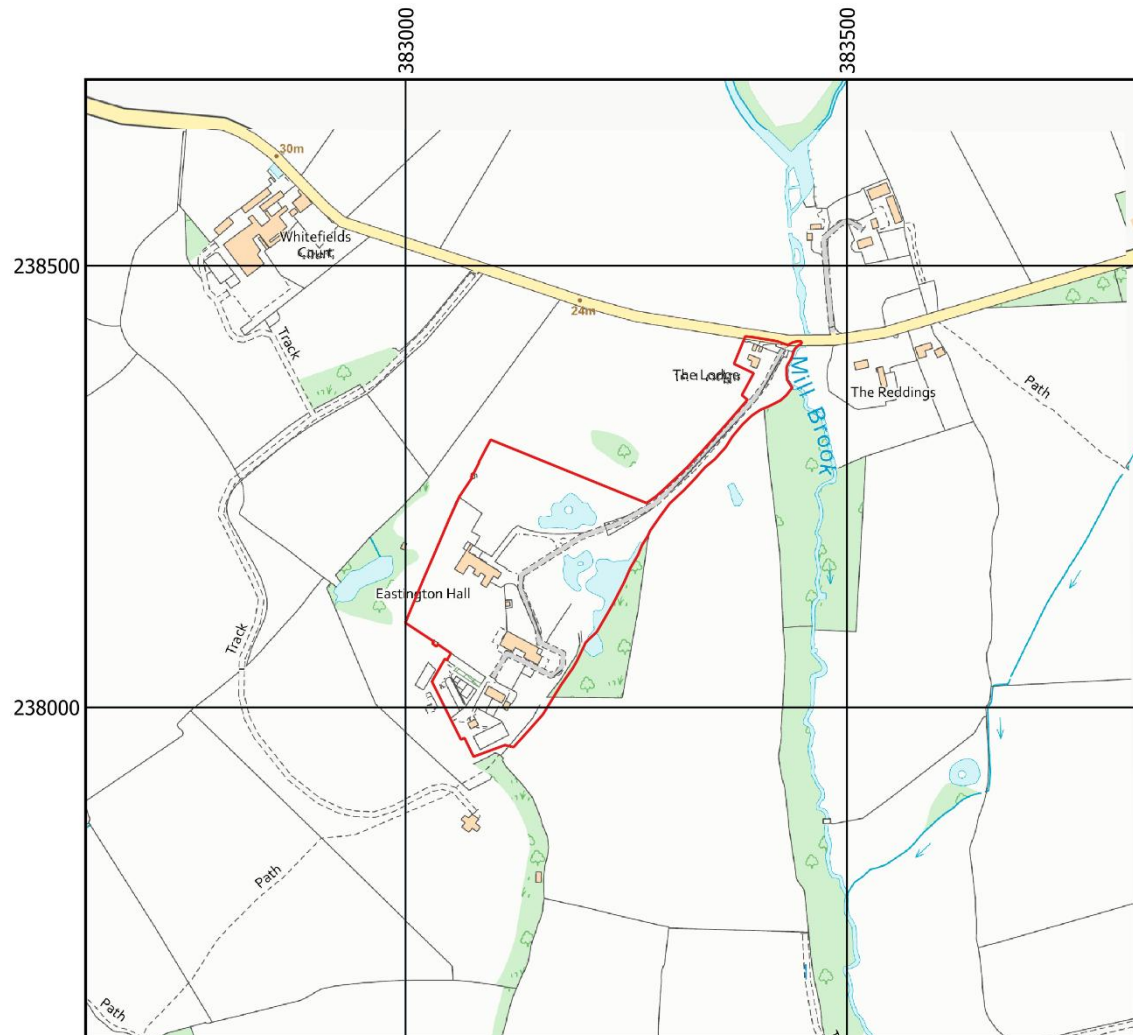
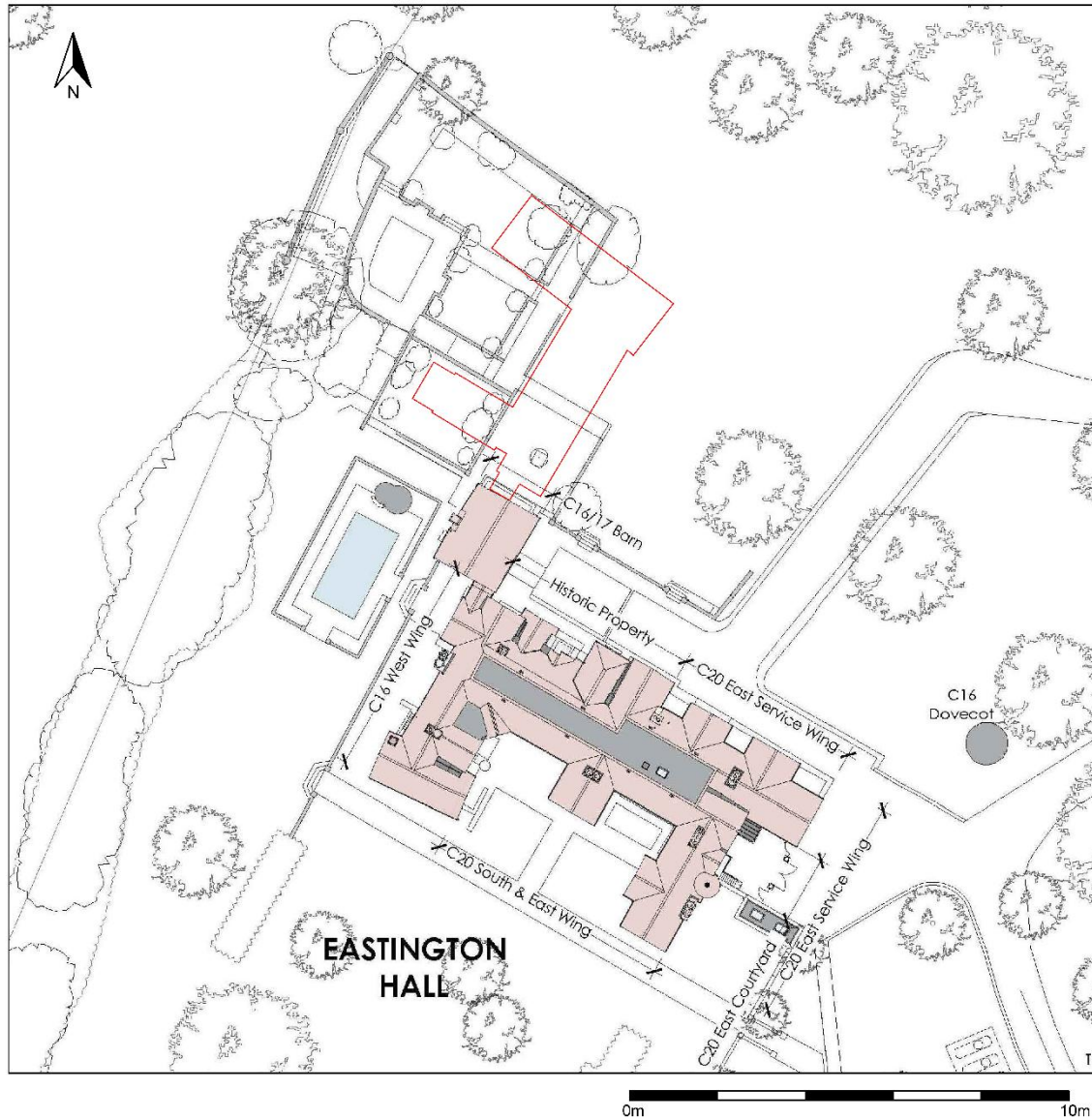

Figure 1. Site location

© Crown copyright and database rights [2025] Ordnance Survey AC0000808122

The area of the proposed development is to the north of Eastington Hall, centred on NGR SO 83073 38184 (Fig 2). Eastington Hall stands at a height of around 25.9m above sea level. The building is on the boundary of two sedimentary bedrocks, 'Arden Sandstone Formation – Siltstone and Sandstone' and 'Sidmouth Mudstone Formation – Mudstone' both of which were formed between 228 and 250 million years ago in the Triassic Period (BGS 2025).



*Figure 2. Location of the proposed development  
Based on plans provided by the client*

## 4. Archaeological context

This section is summarised from the desk-based assessment produced by Elmwood Heritage Ltd.

There is no known evidence of Prehistoric, Roman or Saxon activity on the site at Eastington Hall. Evidence surrounding the site only comes from finds reported to the Portable Antiquities Scheme (PAS).

An Iron Age ring, possibly a strap or scabbard fitting, was recovered close to the site (PAS WAW-CA37F6). Three Roman coins have also been recovered close to the Hall (PAS WAWC99CA8, WAW-C98E14, WAW-C915C3), all of 1<sup>st</sup> to 2<sup>nd</sup> century in date. Part of a Polden Hill type of Roman brooch has also been found close by (PAS WAW-F3F853).

Eastington Hall is a Grade I listed building containing fabric of Medieval date. The core of the building is a Medieval open hall of base crucks believed to date to around 1280 with a 15<sup>th</sup> century spere truss and screen (WSM00323; NHLE1238530). In Pevsner, the hall is described as '*probably the earliest base cruck example in the county*' (Brooks and Pevsner 2007, 437).

To the immediate north of the hall are areas identified as the location of the deserted Medieval settlement of Eastington (WSM00322 and WSM72080) including an area of earthworks of ridge and furrow, tracks and building platforms (WSM22065).

To the immediate south-east of Eastington Hall is a field which has been named 'Pigeon House' (WSM30920). This may relate to the 16<sup>th</sup> century dovecote which stands on it or to an earlier building of the same function. The HER record suggests that the name may be as early as Roman in date. Longdon Mill (WSM07603) was located nearby and was documented from the 13<sup>th</sup> to the 15<sup>th</sup> centuries. It probably lay on the stream to the north-east of the hall, close to Millbank Farm.

Eastington Hall was part of an extensive farmstead (WSM59953) with buildings including the timber frame barn attached to the north-west of the building (WSM00323; NHLE1238530), almost immediately south of the evaluation area. This building is described as a square framed 17<sup>th</sup> century structure although FWB Charles dated it to mid-16<sup>th</sup> century prior to its restoration in the 1980s. Charles also believed that the barn was originally a stable.

Standing to the east of the hall is a circular stone structure with a conical roof topped by a timber lantern. This is the Grade II listed 16<sup>th</sup> century dovecote (WSM02388; NHLE1238714).

A copper alloy strap fitting was found close by. The strap fitting was drop shaped and had two pins. It was dated to between 1600 and 1800 (PAS WAW-CA01A5).

Whilst it is likely that the farmstead (WSM59953) at Eastington Hall originally had earlier buildings, historic photographs show that the last buildings were more likely to be 18<sup>th</sup> century in date. The farm buildings (WSM52303 and WSM05164) were located to the north of the hall in the proposed development area and included a shelter shed (Figure 3). The buildings had been demolished by 1945.

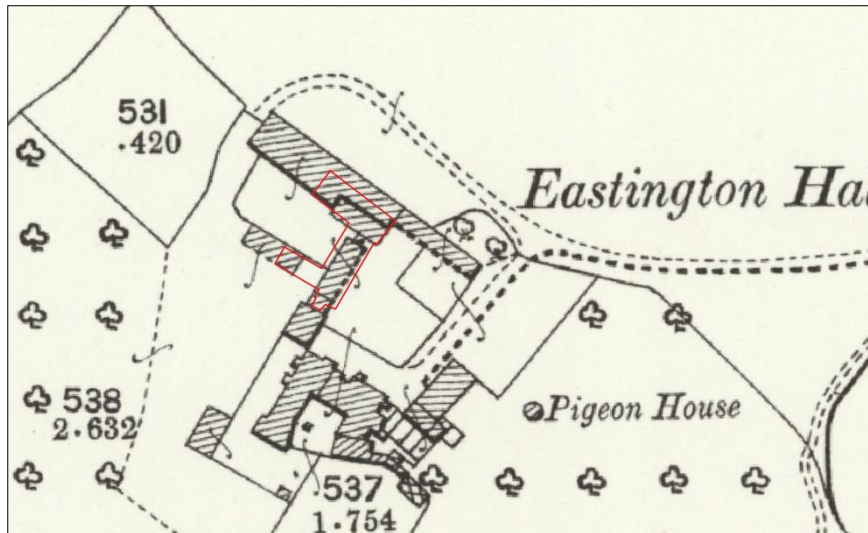

Figure 3. Extract of 2<sup>nd</sup> edition Ordnance Survey map at 25 inches to the mile scale showing location of proposed development outlined in red

On the stream, called Mill Brook, close to Millbank Farm, north-east of Eastington Hall, are an 18<sup>th</sup> century weir (WSM41031) and a footbridge (WSM41030). The weir was associated with a corn mill, Longdon Mill, which lay on the stream. The footbridge crosses the leat running from the weir and back into the stream to the south.

To the north-west and north-east of the hall lie two 19<sup>th</sup> century farms. Whitefields Court Farm (WSM52302 and WSM59952) are to the north-west with The Reddings (WSM52325, WSM59975 and WSM70802) to the north-east.

At Eastington Hall (WSM00323), a south-east wing and open loggia to the west were added in 1914-1915. The south wing is described in Pevsner as *'mostly close-studded, above a Lias ground floor ... elaborate carving and vine-trail bargeboards'* (Brooks and Pevsner 2007, 438).

In the 1920s, Radcliffe Hall wrote part of her novel *The Well of Loneliness* at Eastington Hall and during World War II, it was used as storage for some of the paintings from the Tate Gallery so that they avoided bomb damage (WSM00323).

### Geophysical survey

A Ground Penetrating Radar (GPR) survey was carried out in March 2024 in support of the current application and covered the area of the proposed development (SUMO 2024).

Potential basements were identified at the northern end of the survey area and along the western boundary. These were thought to be associated with pre-late 19<sup>th</sup> century former buildings no longer present. Some parts of the basements were thought to have been partially collapsed or backfilled. Three possible voids located close to the eastern boundary of the survey area were of uncertain origin.

Evidence of a former sunken pathway was found beneath the raised patio in the north-west of the survey area. A cluster of buried, amorphous, fragmental structures at the southern end of the patio were thought to be of more uncertain provenance.

A prominent linear feature transecting the site with a NNE/SSW orientation was thought to possibly be a footing related to a former late 19<sup>th</sup> – early 20<sup>th</sup> century building.

An extensive layer suggestive of an old floor was detected in the walled garden at the south-west end of the site, which does not coincide exactly with a former building position seen on the historical maps.

## 5. Methods

### 5.1 Fieldwork

The evaluation was carried out by Elizabeth Connolly MA ACIfA and Tom Rogers MSc MCIfA following *Standards and Guidelines for Archaeological Projects in Worcestershire*.

The field survey was undertaken on 16<sup>th</sup> and 18<sup>th</sup> September 2025 bright, mild weather. The original intention was to excavate four trenches two of which were to be 15m long and 1.6m wide and two to be 10m long and 1.6m wide. However, on inspection of the site, it was found that the area was divided by stone walls and heavy flagstone paths. Therefore, following consultation with Aidan Smyth, three trenches were excavated in more accessible areas as shown in Figures 4 and 5, at the end of the report.

Prior to excavation, the locations of the trenches were scanned using a Cable Awareness Tool to ensure that no live services were present.

Initial excavation of the trenches (removal of topsoil and subsoil) was carried out using a tracked mechanical excavator fitted with a toothless bucket and under archaeological supervision. Subsequent cleaning of the trench was undertaken by hand. Sections were excavated through a representative sample of features

Context recording was undertaken using context sheets and other pro-forma recording sheets and photographs were taken with a Nikon D3200 SLR camera. Plans and sections of trenches and features were drawn on permatrace at 1:10 and 1:50 scales and recorded by GPS.

On completion of excavation, trenches were reinstated by replacing the excavated material.

### 5.2 Post excavation works

Following excavation, all context sheets were checked and cross referenced. Survey material was downloaded and processed using QGIS 3.16 Hannover and AutoCAD LT 2023.

Provision has been made to upload the digital archive of the project via OASIS (OASIS Id: ambreyar2-537408).

## 6. Results

### 6.1 Stratigraphic analysis

**Trench 1** (Plates 1-3, Figure 6) was T shaped and situated in the location of the proposed 'shelter shed'. The longer arm was 13.5m long and orientated NE-SW meeting the centre of the shorter arm which was 8.8m long and orientated NW-SE.

Here, topsoil (101) comprised a firm mid brown clay silt with frequent charcoal flecks, present to a depth of 0.15m. This overlay (102), a compact reddish brown sandy clay with blue patches, charcoal flecking, brick fragments and frequent angular stones interpreted as made ground formed of subsoil and demolition material. This lay directly over the natural substrate (103) at a depth of 0.4m which comprised a hard reddish-brown clay with blue-grey mottling.

Several structural features were present in this trench. At the north-western end of the shorter arm {104} was a small line of unbonded blue lias stones, 0.24m wide and 0.8m long which may have been the foundation of a small wall or the edge of a demolition layer (Plate 4). Some 200mm to the south-east of this was a square structure formed of eight bricks laid flat {105} and set into the natural substrate. This also appeared to continue into the north-eastern baulk of the trench and may have represent part of a former surface or a post pad.

A further 0.9m to the south-east were two rows of mortared unshaped stones {106} interspersed with irregular lumps of concrete (Plate 5). This crossed the trench on a SW-NE alignment, was up to 0.5m wide and present in the trench for a length of 1.7m. The orientation of this structure was similar to that of the hall, barn and former buildings which stood in this location and it aligns with the north-west wall of the farm building shown in this location on Ordnance Survey maps until the 1940s.

In the central part of the longer arm of the trench, structure {107} comprised a single row of bricks laid flat end to end (header bond) bonded with lime mortar (Plate 6). The bricks were 230mm x 110m x 80mm (9" x 4" x 3") and unfroged.

At the north-eastern end of the trench, a wider brick foundation {108} crossed the trench (Plate 7). This was orientated approximately east-west and was therefore at a 45 degree angle to the other structures within the trench and the buildings which formerly stood here. It comprising two rows of bricks, one laid in stretchers and the other headers. The bricks are 230mm x 110m x 80mm (9" x 4" x 3") and unfroged, bonded with lime mortar.

On the south side of this structure, a section was excavated through a steep sided, flat-bottomed cut [111] which was 0.4m wide and 0.2m deep (Plate 8). The upper fill (109) was a firm reddish brown sandy clay with frequent cbm and charcoal flecking which lay over a rough surface formed of brick and tile fragments set into a matrix of concrete (110). Within the concrete was a square slot which appeared to have formerly housed a post. This feature was interpreted as a drain running adjacent to the wall.

On the north side of the wall a section was also excavated through a layer (112) comprising a firm reddish-brown sandy clay with frequent cbm, mortar and charcoal flecks (Plate 9). This is interpreted as a layer of made ground deposited against the wall to raise the level on this side. A large iron peg had been driven into the natural substrate below this layer.

**Trench 2** (Plate 10, Figure 7) was 6.4m long and 1.6m wide, orientated approximately east-west and situated in a patch of grass to the west of Trench 1 in the location of the proposed 'threshing barn' which will house the swimming pool. Topsoil here was a mid-brown clay silt with frequent charcoal flecks present to a depth of 0.13m. This overlay a subsoil comprising compact reddish-brown sandy clay with blue patches, charcoal flecking, brick fragments and frequent angular stones which in turn overly the natural substrate at a depth of 0.3m.

A single feature was recorded in this trench; a small sub circular pit [205] with a diameter of 0.38m and depth of 0.14m (Plate 11). It was irregular in profile with moderately sloping sides and an irregular base. It was filled with a loose, mid-brown clay silt with frequent angular stones (204) and is interpreted as a garden feature, possibly dug to plant a shrub.

**Trench 3** (Plate 12, Figure 7) was situated 30m to the south-west of Trench 1 in the location of the proposed 'cart shed' and 'machinery shed'. It was 6.7m long and orientated WNW-ESE. The topsoil

(301) was a loose dark grey-brown clay silt with frequent lumps of charcoal and cbm present to a depth of 0.3m. This overlay a deep, mixed layer of grey-brown silty clay, brick fragments and tile with frequent angular stones (302), interpreted as a made ground with demolition material (Plate 13). This in turn overlay a compact, reddish brown silty clay with frequent cbm (303) interpreted as subsoil. The natural substrate (304) was revealed at a depth of 0.8m.

## 6.2 Assessment of Artefacts by Rob Hedge

### 6.2.1 Summary

Archaeological evaluation works carried out by Ambrey Archaeology at Eastington Hall, Longdon, yielded a small assemblage of post-medieval artefacts.

### 6.2.2 Introduction

This assessment aims to quantify, spot-date and sort artefacts according to type, to describe their range and significance, and to make recommendations for further analysis.

The project conforms to standards and guidance issued by the Chartered Institute for Archaeologists (CIfA 2014) and CIfA's Toolkit for Specialist Reporting (2022), as well as further guidance on analysis, archive creation and museum deposition created by the Archaeological Archives Forum (AAF 2011), and the Society of Museum Archaeologists (SMA 1993, 2020).

### 6.2.3 Methodology

All hand-retrieved finds were examined. They were identified, quantified and dated to period. A *terminus post quem* date was produced for each stratified context. This date was used for determining the broad date of phases defined for the site. All information was recorded digitally.

The pottery was examined under x20 magnification and referenced as appropriate by fabric type and form. Where possible, sherds have been classified according to the Worcestershire county type series (WAAS 2017).

### 6.2.4 Quantification

The assemblage comprised 14 artefacts weighing 458g.

<b>material</b>	<b>object type</b>	<b>count</b>	<b>weight(g)</b>
ceramic	brick	3	258
	brick/tile	2	81
	floor/wall tile	1	27
	pot	4	45
glass	vessel	1	21
iron	nail	1	19
shell	oyster	2	7
<b>Grand Total</b>		<b>14</b>	<b>458</b>

Table 1: Quantification

The condition of the artefacts was variable: pottery sherds were small but showed little signs of abrasion, and ceramic building material was typical of demolition debris subject to relatively little post-depositional disturbance.

<i>period</i>	<i>fabric group</i>	<i>fabric number</i>	<b>count</b>	<b>weight (g)</b>
later post-medieval / modern	Late stoneware	81.4	1	22
	Porcelain	83	1	6
	Unglazed redware	78	2	17
<b>Grand Total</b>			<b>4</b>	<b>45</b>

Table 2: ceramic fabric types

### 6.2.5 Analysis

<b>Context</b>	<b>object type</b>	<b>start date</b>	<b>end date</b>	<b>count</b>	<b>weight (g)</b>	<b>TPQ date range</b>
<b>102</b>	brick	1800	1950	2	82	<b>AD 1850 - 1950</b>
	brick/tile	1600	1900	1	25	
	pot	1850	1950	1	22	
<b>302</b>	brick	1700	1900	1	176	<b>AD 1850 - 1950</b>
	brick/tile	1600	1900	1	56	
	floor/wall tile	1800	1950	1	27	
	nail	1800	1950	1	19	
	oyster			2	7d	
	pot	1800	1950	3	23	
	vessel	1850	1950	1	21	

Table 3: Context dating

### 6.2.6 Discussion

Subsoil deposit (102) contained small quantities of 19<sup>th</sup> or early 20<sup>th</sup> century brick, a piece of undiagnostic post-medieval brick or tile, and a single sherd of glazed stoneware (fabric 81.4) of mid-19<sup>th</sup> to mid-20<sup>th</sup> century date.

Deposit (302) contained mixed ceramic building material. Diagnostic pieces included a fragment of brick of 18<sup>th</sup>/19<sup>th</sup> century date, and a 19<sup>th</sup> or early 20<sup>th</sup> century tile. Pottery was limited to two sherds of unglazed redware and a piece of plain porcelain, both of 19<sup>th</sup> or early 20<sup>th</sup> century date. Other artefacts included an iron nail, a fragment of a mid-19<sup>th</sup> to mid-20<sup>th</sup> century glass bottle, and two pieces of oyster shell.

### 6.2.7 Conclusion

This is a small assemblage and is largely later post-medieval in date. There are no finds that appear to pertain to the medieval origins of the hall. Nor are there any artefacts that can be linked to the nearby medieval settlement. The artefacts are consistent with domestic occupation of the site from the 17<sup>th</sup> to mid-20<sup>th</sup> century, and demolition rubble from associated structures.

The assemblage is not sufficiently large to warrant further analysis but should be taken into consideration if further work is undertaken on the site. It is not considered a high priority for accession by Museums Worcestershire although the final decision rests with the Museum's curator.

## 7. Discussion

The evaluation uncovered the remains of farm buildings which formerly stood in this location but no earlier features or artefacts. Map evidence (Elmwood Heritage, figures 3 and 4) suggests that the buildings were late 18<sup>th</sup> or early 19<sup>th</sup> century in date. They are probably part of a cluster shown on the Ordnance Survey drawing of 1812 and the 1831 one inch maps although the layouts show more a generic depiction of a collection of buildings than an accurate survey.

However, it is clear that, by the time of the compilation of the 1840 tithe map of the parish of Longdon, an L-shaped range stood in this location with a SW-NE orientated wing projecting from the north-east wall of the timber framed barn which survives and is joined to the hall. This wing was joined at the NE end by a NW-SE orientated wing projecting to the north-west.

At some point prior to 1885, a further wing was added to the projecting to the south-east, forming a courtyard or farmyard in front of the hall and by 1904 a smaller wing projected to the north-west in the location of the proposed 'cart shed'. By 1928 the farmyard appears to have been formalised into a driveway enclosing a square with a central structure, slightly floral in plan, possibly a fountain.

The 25 inch edition Ordnance Survey map of 1904 (Figure 8) depicts the walls of the buildings fronting the farmyard with dotted lines indicating that these were open fronted, probably shelter sheds or cart sheds. A photograph of circa 1910 reproduced as Plate 14 shows an open fronted building abutting the barn with a relatively steep gable roof which appears to be tiled, the ridge line of which is approximately at the height of the gables of the barn.

The buildings are shown on a Land Utilisation Survey map of 1942 but a 1945 RAF aerial photograph of the site shows them demolished apart from the wall to the north-east which still stands.

Subsequent to this, it is clear that landscaping was undertaken, and some elements of the former buildings were re-used to create an area of formal gardens comprising small lawns divided by low walls and flagstone paths while north-eastern wall of the northern building was retained forming a boundary to this section of the grounds.

Figures 8 and 9 demonstrate that the north-western wall of the building abutting the barn aligns with stone foundation {106} which crossed the southern part of Trench 1, and it is clear from the geophysical report that it continues both to the north-east and south-west (Linear feature I in the SUMO report). No south-eastern wall was present, presumably because the building was open fronted. There are some squarish anomalies shown on the geophysical survey labelled as structural remnants of uncertain origin which might represent the post pads of pillars.

The blue lias stones {104} and brick structure {105} to the north-west of {108} may represent elements of a rectangular extension (probably a lean-to) built on against the rear wall of the shelter shed which is not depicted on the 1904 Ordnance Survey but has been constructed by 1928.

Brick footing {107} aligns with the southern edge of the northern building which was separated by a passage from the building to the south in 1904 but had been joined by 1928.

Wall {108} is enigmatic as it does not align with the rest of the structures or the buildings depicted on the map. The bricks, however, had the same dimensions as other bricks recorded within the trench and the feature was much at the same level so it is possible that this feature was contemporary with the barns, perhaps an internal division with an adjacent drain [111]. To the north of this was a layer of made ground and the natural substrate was lower on this side possibly reflecting the removal of an internal surface.

Apart from a small pit [205] thought to be a garden feature, no features were uncovered in Trench 2 including the southern wall of the NW-SE wing which might have been expected to cross the south-western end of the trench.

It is notable, however, that the current ground surface in this area is about 400mm below that in the area of Trench 1, and it is considered likely that this area was lowered following demolition of the buildings as part of landscaping for the garden which would have removed foundations in this area.

Conversely in Trench 3, where the current ground level is higher, there was a thick layer of made ground (302) mixed with building materials and patches of clay which is probably a result of this area being deliberately elevated also as part of garden landscaping. No trace survived here of the wing which is shown projecting in this direction on the 1904 map but had been removed by 1928.

To some degree, the results of the evaluation (Figure 10) tally with those of the geophysical survey in that the structural features found were mostly recorded as anomalies, apart from narrow brick footing (107). There were, however, other anomalies which were not present including several voids which were thought to represent backfilled basements. No remains of former floor surfaces or present with the possible exception of {105}. It is probable that the many flagstones forming paths and terraces in the vicinity are re-used from the farm buildings.

No features or artefacts of Medieval date were recorded despite the proximity of well-preserved earthworks in the field to the north of the garden. It is noted by Elmwood Heritage, however, that the settlement earthworks appear to have been largely contained within an earthwork holloway which performs a loop from the road to the north, to the hall and back to the road, the eastern section being the driveway. It is notable that the field to the west of the garden, in which earthwork house platforms are visible, is considerably lower than the area evaluated and it is considered likely that the hall occupied the higher ground in the Medieval period.

## 8. Acknowledgements

Ambrey Archaeology would like to thank the following for their assistance in completing this project; Pete Brown of Benjamin + Beauchamp Architects Ltd for commissioning the project on behalf of their clients, Dave Griffiths for supplying welfare facilities and plant and Aidan Smyth of Malvern Hills District Council for monitoring the works.

## 9. Bibliography

AAF, 2011 Archaeological archives: a guide to the best practice in the creation, compilation, transfer and curation. Available at <http://www.archaeologyuk.org/archives/>

Ambrey Archaeology 2025, *Written Scheme of Investigation for an archaeological evaluation at Eastington Hall, Longdon Heath, Upton upon Severn, Worcester* unpublished document

Chartered Institute for Archaeologists 2023a *Standard for Archaeological Field Evaluation*

Chartered Institute for Archaeologists 2023b *Universal Guidance for Archaeological Field Evaluation*

Chartered Institute for Archaeologists, 2014 Standard and guidance for the collection, documentation, conservation and research of archaeological materials. Available at <https://archaeologists.net/sites/default/files/2023-11/CIfA-SandG-Archaeological-Materials-2020.pdf>

CIfA, 2022 Toolkit for Specialist Reporting, <https://www.archaeologists.net/reporting-toolkit/checklist>

Elmwood Heritage 2024 *Desk-based assessment; Eastington Hall, Longdon Heath, Upton upon Severn* unpublished document ref: EH2311-2

SUMO Geosurveys 2024 *Geophysical Survey report; Eastington Hall, Longdon Heath, Worcestershire* unpublished report no 15258d

WAAS 2017 Worcestershire Ceramics Online Database. Available: <https://www.worcestershireceramics.org/>

Worcestershire Archive and Archaeology Service (WAAS) 2024 *Standards and Guidelines for Archaeological Projects in Worcestershire*

Figures 4-10

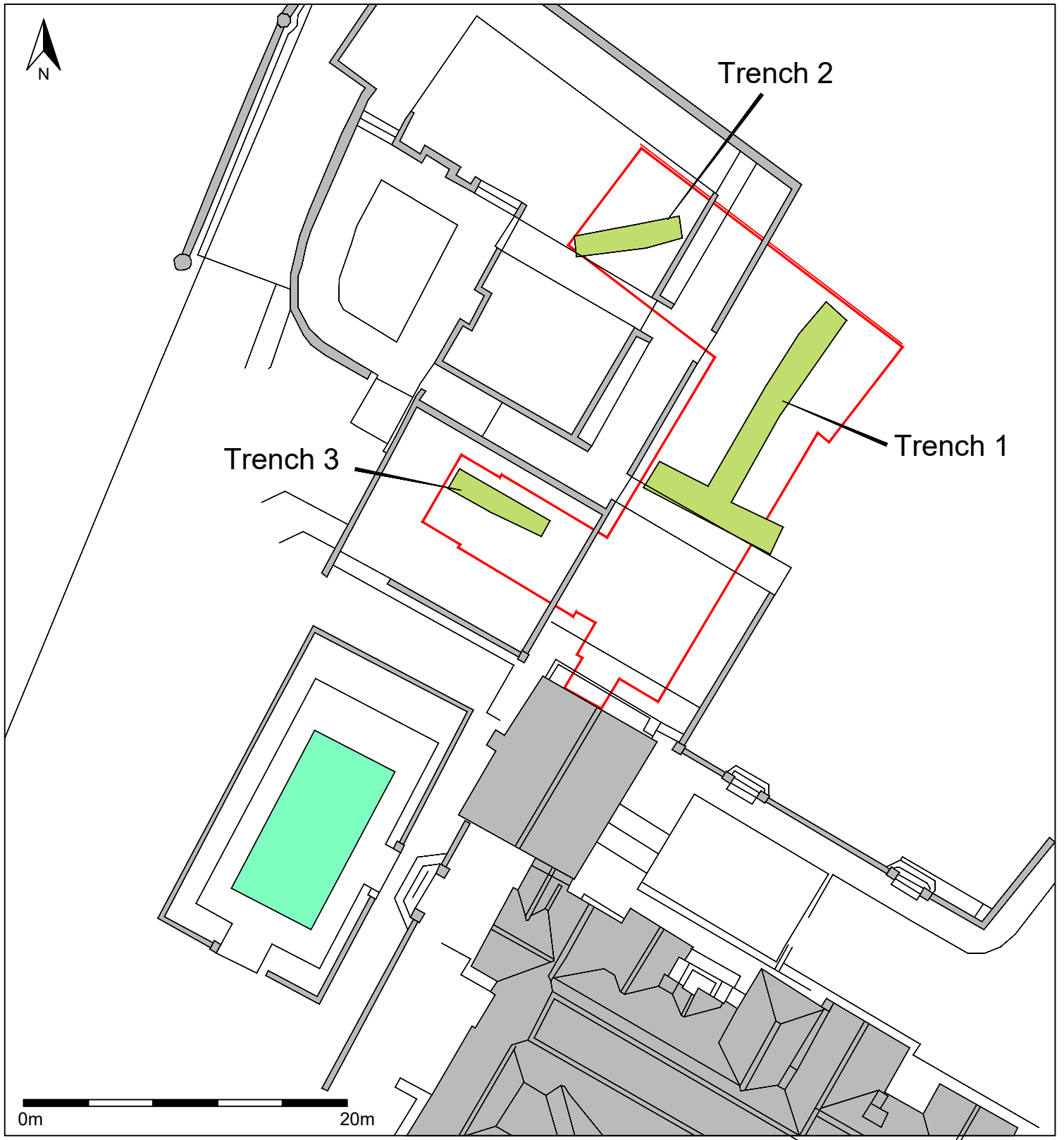

Figure 4. Trench locations

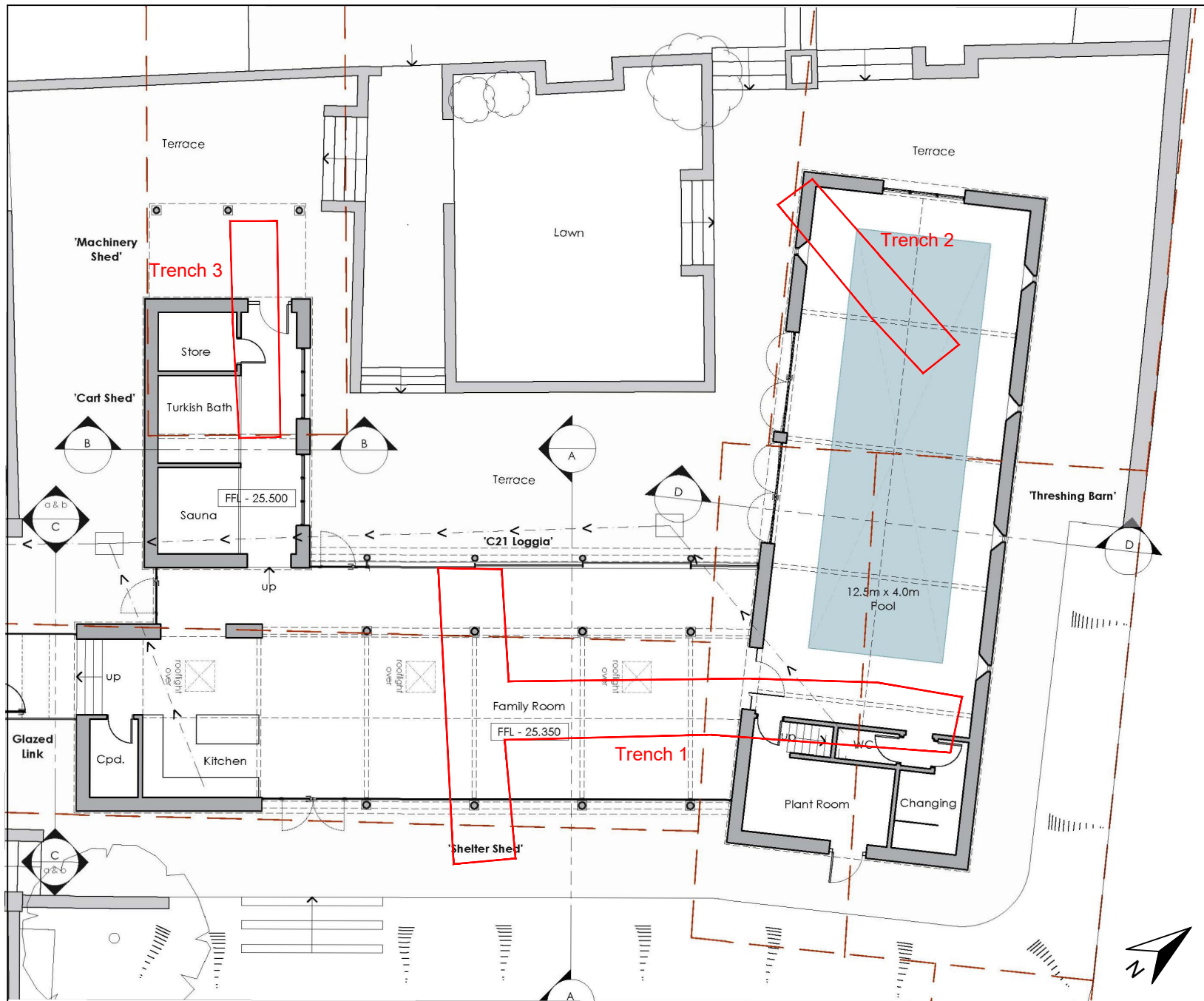

Figure 5. Trench locations in relation to proposed development

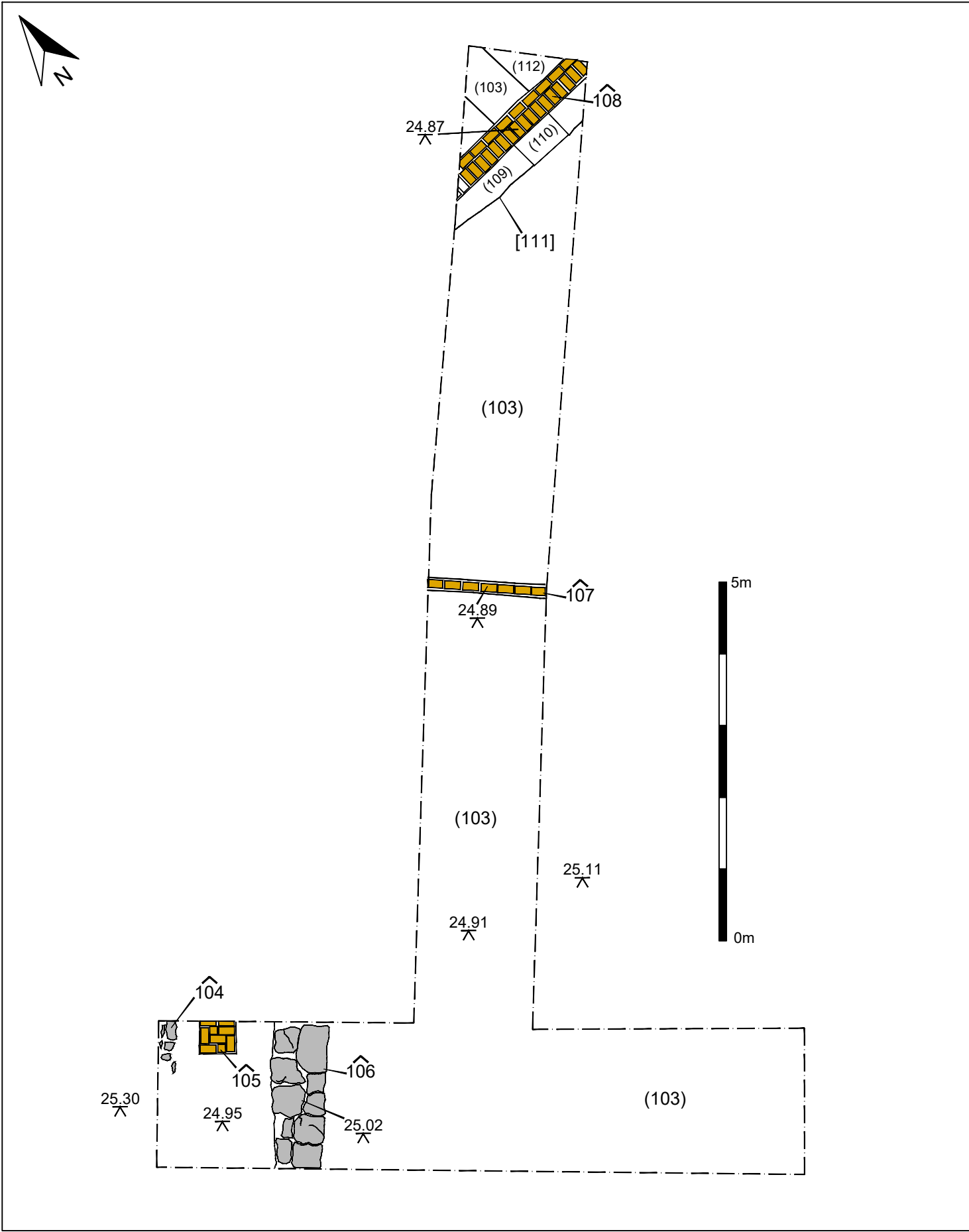

Figure 6. Plan of Trench 1

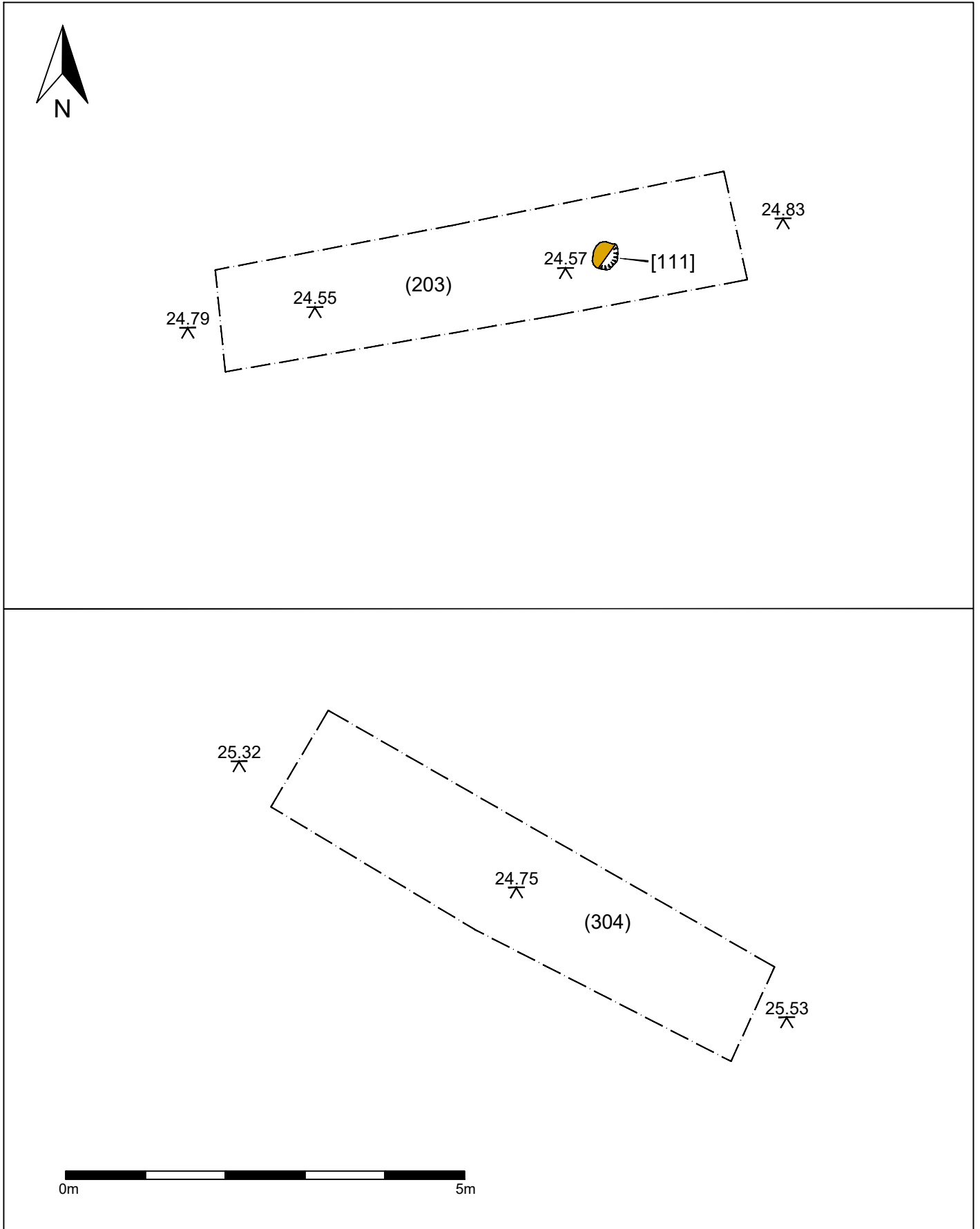

Figure 7. Plan of Trenches 2 and 3

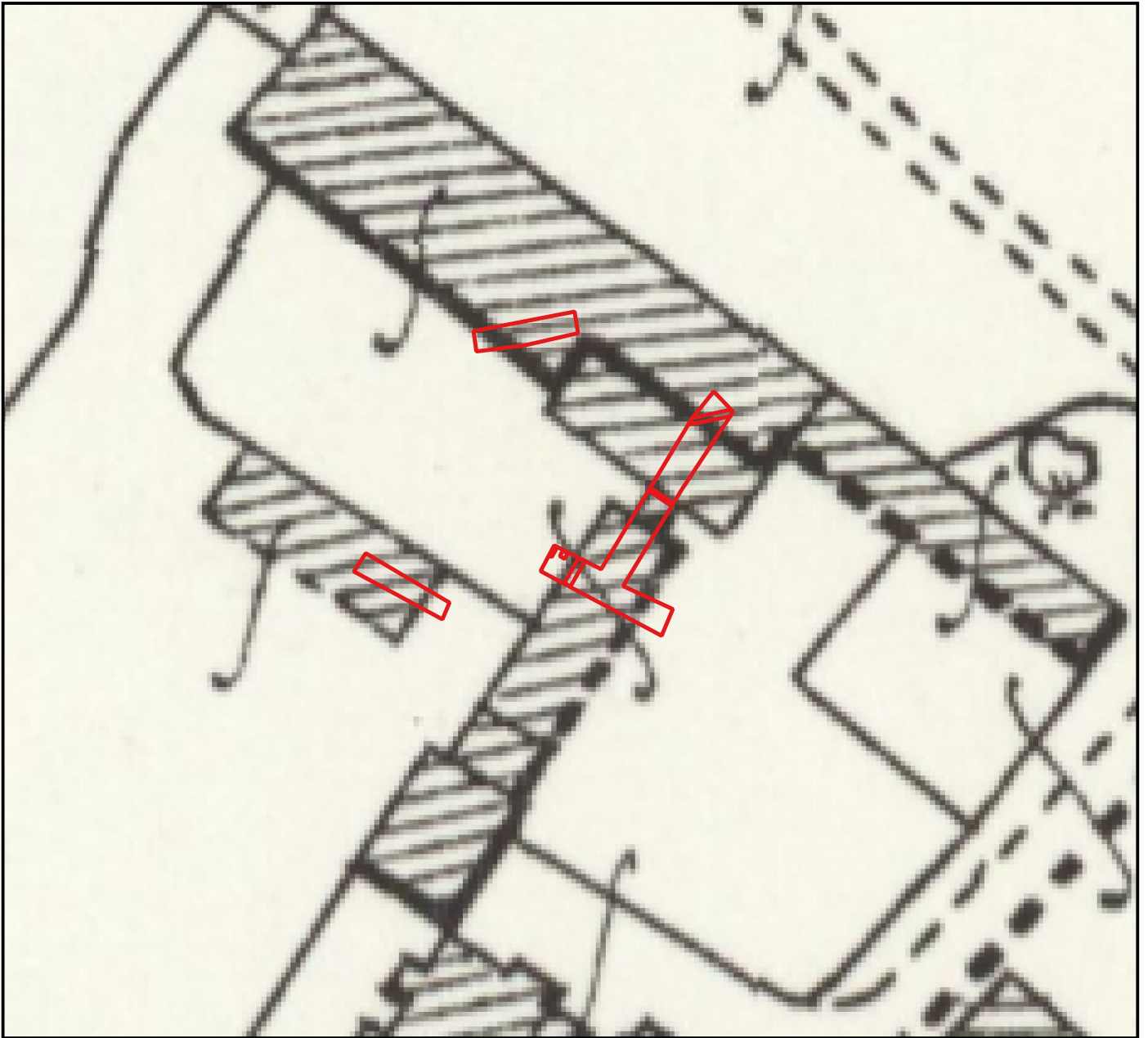
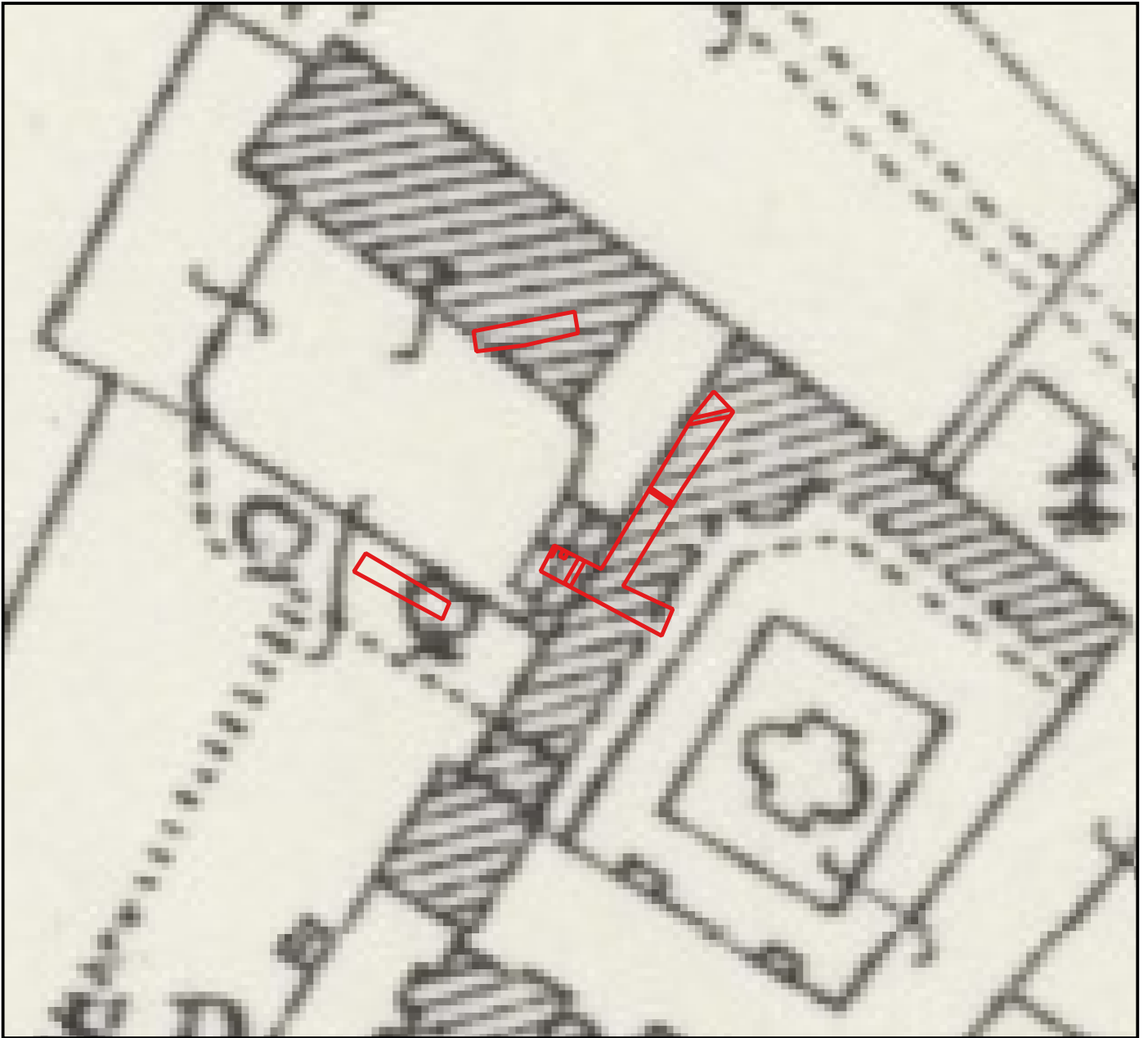

Figure 8. Trench locations laid over 1904 25 inch Ordnance Survey map



*Figure 9. Trench locations laid over 1928 25 inch Ordnance Survey map*

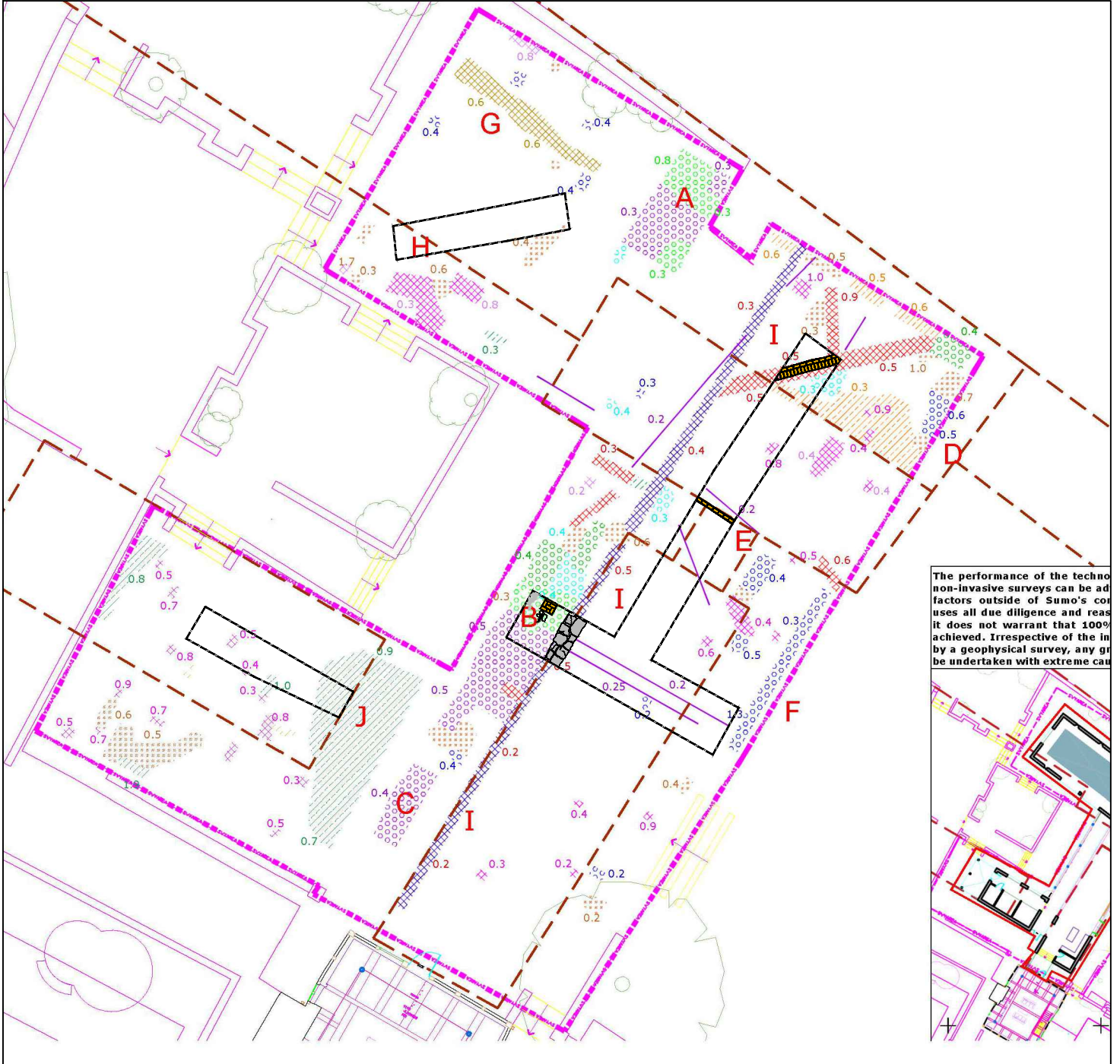

Figure 10. Trenches overlaid on geophysical survey interpretation diagram

## Plates



*Plate 1. Low level aerial view of Trench 1 in relation to Eastington Hall, view south-west*

*Plate 2. Longer Arm of Trench 1, view SSW*





*Plate 3. Shorter arm of Trench 1, view south-east*



*Plate 4. Structures {104} and {105} in north western end of shorter arm of Trench 1, scales 0.4m and 0.5m*

*Plate 5. Wall foundation {106}, view north-east, scales 0.4m and 0.5m*



*Plate 6. Foundation {107}, view north, scale 0.5m*

*Plate 7. Brick structure {108},  
view west, scale 0.5m*



*Plate 8. Cut [111] with layer (110) exposed at the base, view north, scales 0.2m  
and 0.4m*



*Plate 9. Brick structure {108} with section excavated through layer (112), scale 0.4m*



*Plate 10. Trench 2, view east*



*Plate 11. Pit [111] view north-west, scale 0.2m*



*Plate 12. Trench3, view south-east*



*Plate 13. South-west facing baulk of Trench 3*



*Plate 14. C. 1910 Photograph of Eastington Hall showing open fronted shed, demolished in the 1940s.*

## Appendix 1 Context descriptions

**Trench 1:** Length: 13.5m (NE-SW) and 8.8m NW-SE); Width: 1.8m; Maximum depth: 0.4m

Context	Depth	Description	Interpretation
101	0.0 – 0.15m	Firm mid brown clay silt with frequent charcoal flecks	Topsoil
102	0.15-0.4m	Compact reddish brown sandy clay with blue patches, charcoal flecking, brick fragments and frequent angular stones	Subsoil/made ground
103	0.4m+	Hard reddish brown clay with blue-grey mottling	Natural substrate
104	0.3m +	Small line of unbonded blue lias stones, 0.24m wide and 0.8m long.	Possible section of structure
105	0.4m +	Square structure formed of eight bricks laid flat	Possible post pad or end of wall
106	0.3m +	Two rows of mortared unshaped stones crossing the trench on a SW-NE alignment interspersed with irregular lumps of concrete. Up to 0.5m wide and present in trench for length of 1.7m.  Lies directly over (103). Stones a combination of limestone and Blue Lias, largest of which is 0.38m x 0.3m x 0.14m	Base of wall or foundation for former agricultural building.
107	0.2m +	Row of bricks laid flat end to end (header bond) bonded with lime mortar. Bricks are 230mm x 110mm x 80mm (9" x 4" x 3") and unfrogged	Base of former brick wall
108	0.18m +	Brick foundation running east-west across northern end of Trench 1, 0.36m wide comprising two rows of bricks, one laid in stretchers and the other headers.  Bricks are 230mm x 110mm x 80mm (9" x 4" x 3") and unfrogged, bonded with lime mortar	Probable wall footing
109		Firm reddish brown sandy clay with frequent cbm and charcoal flecking	Upper fill of drain 111
110	0.36m +	Rough surface formed of brick and tile fragments set into a matrix of concrete. A	Base of drain 111

		square slot for a post survives in the concrete.	
111	0.3 – 0.45m	Steep sided, flat bottomed drain adjacent to wall 108. Width 0.4m, depth 0.2m.	Cut of drain
112	0.3 – 0.4m	Firm reddish brown sandy clay with frequent cbm mortar and charcoal flecks. 0.14m deep.	Made ground

**Trench 2:** Length: 6.4m; Width: 1.6m; Maximum depth: 0.3m

Context	Depth	Description	Interpretation
201	0.0-0.13m	Firm mid brown clay silt with frequent charcoal flecks	Topsoil
202	0.13 – 0.3m	Compact reddish brown sandy clay with blue patches, charcoal flecking, brick fragments and frequent angular stones	Subsoil/made ground
203	0.3m+	Hard reddish brown clay with blue-grey mottling	Natural substrate
204	0.3m - 0.41m	Loose mid brown clay silt with frequent angular stones	Fill of pit [205]
205	0.3m - 0.41m	Small sub circular pit with a diameter of 0.38m and depth of 0.14m. Irregular in profile with moderately sloping sides and an irregular base.	Possible garden feature

**Trench 3:** Length: 6.7m; Width: 1.6m; Maximum depth: 0.8m

Context	Depth	Description	Interpretation
301	0.0-0.3m	Loose dark grey-brown clay silt with frequent lumps of charcoal and cbm.	Topsoil
302	0.3 – 0.7m	Mixed layer of grey-brown silty clay, brick fragments and tile with frequent angular stones	Made ground
303	0.7 – 0.8m	Compact, reddish brown silty clay with frequent cbm	Subsoil and weathered natural substrate
304	0.3m - 0.41m	Hard reddish brown clay with blue-grey mottling	Natural substrate