

**Archaeological Watching Brief Report
Tortington Priory Barn, Arundel
West Sussex**

**NGR: 500702 106030
(TQ 00702 06030)**

Scheduled Monument No. 1021459

**ASE Project No: 6644
Site Code: TPF14**

**ASE Report No: 2014167
OASIS id: archaeol6-179490**



By John Cook

**Archaeological Watching Brief Report
Tortington Priory Barn, Arundel
West Sussex**

**NGR: 500702 106030
(TQ 00702 06030)**

Scheduled Monument No. 1021459

**ASE Project No: 6644
Site Code: TPF14**

**ASE Report No: 2014167
OASIS id: archaeol6-179490**

By John Cook

May 2014

**Archaeology South-East
Units 1 & 2
2 Chapel Place
Portslade
East Sussex
BN41 1DR**

**Tel: 01273 426830
Fax: 01273 420866
Email: fau@ucl.ac.uk**

Abstract

Archaeology South-East was commissioned by Dr Catherine Watts to undertake an archaeological watching brief at Tortington Priory Barn, Priory Lane, Arundel, West Sussex during repairs to an existing water main. No archaeological remains were encountered during the ground works and only previously disturbed deposits (by the existing pipeline) were excavated.

CONTENTS

- 1.0 Introduction**
- 2.0 Archaeological Background**
- 3.0 Archaeological Methodology**
- 4.0 Results**
- 5.0 Discussion and Conclusions**

Bibliography
Acknowledgements

HER Summary Sheet
OASIS Form

FIGURES

- Figure 1: Site location and Scheduled Monument boundary
- Figure 2: Plan of monitored area
- Figure 3: Test pit photographs

TABLES

- Table 1: Quantification of site archive
- Table 2: List of recorded contexts for TP1
- Table 3: List of recorded contexts for TP2
- Table 4: List of recorded contexts for TP3
- Table 5: List of recorded contexts for TP4
- Table 6: List of recorded contexts for TP5
- Table 7: List of recorded contexts for TP6
- Table 8: List of recorded contexts for TP7
- Table 9: List of recorded contexts for TP8
- Table 10: List of recorded contexts for TP9

1.0 INTRODUCTION

1.1 Site Background

1.1.1 Archaeology South-East (ASE), the contracting division of the Centre for Applied Archaeology (CAA), Institute of Archaeology (IoA), University College London (UCL) was commissioned by Dr Catherine Watts to undertake an archaeological watching brief during repairs to an existing water main crossing land at Tortington Priory Barn, Priory Lane, Arundel, West Sussex (centred NGR 500702 106030; Figures 1 and 2).

1.2 Geology and Topography

1.2.1 According to the British Geological Survey (BGS 2014) the site's geology comprises head – clay, silt, sand and gravel and Raised beach deposits – sand and gravel overlying London Clay formation – clay, silt and sand.

1.2.2 The site lies c.1.2km to the south-west of Arundel and c.400m west of the River Arun on slightly elevated ground (c.8m OD) overlooking the Arun flood plain.

1.3 Planning Background

1.3.1 The site lies within the boundary of Scheduled Monument No 1021459 which relates to the Augustinian priory and part of priory precinct. The existing water main runs roughly north-eastwards from the farmhouse across ground likely to contain structural remains and former ponds associated with the medieval monastic complex.

1.3.2 An application for Scheduled Monument Consent (SMC) to facilitate the repair of the leaking water main was made by Dr Watts via English Heritage which included a method statement prepared by ASE (2014) which was formally approved.

1.4 Aims and Objectives

1.4.1 The general aim of the repair works and associated archaeological involvement are to:

- i. Effect a repair to a leaking water pipe entirely within previously disturbed ground*
- ii. Make an archaeological inspection on completion of the repair works to confirm that no archaeologically significant features/deposits were affected*
- iii. Produce a summary report on the findings for submission to EH and the West Sussex Historic Environment Record.*

1.4.2 The objectives of the project are to:

- i. Ensure that no archaeological remains are affected by the works*
- ii. To produce a report which will form a permanent record of the works undertaken and the location of the water pipe for future reference by the land owner and English Heritage.*

1.5 Scope of Report

1.5.1 This report details the results of the archaeological watching brief undertaken during groundworks at the site. The work was undertaken on the 8th and 16th of April 2014 by Vasilis Tsamis (Senior Archaeologist) and John Cook (Senior Archaeologist). The fieldwork was managed by Neil Griffin (Project Manager) and post-excavation managed by Dan Swift (Project Manager).

2.0 ARCHAEOLOGICAL BACKGROUND

- 2.1 For more detailed background the reader is directed to ASE's previous reports relating to investigations carried out at both Tortington Priory Barn and Priory Farm (see Bibliography).
- 2.2 A comprehensive plan of the former monastic complex is not available. However, during the course of ASE's previous involvement and analysis of aerial photographs it has been demonstrated that structural remains and human burials survive in the immediate vicinity of Tortington Priory Barn and Priory Farm. Earthworks in the field to the north-east of these dwellings are thought to relate to monastic ponds and associated water management. It is therefore likely that the installation of the existing water main will have impacted on archaeologically significant features and/or deposits.

3.0 ARCHAEOLOGICAL METHODOLOGY

3.1 Fieldwork Methodology

3.1.1 Once the leaking pipe was repaired all excavated trial holes were recorded. A written record of each trial hole was made using ASE pro forma supplemented by digital photographs. Additionally, the position of all trial holes and exposed water pipe were surveyed by means of survey grade GPS so that a permanent record of the water pipe's visible extent could be made, plotted and provided to the client and English Heritage for future reference.

3.2 The Site Archive

3.2.1 ASE informed Arundel Museum prior to the commencement of fieldwork that a site archive would be generated and confirmed they will accept the archive. The site archive is currently held at the offices of ASE and will be deposited at Arundel Museum in due course. The contents of the archive are tabulated below (Table 1).

| | |
|---------------------------|------------|
| Number of Contexts | 28 |
| No. of files/paper record | 1 file |
| Photographs | 45 digital |

Table 1: Quantification of site archive

4.0 RESULTS (Figure 3)

Test pits monitored on 08/04/2014 and 16/04/2014

4.1 Test pit 1 NGR 500656.9 106051.6

4.1.1 A 1.2m by 0.7m test pit was excavated through the backfill of an existing pipe trench. Undisturbed stratigraphy was noted of the exposed sections. The natural (1/003), a dark brown silty clay, was overlain by a thin subsoil (1/002), a dark greyish brown silty clay, which was overlain in turn by a dark brown silty clay topsoil (1/001).

4.1.2 No archaeological finds, features or deposits were identified.

| Context | Type | Description | Deposit Thickness m | Height m AOD |
|---------|-------|-----------------|---------------------|--------------|
| 1/001 | Layer | Topsoil | 0.32 | 10.27 |
| 1/002 | Layer | Subsoil | 0.13 | 9.95 |
| 1/003 | Layer | Natural geology | - | 9.82 |

Table 2: List of recorded contexts for TP1

4.2 Test pit 2 NGR 500668.9 106054.0

4.2.1 A 1.2m by 0.6m test pit was excavated through the backfill of an existing pipe trench. Undisturbed stratigraphy was noted of the exposed sections. The natural (2/003), a dark brown silty clay, was overlain by made ground (2/002), which was overlain in turn by a dark brown silty clay topsoil (2/001).

4.2.2 No archaeological finds, features or deposits were identified.

| Context | Type | Description | Deposit Thickness m | Height m AOD |
|---------|-------|-----------------|---------------------|--------------|
| 2/001 | Layer | Topsoil | 0.09 | 9.55 |
| 2/002 | Layer | Made ground | 0.53 | 9.46 |
| 2/003 | Layer | Natural geology | - | 8.93 |

Table 3: List of recorded contexts for TP2

4.3 Test pit 3 NGR 500681.6 106057.5

4.3.1 A 1.4m by 0.7m test pit was excavated through the backfill of an existing pipe trench. Undisturbed stratigraphy was noted of the exposed sections. The natural (3/003), a dark brown silty clay, was overlain by made ground (3/002), which was overlain in turn by a dark brown silty clay topsoil (3/001).

4.3.2 No archaeological finds, features or deposits were identified.

| Context | Type | Description | Deposit Thickness m | Height m AOD |
|---------|-------|-----------------|---------------------|--------------|
| 3/001 | Layer | Topsoil | 0.07 | 8.89 |
| 3/002 | Layer | Made ground | 0.56 | 8.82 |
| 3/003 | Layer | Natural geology | - | 8.26 |

Table 4: List of recorded contexts for TP3

4.4 Test pit 4 NGR 500695.1 106060.6

4.4.1 A 1.2m by 0.6m test pit was excavated through the backfill of an existing pipe trench. Undisturbed stratigraphy was noted of the exposed sections. The natural (4/003), a dark brown silty clay, was overlain by made ground (4/002), which was overlain in turn by a dark brown silty clay topsoil (4/001).

4.4.2 No archaeological finds, features or deposits were identified.

| Context | Type | Description | Deposit Thickness m | Height m AOD |
|---------|-------|-----------------|---------------------|--------------|
| 4/001 | Layer | Topsoil | 0.10 | 8.03 |
| 4/002 | Layer | Made ground | 0.73 | 7.93 |
| 4/003 | Layer | Natural geology | - | 7.20 |

Table 5: List of recorded contexts for TP4

4.5 Test pit 5 NGR 500708.1 106063.1

4.5.1 A 1.3m by 0.7m test pit was excavated through the backfill of an existing pipe trench. Undisturbed stratigraphy was noted of the exposed sections. The natural (5/003), a dark brown silty clay, was overlain by made ground (5/002), which was overlain in turn by a dark brown silty clay topsoil (5/001).

4.5.2 No archaeological finds, features or deposits were identified.

| Context | Type | Description | Deposit Thickness m | Height m AOD |
|---------|-------|-----------------|---------------------|--------------|
| 5/001 | Layer | Topsoil | 0.08 | 7.03 |
| 5/002 | Layer | Made ground | 0.97 | 6.95 |
| 5/003 | Layer | Natural geology | - | 5.98 |

Table 6: List of recorded contexts for TP5

4.6 Test pit 6 NGR 500711.3 106063.7

4.6.1 A 1.2m by 0.6m test pit was excavated through the backfill of an existing pipe trench. Undisturbed stratigraphy was noted of the exposed sections. A possible natural (6/003), was not observed due to water inundation, was overlain by made ground (6/002), which was overlain in turn by a dark brown silty clay topsoil (6/001).

4.6.2 No archaeological finds, features or deposits were identified.

| Context | Type | Description | Deposit Thickness m | Height m AOD |
|---------|-------|-----------------|---------------------|--------------|
| 6/001 | Layer | Topsoil | 0.10 | 6.94 |
| 6/002 | Layer | Made ground | 1.08 | 5.84 |
| 6/003 | Layer | Natural geology | - | 4.76 |

Table 7: List of recorded contexts for TP6

4.7 Test pit 7 NGR 500721.7 106065.6

4.7.1 A 1.3m by 0.6m test pit was excavated through the backfill of an existing pipe trench. Undisturbed stratigraphy was noted of the exposed sections. The natural (7/003), a dark brown silty clay, was overlain by made ground (7/002), which was overlain in turn by a dark brown silty clay topsoil (7/001).

4.7.2 No archaeological finds, features or deposits were identified.

| Context | Type | Description | Deposit Thickness m | Height m AOD |
|---------|-------|-----------------|---------------------|--------------|
| 7/001 | Layer | Topsoil | 0.09 | 6.09 |
| 7/002 | Layer | Made ground | 0.64 | 6.00 |
| 7/003 | Layer | Natural geology | - | 5.36 |

Table 8: List of recorded contexts for TP7

4.8 Test pit 8 NGR 500734.2 106064.5

4.8.1 A 1.0m by 0.6m test pit was excavated through the backfill of an existing pipe trench. Undisturbed stratigraphy was noted of the exposed sections. The natural (8/003), a dark brown silty clay, was overlain by made ground (8/002), which was overlain in turn by a dark brown silty clay topsoil (8/001).

4.8.2 No archaeological finds, features or deposits were identified.

| Context | Type | Description | Deposit Thickness m | Height m AOD |
|---------|-------|-----------------|---------------------|--------------|
| 8/001 | Layer | Topsoil | 0.10 | 5.19 |
| 8/002 | Layer | Made ground | 0.60 | 5.09 |
| 8/003 | Layer | Natural geology | - | 4.39 |

Table 9: List of recorded contexts for TP8

4.9 Test pit 9 NGR 500634.0 105939.0

4.9.1 A 0.7m by 0.5m test pit was excavated through the backfill of an existing pipe trench. Undisturbed stratigraphy was noted of the exposed sections. The natural (9/004), a mid greyish brown silty clay, was overlain by made ground (9/003), which was overlain in turn by paving (9/001) and its corresponding type 1 sub base (9/002).

4.9.2 No archaeological finds, features or deposits were identified.

| Context | Type | Description | Deposit Thickness m | Height m AOD |
|---------|-------|-----------------|---------------------|--------------|
| 9/001 | Layer | Paving | 0.08 | 8.55 |
| 9/002 | Layer | Made ground | 0.12 | 8.47 |
| 9/003 | Layer | Made ground | 0.45 | 8.35 |
| 9/004 | Layer | Natural geology | - | 7.90 |

Table 10: List of recorded contexts for TP9

5.0 DISCUSSION AND CONCLUSIONS

- 5.1 No archaeological finds, deposits or features were identified in any of the test pits monitored.
- 5.2 Only previously disturbed deposits (by the existing pipeline) were excavated.

BIBLIOGRAPHY

- ASE 1997 *An Archaeological Evaluation at Tortington Priory Barn, Arundel*.
Archaeology South-East Unpublished Report 762.
- ASE 1999 *Archaeological monitoring and recording at Tortington Priory Barn, Arundel, West Sussex*. Archaeology South-East Unpublished Report 984.
- ASE 2001 *An Archaeological Watching Brief at Priory Farm, Tortington, Arundel, West Sussex*. Archaeology South-East Unpublished Report 1404.
- ASE 2002 *An Archaeological Evaluation at Priory Farm, Tortington, Arundel, West Sussex*. Archaeology South-East Unpublished Report 1548.
- ASE 2014 *An Archaeological Watching Brief During Repairs To An Existing Water Main Crossing Land At Tortington Priory Barn, Priory Lane, Arundel, West Sussex, BN18 0BG Method Statement*, Unpublished ASE Document
(Prepared by Neil Griffin)
- BGS 2014, British Geological Survey: Geology of Britain Viewer,
<http://www.bgs.ac.uk/discoveringGeology/geologyOfBritain/viewer.html>
(Accessed 21st May 2014)

ACKNOWLEDGEMENTS

ASE would like to thank Dr Catherine Watts for commissioning the work and for their assistance throughout the project.

HER Summary

| | | | | | | |
|---------------------------------|---|--|------------------------------|--|--|--|
| Site Code | TPF14 | | | | | |
| Identification Name and Address | Tortington Priory Barn, Arundel, West Sussex | | | | | |
| County, District &/or Borough | West Suusex | | | | | |
| OS Grid Refs. | NGR 500702 106030 | | | | | |
| Geology | London Clay overlain by Head and Raised beach deposits | | | | | |
| Arch. South-East Project Number | 6644 | | | | | |
| Type of Fieldwork | | | Watching Brief | | | |
| Type of Site | Green Field | | | | | |
| Dates of Fieldwork | | | WB. 08/04/14+ 16/04/14 | | | |
| Sponsor/Client | Dr Catherine Watts | | | | | |
| Project Manager | Neil Griffin | | | | | |
| Project Supervisor | Vasilis Tsamis and John Cook | | | | | |
| Period Summary | | | | | | |
| | | | | | | |
| Summary | <p><i>Archaeology South-East was commissioned by Dr Catherine Watts to undertake an archaeological watching brief at Tortington Priory Barn, Priory Lane, Arundel, West Sussex during repairs to an existing water main. No archaeological remains were encountered during the ground works and only previously disturbed deposits (by the existing pipeline) were excavated.</i></p> | | | | | |

OASIS Form

OASIS ID: archaeol6-179490

Project details

| | |
|--|---|
| Project name | An Archaeological Watching Brief |
| Short description of the project | Archaeology South-East was commissioned by Dr Catherine Watts to undertake an archaeological watching brief at Tortington Priory Barn, Priory Lane, Arundel, West Sussex during repairs to an existing water main. No archaeological remains were encountered during the ground works and only previously disturbed deposits (by the existing pipeline) were excavated. |
| Project dates | Start: 08-04-2014 End: 16-08-2014 |
| Previous/future work | Yes / Not known |
| Any associated project reference codes | 6644 - Contracting Unit No. |
| Any associated project reference codes | TPF14 - Sitecode |
| Type of project | Field evaluation |
| Site status | Scheduled Monument (SM) |
| Current Land use | Grassland Heathland 2 - Undisturbed Grassland |
| Monument type | AUGUSTINIAN MONASTERY Medieval |
| Methods & techniques | "Test Pits" |
| Development type | Service infrastructure (e.g. sewage works, reservoir, pumping station, etc.) |
| Prompt | Scheduled Monument Consent |

Project location

| | |
|------------------|--|
| Country | England |
| Site location | WEST SUSSEX ARUN ARUNDEL Tortington Priory Barn, Arundel, West Sussex |
| Postcode | BN18 0BG |
| Study area | 0.50 Hectares |
| Site coordinates | TQ 00702 06030 50.8444547177 -0.569486693876 50 50 40 N 000 34 10 W Point |

Project creators

| | |
|------------------------------|------------------------|
| Name of Organisation | Archaeology South-East |
| Project brief originator | Archaeology South-East |
| Project design originator | Archaeology South-East |
| Project director/manager | Neil Griffin/Dan Swift |
| Project supervisor | Vasilis Tsamis |
| Type of sponsor/funding body | private client |

Project archives

| | |
|---------------------------|--|
| Physical Archive Exists? | No |
| Digital Archive recipient | Arundel Museum and History Centre |
| Digital Contents | "Stratigraphic","Survey" |
| Digital Media available | "Images raster / digital photography","Survey","Text" |
| Paper Archive recipient | Arundel Museum and History Centre |
| Paper Contents | "Stratigraphic","Survey" |
| Paper Media available | "Context sheet","Miscellaneous Material","Notebook - Excavation',' Research',' General Notes","Report" |

Project bibliography 1

| | |
|-------------------------------|---|
| Publication type | Grey literature (unpublished document/manuscript) |
| Title | An Archaeological Watching Brief |
| Author(s)/Editor(s) | Cook, J. |
| Other bibliographic details | ASE report number: 2014167 |
| Date | 2014 |
| Issuer or publisher | ASE |
| Place of issue or publication | Portslade |

Description Standard ASE Client Report. A4-sized with cover logos

Entered by John Cook (john.cook@ucl.ac.uk)

Entered on 21 May 2014

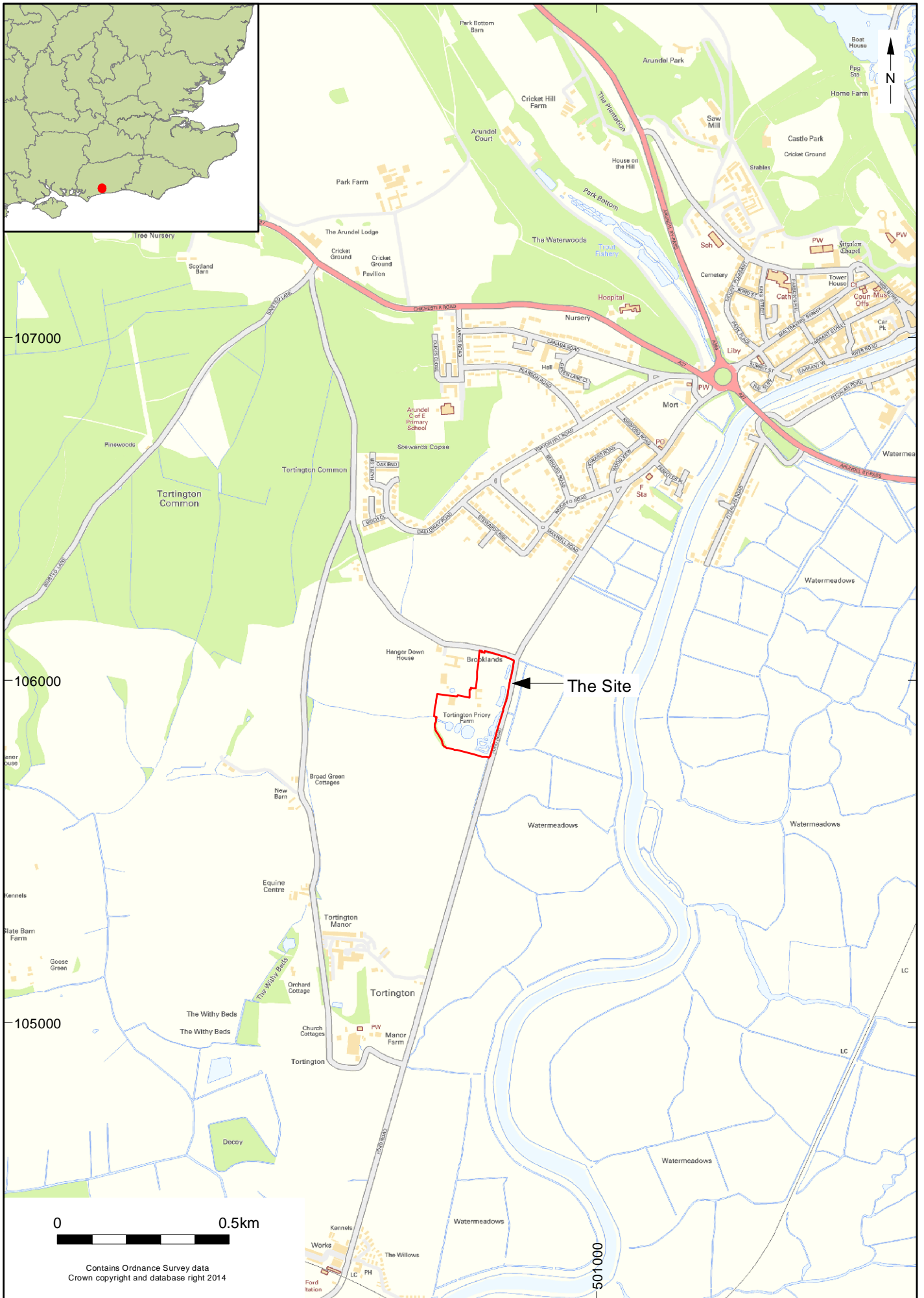

| | | | |
|--------------------------|---------------|---|--------|
| © Archaeology South-East | | Tortington Priors Farm, Tortington | Fig. 1 |
| Project Ref: 6644 | May 2014 | Site location and Scheduled Monument boundary | |
| Report Ref: 2014167 | Drawn by: JLR | | |

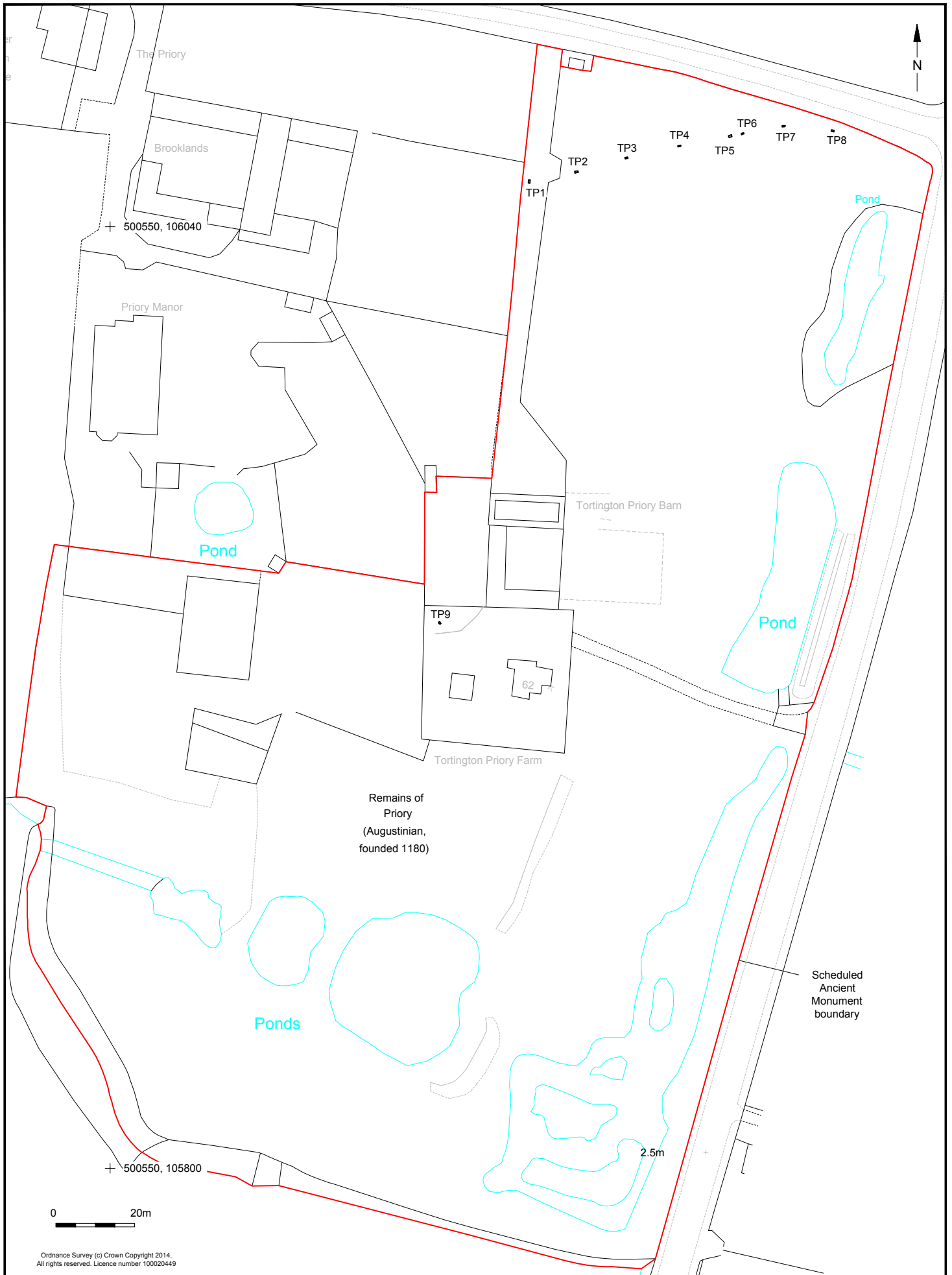

| | | | | |
|--------------------------|--------------|------------------------------------|--|--------|
| © Archaeology South-East | | Tortington Priory Farm, Tortington | | Fig. 2 |
| Project Ref: 6644 | May 2014 | Plan of monitored area | | |
| Report Ref: 2014167 | Drawn by: JR | | | |



Test pit 1



Test pit 2



Test pit 3



Test pit 4



Test pit 5



Test pit 6

| | | | |
|--------------------------|---------------|------------------------------------|--------|
| © Archaeology South-East | | Tortington Priory Farm, Tortington | Fig. 3 |
| Project Ref: 6644 | May 2014 | Test pit photographs | |
| Report Ref: 2014167 | Drawn by: JLR | | |



Test pit 7



Test pit 8



Test pit 9

| | | | |
|--------------------------|---------------|------------------------------------|--------|
| © Archaeology South-East | | Tortington Priory Farm, Tortington | Fig. 4 |
| Project Ref: 6644 | May 2014 | Test pit photographs | |
| Report Ref: 2014167 | Drawn by: JLR | | |

Sussex Office

Units 1 & 2
2 Chapel Place
Portslade
East Sussex BN41 1DR
tel: +44(0)1273 426830
email: fau@ucl.ac.uk
web: www.archaeologyse.co.uk

Essex Office

The Old Magistrates Court
79 South Street
Braintree
Essex CM7 3QD
tel: +44(0)1376 331470
email: fau@ucl.ac.uk
web: www.archaeologyse.co.uk

London Office

Centre for Applied Archaeology
UCL Institute of Archaeology
31-34 Gordon Square
London WC1H 0PY
tel: +44(0)20 7679 4778
email: fau@ucl.ac.uk
web: www.ucl.ac.uk/caa

