

**Archaeological Watching Brief Report
Ellinge Hall, The Street
Glynde, East Sussex**

**NGR: 545668 109241
(TQ 45668 09241)**

**South Downs National Park Authority
Planning Reference: SDNP/17/00568/FUL
ASE Project No: 170294
Site Code: ELL 17
ASE Report No: 2017495
OASIS ID: archaeol6-302098**



By Simon Stevens



**Archaeological Watching Brief Report
Ellinge Hall, The Street
Glynde, East Sussex**

**NGR: 545668 109241
(TQ 45668 09241)**

**South Downs National Park Authority
Planning Reference: SDNP/17/00568/FUL**

**ASE Project No: 170294
Site Code: ELL 17**

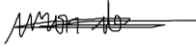
**ASE Report No: 2017495
OASIS ID: archaeol6-302098**

Prepared by:	Simon Stevens	Senior Archaeologist	
Reviewed and approved by:	Andy Margetts	Project Manager	
Date of Issue:	November 2017		
Version:	1		

**Archaeology South-East
Units 1 & 2
2 Chapel Place
Portslade
East Sussex
BN41 1DR**

**Tel: 01273 426830
Fax: 01273 420866
Email: fau@ucl.ac.uk**

Abstract

Archaeology South-East was commissioned by The Trustees of the Glynde Endowment Settlement, Glynde Estates to undertake an archaeological watching brief during groundworks at Ellinge Hall, The Street, Glynde, East Sussex.

No archaeological deposits, features or finds were recorded at the site, and there was clear evidence that any potential archaeological deposits had been removed prior to the current works, presumably during the construction of, or additions to the standing structure.

CONTENTS

- 1.0 Introduction**
- 2.0 Archaeological Background**
- 3.0 Archaeological Methodology**
- 4.0 Results**
- 5.0 Discussion and Conclusions**

Bibliography
Acknowledgements

HER Summary
OASIS Form

TABLES

Table 1: HER entries with 1km of Ellinge Hall
Table 2: Quantification of site paper archive
Table 3: Quantification of artefact and environmental samples
Table 4: List of recorded contexts

FIGURES

Figure 1: Site location
Figure 2: Monitored footings
Figure 3: Monitored footings plan and photos

1.0 INTRODUCTION

1.1 Site Background

1.1.1 Archaeology South-East was commissioned by The Trustees of the Glynde Endowment Settlement, Glynde Estates to undertake an archaeological watching brief during groundworks at Ellinge Hall, The Street, Glynde, East Sussex (NGR 545668 109241; Figure 1).

1.2 Geology and Topography

1.2.1 Ellinge Hall is a substantial 4-bedroom dwelling lying in a rural location on the north side of The Street, a country lane running northwards from Lacys Hill, Glynde. Apparently built in 1802, the house is unlisted and much altered (Lusted and Whitmore 2017).

1.2.2 According to the most recent available data from the British Geological Survey, the underlying geology at the site consists of the West Melbury Marly Chalk Formation with localised superficial deposits of 'head' consisting of clay, silt, sand and gravels (BGS 2017).

1.3 Planning Background

1.3.1 Planning permission was granted by South Downs National Park Authority for the erection of a two storey and single storey extension to the existing building. (planning reference SDNP/17/00568/FUL). Following consultation between South Downs National Park Authority and East Sussex County Council (South Downs National Park Authority's advisers on archaeological issues in this area), a condition was attached to the permission requiring that:

'No development shall take place until the applicant has secured the implementation of a programme of archaeological works in accordance with a written scheme of investigation which has been submitted by the applicant and approved by the Local Planning Authority. A written record of any archaeological works undertaken shall be submitted to the Local Planning Authority within 3 months of the completion of any archaeological investigation unless an alternative timescale for submission of the report is first agreed in writing with the Local Planning Authority.'

Reason: To ensure that the archaeological and historical interest of the site is safeguarded and recorded to comply with the National Planning Policy Framework'

1.3.2 Subsequently a *Written Scheme of Investigation* for the archaeological work was prepared by ASE. The document outlined the methodologies to be used on site (in this case an archaeological watching brief), and in the preparation of a report and archive of the results (ASE 2017). The document was submitted to East Sussex County Council and was duly approved before the commencement of work at the site.

1.4 Scope of Report

- 1.4.1 This report details the results of the archaeological monitoring of groundworks at the site undertaken on 22nd November 2017 by Simon Stevens (Senior Archaeologist). The project was managed by Paul Mason (Project Manager) and by Jim Stevenson and Andy Margetts (Post-excavation Managers).

2.0 ARCHAEOLOGICAL AND CARTOGRAPHIC BACKGROUND

2.1 Archaeological Background

2.1.1 The following archaeological background and research aims are taken directly from the WSI (*ibid.*). The background data was gathered from a search of the East Sussex Historic Environment Record (see also Figure 1). Ellinge Hall lies c.50m north of the projected line of a Roman road (Margary RR 142/145; Margary 1965, 198-200).

HER No.	Description	Period
MES1239	Find spot – pewter plate	Roman
MES1446	St Mary’s Church	C18th
MES1447	‘Harvey’s’ timber framed building	C16th
MES1461	Glynde Place	C16th
MES1462	River crossing (postulated)	Roman?
MES1466	Gardens at Glynde Place	C18th
MES1475	Find spot - coins	Roman
MES1920	Line of Roman road	Roman
MES4753	Line of Roman road	Roman
MES7035	The Old Vicarage	Medieval
MES7162	Ford Cottage Well	C17th
MES16197	The Rye: earthwork	Undated
MES20092	Harvey’s anti-tank bouys	C20th
MES21977	Glynde Medieval Hamlet	Medieval
MES24143	‘Wisdom’s’ timber framed building	C16th
MES24241	Glynde Place Ice House	C19th
MES24242	Agricultural building	C19th
MES24487	Memorial cross at St Mary the Virgin Church	C20th
MES24511	Memorial plaque at St Mary the Virgin Church	C20th
MES24754	Glynde Reach irrigation ditches	Unknown
MES26155	Find spot – flint	Neolithic
MES26156	Find spot – pottery	Iron Age/Roman
MES26157	Pit and well at Orchard House	Medieval
MES26158	Post-medieval finds	Post-medieval
MES29562	Orchard House	C18th
MES32131	Trevor House Farmstead	Medieval
MES32132	Home Farm	C19th
MES32176	Outfarm	C19th
MES32177	Outfarm	C19th
MES34118	Ellinge Hall	C18th

Table 1: HER entries with 1km of Ellinge Hall

2.2 Cartographic Background

- 2.2.1 The current Ellinge Hall was labelled as *Sevenacres* on the first edition Ordnance Survey map of 1875-6. The map shows a small rectangular dwelling with a complex of 'L' shaped farm buildings immediately to the east.
- 2.2.2 By 1899 the name of the property had changed to *Home Farm* and the house has been enlarged. The map of 1910 indicates the footprint of the house very similar to that of today and including the railway carriage on the north-east side of the house.
- 2.2.3 The house is believed to have been the home of the Glynde Estate's manager in the early 1900s and the railway carriage was used as the estate office for a time. Recently, it has rented out by the Estate to private tenants (Mackellar Schwerdt 2017).

2.3 Research Aims And Objectives

- 2.3.1 The general objective of the archaeological watching brief is to record archaeological deposits exposed by the development. Exposed deposits or recovered artefacts should be interpreted within the context of the site as a whole.
- 2.3.2 The watching brief will also assess the past impacts on the site and pay particular attention to the character, height/depth below ground level, condition, date and significance of any deposits.
- 2.3.3 Consideration will also be given to publication of the results in a local journal and/or presentation/s to local historical/archaeological societies should the results be of sufficient interest.
- 2.3.4 The watching brief has the potential to address the following research objectives set out in the South-East Research Framework (SERF):
- The study of Roman communications (and roadside settlements)
 - The chronology and typology of farm buildings and lesser noticed post-medieval agricultural features
- 2.3.5 A final aim is to make public the results of the archaeological watching brief subject to any confidentiality restrictions.

3.0 ARCHAEOLOGICAL METHODOLOGY

3.1 Fieldwork Methodology

- 3.1.1 The mechanical excavation of strip footings was monitored by a suitably qualified archaeologist. All sections were examined for archaeological deposits and all spoil was scanned for the presence of archaeological artefacts, both visually and with a metal detector.
- 3.1.2 All encountered deposits were recorded according to accepted professional standards using standard Archaeology South-East context record forms. Deposit colours were recorded by visual inspection and not by reference to a Munsell Colour chart. A full photographic record of the monitoring was maintained.
- 3.1.3 The fieldwork was undertaken according to WSI (ASE 2017), in accordance with the ClfA *Code of Conduct* (ClfA 2014a) and *Standards and Guidance for Archaeological Watching Brief* (ClfA 2014b) as well as with reference to the *Sussex Archaeological Standards* (ESCC 2015).

3.2 Fieldwork Constraints

- 3.2.1 There were no physical constraints to the archaeological monitoring of the groundworks; machining was closely observed, all sections were examined and all spoil was scanned for the presence of archaeological artefacts.

3.3 The Site Archive

- 3.3.1 The site archive is currently held at the offices of ASE and will be offered to the Lewes Museum in due course. The contents of the archive are tabulated below (Tables 2 and 3).

Context sheets	2
Section sheets	0
Plans sheets	0
Colour photographs	0
B&W photos	0
Digital photos	16
Context register	1
Drawing register	0
Watching brief forms	1
Trench Record forms	0

Table 2: Quantification of site paper archive

Bulk finds (quantity e.g. 1 bag, 1 box, 0.5 box 0.5 of a box)	0
Registered finds (number of)	
Flots and environmental remains from bulk samples	0
Palaeoenvironmental specialists sample samples (e.g. columns, prepared slides)	0
Waterlogged wood	0
Wet sieved environmental remains from bulk samples	0

Table 3: Quantification of artefact and environmental samples

3.3.2 A county-wide policy of selection and retention of archaeological finds is currently under review by the Sussex Archaeological Museum Group working party. Once the policy is agreed and in place, it will be implemented by Archaeology South-East. The finds archive will be revised in accordance with this policy in the event that it is implemented before deposition of the archive occurs.

4.0 RESULTS

4.1 Introduction (Figures 2 and 3)

4.1.1 The mechanical excavation of strip footings by a Kubota KX-14 tracked excavator were monitored on 22nd November 2017. The foundations were 600mm wide and a maximum of 1m in depth.

Context	Type	Description	Max. Deposit Thickness m
001	Layer	Made Ground	0.22
002	Layer	Natural	-

Table 4: List of recorded contexts

4.2 The Stratigraphic Sequence

4.2.1 Monitoring of excavations immediately to the south-west of the existing structure revealed a straightforward stratigraphic sequence. It consisted of a thin surface layer of mid-greyish brown to mid-brown heavily rooted mortary made ground, context [001], left after the recent removal of a patio surface. This directly over the greyish white/whitish grey surface of the marly chalk, context [002]. There had been disturbance to both deposits close to existing structure from the laying of a service.

4.2.2 No archaeological deposits, features or finds were recorded, and as recently deposited made ground was laid directly on the surface of the 'natural' with no evidence of a topsoil or subsoil layer, it is apparent that there has been substantial earthmoving at the site, potentially removing any archaeological deposits.

5.0 DISCUSSION AND CONCLUSIONS

5.1 Overview of stratigraphic sequence

5.1.1 The simple stratigraphic sequence and absence of any clear topsoil or subsoil, demonstrated that there had been significant earthmoving at the site, presumably in the recent past, supported by the paucity of deposited detritus that would be expected close to any property of age.

5.2 Deposit survival and existing impacts

5.2.1 It is clear that there has been substantial earthmoving/truncation at the property, presumably associated with the construction and/or erection of additions to the building over time.

5.3 Consideration of research aims

5.3.1 The watching brief was successful in its general aims of monitoring the groundworks to mitigate exposure of deposits or artefacts of archaeological interest. Given the lack of archaeological remains, none of the more specific research aims could be addressed in any meaningful way.

5.4 Conclusions

5.4.1 No archaeological deposits, features or finds were recorded at the site, and there was evidence that any potential archaeological deposits had been removed prior to the current works.

BIBLIOGRAPHY

ASE 2017. *Written Scheme of Investigation for an Archaeological Watching Brief at Ellinge Hall, The 4 Street, Glynde, East Sussex*. Unpub. ASE document

BGS 2017. *British Geological Survey, Geology of Britain Viewer*, accessed 28.07.2017
<http://mapapps.bgs.ac.uk/geologyofbritain/home.html>

ClfA, 2014a *Code of Conduct*. Chartered Institute of Field Archaeologists

ClfA, 2014b *Standards and Guidance for Archaeological Watching Brief*. Chartered Institute of Field Archaeologists

Lusted, A. and Whitmore C. 2017. *Ellinge: 1802-2017*. Accessed 24.11.2017
<http://glynde.info/history/property.php?id=38>

Mackellar Schwerdt Architects 2017. *Alteration and Extensions to Ellinge Hall: Heritage Statement*. Unpub. MSA Document Ref. 8878/H

Margary, I.D. 1965: *Roman Ways in the Weald* (3rd edition). London: Phoenix House

ESCC 2015. *Standards for Archaeological Work in Sussex*. Lewes: East Sussex County Council

ACKNOWLEDGEMENTS

ASE would like to thank Glynde Estates for commissioning the archaeological work at the property. Thanks are also due to Greg Chuter, County Archaeologist, East Sussex County Council for his input at all stages, and to the groundworkers for their co-operation.

HER Summary

Site code	ELL 17					
Project code	170294					
Planning reference	SDNP/17/00568/FUL					
Site address	Ellinge Hall, The Street, Glynde					
District/Borough	Lewes					
NGR (12 figures)	545668 109241					
Geology	West Melbury Marly Chalk					
Fieldwork type	Eval	Excav	WB ✓	HBR	Survey	Other
Date of fieldwork	22.11.2017					
Sponsor/client	Glynde Estates					
Project manager	Paul Mason					
Project supervisor	Simon Stevens					
Period summary						
						None
Project summary	<p><i>Archaeology South-East was commissioned by The Trustees of the Glynde Endowment Settlement, Glynde Estates to undertake an archaeological watching brief during groundworks at Ellinge Hall, The Street, Glynde, East Sussex.</i></p> <p><i>No archaeological deposits, features or finds were recorded at the site, and there was clear evidence that any potential archaeological deposits had been removed prior to the current works, presumably during the construction of, or additions to the standing structure.</i></p>					

OASIS Form

OASIS ID: archaeol6-302098

Project details

Project name	Archaeological Watching Brief Report - Ellinge Hall, The Street, Glynde, East Sussex
Short description of the project	Archaeology South-East was commissioned by The Trustees of the Glynde Endowment Settlement, Glynde Estates to undertake an archaeological watching brief during groundworks at Ellinge Hall, The Street, Glynde, East Sussex. No archaeological deposits, features or finds were recorded at the site, and there was clear evidence that any potential archaeological deposits had been removed prior to the current works, presumably during the construction of, or additions to the standing structure.
Project dates	Start: 22-11-2017 End: 22-11-2017
Previous/future work	No / Not known
Any associated project reference codes	170294 - Contracting Unit No.
Any associated project reference codes	ELL 17 - Sitecode
Any associated project reference codes	SDNP/17/00568/FUL - Planning Application No.
Type of project	Recording project
Site status	National Park
Current Land use	Other 13 - Waste ground
Monument type	NONE None
Significant Finds	NONE None
Investigation type	"Watching Brief"
Prompt	Direction from Local Planning Authority - PPS
Project location	
Country	England
Site location	EAST SUSSEX LEWES GLYNDE Ellinge Hall, The Street
Study area	100 Square metres
Site coordinates	TQ 45668 09241 50.863722957872 0.070175518504 50 51 49 N 000 04 12 E Point
Project creators	
Name of Organisation	Archaeology South-East
Project brief originator	East Sussex County Council

Project design originator	Archaeology South-East
Project director/manager	Paul Mason
Project supervisor	Simon Stevens
Type of sponsor/funding body	Client
Name of sponsor/funding body	Glynde Estates
Project archives	
Physical Archive Exists?	No
Physical Archive recipient	Lewes Museum
Digital Archive recipient	Lewes Museum
Digital Contents	"other"
Digital Media available	"Text"
Paper Archive recipient	Lewes Museum
Paper Contents	"other"
Paper Media available	"Context sheet", "Miscellaneous Material", "Notebook - Excavation", " Research", " General Notes", "Report", "Unpublished Text"
Project bibliography	
1	
Publication type	Grey literature (unpublished document/manuscript)
Title	Archaeological Watching Brief Report - Ellinge Hall, The Street, Glynde, East Sussex
Author(s)/Editor(s)	Stevens, S.
Other bibliographic details	ASE Report No. 2017495
Date	2017
Issuer or publisher	Archaeology South-East
Place of issue or publication	Portslade, East Sussex
Description	Standard ASE client report. A4-sized with cover logos
Entered by	Simon Stevens (simon.stevens@ucl.ac.uk)
Entered on	24 November 2017

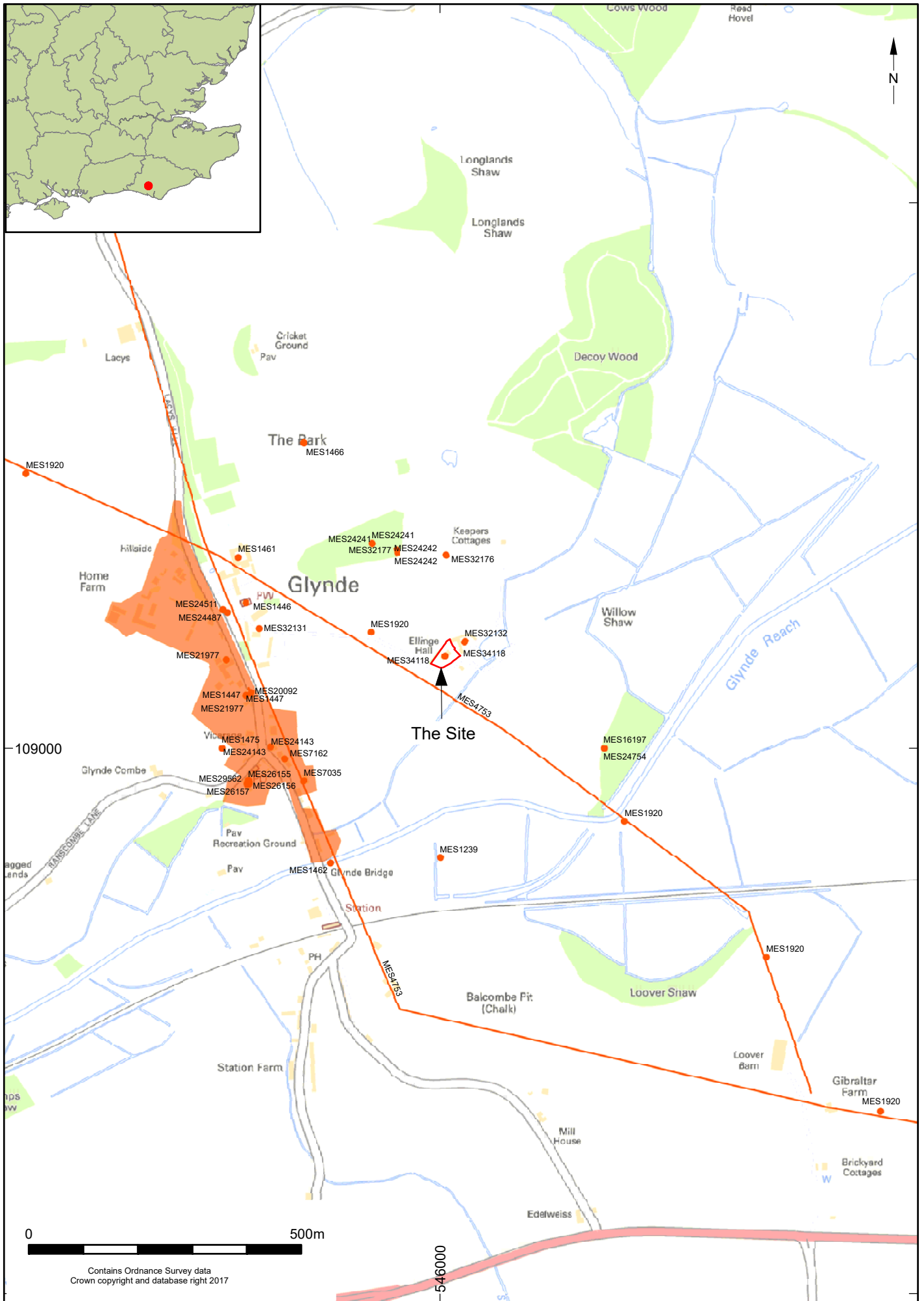

Contains Ordnance Survey data
Crown copyright and database right 2017

© Archaeology South-East		Ellinge Hall, The Street	Fig. 1
Project Ref: 170294	March 2017	Site location	
Report Ref: 2017495	Drawn by: JLR		

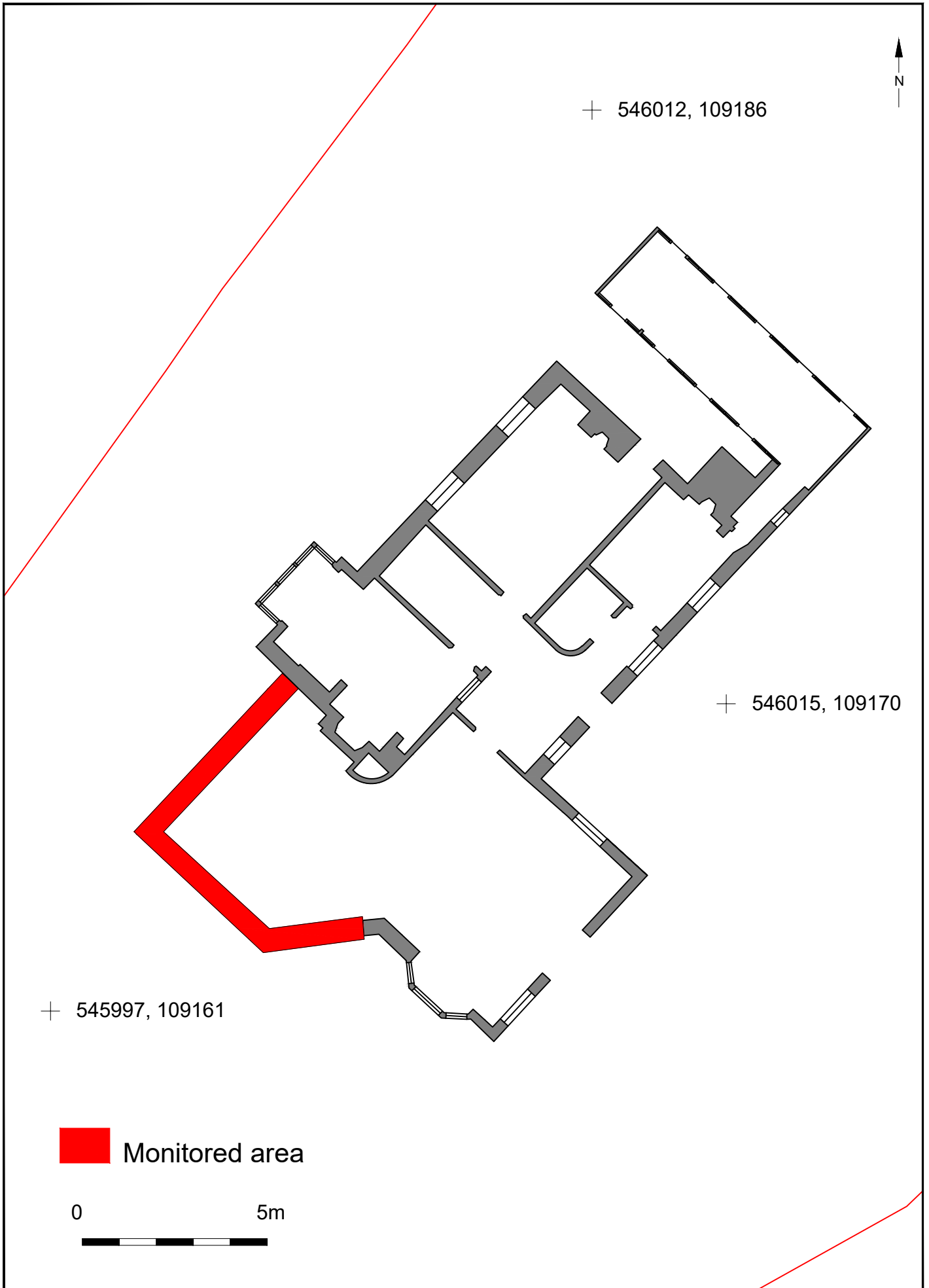

© Archaeology South-East		Ellinge Hall, The Street	Fig. 2
Project Ref: 170294	March 2017	Monitored footings	
Report Ref: 2017495	Drawn by: SC		

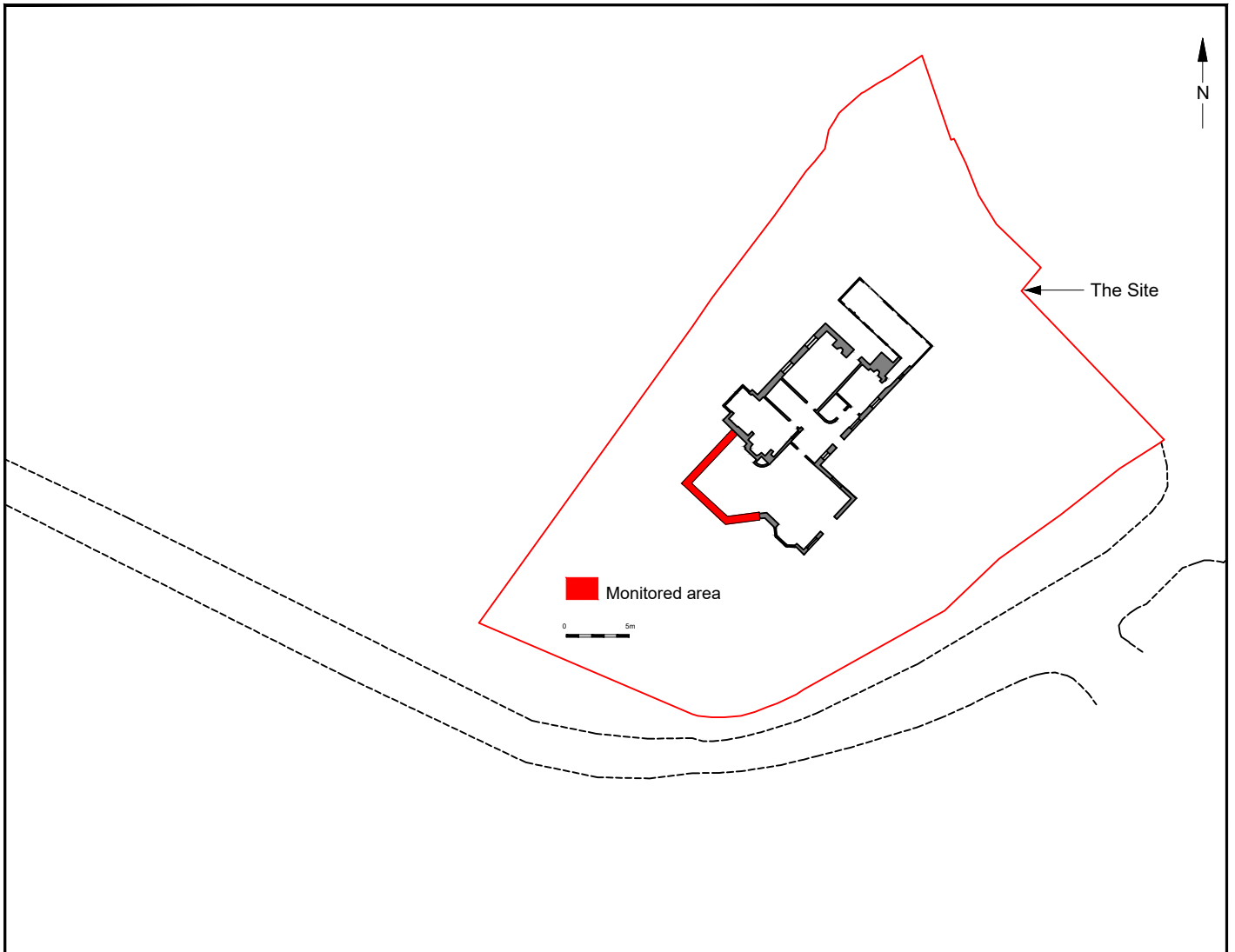

The site looking N



Looking NE



Looking NE

© Archaeology South-East		Ellinge Hall, The Street	Fig. 3
Project Ref: 170294	March 2017	Monitored footings plan and photos	
Report Ref: 2017495	Drawn by: SC		

Sussex Office

Units 1 & 2
2 Chapel Place
Portslade
East Sussex BN41 1DR
tel: +44(0)1273 426830
email: fau@ucl.ac.uk
www.archaeologyse.co.uk

Essex Office

27 Eastways
Witham
Essex
CM8 3YQ
tel: +44(0)1376 331470
email: fau@ucl.ac.uk
www.archaeologyse.co.uk

London Office

Centre for Applied Archaeology
UCL Institute of Archaeology
31-34 Gordon Square
London WC1H 0PY
tel: +44(0)20 7679 4778
email: fau@ucl.ac.uk
www.ucl.ac.uk/caa

