

**An Archaeological Watching Brief at
the former Kingston Works, Gardner Road,
Southwick, West Sussex**

Planning Ref: ADC/0783/07

**NGR: 52535 10530
(TQ 253053)**

**Project No. 3463
Site Code: GRS 08**

**ASE Report No. 2009054
OASIS id: archaeol6-57389**

Kathryn Grant BA MSc AIFA

March 2009

**An Archaeological Watching Brief at
the former Kingston Works, Gardner Road,
Southwick, West Sussex**

Planning Ref: ADC/0783/07

**NGR: 52535 10530
(TQ 253053)**

**Project No. 3463
Site Code: GRS 08**

**ASE Report No. 2009054
OASIS id: archaeol6-57389**

Kathryn Grant BA MSc AIFA

March 2009

**Archaeology South-East
Units 1 & 2
2 Chapel Place
Portslade
East Sussex
BN41 1DR**

**Tel: 01273 426830
Fax: 01273 420866
Email: fau@ucl.ac.uk
www.archaeologyse.co.uk**

Abstract

Archaeology South-East was commissioned by the Philip Pank Partnership, on behalf of Hyde Housing Association to undertake an archaeological watching brief during ground works associated with the construction of a new residential development at the former Kingston Works, Gardner Road, Southwick, West Sussex (centred at NGR: 52535 10530). The archaeological watching brief took place between 18th February and 18th March 2009.

No archaeological deposits, features or artefacts were encountered during the watching brief monitoring of the ground works.

The ground works revealed deposits consisting of modern made ground associated with construction works for the former Kingston Works. Natural geology varied from mid brown-orange silty clay brickearth to degraded chalk stratum perhaps representing redeposited Head Deposit. Natural geology was recorded at a maximum height of 0.5m below ground surface (c. 15.6m AOD).

CONTENTS

- 1.0 Introduction**
- 2.0 Archaeological Background**
- 3.0 Archaeological Methodology**
- 4.0 Results**
- 5.0 Discussion and Conclusions**

Bibliography
Acknowledgements

SMR Summary Form
OASIS Form

FIGURES

- Figure 1: Site Location Map
- Figure 2: Plan Showing Proposed Development
- Figure 3: Plan of Monitored Ground Works

TABLES

- Table 1: Quantification of Site Archive
- Table 2: List of Recorded Contexts

1.0 INTRODUCTION

1.1 Site Background

1.1.1 Archaeology South-East was commissioned by the Philip Pank Partnership, on behalf of Hyde Housing Association to undertake an archaeological watching brief during ground works associated with the construction of a new residential development (Planning Ref: ADC/0783/07) at the former Kingston Works, Gardner Road, Southwick, West Sussex (centred at NGR 52535 10530; Figure 1), hereafter referred to as 'the site'.

1.1.2 The proposed development consists of:

- The demolition of existing buildings (former Kingston Works)
- The excavation of foundation/footing trenches for the new buildings comprising new residential flats and housing, including the excavation and construction of lift shafts for the new flats
- The excavation of service trenches and associated soakaways

1.2 Geology and Topography

1.2.1 According to the British Geological Survey (Sheet 318/333), the underlying geology is Brickearth with Head Deposits.

1.2.2 The site is bounded to the west and east by residential and commercial properties, to the south by Gardner Road and to the north by railway lines.

1.3 Planning Background

1.3.1 A *Written Scheme of Investigation* (WSI) was prepared by ASE (ASE 2008) following communication with West Sussex County Council (WSCC) and in reference to their *Recommended Standard Archaeological Conditions* (WSCC 2008). The WSI was duly approved by WSCC and all work was carried out in accordance with this document and the relevant *Standards and Guidance* of the Institute of Field Archaeologists (IFA 2001).

1.3.2 An application for planning permission for the redevelopment of the site was granted by Adur District Council (Planning Ref: ADC/0783/07) with an attached archaeological condition (No.14) to comply with the policy AH2 of the Adur District Council Local Plan and the CH7 of the West Sussex Structure Plan. Following the advice of the WSCC Senior Archaeologist, Mark Taylor, it was agreed that an archaeological watching brief was to be undertaken throughout the duration of the intrusive ground works.

1.4 Aims and Objectives

1.4.1 The broad aims of the archaeological watching brief as outlined in the WSI (ASE 2008) were to ascertain:

- whether archaeological remains extend across the development site
- the character date and quality of ancient remains and deposits
- how they might be affected by the development of the site
- whether particularly important remains should be preserved *in situ*
- what options should be considered for mitigation

1.5 Scope of Report

1.5.1 This report details the findings of the watching brief which was undertaken by Kathryn Grant and Dylan Hopkinson (Archaeological Field Officers) between 18th February and 18th March 2009. The project was managed by Jon Sygrave (Fieldwork) and Dan Swift (Post-excavation).

2.0 ARCHAEOLOGICAL BACKGROUND

2.1 Overview

2.1.1 Although little recorded archaeological excavation has taken place within the town in Southwick, several isolated findspots have been recorded within the vicinity on the West Sussex County Sites and Monuments Record. These have been summarised by period below.

2.2 Prehistoric

2.2.1 A polished Neolithic axe (TQ 2533005410) was bought by Brighton Museum in 1928, which was apparently found north of Fishersgate halt. Other Neolithic flintwork seems to be from the same location.

2.2.2 Late Bronze Age urns (TQ 2533005410) were found in Fishersgate in 1926. The pottery is thought to be in Brighton Museum.

2.2.3 In 1992, a watching brief carried out in Southwick unearthed prehistoric flintwork (TQ 2452005670), including a small scraper found below the pavement outside No. 4 The Crescent.

2.2.4 A site was excavated by Shoreham College students in which excavations uncovered flintwork (TQ 2355305039), including a socketed stone axe, antler and pottery, but the exact whereabouts are not listed.

2.2.5 Excavations at the site of Southwick Roman Villa revealed Iron Age Postholes (TQ 24460005650).

2.2.6 An Egyptian coin of Ptolemy VIII (dating to c.2BC) (TQ 2375006080) was found at the junction of Kingston lane and Old Shoreham Road.

2.3 Romano-British

2.3.1 A hoard of Bronzes (TQ 2474005020) with dates ranging from the Roman to the late Medieval period were found near Fishersgate Rec. in 1958.

2.3.2 Southwick Roman Villa (TQ 24446005650), comprising a combination of courtyard and corridor style villa, with baths and ancillary buildings, has been investigated at various times since its discovery in 1815. The main excavation results were published in 1932 (Winbolt 1932).

2.4 Anglo-Saxon

2.4.1 There are no isolated records pertaining to the Anglo-Saxon period within the area, although the structures revealed beneath the floor of St Julian's Church are postulated as Anglo-Saxon.

2.5 Medieval

2.4.1 St. Julian's Church (TQ 2357005215) is late C11th with C13th-16th and

modern additions. It also contains much re-used tile.

- 2.4.2 Uneven ground to SE junction of Kingston Lane and Park Lane is thought to be the remains of medieval house platforms of the shrunken settlement of Kingston Buci (TQ 2360005300).
- 2.4.3 St. Michael's Church underwent much work from the C12th to C13th and the tower was dismantled and rebuilt after bomb damage in 1941 (TQ 23942050400).

2.6 Post-Medieval

- 2.6.1 The Maltings (TQ 2440005000) was erected in 1816 and comprised a furnace at the west end with malting floor beneath a series of six hipped roofs. The walls consist of flint walls with brick corners.
- 2.6.2 An old windmill (TQ 2440006000) that was shown on various cartographic sources (apparently a Smock Mill) has now been demolished.
- 2.6.3 In 1922, a pestle (TQ2530005200) made of decomposed dolerite was found below the surface of West Road and Fishergate, although the date and current whereabouts of the artefact are unknown.
- 2.6.4 The Shoreham Harbour Locks (TQ2410004800) (now forming part of the 300yd long ship canal which opened in 1854) are located near to the site and was greatly widened and altered since initially opening in 1818.
- 2.6.5 A large pit (TQ 2480006200), interpreted as a chalk quarry, is recorded on cartographic sources, but it's date is unknown.
- 2.6.6 A report of a smuggler's tunnel (TQ 2357405163) from the lighthouse to the cellar of Shoreham College apparently incorporates a priest hole, but no date is available on the SMR listings.

3.0 ARCHAEOLOGICAL METHODOLOGY

3.1 The Ground Works

(Figures 2 and 3)

3.1.1 The monitored ground works included:

- The excavation of foundation/footing trenches for the new buildings, including the excavation/construction of lift shafts for the new flats
- The excavation of service trenches and associated soakaways

3.1.2 The initial ground works commenced with the excavation and construction for the soak-aways. Although the actual excavation of these was not monitored, the excavated pits were kept open for archaeological observation and recording. The removed spoil was also left next to the excavated area for the checking of stray artefacts.

3.1.3 Although the initial excavation of the footing trenches for the new housing development (on the east of the site) was not monitored the sections of these foundations remained open for inspection. Only a small portion of these footings was not observed and the majority of machine excavation was monitored by an archaeologist.

3.1.4 All of the ground works (e.g. footing trenches, lift shafts) associated with the residential flats was excavated under the supervision of an archaeologist.

3.2 Fieldwork Methodology

3.2.1 The complete adopted methodology may be found in the WSI (ASE 2008), what is listed in this section is a brief précis of the detail within that document.

3.2.2 Machining excavation was undertaken by a 360-degree mechanical excavator. All of the intrusive ground works were carried out under archaeological supervision to ensure that any exposed archaeological remains were identified and recorded as per the WSI document (ASE 2008).

3.2.3 During the monitored excavations all revealed deposits were examined for the presence of archaeological features and artefacts. The removed spoil was scanned for the presence of any stray, unstratified artefacts. The uncovered deposits were recorded according to accepted professional standards (IFA 2000 and 2001, EH 1991) using pro-forma context record sheets

3.2.4 A digital photographic record of the areas exposed during the ground works was kept and will form part of the site archive.

3.3 The Archive

3.3.1 The site archive is presently held at the Archaeology South-East offices in Portslade, East Sussex pending submission to a suitable local museum. The contents of the site archive are summarised in Table 1.

Number of Contexts	9 contexts
Number of files/paper record	1 file
Plan and sections sheets	None (several measured sketches)
Photographs	30 digital images

Table 1: Quantification of the Site Archive

4.0 RESULTS

- 4.1 Ground works relating to the proposed development in the eastern part of the site (Figure 3; in pink) comprised of trenches excavated for wall footings. These trenches were c.0.7m wide and c.0.7m deep.
- 4.2 In the western part of the site, excavations for further footing trenches and two c. 5m x 5m lift shafts were observed (Figure 3; in green).
- 4.3 One of three excavations for new soak-aways was observed in the watching brief. This measured roughly 5m x 5m in plan and was situated near to the western edge of the site.
- 4.4 Only evidence of modern activity was uncovered during the watching brief and no artefacts were observed. Across the entire site, modern made ground [100] was observed to a maximum thickness of c. 0.6m. This directly overlay natural brickearth [101], or degraded crushed chalk [102].

Context Number	Type	Description of Deposit	Max. Thickness of Deposit	Height m AOD (max)
100	D	Made ground, a mixed orange-grey-brown silty clay containing frequent whole bricks, concrete rubble and waste metal	0.6m	c.16.1
101	D	Natural geology, brickearth, a brown-orange silty clay	-	c.15.6
102	D	Degraded crushed chalk	-	c.15.6

Table 2: List of Recorded Contexts

5.0 DISCUSSION AND CONCLUSIONS

- 5.1** No archaeological deposits or features were recorded during the archaeological watching brief on land at the former Kingston Works, Gardner Road, Southwick.
- 5.2** The monitored areas contained substantial deposits of made ground [100], a mixture of the remnants of the demolition of, and levelling material for, the former Kingston Works.
- 5.3** The degraded chalk layer [102] most likely represents redeposited Geological Head also used as levelling material in association with the construction of the former Kingston Works.
- 5.4** As the watching brief was entirely negative, it is reasonable to surmise that the development at the former Kingston Works will have no impact on the archaeological resource.

BIBLIOGRAPHY

British Geological Survey Sheets *Brighton and Worthing: Sheet 318/333* (Solid and Drift Edition) 1:50 000 Series.

ASE 2008. *Written Scheme of Investigation*. Unpublished ASE Document.

English Heritage, 1991. *The Management of Archaeological Projects*. 2nd edition. London: English Heritage.

IFA 2000. The Institute of Field Archaeologists' *Code of Conduct*.

IFA 2001. The Institute of Field Archaeologists' *Standards and Guidance* documents.

WSCC 2008 *Recommended Standard Archaeological Conditions, version b2*

Winbolt, S. E. 1932. *Roman Villa at Southwick*. SAC 73: 12-32.

ACKNOWLEDGEMENTS

The co-operation and assistance of Mark Taylor of West Sussex County Council, and Brian Parks and Dave Chatfield of Denne has been greatly acknowledged.

SMR Summary Form

Site Code	GRS 08					
Identification Name and Address	Kingston Works, Gardner Road, Southwick					
County, District &/or Borough	West Sussex					
OS Grid Refs.	TQ 3252 0530					
Geology	Brickearth with Chalk head deposits					
Arch. South-East Project Number	3463					
Type of Fieldwork	Eval.	Excav.	Watching Brief	Standing Structure	Survey	Other
Type of Site	Green Field	Shallow Urban	Deep Urban	Other		
Dates of Fieldwork	Eval.	Excav.	WB. 18-02-09 – 18-03-09	Other		
Sponsor/Client	CM Parker Browne					
Project Manager	Giles Dawkes					
Project Supervisor	Dylan Hopkinson and Kathy Grant					
Period Summary	Palaeo. None	Meso. None	Neo. None	BA None	IA None	RB None
	AS None	MED None	PM None	Other Modern activity only		
<p>100 Word Summary.</p> <p>Archaeology South-East was commissioned by the Philip Pank Partnership, on behalf of Hyde Housing Association to undertake an archaeological watching brief during ground works associated with the construction of a new residential development at the former Kingston Works, Gardner Road, Southwick, West Sussex (centred at NGR 52535 10530). The archaeological watching brief took place between 18th February and 18th March 2009. The ground works revealed deposits consisting of modern made ground associated with construction works for the former Kingston Works. Natural geology varied from mid brown-orange silty clay brickearth to degraded chalk stratum perhaps representing redeposited Head Deposit. Natural geology was recorded at a maximum height of 0.5m below ground surface (c.15.6m AOD). No archaeological deposits, features or artefacts were encountered during the watching brief monitoring of the ground works.</p>						

OASIS Form

OASIS ID: archaeol6-57389

Project details

Project name Kingston Works, Gardner Road, Southwick

Short description of the project Archaeology South-East was commissioned by the Philip Pank Partnership, on behalf of Hyde Housing Association to undertake an archaeological watching brief during ground works associated with the construction of a new residential development at the former Kingston Works, Gardner Road, Southwick, West Sussex (centred at NGR 52535 10530). The archaeological watching brief took place between 18th February and 18th March 2009. The ground works revealed deposits consisting of modern made ground associated with construction works for the former Kingston Works. Natural geology varied from mid brown-orange silty clay brickearth to degraded chalk stratum perhaps representing redeposited Head Deposit. Natural geology was recorded at a maximum height of 0.5m below ground surface (c.15.6m AOD). No archaeological deposits, features or artefacts were encountered during the watching brief monitoring of the ground works.

Project dates Start: 18-02-2009 End: 18-03-2009

Previous/future work No / Not known

Any associated project reference codes GRS 09 - Sitecode

Any associated project reference codes ADC/0783/07 - Planning Application No.

Type of project Recording project

Monument type NONE None

Significant Finds NONE None

Investigation type 'Watching Brief'

Prompt Planning condition

Project location

Country England
Site location WEST SUSSEX ADUR SHOREHAM BY SEA Kingston Works,
 Gardner Road, Southwick

Postcode BN42 4

Site coordinates TQ 253 053 50.8330807099 -0.220473883702 50 49 59 N 000 13
 13 W Point

Height OD / Depth Min: 15.50m Max: 15.60m

Project creators

Name of Organisation Archaeology South-East

Project brief originator Archaeology South-East

Project design originator west sussex county council

Project director/manager Jon Sygrave

Project supervisor Kathryn Grant

Type of sponsor/funding body Client

Entered by Kathryn Grant (Kathryn.Grant@ucl.ac.uk)
Entered on 26 March 2009

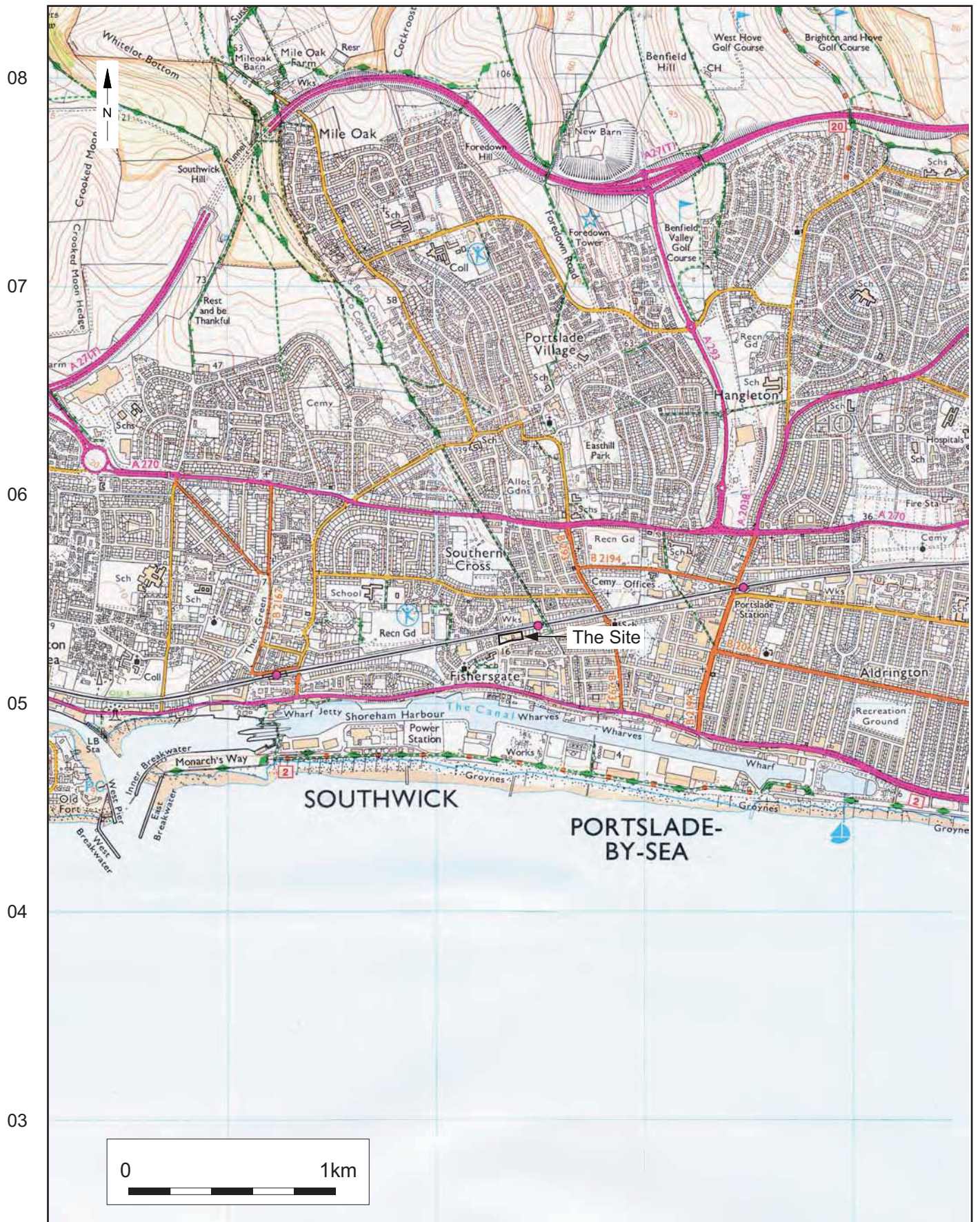

© Archaeology South-East		Gardner Road, Southwick	Fig. 1
Project Ref: 3463	March 2009	Site Location Plan	
Report Ref: 2009054	Drawn by: JLR		

Reproduced from the Ordnance Survey's 1:25000 map of 1997 with permission of the Controller of Her Majesty's Stationary Office. Crown Copyright. Licence No. AL 503 10 A

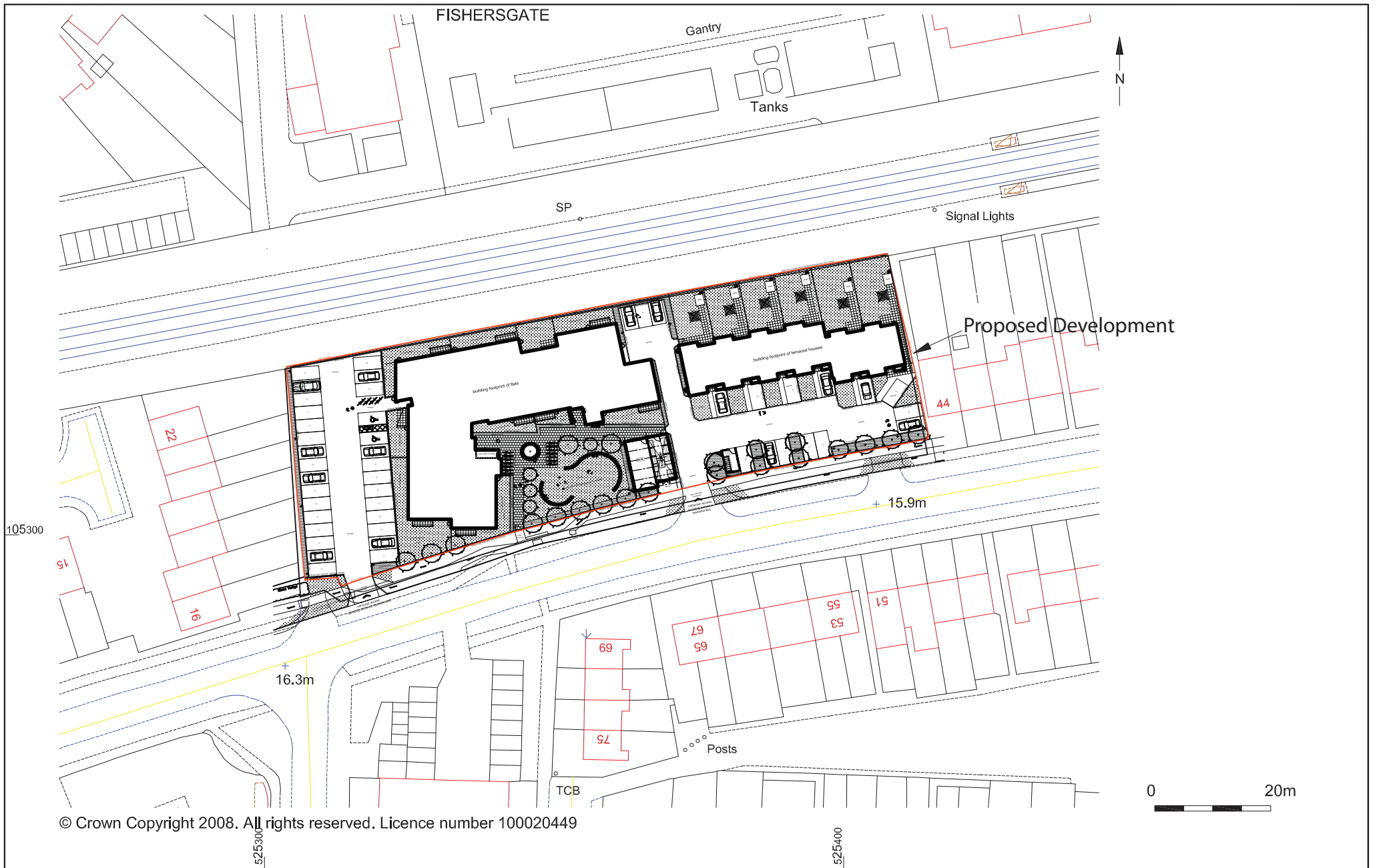

© Archaeology South-East

Project Ref: 3463
Report Ref: 2009054

April 2009
Drawn by: LD

Kingston Works, Gardner Road, Southwick

Plan Showing Proposed Development

Fig. 2



© Archaeology South-East		Gardner Road, Southwick	
Project Ref: 3463	April 2009	Plan of monitored ground works	
Report Ref: 2009054	Drawn by: LD	Fig. 3	

Head Office
Units 1 & 2
2 Chapel Place
Portslade
East Sussex BN41 1DR
Tel: +44(0)1273 426830 Fax: +44(0)1273 420866
email: fau@ucl.ac.uk
Web: www.archaeologyse.co.uk



London Office
Centre for Applied Archaeology
Institute of Archaeology
University College London
31-34 Gordon Square, London, WC1 0PY
Tel: +44(0)20 7679 4778 Fax: +44(0)20 7383 2572
Web: www.ucl.ac.uk/caa

The contracts division of the Centre for Applied Archaeology, University College London 

©Archaeology South-East