

**An Archaeological Watching Brief at
5 High Street, Sevenoaks, Kent**

Planning Ref: SE/04/02601

TQ 53108, 54159

**Project No: 3708
Site Code: SEV 08**

**ASE Report No. 2009065
OASIS id: archaeo16-59844**

By Greg Priestley-Bell

May 2009

**An Archaeological Watching Brief at
5 High Street, Sevenoaks, Kent**

Planning Ref: SE/04/02601

TQ 53108, 54159

**Project No: 3708
Site Code: SEV 08**

**ASE Report No. 2009065
OASIS id: archaeol6-59844**

By Greg Priestley-Bell

May 2009

**Archaeology South-East
Units 1 & 2
2 Chapel Place
Portslade
East Sussex
BN41 1DR**

**Tel: 01273 426830
Fax: 01273 420866
Email: fau@ucl.ac.uk**

Abstract

Archaeology South-East was commissioned by Doug Hume to carry out a watching brief during the construction of a new detached dwelling behind No 5 High Street, Sevenoaks, Kent.

With the possible exception of a probably post-medieval/modern mortar floor, no significant archaeological features or finds were revealed.

CONTENTS

- 1.0 Introduction**
- 2.0 Historical and Archaeological Background**
- 3.0 Methodology and Aims**
- 4.0 Results**
- 5.0 Finds**
- 6.0 Discussion**
- 7.0 Conclusions**

Bibliography
Acknowledgements

SMR Summary Sheet

OASIS Form

Tables

- Table 1: Gazetteer of Sites, Finds and Listed Buildings within a 500 m radius
- Table 2: Quantification of site archive
- Table 3: Quantification of the finds

Figures

- Fig 1: Site location plan
- Fig 2: Site location plan with HER data
- Fig 3: Trench plan
- Fig 4: Plan showing monitored areas

Plates

- Plate 1: Western footing trench, looking north

1.0 INTRODUCTION

- 1.1** Archaeology South-East (ASE), a division of University College London Centre for Applied Archaeology (UCLCAA), was commissioned by Doug Hume to undertake an archaeological watching brief during ground works associated with the demolition of an existing garage block and the construction of a new detached dwelling with integral garage on land to the rear of No. 5 High Street, Sevenoaks, Kent, henceforth referred to as 'the site' (NGR 553108, 154159; Figure 1).
- 1.2** The site is located at the southern end of Sevenoaks High Street, c. 50m south-west of the junction with Oak Lane. The site lies in the footprint of a demolished garage immediately to the rear of No. 5 High Street, Sevenoaks. The site is bounded to the west by the car park to the rear of The Royal Oak Tap Public House, and to the south and east by properties off the High Street. The underlying geology, according to the British Geological Survey map is Folkestone Beds.
- 1.3** Planning permission was granted by Sevenoaks District Council for the construction of a detached dwelling with integral garage (planning ref. SE/04/02601). Following consultation between Kent County Council and the council's own Heritage Conservation Group, a condition was attached to the permission requiring that:
- 'No development shall take place until the applicant, or their agents or successors in title, has secured the implementation of a watching brief to be undertaken by an archaeologist approved by the Local Planning Authority so that the excavation is observed and items of interest and finds are recorded. The watching brief shall be in accordance with a written programme and specification which has been submitted to and approved by the Local Planning Authority.'*
- 1.4** A Specification for the watching brief was produced by the Heritage Conservation Group, Kent County Council (KCC, 2005). Details of the techniques to be used were set out in the specification, a copy of which is contained within the archive. The specification also stated that if significant remains were revealed during the watching brief, further archaeological measures might be required to secure mitigation on the site. The specification provided background information which has been re-used in this report with due acknowledgement.
- 1.5** The watching brief produced negative results and the present document constitutes a 'Watching Brief Report' (as defined by Heritage Conservation Group, KCC).
- 1.6** The watching brief was carried out over two days, 7th and 9th April 2009, by Greg Priestley-Bell (Senior Archaeologist), the project was project managed by Neil Griffin (fieldwork) and Dan Swift (post excavation).

2.0 HISTORICAL AND ARCHAEOLOGICAL BACKGROUND

2.1 The site lies within the medieval and post-medieval settlement of Sevenoaks with several properties from these periods within the vicinity. St Nicholas's Church lies c. 135m to the north of the site and originates from the medieval period. The origins and form of Sevenoaks as a medieval settlement are unclear but it is thought at present that the historic centre of Sevenoaks, including the medieval market area, lay in the area of St Nicholas's Church. The market may have moved in the 13th century into the triangular area formed by the convergence of London Road and the High Street to the north of the site.

2.2 The Historic Environment Record (HER) maintained by KCC, and held at County Hall, Maidstone, was consulted and the results are summarised below. Details were taken of all archaeological sites and listed buildings within a 500 metre radius of the centre of the site. The identified sites (numbered 1 – 82) are tabulated below, and plotted on Figure 2.

Table 1: Gazetteer of Sites, Finds and Listed Buildings within a 500 m Radius of No. 5 High Street, Sevenoaks

	NGR	SMR Reference	Period	Details/Description
1.	TQ 53 54	TQ 55 SW 5	Iron Age	Find spot Iron Age stater
2.	TQ 5311 5431	TQ 55 SW MKE30713	Medieval	Listed Building, Church of St Nicholas 13 th century
3.	TQ 5316 5429	TQ 55 SW 21	Medieval	16 th ?century well
4.	TQ 5317 5419	TQ 55 SW 27	Medieval	Listed Building, Sevenoaks Almshouses
5.	TQ 5308 5457	TQ 55 SW 32	Medieval	Sevenoaks Town
6.	TQ 531 537	TQ 55 SW 3	Medieval	Battlefield 1450, Sole Fields
7.	TQ 53045 54532	TQ 55 SW 50	Medieval	Ditch with 13 th -century pottery
8.	TQ 5311 5430	TQ 55 SW 1	Medieval to Unknown	Church of St Nicholas, Sevenoaks, from 13 th century. Cemetery from Post-Medieval period
9.	TQ 5306 5460	TQ 55 SW MKE30649	Medieval -Post-Medieval	Listed Building, The Chequers Inn
10.	TQ 5314 5415	TQ 55 SW MKE30673	Medieval - Post-Medieval	Listed Building, Almshouses from 1432
11.	TQ 5312 5421	TQ 55 SW MKE30685	Medieval - Post-Medieval	Listed Building, house and post-office, 13 High Street
12.	TQ 5312 5423	TQ 55 SW MKE30686	Medieval - Post-Medieval	Listed Building, house, 17 High Street

Archaeology South-East
 Archaeological WB at 5 High Street, Sevenoaks, Kent
 ASE Report no: 2009065

13.	TQ 5312 5422	TQ 55 SW MKE30712	Medieval - Post-Medieval	Listed Building, house, 15 High Street
14.	TQ 5307 5454	TQ 55 SW MKE32014	Medieval - Post-Medieval	Listed Building, house, 63 & 65 High Street
15.	TQ 5312 5422	TQ 55 SW 9	Post-Medieval	Listed Building, Inn, 15 High Street
16.	TQ 5313 5423	TQ 55 SW 10	Post-Medieval	Listed Building, Inn houses, 17 High Street
17.	TQ 5316 5437	TQ 55 SW 11	Post-Medieval	Listed Building, house, 18 High Street
18.	TQ 5313 5451	TQ 55 SW 12	Post-Medieval	Listed Building, house, 50 High Street
19.	TQ 5317 5419	TQ 55 SW 13	Post-Medieval	Listed Building, Sevenoaks School
20.	TQ 5313 5426	TQ 55 SW 15	Post-Medieval	Listed Building, Chantry house
21.	TQ 5312 5422	TQ 55 SW 16	Post-Medieval	Listed Building, house, 13 High Street
22.	TQ 5341 5430	TQ 55 SW 23	Post-Medieval	Listed Building, 19 th century main lodge entrances to Knole
23.	TQ 5317 5419	TQ 55 SW 28	Post-Medieval	Listed Building, Sevenoaks School
24.	TQ 5317 5419	TQ 55 SW 29	Post-Medieval	Listed Building, Sevenoaks School
25.	TQ 536 542	TQ 55 SW 38	Post-Medieval	Listed Building, Ice House, Knole Park
26.	TQ 5312 5443	TQ 55 SW MKE30628	Post-Medieval	Listed Building, cottage, 3 Six Bells Lane
27.	TQ 5311 5442	TQ 55 SW MKE30629	Post-Medieval	Listed Building, cottage, 8 Six Bells Lane
28.	TQ 5308 5442	TQ 55 SW MKE30630	Post-Medieval	Listed Building, cottage, 12-16 Six Bells Lane, including lamp bracket with lantern
29.	TQ 5307 5441	TQ 55 SW MKE30633	Post-Medieval	Listed Building, gas lamp by 1 Six Bells Lane
30.	TQ 5312 5424	TQ 55 SW MKE30643	Post-Medieval	Listed Building, house, 21 High Street
31.	TQ 5313 5440	TQ 55 SW MKE30644	Post-Medieval	Listed Building, house, 23 High Street
32.	TQ 5314 5440	TQ 55 SW MKE30645	Post-Medieval	Listed Building, house, 25 High Street
33.	TQ 5314 5441	TQ 55 SW MKE30646	Post-Medieval	Listed Building, house, 27 High Street
34.	TQ 5314 5442	TQ 55 SW MKE30647	Post-Medieval	Listed Building, house, 31-37 High Street
35.	TQ 5308 5452	TQ 55 SW MKE30648	Post-Medieval	Listed Building, house, 57 and 59 High Street

Archaeology South-East
 Archaeological WB at 5 High Street, Sevenoaks, Kent
 ASE Report no: 2009065

36.	TQ 5313 5440	TQ 55 SW MKE30656	Post-Medieval	Listed Building, house, 8 London Road
37.	TQ 5309 5421	TQ 55 SW MKE30664	Post-Medieval	Listed Building, house, 1-3 Oak Square
38.	TQ 5316 5425	TQ 55 SW MKE30674	Post-Medieval	Listed Building, house, 2 High Street
39.	TQ 5315 5432	TQ 55 SW MKE30675	Post-Medieval	Listed Building, house, 8 High Street, Manor House Cottages
40.	TQ 5316 5435	TQ 55 SW MKE30676	Post-Medieval	Listed Building, house, 14 and 16 High Street
41.	TQ 5316 5440	TQ 55 SW MKE30677	Post-Medieval	Listed Building, house, 2 High Street
42.	TQ 5315 5446	TQ 55 SW MKE30678	Post-Medieval	Listed Building, house, 38 High Street
43.	TQ 5312 5415	TQ 55 SW MKE30683	Post-Medieval	Listed Building, 18 th -century The Royal Oak Tap, High Street
44.	TQ 5311 5417	TQ 55 SW MKE30684	Post-Medieval	Listed Building, The Royal Oak Hotel, High Street
45.	TQ 5313 5435	TQ 55 SW MKE30688	Post-Medieval	Listed Building, house, The Old Vicarage, High Street
46.	TQ 5315 5422	TQ 55 SW MKE30703	Post-Medieval	Listed Building, archway connecting to the Almshouses
47.	TQ 5315 5422	TQ 55 SW MKE30704	Post-Medieval	Listed Building, side screen walls connecting the Almshouses
48.	TQ 5317 5430	TQ 55 SW MKE30705	Post-Medieval	Listed Building, The Manor House, 6 High Street
49.	TQ 5316 5434	TQ 55 SW MKE30706	Post-Medieval	Listed Building, house, 12 High Street
50.	TQ 5315 5437	TQ 55 SW MKE30707	Post-Medieval	Listed Building, The Old House, 18 High Street
51.	TQ 5312 5451	TQ 55 SW MKE30708	Post-Medieval	Listed Building, The Red House, 50 High Street
52.	TQ 5311 5420	TQ 55 SW MKE30711	Post-Medieval	Listed Building, house, 7-11 High Street
53.	TQ 5303 5463	TQ 55 SW MKE30718	Post-Medieval	Listed Building, house, 10 London Road
54.	TQ 5315 5430	TQ 55 SW MKE31501	Post-Medieval	Listed Building, Gates and wall, Park Grange Lodge
55.	TQ 5312 5410	TQ 55 SW MKE31514	Post-Medieval	Listed Building, Park Grange Lodge, High Street
56.	TQ 5304 5461	TQ 55 SW MKE31984	Post-Medieval	Listed Building, house, 6 London Road
57.	TQ 5316 5433	TQ 55 SW MKE31994	Post-Medieval	Listed Building, Manor House Cottages, 10 High Street
58.	TQ 5316 5438	TQ 55 SW MKE31995	Post-Medieval	Listed Building, house, 20 and 24 High Street
59.	TQ 53047 54530	TQ 55 SW 52	Post-Medieval	Excavation: wall, metallated surface and cess pit

Archaeology South-East
 Archaeological WB at 5 High Street, Sevenoaks, Kent
 ASE Report no: 2009065

60.	TQ 5313 5443	TQ 55 SW MKE32004	Post-Medieval	Listed Building, house, 1 & 2 Six Bells Lane
61.	TQ 5312 5443	TQ 55 SW MKE32005	Post-Medieval	Listed Building, house, 4 Six Bells Lane
62.	TQ 5309 5442	TQ 55 SW MKE32006	Post-Medieval	Listed Building, house, 10 & 11 Six Bells Lane
63.	TQ 5306 5431	TQ 55 SW MKE32008	Post-Medieval	Listed Building, house, gas lamp by churchyard
64.	TQ 5314 5441	TQ 55 SW MKE32012	Post-Medieval	Listed Building, house, 27 High Street
65.	TQ 5312 5446	TQ 55 SW MKE32013	Post-Medieval	Listed Building, house, 43 High Street
66.	TQ 5305 5461	TQ 55 SW MKE32015	Post-Medieval	Listed Building, house, 75 High Street
67.	TQ 5340 5428	TQ 55 SW MKE32018	Post-Medieval	Listed Building, house, main lodge entrance Knole Park
68.	TQ 53201 54579	TQ 55 SW 51	Post-Medieval	Excavation: pit with 18 th -19 th -century pottery
69.	TQ 5263 5412	TQ 55 SW MKE31587	Post-Medieval - Modern	Listed Building, house, 121 Kippington Road
70.	TQ 5308 5454	TQ 55 SW MKE30680	Post-Medieval - Modern	Listed Building, house, 90 and 92 High Street
71.	TQ 5313 5426	TQ 55 SW MKE30687	Post-Medieval- Modern	Listed Building, house, Chantry House including gateway and screen wall, High Street
72.	TQ 5264 5425	TQ 55 SW MKE31509	Post-Medieval - Modern	Listed Building, Gas lamp, Oak Hill Road
73.	TQ 5264 5426	TQ 55 SW MKE31591	Post-Medieval- Modern	Listed Building, gas lamp by Tall Firs, Oakhill Road
74.	TQ 5309 5463	TQ 55 SW MKE31976	Post-Medieval - Modern	Listed Building, house, 86 High Street
75.	TQ 5312 5414	TQ 55 SW MKE31977	Post-Medieval - Modern	Listed Building, house, 1 High Street
76.	TQ 5316 5441	TQ 55 SW MKE31978	Post-Medieval - Modern	Listed Building, house 28 and 30 High Street
77.	TQ 5320 5409	TQ 55 SW MKE31992	Post-Medieval - Modern	Listed Building, Sevenoaks School, High Street
78.	TQ 5317 6427	TQ 55 SW MKE31993	Post-Medieval - Modern	Listed Building, Claridge House, High Street
79.	TQ 5314 5447	TQ 55 SW MKE31996	Post-Medieval - Modern	Listed Building, house, 46 High Street
80.	TQ 5308 5463	TQ 55 SW MKE31997	Post-Medieval - Modern	Listed Building, house, 88 High Street
81.	TQ 5307 5459	TQ 55 SW MKE31583	Modern	Listed Building, Telephone Kiosk High Street/London Rd junction
82.	TQ 5310 5458	TQ 55 SW MKE30679	Modern	Listed Building, National Westminster Bank, 70 High Street

2.3 Cartographic evidence

- 2.3.1** The 1769 Andrews, Dury and Herberts map (not included) appears to show an L-shaped building on the corner of High Street and Oak Lane (south side); no adjacent buildings are shown on the subject site. Hasted's 1799 map (not included) shows a single stylised building on the corner, while the 1800 OS field drawing (not included) shows the same L-shaped building; the map does not extend any further to the south (Heritage Conservation Group, 2004).
- 2.3.2** It is not until the 19th century that No. 5 High Street is clearly defined. The 1870 OS map (not included) shows the inverted L-shaped building immediately to the north (the present Royal Oak Tap Public House) as a 'Hotel' and No 5 High Street much as it is today; a now disappeared square building is shown on, or immediately adjacent to, the subject site. No trace of this building was identified during the current work.

3.0 METHODOLOGY and AIMS

- 3.1** A continuous watching brief was maintained during the hand excavation of strip footings and test holes (Figures 3 and 4). The footings trenches were c. 1m wide and c. 1m deep below existing ground level (Plate 1), while the test holes were up to c. 0.50m wide and c. 0.50m deep.
- 3.2** Archaeological monitoring was conducted following the details of the techniques to be used set out in the specification document (KCC, 2005). Archaeological monitoring included an inspection of excavated material in order to identify and retrieve artefacts and ecofacts, and an examination of exposed surfaces for archaeological remains.
- 3.3** Provision was made for all identified significant archaeological remains to be recorded to accepted professional standards and in accordance with *Standards and Guidance: watching brief* of the Institute for Archaeologists (IfA). Provision was also made for the collection of environmental samples from appropriate deposits – no such deposits were encountered. Full details of the techniques used are contained within the archive.

Number of Contexts	5 contexts
No. of files/paper record	1 file
Plan and sections sheets	1 trench location plan
Photographs	15 photographs

Table 2: Quantification of site archive

- 3.4** The general aim of the archaeological watching brief is to contribute to the understanding of the history of Sevenoaks through the recording of any archaeological remains exposed as a result of excavations in connection in connection with the ground works.
- 3.5** Particular attention is paid to the character, depth below ground level, condition, date and significance of the deposits.

4.0 RESULTS

- 4.1 No topsoil was present. The site was covered by interior and exterior hard standing Context [01] between 80mm – 120mm thick. Interior hard standing was a concrete and paved floor relating to the demolished garage, while exterior hard standing was tarmac (50mm thick) and gravel base [05] (100mm thick) relating to the use of part of the area as an exterior car park.
- 4.2 Hard standing [01] overlay a compact 80mm thick layer of mid whitish yellow very sandy silt [02]. Context [02] overlay a mid/dark yellowish brown very silty sand [03] that produced 19th-century or later material. Context [03] overlay 'natural' [04].
- 4.3 Natural [04] comprised mid yellowish brown silty sand (Folkestone Beds).
- 4.4 Although modern services for No 5 High Street and a 20th-century soakaway associated with the demolished garage were noted, no significant archaeological features were revealed.

5.0 FINDS

- 5.1 Only context [03] contained finds, consisting of ceramic building material (CBM) and a single piece of glass.

Context	CBM	wt (g)	Glass	wt (g)
03	4	744	1	94

Table 3. Quantification of the finds

5.2 The Ceramic Building Material by Sarah Porteus

- 5.2.1 A single fragment of brick and three fragments of peg tile were recovered from context [03]. The brick is of fine orange fabric with a scatter of fine mica and coarse iron rich inclusions and is most likely of 18th- to 19th-century date.
- 5.2.2 Two of the peg tile fragments are of typical Kent fabrics, one pinkish orange calcareous fabric and the other poorly mixed creamy yellow fabric (Canterbury Archaeological Trust codes CAT32 and CAT37 respectively). Both are likely to be of 17th- to 19th-century date.
- 5.2.3 A third peg tile fragment is under fired and brown with sparse very coarse red and black iron-rich inclusions and coarse pale silt inclusions with very coarse quartz and is probably of 17th- to 19th-century date.

5.3 The Glass by Elke Raemen

- 5.3.1** An aqua body sherd from a Hamilton bottle was recovered from [03]. The piece is plain, lacking any maker's marks, and dates to the late 19th to early 20th century.

5.4 Finds Assemblage Potential

- 5.4.1** The assemblage is too small to have any potential for further analysis. No further work is required.

6.0 DISCUSSION

- 6.1** Context [02] was a mortar floor or hard standing, while deposit [03] was the made ground base for mortar floor [02]. A late 19th-century to early 20th-century bottle fragment, together with 17th- to 19th-century ceramic building material (CBM) was recovered from deposit [03].
- 6.2** Floor/hard standing [02] perhaps related to a square building which stood on the site, first identified on the 1870 OS map (see para. 3.2.2). This building perhaps related to the previous use of the site as a public house (Greg Hendrick *pers. comm.*).

7.0 CONCLUSIONS

- 7.1** The lack of significant archaeological remains identified on the site may be due to possible terracing and truncation. However, had a high level of activity occurred on the site during any later prehistoric or early historic period, a significant quantity of residual material might be expected. No such material was identified. In view of this, it is likely that there was only a low level of activity on the site in antiquity. Consequently, the current development is likely to have a minimal detrimental effect upon the archaeological record.
- 7.2** A continuous watching brief during significant ground works is the most effective way to monitor development in areas of proven archaeological potential.

BIBLIOGRAPHY

English Heritage, 1991. *The Management of Archaeological Projects*. 2nd edition. London: English Heritage.

Heritage Conservation Group, Kent County Council 2004. *Kent Historic Towns Survey: Sevenoaks: Archaeological assessment document*

Heritage Conservation Group, Kent County Council 2005. *Specification for an archaeological watching brief at land to the rear of the Royal Oak Tap Public House, High Street, Sevenoaks during the demolition of an existing garage block and the construction of a detached dwelling with integral garage.*

IFA 2000. The Institute of Field Archaeologists' *Code of Conduct*.

IFA 2001. The Institute of Field Archaeologists' *Standards and Guidance* documents.

ACKNOWLEDGEMENTS

ASE would like to thank Doug Hume for commissioning the work and KCC for providing advice on the project.

SMR Summary Form

Site Name: Land to the rear of No.5 High Street, Sevenoaks, Kent	
Site Address: 5 High Street, Sevenoaks, Kent	
Summary: Archaeology South-East was commissioned by Doug Hume to carry out a watching brief during the construction of a new detached dwelling behind No 5 High Street, Sevenoaks, Kent. With the possible exception of a probably post-medieval/modern mortar floor, no significant archaeological features or finds were revealed.	
District/Unitary: Sevenoaks District Council	Parish: Sevenoaks, St Nicholas
Nature of Development: Demolition of an existing garage block and the construction of a detached dwelling with integral garage	
Period(s): Post-Medieval/Modern	
NGR (centre of site : 8 figures): NGR 553108 154159	
Type of archaeological work Watching Brief	
Date of Recording: 7 th and 9 th April 2009	
Unit undertaking recording: Archaeology South-East	
Geology: Folkestone Beds	
Title and author of accompanying report: An Archaeological Watching Brief at Land to the rear of No.5 High Street, Kent by Greg Priestley-Bell	
Summary of fieldwork results Post-Medieval/Modern: Made ground	
Likelihood of surviving archaeological remains on-site: Low to Medium:	
Location of archive/finds: Currently held at the offices of ASE	
Contact at Unit: Neil Griffin	Date: 31 May 2009

OASIS Form

OASIS ID: archaeol6-59844	
Project details	
Project name	An Archaeological Watching Brief at No 5 High Street, Sevenoaks, Kent
Short description of the project	Archaeology South-East was commissioned by Doug Hume to carry out a watching brief during the construction of a new residence behind No 5 High Street, Sevenoaks, Kent. No significant archaeological features or finds were revealed.
Project dates	Start: 07-04-2009 End: 09-04-2009
Previous/future work	No / No
Any associated project reference codes	SEV 08 - Sitecode
Type of project	Recording project
Site status	Conservation Area
Current Land use	Residential 1 - General Residential
Monument type	MADE GROUND Post Medieval
Monument type	MADE GROUND Modern
Significant Finds	GLASS Post Medieval
Significant Finds	CBM Modern
Investigation type	'Watching Brief'
Prompt	Planning condition
Project location	
Country	England
Site location	KENT SEVENOAKS SEVENOAKS 5 High Street Sevenoaks, Kent
Postcode	TN 13 1
Study area	60.00 Square metres
Site coordinates	TQ 53108 54159 51.2654559378 0.194845327515 51 15 55 N 000 11 41 E Point
Height OD / Depth	Min: 154.00m Max: 155.00m
Project creators	
Name of Organisation	Archaeology South East
Project brief originator	Kent County Council

Project design originator	Kent County Council
Project director/manager	Neil Griffin
Project supervisor	Greg Priestley-Bell
Type of sponsor/funding body	Developer
Project archives	
Physical Archive recipient	Local Museum
Physical Contents	'Ceramics','Glass'
Digital Archive recipient	Local Museum
Digital Contents	'none'
Digital Media available	'Images raster / digital photography','Text'
Paper Archive recipient	Local Museum
Paper Contents	'other'
Paper Media available	'Context sheet','Correspondence','Notebook - Excavation',' Research',' General Notes','Photograph','Plan','Report'
Project bibliography 1	
Publication type	Grey literature (unpublished document/manuscript)
Title	An archaeological watching brief at No 5 High Street, Sevenoaks, Kent
Author(s)/Editor(s)	Priestley-Bell, G.
Other bibliographic details	2009065
Date	2009
Issuer or publisher	Archaeology South-East
Place of issue or publication	Portslade
Description	Booklet
Entered by	Greg Priestley-Bell (gregpbell@btinternet.com)
Entered on	22 May 2009



© Archaeology South-East		5 High Street, Sevenoaks	Fig. 1
Project Ref: 3708	April 2009	Site location plan	
Report Ref: 2009065	Drawn by: JLR		

Reproduced from the Ordnance Survey's 1:25000 map of 1997 with permission of the Controller of Her Majesty's Stationary Office. Crown Copyright. Licence No. AL 503 10 A

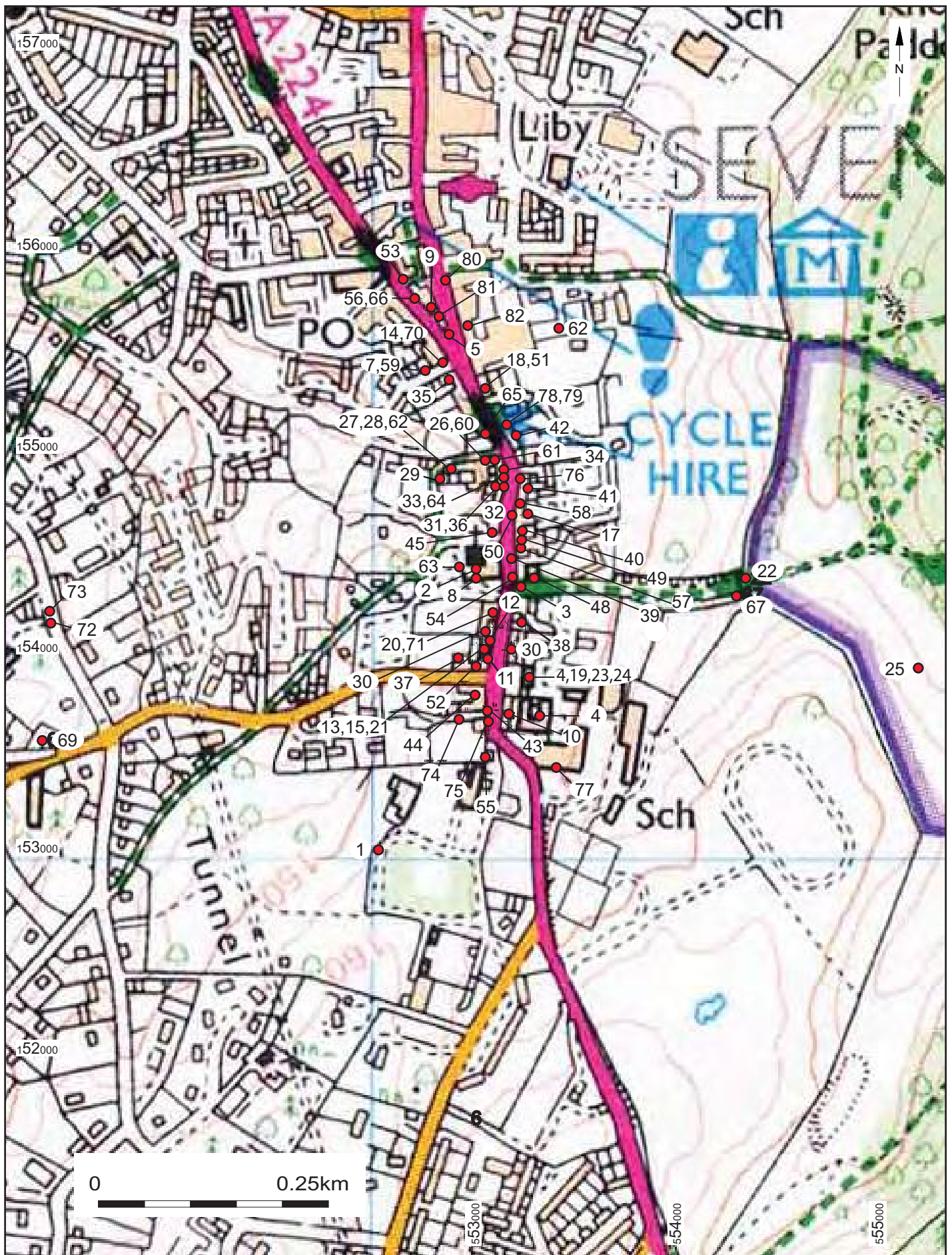

© Archaeology South-East		5 High Street, Sevenoaks	Fig. 2
Project Ref: 3708	April 2009	Site location plan with HER data	
Report Ref: 2009065	Drawn by: HLF		

Reproduced from the Ordnance Survey's 1:25000 map of 1997 with permission of the Controller of Her Majesty's Stationary Office. Crown Copyright. Licence No. AL 503 10 A

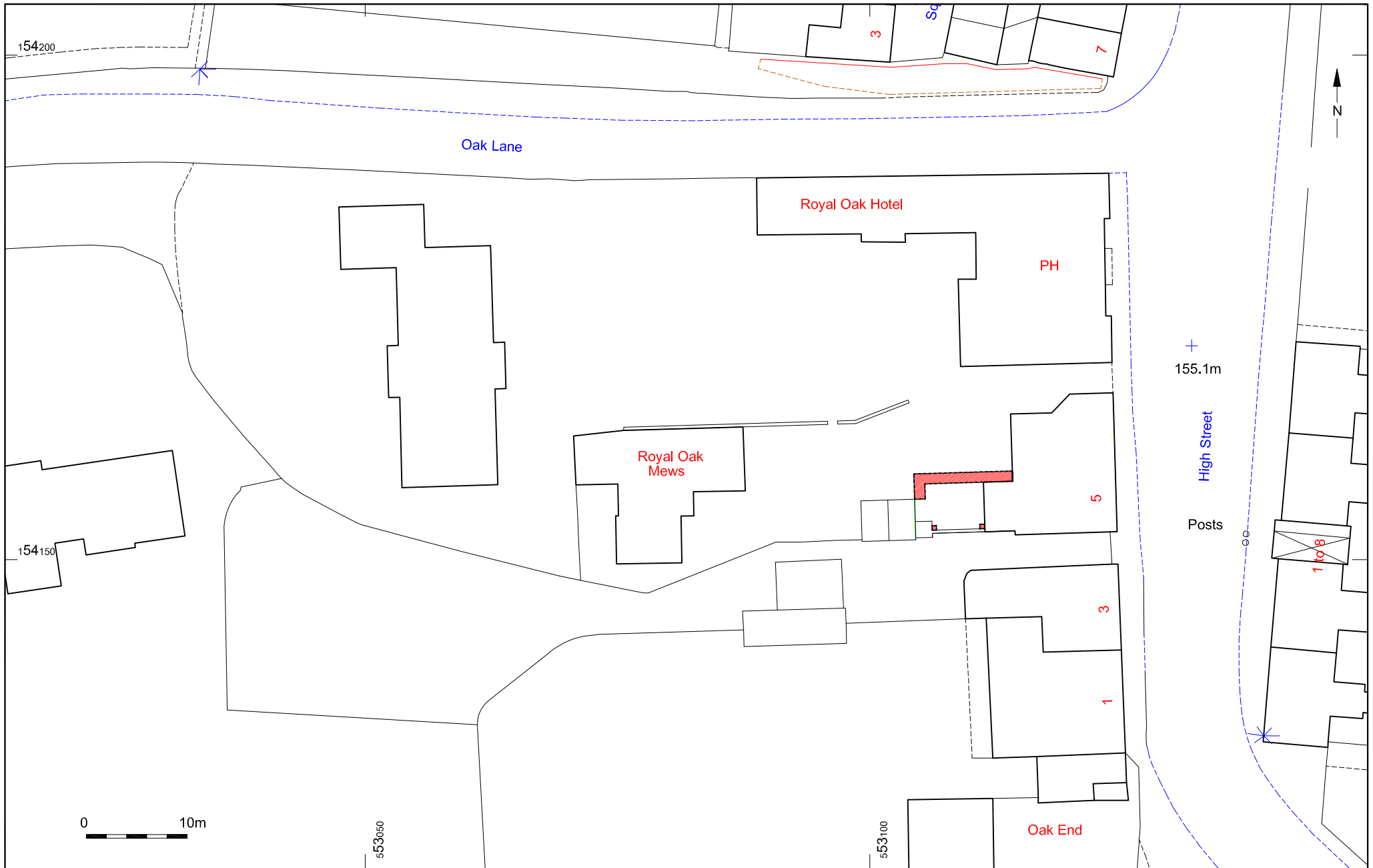

© Archaeology South-East		5 High Street, Sevenoaks	Fig. 3
Project Ref: 3708	April 2009	Trench plan	
Report Ref: 2009065	Drawn by: JLR		

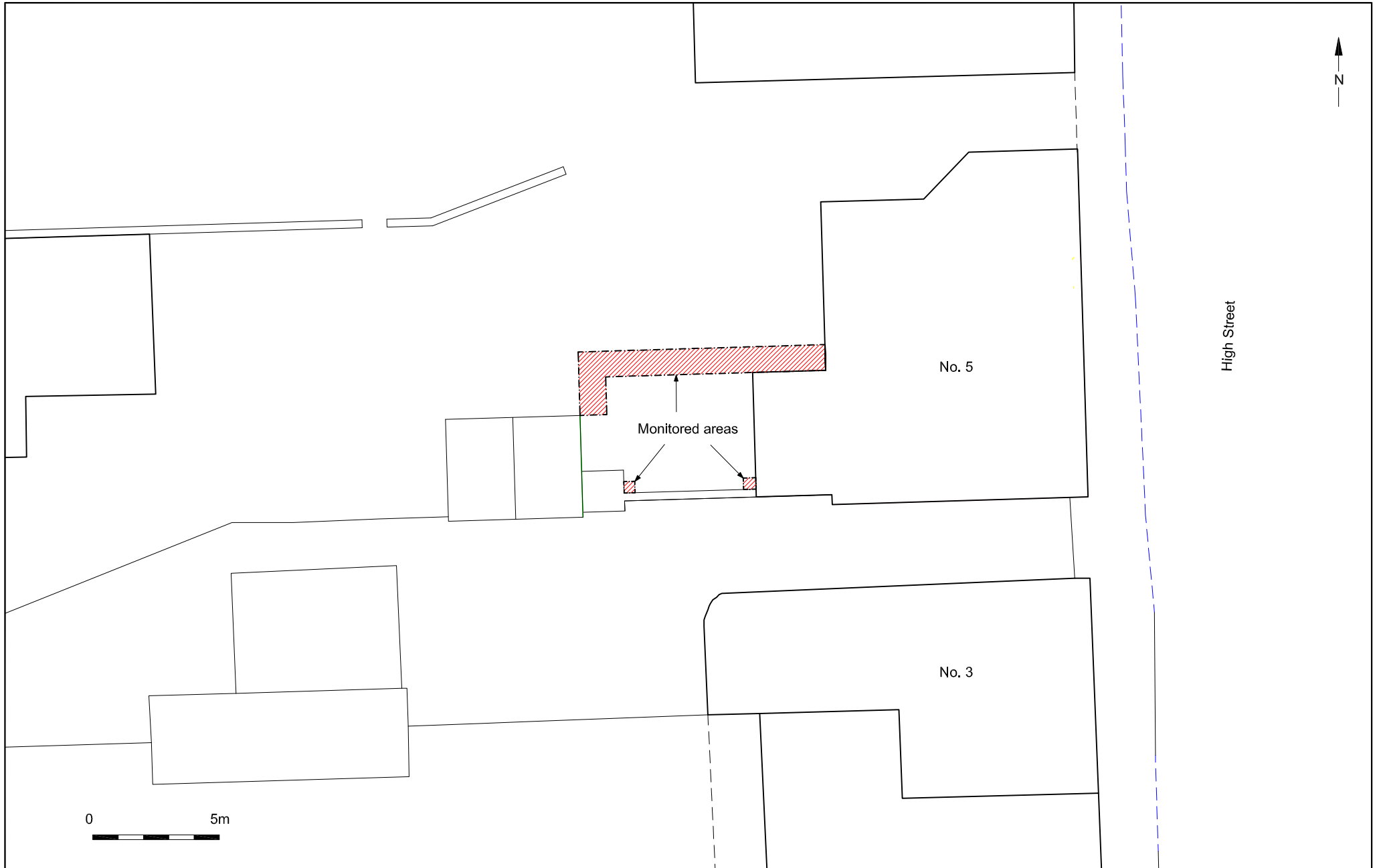

© Archaeology South-East		5 High Street, Sevenoaks	Fig. 4
Project Ref: 3708	April 2009	Plan showing monitored areas	
Report Ref: 2009065	Drawn by: JLR		



Plate 1: Photograph showing the western footing trench, looking north

Head Office
Units 1 & 2
2 Chapel Place
Portslade
East Sussex BN41 1DR
Tel: +44(0)1273 426830 Fax:+44(0)1273 420866
email: fau@ucl.ac.uk
Web: www.archaeologyse.co.uk



London Office
Centre for Applied Archaeology
Institute of Archaeology
University College London
31-34 Gordon Square, London, WC1 0PY
Tel: +44(0)20 7679 4778 Fax:+44(0)20 7383 2572
Web: www.ucl.ac.uk/caa

The contracts division of the Centre for Applied Archaeology, University College London 

©Archaeology South-East