

**An Archaeological Watching Brief at the Site of the Cross,  
East of St Lawrence Church, Mereworth, Kent.**

**Planning Ref:TM/08/03758**

**NGR 566090 153717  
(TQ66090 53717)**



**Project No:3937  
Site Code: TCM09**

**ASE Report No. 2009120  
OASIS id:archaeol6-62873**

**Sarah Porteus**

**August 2009**

**An Archaeological Watching Brief at the Site of the Cross,  
East of St Lawrence Church, Mereworth, Kent.**

**Planning Ref:TM/08/03758**

**NGR 566090 153717  
(TQ66090 53717)**

**Project No:3937  
Site Code: TCM09**

**ASE Report No. 2009120  
OASIS id:archaeol6-62873**

**Sarah Porteus**

**August 2009**

**Archaeology South-East  
Units 1 & 2  
2 Chapel Place  
Portslade  
East Sussex  
BN41 1DR**

**Tel: 01273 426830  
Fax: 01273 420866  
Email: [fau@ucl.ac.uk](mailto:fau@ucl.ac.uk)**

**Abstract**

*Archaeology South-East (ASE) were commissioned by Avenue Building Co. Ltd to undertake a watching brief at the cross, east of St Lawrence Church, Mereworth, Kent during ground works associated with the construction of new offices.*

*No archaeological finds, features or deposits were identified.*

## **CONTENTS**

- 1.0 Introduction**
- 2.0 Archaeological Background**
- 3.0 Archaeological Methodology**
- 4.0 Results**
- 5.0 The Finds and Environmental Samples**
- 6.0 Conclusion**

### **Acknowledgements**

### **SMR Summary Sheet OASIS Form**

## **FIGURES**

- Figure 1: Site Location
- Figure 2: Location of monitored area

## **TABLES**

- Table 1: Quantification of Archive

## **1.0 INTRODUCTION**

### **1.1 Site Background**

- 1.1.1 Archaeology South-East, a division of University College London Centre for Applied Archaeology (UCLCAA), were commissioned by Avenue Building Co. Ltd to undertake a watching brief during ground works associated with the construction of new offices. The site is located at The Cross, Mereworth to the East of St Lawrence church (NGR 566090 153717, Fig 1). The watching brief took place late July 2009.

### **1.2 Geology and Topography**

- 1.2.1 According to the British Geological Survey the site lies on Hythe Beds. The site has a gentle slope from west to east and the land was previously occupied by farm and office buildings with some grassed areas. This has resulted in considerable modern intrusive works and levelling for the insertion of concrete platforms for the buildings which stood onsite prior to commencement of the current works

### **1.3 Planning Background**

- 1.3.1 Planning permission was granted for the construction of new office buildings (ref:TM/08/03758) with an archaeological condition stating that:

*'No development shall take place until the applicant, or their agents or successors in title, has secured the implementation of of a watching brief to be undertaken by an archaeologist approved by the Local Planning Authority so that the excavation is observed and items of interest and finds are recorded. The watching brief shall be in accordance with a written programme and specification, which has been submitted to and approved by the Local Planning Authority'*

### **1.4 Aims and Objectives**

- 1.4.1 The general aim of the archaeological works was to ensure that finds and features of archaeological interest were properly examined and recorded.

### **1.5 Scope of Report**

- 1.5.1 This report represents the findings of the watching brief undertaken by Sarah Porteus (archaeologist) on the 29<sup>th</sup> and 30<sup>th</sup> of July 2009. The project was managed by Darryl Palmer (fieldwork) and Jim Stevenson (post excavation).

## **2.0 ARCHAEOLOGICAL BACKGROUND**

- 2.1 The area of development lies immediately to the east of the 18<sup>th</sup> century church of St Lawrence within the historic centre of Mereworth and close to the 18<sup>th</sup> century Mereworth Castle.

## **3.0 ARCHAEOLOGICAL METHODOLOGY**

- 3.1 Intrusive ground works (Figure 2) were monitored by a suitably qualified archaeologist until archaeological features or the natural subsoil was reached.
- 3.2 A digital photographic record was kept throughout the works.
- 3.3 A measured sketch plan was kept of the location of intrusive modern disturbances found on the site.
- 3.4 All contexts were recorded on standard pro forma recording sheets.

Number of Contexts	4
No. of files/paper record	1
Plan and sections sheets	0
Bulk Samples	0
Photographs	Digital, 1CD
Bulk finds	0
Registered finds	0
Environmental flots/residue	0

Table 1: Quantification of site archive

## 4.0 RESULTS

- 4.1 The intrusive ground works were monitored (Figure 2) and no archaeological finds or features were identified.
- 4.2 The site had been subject to considerable modern intrusive works and levelling for the insertion of concrete platforms for the buildings which stood onsite prior to the commencement of the current works. Modern intrusions included an extensive network of water pipes, a large soak away and Klargest pit and two pits containing modern animal burials with plastic and other modern debris were identified. The tarmac and foundations of the roadway running north south across the site continued to a depth of 0.35m from surface level into the natural.

### List of recorded contexts

Number	Type	Description	Max. Length	Max. Width	Deposit Depth
001	Dep	Topsoil, humic sandy clay.	Tr.	Tr.	0.20m
002	Dep	Natural yellow silty clay	Tr.	Tr.	Tr.
003	Dep	Subsoil, sandy silt	Tr.	Tr.	0.30m
004	intrusions	Modern intrusions	Tr.	Tr.	Continue into natural.

## 5.0 THE FINDS AND ENVIRONMENTAL SAMPLES

- 5.1 No finds of archaeological interest were recovered.
- 5.2 No environmental samples were taken as no features suitable for sampling were encountered.

## 6.0 CONCLUSION

- 6.1 No archaeological finds or features were identified during the watching brief.

## ACKNOWLEDGEMENTS

The co-operation and assistance of Wendy Rogers of Kent County Council and Tony Pallant and Tony Clarke of Avenue Building Co. Ltd are greatly acknowledged.

**SMR Summary Form**

Site Code	TCM09					
Identification Name and Address	The Cross, Mereworth,					
County, District &/or Borough	Kent, Tonbridge and west Malling, Mereworth					
OS Grid Refs.	566090 153717					
Geology	Hythe Beds					
Arch. South-East Project Number	3937					
Type of Fieldwork	Eval.	Excav.	Watching Brief✓	Standing Structure	Survey	Other
Type of Site	Brown Field	Shallow Urban	Deep Urban	Other farm buildings		
Dates of Fieldwork	Eval.	Excav.	WB. 29-30 <sup>th</sup> July 2009	Other		
Sponsor/Client	Avenue Building Co. Ltd					
Project Manager	Darryl Palmer					
Project Supervisor	Sarah Porteus					
Period Summary	Palaeo.	Meso.	Neo.	BA	IA	RB
	AS	MED	PM	Other Modern		
<p>100 Word Summary.</p> <p><i>A watching brief was undertaken at the cross, east of St Lawrence Church, The Street, Kent during ground works associated with the construction of new offices. No archaeological finds, features or deposits were identified.</i></p>						



### OASIS Form

OASIS ID: archaeol6-62873	
Project details	
Project name	An archaeological watching brief at the cross, mereworth, Kent
Short description of the project	An archaeological watching broief was undertaken during ground works for the construction of new offices at the Cross, Mereworth. No finds, deposits or features of archaeological interest were recovered.
Project dates	Start: 29-07-2009 End: 30-07-2009
Previous/future work	No / No
Type of project	Recording project
Site status	None
Current Land use	Other 3 - Built over
Monument type	NONE None
Significant Finds	NONE None
Investigation type	'Watching Brief'
Prompt	Planning condition
Project location	
Country	England
Site location	KENT TONBRIDGE AND MALLING MEREWORTH The cross, Mereworth
Postcode	ME18 5LS
Study area	30.00 metres <sup>2</sup>
Site coordinates	TQ 66090 53717 51.2578386655 0.380575139558 51 15 28 N 000 22 50 E Point
Project creators	
Name of Organisation	Archaeology South-East
Project brief originator	Kent County Council
Project design originator	Kent County Council
Project director/manager	Darryl Palmer
Project supervisor	Sarah Porteus
Type of sponsor/funding body	Developer
Name of sponsor/funding body	Avenue Building Co. Ltd
Project archives	
Physical Archive Exists?	No
Digital Archive recipient	Local Museum

Digital Contents	'none'
Digital Media available	'Images raster / digital photography'
Paper Archive recipient	Local Museum
Paper Contents	'none'
Paper Media available	'Context sheet','Notebook - Excavation',' Research',' General Notes','Unpublished Text'
Project bibliography 1	
Publication type	Grey literature (unpublished document/manuscript)
Title	An archaeological watching brief at the site of the Cross, East of St Lawrence Church, The Street, Mereworth, Kent
Author(s)/Editor(s)	Porteus, S.
Other bibliographic details	Report number:2009120 project: 3937
Date	2009
Issuer or publisher	Archaeology South-East
Place of issue or publication	Archaeology South-East, Portslade
Description	A4 bound report and Pdf available
Entered by	sarah Porteus (s.porteus@ucl.ac.uk)
Entered on	5 August 2009



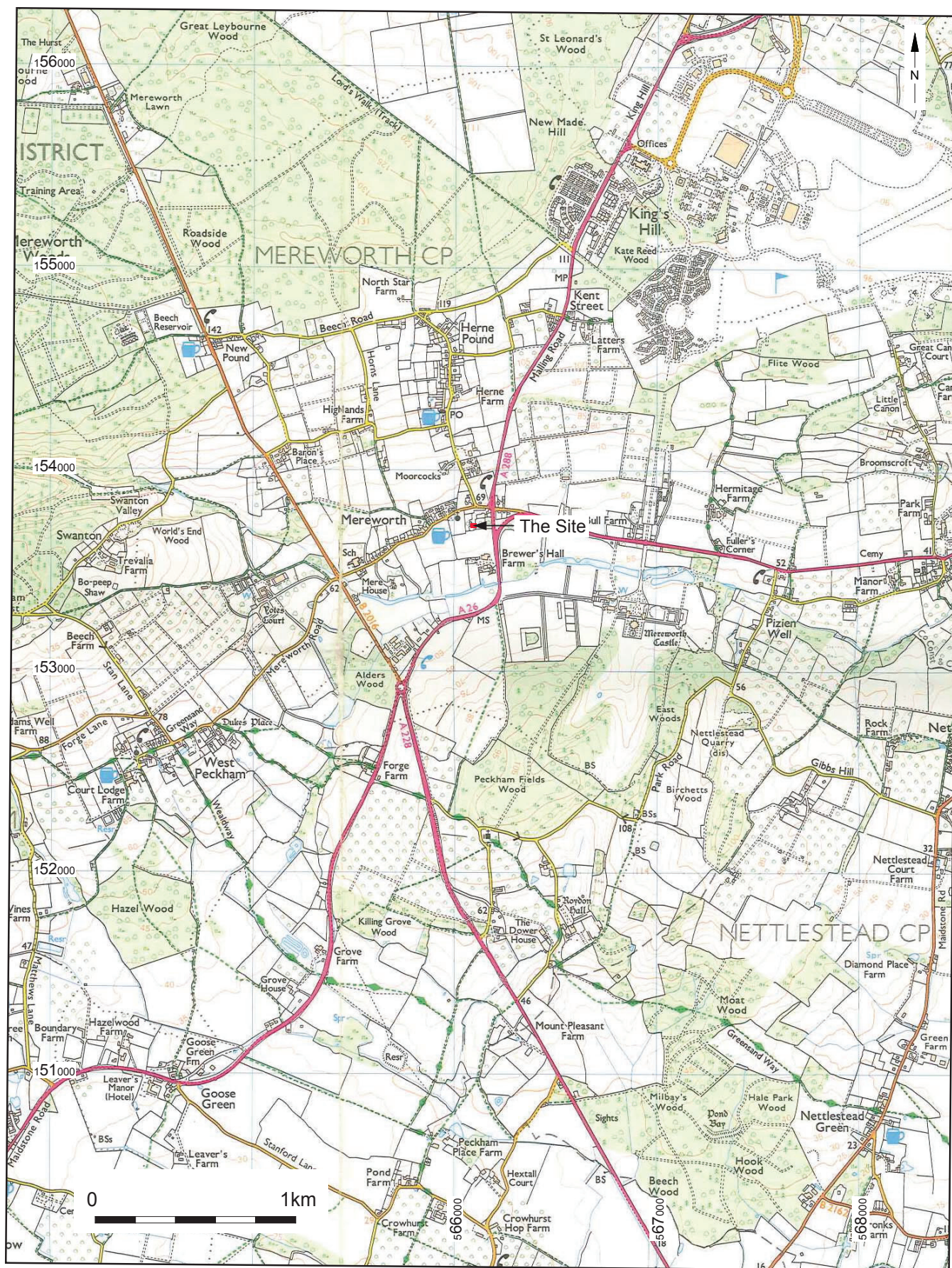

© Archaeology South-East		The Cross, Meresworth, Kent	Fig. 1
Project Ref: 3937	2009	Site location plan	
Report Ref: 2009120	Drawn by: HLF		

Reproduced from the Ordnance Survey's 1:25000 map of 1997 with permission of the Controller of Her Majesty's Stationary Office. Crown Copyright. Licence No. AL 503 10 A



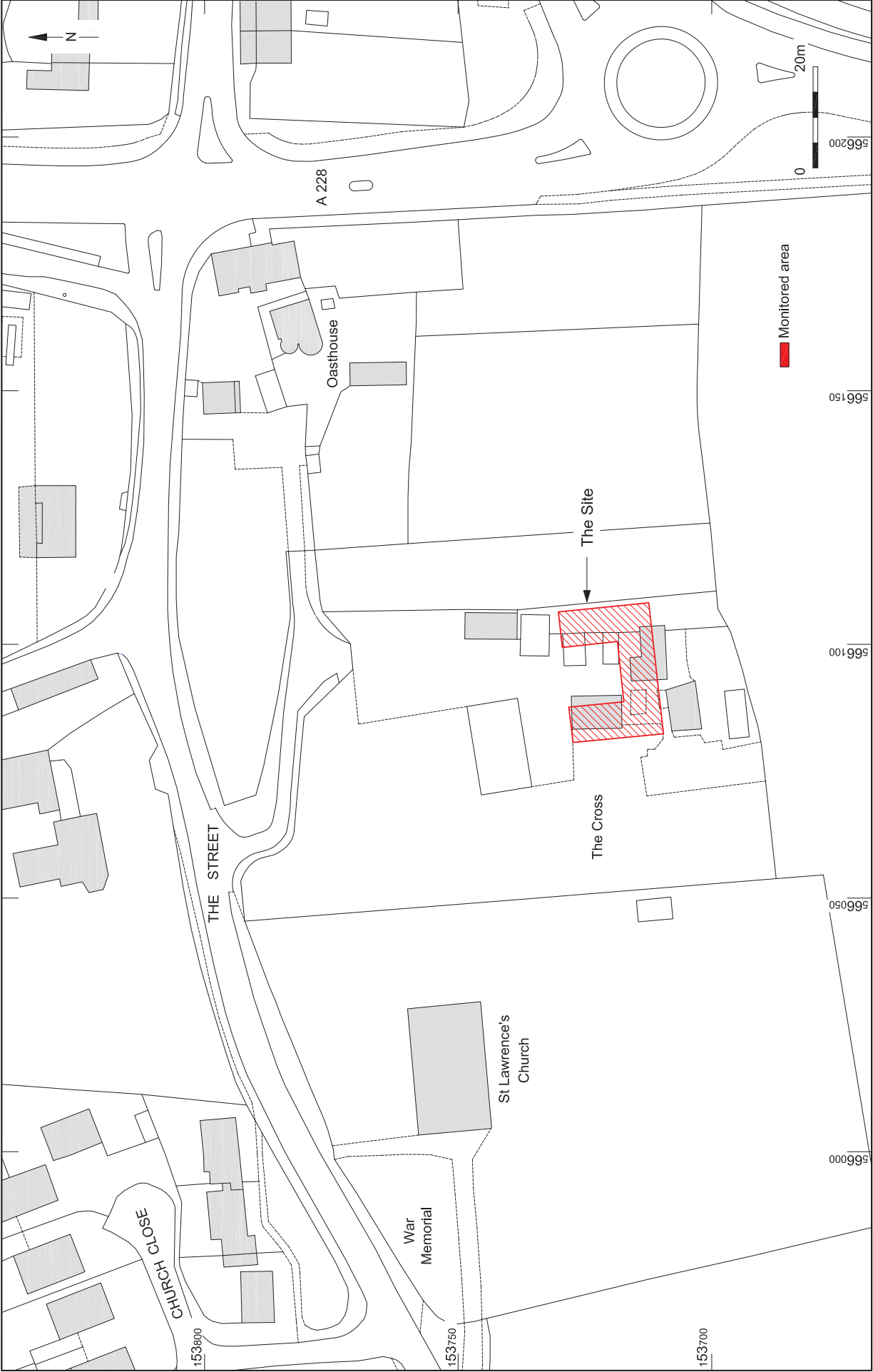

© Archaeology South-East			The Cross, Mereworth, Kent		Fig. 2
Project Ref: 3937	August 2009				
Report Ref: 2009120	Drawn by: HLF		Monitored area		

Head Office  
Units 1 & 2  
2 Chapel Place  
Portslade  
East Sussex BN41 1DR  
Tel: +44(0)1273 426830 Fax: +44(0)1273 420866  
email: [fau@ucl.ac.uk](mailto:fau@ucl.ac.uk)  
Web: [www.archaeologyse.co.uk](http://www.archaeologyse.co.uk)



London Office  
Centre for Applied Archaeology  
Institute of Archaeology  
University College London  
31-34 Gordon Square, London, WC1 0PY  
Tel: +44(0)20 7679 4778 Fax: +44(0)20 7383 2572  
Web: [www.ucl.ac.uk/caa](http://www.ucl.ac.uk/caa)

The contracts division of the Centre for Applied Archaeology, University College London 

©Archaeology South-East