

ARCHAEOLOGICAL SOLUTIONS LTD

216 NEWMARKET ROAD, NORWICH, NORFOLK

**ARCHAEOLOGICAL EVALUATION
BY MONITORING OF SITE INVESTIGATION WORKS**

Authors: Adam Dyson BA (fieldwork and report)	
NGR: TG 2042 0633	Report No: 3840
District: Norwich South	Site Code: CNF 43273
Approved: Claire Halpin	Project No: 4253
Signed:	Date: June 2011

This report is confidential to the client. Archaeological Solutions Ltd accepts no responsibility or liability to any third party to whom this report, or any part of it, is made known. Any such party relies upon this report entirely at their own risk. No part of this report may be reproduced by any means without permission.

Archaeological Solutions Ltd, 98-100 Fore Street, Hertford, SG14 1AB.
Tel: 01992 558170 Fax: 01992 553359 E-mail: info@ascontracts.co.uk
Web: www.archaeologicalsolutions.co.uk
Registered Number: 4702122

CONTENTS

OASIS SUMMARY

SUMMARY

1	INTRODUCTION
2	DESCRIPTION OF THE SITE
3	THE EVIDENCE
4	METHODOLOGY (Evaluation)
5	DESCRIPTION OF RESULTS
6	CONFIDENCE RATING
7	DEPOSIT MODEL
8	DISCUSSION
9	DEPOSITION OF THE ARCHIVE
10	ACKNOWLEDGEMENTS
11	BIBLIOGRAPHY
12	WEB SITES

OASIS SUMMARY SHEET

Project details			
Project name	216 Newmarket Road, Norwich, Norfolk		
<p><i>In May 2011, Archaeological Solutions Ltd (AS) carried out a programme of archaeological evaluation by monitoring at No.216 Newmarket Road, Norwich, Norfolk (NGR TG 2042 0633). The monitoring was carried out during the excavation of six geotechnical test pits dug excavated to investigate the presence or absence of chalk galleries beneath the site. It is proposed to construct a new residential development.</i></p> <p><i>The main archaeological potential for the site was for the continuation of possible flint mines and post-medieval lime workings, known from this area. In the event the archaeological monitoring revealed no archaeological features or finds.</i></p>			
Project dates (fieldwork)	26 th May 2011		
Previous work (Y/N/?)	N	Future work	TBC
P. number	4253	Site code	CNF 43273
Type of project	Evaluation by monitoring of site investigation works		
Site status	-		
Current land use	Residential dwelling and garden		
Planned development	Residential development		
Main features (+dates)	None		
Significant finds (+dates)	None		
Project location			
County/ District/ Parish	Norfolk	Norwich	Norwich South
HER/ SMR for area	NCC HES		
Post code (if known)	-		
Area of site	0.34 ha		
NGR	TL 2042 0633		
Height AOD (max/ min)	30m AOD		
Project creators			
Brief issued by	Norfolk County Council Historic Environment Service (Ken Hamilton)		
Project supervisor/s (PO)	Adam Dyson BA		
Funded by	NMR Ltd		
Full title	216 Newmarket Road, Norwich, Norfolk. An archaeological evaluation by monitoring of site investigation works.		
Authors	Dyson, A		
Report no.	3840		
Date (of report)	June 2011		

216 NEWMARKET ROAD, NORWICH, NORFOLK

ARCHAEOLOGICAL EVALUATION
BY MONITORING OF SITE INVESTIGATION WORKS

SUMMARY

In May 2011, Archaeological Solutions Ltd (AS) carried out a programme of archaeological evaluation by monitoring at No.216 Newmarket Road, Norwich, Norfolk (NGR TG 2042 0633). The monitoring was carried out during the excavation of six geotechnical test pits dug excavated to investigate the possibility of chalk galleries being present beneath the site. It is proposed to construct a new residential development.

The main archaeological potential for the site was for the continuation of possible flint mines and post-medieval lime workings, known from this area. In the event the archaeological monitoring revealed no archaeological features or finds.

1 INTRODUCTION

1.1 In June 2011, Archaeological Solutions Ltd (AS) carried out a programme of archaeological evaluation by monitoring and recording at No. 216 Newmarket Road, Norwich, Norfolk (TG 2042 0633; Figs. 1-2). The monitoring was carried out during the excavation of six geotechnical test pits excavated to investigate the presence or absence of chalk galleries beneath the site, in advance of the proposed residential redevelopment of the site (Planning Application 10/01422/F).

1.2 The evaluation was carried out in accordance with a brief issued by the Norfolk County Council Historic Environment Service (NCC HES, 20/01/2011) (Ken Hamilton), and a specification compiled by AS (24/01/2011). The archaeological monitoring adhered to the Institute for Archaeologists' *Code of Conduct* (revised 2008), and the procedures described in the *IfA Standard and Guidance for Watching Briefs* (revised 2008) and *Standards for Field Archaeology in the East of England* (Gurney 2003).

1.3 The project had the general aim of recovering information regarding the extent, date, phasing, character, function, status, state of preservation and significance of any surviving archaeological remains.

Planning Policy Context

1.4 PPS5 (2010) states that those parts of the historic environment that have significance because of their historic, archaeological, architectural or artistic interest are heritage assets. The Planning Policy Statement aims to deliver sustainable development by ensuring that policies and decisions that concern the historic environment recognise that heritage assets are a non-renewable resource, take account of the wider social, cultural, economic and environmental benefits of heritage conservation, and recognise that intelligently managed change may sometimes be necessary if heritage assets are to be maintained for the long term. It aims to conserve England's heritage assets in a manner appropriate to their significance. It states that opportunities to capture evidence from the historic environment and to contribute to our knowledge and understanding of our past, and to make this publicly available, should be taken, particularly where a heritage asset is to be lost.

2 DESCRIPTION OF THE SITE (Figs. 1 - 2)

2.1 The site lies on the south eastern side of Newmarket Road, 3.5km from Norwich city centre, and currently comprises the residential property and garden of 216 Newmarket Road. It occupies an area of some 0.34 ha.

3 THE EVIDENCE

3.1 Topography, geology and soils (Fig. 1)

3.1.1 The site is at approximately 30m AOD at the top of a valley slope overlooking the River Yare some 550m to the south-west. The local soil is in an unsurveyed urban area but the nearest adjacent soils are of the Burlingham 1 Series which occur on lowland tills. These comprise loamy soils with a distinctive topsoil and subsurface horizon showing significant clay enrichment.

3.2 Archaeological and historical background

3.2.1 In 1868 a Neolithic flint mine was recorded at Eaton Dell approximately 80-100m south-west of the site (TG 2027 0627). The pit contained chalk rubble and fragments of antler and shed horns, most of which were obtained from a small space in rubble or disturbed chalk and subsequently displayed at the Norwich Geological Society (NHER 9547). Sixty centimetres above the Neolithic finds were sherds of Roman amphora and samian ware. The disturbed chalk of the pit was said to be 9m of middle drift but it is not recorded whether the mine was a shaft or a gallery. No trace of the mine was identified during construction of the A11 Bypass.

3.2.2 A post-medieval lime kiln is shown on the 1886 OS map in the same location as the Neolithic mine (NHER 9547), and others were located 100-150m further west (NHER 9612; 2010 0636), and 400m east of the assessment site (NHER 9613; 2082 0633). Fragments of iron-bound concrete from a post-medieval Folly type garden structure were recovered from a garden approximately 70-90m south-west of the assessment site (NHER 9559; TG 2031 0630). Numbers 1 & 3 Eaton Street were originally the same Grade II listed early 19th century house (NHER 48094; 2029 0622).

4 METHODOLOGY (Test-pit evaluation)

4.1 The archaeological evaluation by monitoring comprised the observation of six geotechnical test pits which were excavated using a 180° mechanical excavator (Fig. 2). The pits measured 2m x by 1m and were excavated to a depth of c.2.5m. The monitoring comprised the inspection of subsoil and natural deposits for archaeological features, the examination of spoil heaps and the recording of soil profiles. Deposits were recorded using pro forma recording sheets, drawn to scale and photographed as appropriate.

5 DESCRIPTION OF RESULTS Fig. 3

Sample Sections

Sample sections of the stratigraphy encountered within the test pits were recorded, and the results are tabulated below:

Test Pit 1 (DP2)

<i>South east edge of site</i> 0.00m = 30.26m AOD		
0.00 – 0.50m	L1000	Topsoil. Mid to dark, friable, silty sand.
0.50 – 1.30m	L1001	Subsoil. Mottled mid and light, friable, mixture of silt and sand with moderate gravel.
1.30 – 2.60m+	L1002	Natural. Light yellow orange, friable, sand with moderate gravel.

Test Pit 2 (DP3)

<i>South edge of site</i> 0.00m = 30.29m AOD		
0.00 – 0.40m	L1000	Topsoil. As above.
0.40 – 0.50m	L1001	Subsoil. As above.
0.50 – 2.40m+	L1002	Natural. As above.

Test Pit 3

<i>Central east edge of site</i> 0.00m = 30.32m AOD		
0.00 – 0.50m	L1000	Topsoil. As above.
0.50 – 0.80m	L1001	Subsoil. As above.
0.80 – 2.50m+	L1002	Natural. As above.

Test Pit 4

<i>West corner of site</i> 0.00m = 30.37m AOD		
0.00 – 0.30m	L1000	Topsoil. As above.
0.30 – 0.60m	L1001	Subsoil. As above.
0.60 – 2.50m+	L1002	Natural. As above.

Test Pit 5 (DP4)

<i>North corner of site</i> 0.00m = 30.41m AOD		
0.00 – 0.30m	L1000	Topsoil. As above.
0.30 – 0.60m	L1001	Subsoil. As above.
0.60 – 2.60m+	L1002	Natural. As above.

Test Pit 6 (DP5)

<i>North west edge of site</i> 0.00m = 30.39m AOD		
0.00 – 0.40m	L1000	Topsoil. As above.
0.40 – 0.80m	L1001	Subsoil. As above.
0.80 – 1.30m	L1003	Made ground. Mid orange grey, friable, silty sand with occasional gravel.
1.30 – 2.50m+	L1002	Natural. As above.

Description: No archaeological features or significant finds were present. A brick built soakaway was revealed towards the northern corner of the site.

Made Ground L1003 (0.40m deep) was present within Test Pit 6 towards the north-western boundary of site. It contained no finds.

Test Pit 5 was relocated slightly south of its originally-intended position. This was due to the presence of a large brick soakaway (DP6). The brick structure had a domed brick-built capping which was partially demolished with the mechanical excavator. It was a cylindrical structure c.1.5m in diameter and c.3m deep. Below this depth was soil backfill. The bricks were red and machine made. A modern cement-based mortar was visible within the domed cap.

6 CONFIDENCE RATING

6.1 It is not felt that any factors inhibited the recognition of archaeological features of finds.

7 DEPOSIT MODEL

7.1 Topsoil L1000, was a mid to dark, friable silty sand (0.30 - 0.50m thick). Below L1000 was Subsoil L1001, a mottled mid and light, friable, mixture of silt and sand with moderate gravel (0.10 - 0.80m thick). In Test Pit 6 towards the north western boundary of the site L1001 was overlain by Made Ground L1003, a mid orange grey, friable, silty sand with occasional gravel. Below Subsoil L1001 was the natural, a light yellow orange sand of the site. The geotechnical test pits were excavated to a depth of c.2.50m. At the greater depth compact gravel was encountered.

8 DISCUSSION

8.1 The archaeological potential of the site was for the possible continuation of 19th century (and prehistoric) flint mines and lime workings. In the event no archaeological features or finds were present.

9 DEPOSITION OF THE ARCHIVE

Archive records, with an inventory, will be deposited with the finds from the site, at Norwich Museum. The archive will be quantified, ordered, indexed, cross referenced and checked for internal consistency.

10 ACKNOWLEDGEMENTS

Archaeological Solutions Limited would like to thank the client NMR Ltd for funding the works (in particular Mr Mick Coe), the geotechnical engineers Barter Hill Partnership (in particular Mr Kevin Barter) and Mr Graham Craske of MMBL.

AS would also like to acknowledge the advice and assistance of Dr Ken Hamilton of NCC Historic Environment Service.

11 BIBLIOGRAPHY

Gurney, D. 2003 *Standards for Field Archaeology in the East of England*. East Anglian Archaeology Occasional Paper no. 14

Institute for Archaeologists 1994 (revised 2008) *Standard and Guidance for Archaeological Watching Briefs*

12 WEB SITES

Norfolk Heritage Explorer

PHOTOGRAPHIC INDEX



1
General view of the site. Looking west.



2
Test Pit 1. Looking east.



3
Test Pit 2. Looking north-east.



4
General view of the relocated test pit 5. Looking north.



5
Test Pit 6. Looking north.



6
Brick structure/soakaway located towards northern corner of site. Looking west.

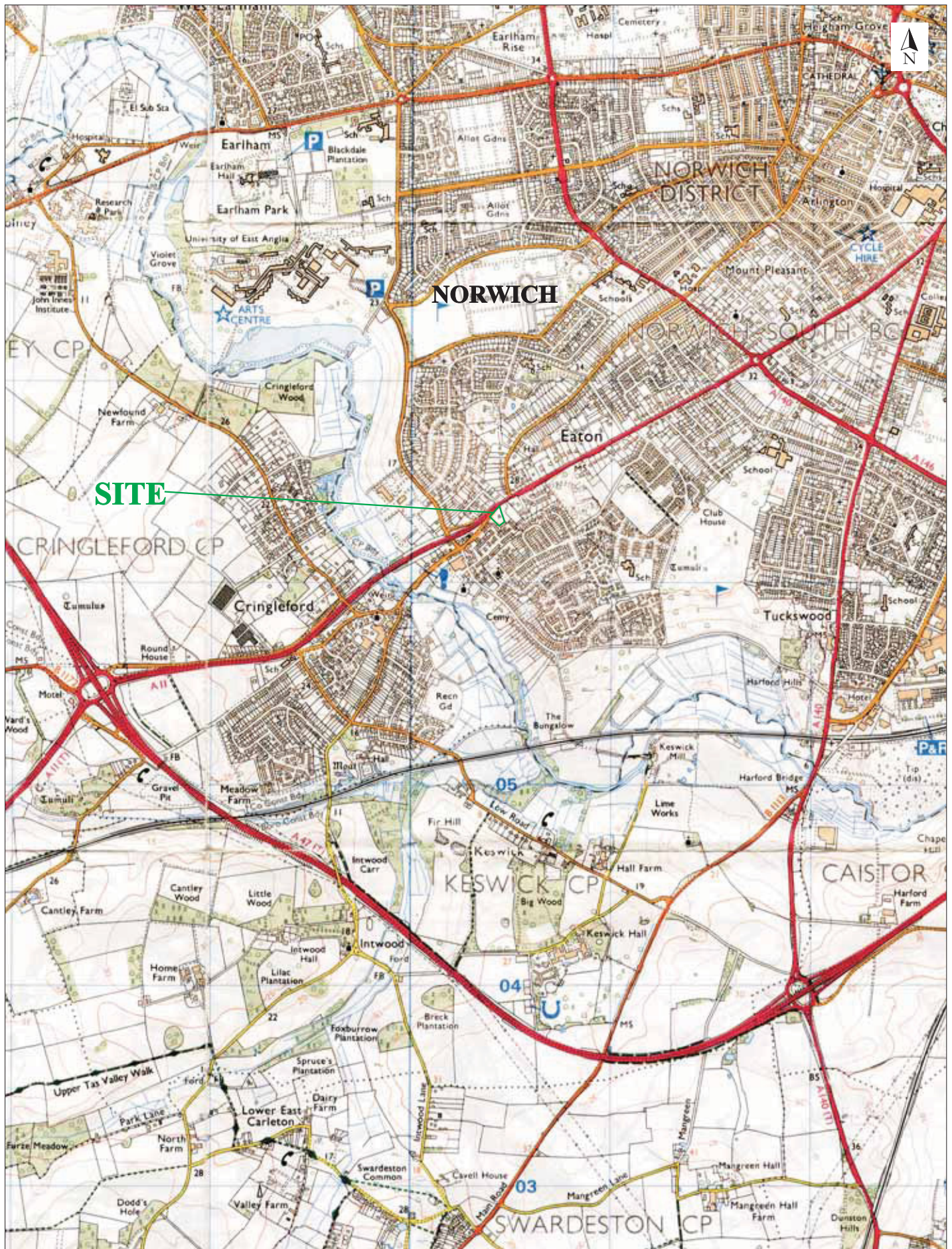

Reproduced from the 1999 Ordnance Survey 1:25000 map with the permission of Her Majesty's Stationery Office. © Crown copyright Archaeological Solutions Ltd Licence number 100036680

Archaeological Solutions Ltd
Fig. 1 Site location plan
 Scale 1:25,000 at A4

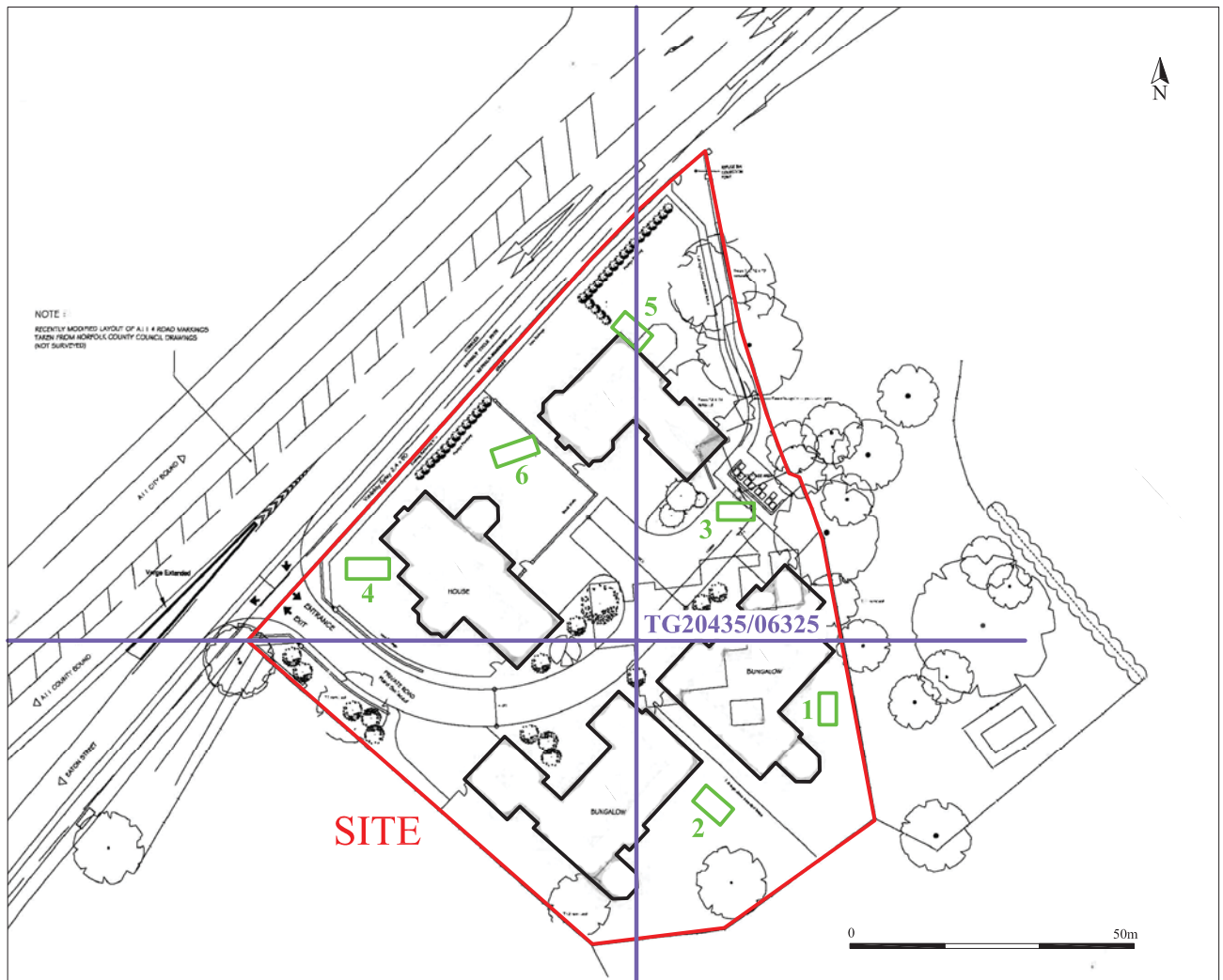

Archaeological Solutions Ltd

Fig. 2 Detailed site location plan

Scale 1:750 at A4

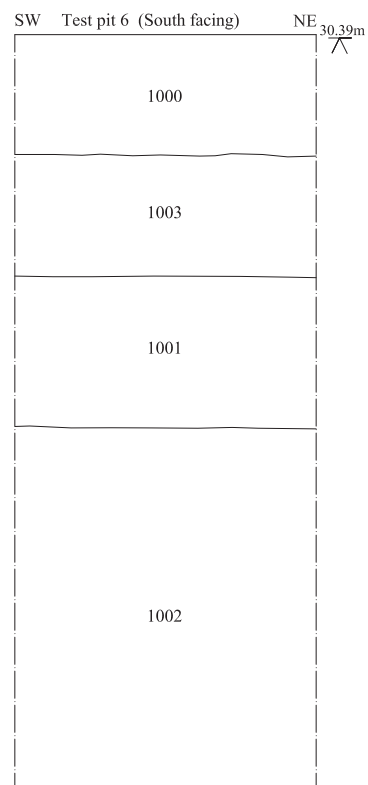
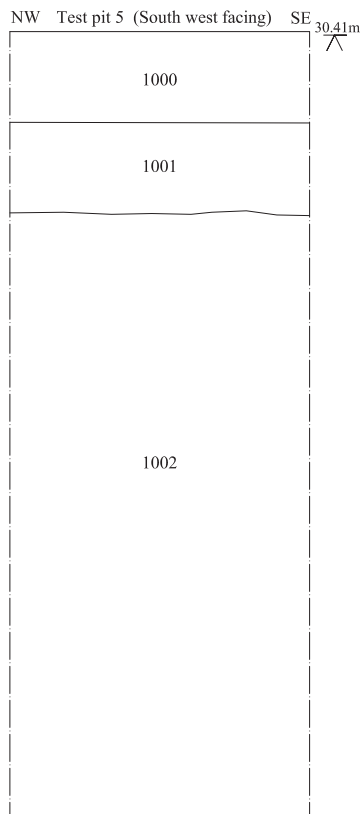
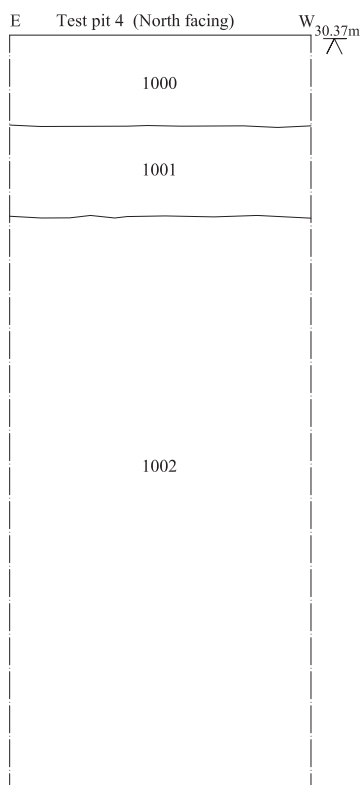
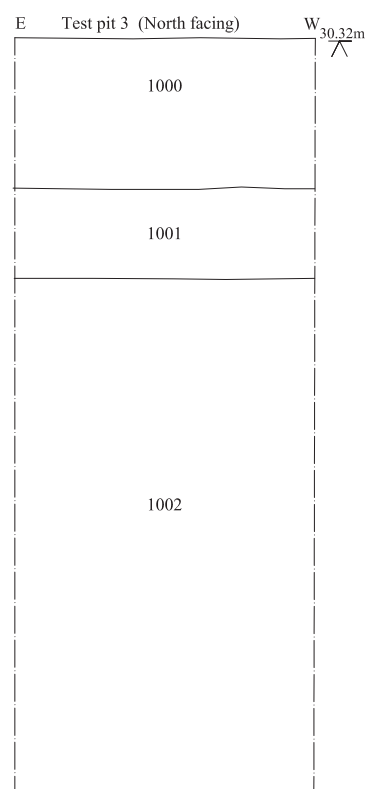
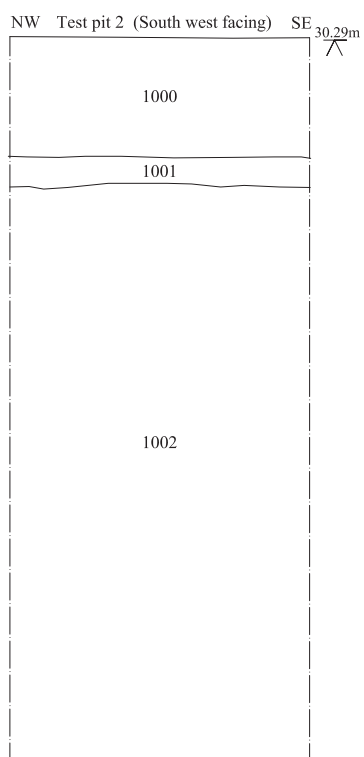
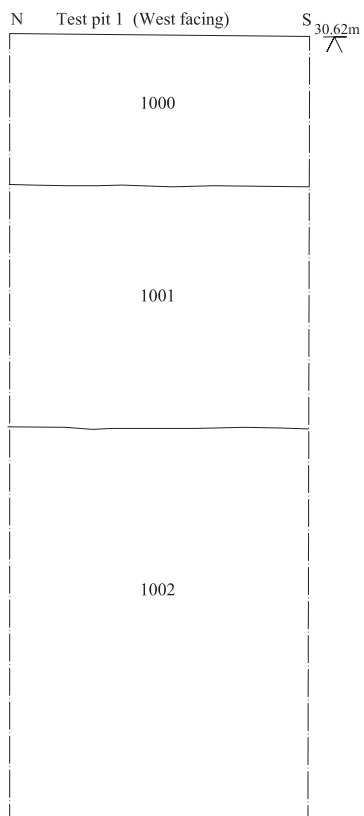

Archaeological Solutions Ltd
Fig. 3 Test pit sections
 Scale 1:25 at A4