ARCHAEOLOGICAL SOLUTIONS LTD

PROPOSED CONSERVATORY THE THATCHED COTTAGE LOWER LUTON ROAD HARPENDEN

ARCHAEOLOGICAL/BUILDING MONITORING AND RECORDING

Authors: Lisa Smith BA Kathren Henry	
NGR: TL 14891 14971	Report No. 3917
District: St Albans	Site Code: AS1433
Approved: Claire Halpin MIFA	Project No. 4462
Signed:	Date: September 2011

This report is confidential to the client. Archaeological Solutions Ltd accepts no responsibility or liability to any third party to whom this report, or any part of it, is made known. Any such party relies upon this report entirely at their own risk. No part of this report may be reproduced by any means without permission.

Archaeological Solutions Ltd, 98-100 Fore Street, Hertford, SG14 1AB
Tel: 01992 558170 Fax: 01992 553359 E-mail: info@ascontracts.co.uk
Web: www.archeologicalsolutions.co.uk
Registered Number:



CONTENTS

OASIS SUMMARY SHEET

SUMMARY

- 1 INTRODUCTION**
- 2 DESCRIPTION OF THE SITE**
- 3 METHODOLOGY**
- 4 DESCRIPTION OF RESULTS**
- 5 CONFIDENCE RATING**
- 6 DEPOSIT MODEL**
- 7 DISCUSSION**

ARCHIVE DEPOSITION

ACKNOWLEDGEMENTS

BIBLIOGRAPHY

APPENDIX 1 LISTED BUILDING DESCRIPTION

OASIS SUMMARY SHEET

Project details			
Project name		<i>Proposed Conservatory, The Thatched Cottage, Lower Luton Road, Harpenden, Hertfordshire Archaeological /Building Monitoring and Recording</i>	
Project description (250 words)			
<p><i>In September 2011 Archaeological Solutions Ltd carried out a programme of archaeological monitoring at The Thatched Cottage, Lower Luton Road, Harpenden, Hertfordshire (NGR TL 14891 14971). The monitoring was carried out to comply with a planning requirement for the construction of a new conservatory (Planning Ref. 5/2011/07030704).</i></p> <p><i>The house is Grade II Listed and is described as 17th century modified in the 1930s in the picturesque style. It has an exposed frame with red brick infill covered in a thickly thatched roof, half hipped at each end. It is divided into three bays representing its previous division into three separate cottages and consists of a single storey with attic rooms. The windows are 20th century leaded casements. There is a central dormer recessed into the thatch with a thatched hood below covering the door (Appendix 1). There are two further dormers though these are part of the 1930s conversion.</i></p> <p><i>The programme of monitoring revealed no archaeological features or finds.</i></p>			
Project dates (fieldwork)		<i>27th September 2011</i>	
Previous work (Y/N/?)		<i>N</i>	Future work (Y/N/?) <i>N</i>
P. number		<i>P4462</i>	Site code <i>AS1433</i>
Type of project		<i>Archaeological Monitoring</i>	
Site status		<i>Grade II Listed</i>	
Current land use		<i>Residential with garden</i>	
Planned development		<i>New conservatory</i>	
Main features (+dates)		<i>17th century cottage renovated in the 1930s</i>	
Significant finds (+dates)		<i>-</i>	
Project location			
County/ District/ Parish		<i>Hertfordshire</i>	<i>St Albans</i> <i>Harpenden</i>
HER/ SMR for area		<i>HALS</i>	
Post code (if known)		<i>-</i>	
Area of site		<i>-</i>	
NGR		<i>TL 14891 14971</i>	
Height AOD (max/ min)		<i>85.2mAOD</i>	
Project creators			
Brief issued by		<i>St Albans District Council</i>	
Project supervisor/s (PO)		<i>Lisa Smith</i>	
Funded by		<i>Mrs Hall</i>	
Full title		<i>Proposed Conservatory, The Thatched Cottage, Lower Luton Road, Harpenden, Hertfordshire Archaeological /Building Monitoring and Recording</i>	
Authors		<i>Smith, L.</i>	
Report no.		<i>3917</i>	
Date (of report)		<i>September 2011</i>	

PROPOSED CONSERVATORY
THE THATCHED COTTAGE
LOWER LUTON ROAD
HARPENDEN

ARCHAEOLOGICAL/BUILDING
MONITORING AND RECORDING

SUMMARY

In September 2011 Archaeological Solutions Ltd carried out a programme of archaeological monitoring at The Thatched Cottage, Lower Luton Road, Harpenden, Hertfordshire (NGR TL 14891 14971). The work was carried out to comply with a planning requirement for the construction of a new conservatory (Planning Ref. 5/2011/07030704).

The programme of monitoring revealed no archaeological features or finds.

1 INTRODUCTION

1.1 In September 2011 Archaeological Solutions Ltd (AS) carried out a programme of archaeological monitoring at The Thatched Cottage, Lower Luton Road, Harpenden, Hertfordshire (NGR TL 14891 14971; Figs. 1-2). The work was carried out to comply with a planning condition imposed on approval for the construction of a new conservatory (Planning Ref. 5/2011/07030704).

1.2 The archaeological monitoring was conducted in response to advice received from the St Albans City and District Council District Archaeologist (SADC; S. West) and a specification prepared by AS (22/06/11), and approved by SADC.

1.3 The programme of archaeological/building monitoring and recording and was conducted according to the Institute of Field Archaeologists' (IFA) *Code of conduct, Standard and Guidance for Archaeological Watching Briefs* (revised 2001). It will also adhere to the document *Standards for Field Archaeology in the East of England* (Gurney 2003). For monitoring of works to the fabric of the building will conform to the English Heritage document *Understanding Historic Buildings: A guide to good recording practice*, 2006 and will also conform to the Institute for Archaeologists' (IFA) *Standard and Guidance for the Archaeological Investigation and Recording of Standing Buildings or Structures* (revised 2008).

2 DESCRIPTION OF THE SITE (Fig. 1-2)

2.1 The Thatched Cottage lies to the east of Harpenden on the south side of Lower Luton Road in the small village of Batford (DP 1 & 2). A large mill stands to the west of the house serviced by the river Lea which runs to the south. Crabtree Lane leads from the house to a fording place at the river.

2.2 The house is Grade II Listed and is described as 17th century modified in the 1930s in the picturesque style. It has an exposed frame with red brick infill covered in a thickly thatched roof, half hipped at each end. It is divided into three bays representing its previous division into three separate cottages and consists of a single storey with attic rooms. The windows are 20th century leaded casements. There is a central dormer recessed into the thatch with a thatched hood below covering the door (Appendix 1). There are two further dormers though these are part of the 1930s conversion.

3 METHODOLOGY

3.1 A rectangular area measuring 3.90m x 2.95m to the rear of Thatched Cottage and following the line of the lean-to at the south-eastern end was excavated for the conservatory foundations (Fig. 3). The area in question was excavated to support a concrete raft therefore the depth of the trench was restricted to approximately 0.60m.

3.2 All excavation was undertaken by hand. Exposed surfaces were cleaned as appropriate and examined for archaeological features and finds. Archaeological features and deposits were recorded using *pro forma* recording sheets, drawn to scale and photographed as necessary.

3.3 The proposed alterations to the building will focus wholly on the lean-to at the south-western end of the listed building (DP 3 & 4). The alterations include the augmentation of the south-eastern elevation of the lean-to by several courses to create a parapet wall and gable to support the conservatory. The existing external doors piercing the wall will be replaced with internal examples.

4 RESULTS

Sample Section 1 North-east facing 0.00m = 85.20m AOD		Fig. 3 DP 5
0.00 – 0.25m	L1000	Topsoil. Dark brownish black sandy silt with occasion rounded gravel, fragments of CBM, slate tiles and very occasional large stones.
0.25 – 0.54m	L1002	Made ground. Mid greyish brown sandy silt with very frequent CBM fragments, flint nodes and modern material.
0.54 – 0.60m+	L1003	Silty sand layer. Mid yellowish brown sandy silt with occasional small stones and CBM fragments.

Sample Section 2 South-west facing 0.00m = 85.18m AOD		Fig. 3 DP 6
0.00 – 0.22m	L1000	Topsoil. As above.
0.22 – 0.59m	L1002	Made ground. As Above.
0.59 – 0.65m+	L1003	Silty sand layer. As above.

Description: No archaeological features or finds were present.

5 CONFIDENCE RATING

5.1 It is not felt that any factors inhibited the recognition of archaeological features and finds during the archaeological investigation.

6 DEPOSIT MODEL

6.1 The uppermost layers encountered during the excavation included a patio located immediately outside a pair of double doors leading from the lean-to into the garden and a lawn beyond. The patio (L1001) consisted of York stone slabs of varying sizes with a thin concrete preparation layer below. The topsoil (L1000) below the patio and extending across the majority of the excavated area consisted of a dark brownish black sandy silt with occasional rounded gravel, fragments of CBM, slate tiles and very occasional large stones. It was seen up to 0.25m below the ground surface.

6.2 After the removal of topsoil a layer of made ground (L1002) was identified comprising a mid greyish brown sandy silt with very frequent CBM fragments, flint nodes and modern rubbish. It was between 0.29m and 0.37m thick and overlay layer L1003. The latter was a mid yellowish brown sandy silt with occasional small stones and CBM fragments and was only identified in a limited number of places across the site and remains *in situ*. No finds were present. The natural was geology not encountered during this excavation.

6.3 The removal of material from the building façade revealed foundations of six courses of brickwork (DP 7), the lowermost course off-set and planted on a concrete base.

7 DISCUSSION

7.1 Due to the nature of the foundation construction for the conservatory the excavations undertaken during this investigation were limited in depth and encountered only modern deposits (DP 8). If archaeological remains are present they will be preserved *in situ* below the level of intrusion.

7.2 The alterations to the house itself are minimal and focused on the lean-to which is likely to be a later addition. The parapet wall is to be

constructed in the same form and similar fabric as the existing structure and will result in the removal of some roof tiles which are concrete and modern. A pair of existing doors are to be replaced with internal examples set within the existing aperture.

DEPOSITION OF THE ARCHIVE

Archive records, with inventory, are to be deposited, as well as any donated finds from the site at St Albans Museum and in accordance with their requirements. The archive will be quantified, ordered, indexed, cross-referenced and check for internal consistency.

ACKNOWLEDGEMENTS

Archaeological Solutions are grateful to the client Mrs Hall of The Thatched Cottage for funding the works, and the project architects, EDR Architects, for their kind assistance (in particular Mr Eric Reeves).

AS would also like to acknowledge the input and advice of Mr Simon West of SADC

BIBLIOGRAPHY

Gurney, D. 2003 *Standards for Field Archaeology in the East of England*. East Anglian Archaeology occasional paper No. 14

Institute of Field Archaeologists (IFA) 2008 *Standard and Guidance for Archaeological Watching Briefs*. IFA, Reading

Websites

English Heritage. Accessed 27/09/11
Address: <http://list.english-heritage.org.uk>

Harpenden History. Accessed 27/09/11
Address: <http://www.harpenden-history.org.uk>

APPENDIX 1 LISTED BUILDING DESCRIPTION

Name: THE THATCHED COTTAGE (ON CORNER OF LOWER LUTON ROAD)

List entry Number: 1102990

The building may lie within the boundary of more than one authority.

County	District	District Type	Parish
Hertfordshire	St. Albans	District Authority	Harpenden

National Park: Not applicable to this List entry.

Grade: II

Date first listed: 27-Sep-1984

Date of most recent amendment: Not applicable to this List entry.

Legacy System Information

The contents of this record have been generated from a legacy data system.

Legacy System: LBS

UID: 163575

Asset Groupings

This list entry does not comprise part of an Asset Grouping. Asset Groupings are not part of the official record but are added later for information.

List entry Description

Summary of Building

Legacy Record - This information may be included in the List Entry Details.

Reasons for Designation

Legacy Record - This information may be included in the List Entry Details.

History

Legacy Record - This information may be included in the List Entry Details.

Details

TL 11 SW HARPENDEN CRABTREE LANE (east side) BATFORD

5/40 The Thatched Cottage (on corner of Lower Luton Road)

- II

Cottage. C17, modified c.1930 in picturesque style. Exposed timber frame.

Red brick infill. Deeply thatched roof, half hipped at ends. 3 bays at right angles to road. 1 storey and attics. 4 C20 leaded casements. 1 central dormer recessed in thatch. Thatched porch hood below. 2 thatched gabled dormers.

Listing NGR: TL1489214972

Selected Sources

Legacy Record - This information may be included in the List Entry Details

National Grid Reference: TL 14892 14972

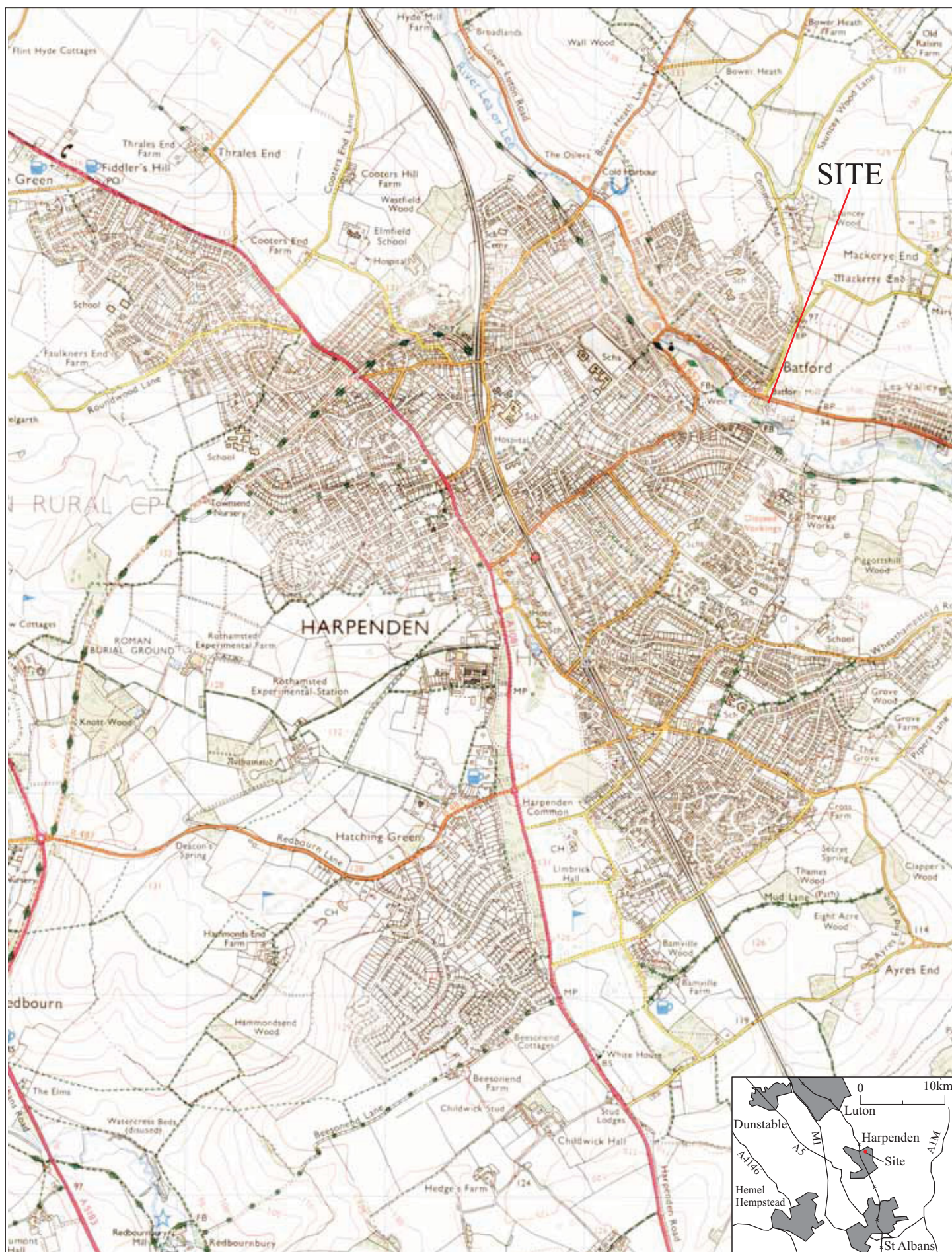

Reproduced from the 1999 Ordnance Survey 1:25000 map with the permission of Her Majesty's Stationery Office. © Crown copyright Archaeological Solutions Ltd Licence number 100036680

Archaeological Solutions Ltd
Fig. 1 Site location plan
 Scale 1:25,000 at A4

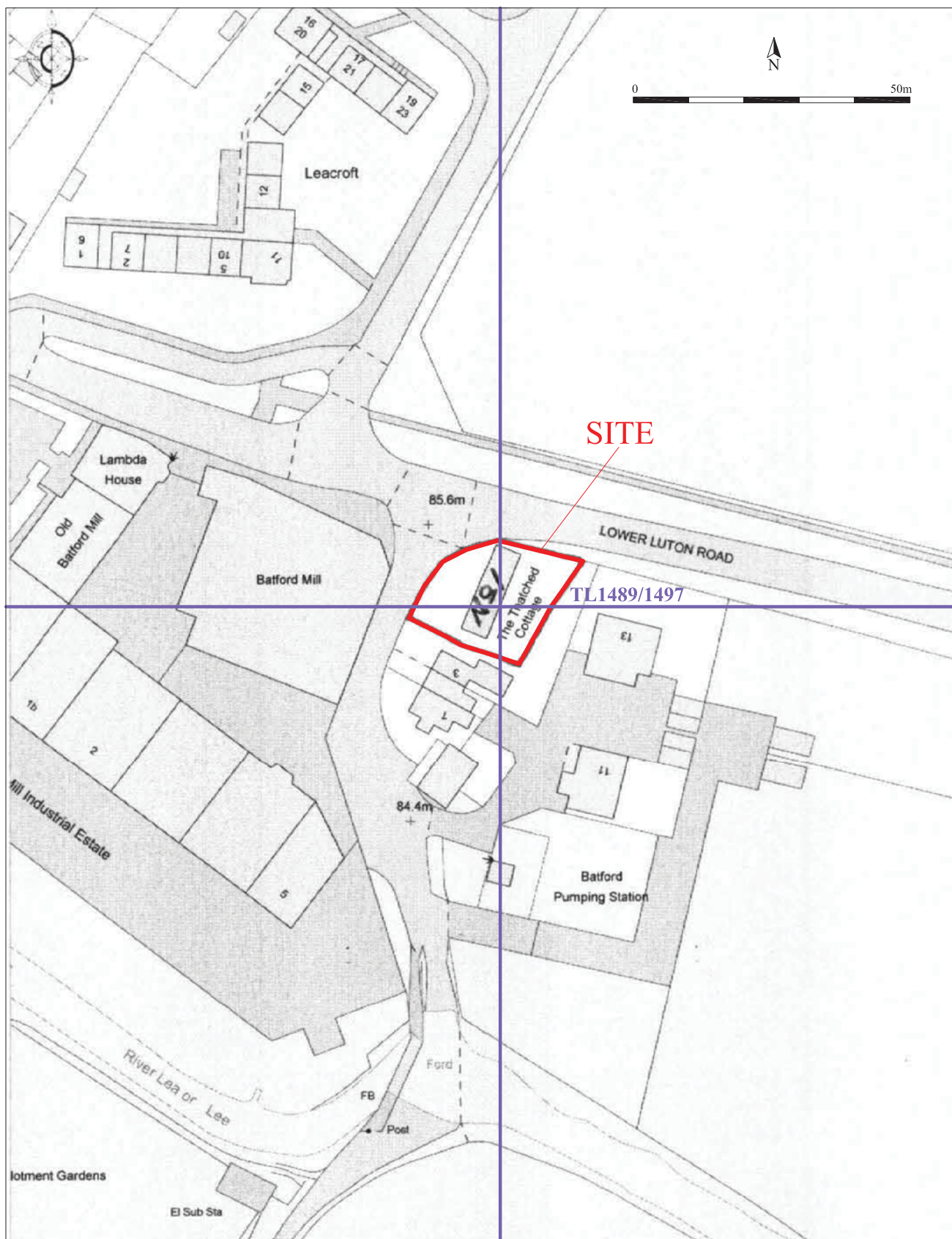

Reproduced from the 1999 Ordnance Survey 1:1250 map with the permission of Her Majesty's Stationery Office. Crown copyright Archaeological Solutions Ltd. Licence No. 100036680

Archaeological Solutions Ltd

Fig. 2 Detailed site location plan

Scale 1:1000 at A4

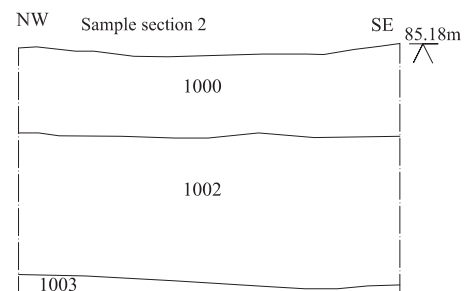
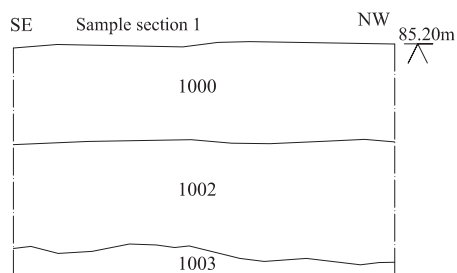
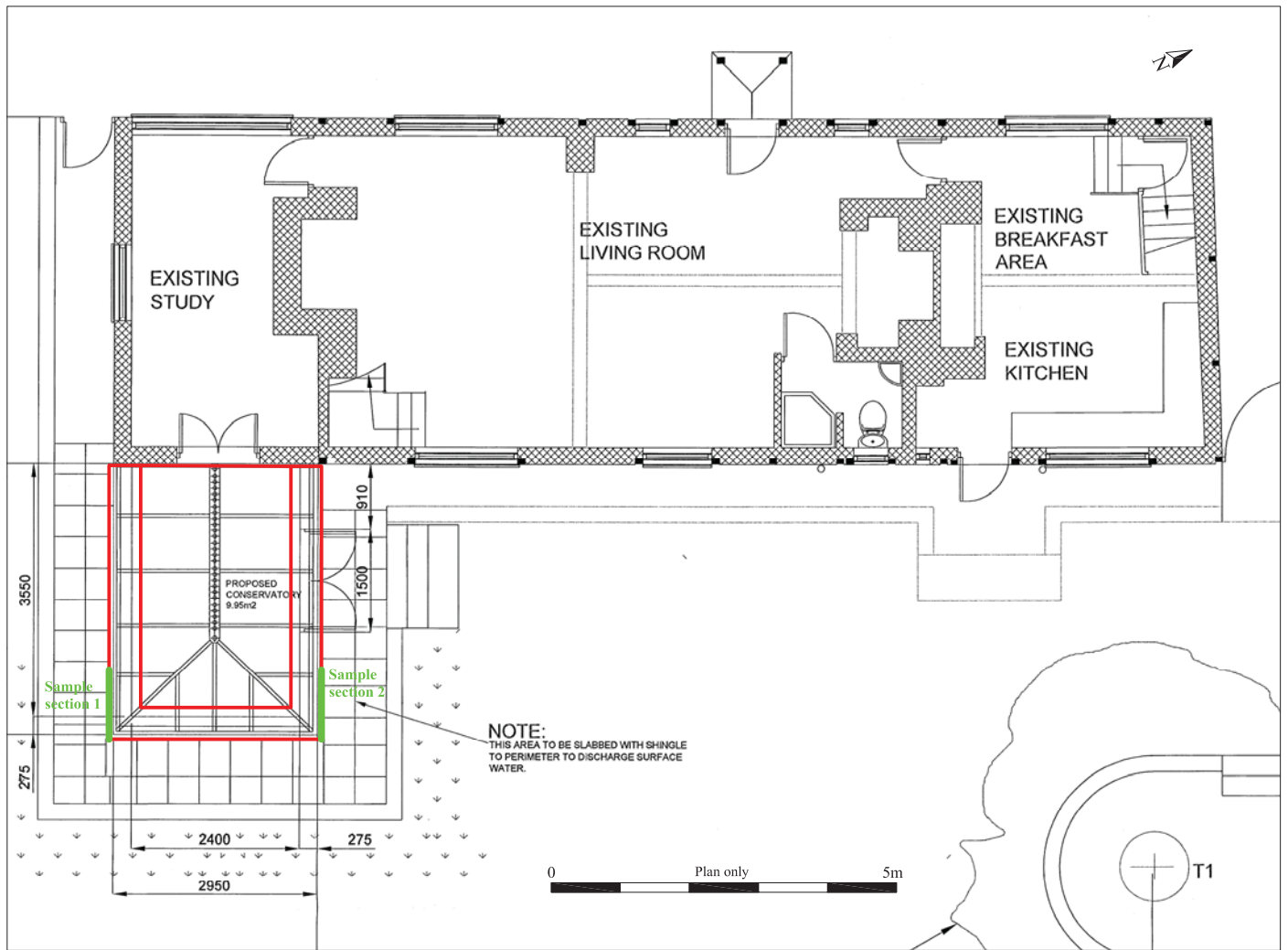

Archaeological Solutions Ltd

Fig. 3 Trench plan & sections

Scale Plan 1:100, sections 1:20 at A4