ARCHAEOLOGICAL SOLUTIONS LTD

FOX HOUSE, HUNSTON, SUFFOLK

AN ARCHAEOLOGICAL EVALUATION

Authors: Gareth Barlow (Fieldwork and Report) Antony Mustchin (Editor)	
Illustrations: Kathren Henry and Charlotte Davies	
NGR: TL 975 685	Report No: 4036
District: Mid Suffolk	Site Code: HUN 013
Approved: Claire Halpin MfA	Project No: P4771
Signed:	Date: March 2012 Revised: November 2012

County HER No. HUN 013

ARCHAEOLOGICAL SOLUTIONS LTD

**98-100 Fore, Street, Hertford SG14 1AB
01992 558170**

**Unit 6, Brunel Business Court, Eastern Way,
Bury St Edmunds IP32 7AJ
01284 765210**

**e-mail info@ascontracts.co.uk
www.archaeologicalsolutions.co.uk**



This report is confidential to the client. Archaeological Solutions Ltd accepts no responsibility or liability to any third party to whom this report, or any part of it, is made known. Any such party relies upon this report entirely at their own risk. Unauthorised copying, reproduction or distribution to other parties will constitute a breach of copyright and is prohibited

CONTENTS

OASIS SUMMARY

SUMMARY

- 1 INTRODUCTION**
- 2 DESCRIPTION OF THE SITE**
- 3 METHODOLOGY**
- 4 DESCRIPTION OF RESULTS**
- 5 CONFIDENCE RATING**
- 6 DEPOSIT MODEL**
- 7 DISCUSSION**
- 8 DEPOSITION OF THE ARCHIVE**

ACKNOWLEDGEMENTS

BIBLIOGRAPHY

OASIS SUMMARY SHEET

Project details			
Project name		<i>Fox House, Hunston, Suffolk.</i>	
<p><i>In March 2012, Archaeological Solutions Ltd (AS) conducted an archaeological evaluation at Fox House, Hunston, Suffolk.</i></p> <p><i>Four features were identified within the evaluation trench (Ditch F1003, a service trench, a land drain and a pit). With the possible exception of Ditch F1003, all the features appeared modern; the service trench contained a plastic pipe and the pit cut both the topsoil and the subsoil. It also contained modern glass and plastics.</i></p> <p><i>Ditch F1003 contained no finds and is therefore undated. It was however parallel to the existing eastern property boundary.</i></p> <p><i>The site lies to the rear of Hunston House suggesting the possibility of archaeological remains and back yard activity. In the event only modern features and an undated ditch were revealed. No residual finds were present. Although modern features were encountered they were not dense, and would not have significantly affected the survival or visibility of archaeological features.</i></p>			
Project dates (fieldwork)		<i>5th March 2012</i>	
Previous work (Y/N/?)		<i>N</i>	Future work <i>TBC</i>
P. number		<i>P4771</i>	Site code <i>HUN 013</i>
Type of project		<i>Archaeological evaluation</i>	
Site status		<i>-</i>	
Current land use		<i>Garden</i>	
Planned development		<i>Dwelling</i>	
Main features (+dates)		<i>Undated ditch (F1003)</i>	
Significant finds(+dates)		<i>None</i>	
Project location			
County/ District/ Parish		<i>Suffolk</i>	<i>Mid Suffolk</i> <i>Hunston</i>
HER/ SMR for area		<i>Suffolk HER</i>	
Post code (if known)		<i>IP31 3EL</i>	
Area of site		<i>c.100m²</i>	
NGR		<i>TL 975 685</i>	
Height AOD (max/ min)		<i>40.04m</i>	
Project creators			
Brief issued by		<i>n/a</i>	
Project supervisor/s (PO)		<i>Gareth Barlow</i>	
Funded by		<i>Mr Lee Marshall</i>	
Full title		<i>Fox House, Hunston, Suffolk. An Archaeological Evaluation.</i>	
Authors		<i>Gareth Barlow (Antony Mustchin – Editor)</i>	
Report no.		<i>4036</i>	
Date (of report)		<i>March 2012 (Revised November 2012)</i>	

FOX HOUSE, HUNSTON, SUFFOLK

AN ARCHAEOLOGICAL EVALUATION

SUMMARY

In March 2012, Archaeological Solutions Ltd (AS) conducted an archaeological evaluation at Fox House, Hunston, Suffolk.

Four features were identified within the evaluation trench (Ditch F1003, a service trench, a land drain and a pit). With the possible exception of Ditch F1003 all the features appeared modern; the service trench contained a plastic pipe and the pit cut both the topsoil and the subsoil. It also contained modern glass and plastics.

Ditch F1003 contained no finds and is therefore undated. It was however parallel to the existing eastern property boundary.

The site lies to the rear of Hunston House suggesting the possibility of archaeological remains and back yard activity. In the event only modern features and an undated ditch were revealed. No residual finds were present. Although modern features were encountered they were not dense, and would not have significantly affected the survival or visibility of archaeological features.

1 INTRODUCTION

1.1 In March 2012 Archaeological Solutions Ltd (AS) conducted an archaeological evaluation at Fox House, Hunston, Suffolk (NGR: TL 975 685; Figs. 1 and 2). The evaluation was undertaken in compliance with a planning condition attached to planning approval for the construction of a replacement dwelling on the site (Mid Suffolk Council Ref. 397/11).

1.2 The evaluation was carried out in accordance with a written scheme of investigation prepared by Mr Lee Marshall, which was approved by Mid Suffolk District Council. The project adhered to appropriate sections of Gurney (2003) *Standards for Field Archaeology in the East of England*, and the Institute for Archaeologists' *Code of Conduct and Standard and Guidance for Archaeological Field Evaluation* (revised 2008).

1.3 The aim of the archaeological evaluation was to determine, as far as was possible, the location, extent, date, character, condition, significance and quality of any surviving archaeological remains liable to be threatened by the proposed development. In addition it was hoped to clarify the nature and extent of existing disturbance and intrusions and hence assess the degree of survival of buried deposits and surviving structures of archaeological significance.

Planning policy context

1.4 Planning Policy Statement 5 (PPS5; 2010) states that those parts of the historic environment that have significance because of their historic, archaeological, architectural or artistic interest are heritage assets. The Planning Policy Statement aims to deliver sustainable development by ensuring that policies and decisions that concern the historic environment recognise that heritage assets are a non-renewable resource, take account of the wider social, cultural, economic and environmental benefits of heritage conservation, and recognise that intelligently managed change may sometimes be necessary if heritage assets are to be maintained for the long term. It aims to conserve England's heritage assets in a manner appropriate to their significance. It states that opportunities to capture evidence from the historic environment and to contribute to our knowledge and understanding of our past, and to make this publicly available, should be taken, particularly where a heritage asset is to be lost.

2 DESCRIPTION OF THE SITE

Background (Figs. 1 and 2)

Location, topography and geology

2.1 The site sits to the rear of Hunston House and to the north of The Street, Hunston. It comprises a garden area adjacent to Fox House. The latter is to be demolished and replaced with a new dwelling to the immediate north. The site lies at c. 40m AOD on glaciofluvial drift deposits.

Historical and archaeological background

2.2 An earlier archaeological investigation at the site by Suffolk County Council Archaeological Service (SCCAS) (HER HUN 003; Fig. 2¹) reported only an undated ditch running east to west across the site. However, a small Roman glass vessel (unguentarium) has also been reported from the immediate vicinity (also HER HUN 003; Fig. 2). A more recent evaluation, also conducted by SCCAS, within the grounds of Rose Cottage (now the site of Beech House), c. 110m to the south-west of the current site, reported only an undated pit (Craven 2006, 3; HER HUN 12). Other finds in the immediate vicinity comprise Roman, early Anglo-Saxon and medieval pottery found c. 75m to the south-west of the site (HER HUN 011; Fig. 2). Craven (2006, 1) suggests that the nature of the finds from the immediate vicinity might indicate the presence of nearby funerary activity.

2.3 Other noteworthy finds from the Hunston area include a Roman copper alloy 'dolphin' bow brooch (HER HUN 005) and a Roman copper alloy grinder (HER HUN Misc) found during metal detecting, an artefact scatter, including ?late Saxon to 14th

¹ Find spots marked on Figure 2 are largely after Craven (2006, 1, fig. 1)

century pottery (including Thetford type sherds; HER HUN 007) and a ?Mesolithic flint axehead (HER HUN 009). The Grade II* listed medieval church of St Michael's (HER HUN 004) is located c. 450m to the south of the site.

2.4 The site sits on the periphery of the historic settlement core of Hunston (Tipper *pers. comm.*). Listed buildings² fronting The Street to the east of the site include *Elwyn* (NGR TL 9753 6852), dating to the 18th century and *The Yard* (NGR TL 9757 6853), dating to the 17th century (both Grade II; Fig. 2). *Rose cottage*, to the west of the site (NGR 9741 6850), is Grade II listed and dates from the 17th century. The existing property to the south of the proposed development, Hunston House, is also Grade II listed and is 17th to 18th century in origin. In total, 12 properties in the immediate area of the site are listed, the earliest of which, bar the 12th to 13th century church of St Michael's (see above), date to the 16th century.

3 METHODOLOGY

3.1 A single trial trench, measuring 11.50 x 1.50m (east to west) was excavated across the footprint of the proposed development (Fig. 3).

3.2 Undifferentiated overburden was removed under close archaeological supervision using a 360° tracked mechanical excavator fitted with a 1.20m wide toothless ditching bucket. Thereafter, investigation was undertaken by hand. Exposed surfaces were cleaned and examined for archaeological features and finds. Deposits were recorded using *pro forma* recording sheets, drawn to scale and photographed as appropriate.

4 DESCRIPTION OF RESULTS

Trench 1 (Figs. 2-3)

<i>Sample section: East end, north facing</i>		
<i>0.00 = 40.02m AOD</i>		
0.00 – 0.20m	L1000	Topsoil. Firm, dark grey brown, organic sandy silt with occasional small and medium sub-angular flints.
0.18 – 0.24m	L1005	Made ground present over Ditch F1003 only. Friable, pale yellow orange silty coarse sand and gravel.
0.20 – 0.40m	L1001	Subsoil. Firm, mid grey brown sandy silt with occasional small and medium sub-angular flints.
0.40m+	L1002	Natural deposits. Friable, orange silty sand with frequent small and medium sub-angular flints and occasional large flint nodules.

² Listed buildings data are from: www.britishlistedbuildings.co.uk (accessed 05/11/2012)

<i>Sample section: West end, south facing</i>		
<i>0.00 = 40.04m AOD</i>		
0.00 – 0.19m	L1000	Topsoil. As above
0.19 – 0.38m	L1001	Subsoil. As above
0.38m+	L1002	Natural deposits. As above.

Description: Trench 1 contained an undated ditch (F1003), a modern service trench containing a plastic pipe, a pit containing burnt modern material, and a twin-piped land drain.

Ditch F1003 was linear (1.50+ x 1.48 x 0.40m³), orientated north to south, parallel to the current eastern boundary and roughly perpendicular to the street frontage (to the south). F1003 had steep sides rounding to a shallow concave base. Its fill, L1004, was a firm, pale orange brown sandy silt with moderate small and medium sub-angular flints. It contained no finds.

5 CONFIDENCE RATING

5.1 It is not felt that any factors inhibited the recognition of archaeological features or finds.

6 DEPOSIT MODEL

6.1 Topsoil L1000 was ubiquitous across the site. It comprised a firm, dark grey brown, organic sandy silt with occasional small and medium sub-angular flints (0.20m thick). Below L1000 was Subsoil L1001, a firm, mid grey brown sandy silt with occasional small and medium sub-angular flints (c. 20m thick). A discrete (1.50+ x 0.84 x 0.06m) layer of friable, pale yellow orange silty coarse sand and gravel (L1005) was present below L1000 and above L1001 in the area of Ditch L1003 (Fig. 3). At the base of the sequence, at a depth of 0.40m lay Natural L1002, a friable, orange silty sand with frequent small and medium sub-angular flints and occasional large flint nodules.

7 DISCUSSION

7.1 Four features were identified within the trench (Ditch F1003, a service trench, a land drain and a pit). With the possible exception of Ditch F1003 all the features were modern; the service trench contained a plastic pipe and the pit truncated both the topsoil and the subsoil. It also contained modern glass and plastics.

7.2 Ditch F1003 contained no finds and therefore remains undated. It was however parallel to the existing eastern property boundary and may have been broadly

³ Dimensions: length x width x depth

contemporary to Hunston House, to the immediate south (i.e. 17th to 18th century in origin; see Section 2.4). Alternatively, an earlier medieval date for this feature might be postulated based on pottery findspots in the area and the dates of other buildings fronting The Street (see Section 2.4), though cannot be substantiated.

7.3 The site lies within an area of archaeological interest, close to the findspots of Roman, early Anglo-Saxon and medieval finds, suggestive of cemetery activity (Craven 2006, 1). In the event only modern features and one undated ditch (F1003) were revealed. No residual finds were present. Although modern features were encountered they were not dense, and would not have significantly affected the survival or visibility of archaeological features.

8 DEPOSITION OF THE ARCHIVE

Archive records with an inventory will be deposited in the County Store. The archive will be quantified, ordered, indexed, cross-referenced and checked for internal consistency. In addition to the overall site summary, it will be necessary to produce a summary of the artefactual and ecofactual data.

ACKNOWLEDGEMENTS

Archaeological Solutions Ltd would like to thank Mr Lee Marshall for commissioning and funding the evaluation and for his assistance.

AS is pleased to acknowledge the advice and input of Dr Jess Tipper of Suffolk County Council Archaeological Service Conservation Team.

BIBLIOGRAPHY

Craven, J. A. 2006, *Land adjacent to Rose Cottage, The Street, Hunston. A report on the archaeological evaluation, 2006*, Suffolk County Council Archaeological Service unpublished report no. 2006/33

Gurney, D. 2003, 'Standards for Field Archaeology in the East of England', *East Anglian Archaeology Occasional Paper 14*

The Institute for Archaeologists' 2008, *Code of Conduct and Standard and Guidance for Archaeological Field Evaluation*, IfA, Reading

Websites

www.britishlistedbuildings.co.uk (accessed 05/11/2012)



1
Front of Hunston House. Looking northwest.



2
General view of site. Looking south towards rear of Hunston House.



3
General view of site. Looking southwest.



4
Trench 1, post excavation. Looking west.



5
Sample section 1A and Ditch F1003. Looking south.



6
Sample Section 1B. Looking north.

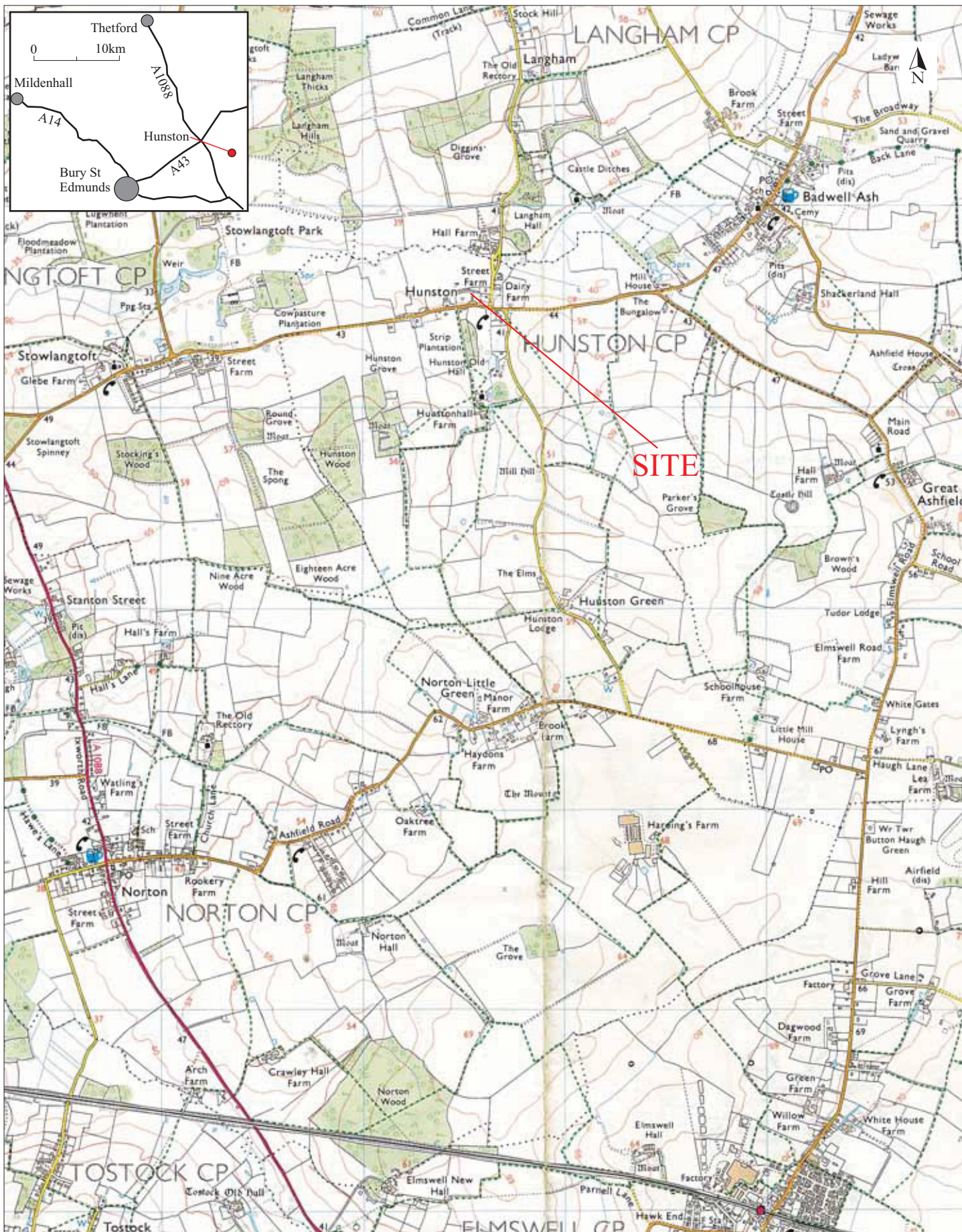

Reproduced from the 1999 Ordnance Survey 1:25000 map with the permission of Her Majesty's Stationery Office. © Crown copyright Archaeological Solutions Ltd Licence number 100036680

Archaeological Solutions Ltd
Fig. 1 Site location plan
 Scale 1:25,000 at A4

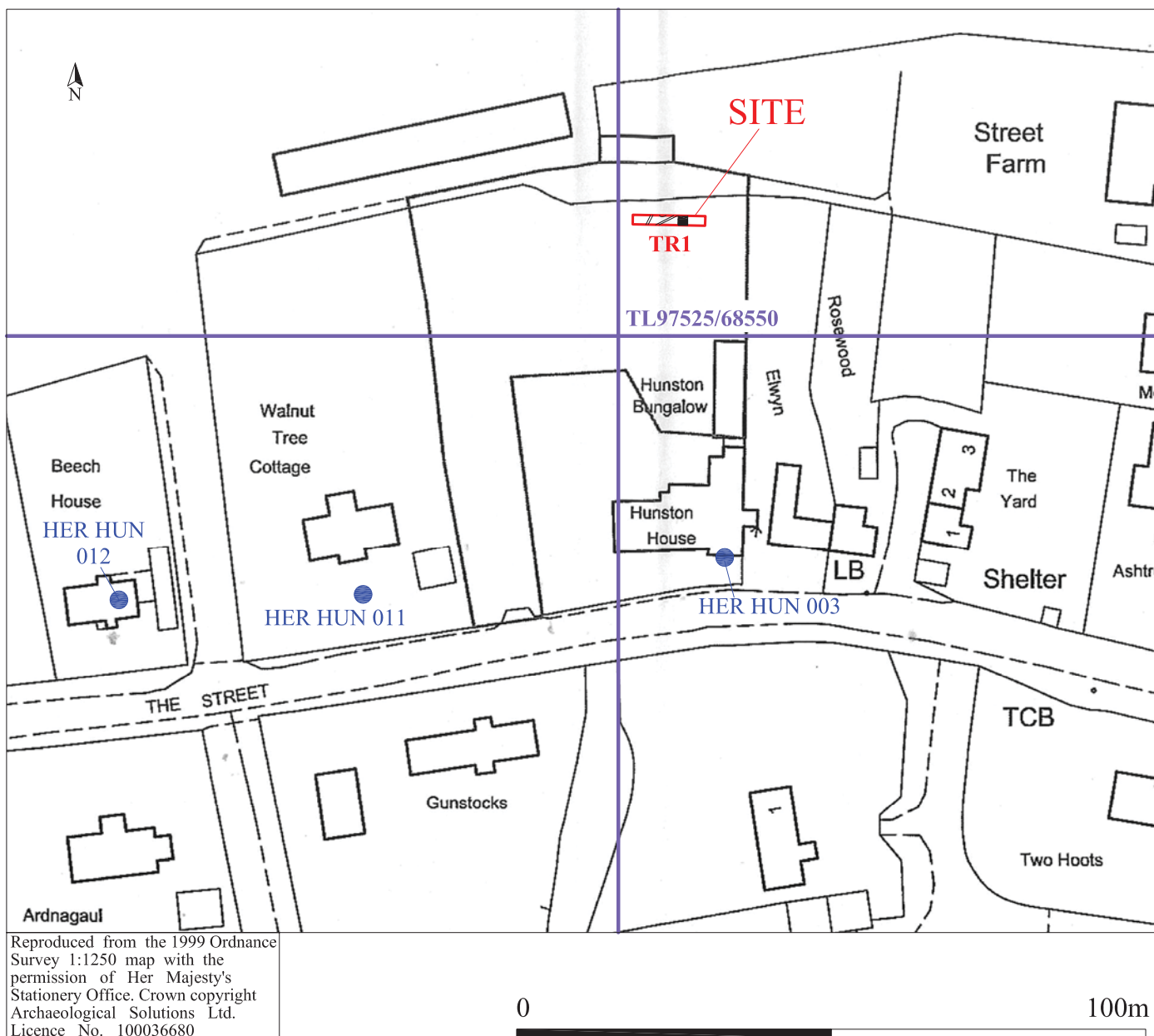

Archaeological Solutions Ltd
Fig. 2 Detailed site location plan
 Scale 1:1000 at A4

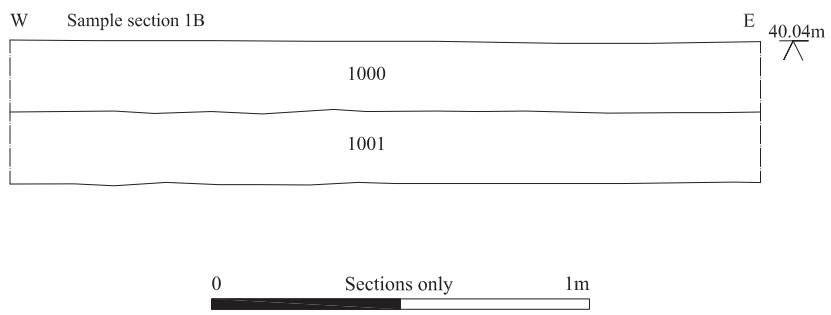
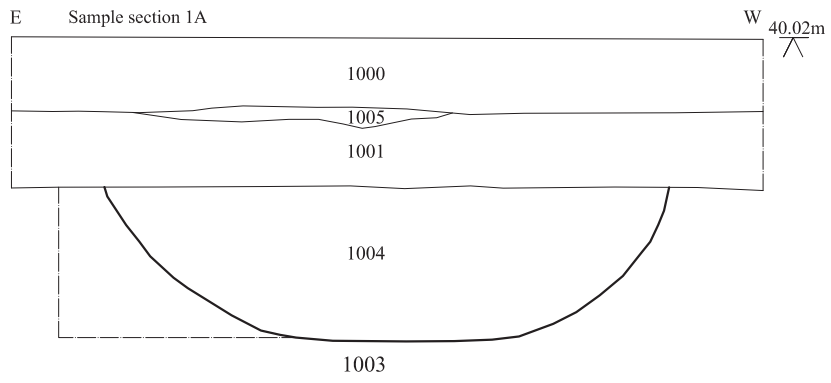
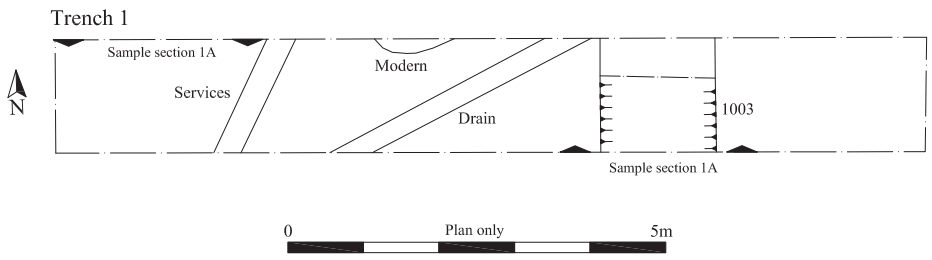

Archaeological Solutions Ltd
Fig. 3 Plan & section
 Scale Plan 1:100, sections 1:20 at A4