

---

ARCHAEOLOGICAL SOLUTIONS LTD

THE BREWHOUSE AT GORHAMBURY  
ST ALBANS  
HERTFORDSHIRE

HISTORIC PHOTOGRAPHIC RECORDING

Authors: Lisa Smith BA Kathren Henry	
NGR: TL 11351 07922	Report No. 4452
District: St Albans	Site Code: GOR13
Approved: Claire Halpin	Project No. 5443
MIFA	Date: 4 November 2013
Signed:	

*This report is confidential to the client. Archaeological Solutions Ltd accepts no responsibility or liability to any third party to whom this report, or any part of it, is made known. Any such party relies upon this report entirely at their own risk. No part of this report may be reproduced by any means without permission.*

Archaeological Solutions is an independent archaeological contractor providing the services which satisfy all archaeological requirements of planning applications, including:

*Desk-based assessments and environmental impact assessments*  
*Historic building recording and appraisals*  
*Trial trench evaluations*  
*Geophysical surveys*  
*Archaeological monitoring and recording*  
*Archaeological excavations*  
*Post excavation analysis*  
*Promotion and outreach*  
*Specialist analysis*

**ARCHAEOLOGICAL SOLUTIONS LTD**

**98-100 Fore Street, Hertford SG14 1AB  
Tel 01992 558170**

**Unit 6, Brunel Business Court, Eastern Way,  
Bury St Edmunds IP32 7AJ  
Tel 01284 765210**

**e-mail [info@ascontracts.co.uk](mailto:info@ascontracts.co.uk)  
[www.archaeologicalsolutions.co.uk](http://www.archaeologicalsolutions.co.uk)**



[twitter.com/ArchaeologicalS](https://twitter.com/ArchaeologicalS)



[www.facebook.com/ArchaeologicalSolutions](https://www.facebook.com/ArchaeologicalSolutions)



## **CONTENTS**

### ***OASIS SUMMARY SHEET***

#### ***SUMMARY***

- 1 INTRODUCTION***
- 2 METHODOLOGY***
- 3 DESCRIPTION OF THE SITE***
- 4 PHOTOGRAPHIC SURVEY***

#### ***DEPOSITION OF THE ARCHIVE***

#### ***ACKNOWLEDGEMENTS***

#### ***BIBLIOGRAPHY***

#### ***APPENDICES***

- 1 HER SUMMARY SHEET***
- 2 BUILDING RECORDING ARCHIVE FORM***

<b>OASIS SUMMARY SHEET</b>			
Project name	<i>The Brewhouse at Gorhambury, St Albans, Hertfordshire. Historic Photographic Recording</i>		
<b>Summary</b>			
<p><i>In October 2013 Archaeological Solutions (AS) conducted a historic photographic recording at the Brewhouse, Gorhambury, St Albans, Hertfordshire (TL 11351 07922). The recording was carried out as part of a series of investigations as required by a planning condition attached to planning approval for a scheme to install a biomass boiler within the building (St Albans Ref. 5/2013/1067).</i></p> <p><i>The photographic recording was carried out with medium format black and white film duplicated by digital photography and included general views of the exterior of the brewhouse as well as internal coverage with attention paid to the roof and ventilation louvres set at high level.</i></p>			
Project dates (fieldwork)	<i>28<sup>th</sup> October 2013</i>		
Previous work (Y/N/?)	<i>N</i>	Future work (Y/N/?)	<i>Y</i>
P. number	<i>5443</i>	Site code	<i>AS1642</i>
Type of project	<i>Historic building recording</i>		
Site status	<i>Area of archaeological importance</i>		
Current land use	<i>Building used for storage</i>		
Planned development	<i>Building to house biomass boiler</i>		
Main features (+dates)	<i>Late 18<sup>th</sup> / early 19<sup>th</sup> century brewhouse</i>		
Significant finds (+dates)	<i>n/a</i>		
<b>Project location</b>			
County/ District/ Parish	<i>Hertfordshire</i>	<i>St Albans</i>	<i>St Michael</i>
HER for area	<i>HALS</i>		
Post code (if known)	<i>-</i>		
Area of site	<i>-</i>		
NGR	<i>TL 11351 07922</i>		
Height AOD (max)	<i>124.28m AOD</i>		
<b>Project creators</b>			
Brief issued by	<i>St Albans SADC (Simon West)</i>		
Project supervisor/s (PO)	<i>Lisa Smith</i>		
Funded by	<i>Novapower Limited</i>		
Full title	<i>The Brewhouse at Gorhambury, St Albans, Hertfordshire. Historic Photographic Recording</i>		
Authors	<i>Smith, L.</i>		
Report no.	<i>4452</i>		
Date (of report)	<i>November 2013</i>		

THE BREWHOUSE AT GORHAMBURY  
ST ALBANS  
HERTFORDSHIRE

HISTORIC PHOTOGRAPHIC RECORDING

**SUMMARY**

*In October 2013 Archaeological Solutions (AS) conducted a historic photographic recording at the brewhouse, Gorhambury, St Albans, Hertfordshire (TL 11351 07922). The recording was carried out as part of a series of investigations as required by a planning condition attached to planning approval for a scheme to install a biomass boiler within the building (St Albans Ref. 5/2013/1067).*

*The photographic recording was carried out with medium format black and white film duplicated by digital photography and included general views of the exterior of the brewhouse as well as internal coverage with attention paid to the roof and ventilation louvres set at high level.*

**1 INTRODUCTION**

1.1 In October 2013 Archaeological Solutions (AS) conducted a historic photographic recording at the Brewhouse, Gorhambury, St Albans, Hertfordshire (TL 11351 07922). The recording was carried out as part of a series of investigations as required by a planning condition attached to planning approval for a scheme to install a biomass boiler within the building (St Albans Ref. 5/2013/1067).

1.2 The historic photographic recording conformed to a specification prepared by AS dated 7<sup>th</sup> August 2013 in response to a requirement of the St Albans City & District Council District Archaeologist (SADC; Simon West). The project followed the procedures set out in English Heritage's '*Understanding historic buildings: a guide to good recording practice*' (2006), and also conformed to the Institute for Archaeologists' '*Standard and guidance for the archaeological investigation and recording of standing buildings or structures*' (IFA 2008). The recording was conducted to **Level 2/3** as defined in the EH document.

1.3 The main elements of the project were:

- to compile a photographic record of the existing building prior to alterations.

1.4 Further building / archaeological monitoring is to take place during the works and will be the subject of an augmented report to be compiled at the conclusion of the project.

## *Planning policy*

1.5 The National Planning Policy Framework (NPPF 2012) states that those parts of the historic environment that have significance because of their historic, archaeological, architectural or artistic interest are heritage assets. The NPPF aims to deliver sustainable development by ensuring that policies and decisions that concern the historic environment recognise that heritage assets are a non-renewable resource, take account of the wider social, cultural, economic and environmental benefits of heritage conservation, and recognise that intelligently managed change may sometimes be necessary if heritage assets are to be maintained for the long term. The NPPF requires applications to describe the significance of any heritage asset, including its setting that may be affected in proportion to the asset's importance and the potential impact of the proposal.

1.6 The NPPF aims to conserve England's heritage assets in a manner appropriate to their significance with substantial harm to designated heritage assets (i.e. listed buildings and scheduled monuments) only permitted in exceptional circumstances when the public benefit of a proposal outweighs the conservation of the asset. The effect of proposals on non-designated heritage assets must be balanced against the scale of loss and significance of the asset, but non-designated heritage assets of demonstrably equivalent significance may be considered subject to the same policies as those that are designated. The NPPF states that opportunities to capture evidence from the historic environment, to record and advance the understanding of heritage assets and to make this publicly available is a requirement of development management. This opportunity should be taken in a manner proportionate to the significance of a heritage asset and to impact of the proposal, particularly where a heritage asset is to be lost.

## **2 METHODOLOGY**

2.1 The site was visited on 28<sup>th</sup> October 2013 in order to carry out the photographic recording of the building. It was carried out by Lisa Smith using medium format (4.5cm x 6cm) black and white film. This utilised a Zenza Bronica ETRS camera and Ilford HP5 IOS 400 120mm film. Colour photographs were taken using a Canon 60D (18 megapixels) digital camera, duplicating the black and white photography. Where necessary, architectural detail was captured using 35mm black and white film and supplementary colour photography used 35mm Ektachrome colour transparency. External lighting and weather conditions were good at the time of the survey. A scale was used wherever possible, and a flash was employed for internal shots. The digital photographs have been included as colour plates, together with their location plots shown on a sketch plan (Fig. 3).

### **3 DESCRIPTION OF THE SITE (Figs. 1 & 2)**

3.1 The Brewhouse lies at the heart of the Gorhambury estate located between the main house and cottages to the south and the old stable yard to the north. The estate lies to the west of St Albans enclosed on the west by the M1. The house itself was built between 1777 and 1784 to replace the earlier Tudor mansion, fragments of which remain as a picturesque ruin nearby. The Brewhouse now used as a storage facility. It is proposed to install a biomass boiler within the building.

### **DEPOSITION OF THE ARCHIVE**

An archive of all materials produced by the report has been created and listed according to English Heritage (MAP2) standards. Copies of the final report will be lodged with the Hertfordshire Heritage Environment Record (HER) and the National Monument Record (NMR), Swindon. The project archive will be lodged with Hertfordshire Archives and Local Studies (HALS).

### **ACKNOWLEDGEMENTS**

Archaeological Solutions is grateful to Mr David Jardine-Paterson of Novapower Limited for commissioning the work.

AS would also like to acknowledge the input and advice of Mr Simon West of SADC.

### **BIBLIOGRAPHY**

English Heritage's *'Understanding historic buildings: a guide to good recording practice'* (2006)

Institute for Archaeologists' *'Standard and guidance for the archaeological investigation and recording of standing buildings or structures'* (IFA 2008).

## APPENDIX 1 HER SUMMARY SHEET

<b>Site name and address:</b>	The Brewhouse at Gorhambury, St Albans, Herts
<b>County:</b> Hertfordshire	<b>District:</b> St Albans
<b>Village/Town:</b> St Albans	<b>Parish:</b>
<b>Planning application reference:</b>	St Albans Ref. 5/2013/1067
<b>Client name/address/tel:</b>	Novapower Limited
<b>Nature of application:</b>	Building to house a biomass boiler
<b>Present land use:</b>	Used for storage
<b>Size of application area:</b>	<b>Size of area investigated</b>
<b>NGR (8 figures):</b>	TL 11351 07922
<b>Site Code:</b>	AS1642
<b>Site director/Organization:</b>	Archaeological Solutions
<b>Type of work:</b>	Historic photographic recording
<b>Date of work:</b>	October 2013
<b>Location of finds/Curating museum:</b>	HALS
<b>Related SMR Nos:</b>	<b>Periods represented:</b>
<b>Relevant previous summaries/reports: -</b>	
<b>Summary of fieldwork results:</b>	<p>In October 2013 Archaeological Solutions (AS) conducted a historic photographic recording at the brewhouse, Gorhambury, St Albans, Hertfordshire (TL 11351 07922). The recording was carried out as part of a series of investigations as required by a planning condition attached to planning approval for a scheme to install a biomass boiler within the building (St Albans Ref. 5/2013/1067).</p> <p>The photographic recording was carried out with medium format black and white film duplicated by digital photography and included general views of the exterior of the brewhouse as well as internal coverage with attention paid to the roof and ventilation louvres set at high level.</p>
<b>Author of summary:</b> Lisa Smith	<b>Date of Summary:</b> October 2013



## APPENDIX 2      ARCHAEOLOGICAL SOLUTIONS BUILDING RECORDING ARCHIVE FORM

Site Details							
<b>Site Name:</b> The brewhouse at Gorhambury, St Albans, Hertfordshire					<b>NGR:</b> TL 11351 07922		
<b>County:</b> Hertfordshire				<b>Museum Collecting Area:</b> HALS			
<b>Site Code:</b> AS1642				<b>Project Number:</b> 5443			
<b>Date of Work:</b> October 2013				<b>Related Work:</b>			
Brief/s				Specification/s			
Date		Present		Date		Present	
None		-		7 <sup>th</sup> August 2013		Yes	
Site Records (Description)							
Notes taken on site (1 pages A4)							
Site Drawings (Give Details of Formats & Size)							
-							
Architect's Drawings:							
Plans and elevations 3 sheets A3 Plans and elevations 2 sheets A4							
Digital Drawings							
Printouts of Drawings			Printouts of Data			Digital Data	
In report						Digital photographs and drawings in digital format on CD	
Reports							
Report No		Report Type				Present	
4452		Historic Building Recording				Yes	
Site Photographs							
Black & White Contact Prints					Colour Slides		
Film No	Film Type	Negs	Negs Present	Contacts Present	Film No	Negs	Present
1	120mm	9-15	Yes	Yes	1	1 -9	Yes
2	120mm	1-15	Yes	Yes			
Photographic Location Plans Present? (Give Details)							
In report and separate printouts in archive folder							
Digital Photographs (Give Details):							
Digital photography. Index and selected plates printed in report. Separate printout of index included in archive folder and digitally on CD							

#### 4 PHOTOGRAPHIC SURVEY



DP 1 The brewhouse, taken from the north



DP 2 North-east elevation, taken from the north-east



DP 3 Ventilation apertures at high level, north-east elevation, taken from the north-east



DP 4

The brewhouse, taken from the west



DP 5

North-west elevation, taken from the south-west



DP 6

Lower fenestration to the north-west elevation, taken from the south-west



DP 7 Original sash windows removed and replaced with casements, north-west elevation, taken from the north



DP 8

South-west elevation, taken from the south-west



DP 9

The brewhouse, taken from the south



DP 10

Double doors to the north-east elevation, taken from the south-west



DP 11 Interior, north-east end of the building, taken from the south-west



DP 12 Interior, north-east end of the building, taken from the south



DP 13 Interior, south-west end of the building, taken from the north-east



DP 14 Interior, south-west end of the building, taken from the east





DP 15 Interior, south-east corner of the building, taken from the west



DP 16 Low brick plinth against north-east wall, taken from the north-west



DP 17 Later casement windows fitted from the inside, north-west elevation, taken from the east



DP 18

Roof structure, taken from the north-east



DP 19

Roof structure, taken from the south-west



DP 20

Timber cupola as part of the roof structure, taken from the north-west



DP 21

Upper ventilation louvres behind mesh, taken from the west



DP 22

Roof structure and cupola, taken from the north-east



DP 23 Upper ventilation louvres, taken from the east



DP 24 Opening mechanism for ventilation louvres, taken from the south-east



DP 25

Opening mechanism for ventilation louvres, taken from the south-east

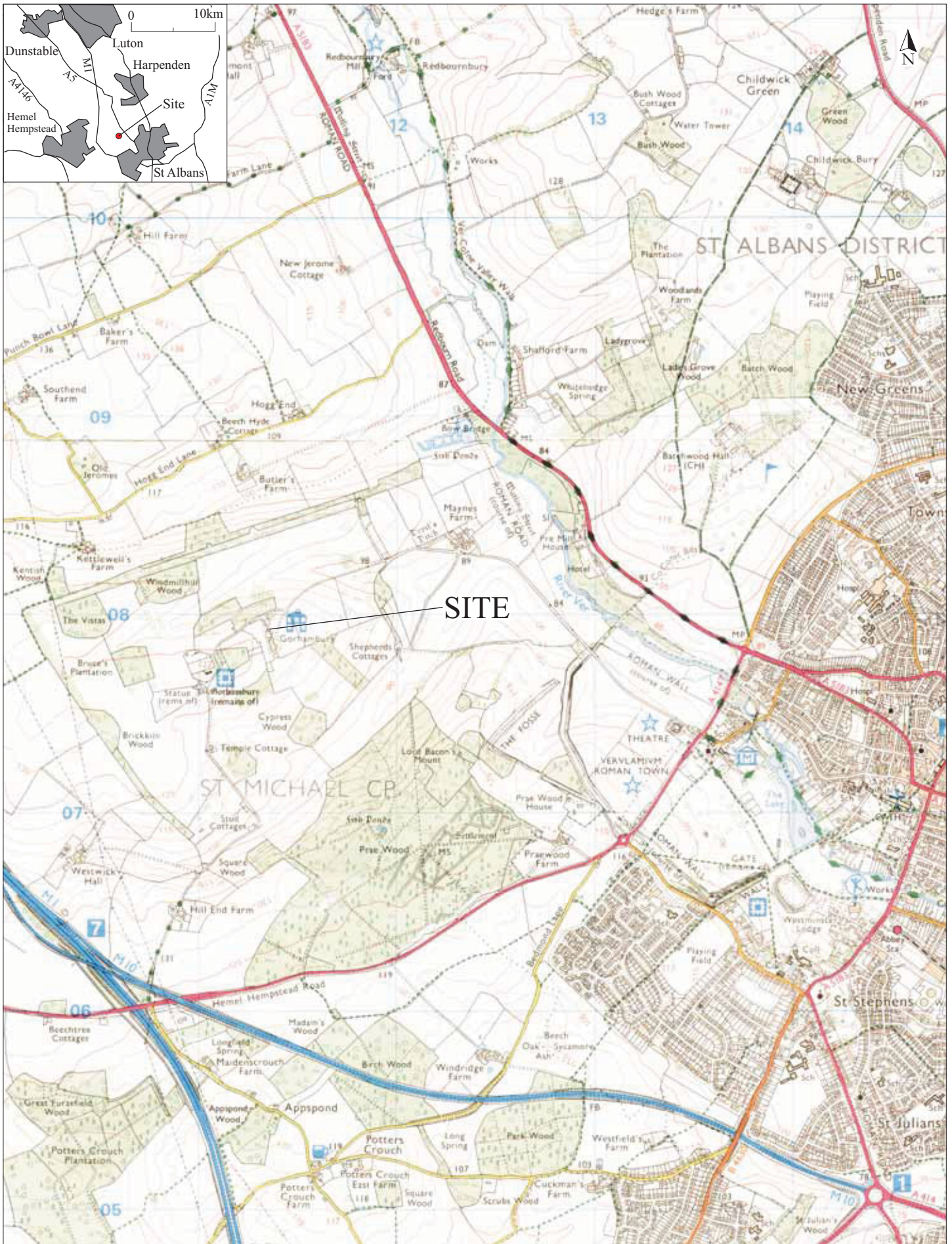

Reproduced from the 1999 Ordnance Survey 1:25000 map with the permission of Her Majesty's Stationery Office. © Crown copyright Archaeological Solutions Ltd Licence number 100036680

*Archaeological Solutions Ltd*  
**Fig. 1 Site location plan**  
 Scale 1:25,000 at A4

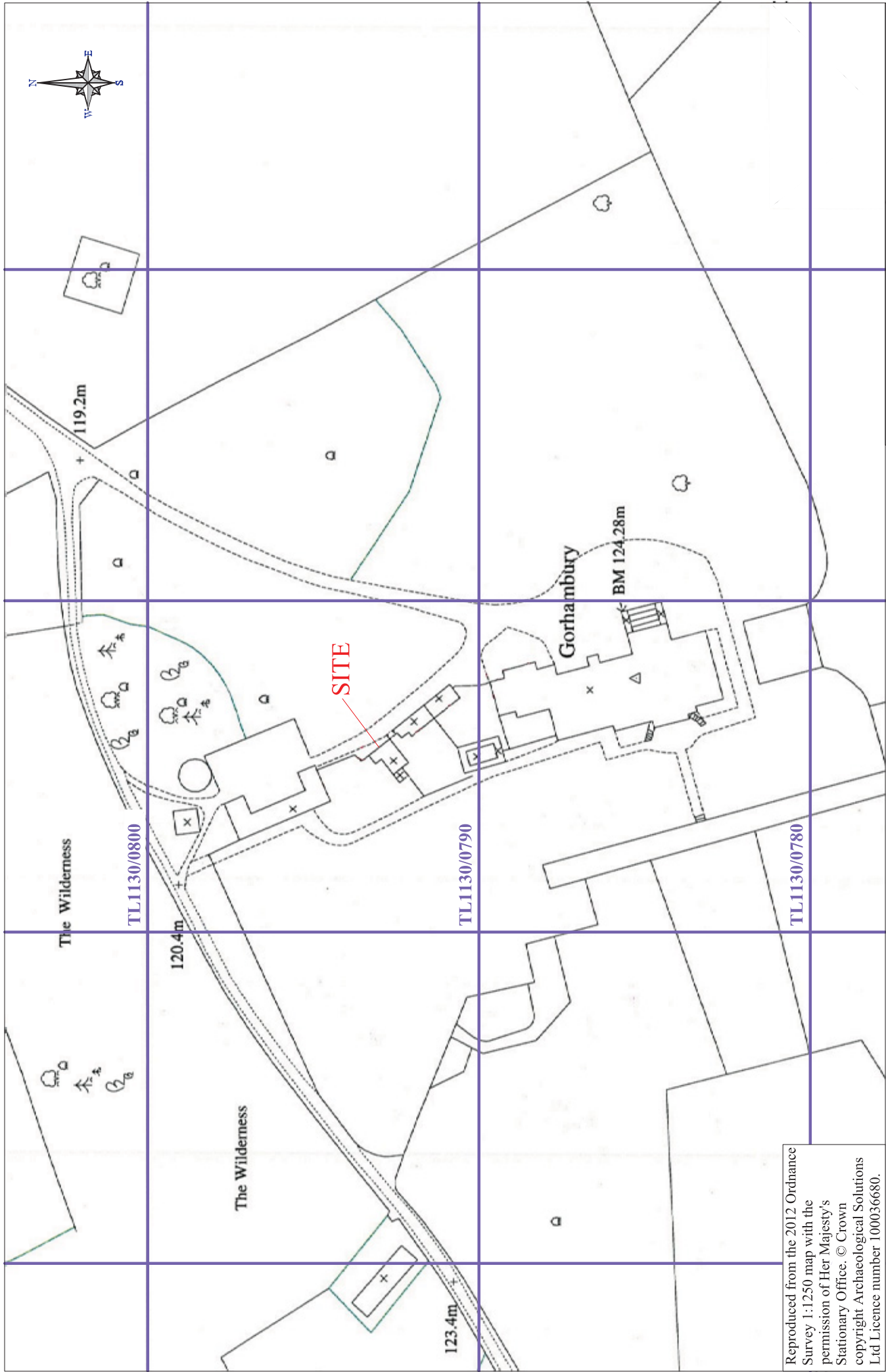



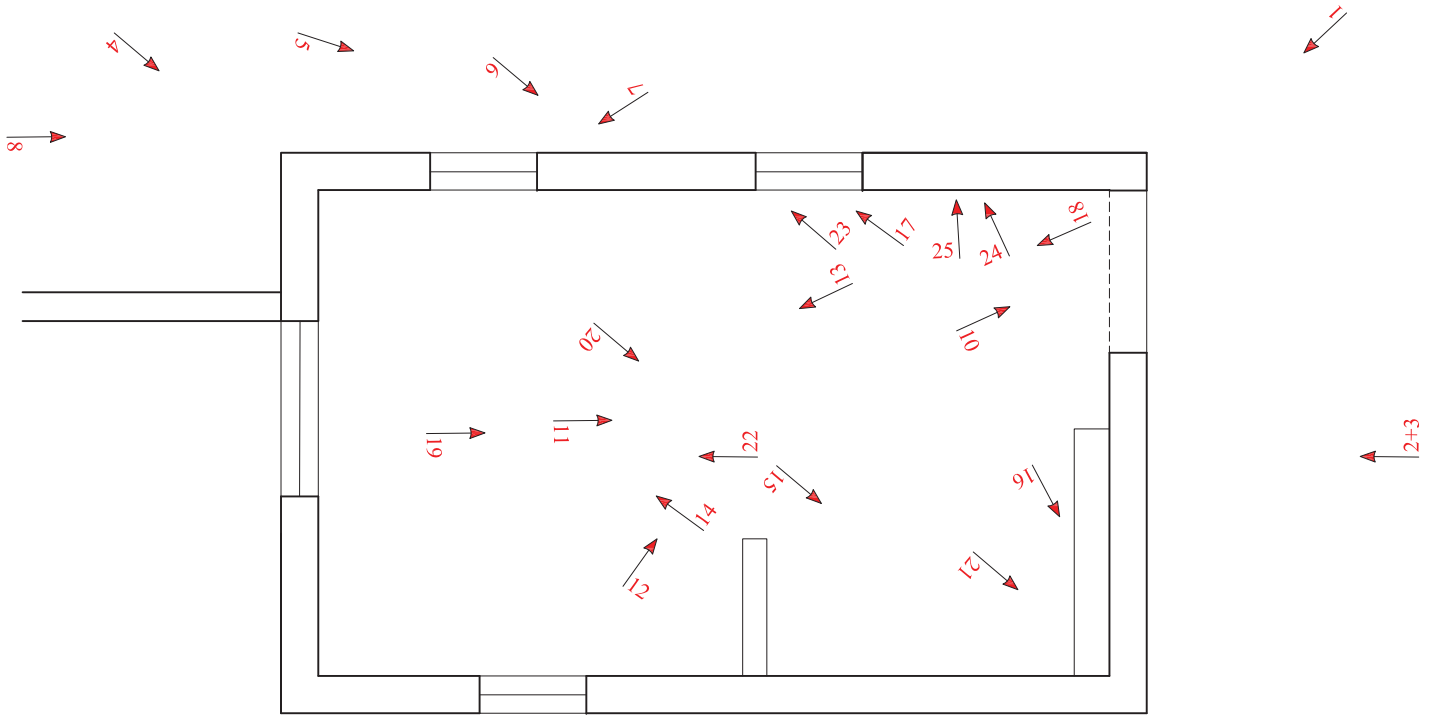

GROUND FLOOR



→ Photographic location



<i>Archaeological Solutions Ltd</i>
<b>Fig. 3 Photographic location plan</b>
Scale 1:150 at A4