ARCHAEOLOGICAL SOLUTIONS LTD

**LAND AT THE CRUMP, BRICKHOUSE LANE,
BERDEN, ESSEX CM23 1AZ**

ARCHAEOLOGICAL EVALUATION

Authors: Julie Walker (Fieldwork and report)	
NGR: TL 46946 28988	Report No: 5147
District: Uttlesford	Site Code: BETC16
Approved: Claire Halpin MCIfA	Project No: 6522
Signed:	Date: 14 June 2016

This report is confidential to the client. Archaeological Solutions Ltd accepts no responsibility or liability to any third party to whom this report, or any part of it, is made known. Any such party relies upon this report entirely at their own risk. No part of this report may be reproduced by any means without permission.

Archaeological Solutions is an independent archaeological contractor providing the services which satisfy all archaeological requirements of planning applications, including:

Desk-based assessments and environmental impact assessments
Historic building recording and appraisals
Trial trench evaluations
Geophysical surveys
Archaeological monitoring and recording
Archaeological excavations
Post excavation analysis
Promotion and outreach
Specialist analysis

ARCHAEOLOGICAL SOLUTIONS LTD

Unit 6, Brunel Business Court, Eastern Way,
Bury St Edmunds IP32 7AJ
Tel 01284 765210

P I House, Rear of 23 Clifton Road, Shefford,
Bedfordshire, SG17 5AF
Tel: 01462 850483

e-mail: info@ascontracts.co.uk
www.archaeologicalsolutions.co.uk



twitter.com/ArchaeologicalS



www.facebook.com/ArchaeologicalSolutions



CONTENTS

OASIS SUMMARY SHEET

SUMMARY

- 1 *INTRODUCTION***
- 2 *DESCRIPTION OF THE SITE***
- 3 *ARCHAEOLOGICAL AND HISTORICAL BACKGROUND***
- 4 *METHODOLOGY***
- 5 *DESCRIPTION OF RESULTS***
- 6 *CONFIDENCE RATING***
- 7 *DEPOSIT MODEL***
- 8 *DISCUSSION***
- 9 *DEPOSITION OF THE ARCHIVE***

ACKNOWLEDGEMENTS

BIBLIOGRAPHY

OASIS SUMMARY SHEET

Project details			
Project name		<i>Land at The Crump, Brickhouse Lane, Berden, Essex CM23 1AZ</i>	
<p><i>In June 2016 Archaeological Solutions (AS) carried out an archaeological trial trench evaluation on land at The Crump, Brickhouse Lane, Berden, Essex CM23 1AZ (NGR TL 46946 28988). It is proposed to change the use of agricultural land to grazing and erect a new stable block with new access drive. The evaluation was carried out in compliance with a planning condition of Uttlesford District Council, as advised by the Historic Environment Advisor of Essex County Council (Planning Ref. UTT/15/2983/FUL).</i></p> <p><i>The site lies within an area of archaeological potential as highlighted on the Essex Historic Environment Record (EHER). The medieval ringwork of The Crump lies immediately adjacent to the south. This is Scheduled as an Ancient Monument (SM 20665). It comprises a mound and ditch earthwork to the rear of the property of The Crump, with no obvious causeway access across the ditch into the area of the inner mound. It has been subject to a partial excavation by the site owner which revealed quantities of 12th century pottery suggesting the earthwork is of medieval date.</i></p> <p><i>One of the evaluation trenches contained features (Trench 1), and the features were linears (Ditches F1005 and F1007, and Gully F1009). Ditch F1007 contained a fragment of modern CBM and the other features contained no finds. No direct association with the medieval ringwork was evident.</i></p>			
Project dates (fieldwork)		<i>June 2016</i>	
Previous work (Y/N/?)		<i>N</i>	Future work (Y/N/?) <i>TBC</i>
P. number		<i>6522</i>	Site code <i>BETC16</i>
Type of project		<i>Archaeological Evaluation</i>	
Site status		<i>None</i>	
Current land use		<i>Agricultural</i>	
Planned development		<i>Stable block</i>	
Main features (+dates)		<i>Linears (ditches, gully)</i>	
Significant finds (+dates)		<i>None</i>	
Project location			
County/ District/ Parish		<i>Essex</i>	<i>Uttlesford</i> <i>Berden</i>
HER/ SMR for area		<i>Essex Historic Environment Record</i>	
Post code (if known)		<i>-</i>	
Area of site		<i>c. ha.</i>	
NGR		<i>TL 46946 28988</i>	
Height AOD (min/max)		<i>c. 117m AOD</i>	
Project creators			
Brief issued by		<i>Essex County Council</i>	
Project supervisor/s (PO)		<i>Julie Walker</i>	
Funded by		<i>Ms Kerinda Ibbotson</i>	
Full title		<i>Land at The Crump, Brickhouse Lane, Berden, Essex CM23 1AZ. An Archaeological Evaluation</i>	
Authors		<i>Walker, J.</i>	
Report no.		<i>5147</i>	
Date (of report)		<i>June 2016</i>	

LAND AT THE CRUMP, BRICKHOUSE LANE, BERDEN, ESSEX CM23 1AZ

ARCHAEOLOGICAL EVALUATION

SUMMARY

In June 2016 Archaeological Solutions (AS) carried out an archaeological trial trench evaluation on land at The Crump, Brickhouse Lane, Berden, Essex CM23 1AZ (NGR TL 46946 28988). It is proposed to change the use of agricultural land to grazing and erect a new stable block with new access drive. The evaluation was carried out in compliance with a planning condition of Uttlesford District Council, as advised by the Historic Environment Advisor of Essex County Council (Planning Ref. UTT/15/2983/FUL).

The site lies within an area of archaeological potential as highlighted on the Essex Historic Environment Record (EHER). The medieval ringwork of The Crump lies immediately adjacent to the south. This is Scheduled as an Ancient Monument (SM 20665). It comprises a mound and ditch earthwork to the rear of the property of The Crump, with no obvious causeway access across the ditch into the area of the inner mound. It has been subject to a partial excavation by the site owner which revealed quantities of 12th century pottery suggesting the earthwork is of medieval date.

The site therefore had a potential for evidence of activity associated with the adjacent medieval defensive ringwork, which may have attracted contemporary occupation adjacent to it.

In the event one of the evaluation trenches contained features (Trench 1), and the features were linears (Ditches F1005 and F1007, and Gully F1009). Ditch F1007 contained a fragment of modern CBM and the other features contained no finds. No direct association with the medieval ringwork was evident.

1 INTRODUCTION

1.1 In June 2016 Archaeological Solutions (AS) carried out an archaeological trial trench evaluation on land at The Crump, Brickhouse Lane, Berden, Essex CM23 1AZ (NGR TL 46946 28988; Figs. 1 - 2). It is proposed to change the use of agricultural land to grazing and erect a new stable block with new access drive. The evaluation was carried out in compliance with a planning condition of Uttlesford District Council, as advised by the Historic Environment Advisor of Essex County Council (Planning Ref. UTT/15/2983/FUL).

1.2 The evaluation was undertaken in accordance to a brief prepared by the Historic Environment Advisor of Essex County Council (ECC HEA; *Brief for Archaeological Trial Trenching and Excavation on land at The Crump, Brickhouse Lane, Berden*, dated 4th December 2015), and a written scheme of investigation (specification) prepared by AS (dated 14th December 2015), and approved by ECC HEA. The project conformed to the Chartered Institute for Archaeologists (CIfA) *Code of Conduct and Standard and Guidance for an Archaeological Evaluation* (2014), as well as the document *Standards for Field Archaeology in the East of England* (Gurney 2003).

1.3 The objectives of the evaluation were to determine the location, date, extent, character, condition significance and quality of any archaeological remains liable to be threatened by the proposed development.

Planning policy context

1.4 The National Planning Policy Framework (NPPF 2012) states that those parts of the historic environment that have significance because of their historic, archaeological, architectural or artistic interest are heritage assets. The NPPF aims to deliver sustainable development by ensuring that policies and decisions that concern the historic environment recognise that heritage assets are a non-renewable resource, take account of the wider social, cultural, economic and environmental benefits of heritage conservation, and recognise that intelligently managed change may sometimes be necessary if heritage assets are to be maintained for the long term. The NPPF requires applications to describe the significance of any heritage asset, including its setting that may be affected in proportion to the asset's importance and the potential impact of the proposal.

1.5 The NPPF aims to conserve England's heritage assets in a manner appropriate to their significance, with substantial harm to designated heritage assets (i.e. listed buildings, scheduled monuments) only permitted in exceptional circumstances when the public benefit of a proposal outweighs the conservation of the asset. The effect of proposals on non-designated heritage assets must be balanced against the scale of loss and significance of the asset, but non-designated heritage assets of demonstrably equivalent significance may be considered subject to the same policies as those that are designated. The NPPF states that opportunities to capture evidence from the historic environment, to record and advance the understanding of heritage assets and to make this publicly available is a requirement of development management. This opportunity should be taken in a manner proportionate to the significance of a heritage asset and to impact of the proposal, particularly where a heritage asset is to be lost.

2 DESCRIPTION OF THE SITE

3.1 The site lies on the eastern side of Brickhouse Lane at Berden, immediately to the north of The Crump. It comprises existing agricultural land. A new access is proposed through a break in the roadside hedge, and a new stable block is to be built.

3 ARCHAEOLOGICAL AND HISTORICAL BACKGROUND

3.1 The site lies within an area of archaeological potential as highlighted on the Essex Historic Environment Record (EHER). The medieval ringwork of The Crump lies immediately adjacent to the south. This is Scheduled as an Ancient Monument (SM 20665). It comprises a mound and ditch earthwork to the rear of the property of The Crump, with no obvious causeway access across the ditch into the area of the inner mound. It has been subject to a partial excavation by the site owner which revealed quantities of 12th century pottery suggesting the earthwork is of medieval date.

3.2 The site therefore had a potential for evidence of activity associated with the adjacent medieval defensive ringwork, which may have attracted contemporary occupation adjacent to it.

4 METHODOLOGY

4.1 The brief required a sample of the proposed development site to be investigated by trial trenching with one trench across the footprint of the proposed new stable block and a further trench within the proposed new access road. The trenches were each 15m x 1.6m (Fig.2).

4.2 The topsoil was mechanically excavated under close archaeological supervision. Exposed surfaces were cleaned by hand and examined for archaeological features. Deposits were recorded using *pro forma* recording sheets, drawn to scale, and photographed as appropriate. Excavated spoil was searched for finds and the trenches were scanned by a metal detector.

5 DESCRIPTION OF RESULTS

5.1 The individual trench descriptions are presented below:

Trench 1 (Figs. 2-3)

<i>Sample section 1A</i> 0.00 = 117.21m AOD		
0.00 – 0.04m	L1001	Gravel
0.04 – 0.24m	L1002	Levelling Layer
0.24 – 0.36m	L1000	Topsoil. Friable, dark grey brown clayey silt with occasional small stones
0.36m+	L1003	Natural deposits. Compact, light yellow clay and chalk

<i>Sample section 1B</i> 0.00 = 117.34m AOD		
0.26 – 0.26m	L1000	Topsoil. As above.
0.26m+	L1003	Natural deposits. As above.

Description: Trench 1 contained Ditches F1005 and F1007, and Gully F1009. Ditch F1007 contained a fragment of modern CBM and the other features contained no finds.

Ditch F1005 was linear (2.00+ x 0.40 x 0.12m), orientated east / west. It had moderately steep sides and a concave base. Its fill, L1006, was a firm, mid orange brown clayey silt with sparse small stones. It contained no finds.

Ditch F1007 was linear (2.00+ x 0.84 x 0.28m), orientated north east / south west. It had steep sides and a concave base. Its fill, L1008, was a firm, mid grey brown clayey silt with occasional small stones. It contained a fragment of modern CBM.

Gully F1009 was curvilinear (2.00+ x 0.32 x 0.08m). It had moderately sloping sides and a concave base. Its fill, L1009, was a firm, mid grey brown clayey. It contained no finds.

Trench 2 (Fig. 2)

<i>Sample section 2A</i> 0.00 = 117.32m AOD		
0.00 – 0.21m	L1000	Topsoil. As above.
0.21m+	L1003	Natural. As above.

<i>Sample section 2B</i> 0.00 = 117.37m AOD		
0.00 – 0.23m	L1000	Topsoil. As above.
0.23m+	L1001	Natural deposits. As above.

Description: Trench 2 contained no archaeological features or finds.

6 CONFIDENCE RATING

6.1 Within the area of the site examined, it is not felt that any factors inhibited the recognition of archaeological features or finds.

7 DEPOSIT MODEL

7.1 Topsoil L1000 was a friable, dark grey brown clayey silt with occasional small stones (c. 0.25m thick). L1000 overlay the natural geology, L1001. The latter comprised a compact, light yellow clay and chalk (0.21 – 0.36m below the present day ground surface).

8 DISCUSSION

8.1 The site lies within an area of archaeological potential as highlighted on the Essex Historic Environment Record (EHER). The medieval ringwork of The Crump lies immediately adjacent to the south. This is Scheduled as an Ancient Monument (SM 20665). It comprises a mound and ditch earthwork to the rear of the property of The Crump, with no obvious causeway access across the ditch into the area of the inner mound. It has been subject to a partial excavation by the site owner which revealed quantities of 12th century pottery suggesting the earthwork is of medieval date.

8.2 The site therefore had a potential for evidence of activity associated with the adjacent medieval defensive ringwork, which may have attracted contemporary occupation adjacent to it.

8.3 In the event one of the evaluation trenches contained features (Trench 1), and the features were linears (Ditches F1005 and F1007, and Gully F1009). Ditch F1007 contained a fragment of modern CBM and the other features contained no finds. No direct association with the medieval ringwork was evident.

9 DEPOSITION OF THE ARCHIVE

9.1 Archive records, with inventory, will be deposited at Saffron Walden Museum in accordance with their requirements. The archive will be quantified, ordered, indexed, cross-referenced and checked for internal consistency. In addition to the overall site summary, it will be necessary to produce a summary of the artefactual and ecofactual data.

ACKNOWLEDGEMENTS

Archaeological Solutions would like to thank Ms Kerinda Ibbotson for funding the works, and Mr Jeremy Whitton-Spriggs and architects Hibbs & Walsh, in particular Mr Sebastian Walsh

AS would like to acknowledge the input and advice of Mr Richard Havis of Essex County Council

BIBLIOGRAPHY

British Geological Survey 1991 *East Anglia Sheet 52°N-00° 1:250,000 Series Quaternary Geology*. Ordnance Survey, Southampton

Gurney, D. 2003 *Standards for Field Archaeology in the East of England*. East Anglian Archaeology Occasional Paper no. 14

Chartered Institute for Archaeologists 2014 *Standard and Guidance for Archaeological Evaluation*

SSEW 1983 *Soil Survey of England and Wales: Soils of South East England (sheet 4)*. Harpenden, Rothamsted Experimental Station/Lawes Agricultural Trust

SSEW 1983 *Soil Survey of England and Wales: Legend for the 1:250,000 Soil Map of England and Wales* Harpenden, Rothamsted Experimental Station/Lawes Agricultural Trust

PHOTOGRAPHIC INDEX



1
View of Trench 1 looking south-east



2
F1005 in Trench 1 looking west



3
F1007 in Trench 1 looking south-west



4
F1009 in Trench 1 looking south-west



5
Sample Section 1A in Trench 1 looking north-east



6
Sample Section 1B in Trench 1 looking south-west



7
Sample Section 2A in Trench 2 looking north-east



8
Sample Section 2B in Trench 2 looking south-west

PHOTOGRAPHIC INDEX



1
View of Trench 1 looking south-east



2
F1005 in Trench 1 looking west



3
F1007 in Trench 1 looking south-west



4
F1009 in Trench 1 looking south-west



5
Sample Section 1A in Trench 1 looking north-east



6
Sample Section 1B in Trench 1 looking south-west



7
Sample Section 2A in Trench 2 looking north-east



8
Sample Section 2B in Trench 2 looking south-west



Reproduced from the 1999 Ordnance Survey 1:25000 map with the permission of Her Majesty's Stationery Office. © Crown copyright
 Archaeological Solutions Ltd
 Licence number 100036680

Archaeological Solutions Ltd
Fig. 1 Site location plan
 Scale 1:25,000 at A4
 The Crump, Berden, Essex (P6522)

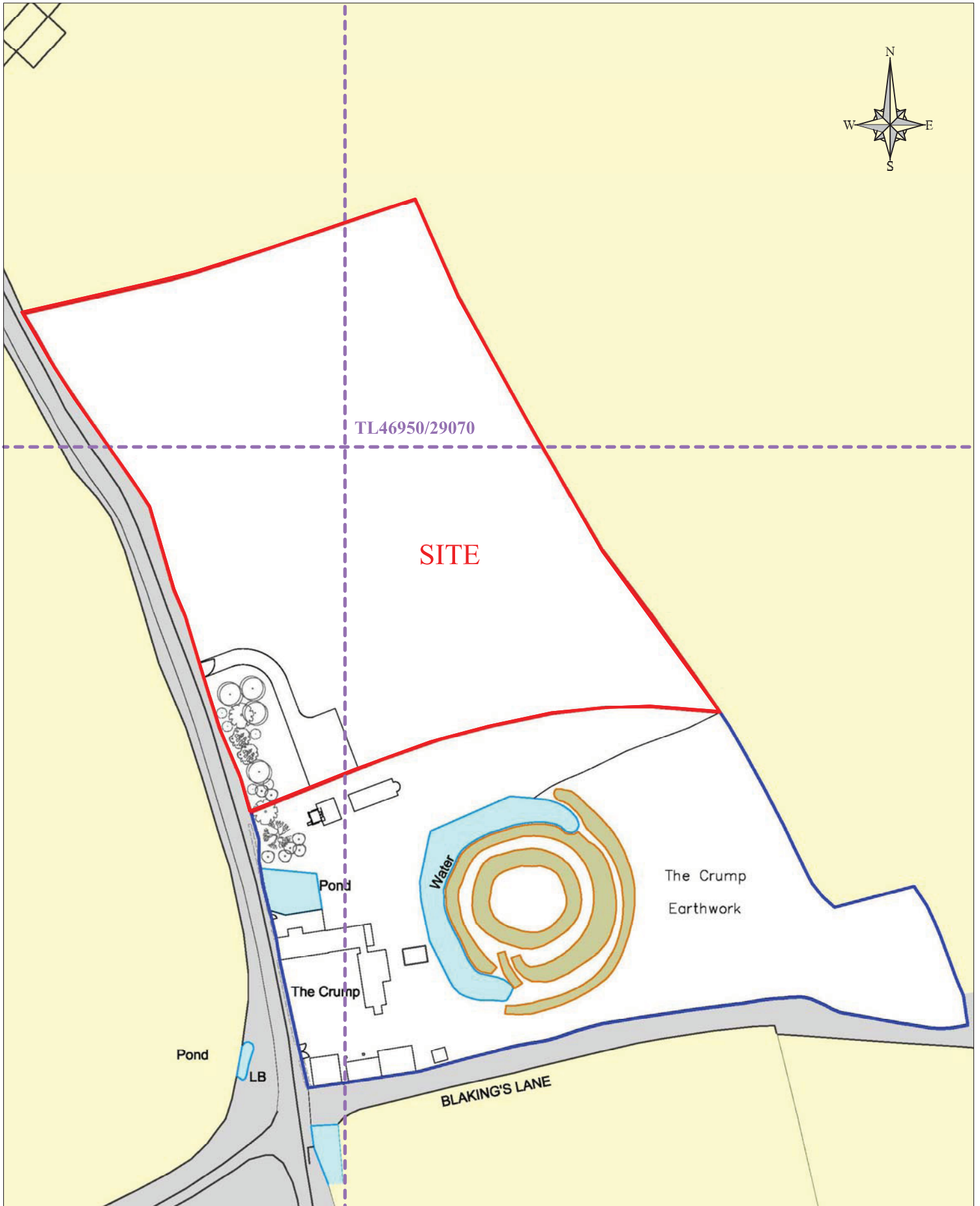

0 50m

<i>Archaeological Solutions Ltd</i>
Fig. 2 Detailed site location plan
Scale 1:1250 at A4
The Crump, Berden, Essex (P6522)

Gate

Proposed Stable Block - 80 sq m

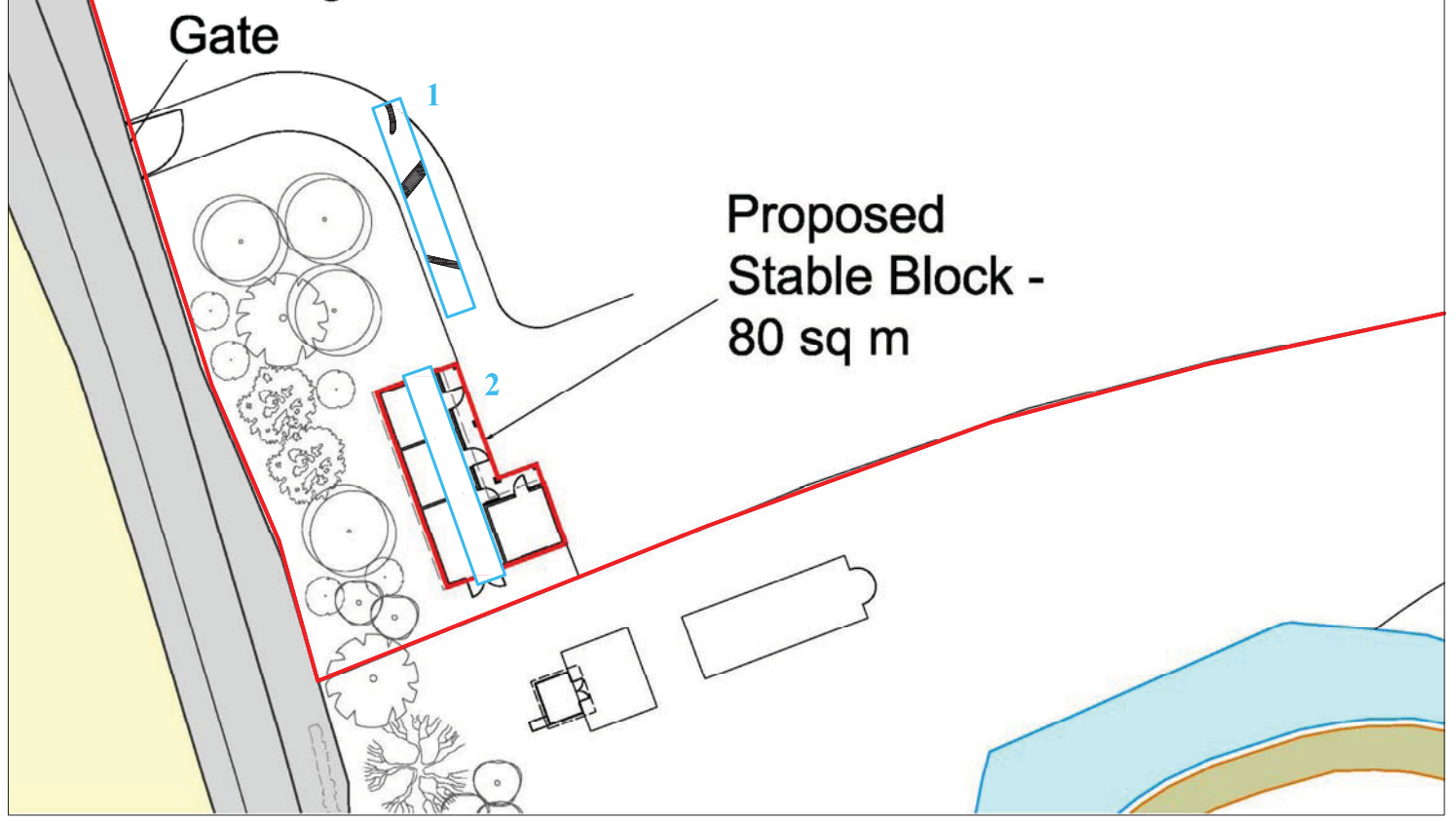

Trench 1

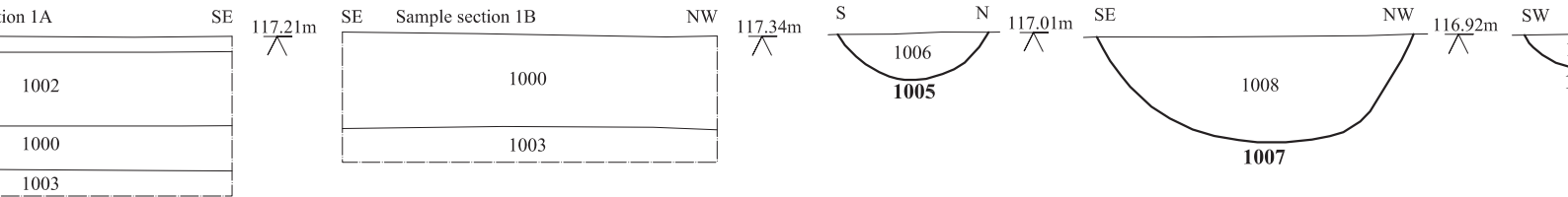
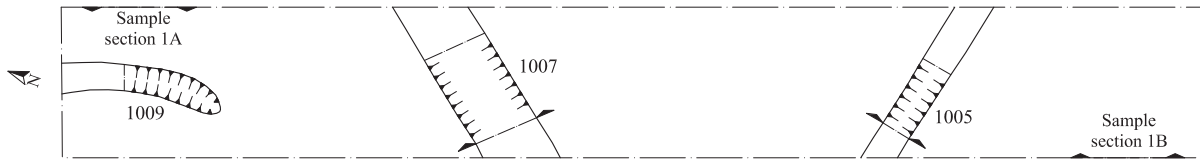

0 Plan only 5m

Trench 2

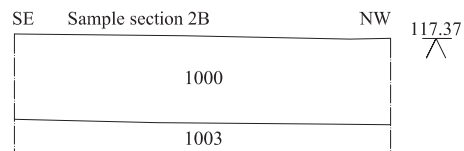
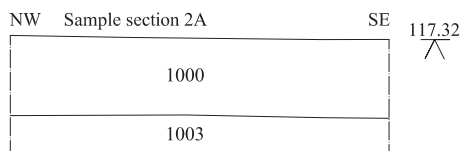

0 Sections only 1m