

ARCHAEOLOGICAL SOLUTIONS LTD

JEANS YARDLING, TYE GREEN VILLAGE, HARLOW, ESSEX CM18 6QZ

ARCHAEOLOGICAL EVALUATION

Authors: Mark Blagg-Newsome (Fieldwork and report)	
NGR: TL 45499 08521	Report No: 5206
District: Harlow	Site Code: HAJY16
Approved: Claire Halpin MCfA	Project No: 6607
	Date: September 2016

This report is confidential to the client. Archaeological Solutions Ltd accepts no responsibility or liability to any third party to whom this report, or any part of it, is made known. Any such party relies upon this report entirely at their own risk. No part of this report may be reproduced by any means without permission.

Archaeological Solutions is an independent archaeological contractor providing the services which satisfy all archaeological requirements of planning applications, including:

Desk-based assessments and environmental impact assessments
Historic building recording and appraisals
Trial trench evaluations
Geophysical surveys
Archaeological monitoring and recording
Archaeological excavations
Post excavation analysis
Promotion and outreach
Specialist analysis

ARCHAEOLOGICAL SOLUTIONS LTD

Unit 6, Brunel Business Court, Eastern Way,
Bury St Edmunds IP32 7AJ
Tel 01284 765210

P I House, Rear of 23 Clifton Road, Shefford,
Bedfordshire, SG17 5AF
Tel: 01462 850483

e-mail: info@ascontracts.co.uk
www.archaeologicalsolutions.co.uk



twitter.com/ArchaeologicalS



www.facebook.com/ArchaeologicalSolutions



CONTENTS

OASIS SUMMARY SHEET

SUMMARY

- 1 INTRODUCTION***
- 2 DESCRIPTION OF THE SITE***
- 3 GEOLOGY, ARCHAEOLOGICAL AND HISTORICAL
BACKGROUND***
- 4 METHODOLOGY***
- 5 DESCRIPTION OF RESULTS***
- 6 CONFIDENCE RATING***
- 7 DEPOSIT MODEL***
- 8 DISCUSSION***
- 9 DEPOSITION OF THE ARCHIVE***

ACKNOWLEDGEMENTS

BIBLIOGRAPHY

WEB SITES

OASIS SUMMARY SHEET

Project details			
Project name	Jeans Yardling, Tye Green Village, Harlow, Essex		
<p>In September 2016 Archaeological Solutions (AS) carried out an archaeological trial trench evaluation on land at Jeans Yardling, Tye Green Village, Harlow, Essex CM18 6QZ (NGR TL 45499 08521; 00442). It is proposed to erect a single new dwelling and garage. The evaluation was carried out in compliance with a planning appeal condition attached to planning permission, as advised by ECC (Harlow Council Planning Approval Ref. HW/PL/15/00285), based on the advice of Historic Environment Advisor of Essex County Council (ECC HEA)</p> <p>Jeans Yardling adjacent is a Grade II listed farmhouse of 16th century date, and the site has the potential to reveal remains of medieval/early post-medieval date associated with the settlement at Tye Green. Jeans Yardling is a timber-framed two-storey building. Historic mapping from 1777 (Chapman & Andre) shows a further building to the south, with the proposed development site an enclosed plot in between.</p> <p>The evaluation revealed no archaeological features or finds.</p>			
Project dates (fieldwork)	September 2016		
Previous work (Y/N/?)	N	Future work (Y/N/?)	N
P. number	6607	Site code	HJY16
Type of project	Archaeological Evaluation		
Site status	None		
Current land use	Garden		
Planned development	Residential		
Main features (+dates)	None		
Significant finds (+dates)	None		
Project location			
County/ District/ Parish	Essex	Harlow	Tye Green
HER/ SMR for area	Essex Historic Environment Record		
Post code (if known)	CM18 6QZ		
Area of site	0.5ha		
NGR	TL 45499 08521		
Height AOD (min/max)	c. 70m AOD		
Project creators			
Brief issued by	Essex County Council		
Project supervisor/s (PO)	Mark Blagg-Newsome		
Funded by	KP Developments Ltd		
Full title	Jeans Yardling, Tye Green Village, Harlow, Essex. An Archaeological Evaluation		
Authors	Blagg-Newsome, M.		
Report no.	5206		
Date (of report)	September 2016		

JEANS YARDLING, TYE GREEN VILLAGE, HARLOW, ESSEX CM18 6QZ

ARCHAEOLOGICAL EVALUATION

SUMMARY

In September 2016 Archaeological Solutions (AS) carried out an archaeological trial trench evaluation on land at Jeans Yardling, Tye Green Village, Harlow, Essex CM18 6QZ (NGR TL 45499 08521; 00442). It is proposed to erect a single new dwelling and garage. The evaluation was carried out in compliance with a planning appeal condition attached to planning permission, as advised by ECC (Harlow Council Planning Approval Ref. HW/PL/15/00285), based on the advice of Historic Environment Advisor of Essex County Council (ECC HEA)

Jeans Yardling adjacent is a Grade II listed farmhouse of 16th century date, and the site had the potential to reveal remains of medieval/early post-medieval date associated with the settlement at Tye Green. Jeans Yardling is a timber-framed two-storey building. Historic mapping from 1777 (Chapman & Andre) shows a further building to the south, with the proposed development site an enclosed plot in between.

The evaluation revealed no archaeological features or finds. The site appeared relatively undisturbed with Subsoil L1002 intact.

1 INTRODUCTION

1.1 In September 2016 Archaeological Solutions (AS) carried out an archaeological trial trench evaluation on land at Jeans Yardling, Tye Green Village, Harlow, Essex CM18 6QZ (NGR TL 45499 08521; 00442; Figs. 1 – 2). It is proposed to erect a single new dwelling and garage. The evaluation was carried out in compliance with a planning appeal condition attached to planning permission, as advised by ECC (Harlow Council Planning Approval Ref. HW/PL/15/00285), based on the advice of Historic Environment Advisor of Essex County Council (ECC HEA)

1.2 The evaluation was undertaken in accordance to a brief prepared by the Historic Environment Advisor of Essex County Council (ECC HEA), *Brief for trial trenching of Jeans Yardling, Tye Green Village, Harlow*, dated 19th February 2016), and a written scheme of investigation (specification) prepared by AS (dated 22nd February

2016), and approved by ECC HEA. The project conformed to the Chartered Institute for Archaeologists (CIfA) *Standard and Guidance for an Archaeological Evaluation* (2014), as well as the document *Standards for Field Archaeology in the East of England* (Gurney 2003).

1.3 The objectives of the evaluation were to determine the location, date, extent, character, condition significance and quality of any archaeological remains liable to be threatened by the proposed development.

Planning policy context

1.4 The National Planning Policy Framework (NPPF 2012) states that those parts of the historic environment that have significance because of their historic, archaeological, architectural or artistic interest are heritage assets. The NPPF aims to deliver sustainable development by ensuring that policies and decisions that concern the historic environment recognise that heritage assets are a non-renewable resource, take account of the wider social, cultural, economic and environmental benefits of heritage conservation, and recognise that intelligently managed change may sometimes be necessary if heritage assets are to be maintained for the long term. The NPPF requires applications to describe the significance of any heritage asset, including its setting that may be affected in proportion to the asset's importance and the potential impact of the proposal.

1.5 The NPPF aims to conserve England's heritage assets in a manner appropriate to their significance, with substantial harm to designated heritage assets (i.e. listed buildings, scheduled monuments) only permitted in exceptional circumstances when the public benefit of a proposal outweighs the conservation of the asset. The effect of proposals on non-designated heritage assets must be balanced against the scale of loss and significance of the asset, but non-designated heritage assets of demonstrably equivalent significance may be considered subject to the same policies as those that are designated. The NPPF states that opportunities to capture evidence from the historic environment, to record and advance the understanding of heritage assets and to make this publicly available is a requirement of development management. This opportunity should be taken in a manner proportionate to the significance of a heritage asset and to impact of the proposal, particularly where a heritage asset is to be lost.

2 DESCRIPTION OF THE SITE

2.1 The site lies in the historic hamlet of Tye Green (Netteswell parish) in the south of Harlow, on the northern side of the road of Tye Green Village, set back from the road, and is currently a lawned

garden plot adjacent to the house of Jeans Yardling. It is proposed to build a new detached dwelling and single garage on the site.

3 GEOLOGICAL, ARCHAEOLOGICAL AND HISTORICAL BACKGROUND

3.1 The site lies within an area of archaeological potential as highlighted on the Essex Historic Environment Record (EHER). Jeans Yardling adjacent is a Grade II listed farmhouse of 16th century date, and the site has the potential to reveal remains of medieval/early post-medieval date associated with the settlement at Tye Green. Jeans Yardling is a timber-framed two-storey building. Historic mapping from 1777 (Chapman & Andre) shows a further building to the south, with the proposed development site an enclosed plot in between.

4 METHODOLOGY

4.1 The brief required a sample of the proposed development site to be investigated by trial trenching with one trench aligned N/S across the footprint of the proposed new dwelling. The trench was 10m x 1.6m (Fig.3).

4.2 The topsoil/subsoil was mechanically excavated under close archaeological supervision. Exposed surfaces were cleaned by hand and examined for archaeological features. Deposits were recorded using *pro forma* recording sheets, drawn to scale, and photographed as appropriate. Excavated spoil was searched for finds and the trenches were scanned by a metal detector.

5 DESCRIPTION OF RESULTS

5.1 The individual trench descriptions are presented below:

Trench 1 (Figs. 2 - 5)

<i>Sample section 1A</i>		
<i>0.00 = 70.66m AOD</i>		
0.00 – 0.16m	L1000	Topsoil. Friable, dark reddish brown, silty clay with occasional small rounded stones.
0.16 – 0.50m	L1001	Made Ground. Firm, dark greyish brown silty clay with moderate small – medium angular flint.
0.50 - 0.62m	L1002	Subsoil. Firm, mid orange brown, silty clay sand with occasional small – medium angular flint
0.62m +	L1003	Natural. Compact, mid reddish orange, clay.

<i>Sample section 1B</i>		
<i>0.00 = 70.45m AOD</i>		
0.00 – 0.18m	L1000	Topsoil. As above.
0.18 – 0.50m	L1001	Made Ground. As above.
0.50 - 0.73m	L1002	Subsoil. As above.
0.73m +	L1003	Natural. As above

Description: Trench 1 contained no archaeological features or finds.

6 CONFIDENCE RATING

6.1 It is not felt that any factors inhibited the recognition of archaeological features or finds.

7 DEPOSIT MODEL

7.1 Uppmost was Topsoil L1000, a friable, dark reddish brown, silty clay with occasional small rounded stones. L1000 overlay Made Ground L1001, a firm, dark greyish brown silty clay with moderate small – medium angular flint. Below L1001 was Subsoil L1002, a firm, mid orange brown, silty clay sand with occasional small – medium angular flint. The natural, L1003, was a compact mid reddish orange clay (0.62 – 0.73m below the present day ground level.

8 DISCUSSION

8.1 The site lies within an area of archaeological potential as highlighted on the Essex Historic Environment Record (EHER). Jeans Yardling adjacent is a Grade II listed farmhouse of 16th century date, and the site has the potential to reveal remains of medieval/early post-medieval date associated with the settlement at Tye Green. Jeans Yardling is a timber-framed two-storey building. Historic mapping from 1777 (Chapman & Andre) shows a further building to the south, with the proposed development site an enclosed plot in between.

8.2 In the event the evaluation revealed no archaeological features or finds. The site appeared relatively undisturbed with Subsoil L1002 intact.

9 DEPOSITION OF THE ARCHIVE

9.1 Archive records, with inventory, will be deposited at Harlow Museum in accordance with their requirements. The archive will be quantified, ordered, indexed, cross-referenced and checked for internal

consistency. In addition to the overall site summary, it will be necessary to produce a summary of the artefactual and ecofactual data.

ACKNOWLEDGEMENTS

Archaeological Solutions would like to thank KP Developments Ltd for funding the evaluation and for their assistance, and Mr Sam Hounslow of Hounslow Contracts for assistance on site. AS would also like to acknowledge the assistance of Mr Alistair Allan of BRD Tech Ltd

AS would like to acknowledge the input and advice of Ms Maria Medlycott of Essex County Council

BIBLIOGRAPHY

British Geological Survey 1991 *East Anglia Sheet 52°N-00° 1:250,000 Series Quaternary Geology*. Ordnance Survey, Southampton

Chartered Institute for Archaeologists 1994 (revised 2014) *Standard and Guidance for Archaeological Evaluation*

Gurney, D. 2003 *Standards for Field Archaeology in the East of England*. East Anglian Archaeology Occasional Paper no. 14

SSEW 1983 *Soil Survey of England and Wales: Soils of South East England (sheet 4)*. Harpenden, Rothamsted Experimental Station/Lawes Agricultural Trust

PHOTOGRAPHIC INDEX



1
Sample Section 1A looking north-east



2
Sample Section 1B looking south-west



3
Post-excavation view of trench 1 looking south-east



4
View of site looking north-west

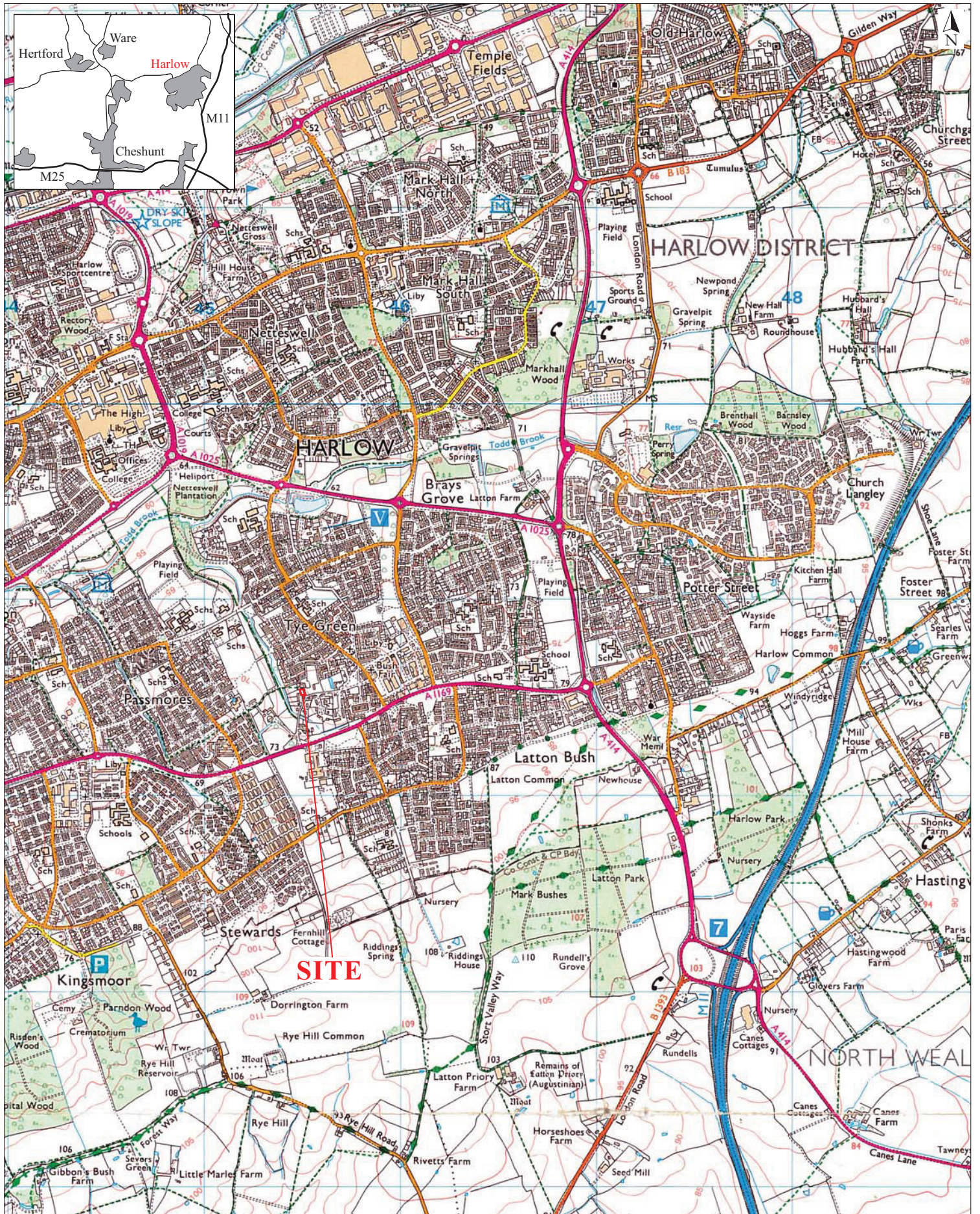

Reproduced from the 1999 Ordnance Survey 1:25000 map with the permission of Her Majesty's Stationery Office. © Crown copyright Archaeological Solutions Ltd Licence number 100036680

Archaeological Solutions Ltd
Fig. 1 Site location plan
 Scale 1:25,000 at A4
 Tye Green Village, Harlow, Essex (P6607)

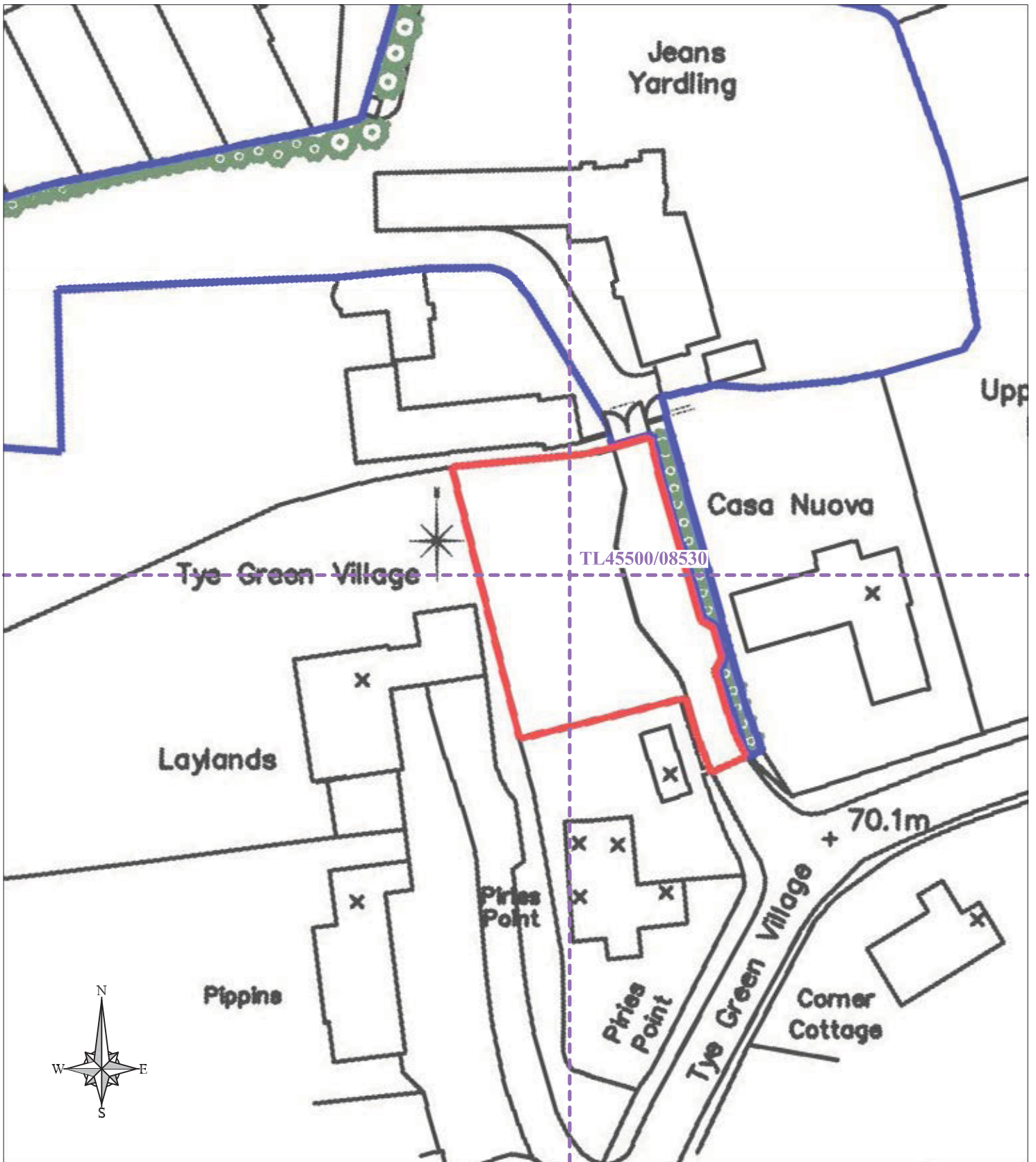

0 25m

<i>Archaeological Solutions Ltd</i>
Fig. 2 Detailed site location plan
Scale 1:500 at A4
Tye Green Village, Harlow, Essex (P6607)

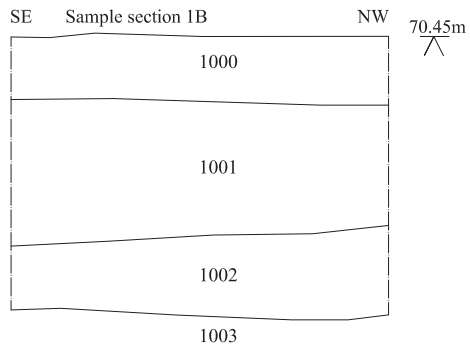
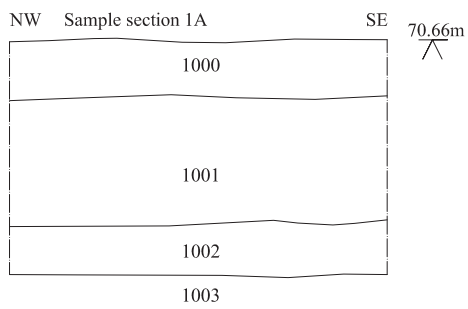
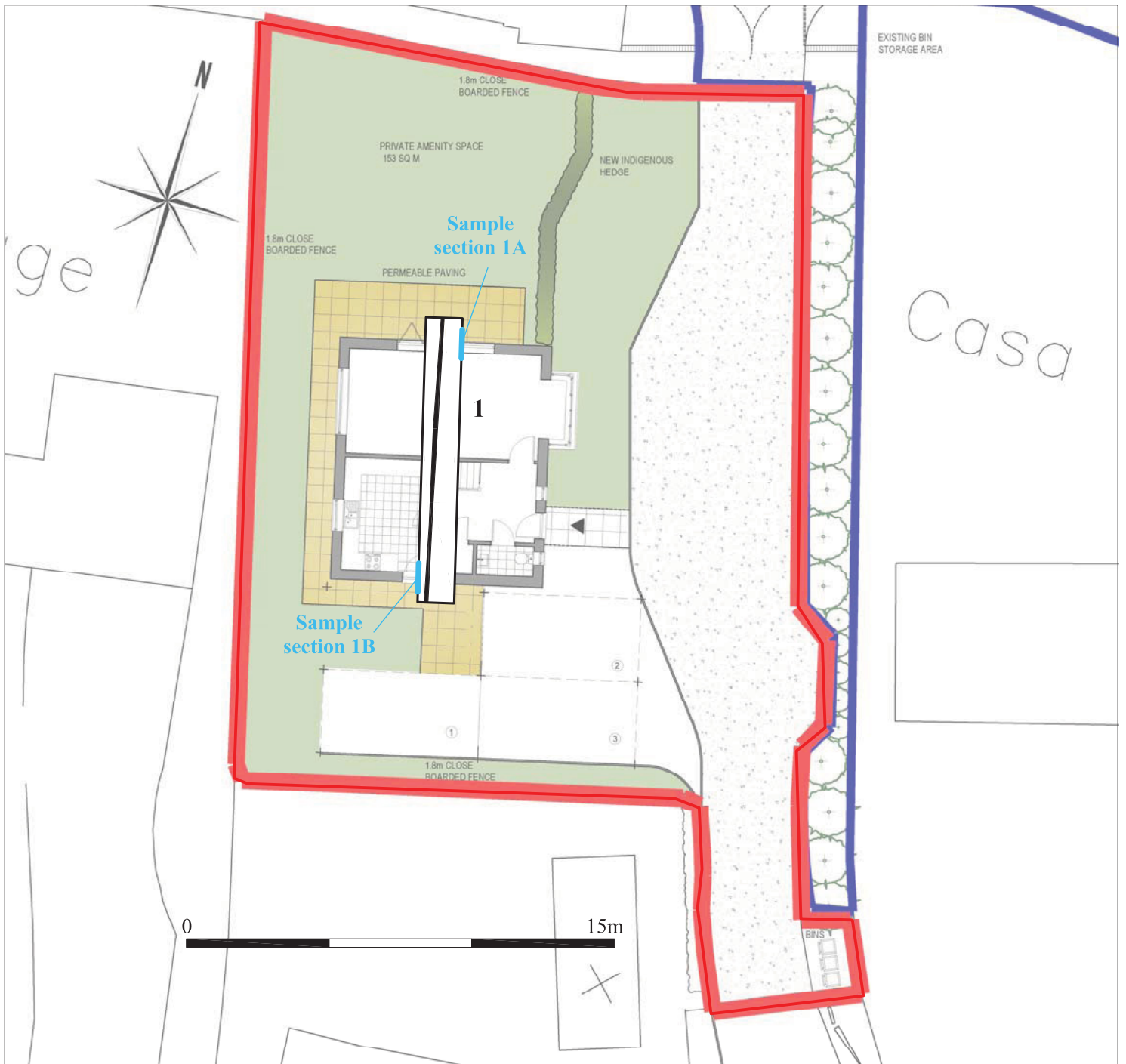

Archaeological Solutions Ltd

Fig. 3 Trench plan and sample sections

Scale 1:200 at A4
Tye Green Village, Harlow, Essex (P6607)