ARCHAEOLOGICAL SOLUTIONS LTD

**LAND ON THE SOUTH SIDE OF ST NEOTS ROAD,
HARDWICK, CAMBRIDGESHIRE**

AN ARCHAEOLOGICAL EVALUATION

CHER ECB: 4730

Authors: Vinny Monahan (Fieldwork and report)	
NGR: TL 3676 5937	Report No: 5309
District: South Cambs	Site Code: ECB 4730
Approved: Claire Halpin MCIfA	Project No: 6671
	Date: 21 February 2017

This report is confidential to the client. Archaeological Solutions Ltd accepts no responsibility or liability to any third party to whom this report, or any part of it, is made known. Any such party relies upon this report entirely at their own risk. No part of this report may be reproduced by any means without permission.

Archaeological Solutions is an independent archaeological contractor providing the services which satisfy all archaeological requirements of planning applications, including:

Desk-based assessments and environmental impact assessments
Historic building recording and appraisals
Trial trench evaluations
Geophysical surveys
Archaeological monitoring and recording
Archaeological excavations
Post excavation analysis
Promotion and outreach
Specialist analysis

ARCHAEOLOGICAL SOLUTIONS LTD

**Unit 6, Brunel Business Court, Eastern Way,
Bury St Edmunds IP32 7AJ
Tel 01284 765210**

**P I House, Rear of 23 Clifton Road, Shefford,
Bedfordshire, SG17 5AF
Tel: 01462 850483**

**e-mail info@ascontracts.co.uk
www.archaeologicalsolutions.co.uk**



 twitter.com/ArchaeologicalS

 www.facebook.com/ArchaeologicalSolutions



**INVESTORS
IN PEOPLE**

CONTENTS

OASIS SUMMARY SHEET

SUMMARY

- 1 *INTRODUCTION***
- 2 *DESCRIPTION OF THE SITE***
- 3 *TOPOGRAPHY, GEOLOGY AND SOILS***
- 4 *ARCHAEOLOGICAL AND HISTORICAL BACKGROUND***
- 5 *METHODOLOGY***
- 6 *DESCRIPTION OF RESULTS***
- 7 *CONFIDENCE RATING***
- 8 *DEPOSIT MODEL***
- 9 *DISCUSSION***
- 10 *CONCLUSION***
- 11 *DEPOSITION OF THE ARCHIVE***

ACKNOWLEDGEMENTS

BIBLIOGRAPHY

OASIS SUMMARY SHEET

Project details			
Project name	<i>Land on the south side of St Neots Road, Hardwick, Cambridgeshire</i>		
<p><i>In February 2017 Archaeological Solutions (AS) carried out an archaeological evaluation of land on the south side of St Neots Road, Hardwick, Cambridgeshire (NGR TL 3676 5937). The evaluation was undertaken in advance of the determination of a planning application for the development of the site comprising the construction of up to 160 houses.</i></p> <p><i>An Iron Age settlement and Roman settlement and a driveway have been investigated to the immediate north of the site and at Scotland Farm (CHER MCB 16338; MCB16811, NCB18507; MCB16337 & ECB2765). Medieval activity is also known from the area; earthwork evidence of medieval settlement is known from Redbrick Farm south east of the site (CHER MCB15645; NCB13222; MCB12331) and evidence of medieval ridge and furrow cultivation is known from widespread areas surrounding Hardwick.</i></p> <p><i>The predominant recorded features revealed during the trial trench evaluation were furrows and these were present in every trench which could be excavated except Trenches 37 and 38 in the southernmost sector of the site.</i></p> <p><i>The only other recorded features, excepting modern features, were ditches and it is likely that these ditches correspond with those depicted on the historic maps.</i></p> <p><i>The only finds present were sherds of modern (19th – 20th century) pottery within Ditch F1033 (Trench 1) and post-medieval and modern CBM within Ditches F1033 (Trench 1) and F1021 (Trench 27).</i></p> <p><i>Perhaps surprisingly given the volume of known archaeology locally and the size of the site, excepting furrows and relatively recent ditches no archaeological features were present and no finds pre-dating the post-medieval period were present.</i></p>			
Project dates (fieldwork)	<i>February 2017</i>		
Previous work (Y/N/?)	<i>N</i>	Future work (Y/N/?)	<i>TBC</i>
P. number	<i>6922</i>	Site code	<i>ECB 4730</i>
Type of project	<i>An Archaeological Evaluation</i>		
Site status	<i>-</i>		
Current land use	<i>Dense scrub/woodland, paddocks, private gardens</i>		
Planned development	<i>Residential</i>		
Main features (+dates)	<i>Furrows, ditches</i>		
Significant finds (+dates)	<i>Post-medieval and modern</i>		
Project location			
County/ District/ Parish	<i>Cambridgeshire</i>	<i>South Cambs</i>	<i>Hardwick</i>
HER/ SMR for area	<i>Cambridgeshire HER</i>		
Post code (if known)	<i>-</i>		
Area of site	<i>c.7.12ha</i>		
NGR	<i>TL 3676 5937</i>		
Height AOD (min/max)	<i>c.62m</i>		
Project creators			
Brief issued by	<i>CCC HET</i>		
Project supervisor/s (PO)	<i>Archaeological Solutions Ltd</i>		
Funded by	<i>Circle Housing Asset and Development Limited.</i>		

Full title	<i>Land on the South Side of St Neots Road, Hardwick, Cambridgeshire. An Archaeological Evaluation</i>
Authors	<i>Monahan, V.</i>
Report no.	<i>5309</i>
Date (of report)	<i>February 2017</i>

LAND ON THE SOUTH SIDE OF ST NEOTS ROAD, HARDWICK, CAMBRIDGESHIRE

AN ARCHAEOLOGICAL EVALUATION

SUMMARY

In February 2017 Archaeological Solutions (AS) carried out an archaeological evaluation of land on the south side of St Neots Road, Hardwick, Cambridgeshire (NGR TL 3676 5937). The evaluation was undertaken in advance of the determination of a planning application for the development of the site comprising the construction of up to 160 houses.

An Iron Age settlement and Roman settlement and a droveway have been investigated to the immediate north of the site and at Scotland Farm (CHER MCB 16338; MCB16811, NCB18507; MCB16337 and ECB2765). Medieval activity is also known from the area; earthwork evidence of medieval settlement is known from Redbrick Farm south east of the site (CHER MCB15645; NCB13222; MCB12331) and evidence of medieval ridge and furrow cultivation is known from widespread areas surrounding Hardwick.

The site thus had a potential for multi-period remains associated with the Iron Age and Romano-British settlement of the area and also for remains of the medieval village and its agricultural hinterland.

The predominant recorded features revealed during the trial trench evaluation were furrows and these were present in every trench which could be excavated except Trenches 37 and 38 in the southernmost sector of the site. Throughout the site the furrows were consistently orientated north west / south east. None contained finds.

The only other recorded features, excepting modern features, were ditches, and these were present in Trenches 1 - 2, 11, 18 - 19, 22 and 27. Like the furrows these were orientated north west / south east (Trenches 1 - 2 and 22) and also north east / south west (Trenches 11, 18 - 19 and 27). The same ditch was traceable through Trenches 11 and 18 - 19). It is likely that these ditches correspond with those depicted on the historic maps (Figs. 7 - 8).

The only finds present were sherds of modern (19th - 20th century) pottery within Ditch F1033 (Trench 1) and post-medieval and modern CBM within Ditches F1033 (Trench 1) and F1021 (Trench 27).

Perhaps surprisingly given the volume of known archaeology locally and the size of the site, excepting furrows and relatively recent ditches no archaeological features were present and no finds pre-dating the post-medieval period were present.

1 INTRODUCTION

1.1 In February 2017 Archaeological Solutions (AS) carried out an archaeological evaluation of land on the south side of St Neots Road, Hardwick, Cambridgeshire (NGR TL 3676 5937; Figs. 1 – 3). The evaluation was undertaken in advance of the determination of a planning application for the development of the site comprising the construction of up to 160 houses.

1.2 The evaluation was undertaken in accordance with a brief issued by Cambridgeshire County Council Historic Environment Team (CCC HET; Andy Thomas, dated 30/03/2016), and a written scheme of investigation (specification) prepared by AS (dated 12/12/2016) and approved by CCC HET. The project conformed to the Chartered Institute for Archaeologists (CIfA) *Code of Conduct and Standard and Guidance for Archaeological Field Evaluation* (2014), and the document *Standards for Field Archaeology in the East of England* (Gurney 2003).

1.3 The evaluation aimed to determine the location, extent, date, character, condition, significance and quality of any surviving archaeological remains liable to be threatened by the proposed development.

Planning policy context

1.4 The National Planning Policy Framework (NPPF 2012) states that those parts of the historic environment that have significance because of their historic, archaeological, architectural or artistic interest are heritage assets. The NPPF aims to deliver sustainable development by ensuring that policies and decisions that concern the historic environment recognise that heritage assets are a non-renewable resource, take account of the wider social, cultural, economic and environmental benefits of heritage conservation, and recognise that intelligently managed change may sometimes be necessary if heritage assets are to be maintained for the long term. The NPPF requires applications to describe the significance of any heritage asset, including its setting that may be affected in proportion to the asset's importance and the potential impact of the proposal.

1.5 The NPPF aims to conserve England's heritage assets in a manner appropriate to their significance, with substantial harm to designated heritage assets (i.e. listed buildings, scheduled monuments) only permitted in exceptional circumstances when the public benefit of a proposal outweighs the conservation of the asset. The effect of proposals on non-designated heritage assets must be balanced against the scale of loss and significance of the asset, but non-designated heritage assets of demonstrably equivalent

significance may be considered subject to the same policies as those that are designated. The NPPF states that opportunities to capture evidence from the historic environment, to record and advance the understanding of heritage assets and to make this publicly available is a requirement of development management. This opportunity should be taken in a manner proportionate to the significance of a heritage asset and to impact of the proposal, particularly where a heritage asset is to be lost.

2 DESCRIPTION OF THE SITE

2.1 The village of Hardwick is located 9km west of Cambridge and immediately south of the A428. The site is located on the southern side of Hardwick, and it is proposed to erect up to 160 new dwellings on land south of St Neots Road. The site is largely set back from the plots fronting St Neots Road. It comprises a mixture of large areas of dense hawthorn scrub/trees, orchard, grassland, paddocks, houses, out buildings and gardens. It extends to some 7.12ha in total.

3 TOPOGRAPHY, GEOLOGY AND SOILS

3.1 The site is located at approximately 62m AOD in the uplands west of Cambridge, on soils of the Hanslope series characterised as slowly permeable calcareous clayey soils, and sometimes slowly permeable non calcareous clayey soils. This overlies Oadby Member chalky till with the solid geology comprising Gault Formation mudstone. There is a drain bordering the east side of the assessment site, which forms part of the north flowing Callow Brook. Another feature of the local landscape is winterbourne streams which are typically found on chalk or limestone, and flow only after wet weather.

4 ARCHAEOLOGICAL AND HISTORICAL BACKGROUND

4.1 An archaeological desk-based assessment has been prepared (Thompson 2016). In summary:

Three areas of Iron Age settlement have been excavated to the north of the assessment site. A middle Iron Age farmstead comprising four enclosures, pits and round houses was excavated to the north-west straddling the Dam Brook, formerly a winterbourne (CHER MCB16338). This site underlies and continues north of the A428 and is given a central grid reference some 300m north-west of the assessment site. It appears that this farmstead was abandoned due to waterlogging, with the settlement moving some 300m north to Scotland Farm where 3 more enclosures, pits and a stock pen were located (CHER 11441). This site started as a stock enclosure before also developing as a settlement, but occupation was short lived between

the late 1st century BC and the early 1st century AD. Another middle Iron Age enclosure and 15 quarry pits were located to the east of the middle Iron Age settlement and are given a central grid reference 220m north of the assessment site (CHER MCB18611).

A Romano-British track or driveway overlies the middle Iron Age farmstead on the Dam Brook (CHER MCB18507). It runs to the edge of the excavated area 200m north-west of the assessment site, and appears to continue towards it (Fig. 3b & 3c). A Romano-British ladder settlement was located towards Childerley Gate 770m to the west-north-west, which began in the 2nd century and was still in occupation at the end of the Roman period (CHER MCB16337). A possible Anglo-Saxon sunken featured building was located there (CHER MCB16337).

An archaeological trial trenching evaluation on land abutting the west side of the assessment site identified a possible undated ditch terminus and two tree throws (CHER MCB17282). The assessment site is located between the medieval villages of Hardwick, which has a possible medieval moated enclosure (CHER 01100) and other earthworks, and neighbouring Childerley. It was in a rural setting indicated by extensive amounts of medieval ridge and furrow identified around the assessment site, largely as a result of the excavations ahead of the A428 construction (CHER 03437, CHER 09572, CHER 09573, Fig. 3c, 3d, 3f). Undated features including four post-holes and a ditch were identified during excavations 330m north-east of the assessment site which cut a colluvial layer (CHER MCB1681). The historic maps show that there have been several buildings or structures and field boundaries featuring on the assessment site.

5 METHODOLOGY

5.1 The brief required a c.4% sample of the c.7.12ha area to be subject to development to be trial trenched. Forty trenches, each 40 x 1.8m were therefore initially proposed, to follow tree/dense scrub clearance. For practical reasons (access issues, site obstacles and the retention of screening trees around the periphery of the site) 25 trenches were excavated using a mechanical 360° excavator fitted with a toothless ditching bucket (Fig. 2).

5.2 A one-metre square of topsoil and subsoil was bucket sampled and sorted by hand at each end of the trenches. The main spoil heaps were scanned for the retrieval of unstratified artefacts. A metal detector will be used to enhance finds recovery. The metal detector survey was conducted when the trenches were opened and the spoil tips were also surveyed. No finds, except modern finds, were present.

5.3 Topsoil and subsoil were mechanically excavated under close archaeological supervision. Exposed surfaces were cleaned by hand

and examined for archaeological features. Deposits were recorded using *pro forma* recording sheets, drawn to scale, and photographed as appropriate.

6 DESCRIPTION OF RESULTS

The individual trench descriptions are presented below:

Trench 1 (Figs. 3 - 4)

<i>Sample section 1A:</i> 0.00m = 63.63m AOD		
0.00 – 0.18m	L1000	Topsoil. Friable, dark greyish brown silty clay
0.18 - 0.44m	L1001	Subsoil. Friable, light brownish grey silty clay with occasional small chalk pebbles.
0.44m+	L1002	Natural. Firm, pale bluish grey clay with moderate small to large natural chalk nodules.

<i>Sample section 1B:</i> 0.00m = 63.95m AOD		
0.00 – 0.28m	L1000	Topsoil. As above
0.28 - 0.55m	L1001	Subsoil. As above.
0.55m+	L1002	Natural. As above.

Description: Trench 1 contained Furrows F1031 and F1035, Ditch F1033, and Ditch Terminus F1037.

Furrow F1031 was linear in plan (2.3+ x 1.71 x 0.08m). It had gently sloping sides and a concave base. Its fill, L1032, was a firm, pale brownish grey silty clay with occasional, small, natural chalk pebbles. It contained no finds.

Furrow F1035 was linear in plan (2.3+ x 0.92 x 0.08m). It had shallow sides and a concave base. Its fill, L1036, was a firm, pale yellowish brown silty clay with occasional, small, natural chalk pebbles. It contained no finds.

Ditch F1033 was linear in plan (2.3+ x 0.94 x 0.11m). It had moderately sloping sides and a concave base. Its fill, L1034, was a firm, pale yellowish grey silty clay with occasional, small, natural chalk pebble, and small, crushed red brick. It contained

Ditch Terminus F1037 was linear in plan (2.3+ x 0.65 x 0.32m) It had steep sides and a concave base. Its basal fill, L1038, was a firm, pale yellowish brown silty clay with occasional, small, angular and sub-

angular flints. It contained no finds. Its upper fill, L1039, was a firm, yellowish brown silty clay with occasional, small, angular flints. It contained no finds.

Trench 2 (Figs. 3 - 4)

<i>Sample section 2A:</i> <i>0.00m = 64.05m AOD</i>		
0.00 – 0.20m	L1000	Topsoil. As Above, Trench 1
0.20 - 0.42m	L1001	Subsoil. As Above, Trench 1
0.42m+	L1002	Natural. As Above, Trench 1

<i>Sample section 2B:</i> <i>0.00m = 64.21m AOD</i>		
0.00 – 0.10m	L1000	Topsoil. As Above, Trench 1
0.10 - 0.28m	L1001	Subsoil. As Above, Trench 1
0.28m+	L1002	Natural. As Above, Trench 1

Description: Trench 2 contained Ditch F1040 and Furrow F1042.

Ditch F1040 was linear in plan (2.3+ x 0.60 x 0.26m). It had moderate - steep sides and a concave base. Its fill, L1041, was a friable pale brownish grey silty clay with occasional, small, mixed, pebble. It contained no finds.

Furrow F1042 was linear in plan (2.3+ x 1.98 x 0.09m). It had gently sloping sides and a concave base. Its fill, L1043, was a friable pale yellowish grey silty clay with occasional, small, natural chalk pebbles. It contained no finds.

Trench 3 (Fig. 3)

Trench 3 was not cut because the area was covered in modern debris

Trench 4 (Fig. 3)

Trench 4 was not cut because the area was covered in modern debris

Trench 5 (Fig. 3)

Trench 5 was not cut because the area was covered in modern debris

Trench 6 (Fig. 3)

Trench 6 was not cut because no access was available for this area

Trench 7 (Figs. 3 & 5)

<i>Sample section 7A:</i> <i>0.00m = 62.57m AOD</i>		
0.00 – 0.13m	L1000	Topsoil. As Above, Trench 1
0.13 - 0.48m	L1001	Subsoil. As Above, Trench 1
0.48m+	L1002	Natural. As Above, Trench 1

<i>Sample section 7B:</i> <i>0.00m = 62.82m AOD</i>		
0.00 – 0.14m	L1000	Topsoil. As Above, Trench 1
0.14 - 0.46m	L1001	Subsoil. As Above, Trench 1
0.46m+	L1002	Natural. As Above, Trench 1

Description: Trench 7 contained Furrows F1044, F1046 and F1048.

Furrow F1044 was linear in plan (2.3+ x 1.40 x 0.14m). It had gently sloping sides and a concave base. Its fill, L1045, was a friable, pale brownish grey silty clay with occasional, small, natural chalk pebbles. It contained no finds.

Furrow F1046 was linear in plan (2.3+ x 1.52 x 0.09m). It had gently sloping sides and a concave base. Its fill, L1047, was a friable, pale yellowish grey silty clay with occasional, small, natural chalk pebbles. It contained no finds.

Furrow F1048 was linear in plan (2.3+ x 1.2 x 0.12m). It had gently sloping sides and a concave base. Its fill, L1049, was a firm pale yellowish grey silty clay with occasional, small, natural chalk pebbles. It contained no finds.

Trench 8 (Fig. 3)

<i>Sample section 8A:</i> <i>0.00m = 63.33m AOD</i>		
0.00 – 0.08m	L1000	Topsoil. As Above, Trench 1
0.08 - 0.52m	L1001	Subsoil. As Above, Trench 1
0.52m+	L1002	Natural. As Above, Trench 1

<i>Sample section 8B:</i> <i>0.00m = 62.82m AOD</i>		
--	--	--

0.00 – 0.10m	L1000	Topsoil. As Above, Trench 1
0.10 - 0.60m	L1001	Subsoil. As Above, Trench 1
0.60m+	L1002	Natural. As Above, Trench 1

Description: Trench 8 contained two furrows which were recorded in plan but not excavated.

Trench 9 (Fig. 3)

<i>Sample section 9A:</i> <i>0.00m = 62.55m AOD</i>		
0.00 – 0.15m	L1000	Topsoil. As Above, Trench 1
0.15 - 0.54m	L1001	Subsoil. As Above, Trench 1
0.54m+	L1002	Natural. As Above, Trench 1

<i>Sample section 9B:</i> <i>0.00m = 62.49m AOD</i>		
0.00 – 0.11m	L1000	Topsoil. As Above, Trench 1
0.11 - 0.38m	L1001	Subsoil. As Above, Trench 1
0.38m+	L1002	Natural. As Above, Trench 1

Description: Trench 9 contained one furrow which was recorded in plan but not excavated.

Trench 10 (Fig. 3)

<i>Sample section 10A:</i> <i>0.00m = 61.90m AOD</i>		
0.00 – 0.35m	L1000	Topsoil. As Above, Trench 1
0.35 - 0.75m	L1001	Subsoil. As Above, Trench 1
0.75m+	L1002	Natural. As Above, Trench 1

<i>Sample section 10B:</i> <i>0.00m = 61.42m AOD</i>		
0.00 – 0.28m	L1000	Topsoil. As Above, Trench 1
0.28 - 0.72m	L1001	Subsoil. As Above, Trench 1
0.72m+	L1002	Natural. As Above, Trench 1

Description: Trench 10 contained two furrows which were recorded in plan but not excavated.

Trench 11 (Fig. 3)

<i>Sample section 11A:</i> <i>0.00m = 61.92m AOD</i>		
0.00 – 0.22m	L1000	Topsoil. As Above, Trench 1
0.22 - 0.68m	L1001	Subsoil. As Above, Trench 1
0.68m+	L1002	Natural. As Above, Trench 1

<i>Sample section 11B:</i> <i>0.00m = 62.15m AOD</i>		
0.00 – 0.17m	L1000	Topsoil. As Above, Trench 1
0.17 - 0.59m	L1001	Subsoil. As Above, Trench 1
0.59m+	L1002	Natural. As Above, Trench 1

Description: Trench 11 contained four furrows and a post-medieval / modern ditch which were recorded in plan but not excavated.

Trench 12 (Fig. 3)

<i>Sample section 12A:</i> <i>0.00m = 62.81m AOD</i>		
0.00 – 0.15m	L1000	Topsoil. As Above, Trench 1
0.15 - 0.58m	L1001	Subsoil. As Above, Trench 1
0.58m+	L1002	Natural. As Above, Trench 1

<i>Sample section 12B:</i> <i>0.00m = 63.04m AOD</i>		
0.00 – 0.13m	L1000	Topsoil. As Above, Trench 1
0.13 - 0.48m	L1001	Subsoil. As Above, Trench 1
0.48m+	L1002	Natural. As Above, Trench 1

Description: Trench 12 contained one furrow which was recorded in plan but not excavated.

Trench 13 (Fig. 3)

<i>Sample section 13A:</i> <i>0.00m = 63.95m AOD</i>		
0.00 – 0.12m	L1000	Topsoil. As Above, Trench 1
0.12 - 0.48m	L1001	Subsoil. As Above, Trench 1

0.48m+	L1002	Natural. As Above, Trench 1
--------	-------	-----------------------------

<i>Sample section 13B:</i> <i>0.00m = 63.13m AOD</i>		
0.00 – 0.14m	L1000	Topsoil. As Above, Trench 1
0.14 - 0.53m	L1001	Subsoil. As Above, Trench 1
0.53m+	L1002	Natural. As Above, Trench 1

Description: Trench 13 contained four furrows which were recorded in plan but not excavated.

Trench 14 (Fig. 3)

Trench 14 was not cut due to the presence of modern debris

Trench 15 (Fig. 3)

Trench 15 was not cut due to the presence of modern debris

Trench 16 (Fig. 3)

<i>Sample section 16A:</i> <i>0.00m = 63.45m AOD</i>		
0.00 – 0.10m	L1000	Topsoil. As Above, Trench 1
0.10 - 0.40m	L1001	Subsoil. As Above, Trench 1
0.40m+	L1002	Natural. As Above, Trench 1

<i>Sample section 16B:</i> <i>0.00m = 63.65m AOD</i>		
0.00 – 0.10m	L1000	Topsoil. As Above, Trench 1
0.10 - 0.40m	L1001	Subsoil. As Above, Trench 1
0.40m+	L1002	Natural. As Above, Trench 1

Description: Trench 16 contained four furrows which were recorded in plan but not excavated.

Trench 17 (Figs. 3 & 5)

<i>Sample section 17A:</i> <i>0.00m = 63.49m AOD</i>		
0.00 – 0.08m	L1000	Topsoil. As Above, Trench 1
0.08 - 0.52m	L1001	Subsoil. As Above, Trench 1

0.52m+	L1002	Natural. As Above, Trench 1
--------	-------	-----------------------------

<i>Sample section 17B:</i> <i>0.00m = 63.87m AOD</i>		
0.00 – 0.12m	L1000	Topsoil. As Above, Trench 1
0.12 - 0.68m	L1001	Subsoil. As Above, Trench 1
0.68m+	L1002	Natural. As Above, Trench 1

Description: Trench 17 contained Furrows F1025, F1027 and F1029.

Furrow F1025 was linear in plan (2.3+ x 0.89 x 0.16m). It had gently sloping sides and a concave base. Its fill, L1026, was a firm, pale yellowish grey silty clay with occasional natural chalk pebbles. It contained no finds.

Furrow F1027 was linear in plan (2.3+ x 0.49 x 0.09m). It had moderately sloping sides and a narrow base. Its fill, L1027, was a firm, pale yellowish grey silty clay with occasional, small, natural chalk pebbles. It contained no finds.

Furrow F1029 was linear in plan (2.3+ x 0.49 x 0.08m). It had gently sloping sides and a concave base. Its fill, L1030, was a firm, pale yellowish grey silty clay with occasional, small, natural chalk pebbles. It contained no finds.

Trench 18 (Fig. 3)

<i>Sample section 18A:</i> <i>0.00m = 62.79m AOD</i>		
0.00 – 0.34m	L1000	Topsoil. As Above, Trench 1
0.34 - 0.75m	L1001	Subsoil. As Above, Trench 1
0.75m+	L1002	Natural. As Above, Trench 1

<i>Sample section 18B:</i> <i>0.00m = 62.91m AOD</i>		
0.00 – 0.34m	L1000	Topsoil. As Above, Trench 1
0.34 - 0.75m	L1001	Subsoil. As Above, Trench 1
0.75m+	L1002	Natural. As Above, Trench 1

Description: Trench 18 contained two furrows and a post-medieval / modern ditch which were recorded in plan but not excavated.

Trench 19 (Fig. 3)

<i>Sample section 19A:</i> <i>0.00m = 62.70m AOD</i>		
0.00 – 0.26m	L1000	Topsoil. As Above, Trench 1
0.26 - 0.52m	L1001	Subsoil. As Above, Trench 1
0.52m+	L1002	Natural. As Above, Trench 1

<i>Sample section 19B:</i> <i>0.00m = 62.43m AOD</i>		
0.00 – 0.20m	L1000	Topsoil. As Above, Trench 1
0.20 - 0.63m	L1001	Subsoil. As Above, Trench 1
0.63m+	L1002	Natural. As Above, Trench 1

Description: Trench 19 contained three furrows and a post-medieval / modern ditch which were recorded in plan but not excavated.

Trench 20 (Fig. 3)

<i>Sample section 20A:</i> <i>0.00m = 62.77m AOD</i>		
0.00 – 0.26m	L1000	Topsoil. As Above, Trench 1
0.26 - 0.68m	L1001	Subsoil. As Above, Trench 1
0.68m+	L1002	Natural. As Above, Trench 1

<i>Sample section 20B:</i> <i>0.00m = 63.09m AOD</i>		
0.00 – 0.16m	L1000	Topsoil. As Above, Trench 1
0.16 - 0.44m	L1001	Subsoil. As Above, Trench 1
0.44m+	L1002	Natural. As Above, Trench 1

Description: Trench 20 contained three furrows which were recorded in plan but not excavated.

Trench 21 (Fig. 3)

<i>Sample section 21A:</i> <i>0.00m = 63.28m AOD</i>		
0.00 – 0.28m	L1000	Topsoil. As Above, Trench 1
0.28 - 0.62m	L1001	Subsoil. As Above, Trench 1

0.62m+	L1002	Natural. As Above, Trench 1
--------	-------	-----------------------------

<i>Sample section 21B:</i> <i>0.00m = 63.29m AOD</i>		
0.00 – 0.18m	L1000	Topsoil. As Above, Trench 1
0.18 - 0.66m	L1001	Subsoil. As Above, Trench 1
0.66m+	L1002	Natural. As Above, Trench 1

Description: Trench 21 contained two furrows which were recorded in plan but not excavated.

Trench 22 (Figs. 3 & 6)

<i>Sample section 22A:</i> <i>0.00m = 63.33m AOD</i>		
0.00 – 0.10m	L1000	Topsoil. As Above, Trench 1
0.10 - 0.50m	L1001	Subsoil. As Above, Trench 1
0.50m+	L1002	Natural. As Above, Trench 1

<i>Sample section 22B:</i> <i>0.00m = 63.98m AOD</i>		
0.00 – 0.10m	L1000	Topsoil. As Above, Trench 1
0.10 - 0.50m	L1001	Subsoil. As Above, Trench 1
0.50m+	L1002	Natural. As Above, Trench 1

Description: Trench 22 contained five furrows: F1003, F1005, F1013, F1015 and F1017, and Ditches F1007 and F1011.

Ditch F1007 was linear in plan (2.3+ x 0.62 x 0.26m). It had moderately sloping sides and a concave base. The ditch had three fills: the basal fill, L1008, was a firm, pale yellowish grey silty clay with occasional, small, natural chalk inclusions. The secondary fill, L1009, was a friable, pale greyish red layer of crushed red brick. The upper fill, L1010, was a firm, mid brownish grey silty clay. The feature contained no finds.

The furrows are tabulated below:

Feature	Plan/ Profile (dimensions)	Fill (s)	Finds
F1003	Linear in plan (2.30+ x 0.88 x 0.12m). Gently sloping sides and a concave base.	L1004. Firm, pale brownish grey silty clay with occasional, small, natural chalk pebble	-
F1005	Linear in plan (2.30	L1006. Firm, pale brownish grey	-

	+ x 1.17 x 0.18m). Gently sloping sides and a concave base.	silty clay with occasional, small, natural chalk pebble	
F1013	Linear in plan (2.30+ x 0.74 x 0.11m). Gently sloping sides and a concave base.	L1014. Firm, pale brownish grey silty clay with occasional, small, natural chalk pebble	-
F1015	Linear in plan (2.30+ x 0.64 x 0.16m). Gently sloping sides and a concave base	L1016. Firm, pale brownish grey silty clay with occasional, small, natural chalk pebble	-
F1017	Linear in plan (2.30+ x 0.69 x 0.18m). Gently sloping sides and a concave base.	L1018. Firm, pale brownish grey silty clay with occasional, small, natural chalk pebble	-

Trench 23 (Fig. 3)

<i>Sample section 23:</i> <i>0.00m = 64.10m AOD</i>		
0.00 – 0.18m	L1000	Topsoil. As Above, Trench 1
0.18 - 0.57m	L1001	Subsoil. As Above, Trench 1
0.57m+	L1002	Natural. As Above, Trench 1

Description: Trench 23 contained two furrows which were recorded in plan but not excavated.

Trench 24

Trench 24 was not cut because of the presence of modern debris

Trench 25 (Fig. 3)

<i>Sample section 25A:</i> <i>0.00m = 64.99m AOD</i>		
0.00 – 0.12m	L1000	Topsoil. As Above, Trench 1
0.12 - 0.39m	L1001	Subsoil. As Above, Trench 1
0.39m+	L1002	Natural. As Above, Trench 1

<i>Sample section 25B:</i> <i>0.00m = 64.68m AOD</i>		
0.00 – 0.21m	L1000	Topsoil. As Above, Trench 1
0.21 - 0.44m	L1001	Subsoil. As Above, Trench 1
0.44m+	L1002	Natural. As Above, Trench 1

Description: Trench 25 contained two furrows which were recorded in plan but not excavated.

Trench 26

Trench 26 was not cut because of the presence of modern debris

Trench 27 (Figs. 3 & 6)

<i>Sample section 27A:</i> <i>0.00m = 64.39m AOD</i>		
0.00 – 0.10m	L1000	Topsoil. As Above, Trench 1
0.10 - 0.60m	L1001	Subsoil. As Above, Trench 1
0.60m+	L1002	Natural. As Above, Trench 1

<i>Sample section 27B:</i> <i>0.00m = 64.02m AOD</i>		
0.00 – 0.10m	L1000	Topsoil. As Above, Trench 1
0.10 - 0.65m	L1001	Subsoil. As Above, Trench 1
0.65m+	L1002	Natural. As Above, Trench 1

Description: Trench 27 contained post-medieval / modern Ditches F1021 and F1023, and Furrow F1019.

Furrow F1019 was linear in plan (2.3+ x 0.82 x 0.06m). It had gently sloping sides and a concave base. Its fill, L1020, was a firm, pale yellowish brown silty clay with occasional, small, natural chalk pebbles. It contained no finds.

Ditch F1021 was linear in plan (2.3+ x 1.44 x 0.28m). It had moderately sloping sides and an unknown base. Its fill, L1022, was a friable, pale brownish grey silty clay with occasional, small mixed gravel. F1021 contained a drainage pipe.

Ditch F1023 was linear in plan (2.3+ x 0.6 x 0.23m). It had steep sides and a narrow base. Its fill, L1024, was a friable, pale brownish grey silty clay with moderate, small mixed gravel. It contained no finds.

Trench 28 (Fig. 3)

<i>Sample section 28A:</i> <i>0.00m = 63.46m AOD</i>		
0.00 – 0.14m	L1000	Topsoil. As Above, Trench 1
0.14 - 0.46m	L1001	Subsoil. As Above, Trench 1
0.46m+	L1002	Natural. As Above, Trench 1

<i>Sample section 28B:</i> <i>0.00m = 64.66m AOD</i>		
0.00 – 0.09m	L1000	Topsoil. As Above, Trench 1
0.09 - 0.48m	L1001	Subsoil. As Above, Trench 1
0.48m+	L1002	Natural. As Above, Trench 1

Description: Trench 28 contained three furrows which were recorded in plan but not excavated.

Trench 29

Trench 29 was not cut due to the presence of modern debris

Trench 30 (Fig. 3)

<i>Sample section 30A:</i> <i>0.00m = 65.27m AOD</i>		
0.00 – 0.28m	L1000	Topsoil. As Above, Trench 1
0.28 - 0.64m	L1001	Subsoil. As Above, Trench 1
0.64m+	L1002	Natural. As Above, Trench 1

<i>Sample section 30B:</i> <i>0.00m = 65.43m AOD</i>		
0.00 – 0.13m	L1000	Topsoil. As Above, Trench 1
0.13 - 0.40m	L1001	Subsoil. As Above, Trench 1
0.40m+	L1002	Natural. As Above, Trench 1

Description: Trench 30 contained three furrows which were recorded in plan but not excavated.

Trench 31 (Fig. 3)

<i>Sample section 31:</i> <i>0.00m = 64.98m AOD</i>		
0.00 – 0.21m	L1000	Topsoil. As Above, Trench 1
0.21 - 0.69m	L1001	Subsoil. As Above, Trench 1
0.69m+	L1002	Natural. As Above, Trench 1

Description: Trench 31 contained three furrows which were recorded in plan but not excavated.

Trench 32

Trench 32 was not cut because access was not available

Trench 33

Trench 33 was not cut because space was not available

Trench 34

Trench 34 was not cut because space was not available

Trench 35

Trench 35 was not cut because the area is not to be developed

Trench 36 (Fig. 3)

<i>Sample section 36A:</i> <i>0.00m = 65.22m AOD</i>		
0.00 – 0.13m	L1000	Topsoil. As Above, Trench 1
0.13 - 0.38m	L1001	Subsoil. As Above, Trench 1
0.38m+	L1002	Natural. As Above, Trench 1

<i>Sample section 36B:</i> <i>0.00m = 65.92m AOD</i>		
---	--	--

0.00 – 0.26m	L1000	Topsoil. As Above, Trench 1
0.26 - 0.43m	L1001	Subsoil. As Above, Trench 1
0.43m+	L1002	Natural. As Above, Trench 1

Description: Trench 36 contained two furrows which were recorded in plan but not excavated.

Trench 37 (Fig. 3)

<i>Sample section 37A: 0.00m = 65.82m AOD</i>		
0.00 – 0.12m	L1000	Topsoil. As Above, Trench 1
0.12 - 0.39m	L1001	Subsoil. As Above, Trench 1
0.39m+	L1002	Natural. As Above, Trench 1

<i>Sample section 37B: 0.00m = 65.73m AOD</i>		
0.00 – 0.26m	L1000	Topsoil. As Above, Trench 1
0.26 - 0.54m	L1001	Subsoil. As Above, Trench 1
0.54m+	L1002	Natural. As Above, Trench 1

Description: Trench 37 contained no archaeological features

Trench 38 (Fig. 3)

<i>Sample section 38A: 0.00m = 65.95m AOD</i>		
0.00 – 0.18m	L1000	Topsoil. As Above, Trench 1
0.18 - 0.58m	L1001	Subsoil. As Above, Trench 1
0.58m+	L1002	Natural. As Above, Trench 1

<i>Sample section 38B: 0.00m = 65.74m AOD</i>		
0.00 – 0.17m	L1000	Topsoil. As Above, Trench 1
0.17 - 0.41m	L1001	Subsoil. As Above, Trench 1
0.41m+	L1002	Natural. As Above, Trench 1

Description: Trench 38 contained no archaeological features.

Trench 39

Trench 39 was not cut because access was not available

Trench 40

Trench 40 was not cut because access was not available

7 CONFIDENCE RATING

7.1 It is not felt that any factors inhibited the recognition of archaeological features or finds. Although not all of the trial trenches could be excavated for practical reasons it is not felt that the validity of the evaluation was significantly compromised.

8 DEPOSIT MODEL

8.1 Uppermost across the site was Topsoil L1000, a Friable, dark greyish brown silty clay. Below L1000, Subsoil L1001 was a friable, light brownish grey silty clay with occasional small chalk pebbles. At the base of the sequence the natural, L1002, was present at c.0.50m+ below the existing ground level and comprised a firm, pale bluish grey clay with moderate small to large natural chalk nodules.

9 DISCUSSION

The excavated and recorded features are tabulated below:

Trench	Context	Description	Date	Comment
1	F1031	Furrow		
	F1033	Ditch	Modern (19 th – 20 th C)	
	F1035	Furrow		
	F1037	Ditch Terminus		
2	F1040	Ditch		
	F1042	Furrow		
3				Trench not cut
4				Trench not cut
5				Trench not cut
6				Trench not cut
7	F1044	Furrow		
	F1046	Furrow		
	F1048	Furrow		
8		Furrow		
		Furrow		
9		Furrow		
10		Furrow		
		Furrow		
11		Furrow		

		Furrow		
		Furrow		
		Furrow		
		Ditch	Post-medieval / modern	
12		Furrow		
13		Furrow		
		Furrow		
		Furrow		
		Furrow		
14				Trench not cut
15				Trench not cut
16		Furrow		
		Furrow		
		Furrow		
		Furrow		
17	F1025	Furrow		
	F1027	Furrow		
	F1029	Furrow		
18		Furrow		
		Furrow		
		Ditch	Post-medieval / modern	
19		Furrow		
		Furrow		
		Furrow		
		Ditch	Post-medieval / modern	
20		Furrow		
		Furrow		
		Furrow		
21		Furrow		
		Furrow		
22	F1003	Furrow		
	F1005	Furrow		
	F1007	Ditch		
	F1011	Ditch		
	F1013	Furrow		
	F1015	Furrow		
	F1017	Furrow		
23		Furrow		
		Furrow		
24				Trench not cut
25		Furrow		
		Furrow		
26				Trench not cut
27	F1019	Furrow		
	F1021	Ditch	Post-medieval / modern	
	F1023	Ditch	Post-medieval / modern	
28		Furrow		
		Furrow		

		Furrow		
29				Trench not cut
30		Furrow		
		Furrow		
		Furrow		
31		Furrow		
		Furrow		
		Furrow		
32				Trench not cut
33				Trench not cut
34				Trench not cut
35				Trench not cut
36		Furrow		
		Furrow		
37				No archaeology
38				No archaeology
39				Trench not cut
40				Trench not cut

9.2 The predominant recorded features were furrows and these were present in every trench which could be excavated except Trenches 37 and 38 in the southernmost sector of the site. Throughout the site the furrows were consistently orientated north west / south east. None contained finds.

9.3 The only other recorded features, excepting modern features, were ditches, and these were present in Trenches 1 - 2, 11, 18 - 19, 22 and 27. Like the furrows these were orientated north west / south east (Trenches 1 – 2 and 22) and also north east / south west (Trenches 11, 18 - 19 and 27). The same ditch was traceable through Trenches 11 and 18 – 19). It is likely that these ditches correspond with those depicted on the historic maps (Figs. 7 – 8), for example, the ditch recorded in Trenches 11, 18 and 19 corresponds with the long NE/SW ditch evident on the 1836 Pre-enclosure map (Fig. 7).

9.4 The only finds present were sherds of modern (19th – 20th century) pottery within Ditch F1033 (Trench 1) and post-medieval and modern CBM within Ditches F1033 (Trench 1) and F1021 (Trench 27).

10 CONCLUSION

10.1 The site had a potential for multi-period archaeological remains. In particular an Iron Age settlement and Roman settlement and a driveway have been investigated to the immediate north of the site and at Scotland Farm (CHER MCB 16338; MCB16811, NCB18507; MCB16337 and ECB2765).

10.2 Perhaps surprisingly given the volume of known archaeology locally and the size of the site, excepting furrows and relatively recent

ditches no archaeological features were present and no finds pre-dating the post-medieval period were present.

11 DEPOSITION OF THE ARCHIVE

11.1 Archive records, with an inventory, will be deposited with any donated finds from the site at Cambridge County Archaeological Store. The archive will be quantified, ordered, indexed, cross-referenced and checked for internal consistency.

ACKNOWLEDGEMENTS

Archaeological Solutions would like to thank Mr. Tony Welland, of The Design Partnership (Ely) Ltd. for commissioning this archaeological evaluation on behalf of the client, Circle Housing Asset and Development Limited.

AS would also like to acknowledge the input and advice of Mr Andy Thomas of Cambridgeshire County Council Historic Environment Team.

BIBLIOGRAPHY

British Geological Survey (BGS), 1978, *Legend for the 1:625,000 Geological map of the United Kingdom (solid geology)*; London. Mansfield

Chartered Institute for Archaeologists (CIfA), 2014, *Standard and Guidance for Archaeological Field Evaluation*. IfA, Reading

Gurney, D., 2003, *Standards for Field Archaeology in the East of England*, East Anglian Archaeology Occasional Papers 14/ALGAO

Soil Survey of England and Wales (SSEW), 1983, *Legend for the 1:250,000 Soil Map of England and Wales*. SSEW, Harpenden

Thompson, P., 2016. Land South of St Neots Road, Hardwick, Cambridgeshire. An Archaeological Desk-based Assessment. AS Report No. 5257.

APPENDIX 1 CONCORDANCE OF FINDS

ECB4730 - P6671, Land on South Side of St Neots Road, Hardwick, Cambs.

Feature	Context	Segment	Trench	Description	Spot Date (Pot Only)	Pot Qty	Pottery (g)	CBM (g)	A.Bone (g)	Other Material	Other Qty	Other (g)
1021	1022		27	Fill of Ditch (Field Drain)			328					
1033	1034		1	Fill of Ditch	19th-20th	2	30	65		Slate	2	74

APPENDIX 2 SPECIALIST REPORT

The Ceramic Building Materials

Andrew Peachey

The evaluation recovered two fragments (393g) of late 18th to 19th century CBM. Ditch F1021 contained a single fragment (328g) of a red earthen ware horse-shoe pipe, part of a field drain; while Ditch F1033 contained a single fragment (65g) of salt-glazed white earthen ware tubular pipe, probably part of a water or sewer pipe.

OASIS DATA COLLECTION FORM: England

[List of Projects](#) | [Manage Projects](#) | [Search Projects](#) | [New project](#) | [Change your details](#) | [HER coverage](#) | [Change country](#) | [Log out](#)

Printable version

OASIS ID: archaeol7-283264

Project details

Project name	Land on the south side of St Neots Road, Hardwick, Cambridgeshire
Short description of the project	In February 2017 Archaeological Solutions (AS) carried out an archaeological evaluation of land on the south side of St Neots Road, Hardwick, Cambridgeshire (NGR TL 3676 5937). The evaluation was undertaken in advance of the determination of a planning application for the development of the site comprising the construction of up to 160 houses.
Project dates	Start: 01-02-2017 End: 28-02-2017
Previous/future work	No / Not known
Any associated project reference codes	P6671 - Contracting Unit No.
Any associated project reference codes	ECB4730 - Sitecode
Type of project	Field evaluation
Site status	None
Current Land use	Other 5 - Garden
Monument type	DITCH Modern
Monument type	DITCH Post Medieval
Significant Finds	CBM Post Medieval
Significant Finds	POTTERY Modern
Methods & techniques	"Sample Trenches", "Targeted Trenches"
Development type	Rural residential
Prompt	Planning condition
Position in the planning process	Pre-application

Project location

Country	England
Site location	CAMBRIDGESHIRE SOUTH CAMBRIDGESHIRE HARDWICK Land on the south side of St Neots Road, Hardwick, Cambridgeshire
Study area	7.12 Hectares

Site coordinates TL 3676 5937 52.215127470806 0.002022955255 52 12 54 N 000 00 07 E Point
 Height OD / Depth Min: 62m Max: 62m

Project creators

Name of Organisation Archaeological Solutions Ltd
 Project brief originator CCC HET
 Project design originator Jon Murray
 Project director/manager Jon Murray
 Project supervisor Archaeological Solutions Ltd

Project archives

Physical Archive recipient Cambridgeshire County Archaeological Store
 Physical Contents "Ceramics"
 Digital Archive recipient Cambridgeshire County Archaeological Store
 Digital Contents "Survey"
 Digital Media available "Images raster / digital photography", "Survey", "Text"
 Paper Archive recipient Cambridgeshire County Archaeological Store
 Paper Contents "Survey"
 Paper Media available "Drawing", "Photograph", "Plan", "Report", "Survey "

Project bibliography 1

Publication type Grey literature (unpublished document/manuscript)
 Title Land on the south side of St Neots Road, Hardwick, Cambridgeshire
 Author(s)/Editor(s) Monahan, V
 Other bibliographic details Archaeological Solutions Report No. 5309
 Date 2017
 Issuer or publisher Archaeological Solutions Ltd
 Place of issue or publication Bury St Edmunds
 Entered by Sarah Powell (info@ascontracts.co.uk)
 Entered on 20 April 2017

OASIS:

Please e-mail [Historic England](#) for OASIS help and advice

© ADS 1996-2012 Created by [Jo Gilham and Jen Mitcham](#), email Last modified Wednesday 9 May 2012

Cite only: <http://www.oasis.ac.uk/form/print.cfm> for this page

PHOTOGRAPHIC INDEX



1
Furrow F1031 and Ditch F1033 in Trench 1



2
Furrow F1035 in Trench 1



3
Ditch Terminus F1037 in Trench 1



4
Ditch F1040 in Trench 2



5
Furrow F1042 in Trench 2



6
Furrow F1044 in Trench 7



7
Furrow F1046 in Trench 7



8
Furrow F1048 in Trench 7



9
Furrow F1025 in Trench 17



10
Furrow F1027 in Trench 17



11
Furrow F1003 in Trench 22



12
Ditch F1007 in Trench 22



13
Ditch F1011 in Trench 22



14
Furrow F1013 in Trench 22



15
Furrow F1015 in Trench 22



16
Furrow F1017 in Trench 22



17
Furrow F1019 in Trench 27



18
Ditch F1021 in Trench 27



19
Ditch F1023 in Trench 27

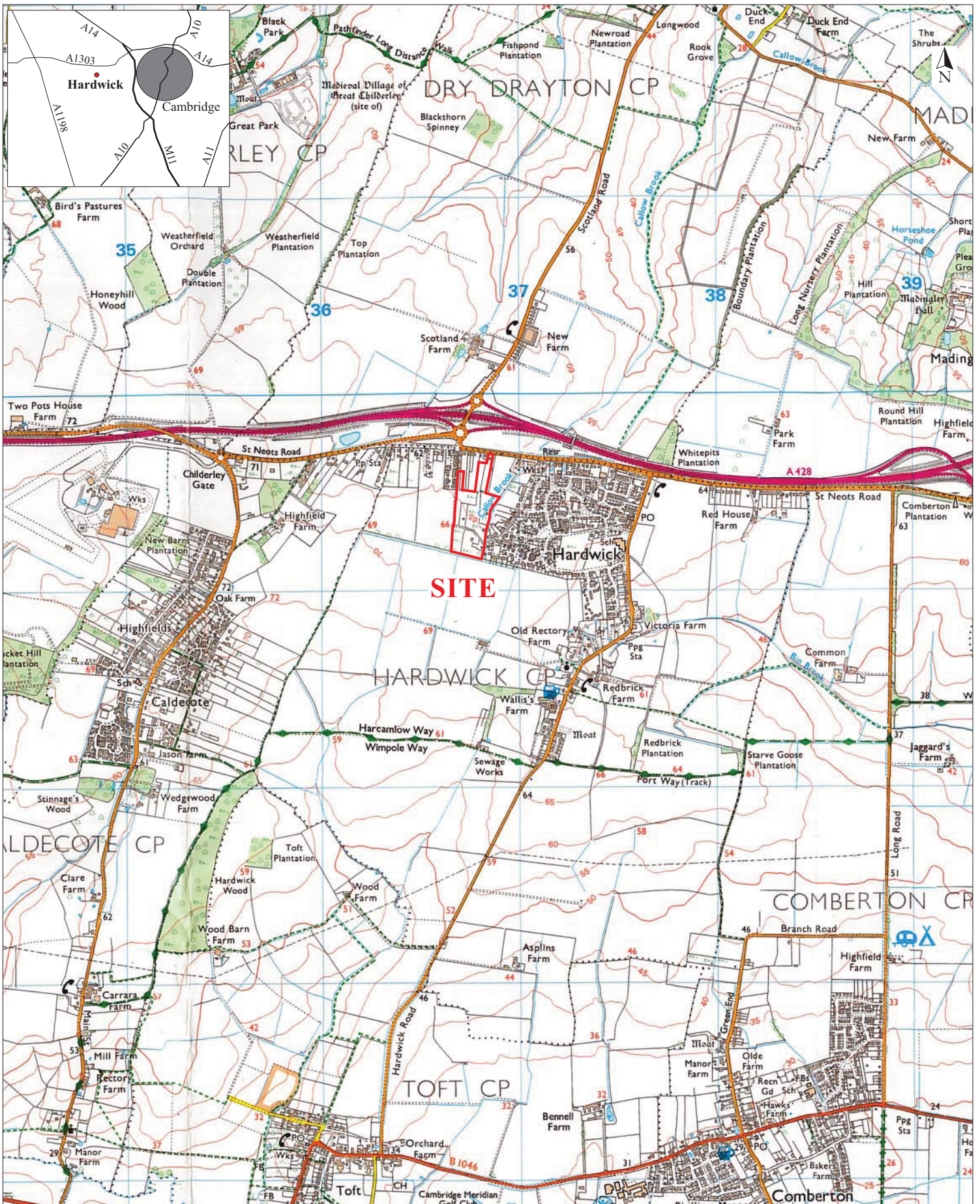

Reproduced from the 2007 Ordnance Survey 1:25000 map with the permission of Her Majesty's Stationery Office. © Crown copyright Archaeological Solutions Ltd Licence number 100036680

Archaeological Solutions Ltd
Fig. 1 Site location plan
 Scale 1:25,000 at A4
 St Neets Rd, Hardwick, Cambridgeshire (P6671)

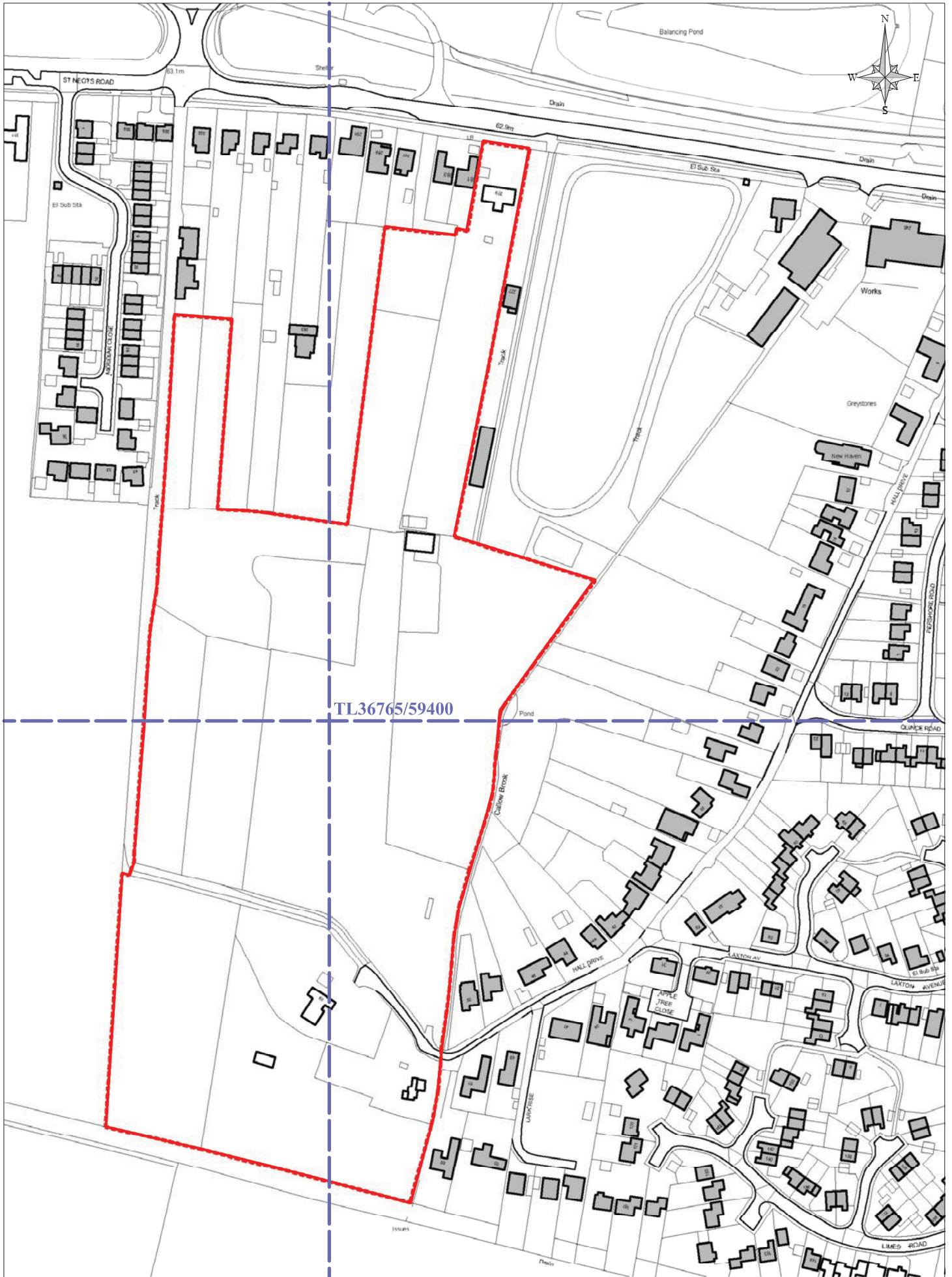





Archaeological Solutions Ltd

Fig. 2 Detailed site location plan

Scale 1:2500 at A4

St Neots Rd, Hardwick, Cambridgeshire (P6671)



-  Ditch
-  Furrow
-  Modern feature
-  Unexcavated trench

0 75m

Archaeological Solutions Ltd
Fig. 3 Trench location plan
Scale 1:1250 at A3
St Neots Rd, Hardwick, Cambridgeshire (P6671)

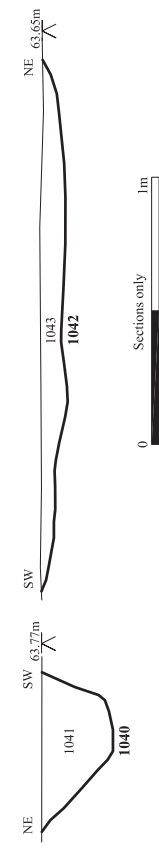
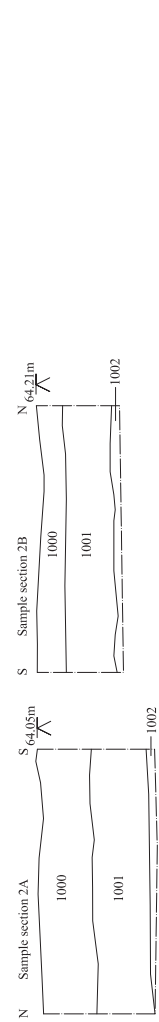
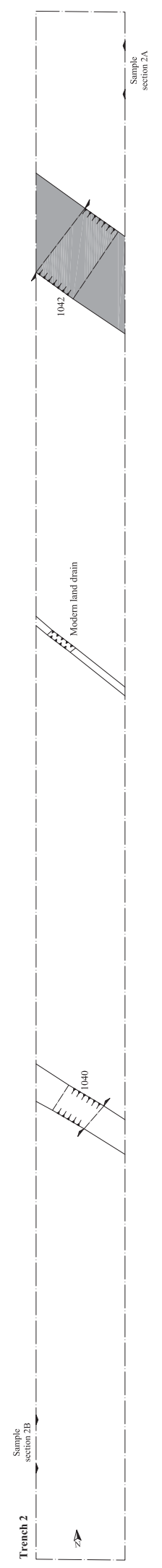
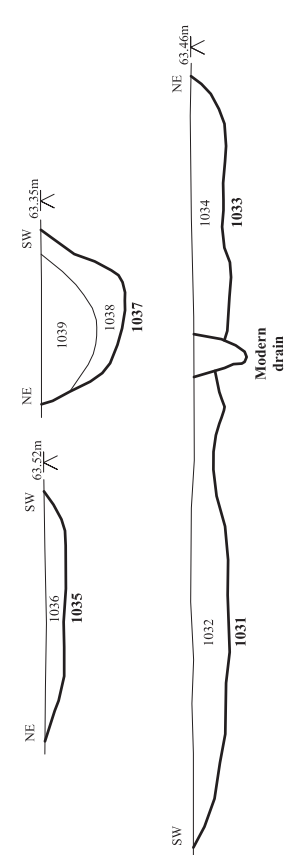
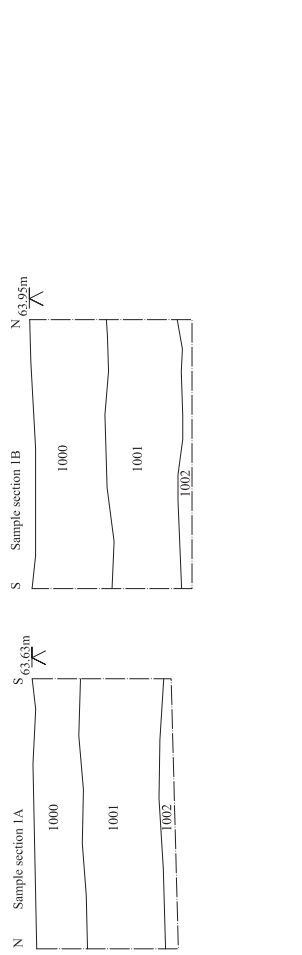
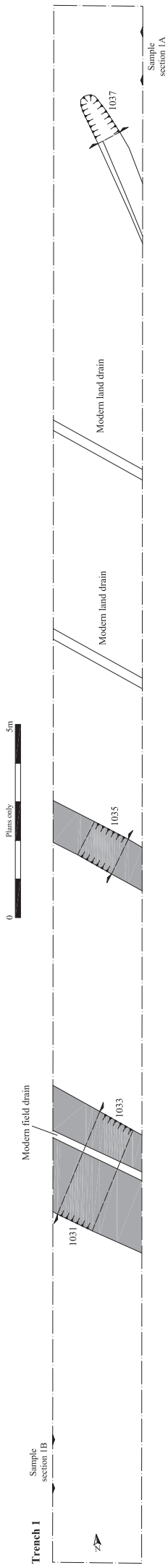

Archaeological Solutions Ltd
Fig. 4 Trench plans and sections
 Scale 1:100 and 1:20 at A3
 St Neots Rd, Hardwick, Cambridgeshire (P6671)

Furrow

Plans only 5m

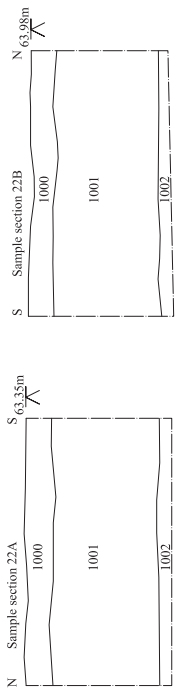
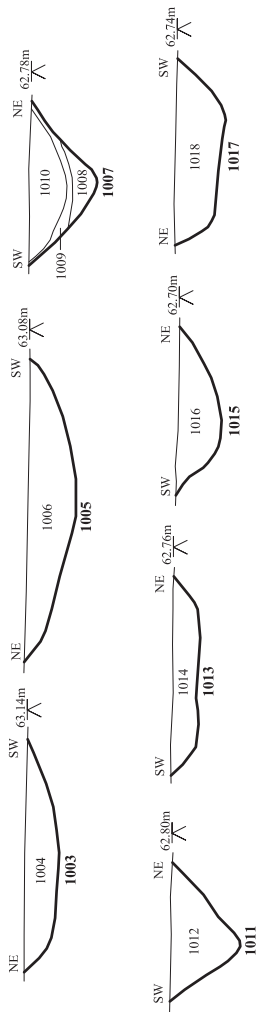
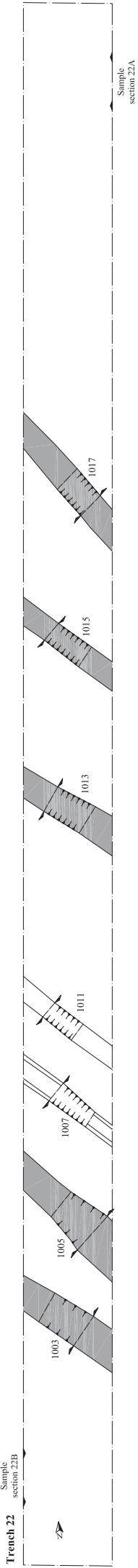

Trench 27

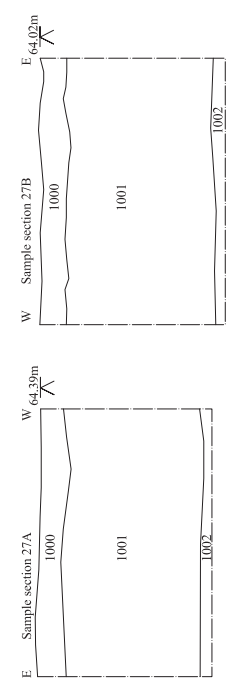
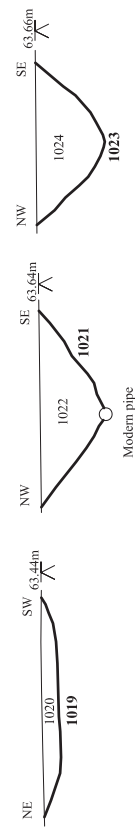
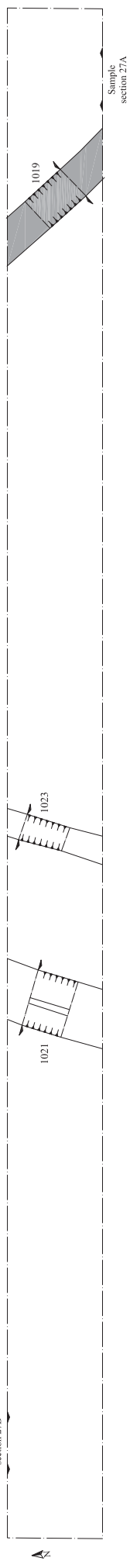

Sections only 1m



Archaeological Solutions Ltd
Fig. 6 Trench plans and sections
 Scale 1:100 and 1:20 at A3
 St Neots Rd, Hardwick, Cambridgeshire (P6671)

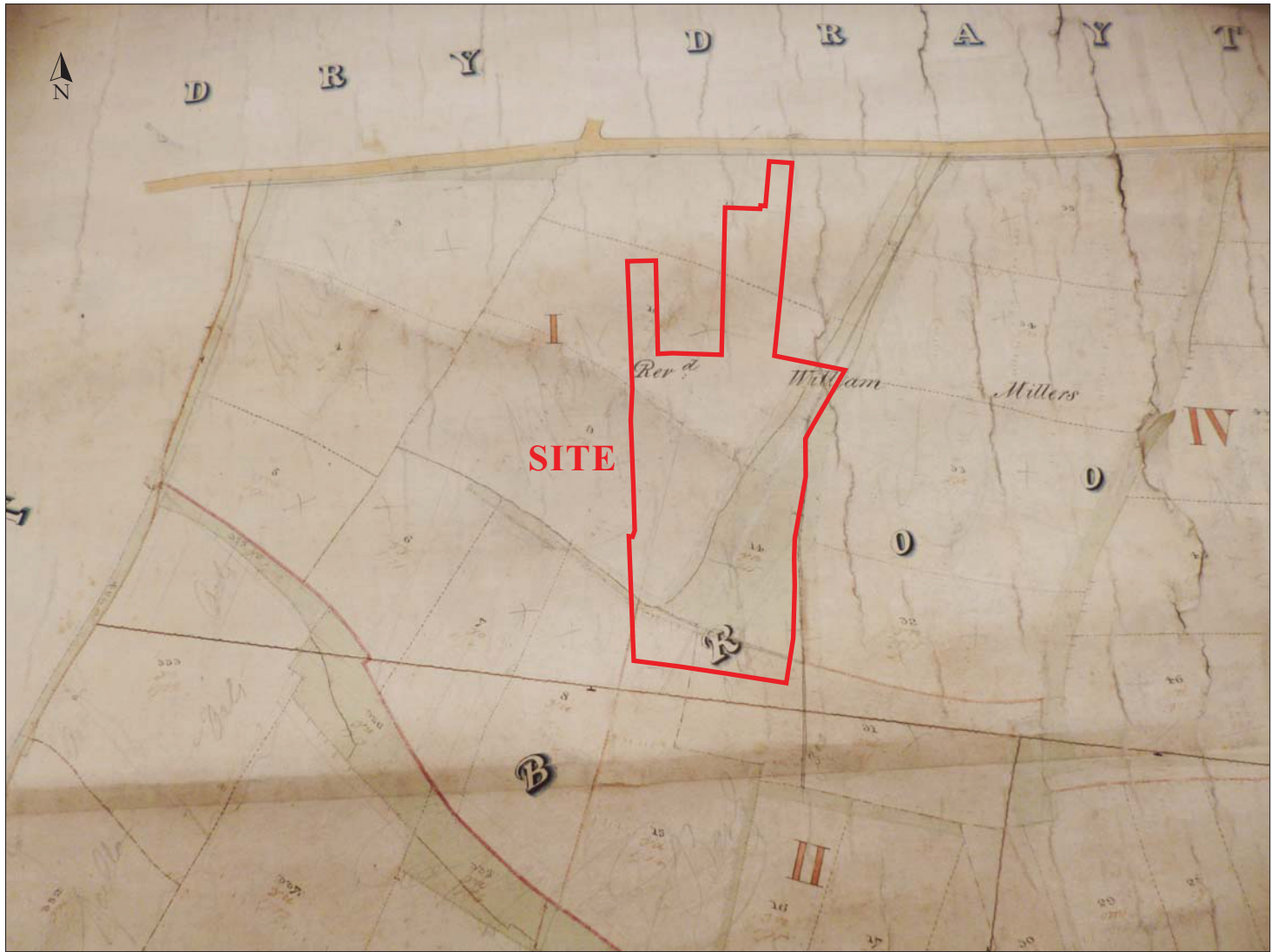

<i>Archaeological Solutions Ltd</i>
Fig. 7 Pre-enclosure map, 1836
Scale 1:25,000 at A4
St Neots Rd, Hardwick, Cambridgeshire (P6671)

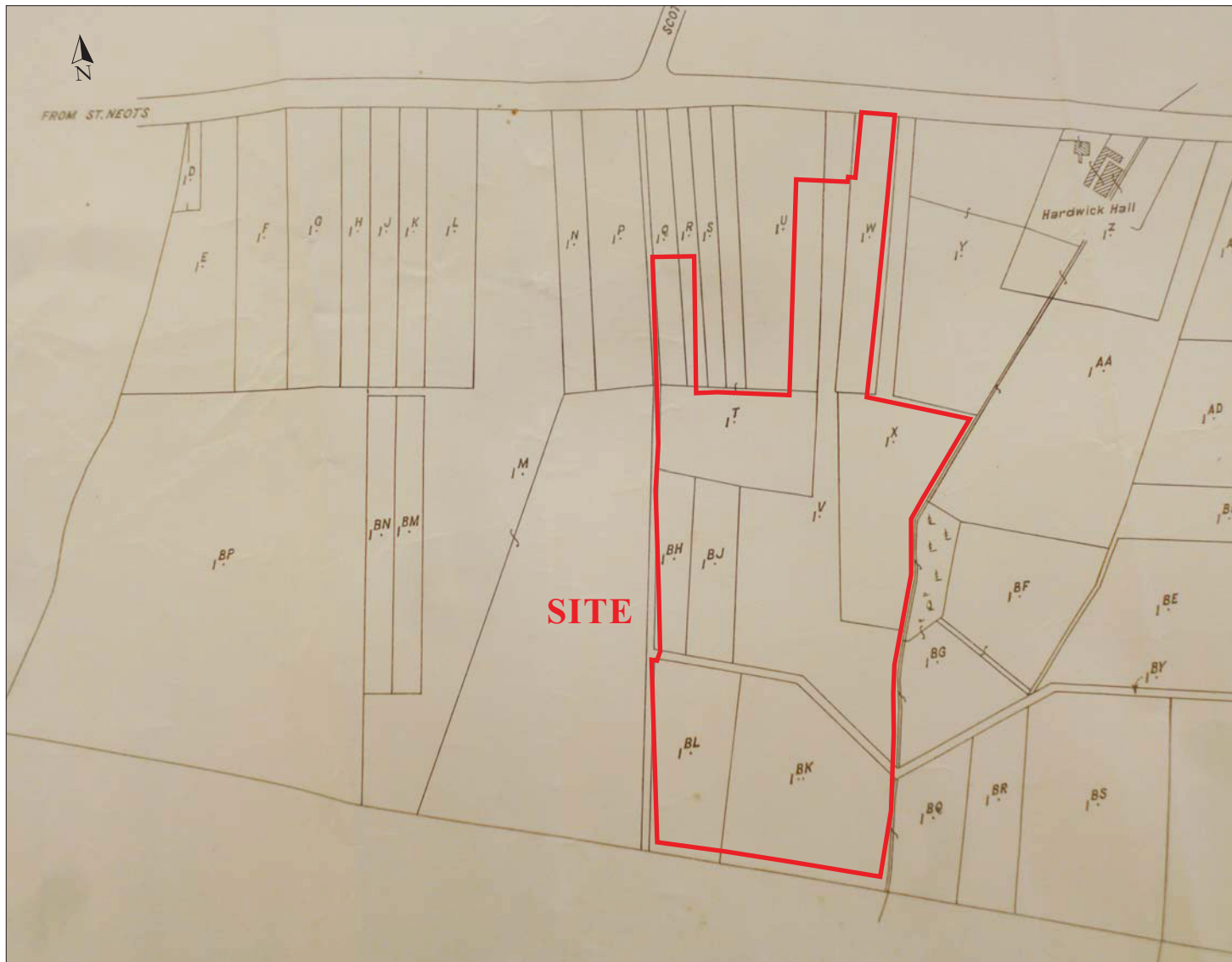

<i>Archaeological Solutions Ltd</i>
Fig. 8 Hardwick tithe map, 1837
Not to scale
St Neots Rd, Hardwick, Cambridgeshire (P6671)