

ARCHAEOLOGICAL SOLUTIONS LTD

LAND SOUTH OF 16 NORTH END YARD, KING'S LYNN, NORFOLK

ARCHAEOLOGICAL MONITORING AND RECORDING

Authors: Antony Mustchin (Fieldwork & report)	
NGR: TF 6197 2063	Report No. 5446
District: King's Lynn and West Norfolk	Site Code: ENF 142544
Approved: Claire Halpin MCIfA	Project No: 6021
	Date: 4 October 2017

This report is confidential to the client. Archaeological Solutions Ltd accepts no responsibility or liability to any third party to whom this report, or any part of it, is made known. Any such party relies upon this report entirely at their own risk. No part of this report may be reproduced by any means without permission.

CONTENTS

OASIS SUMMARY

SUMMARY

- 1 INTRODUCTION**
 - 2 DESCRIPTION OF THE SITE**
 - 3 TOPOGRAPHY, GEOLOGY AND SOILS**
 - 4 ARCHAEOLOGICAL & HISTORICAL BACKGROUND**
 - 5 METHODOLOGY**
 - 6 DESCRIPTION OF RESULTS**
 - 7 CONFIDENCE RATING**
 - 8 DEPOSIT MODEL**
 - 9 DISCUSSION**
 - 10 DEPOSITION OF THE ARCHIVE**
- ACKNOWLEDGEMENTS**
BIBLIOGRAPHY

APPENDIX 1 OASIS DATA COLLECTION FORM

Project details			
Project name	<i>Land South of 16 North End Yard, King's Lynn, Norfolk</i>		
<p><i>In September 2017 Archaeological Solutions Ltd (AS) carried out archaeological monitoring and recording on land south of 16 North End Yard King's Lynn (NGR TF 6197 2063; Figs. 1 - 2). The monitoring and recording was commissioned in advance of a proposed residential development. It was carried out in fulfilment of a condition attached to planning approval for the construction of four dwellings (King's Lynn & West Norfolk Borough Council Ref. 14/01111/F).</i></p> <p><i>Excepting a brick wall, the monitoring revealed no archaeological features or finds. The site stratigraphy was truncated and archaeological features if present may have been removed in the past, likely when the original depot was constructed. No residual archaeological finds were present.</i></p>			
Project dates (fieldwork)	<i>September 2017</i>		
Previous work (Y/N/?)	<i>N</i>	<i>Future work</i>	<i>N</i>
P. number	<i>6021</i>	<i>Site code</i>	<i>ENF 142 544</i>
Type of project	<i>Monitoring and Recording</i>		
Site status			
Current land use			
Planned development	<i>Residential</i>		
Main features (+dates)	<i>None</i>		
Significant finds (+dates)	<i>None</i>		
Project location			
County/ District/ Parish	<i>Norfolk</i>	<i>King's Lynn & West Norfolk</i>	<i>King's Lynn</i>
HER/ SMR for area	<i>Norfolk County Council Historic Environment Record</i>		
Post code (if known)	<i>-</i>		
Area of site	<i>-</i>		
NGR	<i>TF 6197 2063</i>		
Height AOD (min/max)	<i>4.50m AOD</i>		
Project creators			
Brief issued by	<i>Norfolk County Council Historic Environment Service</i>		
Project supervisor/s (PO)	<i>Archaeological Solutions</i>		
Funded by	<i>Ian Edgar</i>		
Full title	<i>Land South of 16 North End Yard, King's Lynn, Norfolk: Archaeological monitoring and recording</i>		
Authors	<i>Mustchin, A.</i>		
Report no.	<i>5446</i>		
Date (of report)	<i>October 2017</i>		

LAND SOUTH OF 16 NORTH END YARD, KING'S LYNN, NORFOLK

ARCHAEOLOGICAL MONITORING AND RECORDING

SUMMARY

In September 2017 Archaeological Solutions Ltd (AS) carried out an archaeological monitoring and recording on land south of 16 North End Yard King's Lynn (NGR TF 6197 2063; Figs. 1 - 2). The monitoring and recording was commissioned in advance of a proposed residential development. It was carried out in fulfilment of a condition attached to planning approval for the construction of four dwellings (King's Lynn & West Norfolk Borough Council Ref. 14/01111/F).

A number of important archaeological features are known within the immediate vicinity of the site, including the remains of a medieval bridge, identified c.60m south of the site (HER 40068), and in 2006 an archaeological evaluation c.75m south-east of the site identified remains of a medieval structure (HER 49124). Medieval stone mortar fragments have been recovered, along with post-medieval pottery sherds c.110m south-west of the site (HER 1151). Approximately 144m north-east of the site a find spot yielded an Iron Age ceramic jug (HER 29543). Additionally, 150m north of the site is the location of one of the Savage Engineering Works factories, in use from the 1870s (HER 13622).

Excepting a brick wall, the monitoring revealed no archaeological features or finds. The site stratigraphy was truncated and archaeological features if present may have been removed in the past, likely when the original depot was constructed. No residual archaeological finds were present.

1 INTRODUCTION

1.1 In September 2017 Archaeological Solutions Ltd (AS) carried out an archaeological monitoring and recording on land south of 16 North End Yard King's Lynn (NGR TF 6197 2063; Figs. 1 - 2). The monitoring and recording was commissioned in advance of a proposed residential development. It was carried out in fulfilment of a condition attached to planning approval for the construction of four dwellings (King's Lynn & West Norfolk Borough Council Ref. 14/01111/F).

1.2 The project was carried out in accordance with a generic brief issued by Norfolk County Council Historic Environment Service, and a specification compiled by AS (dated 23rd October 2014). It followed the procedures outlined in the Institute of Field Archaeologists' *Code of Conduct, Standard and Guidance for Archaeological Watching Brief* (2014). It also adhered to the

relevant sections of *Standards for Field Archaeology in the East of England* (Gurney 2003).

1.3 The principal objectives of the monitoring and recording were:

- To ensure the archaeological excavation and monitoring of all aspects of the development programme likely to affect buried archaeological remains.
- To secure the adequate recording of any archaeological remains revealed by the development programme.
- To secure the full analysis and interpretation of the site archive and the appropriate publication of the project results, if required.
- To secure the analysis, long term conservation and storage of the project archive.

Planning Policy Context

1.4 The National Planning Policy Framework (NPPF 2012) states that those parts of the historic environment that have significance because of their historic, archaeological, architectural or artistic interest are heritage assets. The NPPF aims to deliver sustainable development by ensuring that policies and decisions that concern the historic environment recognise that heritage assets are a non-renewable resource, take account of the wider social, cultural, economic and environmental benefits of heritage conservation, and recognise that intelligently managed change may sometimes be necessary if heritage assets are to be maintained for the long term. The NPPF requires applications to describe the significance of any heritage asset, including its setting that may be affected in proportion to the asset's importance and the potential impact of the proposal.

1.5 The NPPF aims to conserve England's heritage assets in a manner appropriate to their significance, with substantial harm to designated heritage assets (i.e. listed buildings, scheduled monuments) only permitted in exceptional circumstances when the public benefit of a proposal outweighs the conservation of the asset. The effect of proposals on non-designated heritage assets must be balanced against the scale of loss and significance of the asset, but non-designated heritage assets of demonstrably equivalent significance may be considered subject to the same policies as those that are designated. The NPPF states that opportunities to capture evidence from the historic environment, to record and advance the understanding of heritage assets and to make this publicly available is a requirement of development management. This opportunity should be taken in a manner proportionate to the significance of a heritage asset and to impact of the proposal, particularly where a heritage asset is to be lost.

2 DESCRIPTION OF THE SITE

2.1 The site is situated towards the north of central King's Lynn, on the northern side of John Kennedy Road, with Bentinck Dock c.300m to the

north-west. King's Lynn railway station is located c.660m south-east of the site. The A17 is found c.2.38 km south of the site, traveling roughly north-west/south-east, whilst the A149 is found some c.3.4km east of the site, traveling north-east/south west.

3 TOPOGRAPHY, GEOLOGY AND SOILS

3.1 The site is c.530m east of the channelised River Great Ouse, which flows into The Wash c.8.5km to the north. King's Lynn lies at approximately 5m AOD on the boundary between fenland in the west and low rolling chalk hills in the east. The soils of the area are unsurveyed, but the solid geology comprises the Ampthill and Kimmeridge clay formations.

4 ARCHAEOLOGICAL AND HISTORICAL BACKGROUND

4.1 The earliest evidence for significant settlement within the immediate vicinity of the site is attributed to the Anglo-Saxon period, with scattered finds of pottery (HER 25906), and evidence for sea defences constructed during this period (HER 5486). However, it is not until the 12th century that a substantial occupation of the area takes place, when Herbert de Losinga founded St. Margaret's Church, and established a market in the area between the Purfleet and Millfleet. Later, in the mid 12th century, Bishop Turbe brought an expansion of the town north of the Purfleet with the construction of the Church of St. Nicholas and saw to the establishment of a second market in the town. By this point, King's Lynn had become a significant regional trading centre necessitating an upgrade of the town's existing sea defences and the construction of the town walls in the 13th/15th centuries (HER 5486). The success of the town attracted a number of religious houses, including the Dominican Friary in the 13th century (HER 1176), and later the Augustinian Friary in the 15th century (HER 1025). The prosperity of King's Lynn continued throughout the Middle Ages, and by the 18th century, along with Yarmouth, was one of the dominant grain handling ports in the country. By the 19th century however, sea trade had declined with both the Napoleonic wars and the construction of the railway, and the focus of the town shifted inland away from the river towards the railway and local industries such as the Savage Works, producing agricultural machinery in factories on Tower Street and London Road; with engineering and machinery production becoming the dominant local industry.

4.2 A number of important archaeological features are known within the immediate vicinity of the site, including the remains of a medieval bridge, identified c.60m south of the site (HER 40068), and in 2006 an archaeological evaluation c.75m south-east of the site identified remains of a medieval structure (HER 49124). Medieval stone mortar fragments have been recovered, along with post-medieval pottery sherds c.110m south-west of the site (HER 1151). Approximately 144m north-east of the site a find spot yielded an Iron Age ceramic jug (HER 29543). Additionally, 150m north of the

site is the location of one of the Savage Engineering Works factories, in use from the 1870s (HER 13622).

5 METHODOLOGY

5.1 The ground reduction and excavation of the foundation trenches associated with the construction of the dwellings was undertaken under close archaeological observation (Fig.2).

5.2 Exposed sections were cleaned and examined for archaeological features. Deposits were recorded using *pro forma* recording sheets, drawn to scale and photographed as appropriate. Open trenches and excavated spoil were manually/ visually searched and scanned by metal detector to enhance the recovery of archaeological finds.

6 DESCRIPTION OF RESULTS

Sample sections were drawn and are presented below:

Sample Section 1 (Figs. 3 - 4)

<i>Sample section 1:</i> <i>0.00m = 4.41m AOD</i>		
0.00 - 0.06m	L1005	Gravel surface
0.06 – 0.21m	L1001	Made ground. Friable, dark brown slightly clayey silt with frequent small angular stones and CBM
0.21 – 0.45m	L1002	Made ground. Firm, dark yellow brown clayey silt with frequent stones.
0.45m+	L1003	Disturbed natural. Firm, mid yellow brown silty clay

Sample Section 2 (Figs. 3 - 4)

<i>Sample section 2:</i> <i>0.00m = 4.04m AOD</i>		
0.00 - 0.13m	L1001	Made ground. As above, Section 1
0.13 – 0.34m	L1002	Made ground. As above, Section 1
0.34m+	L1003	Disturbed natural. As above, Section 1

Sample Section 3 (Figs. 3 - 4)

<i>Sample section 3:</i> <i>0.00m = 4.23m AOD</i>		
0.00 - 0.17m	L1001	Made ground. As above, Section 1
0.17 – 0.34m	L1002	Made ground. As above, Section 1
0.34m+	L1003	Disturbed natural. As above, Section 1

Sample Section 4 (Figs. 3 - 4)

<i>Sample section 4:</i> <i>0.00m = 4.19m AOD</i>		
0.00 - 0.18m	L1005	Gravel Surface
0.18 - 0.41m	L1001	Made ground. As above, Section 1
0.41 - 0.53m	L1002	Made ground. As above, Section 1
0.53m+	L1003	Disturbed natural. As above, Section 1

Sample Section 5 (Figs. 3 - 4)

<i>Sample section 5:</i> <i>0.00m = 4.35m AOD</i>		
0.00 - 0.17m	L1005	Gravel surface
0.17 - 0.22m	L1006	Loose, sand
0.22 - 0.34m	L1001	Made ground. As above, Section 1
0.34 - 0.58m	L1002	Made ground. As above, Section 1
0.58m+	L1003	Disturbed natural. As above, Section 1

Sample Section 6 (Figs. 3 - 4)

<i>Sample section 6:</i> <i>0.00m = 4.45m AOD</i>		
0.00 - 0.30m	L1001	Made ground. As above, Section 1
0.30 - 0.47m	L1002	Made ground. As above, Section 1
0.47m+	L1003	Disturbed natural. As above, Section 1

Sample Section 7 (Figs. 3 - 4)

<i>Sample section 7:</i> <i>0.00m = 4.41m AOD</i>		
0.00 - 0.07m	L1000	Concrete
0.07 - 0.30m	L1001	Made ground. As above, Section 1
0.30 - 0.45m	L1002	Made ground. As above, Section 1
0.45m+	L1003	Disturbed natural. As above, Section 1

Sample Section 8 (Figs. 3 - 4)

<i>Sample section 8:</i> <i>0.00m = 4.22m AOD</i>		
0.00 - 0.04m	L1000	Concrete
0.04 - 0.30m	L1001	Made ground. As above, Section 1
0.30 - 0.46m	L1002	Made ground. As above, Section 1
0.46m+	L1003	Disturbed natural. As above, Section 1

Description: The remnants of a brick wall were visible and it truncated L1001 and L1002. M1004 was constructed using red frogged bricks, 220 x 110 x 70mm, and bonded with a pale yellow sandy mortar.

Excepting the brick wall no archaeological features or finds were present.

7 CONFIDENCE RATING

7.1 Within the parameters of the investigation it is not felt that any factors restricted the identification of archaeological features or finds.

8 DISCUSSION

8.1 A number of important archaeological features are known within the immediate vicinity of the site, including the remains of a medieval bridge, identified c.60m south of the site (HER 40068), and in 2006 an archaeological evaluation c.75m south-east of the site identified remains of a medieval structure (HER 49124). Medieval stone mortar fragments have been recovered, along with post-medieval pottery sherds c.110m south-west of the site (HER 1151). Approximately 144m north-east of the site a find spot yielded an Iron Age ceramic jug (HER 29543). Additionally, 150m north of the site is the location of one of the Savage Engineering Works factories, in use from the 1870s (HER 13622).

8.2 Excepting a brick wall, the monitoring revealed no archaeological features or finds. The site stratigraphy was truncated and archaeological features if present may have been removed in the past, likely when the original depot was constructed. No residual archaeological finds were present.

10 DEPOSITION OF THE ARCHIVE

10.1 Archive records, with an inventory, will be deposited at the Norwich Castle Museum. The archive will be quantified, ordered, indexed, cross referenced and checked for internal consistency.

ACKNOWLEDGEMENTS

Archaeological Solutions Ltd (AS) would like to thank Mr Ian Edgar for commissioning and funding the project, and for his assistance.

AS is also pleased to acknowledge the input and advice of Mr David Robertson of Norfolk County Council Historic Environment Service, and Mr Peter Watkins for providing the HER information.

BIBLIOGRAPHY

British Geological Survey, 1991
East Anglia Sheet 52°N-00° 1:250,000 Series Quaternary Geology
(Southampton, Ordnance Survey)

Chartered Institute for Archaeologists 2014
Standard and Guidance for Archaeological Watching Briefs, Reading, ClfA

Gurney, D., 2003
Standards for Field Archaeology in the East of England, East Anglian
Archaeology Occasional Paper no. 14

Soil Survey of England and Wales, 1983
Legend for the 1:250,000 Soil Map of England and Wales (Harpenden, Soil
Survey of England and Wales)

Soil Survey of England and Wales, 1983
Legend for the 1:250,000 Soil Map of England and Wales (Harpenden, Soil
Survey of England and Wales)

APPENDIX 1 OASIS DATA COLLECTION FORM

OASIS DATA COLLECTION FORM: England

[List of Projects](#) | [Manage Projects](#) | [Search Projects](#) | [New project](#) | [Change your details](#) | [HER coverage](#) | [Change country](#) | [Log out](#)

Printable version

OASIS ID: archaeo17-303082

Project details

Project name	Land South of 16 North End Yard, King's Lynn, Norfolk
Short description of the project	In September 2017 Archaeological Solutions Ltd (AS) carried out archaeological monitoring and recording on land south of 16 North End Yard King's Lynn (NGR TF 6197 2063; Figs. 1 - 2). The monitoring and recording was commissioned in advance of a proposed residential development. It was carried out in fulfilment of a condition attached to planning approval for the construction of four dwellings (King's Lynn and West Norfolk Borough Council Ref. 14/01111/F). Excepting a brick wall, the monitoring revealed no archaeological features or finds. The site stratigraphy was truncated and archaeological features if present may have been removed in the past, likely when the original depot was constructed. No residual archaeological finds were present.
Project dates	Start: 01-09-2017 End: 30-09-2017
Previous/future work	No / No
Any associated project reference codes	P6021 - Contracting Unit No.
Any associated project reference codes	ENF142544 - Sitecode
Type of project	Recording project
Site status	None
Current Land use	Other 15 - Other
Monument type	NONE None
Significant Finds	NONE None
Investigation type	"Watching Brief"
Prompt	Planning condition

Project location

Country	England
Site location	NORFOLK KINGS LYNN AND WEST NORFOLK KINGS LYNN Land South of 16 North End Yard, King's Lynn, Norfolk
Study area	0 Square metres
Site coordinates	TF 6197 2063 52.758583236108 0.4005425583 52 45 30 N 000 24 01 E Point
Height OD / Depth	Min: 4.5m Max: 4.5m

Project creators

Name of Organisation	Archaeological Solutions Ltd
Project brief originator	Norfolk County Council Historic Environment Service
Project design originator	Jon Murray
Project director/manager	Jon Murray
Project supervisor	Archaeological Solutions Ltd

Project archives

Physical Archive Exists?	No
Digital Archive recipient	Norwich Castle Museum
Digital Contents	"Survey"
Digital Media available	"Images raster / digital photography","Survey","Text"
Paper Archive recipient	Norwich Castle Museum
Paper Contents	"Survey"
Paper Media available	"Drawing","Photograph","Plan","Report","Survey "

Project bibliography 1

Publication type	Grey literature (unpublished document/manuscript)
Title	Land South of 16 North End Yard, King's Lynn, Norfolk
Author(s)/Editor(s)	Mustchin, A
Other bibliographic details	Archaeological Solutions Report No. 5446
Date	2017
Issuer or publisher	Archaeological Solutions Ltd
Place of issue or publication	Bury St Edmunds
Entered by	Sarah Powell (info@ascontracts.co.uk)
Entered on	6 December 2017

OASIS:

Please e-mail [Historic England](#) for OASIS help and advice

© ADS 1996-2012 Created by [Jo Gilham and Jen Mitcham, email](#) Last modified Wednesday 9 May 2012

Cite only: <http://www.oasis.ac.uk/form/print.cfm> for this page

PHOTOGRAPHIC INDEX



1
View of Site looking north



2
Wall 1004 looking north-west



3
Sample Section 3 looking north-west



4
Sample Section 5 looking south-east

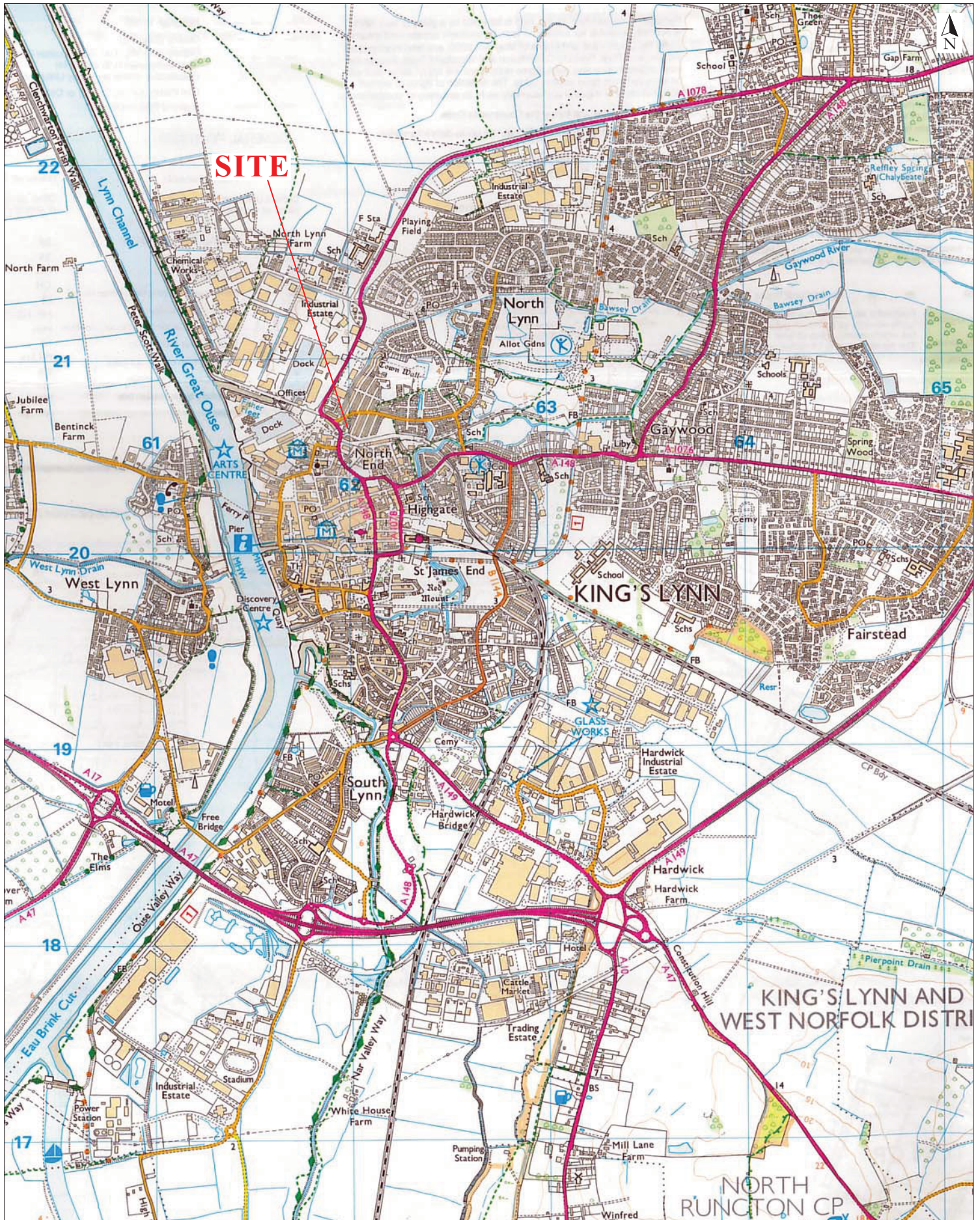

Reproduced from the 1999 Ordnance Survey 1:25000 map with the permission of Her Majesty's Stationery Office. © Crown copyright Archaeological Solutions Ltd Licence number 100036680

Archaeological Solutions Ltd
Fig. 1 Site location plan
 Scale 1:25,000 at A4
 North End Yard, Kings Lynn, Norfolk (P6021)

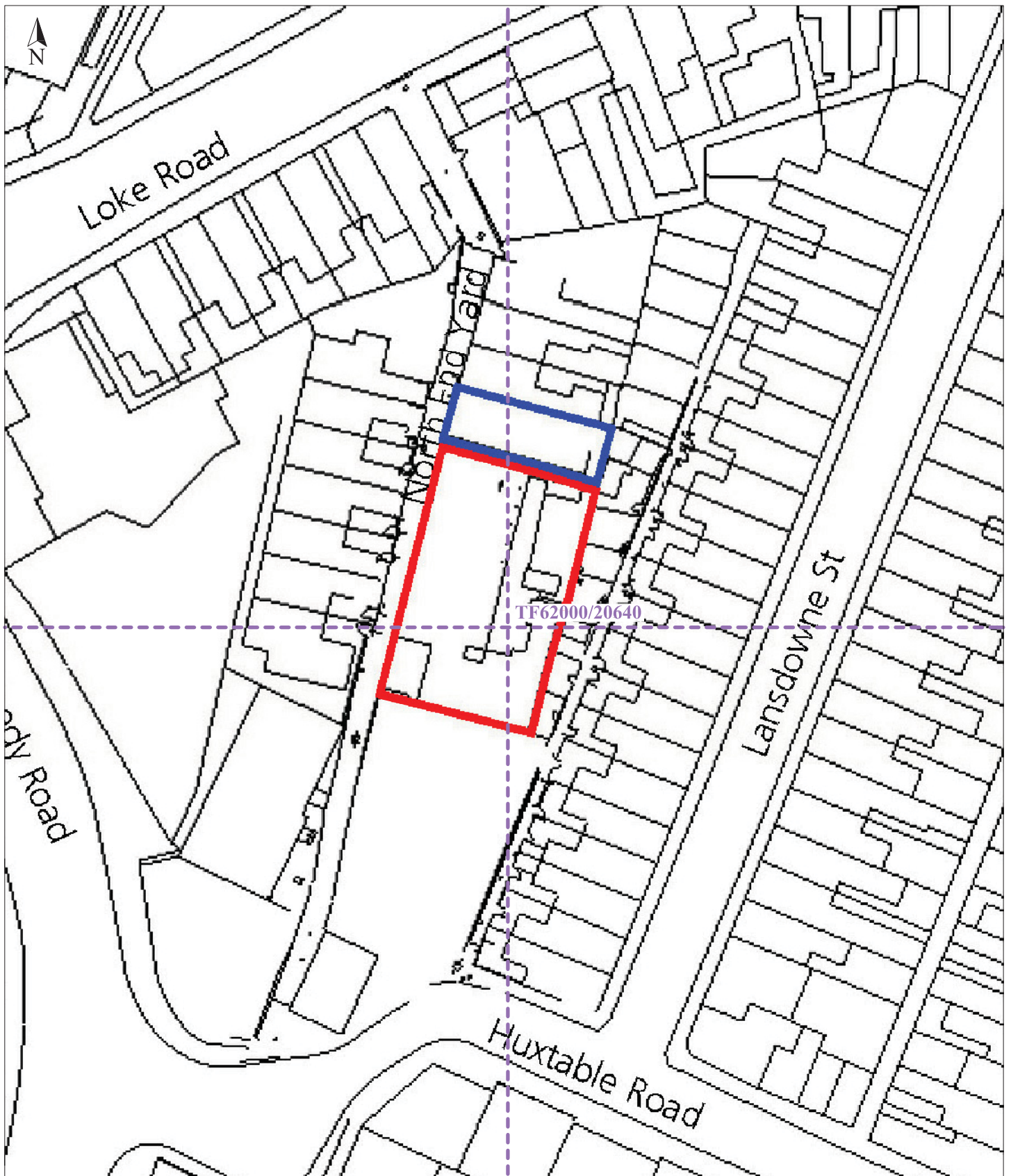

0 25m

Archaeological Solutions Ltd
Fig. 2 Detailed site location plan
Scale 1:500 at A4
North End Yard, King's Lynn, Norfolk (P6021)

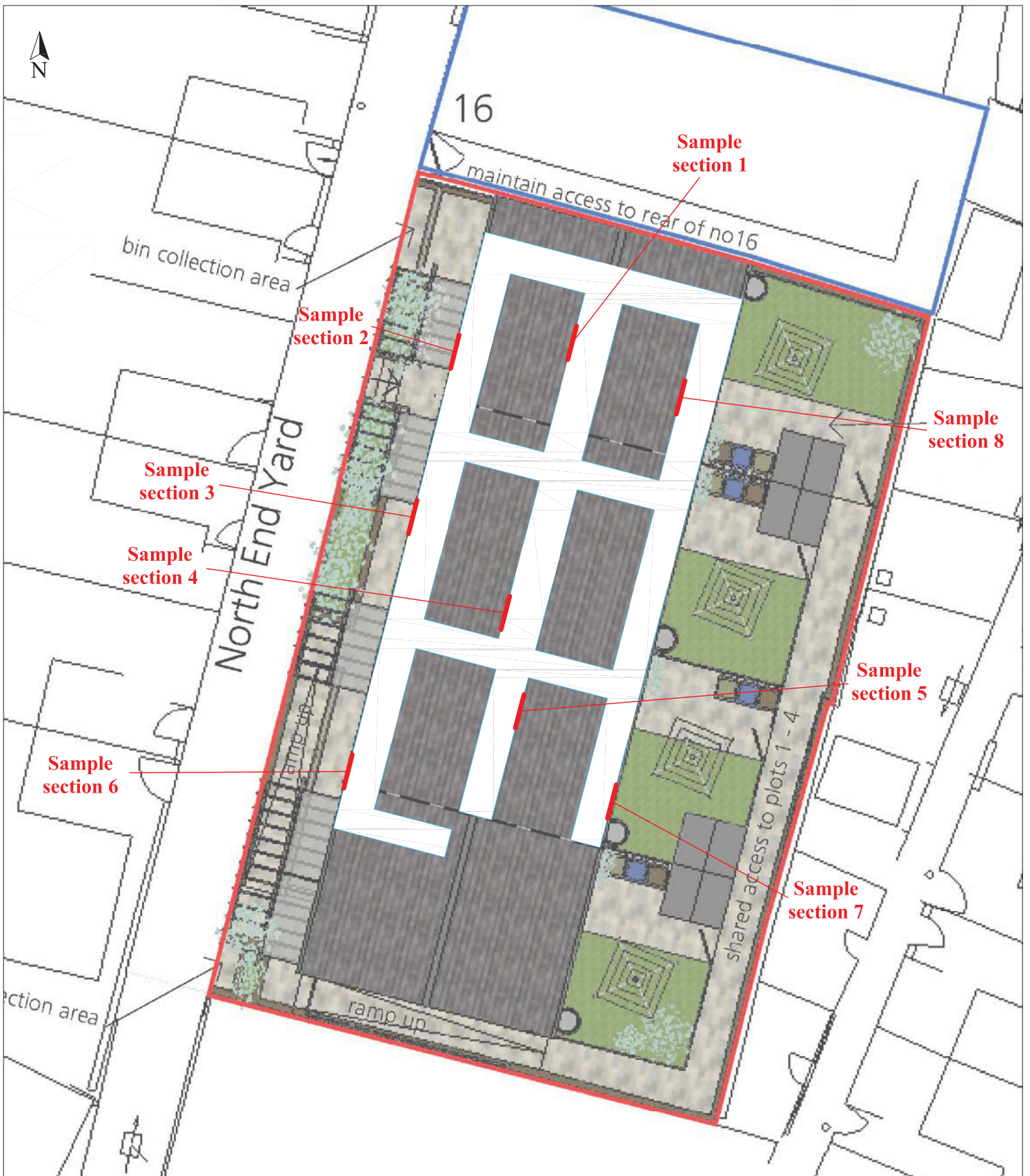

0 10m

<i>Archaeological Solutions Ltd</i>
Fig. 3 Sample section locations
Scale 1:150 at A4
North End Yard, King's Lynn, Norfolk (P6021)

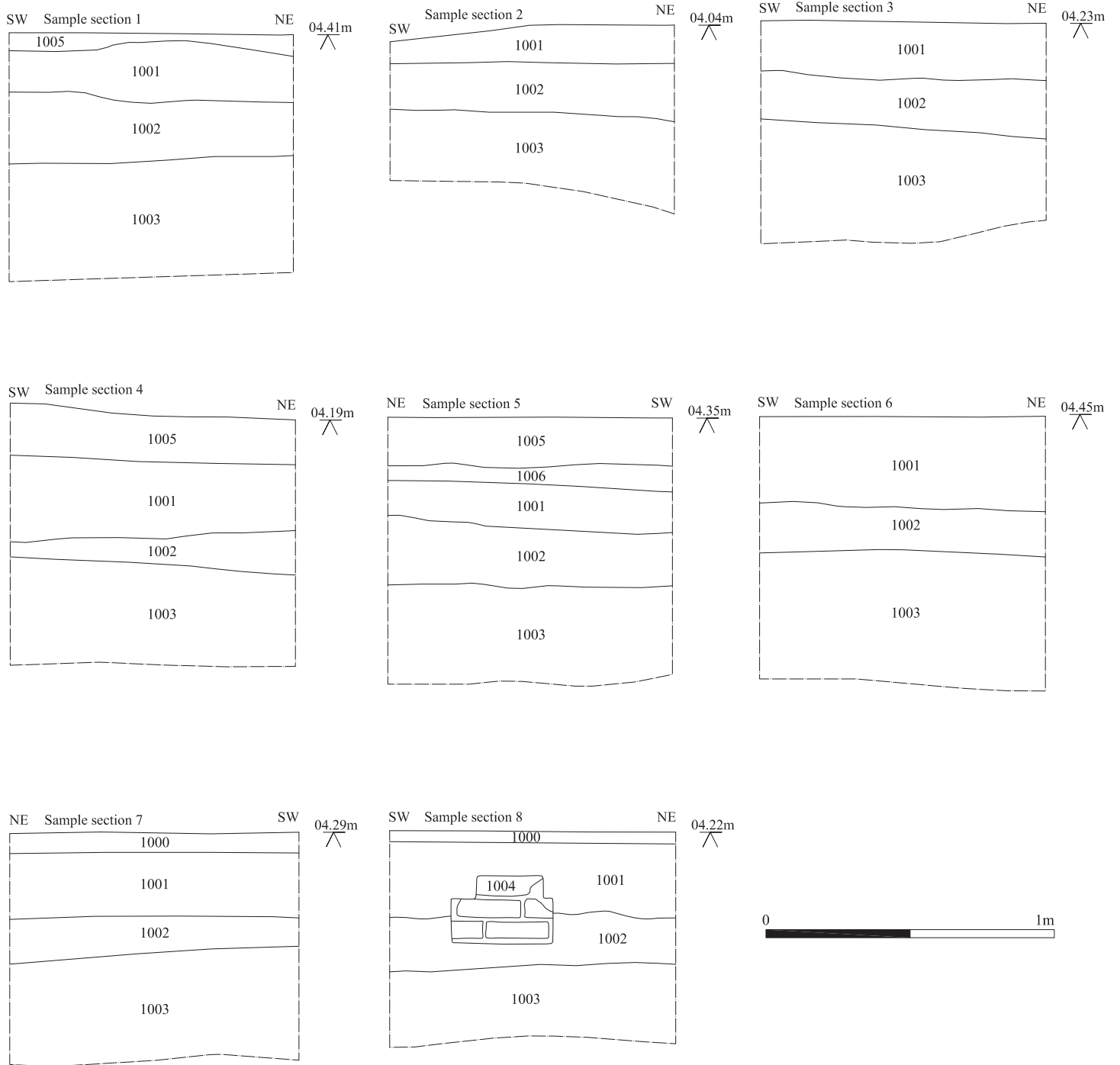

<i>Archaeological Solutions Ltd</i>
Fig. 4 Sample sections
Scale 1:20 at A4
North End Yard, King's Lynn, Norfolk (P6021)