ARCHAEOLOGICAL SOLUTIONS LTD

**ASHWELL END FARM, LOVES LANE, ASHWELL,
HERTFORDSHIRE SG7 5HZ**

ARCHAEOLOGICAL STRIP, MAP & RECORD INVESTIGATION AND
ARCHAEOLOGICAL MONITORING & RECORDING

HER Enquiry No. 267/17

Author: Samuel Thomelius (Fieldwork & Report)	
NGR: TL 25162 40211	Report No: 5717
District: North Herts	Site Code: AS 1965
Approved: Claire Halpin MCIfA	Project No: 7839
	Date: 8 January 2019

This report is confidential to the client. Archaeological Solutions Ltd accepts no responsibility or liability to any third party to whom this report, or any part of it, is made known. Any such party relies upon this report entirely at their own risk. No part of this report may be reproduced by any means without permission.

Archaeological Solutions is an independent archaeological contractor providing the services which satisfy all archaeological requirements of planning applications, including:

Desk-based assessments and environmental impact assessments
Historic building recording and appraisals
Trial trench evaluations
Geophysical surveys
Archaeological monitoring and recording
Archaeological excavations
Post excavation analysis
Promotion and outreach
Specialist analysis

ARCHAEOLOGICAL SOLUTIONS LTD

**Unit 6, Brunel Business Court, Eastern Way,
Bury St Edmunds IP32 7AJ
Tel 01284 765210**

**P I House, Rear of 23 Clifton Road, Shefford,
Bedfordshire, SG17 5AF
Tel: 01462 850483**

**e-mail info@ascontracts.co.uk
www.archaeologicalsolutions.co.uk**



twitter.com/ArchaeologicalS



www.facebook.com/ArchaeologicalSolutions



CONTENTS

OASIS SUMMARY SHEET

SUMMARY

- 1 INTRODUCTION***
- 2 DESCRIPTION OF THE SITE***
- 3 TOPOGRAPHY, GEOLOGY AND SOILS***
- 4 ARCHAEOLOGICAL AND HISTORICAL BACKGROUND***
- 5 METHODOLOGY***
- 6 DESCRIPTION OF RESULTS***
- 7 CONFIDENCE RATING***
- 8 DISCUSSION***

DEPOSITION OF THE ARCHIVE

ACKNOWLEDGEMENTS

BIBLIOGRAPHY

OASIS SUMMARY SHEET**Project details**

Project name Ashwell End Farm, Loves Lane, Ashwell, Hertfordshire SG7 5HZ

In November 2018 Archaeological Solutions Ltd (AS) carried out a programme of detailed archaeological 'strip, map & record' investigation and archaeological monitoring and recording during groundworks associated with the construction of a menage at Ashwell End Farm, Loves Lane, Ashwell, Hertfordshire SG7 5HZ (NGR TL 25162 40211; Figs. 1 - 2). The monitoring was carried out according to the requirements of the Hertfordshire County Council Historic Environment Advisor Team (HCC HEAT), and was required in compliance with a planning condition attached to the planning approval (NHDC Planning Approval Ref. 18/02549/FP).

The site had a particular potential for the presence of medieval occupation remains associated with the adjacent homestead moat.

The monitoring recorded that the construction of the menage was relatively superficial and the ground reduction and drainage did not penetrate the subsoil, and therefore if archaeological features are present they are preserved in situ.

Project dates (fieldwork) 12th, 13th, 14th November 2018

Previous work (Y/N/?) Y Future work N

P. number 7460 Site code AS1965

Type of project Archaeological monitoring & recording

Site status Within an Area of Archaeological Significance (No. 191)

Current land use Former chicken coop and paddock

Planned development Menage

Main features (+dates) None

Significant finds (+dates) None

Project location

County/ District/ Parish Hertfordshire North Herts Ashwell

HER for area Hertfordshire Historic Environment Record (HER enquiry No. 267/17)

Post code (if known) SG7 5HZ

Area of site c.1300 m²

NGR TL 25162 40211

Height AOD (max/ min) c. 39m AOD

Project creators

Brief issued by Hertfordshire County Council Historic Environment Team

Project supervisor/s (PO) Archaeological Solutions Ltd

Funded by Dr Merry Pertwee

Full title Ashwell End Farm, Loves Lane, Ashwell, Hertfordshire SG7 5HZ. Archaeological Monitoring and Recording

Authors Thomelius, S.

Report no. 5717

Date (of report) January 2019

**ASHWELL END FARM, LOVES LANE, ASHWELL,
HERTFORDSHIRE SG7 5HZ**

**ARCHAEOLOGICAL STRIP, MAP & RECORD
INVESTIGATION AND
ARCHAEOLOGICAL MONITORING & RECORDING**

SUMMARY

In November 2018 Archaeological Solutions Ltd (AS) carried out a programme of detailed archaeological 'strip, map & record' investigation and archaeological monitoring and recording during groundworks associated with the construction of a menage at Ashwell End Farm, Loves Lane, Ashwell, Hertfordshire SG7 5HZ (NGR TL 25162 40211; Figs. 1 - 2). The monitoring was also carried out according to the requirements of the Hertfordshire County Council Historic Environment Advisor Team (HCC HEAT), and was required in compliance with a planning condition attached to the planning approval (NHDC Planning Approval Ref. 18/02549/FP).

The site lies within an Area of Archaeological Significance (No. 191) as identified on the local plan, on the extreme north western edge of the village of Ashwell.

It is immediately adjacent to an area Scheduled as an Ancient Monument to the west of Loves Lane, Ashwell (NHLE 1012208, Hertfordshire Historic Environment Record HER 4197). This comprises a moated enclosure of medieval date, and the moated platform contains the buildings of Ashwell End Farm. An adjacent double island moated site lies close by to the east. Such combined moated enclosures are rare and unusual in Hertfordshire. A bank lies between the western edge of the enclosure and the area of the proposed new menage.

The site had a particular potential for the presence of medieval occupation remains associated with the adjacent homestead moat.

The construction of the menage was relatively superficial (0.16 – 0.42m deep) and the ground reduction and drainage did not penetrate the subsoil, and therefore if archaeological features are present they are preserved in situ.

1 INTRODUCTION

1.1 In November 2018 Archaeological Solutions Ltd (AS) carried out a programme of detailed archaeological 'strip, map & record' investigation and archaeological monitoring and recording during groundworks associated with the construction of a menage at Ashwell End Farm, Loves Lane, Ashwell, Hertfordshire SG7 5HZ (NGR TL 25162 40211; Figs. 1 - 2). The monitoring was carried out according to the requirements of the Hertfordshire County Council Historic Environment Advisor Team (HCC HEAT), and was required in compliance with a planning condition attached to the planning approval (NHDC Planning Approval Ref. 18/02549/FP).

1.2 The programme of archaeological monitoring and recording was carried out in accordance with a specification/Written Scheme of Investigation compiled by AS (6th November 2017) and approved by HCC HEA and the LPA. The project was also undertaken according to the requirements of the document *Standards for Field Archaeology in the East of England* (Gurney 2003) and the ClfA *Standard and Guidance for Archaeological Watching Briefs* (2014).

1.3 The requirements of the project were:

- Archaeological monitoring by a programme of 'strip, map & record' across the footprint of the proposed new menage, with the investigation and recording of any archaeology thereby revealed.
- The archaeological monitoring of all other groundworks associated with the scheme likely to have an impact on any remains (principally ground reduction/excavation, new drainage etc)
- The provision of an adequately detailed project report
- The dissemination and publication of the project results, as appropriate

Planning policy context

1.4 The National Planning Policy Framework (NPPF 2012) states that those parts of the historic environment that have significance because of their historic, archaeological, architectural or artistic interest are heritage assets. The NPPF aims to deliver sustainable development by ensuring that policies and decisions that concern the historic environment recognise that heritage assets are a non-renewable resource, take account of the wider social, cultural, economic and environmental benefits of heritage conservation, and recognise that intelligently managed change may sometimes be necessary if heritage assets are to be maintained for the long term. The NPPF requires applications to describe the significance of any

heritage asset, including its setting that may be affected in proportion to the asset's importance and the potential impact of the proposal.

1.5 The NPPF aims to conserve England's heritage assets in a manner appropriate to their significance, with substantial harm to designated heritage assets (i.e. listed buildings, scheduled monuments) only permitted in exceptional circumstances when the public benefit of a proposal outweighs the conservation of the asset. The effect of proposals on non-designated heritage assets must be balanced against the scale of loss and significance of the asset, but non-designated heritage assets of demonstrably equivalent significance may be considered subject to the same policies as those that are designated. The NPPF states that opportunities to capture evidence from the historic environment, to record and advance the understanding of heritage assets and to make this publicly available is a requirement of development management. This opportunity should be taken in a manner proportionate to the significance of a heritage asset and to impact of the proposal, particularly where a heritage asset is to be lost.

2 DESCRIPTION OF THE SITE

2.1 The site lies within the bounds of Ashwell End Farm, a farmstead lying in the rural hinterland of Ashwell in north Hertfordshire. The site lies c. 1.6km north-west of the village of Ashwell and c. 1.6km south-east of the smaller village of Hinxworth.

2.2 At the time that archaeological work commenced, the site was in use as fairly rough, undeveloped grassland adjacent to the gardens associated with the farmhouse at Ashwell End Farm.

3 TOPOGRAPHY, GEOLOGY AND SOILS

3.1 The site lies at c. 45m OD in a fairly flat landscape which rises only slightly to the north-west and north-east in the vicinity of the villages of Dunton and Guilden Morden respectively. To the south-east the land drops slightly towards the centre of Ashwell before climbing steeply to the south. The land reaches a height of c. 84m OD around 1.5km to the south of the site.

3.2 The site lies on soils of the Milton Association, which are described as deep calcareous fine local soils. Soils of the Swaffham Prior Association are also present in the surrounding area; these well drained calcareous coarse and fine loamy soils over chalk rubble (SSEW 1983). The solid geology of the area belongs to the West Melbury Marly Chalk Formation(mapapps.bgs.ac.uk/geologyofbritain/home.html)

4 ARCHAEOLOGICAL & HISTORICAL BACKGROUND

4.1 The site lies within an Area of Archaeological Significance (No.191) as identified on the local plan, on the extreme north western edge of the village of Ashwell.

4.2 The site is immediately adjacent to an area Scheduled as an Ancient Monument to the west of Loves Lane, Ashwell (NHLE 1012208, Hertfordshire Historic Environment Record HER 4197). This comprises a moated enclosure of medieval date, and the moated platform contains the buildings of Ashwell End Farm. An adjacent double island moated site lies close by to the east. Such combined moated ensues are rare and unusual in Hertfordshire although this is one of three in the immediately surrounding area (see also HER 416 and HER 423). A bank lies between the western edge of the enclosure and the area of the proposed new menage.

4.3 Cropmarks of ring-ditches have been recorded to the east of Ashwell End Farm and further to the south-east; these are potentially of later Neolithic or Bronze Age date (HER 1245, 1259). Fragments of Bronze Age axes have been found in the surrounding area (HER 214, 437, 2840)

4.4 Evidence of Iron Age occupation in the area comes in the form of late Iron Age coin (a bronze stater) found in the Ashwell End area (HER 2844). Iron Age and Roman metalwork (HER 13402) has been found at Bluegates Farm

4.5 The Roman period is represented in the area surrounding the site by findspots from which a Roman figurine and other artefacts (HER 15648) and occupation material (HER 1178) have been recovered. A rectangular enclosure has been recorded to the south-east of Hinxworth and this is considered to possibly represent a Roman military camp (HER 181). Iron Age and Roman metalwork (HER 13402) and Roman pottery (HER 425) has been recovered from locations at nearby Bluegates Farm.

4.6 The site had a particular potential for the presence of medieval occupation remains associated with the adjacent homestead moat.

5 METHODOLOGY

5.1 The ground reduction and excavation of the drain were monitored.

5.2 The archaeological monitoring comprised the observation of all groundworks likely to affect archaeological remains, the inspection of

the subsoil and natural deposits for archaeological features, the examination of spoil heaps and the recording of soil profiles. Encountered features and deposits were cleaned by hand and recorded using *pro forma* recording sheets, drawn to scale and photographed as appropriate. Excavated spoil was checked for finds.

6 DESCRIPTION OF RESULTS

6.1 The encountered stratigraphy was recorded in sample sections presented below:

<i>Sample section 1</i> <i>0.00 = 39.97m AOD</i>		
0.00 – 0.11m	L1000	Topsoil. Friable, mid brown sandy clay with occasional small sub-angular and sub-rounded flint. It contained modern (20 th century) pottery, CBM and glass
0.11 - 32m+	L1001	Subsoil. Friable, mid grey brown sandy clay silt with occasional small sub-angular and sub-rounded flint.

<i>Sample section 2</i> <i>0.00 = 39.98m AOD</i>		
0.00 – 0.15m	L1000	Topsoil. As above
0.15 - 29m+	L1001	Subsoil. As above.

<i>Sample section 3</i> <i>0.00 = 39.99m AOD</i>		
0.00 – 0.28m	L1000	Topsoil. As above
0.28 – 0.42m+	L1001	Subsoil. As above.

<i>Sample section 4</i> <i>0.00 = 39.98m AOD</i>		
0.00 – 0.08m	L1000	Topsoil. As above
0.08- 34m+	L1001	Subsoil. As above.

<i>Sample section 5</i> <i>0.00 = 39.93m AOD</i>		
0.00 – 0.19m+	L1000	Topsoil. As above

<i>Sample section 6</i> <i>0.00 = 39.96m AOD</i>		
0.00 – 0.15m	L1000	Topsoil. As above
0.15 - 33m+	L1001	Subsoil. As above.

Sample section 7 0.00 = 39.87m AOD		
0.00 – 0.16m+	L1000	Topsoil. As above

Description: No archaeological features or finds were present.

Some ground disturbance at the surface level was evident in the form of an old chicken coop, and modern (20th century) pottery, CBM and glass were present within Topsoil L1000.

7 CONFIDENCE RATING

7.1 Within the parameters of the investigation it is not felt that any factors restricted the identification of archaeological features or finds.

8 DISCUSSION

8.1 The site immediately adjacent to an area Scheduled as an Ancient Monument to the west of Loves Lane, Ashwell (NHLE 1012208, Hertfordshire Historic Environment Record HER 4197). An adjacent double island moated site lies close by to the east. Such combined moated enclosures are rare and unusual in Hertfordshire.

8.2 The construction of the menage was relatively superficial (0.16 – 0.42m deep) and the ground reduction and drainage did not penetrate the subsoil, and therefore if archaeological features are present they are preserved *in situ*.

DEPOSITION OF THE ARCHIVE

Archive records, with an inventory, will be deposited with North Hertfordshire Museums. The archive will be quantified, ordered, indexed, cross referenced and checked for internal consistency.

ACKNOWLEDGEMENTS

Archaeological Solutions would like to thank Dr Merry Pertwee for funding the programme of archaeological monitoring and recording, and for all her assistance.

AS is also pleased to acknowledge the staff of the Hertfordshire Historic Environment Record, AS would also like to thank the staff of the Hertfordshire Archives and Local Studies (HALS), based in County Hall, Hertford.

AS would also like to acknowledge the input and advice of Dr Simon Wood, HCC Historic Environment Advisor.

BIBLIOGRAPHY

British Geological Survey (BGS) 2015 *British Geological Survey, Geology of Britain Viewer*, <http://mapapps.bgs.ac.uk/geologyofbritain/home.html>, accessed January 2018

Chartered Institute for Archaeologists (CIfA) 2014 *Standard and Guidance for the Archaeological Monitoring and Recording*. CIfA, Reading

Gurney, D. 2003 *Standards for Field Archaeology in the East of England*. East Anglian Archaeology Occasional Paper 14

Soil Survey of England and Wales (SSEW) 1983 *Soils of South East England (sheet 4)*. SSEW, Harpenden

Soil Survey of England and Wales (SSEW) 1983 *Soil Survey of England and Wales: Legend for the 1:250,000 Soil Map of England and Wales*. SSEW, Harpenden

APPENDIX 1

HER SUMMARY SHEET

Site name and address:	<i>Ashwell End Farm, Loves Lane, Ashwell, Hertfordshire SG7 5HZ</i>
County: <i>Hertfordshire</i>	District: <i>North Herts</i>
Village/Town:	Parish: <i>Ashwell</i>
Planning application reference:	<i>NHDC Planning Approval Ref. 18/02549/FP</i>
Client name/address	<i>Dr M Pertwee, Ashwell End Farm</i>
Nature of application:	<i>Menage</i>
Present land use:	<i>Former chicken coop and paddock</i>
Size of application area:	Size of area investigated <i>c .1300m2</i>
NGR (8 figures):	<i>TL 25162 40211</i>
Site Code:	<i>AS 1965</i>
Organisation:	<i>Archaeological Solutions Ltd</i>
Type of work:	<i>Archaeological monitoring and recording.</i>
Date of work:	<i>12th, 13th, 14th November 2018</i>
Location of Curating museum:	<i>North Herts</i>
Related SMR Nos:	Periods represented: <i>None</i>
Relevant previous summaries/reports: -	-
Summary of fieldwork results:	<p><i>In November 2018 Archaeological Solutions Ltd (AS) carried out a programme of detailed archaeological 'strip, map & record' investigation and archaeological monitoring and recording during groundworks associated with the construction of a menage at Ashwell End Farm, Loves Lane, Ashwell, Hertfordshire SG7 5HZ (NGR TL 25162 40211; Figs. 1 - 2). The monitoring was also carried out according to the requirements of the Hertfordshire County Council Historic Environment Advisor Team (HCC HEAT), and was required in compliance with a planning condition attached to the planning approval (NHDC Planning Approval Ref. 18/02549/FP).</i></p> <p><i>The construction of the menage was relatively superficial (0.16 – 0.42m deep) and the ground reduction and drainage did not penetrate the subsoil, and therefore if archaeological features are present they are preserved in situ.</i></p>
Author of summary: <i>Samuel Thomelius</i>	Date of Summary: <i>January 2019</i>

OASIS DATA COLLECTION FORM: England

[List of Projects](#) | [Manage Projects](#) | [Search Projects](#) | [New project](#) | [Change your details](#) | [HER coverage](#) | [Change country](#) | [Log out](#)

Printable version

OASIS ID: archaeol7-333247

Project details

Project name	Ashwell End Farm, Loves Lane, Ashwell, Hertfordshire (SMS)
Short description of the project	In November 2018 Archaeological Solutions Ltd (AS) carried out a programme of detailed archaeological 'strip, map and record' investigation and archaeological monitoring and recording during groundworks associated with the construction of a menage at Ashwell End Farm, Loves Lane, Ashwell, Hertfordshire SG7 5HZ (NGR TL 25162 40211; Figs. 1 - 2). The monitoring was carried out according to the requirements of the Hertfordshire County Council Historic Environment Advisor Team (HCC HEAT), and was required in compliance with a planning condition attached to the planning approval (NHDC Planning Approval Ref. 18/02549/FP). The site had a particular potential for the presence of medieval occupation remains associated with the adjacent homestead moat. The monitoring recorded that the construction of the menage was relatively superficial and the ground reduction and drainage did not penetrate the subsoil, and therefore if archaeological features are present they are preserved in situ.
Project dates	Start: 12-11-2018 End: 15-11-2018
Previous/future work	Yes / No
Any associated project reference codes	P7839 - Contracting Unit No.
Any associated project reference codes	AS1965 - Sitecode
Type of project	Recording project
Site status	Area of Archaeological Importance (AAI)
Current Land use	Other 15 - Other
Monument type	NONE None
Significant Finds	NONE None
Investigation type	"Watching Brief"
Prompt	Planning condition

Project location

Country	England
Site location	HERTFORDSHIRE NORTH HERTFORDSHIRE ASHWELL Ashwell End Farm, Loves Lane, Ashwell, Hertfordshire
Postcode	SG7 5HZ
Study area	1300 Square metres

Site coordinates TL 25162 40211 52.045709728035 -0.174713601478 52 02 44 N 000 10 28 W Point
 Height OD / Depth Min: 39m Max: 39m

Project creators

Name of Organisation Archaeological Solutions Ltd
 Project brief originator HCC HEU
 Project design originator Jon Murray
 Project director/manager Jon Murray
 Project supervisor Archaeological Solutions
 Type of sponsor/funding body Dr Merry Pertwee
 Name of sponsor/funding body Dr Merry Pertwee

Project archives

Physical Archive Exists? No
 Digital Archive recipient North Hertfordshire Museums Service
 Digital Contents "none"
 Digital Media available "Database","Images raster / digital photography","Spreadsheets","Text"
 Paper Archive recipient North Hertfordshire Museums Service
 Paper Contents "none"
 Paper Media available "Context sheet","Diary","Map","Photograph","Plan","Report","Section","Survey "

Project bibliography 1

Publication type Grey literature (unpublished document/manuscript)
 Title Ashwell End Farm, Loves Lane, Ashwell, Hertfordshire SG7 5HZ. Archaeological Monitoring and Recording
 Author(s)/Editor(s) Thomelius, S.
 Other bibliographic details 5717
 Date 2019
 Issuer or publisher Archaeological Solutions Ltd
 Place of issue or publication Bury St Edmunds
 Entered by Hollie Wesson (admin@ascontract.co.uk)
 Entered on 8 January 2019

OASIS:

Please e-mail [Historic England](#) for OASIS help and advice

© ADS 1996-2012 Created by [Jo Gilham and Jen Mitcham](#), email Last modified Wednesday 9 May 2012

Cite only: <http://www.oasis.ac.uk/form/print.cfm> for this page

[Cookies](#) [Privacy Policy](#)

PHOTOGRAPHIC INDEX (P7839)



1
General site overview looking south



2
General site overview looking north



3
Area of excavation looking east



4
View of excavated drainage channels looking north



5
Sample Section 1 looking east



6
Sample Section 2 looking west



7
Sample Section 3 looking south



8
Sample Section 4 looking east



9
Sample Section 5 looking west



10
Sample Section 6 looking east



11
Sample Section 7 looking west

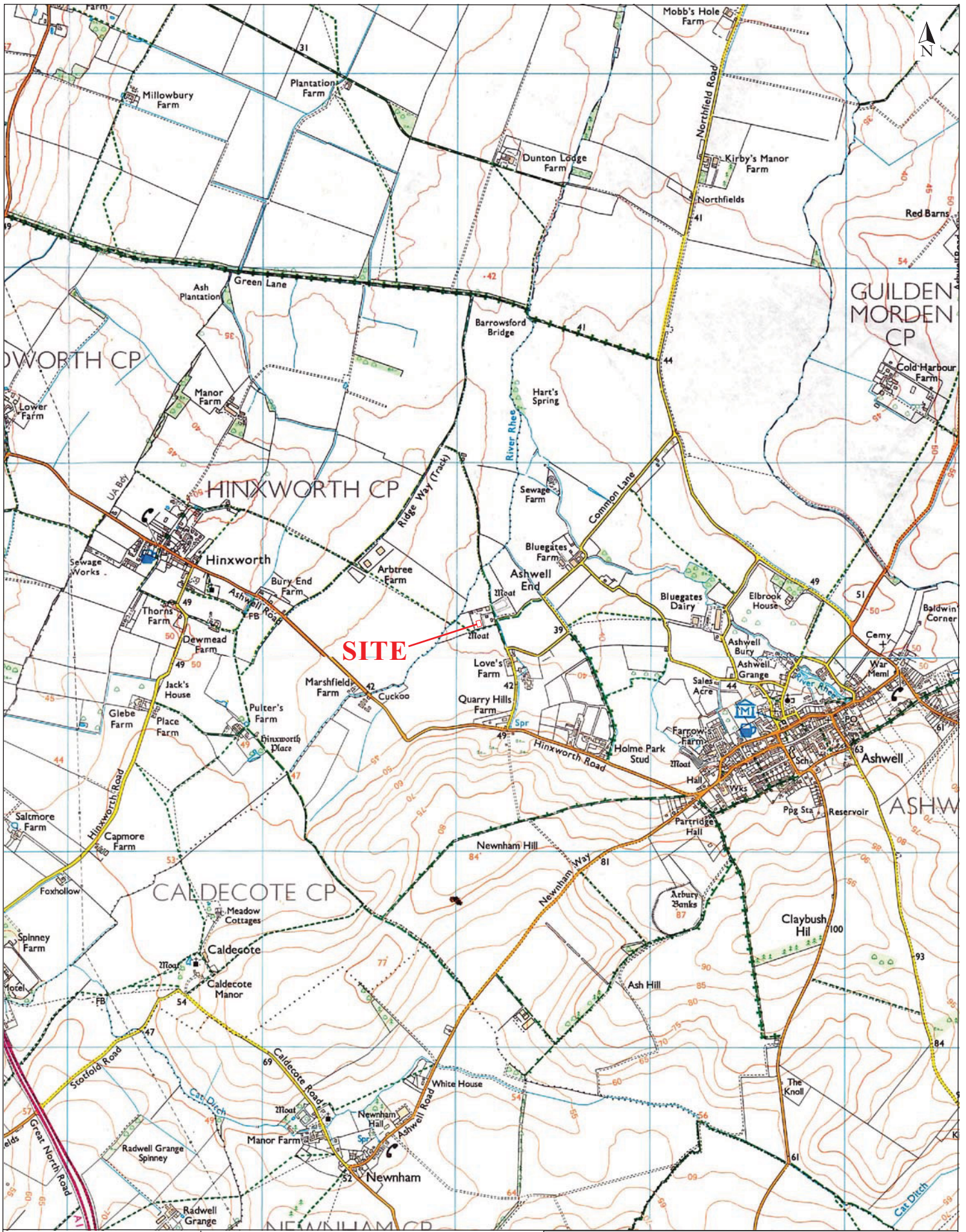

Reproduced from the 2010 Ordnance Survey 1:25000 map with the permission of Her Majesty's Stationery Office. © Crown copyright Archaeological Solutions Ltd Licence number 100036680

Archaeological Solutions Ltd
Fig. 1 Site location plan
 Scale 1:25,000 at A4
 Ashwell End Farm, Love Lane, Hertfordshire (P7839)

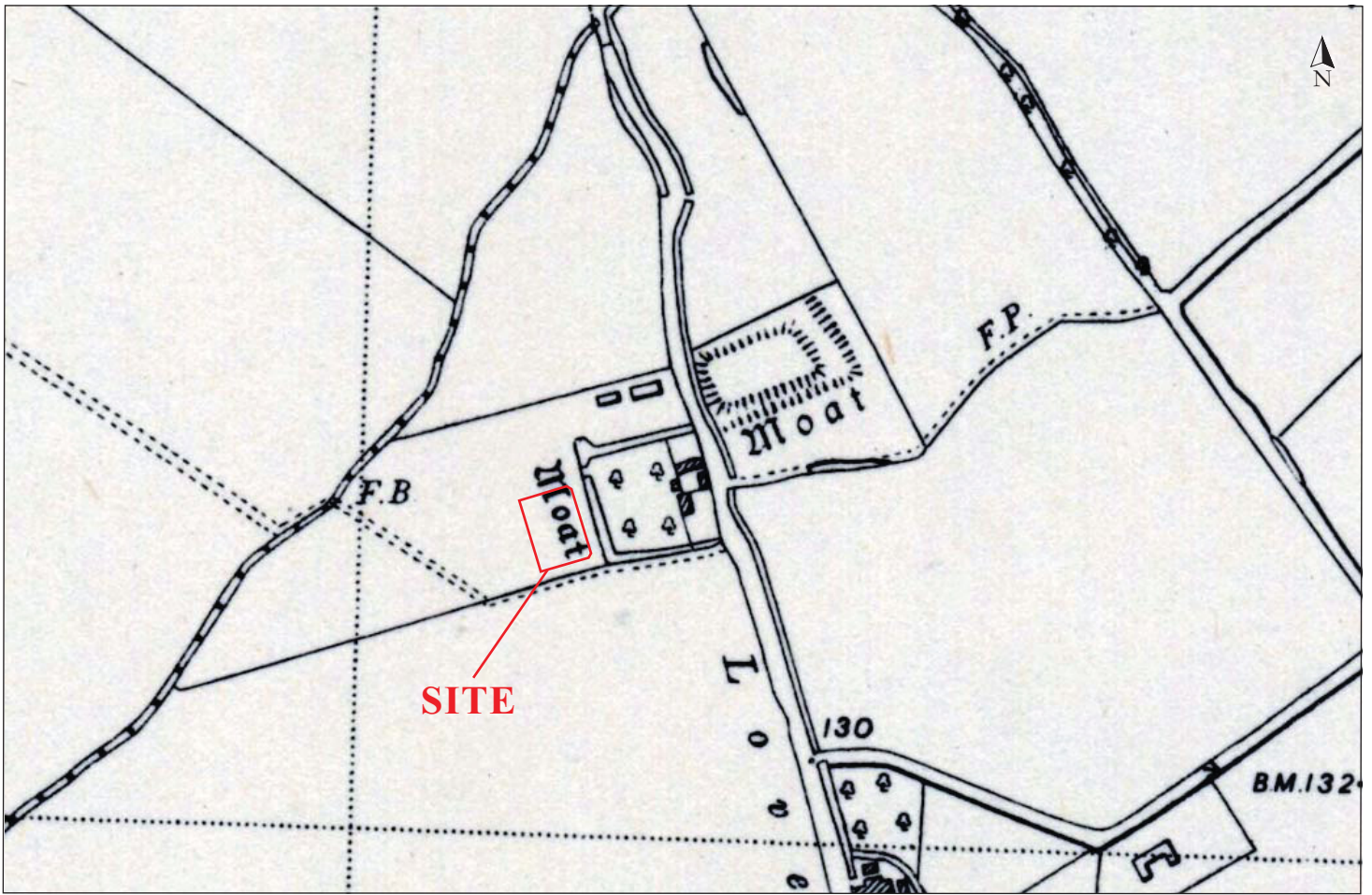

<i>Archaeological Solutions Ltd</i>
Fig. 2a 1898 OS map
Not to scale
Ashwell End Farm, Love Lane, Hertfordshire (P7839)

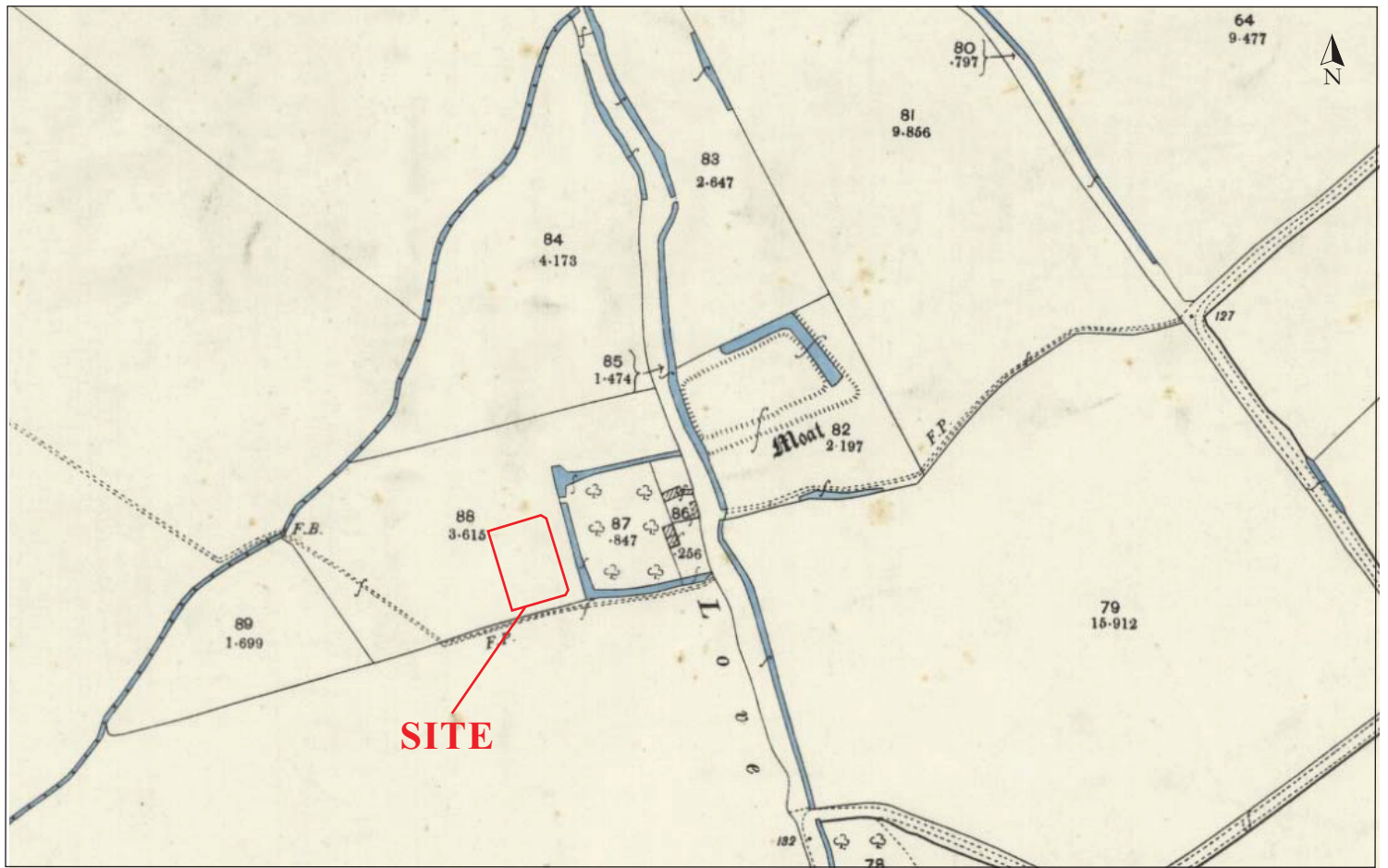

<i>Archaeological Solutions Ltd</i>
Fig. 2b 1950 OS map
Not to scale
Ashwell End Farm, Love Lane, Hertfordshire (P7839)

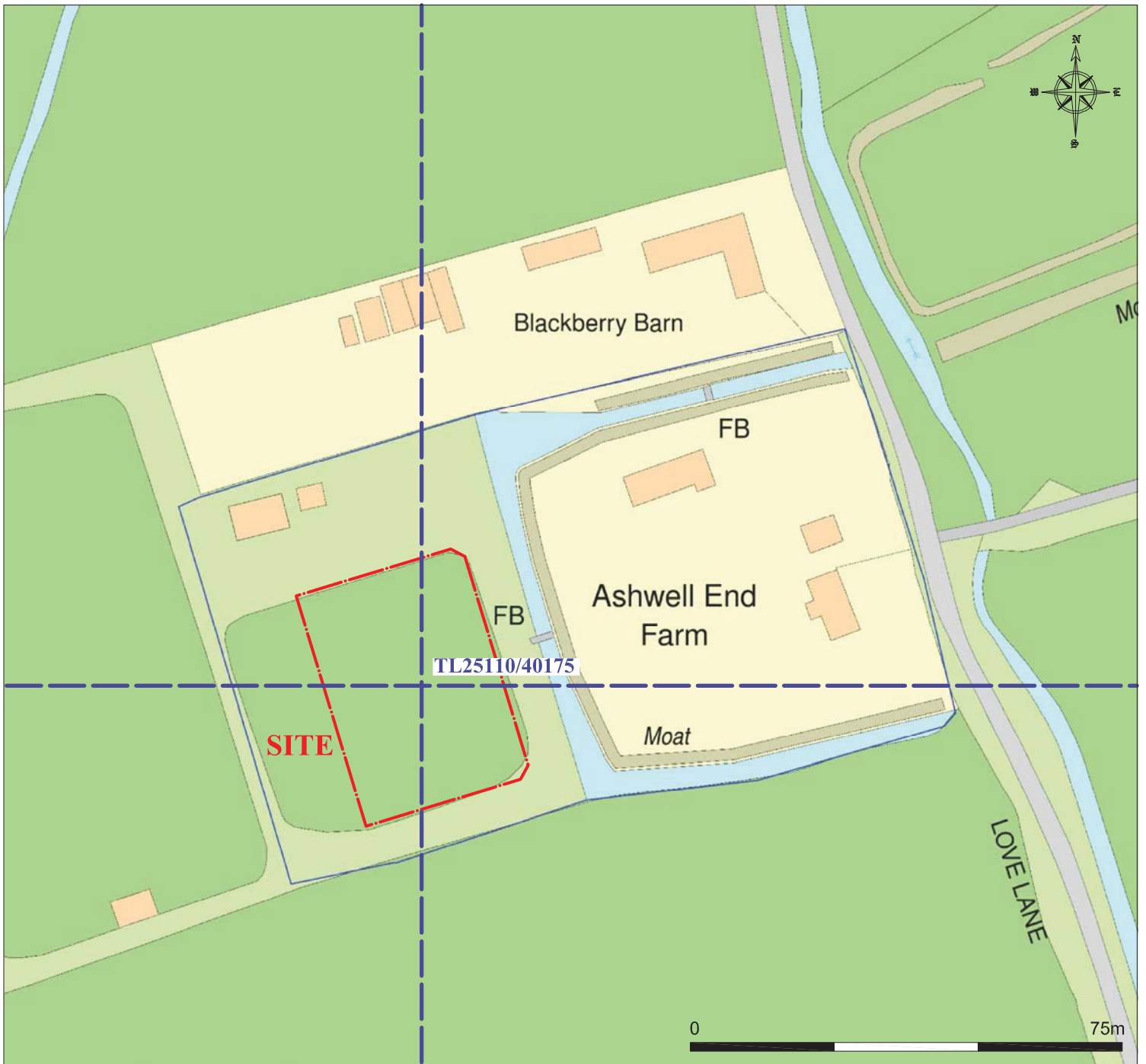

Contains Ordnance Survey data ©
Crown copyright and database right [2018]

<i>Archaeological Solutions Ltd</i>
Fig. 3 Detailed site location plan
Scale 1:1000 at A4
Ashwell End Farm, Love Lane, Hertfordshire (P7839)

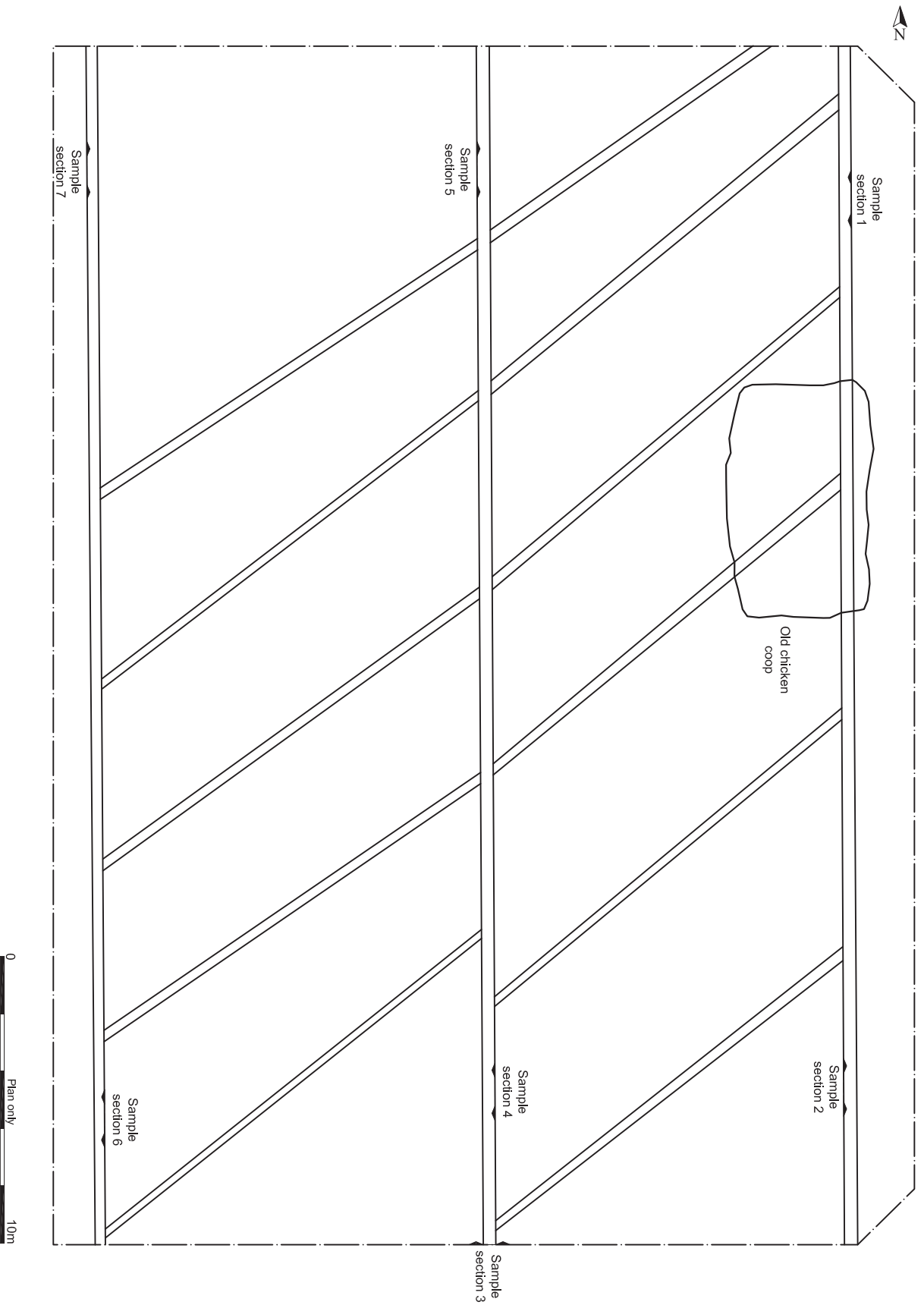

Archaeological Solutions Ltd

Fig. 4 Site plan

Scale 1:200 at A4

Ashwell End Farm, Love Lane, Hertfordshire (P7839)

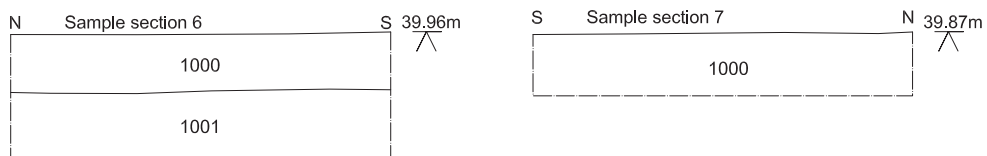
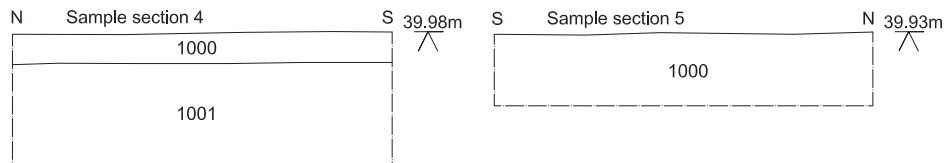
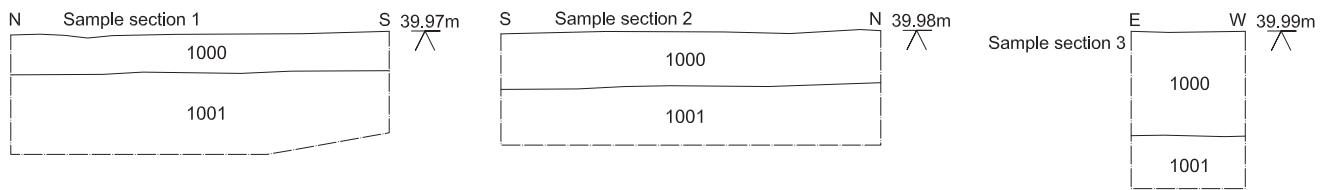

0 Sections only 1m

Archaeological Solutions Ltd
Fig. 5 Sample sections
 Scale 1:20 at A4
 Ashwell End Farm, Love Lane, Hertfordshire (P7839)