

ARCHAEOLOGICAL SOLUTIONS LTD

**3 HOLLY BUSH CLOSE, SEVENOAKS, KENT
TN13 3XW**

**ARCHAEOLOGICAL OBSERVATION,
INVESTIGATION, RECORDING,
ANALYSIS AND PUBLICATION**

Authors: Andy Newton (Fieldwork & report)	
NGR: TQ 53400 55400	Report No. 5680
District: Kent	Site Code: AS 1968
Approved: Claire Halpin MCIfA	Project No. 6735
	Date: 19 November 2018

This report is confidential to the client. Archaeological Solutions Ltd accepts no responsibility or liability to any third party to whom this report, or any part of it, is made known. Any such party relies upon this report entirely at their own risk. No part of this report may be reproduced by any means without permission.

CONTENTS

PROJECT SUMMARY SHEET

SUMMARY

- 1 INTRODUCTION***
- 2 TOPOGRAPHY, GEOLOGY & SOILS***
- 3 ARCHAEOLOGICAL & HISTORICAL BACKGROUND***
- 4 METHOD OF WORK***
- 5 DESCRIPTION OF RESULTS***
- 6 CONFIDENCE RATING***
- 7 DISCUSSION***
- 8 ARCHIVE DEPOSITION***

ACKNOWLEDGEMENTS

BIBLIOGRAPHY

PROJECT SUMMARY SHEET

Project details			
Project name	<i>3 Holly Bush Close, Sevenoaks, Kent TN13 3XW</i>		
<p><i>In May 2017, Archaeological Solutions Ltd (AS) carried out a programme of archaeological monitoring and recording at 3 Holly Bush Close, Sevenoaks, Kent (NGR TQ 53400 55400; Figs. 1 - 2). The monitoring was undertaken in compliance with a planning condition attached to planning approval for the construction of a dwelling (Sevenoaks Planning Ref. SE/13/02654/HOUSE), based on the advice of the Heritage Conservation Group, Kent County Council.</i></p> <p><i>The monitoring revealed a probable root hollow. No archaeological finds or features were present.</i></p>			
Project dates (fieldwork)	<i>4th May 2017</i>		
Previous work (Y/N/?)	<i>N</i>	Future work (Y/N/?)	<i>N</i>
P. number	<i>P6735</i>	Site code	<i>AS 1968</i>
Type of project	<i>Archaeological Monitoring</i>		
Site status	<i>-</i>		
Current land use	<i>Dwelling and garden</i>		
Planned development	<i>Residential dwelling</i>		
Main features (+dates)	<i>-</i>		
Significant finds (+dates)	<i>-</i>		
Project location			
County/ District/ Parish	<i>Kent</i>	<i>Sevenoaks</i>	<i>Sevenoaks</i>
HER/ SMR for area	<i>Heritage Conservation Group, Kent County Council</i>		
Post code (if known)	<i>TN13 3XW</i>		
Area of site	<i>-</i>		
NGR	<i>TQ 53400 55400</i>		
Height AOD (max/ min)	<i>c.124m AOD</i>		
Project creators			
Brief issued by	<i>HCG KCC</i>		
Project supervisor/s (PO)	<i>Archaeological Solutions Ltd.</i>		
Funded by	<i>Mr & Mrs Elder</i>		
Full title	<i>3 Holly Bush Close, Sevenoaks, Kent. Archaeological Observation, Investigation, Recording, Analysis, and Publication.</i>		
Authors	<i>Newton, A.</i>		
Report no.	<i>5680</i>		
Date (of report)	<i>November 2018</i>		

**3 HOLLY BUSH CLOSE, SEVENOAKS, KENT
TN13 3XW**

**ARCHAEOLOGICAL OBSERVATION, INVESTIGATION,
RECORDING, ANALYSIS AND PUBLICATION**

SUMMARY

In May 2017, Archaeological Solutions Ltd (AS) carried out a programme of archaeological monitoring and recording at 3 Holly Bush Close, Sevenoaks, Kent (NGR TQ 53400 55400. Figs. 1 - 2). The monitoring was undertaken in compliance with a planning condition attached to planning approval for the construction of a dwelling (Sevenoaks Planning Ref. SE/13/02654/HOUSE), based on the advice of the Heritage Conservation Group, Kent County Council.

The monitoring revealed a probable root hollow. No archaeological finds or features were present.

1 INTRODUCTION

1.1 In May 2017, Archaeological Solutions Ltd (AS) carried out a programme of archaeological monitoring and recording at 3 Holly Bush Close, Sevenoaks, Kent (NGR TQ 53400 55400; Figs. 1 - 2). The monitoring was undertaken in compliance with a planning condition attached to planning approval for the construction of a dwelling (Sevenoaks Planning Ref. SE/13/02654/HOUSE), based on the advice of the Heritage Conservation Group, Kent County Council.

1.2 The programme of archaeological monitoring and recording was carried out in accordance with the requirements of a specification (Heritage Conservation Group, Kent County Council), and the Chartered Institute for Archaeologists' (CIfA) *Standard and Guidance for Archaeological Watching Briefs* (2014).

1.3 The project objectives were to identify and record any features of interest that were exposed during groundworks for the proposed development. The archaeological monitoring was to determine and understand the nature, function and character of an archaeological site in its cultural and environmental setting.

Planning policy context

1.4 The National Planning Policy Framework (NPPF 2012) states that those parts of the historic environment that have significance because of their historic, archaeological, architectural or artistic interest are heritage assets. The NPPF aims to deliver sustainable development by ensuring that policies and decisions that concern the historic environment recognise that heritage assets are a non-renewable resource, take account of the wider social, cultural, economic and environmental benefits of heritage conservation, and recognise that intelligently managed change may sometimes be necessary if heritage assets are to be maintained for the long term. The NPPF requires applications to describe the significance of any heritage asset, including its setting that may be affected in proportion to the asset's importance and the potential impact of the proposal.

1.5 The NPPF aims to conserve England's heritage assets in a manner appropriate to their significance, with substantial harm to designated heritage assets (i.e. listed buildings, scheduled monuments) only permitted in exceptional circumstances when the public benefit of a proposal outweighs the conservation of the asset. The effect of proposals on non-designated heritage assets must be balanced against the scale of loss and significance of the asset, but non-designated heritage assets of demonstrably equivalent significance may be considered subject to the same policies as those that are designated. The NPPF states that opportunities to capture evidence from the historic environment, to record and advance the understanding of heritage assets and to make this publicly available is a requirement of development management. This opportunity should be taken in a manner proportionate to the significance of a heritage asset and to impact of the proposal, particularly where a heritage asset is to be lost.

2 TOPOGRAPHY, GEOLOGY AND SOILS

2.1 Sevenoaks is located at the southern end of the Darent valley, at the point where the River Darent cuts through the North Downs, and is set in a broad vale at the foot of the slope of the Downs. The River Darent flows on a south to north alignment 3.5km to the west-north-west, while former gravel extraction pits are situated at the northern extent of Sevenoaks.

2.2 Sevenoaks and the surrounding area are located upon a solid geology of Folkestone Formation Beds, which dominate the North Downs (BGS 2015; DBC 2004).

3 ARCHAEOLOGICAL AND HISTORICAL BACKGROUND

Prehistoric

3.1 Although Sevenoaks is located in a relatively prominent location at the southern end of the Darent valley and at the foot of the slope of the North Downs, evidence for early exploitation of the area is sparse (Ashbee 2005; Williams 2007). Early occupation was likely concentrated along the course of the River Darent to the north-west, although there is evidence for a Mesolithic to Bronze Age occupation floor located to the south-west within Knole Park (HER TQ 55 NW 33). The discovery of polished flint axes, tanged arrowheads and other implements found from 1926 onwards immediately below the modern turf in Knole Park indicate the early occupation site. A Bronze Age arrowhead has also been recorded c.150m to the north-west on Bethal Road (HER TQ 55 NW 93).

Romano-British

3.2 In the Romano-British period, the River Darent may have been the focus for trade and settlement, with a significant Roman villa at Lullingstone and further villas and farmsteads known along the valley (Williams & Brown 1999).

Saxon and medieval

3.3 Very little is known about the Saxon occupation in the area surrounding Sevenoaks and no Anglo-Saxon remains are recorded in the vicinity, although the Church of St Nicholas may have Saxon origins (KCC 2004). Place-name evidence reveals that Sevenoaks derives from the Old English words *seofon* and *ac*, meaning the '*place by seven oak trees*' (Glover 1976), whilst there is no mention of Sevenoaks in Domesday (Morris 1983). The manor and settlement of Sevenoaks is first recorded as *Seouenaca* in a document dating to the 1120s (Mills 1993).

Post-medieval and later

3.4 Sevenoaks owed its prosperity to its location at the junction of two important routes, namely the London to Hastings coastal route, and the road leading to the Thames estuary at Dartford. Until the early 20th century, the site remained as agricultural land to the north of the extent of urban Sevenoaks. It was adjacent to the north-east of the Grade II Listed Vine House, which was built in the 18th century, with a cricket ground and pleasure grounds to the south-east (HER TQ 55 NW 199, TQ 55 NW 326 & TQ 55 NW 204). Knole Park, including Plymouth Lodge was situated slightly further to the south (HER TQ 55 NW 187); while a small farmstead or outfarm with a loose courtyard plan appears to have been situated close to the modern junction within Hollybush Close (HER MKE83728).

4 METHODOLOGY Figs. 2 - 3

4.1 The monitoring and recording encompassed the ground works associated with the ground reduction and excavation of the footings for the new extension.

4.2 The monitoring comprised the observation of the ground works, inspection of subsoil, make-up layers, and natural deposits for archaeological features, the examination of spoil heaps for archaeological finds and the recording of soil profiles. Deposits were recorded by means of *pro forma* recording sheets, drawn to scale and photographed as appropriate.

5 RESULTS Figs. 3 - 5

5.1 Sample sections were recorded:

<i>Sample section 1</i> <i>0.00 = 128.17m AOD</i>		
0.00 – 0.54m	L1000	Topsoil. Friable, mid brown sandy silt.
0.54 – 0.73m	L1001	Subsoil. Friable, dark yellow brown sand.
0.73m+	L1002	Natural deposits. Friable, grey yellow brown sand.

<i>Sample section 2</i> <i>0.00 = 128.18m AOD</i>		
0.00 – 0.93m	L1001	Subsoil. As above.
0.93m+	L1002	Natural deposits. As above.

<i>Sample section 3</i> <i>0.00 = 128.35m AOD</i>		
0.00 – 0.54m	L1001	Subsoil. As above.
0.54 – 0.68m	L1005	Mid grey concrete slab.
0.68m+	L1006	Modern disturbance. Friable, mid and dark brown sandy silt. Contained modern factory-sawn wood.

<i>Sample section 4</i> <i>0.00 = 128.62m AOD</i>		
0.00 – 1.20m	L1007	Made Ground. Friable, pale yellow brown sand with occasional pockets of gravel.
1.20m+	L1002	Natural deposits. As above.

<i>Sample section 5</i> <i>0.00 = 128.18m AOD</i>		
0.00 – 0.73m	L1000	Topsoil. As above.
0.73 – 1.18m	L1008	Layer. Friable, grey green sand.
1.18m+	L1002	Natural deposits. As above.

Description: A probable root hollow was recorded. No archaeological features or finds were present. Modern disturbance, L1006, was evident.

F1003 was a probable root hollow (2.30 x 0.85 x 0.31m). It was sub-circular in plan with irregular sides and an irregular base. Its fill (L1004) was a firm, mid brown sandy silt with occasional pockets of natural sand.

6 CONFIDENCE RATING

6.1 Within the confines of the monitoring, it is not felt that any factors inhibited the recognition of archaeological features and finds. That said, an area of modern disturbance (L1006) was evident.

7 DISCUSSION

7.1 The monitoring revealed a probable root hollow. No archaeological finds or features were present.

8 DEPOSITION OF THE ARCHIVE

Archive records, with an inventory, will be deposited with any donated finds from the site at the local museum, once a facility is available. The archive will be quantified, ordered, indexed, cross-referenced and checked for internal consistency. In addition to the overall site summary, it will be necessary to produce a summary of the artefactual and ecofactual data.

ACKNOWLEDGEMENTS

Archaeological Solutions Limited would like to thank Mr & Mrs Elder for funding the project and IQ Consultants for all their assistance.

AS is pleased to acknowledge the advice, assistance and input of Ms Wendy Rogers of Kent County Council.

BIBLIOGRAPHY

Institute of Field Archaeologists (ClfA), 2014. *Standard and Guidance for Archaeological Watching Briefs*. ClfA, Reading

OASIS DATA COLLECTION FORM: England

[List of Projects](#) | [Manage Projects](#) | [Search Projects](#) | [New project](#) | [Change your details](#) | [HER coverage](#) | [Change country](#) | [Log out](#)

Printable version

OASIS ID: archaeol7-334670

Project details

Project name	3 HOLLY BUSH CLOSE, SEVENOAKS, KENT TN13 3XW (WB)
Short description of the project	In May 2017, Archaeological Solutions Ltd (AS) carried out a programme of archaeological monitoring and recording at 3 Holly Bush Close, Sevenoaks, Kent (NGR TQ 53400 55400; Figs. 1 - 2). The monitoring was undertaken in compliance with a planning condition attached to planning approval for the construction of a dwelling (Sevenoaks Planning Ref. SE/13/02654/HOUSE), based on the advice of the Heritage Conservation Group, Kent County Council. The monitoring revealed a probable root hollow. No archaeological finds or features were present.
Project dates	Start: 04-05-2017 End: 30-05-2017
Previous/future work	No / No
Any associated project reference codes	P6735 - Contracting Unit No.
Any associated project reference codes	AS1968 - Sitecode
Type of project	Recording project
Site status	Area of Archaeological Importance (AAI)
Current Land use	Other 15 - Other
Monument type	NONE None
Significant Finds	NONE None
Investigation type	"Watching Brief"
Prompt	Planning condition

Project location

Country	England
Site location	KENT SEVENOAKS SEVENOAKS 3 Holly Bush Close, Sevenoaks, Kent
Postcode	TN13 3XW
Study area	0 Square metres
Site coordinates	TQ 53400 55400 51.276529080569 0.199560548368 51 16 35 N 000 11 58 E Point
Height OD / Depth	Min: 124m Max: 124m

Project creators

Name of Organisation	Archaeological Solutions Ltd
Project brief originator	n/a
Project design originator	Jon Murray
Project director/manager	Jon Murray
Project supervisor	Archaeological Solutions
Type of sponsor/funding body	Mr and Mrs Elder
Name of sponsor/funding body	Mr & Mrs Elder

Project archives

Physical Archive Exists?	No
Digital Archive recipient	Unknown
Digital Contents	"none"
Digital Media available	"Database", "Images raster / digital photography", "Spreadsheets", "Text"
Paper Archive recipient	Unknown
Paper Contents	"none"
Paper Media available	"Context sheet", "Drawing", "Map", "Photograph", "Plan", "Report", "Section", "Survey "

Project bibliography 1

Publication type	Grey literature (unpublished document/manuscript)
Title	Holly Bush Close, Sevenoaks, Kent. Archaeological Observation, Investigation, Recording, Analysis, and Publication.
Author(s)/Editor(s)	Newton, A
Other bibliographic details	5680
Date	2018
Issuer or publisher	Archaeological Solutions Ltd
Place of issue or publication	Bury St Edmunds
Entered by	Hollie Wesson (admin@ascontract.co.uk)
Entered on	23 November 2018

Please e-mail [Historic England](#) for OASIS help and advice

© ADS 1996-2012 Created by [Jo Gilham and Jen Mitcham](#), email Last modified Wednesday 9 May 2012

Cite only: <http://www.oasis.ac.uk/form/print.cfm> for this page

[Cookies](#) [Privacy Policy](#)

PHOTOGRAPHIC INDEX (P6735)



1
General site overview looking south



2
General site overview looking north-west



3
Commencement of works looking west



4
Pit F1003 looking north



5
L1006 looking south-east



6
Sample Section 1 looking south-west



7
Sample Section 2 looking south-east



8
Sample Section 3 looking north-west



9
Sample Section 4 looking south-west



10
Sample Section 5 looking south-east

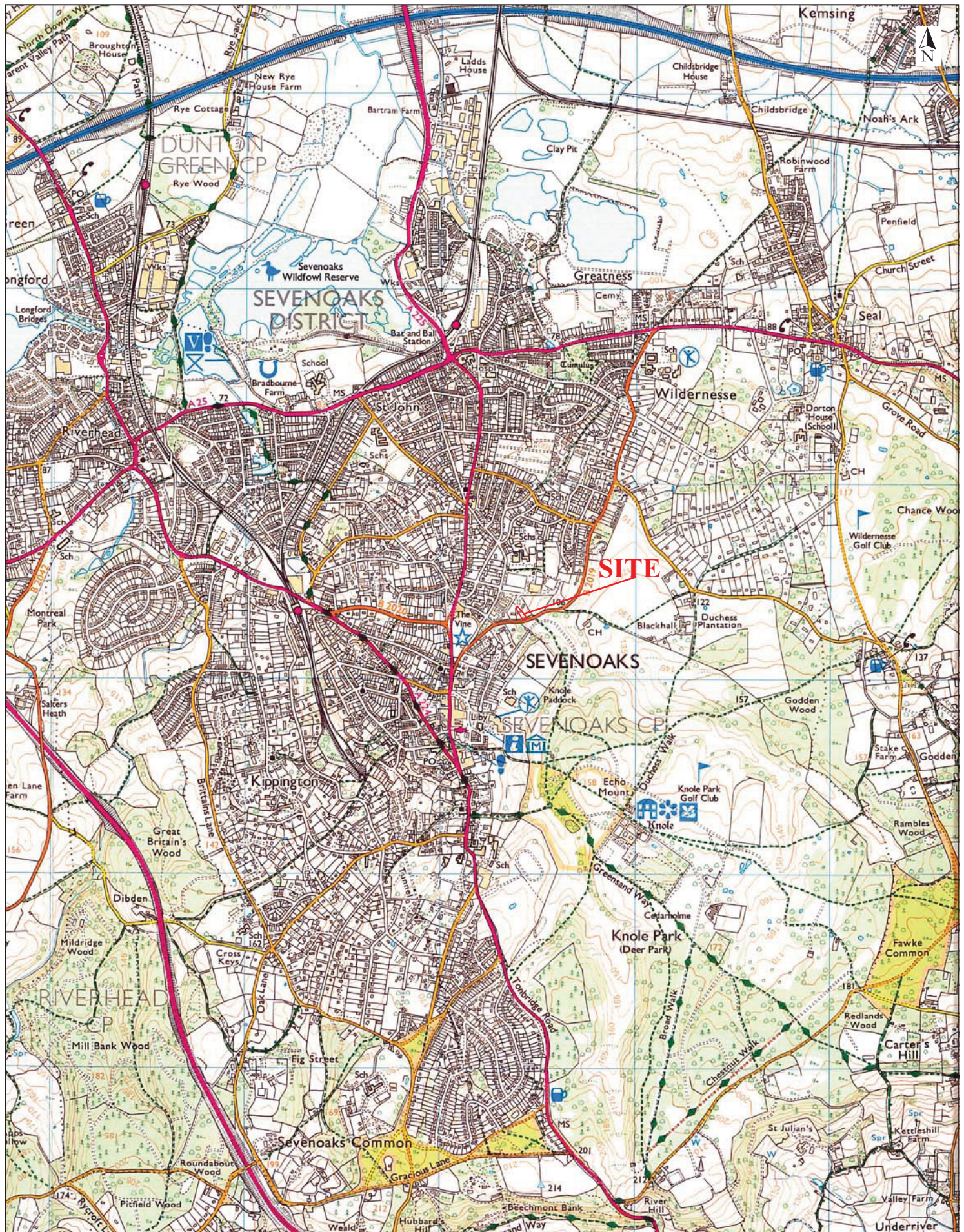

Reproduced from the 2007 Ordnance Survey 1:25000 map with the permission of Her Majesty's Stationery Office. © Crown copyright
Archaeological Solutions Ltd
Licence number 100036680

Archaeological Solutions Ltd

Fig. 1 Site location plan

Scale 1:25,000 at A4

3 Hollybush Close, Sevenoaks, Kent (P6735)

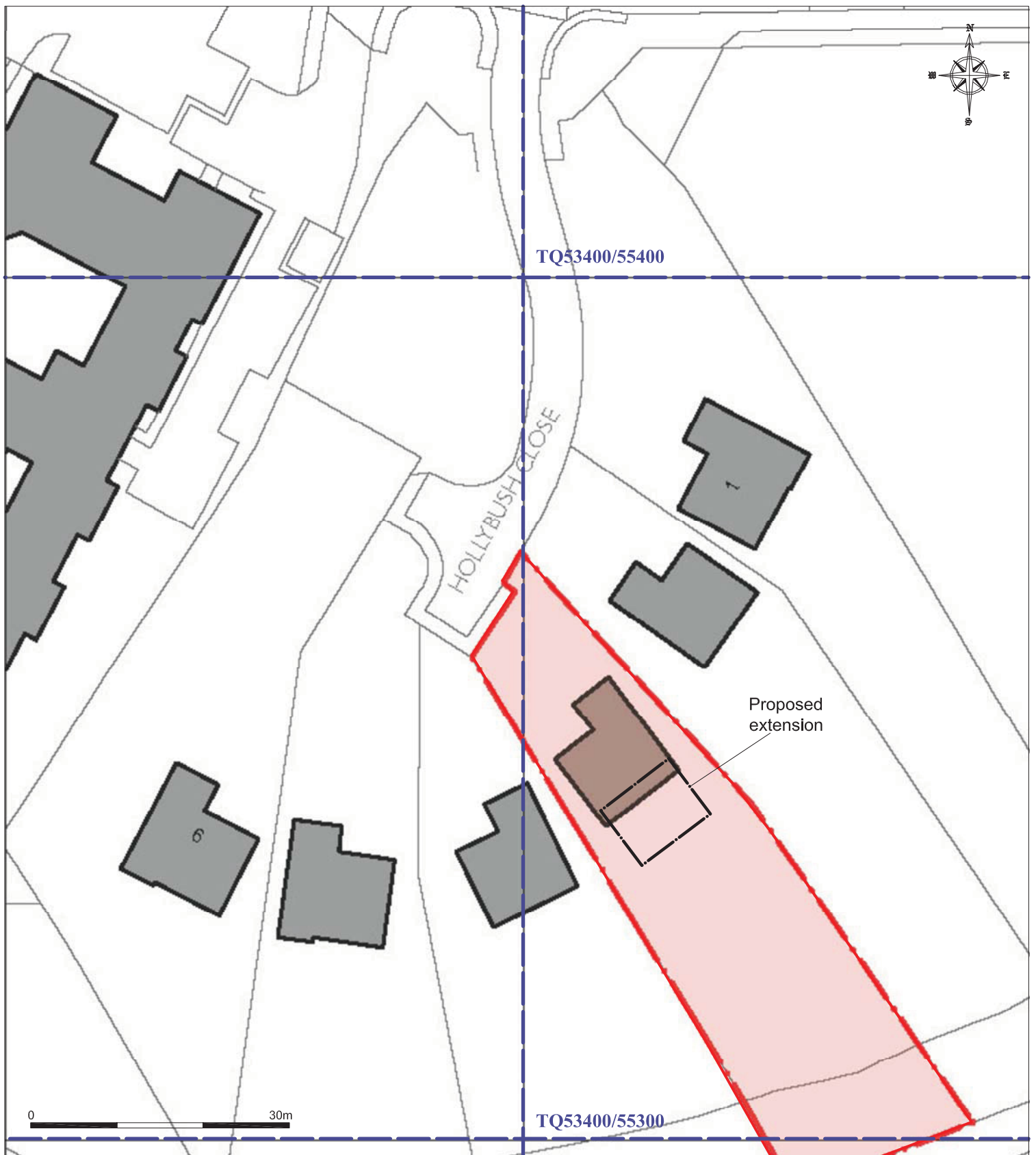

<i>Archaeological Solutions Ltd</i>
Fig. 2 Detailed site location plan
Scale 1:600 at A4
3 Hollybush Close, Sevenoaks, Kent (P6735)

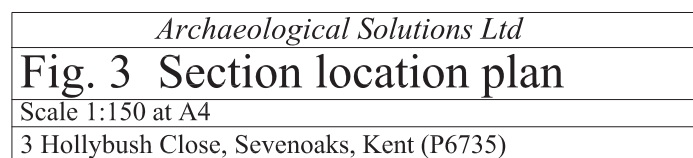

3 Hollybush Close, Sevenoaks, Kent (P6735)

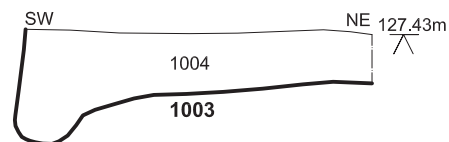
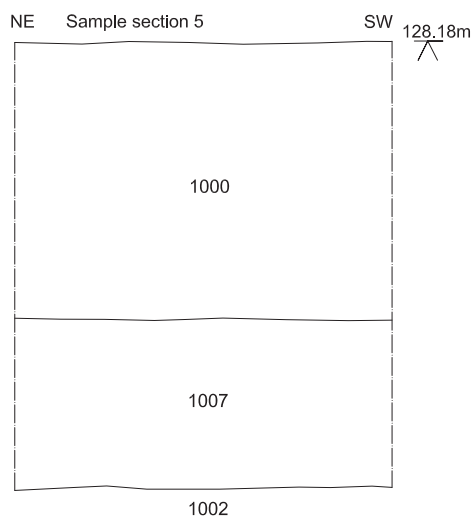
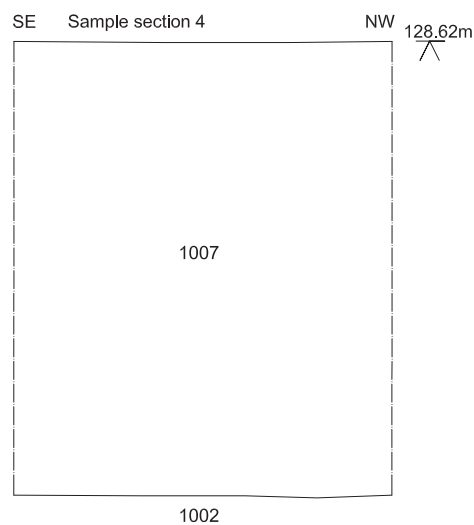
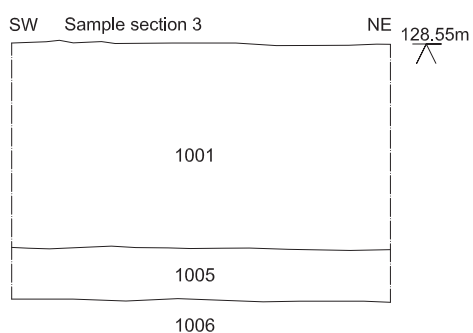
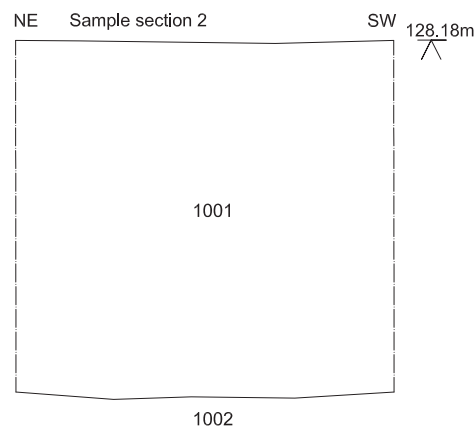
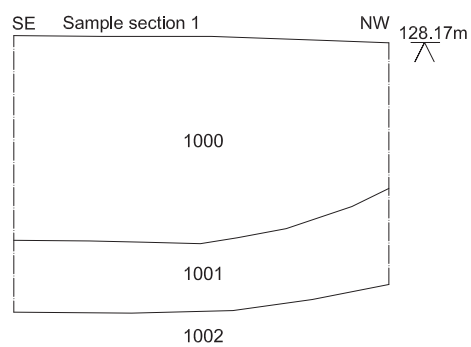

0 Sections only 1m

<i>Archaeological Solutions Ltd</i>
Fig. 4 Sections
Scale 1:20 at A4
3 Hollybush Close, Sevenoaks, Kent (P6735)