

**LAND AT SANDHILL CLOSE, MILLBROOK,  
BEDFORDSHIRE**

**ARCHAEOLOGICAL TRIAL TRENCH EVALUATION**

*HER Search No. 201819/63*

|   |   |
|---|---|
| Authors: Joseph Locke (Fieldwork and report)<br>Kate Higgs (Background research)<br>Liam Podbury (Report) |   |
| NGR: TL 01495 38885   | Report No: 5830                           |
| District: Central Beds  | Site Code: AS1996                         |
| Approved: Claire Halpin MCIfA   | Project No: 7663                          |
|   | Date: 13 May 2019;<br>Revised 17 May 2019 |

This report is confidential to the client. Archaeological Solutions Ltd accepts no responsibility or liability to any third party to whom this report, or any part of it, is made known. Any such party relies upon this report entirely at their own risk. No part of this report may be reproduced by any means without permission.

Archaeological Solutions is an independent archaeological contractor providing the services which satisfy all archaeological requirements of planning applications, including:

*Desk-based assessments and environmental impact assessments*  
*Historic building recording and appraisals*  
*Trial trench evaluations*  
*Geophysical surveys*  
*Archaeological monitoring and recording*  
*Archaeological excavations*  
*Post excavation analysis*  
*Promotion and outreach*  
*Specialist analysis*

**ARCHAEOLOGICAL SOLUTIONS LTD**

**PI House, 23 Clifton Road, Shefford,  
Bedfordshire SG17 5AF  
01462 850483**

**Unit 6, Brunel Business Court, Eastern Way,  
Bury St Edmunds IP32 7AJ  
01284 765210**

**e-mail [info@ascontracts.co.uk](mailto:info@ascontracts.co.uk)  
[www.archaeologicalsolutions.co.uk](http://www.archaeologicalsolutions.co.uk)**



[twitter.com/ArchaeologicalS](https://twitter.com/ArchaeologicalS)



[www.facebook.com/ArchaeologicalSolutions](https://www.facebook.com/ArchaeologicalSolutions)



## **CONTENTS**

### **PROJECT SUMMARY**

#### **SUMMARY**

- 1 INTRODUCTION**
  - 2 DESCRIPTION OF THE SITE**
  - 3 TOPOGRAPHY, GEOLOGY AND SOILS**
  - 4 ARCHAEOLOGICAL & HISTORICAL BACKGROUND**
  - 5 PREVIOUS SITE INVESTIGATION**
  - 6 METHODOLOGY**
  - 7 RESULTS**
  - 8 CONFIDENCE RATING**
  - 9 DISCUSSION**
- ACKNOWLEDGEMENTS**  
**BIBLIOGRAPHY**

| <b>Project details</b>  |  |                     |                  |
|---|--|---------------------|------------------|
| Project name  | <i>Land at Sandhill Close, Millbrook, Bedfordshire</i>                               |                     |                  |
| <p><i>In May 2019 Archaeological Solutions Ltd (AS) carried out a programme of archaeological investigation of land at Sandhill Close, Millbrook, Bedfordshire (NGR TL 01495 38885; Figs. 1 - 2). The investigation was undertaken in compliance with the initial requirement of a planning condition (3) attached to outline planning approval for the erection of six dwellings (Central Bedfordshire Council (CBC) Planning Reference CB/18/04040/FULL). It was based on the requirements of the Central Bedfordshire Council Archaeologists (CBC).</i></p> <p><i>Trench 1 on the western side of the site contained a possible pit, F1005, which was undated. Trench 2 in the centre of the site contained no features. Five parallel furrows were recorded on the eastern side of the site (Trench 3), orientated NE/SW. A possible sixth furrow, F1013, was orientated E/W. A small post hole was also present in Trench 3 (F1011) and it contained a fragment of CBM of 19<sup>th</sup> or 20<sup>th</sup> century date.</i></p> |  |                     |                  |
| Project dates (fieldwork)   | <i>7<sup>th</sup> May 2019</i>   |                     |                  |
| Previous work (Y/N/?)   | <i>N</i>   | Future work         | <i>TBC</i>       |
| P. number   | <i>7663</i>  | Site code           | <i>AS1996</i>    |
| Type of project   | <i>Archaeological evaluation</i>   |                     |                  |
| Site status   | <i>Conservation Area and within medieval village extent (HER16996)</i>               |                     |                  |
| Current land use  | <i>Woodland</i>  |                     |                  |
| Planned development   | <i>Residential Development</i>   |                     |                  |
| Main features (+dates)  | <i>Furrows</i>   |                     |                  |
| Significant finds (+dates)  | <i>-</i>   |                     |                  |
| <b>Project location</b>   |  |                     |                  |
| County/ District/ Parish  | <i>Bedfordshire</i>  | <i>Central Beds</i> | <i>Millbrook</i> |
| HER/ SMR for area   | <i>Central Bedfordshire Historic Environment Record (HER Search No. 201819/63))</i>  |                     |                  |
| Post code (if known)  | <i>n/a</i>   |                     |                  |
| Area of site  | <i>c. 3,200m<sup>2</sup></i>   |                     |                  |
| NGR   | <i>TL 01495 38885</i>  |                     |                  |
| Height AOD (min/max)  | <i>c. 85m AOD</i>  |                     |                  |
| <b>Project creators</b>   |  |                     |                  |
| Brief issued by   | <i>n/a</i>   |                     |                  |
| Project supervisor/s (PO)   | <i>Archaeological Solutions Ltd</i>  |                     |                  |
| Funded by   | <i>Landcrest Developments Ltd</i>  |                     |                  |
| Full title  | <i>Land at Sandhill Close, Millbrook, Bedfordshire. An Archaeological Evaluation</i> |                     |                  |
| Authors   | <i>Locke, J., &amp; Podbury, L.</i>  |                     |                  |
| Report no.  | <i>5830</i>  |                     |                  |
| Date (of report)  | <i>May 2019</i>  |                     |                  |

# LAND AT SANDHILL CLOSE, MILLBROOK, BEDFORDSHIRE ARCHAEOLOGICAL TRIAL TRENCH EVALUATION

## SUMMARY

*In May 2019 Archaeological Solutions Ltd (AS) carried out a programme of archaeological investigation of land at Sandhill Close, Millbrook, Bedfordshire (NGR TL 01495 38885; Figs. 1 - 2). The investigation was undertaken in compliance with the initial requirement of a planning condition (3) attached to outline planning approval for the erection of six dwellings (Central Bedfordshire Council (CBC) Planning Reference CB/18/04040/FULL). It was based on the requirements of the Central Bedfordshire Council Archaeologists (CBC).*

*The settlement of Millbrook has its origins in the medieval period (HER 16996). The site lies at the northern extent of the medieval village of Millbrook (HER 16996), and within Millbrook's Conservation Area. Thomas Jeffreys' map of Bedfordshire, which dates to 1765 (Fig. 4) suggests a building lay within the site, but this is not supported by subsequent cartographic sources. Throughout the early modern and modern periods, the site is depicted on historic mapping as land associated with the farmhouse to the immediate east, and from 1901 onwards with allotment gardens extending further south and south-westwards.*

*Trench 1 on the western side of the site contained a possible pit, F1005, which was undated. Trench 2 in the centre of the site contained no features. Five parallel furrows were recorded on the eastern side of the site (Trench 3), orientated NE/SW. A possible sixth furrow, F1013, was orientated E/W. A small post hole was also present in Trench 3 (F1011) and it contained a fragment of CBM of 19<sup>th</sup> or 20<sup>th</sup> century date.*

## 1 INTRODUCTION

1.1 In May 2019, Archaeological Solutions Ltd (AS) carried out a programme of archaeological investigation of land at Sandhill Close, Millbrook, Bedfordshire (NGR TL 01495 38885; Figs. 1 - 2). The investigation was undertaken in compliance with the initial requirement of a planning condition (3) attached to outline planning approval for the erection of six dwellings (Central Bedfordshire Council (CBC) Planning Reference CB/18/04040/FULL). It was based on the requirements of the Central Bedfordshire Council Archaeologists (CBC).

1.2 The evaluation was undertaken in accordance with a brief prepared by CBC, *Brief of a Scheme of Archaeological Investigation, Recording, Analysis and Publication*, Land South of Sandhill Close, Millbrook, Bedfordshire (dated 11 February 2019), and a Written Scheme of Investigation prepared by AS (dated 22<sup>nd</sup> February 2019) and approved by CBC. It followed the procedures outlined in the Chartered Institute for Archaeologists' *Standard and Guidance for Archaeological Evaluation* (2014). It also adhered to the relevant sections of *Standards for Field Archaeology in the East of England* (Gurney 2003).

1.3 The general aims and objectives for the investigation included:

- to determine the location, extent, nature and date of any archaeological features or deposits that may be present;
- to provide information on the integrity and state of preservation of any archaeological features or deposits that may be present;
- to recover any palaeoenvironmental remains to determine local environmental conditions; and
- to relate any remains found to the surrounding contemporary Landscapes.

#### *Research potential*

1.4 The research potential of the site comprises:

- The main research potential of the site relates to its proximity to the historic medieval settlement core (and potential Saxon extent) of Millbrook. Oake *et al* (2007, 14) emphasise the need for further research into the medieval rural settlements of Bedfordshire, both in terms of investigating the chronology, structure, and function of individual settlements and in terms of looking at broader patterns of medieval settlement. The location of this site suggests the possibility that its northern and central parts may contain information regarding the form and character of medieval settlement in Millbrook.
- The evaluation also has the potential to shed further light on the character of later prehistoric and / or Roman settlement, land use and funerary use of this part of the Greensand Ridge.
- Post-medieval building remains may also be encountered, given the presence of such structures on the site on historic cartographic sources. Any such evidence that may be encountered within the current site would have the potential to provide information relating to the function of the site and the broader development of settlement at Millbrook or to the agriculturally-based industries for which Bedfordshire became known (Oake *et al* 2007, 16), and any such structures should be properly recorded (Medlycott 2011, 79).

#### *Planning Policy Context*

1.5 The National Planning Policy Framework (NPPF 2018) states that those parts of the historic environment that have significance because of their historic, archaeological, architectural or artistic interest are heritage assets. The NPPF aims to deliver sustainable development by ensuring that policies and decisions that concern the historic environment recognise that heritage assets are a non-renewable resource, take account of the wider social, cultural, economic and environmental benefits of heritage conservation, and recognise that intelligently managed change may sometimes be necessary if heritage assets are to be maintained for the long term. The NPPF requires applications to describe the significance of any heritage asset, including its

setting that may be affected in proportion to the asset's importance and the potential impact of the proposal.

1.6 The NPPF aims to conserve England's heritage assets in a manner appropriate to their significance, with substantial harm to designated heritage assets (i.e. listed buildings, scheduled monuments) only permitted in exceptional circumstances when the public benefit of a proposal outweighs the conservation of the asset. The effect of proposals on non-designated heritage assets must be balanced against the scale of loss and significance of the asset, but non-designated heritage assets of demonstrably equivalent significance may be considered subject to the same policies as those that are designated. The NPPF states that opportunities to capture evidence from the historic environment, to record and advance the understanding of heritage assets and to make this publicly available is a requirement of development management. This opportunity should be taken in a manner proportionate to the significance of a heritage asset and to impact of the proposal, particularly where a heritage asset is to be lost.

## **2 DESCRIPTION OF THE SITE**

2.1 The site is located within the village and parish of Millbrook, which is situated within the district of Central Bedfordshire and the county of Bedfordshire (Fig. 1). The site lies at the northern extent of the village of Millbrook, specifically along the southern frontage of Sandhill Close. It also lies within Millbrook's Conservation Area (HER DBD3400; CBC 2009).

2.2 The site comprises a roughly rectangular plot of land covering an area of c. 3,200m<sup>2</sup> (Fig. 2). It lies along the southern frontage of Sandhill Close, close to its junction with Russell Grove. To the immediate west of the site is No. 12 Sandhill Close and its associated rear garden, while to the immediate east are Nos. 1 and 2 Russell Grove. To the south of the site is woodland.

## **3 TOPOGRAPHY, GEOLOGY AND SOILS**

3.1 The village of Millbrook lies along the spur of the Greensand Ridge, which runs south-west to north-eastwards through this section of Bedfordshire (Fig. 1). To the north of the ridge lies the lower-lying Marston Vale. The area surrounding the site thus has a varied and undulating landscape dominated by the Greensand Ridge, the spur of which is dominated by Millbrook's Church of St Michael.

3.2 Small watercourses punctuate the wider area and drain northwards towards the River Great Ouse, although the Marston Vale to the north of Millbrook is dominated by a series of large, former gravel pit lakes, which constitute Marston Vale Millennium County Park. The site lies on the northern spur at 85m AOD, with the surrounding relief declining rapidly to the north. The solid geology of the Millbrook area comprises Oxford Clay of the Jurassic period, which are overlain by sandstone and sands of the Lower Greensand

Group (BGS 2015). The soils of the site comprise those of the Frilford Association, which are described as deep, well drained, sandy and coarse loamy soils (SSEW 1983).

## **4 ARCHAEOLOGICAL AND HISTORICAL BACKGROUND**

4.1 Evidence of earlier activity in the Iron Age and Roman periods has been recorded in the wider area around Millbrook, such as at Rookery Pit, Stewartby (CHER 19806) and Marston Park, Marston Moretaine (CBHER 15321). Saxon activity has also been recorded recently on the crest of the Greensand Ridge at Amphill Park to the east (CBHER 18265).

4.2 The site lies in the core of the historic medieval (or earlier) settlement of Millbrook, recorded at Domesday and with likely origins in the late Saxon period (CBHER 16996). At the time of the Domesday survey it was held by the D'Albini family who also held the barony of Cainhoe. The main manor was subdivided in the 15<sup>th</sup> century and subsequently attached to the Honour of Amphill, until documentary sources record no manorial seat in the parish by 1649. The location of the main medieval manorial site remains unknown, but there were several lesser manors and lands were also held by a number of the main regional religious houses. A cell belonging to Beaulieu Priory and later gifted to St Albans Abbey was established in the parish in the 11<sup>th</sup> century, though its location is unknown.

4.3 Millbrook was granted a fair and market earlier in the medieval period indicating it was of moderate size, but mid 14<sup>th</sup> century documentary references suggest village contraction, as was not uncommon during this period. The medieval church of St Michael lies c.360m to the south west of the proposed development site (CBHER 923; NHLE 1113934), with 13<sup>th</sup> century origins, 14<sup>th</sup> and 15<sup>th</sup> century additions and Victorian re-working. It's original rectory lay to the west. No further medieval buildings survive within the village, but the parish hall some 340m to the south west dates to the 17<sup>th</sup> century (CBHER 3756). The site of a mill has been identified 550m to the north-north-west of the site on the basis of place-name evidence and traces of a diverted stream at Millbrook (CBHER 2798). The possible site of a windmill is judged to lie only 120m to the south-west (CBHER 3163). Lower Farm, which stands 150m to the north-east incorporates a possible field system indicated by cropmarks (CBHER 14743) and the findspot of a 13th/14th century harness pendant (CBHER 18488). Further south-westwards, an evaluation at Warren Wood revealed a medieval rabbit warren (CBHER 10042).

4.4 Millbrook remained a relatively small, nucleated settlement throughout the post-medieval period, overshadowed undoubtedly by its larger neighbour of Amphill. Historic cartographic sources show a Cattle Pound to the north east of the proposed development site and 18<sup>th</sup> century mapping suggests the presence of a structure within the proposed development site boundaries at this time (Fig. 4).



## 5 PREVIOUS INVESTIGATION

5.1 An archaeological desk-based assessment has been undertaken (Higgs, 2018), in summary:

*Based on the known archaeology the site is located in an area of relatively limited archaeological potential. It has only a low potential for archaeological remains dating from the prehistoric, Roman, Saxon and post-medieval periods, and a low to moderate potential for medieval archaeology. The early occupation of the Millbrook area remains relatively unknown, particularly given the paucity of previous archaeological investigation undertaken in the village and the limited number of prehistoric findspots, with only three Mesolithic remains, which are sited further eastwards, recorded.*

*The settlement of Millbrook has its origins in the medieval period (HER 16996). The site lies at the northern extent of the medieval village of Millbrook (HER 16996), and within Millbrook's Conservation Area. Thomas Jeffreys' map of Bedfordshire, which dates to 1765 suggests a building lay within the site, but this is not supported by subsequent cartographic sources. Throughout the early modern and modern periods, the site is depicted on historic mapping as land associated with the farmhouse to the immediate east, and from 1901 onwards with allotment gardens extending further south and south-westwards.*

*Previous ground disturbance at the site is judged to be moderate and will be limited to agricultural activity and its use as allotment gardens. The proposed development will have a significant impact on any archaeological remains, if present.*

## 6 METHODOLOGY

6.1 CBC required a programme of archaeological trial trenching comprising three trenches each 25m x 1.8m width (Fig. 2)

6.2 The archaeological evaluation comprised the inspection of the subsoil and natural deposits for archaeological features, the examination of spoil heaps and the recording of soil profiles. Encountered features and deposits were cleaned by hand and recorded using *pro forma* recording sheets, drawn to scale and photographed as appropriate.

6.3 Open trenches and excavated spoil were manually / visually searched and scanned by metal detector to enhance the recovery of archaeological finds.

## 7 DESCRIPTION OF RESULTS Figs. 2 - 3

7.1 The individual trench descriptions are presented below:

### Trench 1

|                                     |       |   |
|-------------------------------------|-------|---|
| Sample Section<br>0.00 = 86.35m AOD |       |   |
| 0.00 – 0.25m                        | L1000 | Topsoil. Friable, dark grey brown/black sandy clayey silt with occasional small-medium rounded, sub-rounded and angular flints and gravels. |
| 0.25 – 0.30m                        | L1001 | Subsoil. Compact, mid grey brown silty sand with rare small and medium angular flints.  |
| 0.30m+                              | L1002 | Natural Clay. Compact, light-mid brown grey clay with rare small degraded chalk flecks.   |

*Description: Trench 1 contained undated Pit F1005.*

Pit F1005 was irregular in plan (1.35m+ x 1.20m x 0.09m). It had shallow gently sloping sides and a flattish base. Its fill, L1006, was a compact, mid grey brown silty clay with occasional small angular flints. It contained no finds.

### Trench 2 Fig. 2

|                                     |       |                        |
|-------------------------------------|-------|------------------------|
| Sample Section<br>0.00 = 85.78m AOD |       |                        |
| 0.00 – 0.27m                        | L1000 | Topsoil. As above.     |
| 0.27 – 0.32m                        | L1001 | Subsoil. As above.     |
| 0.32m+                              | L1002 | Natural Clay. As above |

*Description: Trench 2 contained no archaeological features or finds.*

### Trench 3 Figs. 2 - 3

|   |       |  |
|---|-------|--|
| Sample Section 3A<br>0.00 = 85.52m AOD<br>South-west Facing |       |  |
| 0.00 – 0.25m  | L1003 | Re-deposited Topsoil. Friable, dark grey brown/black sandy clayey silt with occasional small-medium rounded, sub-rounded and angular flints and gravels. |
| 0.25 – 0.29m  | L1004 | Made Ground. Friable, mid brown yellow silty/clayey sand with occasional small and medium brick and tile.  |
| 0.29 – 0.40m  | L1000 | Topsoil. As above.   |
| 0.40 – 0.60m  | L1001 | Subsoil. As above.   |
| 0.60m+  | L1002 | Natural Clay. As above   |

|   |       |                        |
|---|-------|------------------------|
| Sample Section 3B<br>0.00 = 85.64m AOD<br>North-west Facing |       |                        |
| 0.00 – 0.25m  | L1000 | Topsoil. As above.     |
| 0.25 – 0.30m  | L1001 | Subsoil. As above.     |
| 0.30m+  | L1002 | Natural Clay. As above |

*Description: Trench 3 contained six furrows of which four were excavated (F1007, F1009, F1013 and F1020), and Post Hole F1011. The majority of the furrows were orientated NE/SW and evenly spaced. Furrow F1013 was orientated E/W. The furrows contained no finds, and the post hole contained a fragment of CBM of 19<sup>th</sup> or 20<sup>th</sup> century date. The natural was test pitted to ensure its definition.*

Furrow F1007 was linear in plan (1.80m+ x 1.60m x 0.24m), orientated NE/SW. It had moderately sloping sides and a flattish base. Its fill, L1008, was a compact, mid yellow brown silty clay with occasional small angular flints. It contained no finds.

Furrow F1009 was linear in plan (1.80m+ x 1.90m x 0.20m), orientated NE/SW. It had moderately sloping sides and an irregular base. Its fill, L1010, was a compact, mid yellow brown silty clay with occasional small angular flints. It contained no finds.

Post Hole F1011 was sub-circular in plan (0.30m x 0.28m x 0.12m). It had steep sides and a flattish base. Its fill, L1012, was a compact, mid-dark grey brown silty clay with occasional small angular flints. It contained a fragment of CBM of 19<sup>th</sup> or 20<sup>th</sup> century date.

Furrow F1013 was linear in plan (1.80m+ x 0.90m+ x 0.14m), orientated E/W. It had gently sloping sides and a flattish base. Its fill, L1014, was a compact, mid yellow brown silty clay with occasional small angular flints. It contained no finds.

Furrow F1020 was linear in plan (1.80m+ x 1.45m+ x 0.17m), orientated E/W. It had a flattish base. Its fill, L1021, was a compact, pale yellow brown silty clay with occasional small angular flints. It contained no finds.

## **8 CONFIDENCE RATING**

8.1 It is not felt that any factors significantly inhibited the recognition of archaeological features or finds.

## 9 DISCUSSION

### 9.1 The recorded features are tabulated

| Trench | Context | Description | Date                                       |
|--------|---------|-------------|--|
| 1      | F1005   | Pit         | -  |
| 3      | F1007   | Furrow      | -  |
|        | F1009   | Furrow      | -  |
|        | F1011   | Post Hole   | 19 <sup>th</sup> or 20 <sup>th</sup> C CBM |
|        | F1013   | Furrow      | -  |
|        | F1016   | Furrow      | -  |
|        | F1018   | Furrow      | -  |
|        | F1020   | Furrow      | -  |

9.2 The settlement of Millbrook has its origins in the medieval period (HER 16996). The site lies at the northern extent of the medieval village of Millbrook (HER 16996), and within Millbrook's Conservation Area. Thomas Jeffreys' map of Bedfordshire, which dates to 1765 (Fig. 4) suggests a building lay within the site, but this is not supported by subsequent cartographic sources; the omission likely reflects the lack of accuracy or detail on such a source rather than an actual physical discrepancy. Throughout the early modern and modern periods, the site is depicted on historic mapping as land associated with the farmhouse to the immediate east, and from 1901 onwards with allotment gardens extending further south and south-westwards.

9.3 Trench 1 on the western side of the site contained a possible pit, F1005, which was undated. Trench 2 in the centre of the site contained no features. Five parallel furrows were recorded on the eastern side of the site (Trench 3), orientated NE/SW. A possible sixth furrow, F1013, was orientated E/W. The alignment of these furrows does not correspond with any of the historic field boundaries of the large field that contains the site, but does correspond with several long field boundaries in the local area that are depicted on the early edition Ordnance Survey maps (Fig. 5) that succeed Jeffrey's map in the late 19<sup>th</sup> century, therefore it seems likely they are a remnant of post-medieval cultivation close to the village core. A small post hole was also present in Trench 3 (F1011) and it contained a fragment of CBM of 19<sup>th</sup> or 20<sup>th</sup> century date. The latter probably represents the incidental inclusion of rubble within the soil used to backfill a fencepost.

### DEPOSITION OF THE ARCHIVE

Archive records, with an inventory, will be deposited with the local museum (Bedford Accession No. BEDFM: 2019.08). The archive will be quantified, ordered, indexed, cross referenced and checked for internal consistency.

## ACKNOWLEDGEMENTS

Archaeological Solutions would like to thank Landcrest Developments for funding the programme of archaeological investigation, recording, analysis and publication, in particular Mr. Peter Barnett.

AS is also pleased to acknowledge the assistance, input and advice of Slawek Utrata, Central Bedfordshire Council Archaeological Officer, and the assistance of the Central Bedfordshire Historic Environment Record.

## BIBLIOGRAPHY

British Geological Survey 1991 *East Anglia Sheet 52°N-00° 1:250,000 Series Quaternary Geology*. Ordnance Survey, Southampton

Central Bedfordshire Council (CBC) 2009 *Millbrook Conservation Area Appraisal Draft*. CBC, Chicksands

Chartered Institute for Archaeologists 2014 *Standard and Guidance for Archaeological Evaluation*, Reading, ClfA

English Heritage, 1991 *Exploring Our Past*. EH, Swindon

Gurney, D. 2003 *Standards for Field Archaeology in the East of England*. East Anglian Archaeology Occasional Paper no. 14

Higgs, K, 2018, *Land at Sandhill Close, Millbrook, Bedfordshire. An Archaeological Desk-Based Assessment/Heritage Statement*, AS Report 5612

Oake M. et al. 2007 *Research and Archaeology: Resource Assessment Research Agenda and Strategy*. Bedfordshire Archaeology Monograph

SSEW 1983 *Soil Survey of England and Wales: Soils of South East England (sheet 4)*. Harpenden, Rothamsted Experimental Station/Lawes Agricultural Trust

SSEW 1983 *Soil Survey of England and Wales: Legend for the 1:250,000 Soil Map of England and Wales* Harpenden, Rothamsted Experimental Station/Lawes Agricultural Trust

# OASIS DATA COLLECTION FORM: England

[List of Projects](#) | [Manage Projects](#) | [Search Projects](#) | [New project](#) | [Change your details](#) | [HER coverage](#) | [Change country](#) | [Log out](#)

## Printable version

**OASIS ID: archaeol7-351233**

### Project details

|  |   |
|--|---|
| Project name                           | Land at Sandhill Close, Millbrook, Bedfordshire (TT)  |
| Short description of the project       | In May 2019 Archaeological Solutions Ltd (AS) carried out a programme of archaeological investigation of land at Sandhill Close, Millbrook, Bedfordshire (NGR TL 01495 38885; Figs. 1 - 2). The investigation was undertaken in compliance with the initial requirement of a planning condition (3) attached to outline planning approval for the erection of six dwellings (Central Bedfordshire Council (CBC) Planning Reference CB/18/04040/FULL). It was based on the requirements of the Central Bedfordshire Council Archaeologists (CBC). Trench 1 on the western side of the site contained a possible pit, F1005, which was undated. Trench 2 in the centre of the site contained no features. Five parallel furrows were recorded on the eastern side of the site (Trench 3), orientated NE/SW. A possible sixth furrow, F1013, was orientated E/W. A small post hole was also present in Trench 3 (F1011) and it contained a fragment of CBM of 19th or 20th century date. |
| Project dates                          | Start: 07-05-2019 End: 08-05-2019   |
| Previous/future work                   | No / Not known  |
| Any associated project reference codes | P7663 - Contracting Unit No.  |
| Any associated project reference codes | AS1996 - Sitecode   |
| Type of project                        | Field evaluation  |
| Site status                            | None  |
| Current Land use                       | Other 15 - Other  |
| Monument type                          | FURROWS Uncertain   |
| Significant Finds                      | NONE None   |
| Methods & techniques                   | "Targeted Trenches"   |
| Development type                       | Urban residential (e.g. flats, houses, etc.)  |
| Prompt                                 | Planning condition  |
| Position in the planning process       | Not known / Not recorded  |

### Project location

|               |   |
|---------------|---|
| Country       | England   |
| Site location | BEDFORDSHIRE MID BEDFORDSHIRE MILLBROOK Land at Sandhill Close, Millbrook, Bedfordshire |

Study area 3200 Square metres  
 Site coordinates TL 01495 38885 52.03863823417 -0.520113532052 52 02 19 N 000 31 12 W Point  
 Height OD / Depth Min: 85m Max: 85m

### Project creators

Name of Organisation Archaeological Solutions Ltd  
 Project brief originator Central Bedfordshire Council  
 Project design originator Jon Murray  
 Project director/manager Jon Murray  
 Project supervisor Archaeological Solutions Ltd  
 Name of sponsor/funding body Landcrest Developments Ltd

### Project archives

Physical Archive Exists? No  
 Digital Archive recipient Unknown  
 Digital Contents "none"  
 Digital Media available "Database","Images raster / digital photography","Spreadsheets","Text"  
 Paper Archive recipient Unknown  
 Paper Contents "none"  
 Paper Media available "Context sheet","Drawing","Map","Photograph","Plan","Report","Section","Survey "

### Project bibliography 1

Publication type Grey literature (unpublished document/manuscript)  
 Title Land at Sandhill Close, Millbrook, Bedfordshire. An Archaeological Evaluation  
 Author(s)/Editor(s) Locke, J  
 Author(s)/Editor(s) Podbury, L  
 Other bibliographic details 5830  
 Date 2019  
 Issuer or publisher Archaeological Solutions  
 Place of issue or publication Bury St Edmunds  
 Entered by Hollie Wesson (admin@ascontract.co.uk)  
 Entered on 17 May 2019

# OASIS:

Please e-mail [Historic England](#) for OASIS help and advice

© ADS 1996-2012 Created by [Jo Gilham and Jen Mitcham, email](#) Last modified Wednesday 9 May 2012

Cite only: <http://www.oasis.ac.uk/form/print.cfm> for this page

[Cookies](#) [Privacy Policy](#)



PHOTOGRAPHIC INDEX (P7663)



1  
Trench 1 looking west



2  
Sample section 1 looking south



3  
Pit F1005 in Trench 1 looking north



4  
Trench 2 looking south



5  
Trench 3 looking north-west



6  
Sample section 3A looking north-east



7  
Sample section 3B looking south-west



8  
Furrow F1007 in Trench 3 looking south-west



9  
Furrow F1009 in Trench 3 looking south-west



10  
Post Hole F1011 in Trench 3 looking north-west



11  
Furrow F1013 in Trench 3 looking north-east



12  
Furrow F1020 in Trench 3 looking south-west

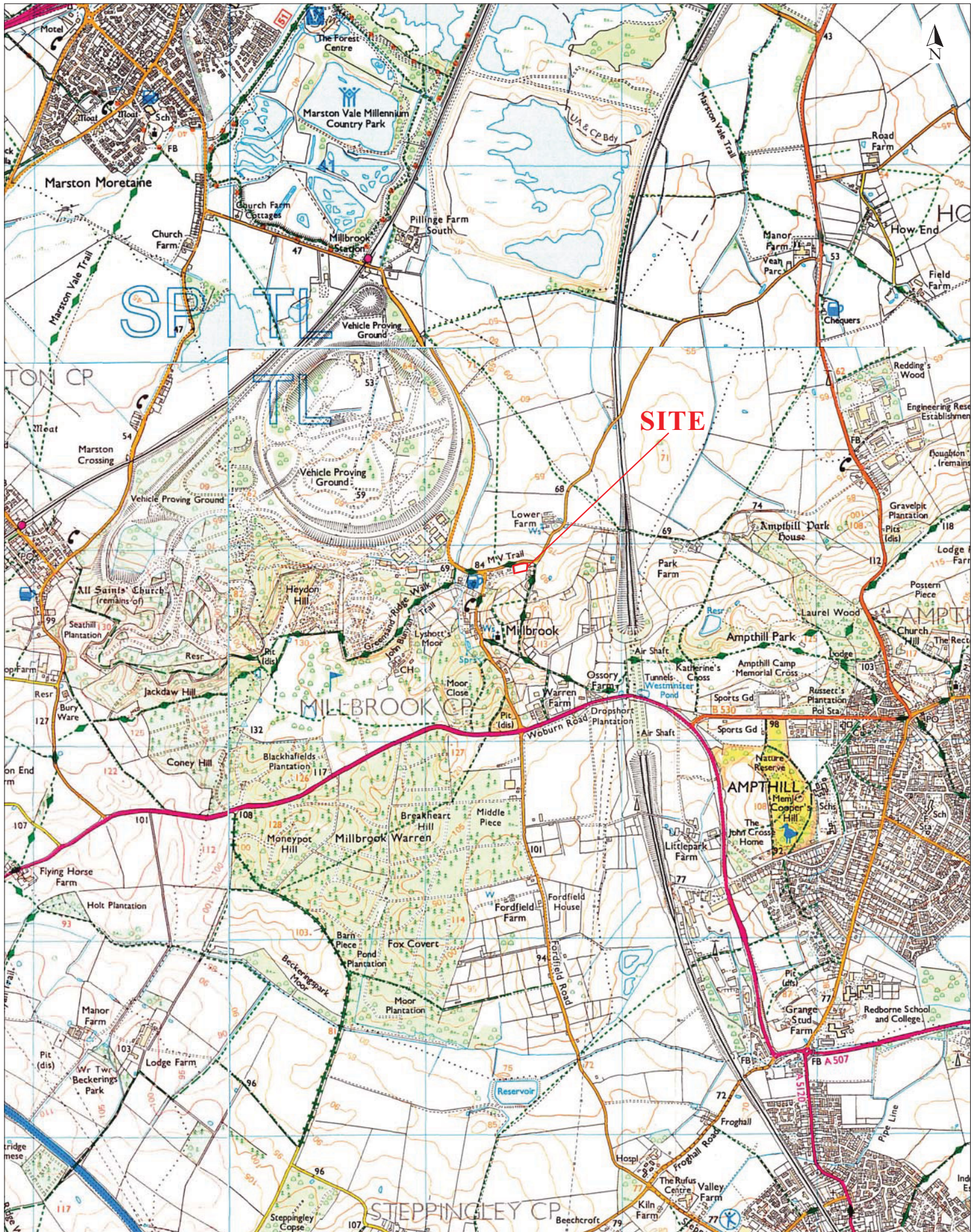

Reproduced from the 2009 Ordnance Survey 1:25000 map with the permission of Her Majesty's Stationery Office. © Crown copyright Archaeological Solutions Ltd Licence number 100036680

Archaeological Solutions Ltd  
**Fig. 1 Site location plan**  
 Scale 1:25,000 at A4  
 Sandhill Close, Millbrook, Bedfordshire (P7663)

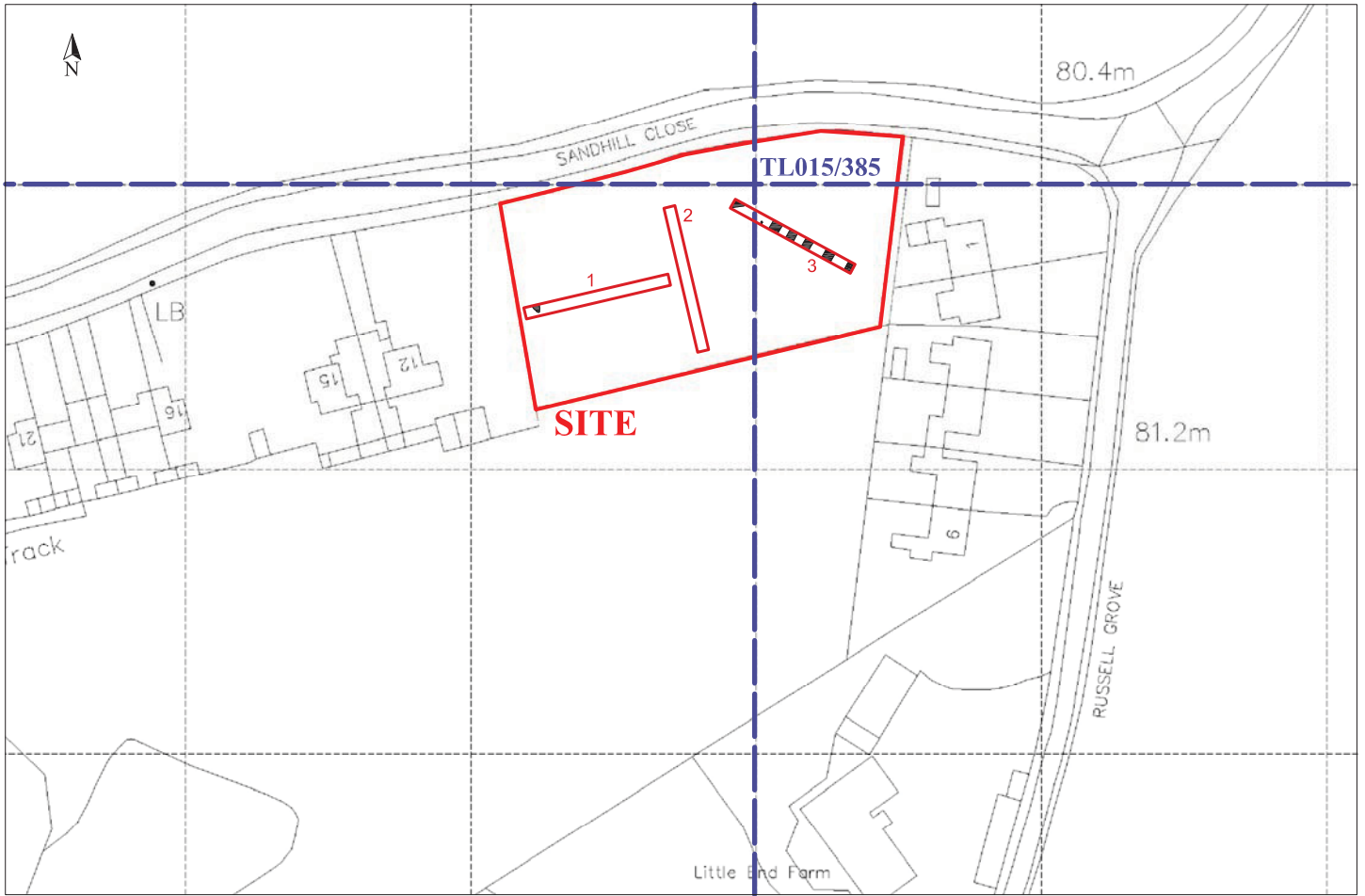

Contains Ordnance Survey data ©  
 Crown copyright and database right [2008]



|   |
|---|
| <i>Archaeological Solutions Ltd</i>             |
| <b>Fig. 2 Detailed site location plan</b>       |
| Scale 1:1250 at A4                              |
| Sandhill Close, Millbrook, Bedfordshire (P7663) |

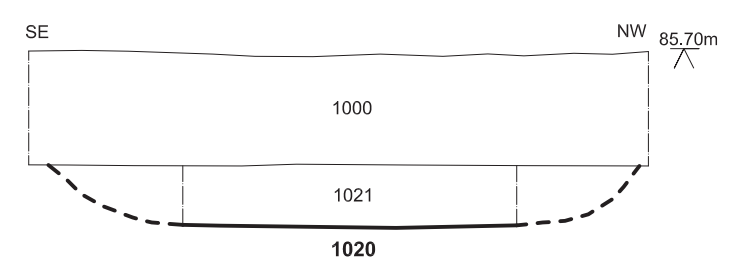
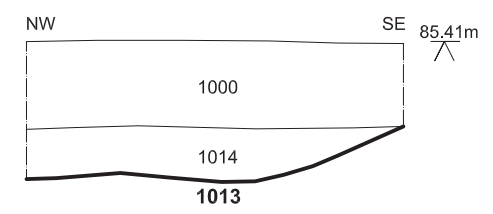
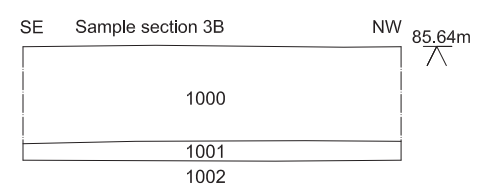
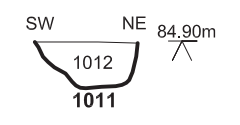
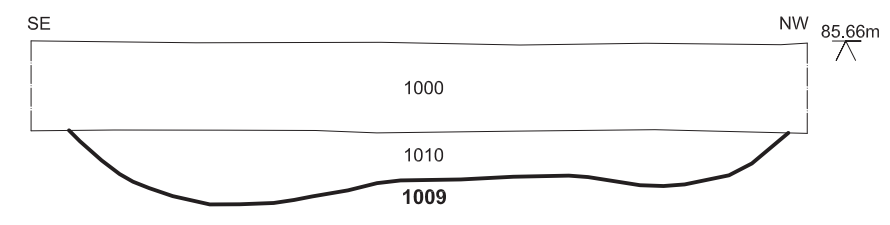
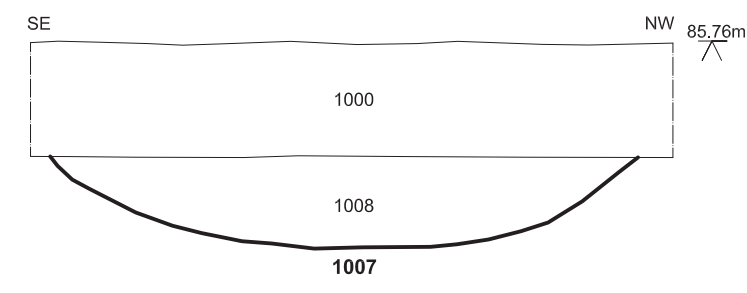
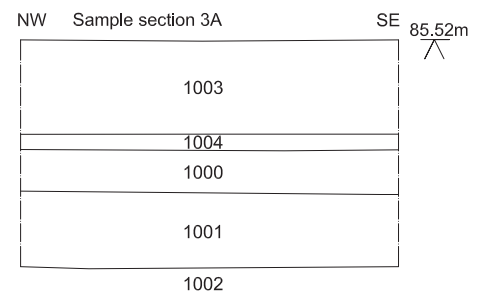
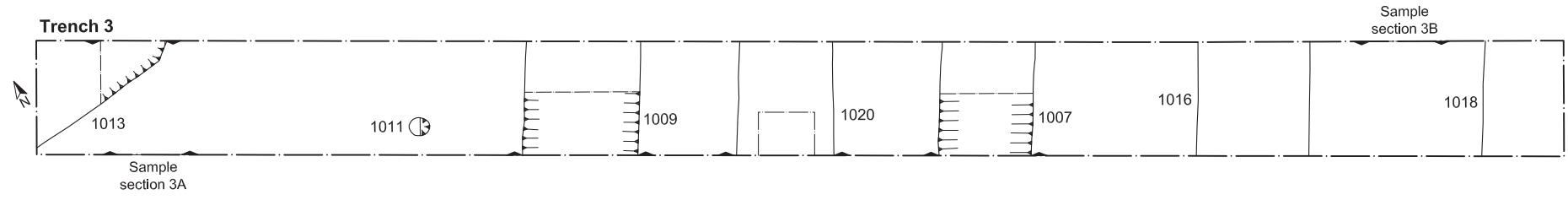
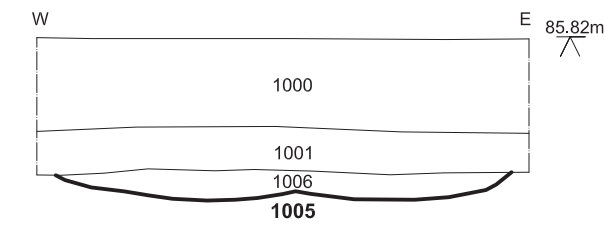
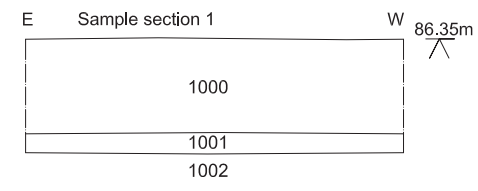
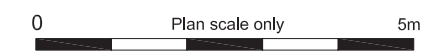
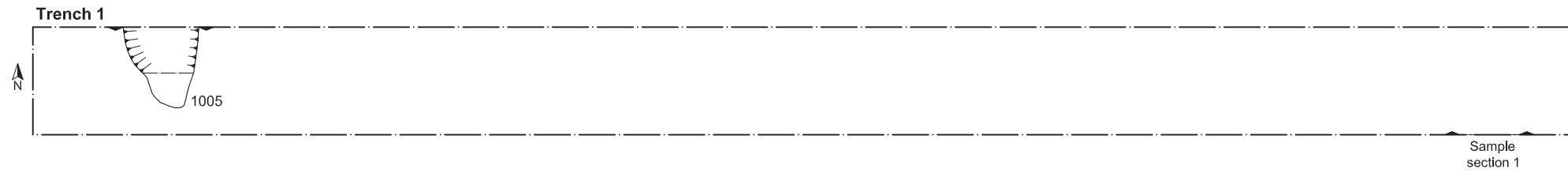

Archaeological Solutions Ltd  
**Fig. 3 Plans and sections**  
 Scale Plans 1:100, sections 1:20 at A3  
 Sandhill Close, Millbrook, Bedfordshire (P7663)

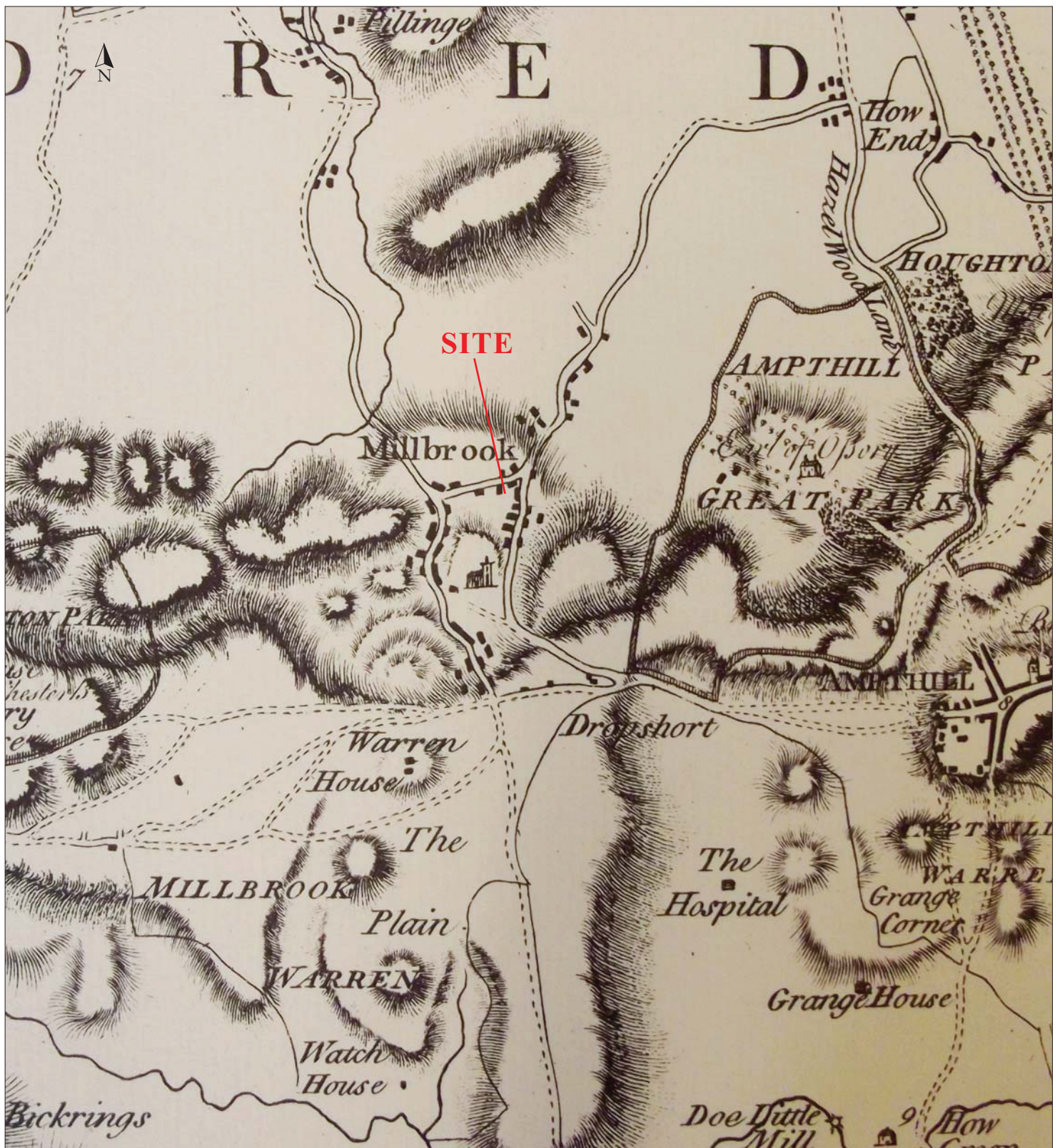

Archaeological Solutions Ltd  
Fig. 4 Jeffreys' map, 1765  
Not to scale  
Sandhill Close, Millbrook, Bedfordshire (P7663)

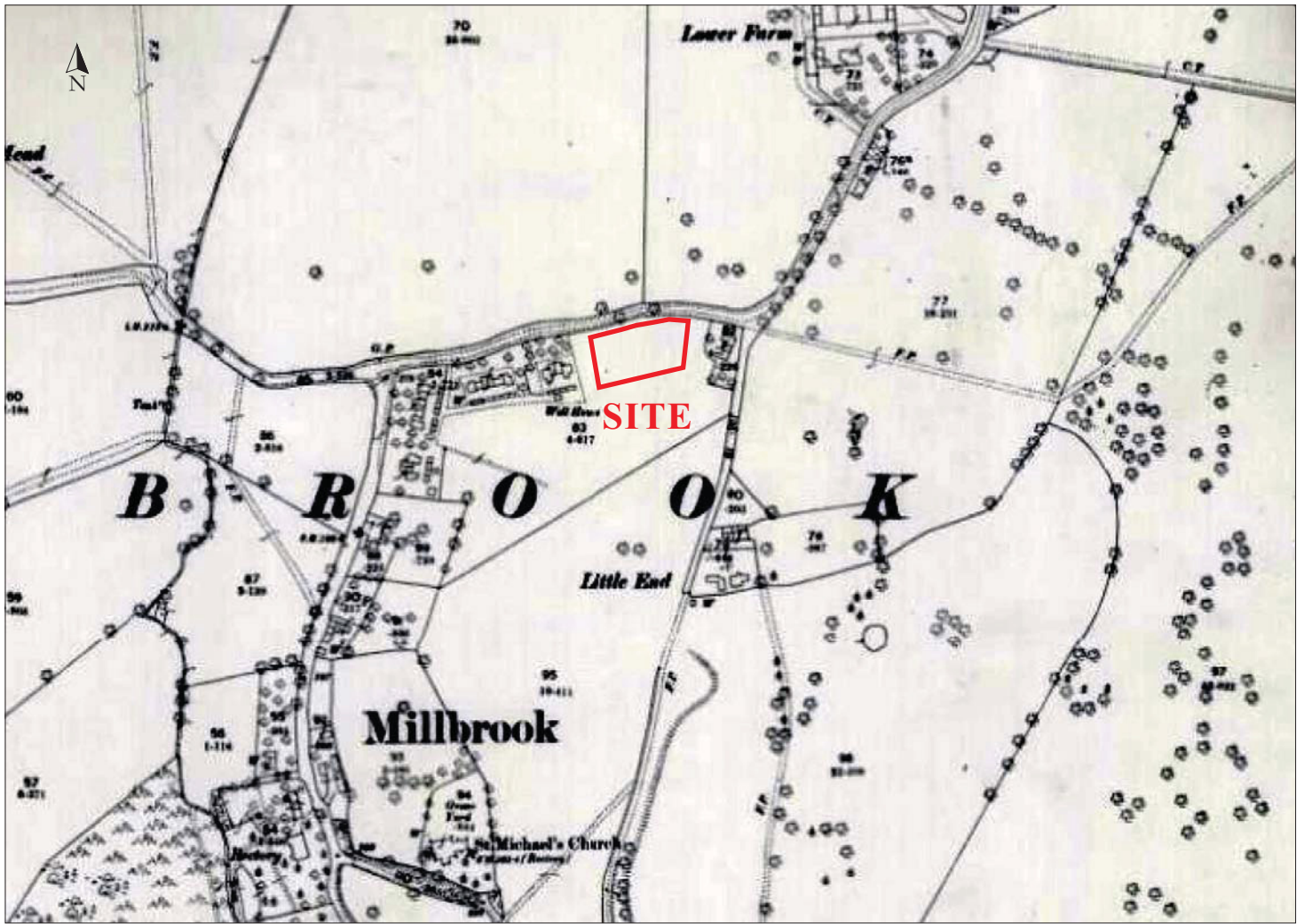

|   |
|---|
| <i>Archaeological Solutions Ltd</i>             |
| <b>Fig. 5 OS map, 1883</b>                      |
| Not to scale                                    |
| Sandhill Close, Millbrook, Bedfordshire (P7663) |