

---

**ARCHAEOLOGICAL SOLUTIONS LTD**

**LAND ADJACENT TO 33 GUNTON CHURCH LANE,  
LOWESTOFT, SUFFOLK**

**ARCHAEOLOGICAL MONITORING & RECORDING**

Authors: Paul Harris BA, MA.	
NGR: TM 542 956	Report No. 2904
District; Lowestoft	Site Code: LWT130
Approved: Claire Halpin MIFA	Project No. P2863
Signed:	Date: July 07

*This report is confidential to the client. Archaeological Solutions Ltd accepts no responsibility or liability to any third party to whom this report, or any part of it, is made known. Any such party relies upon this report entirely at their own risk. No part of this report may be reproduced by any means without permission.*

**OASIS SUMMARY**

**SUMMARY**

- 1 INTRODUCTION**
  - 2 SITE DESCRIPTION**
  - 3 ARCHAEOLOGICAL BACKGROUND**
  - 4 METHODOLOGY**
  - 5 RESULTS**
  - 6 CONFIDENCE RATING**
  - 7 DEPOSIT MODEL**
  - 8 DISCUSSION**
  - 9 DEPOSITION OF THE ARCHIVE**
- ACKNOWLEDGEMENTS**
- REFERENCES**

**APPENDICES**

- 1 CONCORDANCE OF FINDS BY FEATURE**
- 2 POTTERY REPORT**

**OASIS SUMMARY SHEET**

<b>Project details</b>			
Project name	<i>Land adjacent to 33 Gunton Church Lane, Lowestoft, Suffolk</i>		
<i>In May and June 2007, Archaeological Solutions Ltd (AS) carried out a programme of archaeological monitoring and recording during the excavation of foundation trenches at the site of a proposed new dwelling on the land adjacent to 33 Gunton Church Lane, Lowestoft, Suffolk (TM 542 956). The monitoring was commissioned by AAK Design Associates in advance of the proposed development. It was undertaken in response to a planning condition imposed by the Suffolk County Council Archaeology Service Conservation team (SCC AS).</i>			
<i>The site is situated on land to the north east of 33 Gunton Church Lane, Lowestoft, Suffolk, approximately 120m to the south of the early medieval church of St. Peter, Gunton and its churchyard (LWT 021) and within 130m of the site of Gunton Hall (LWT 022). Lowestoft lies 2.5km to the south-west of the site.</i>			
<i>Monitoring of the excavation of foundation trenches associated with the construction of a new house on the site was undertaken on 23/05/07 and 24/05/07. An in-filled cellar constructed from breeze blocks, and the low brick wall and concreted floor of a recently demolished garage were the only features uncovered on the site.</i>			
Project dates (fieldwork)	<i>23<sup>rd</sup> &amp; 24<sup>th</sup> May 2007</i>		
Previous work (Y/N/?)	<i>N</i>	Future work (Y/N/?)	<i>N</i>
P. number	<i>2863</i>	Site code	<i>LWT130</i>
Type of project	<i>Watching Brief</i>		
Site status	<i>None</i>		
Current land use	<i>Garden and Boat garage</i>		
Planned development	<i>Dwelling</i>		
Main features (+dates)	<i>Modern cellar S1004, modern garage wall S1007 and concrete floor L1006.</i>		
Significant finds (+dates)	<i>None</i>		
<b>Project location</b>			
County/ District/ Parish	<i>Suffolk</i>	<i>Lowestoft</i>	<i>Gunton</i>
HER/ SMR for area	<i>Suffolk SMR</i>		
Post code (if known)			
Area of site	<i>217m<sup>2</sup></i>		
NGR	<i>TM 542 956</i>		
Height AOD (max/ min)			
<b>Project creators</b>			
Brief issued by	<i>Suffolk County Council, Archaeological Service, Conservation team (SCC ASCT)</i>		
Project supervisor/s (PO)	<i>Paul Harris BA, MA</i>		
Funded by	<i>AAK Design Associates</i>		
<b>Bibliography</b>			
Full title	<i>Land Adjacent to 33 Gunton Church Lane, Lowestoft, Suffolk.</i>		
Authors	<i>Paul Harris MA</i>		
Report no.	<i>2904</i>		
Date (of report)	<i>July 2007</i>		

# LAND ADJACENT TO 33 GUNTON CHURCH LANE, LOWESTOFT, SUFFOLK

## Archaeological Monitoring and Recording

### **SUMMARY**

*In May and June 2007, Archaeological Solutions Ltd (AS) carried out a programme of archaeological monitoring and recording during the excavation of foundation trenches at the site of a proposed new dwelling on the land adjacent to 33 Gunton Church Lane, Lowestoft, Suffolk (TM 542 956) (fig. 1). The monitoring was commissioned by AAK Design Associates in advance of the proposed development. It was undertaken in response to a planning condition imposed by the Suffolk County Council Archaeology Service Conservation team (SCC AS).*

*The site is situated on land to the north east of 33 Gunton Church Lane, Lowestoft, Suffolk, approximately 120m to the south of the early medieval church of St. Peter, Gunton and its churchyard (LWT 021) and within 130m of the site of Gunton Hall (LWT 022). Lowestoft lies 2.5km to the south-west of the site (fig. 1).*

*The monitoring was undertaken during the excavation of foundation trenches associated with the construction of a new house on the site. Site visits were undertaken to monitor and record these works on 23/05/07 and 24/05/07. An in-filled cellar constructed from breeze blocks, and the low brick wall and concreted floor of a recently demolished garage were the only features uncovered on the site*

## **1 INTRODUCTION**

1.1 In May and June 2007, Archaeological Solutions Ltd (AS) carried out a programme of archaeological monitoring and recording during the excavation of foundation trenches at the site of a proposed new dwelling on the land adjacent to 33 Gunton Church Lane, Lowestoft, Suffolk (TM 542 956) (Figs. 1-2). The monitoring was commissioned by AAK Design Associates in advance of the proposed development. It was undertaken in response to a planning condition (Planning Ref. W11671/6) imposed by the Suffolk County Council Archaeology Services Conservation Team (SCC AS).

1.2 The monitoring and recording was undertaken in accordance with a brief issued by SCC AS (R D Carr, 12<sup>th</sup> February 2007) and a specification prepared by AS (dated 13<sup>th</sup> June 2002). The programme of works also complied with the document; Gurney *Standards for Field Archaeology in the East of England* (2003) *EAA Occasional Paper 14*, and the Institute of Field Archaeologists' (IFA) *Standard and Guidance for Archaeological Watching Briefs* (revised 2001).

1.3 The monitoring was undertaken during the excavation of foundation trenches associated with the construction of a new house on the site. Site visits were undertaken to monitor and record these works on 24/05/07 and 16/06/07.

1.4 The objectives of the project were:

- To ensure the archaeological monitoring of all aspects of the development programme likely to affect archaeological remains;
- To secure the adequate recording of any archaeological remains revealed by the development programme;
- To secure the full analysis and interpretation of the site archive and the publication of the project results, if appropriate;
- To secure the conservation and long-term storage of any artefactual/ecofactual material recovered from the site.

## **2 SITE DESCRIPTION**

2.1 The site is situated off land at 33 Gunton Church Lane, approximately 120m to the south of the early medieval church of St. Peter, Gunton and its churchyard (Suffolk Sites and Monuments Ref. LWT 021) and within 130m of the site of Gunton Hall (SSMR Ref. LWT 022). Lowestoft lies 2.5km to the south-west of the site (Fig. 1).

2.2 The excavation comprised an interlinked series of foundation trenches following the outline of the proposed dwelling (Fig. 3). The site was bordered to the south and west by the garage and shed of 33 Gunton Church Lane (Fig. 2).

2.3 The site lies at *c.* 17m AOD on the low lying land characteristic of eastern Suffolk. Lowestoft and the surrounding area lies on a solid geology of Eocene clay. The overlying drift in the area in which the site is located comprises glacial sands and gravels. As an urban area the soils Lowestoft are unsurveyed but the soils of the surrounding area are of the Beccles 1 and Gresham associations which are both loamy over clayey or silty soils. The loamy soils of the Newport 3 association and the loamy over sandstone soils of the Rivington 1 association are, however, more prevalent in the surrounding area (SSEW 1983).

## **3 ARCHAEOLOGICAL BACKGROUND**

3.1 The site is located within the probable core of an early settlement focused within Gunton, characterised by the presence of the early medieval church of St. Peter, Gunton and its churchyard (SSMR Ref. LWT 021) and Gunton Hall (SSMR Ref. LWT022). The principal archaeological potential for the site is for remains associated with medieval activity, though there is a possibility of earlier remains which are important to identify (in particular evidence of Saxon activity).

3.2 Remains from the Saxon and medieval periods are especially significant within the framework of regional research agendas of population distribution and density, settlement character and development and the evolution of land use which are suggested by Wade (Brown & Glazebrook, 2000, 23-26). The close proximity of an early medieval church and medieval hall suggest remains of significance terms of the aforementioned agendas are probable across the site.

## 4 METHODOLOGY

4.1 The archaeological monitoring comprised the observation of all groundworks, inspection of subsoil and natural deposits for archaeological features, the examination of spoil heaps and the recording of soil profiles. Deposits were recorded by means of *pro forma* recording sheets, drawn to scale and photographed as appropriate. Excavated spoil was searched for archaeological finds.

4.2 The monitoring and recording focused on groundworks associated with the excavation of foundation trenches for the new development. Site visits were undertaken to monitor these works on 23/05/07 and 24/05/07.

## 5 RESULTS

5.1 Seven sample sections (Fig 3) were recorded:

Sample Section 1 (Plate 2) Southern corner of site. South-west facing section.	
0.00 – 0.50m	L1000. Topsoil. Dark greyish brown, clayey silty sand.
0.50 – 0.66m	L1005. Subsoil. Mid yellow with mottled white, soft clayey silty sand
0.66m+	L1001. Natural. Light orange brown mottled with patches of light yellow / white, friable sand.

Sample Section 2 (Plate 3) South-west central area of site. South-east facing section	
0.00 – 0.26m	L1000. Topsoil. As above.
0.26 – 0.52m	L1005. Subsoil. As above.
0.52m+	L1001. Natural. As above

Sample Section 3 (Plate 4) Centre of site. North-west facing section.	
0.00 – 0.43m	L1000. Topsoil. As above.
0.43 – 0.65m	L1005. Subsoil. As above.
0.65m+	L1001. Natural. As above.

Sample Section 4 Western corner of site. North-west facing section	
0.00 – 0.48m	L1000. Topsoil. As above.
0.48 – 0.97m+	L1005. Subsoil. As above.

Sample Section 5 Northern corner of site. South-east facing	
0.00 – 0.48m	L1000. Natural. As above.
0.48 – 0.84m	L1002. Subsoil. As above.
0.84m+	L1001. Natural. As above.

Sample Section 6 Eastern corner of site. South-west facing	
0.00 – 0.36m	L1000. Natural. As above.
0.36 – 0.55m	L1002. Subsoil. As above.
0.55m+	L1001. Natural. As above.

Sample Section 7 Centre of South-east site boundary. North-west facing	
0.00 – 0.30m	L1000. Natural. As above.
0.30 – 0.58m	L1002. Subsoil. As above.
0.58m+	L1001. Natural. As above.

5.2 An in-filled modern cellar below an area of concreted surfacing, L1006, was uncovered in the northern area of the site (Fig 3).

5.3 A cellar wall, S1003 (0.56m long x <1.8m deep) composed of dark bluish grey breeze blocks and concrete blocks (700x500x250mm) standing 6 courses tall, within a grey cement bonding material, was revealed. The U-shaped course of S1003 contained a rubble backfill comprising bricks, breeze blocks and plastic material above sheets of plastic bubble wrap at the base. Both Wall S1003 and fill L1002 were located within cellar foundation trench F1004 (0.36 x 0.56 x <1.80m), which was rectangular with vertical sides breaking at 90° to a flat base.

5.4 Surrounding Cellar Wall S1003 was a low brick wall, S1007, which represents the shed wall for a boat garage which previously occupied the site. A concrete slab, L1006, (2 x 2 x 0.2m), which was part of a recent garage floor surface, extended from S1007 to the south east.

## 6 CONFIDENCE RATING

6.1 It is not felt that any factors inhibited the recognition of archaeological features or finds during the program of archaeological monitoring and recording.

## 7 DEPOSIT MODEL

7.1 The stratigraphy of the site consists of a dark greyish brown, clayey silty sand topsoil, L1000, overlying a mid yellow clayey silty sand subsoil, L1005. The latter overlies a light orange brown natural sand L1001. The stratigraphic sequence was the same throughout the site, although towards the west of the site it is notable that the topsoil and subsoil are deeper and that the excavation did not reach the natural.

## 8 DISCUSSION

8.1 No archaeological features were present other than a modern cellar constructed with breeze blocks, S1003, and a surrounding wall (S1007) and concrete floor (L1006) of a

recently demolished garage (Fig. 3). The stratigraphy was undisturbed suggesting that archaeological remains, if present, would have been preserved

## **9 DEPOSITION OF THE ARCHIVE**

9.1 The archive will be deposited with the Suffolk Sites and Monument Record. The archive will be adequately catalogued, labelled and packaged for transfer and storage in accordance with the guidelines set out in the United Kingdom Institute for Conservation's *Conservation Guideline No. 2* and other relevant reference documents. The archive will be quantified, ordered, indexed, cross-referenced and checked for internal consistency. In addition to the overall site summary, it will be necessary to produce a summary of the artefactual and ecofactual data.

## **ACKNOWLEDGEMENTS**

Archaeological Solutions would like to thank AAK Design Associates for commissioning the archaeological monitoring.

Archaeological solutions would also like to thank the Suffolk County Council Archaeological Service Conservation Team, in particular Bob Carr for his input and advice.

## **REFERENCES**

Brown, N & Glazebrook, J (eds.), 2000, *Research and Archaeology: A Framework for the Eastern Counties. 2. Research Agenda and Strategy*, East Anglian Archaeology Occasional Papers 8

Gurney, D, 2003, *Standards for Field Archaeology in the East of England*, East Anglian Archaeology Occasional Paper 14/ALGAO

Institute of Field Archaeologists, 1994 (revised 2001), *Standard and Guidance for Archaeological Watching Briefs*. IFA



## APPENDIX 1

### LWT130: 33 Gunton Church Lane, Lowestoft, Suffolk

Concordance of finds by feature

Feature	Context	Description	Spot Date	Pottery	Other
1007		Garage Wall?			Brick (1) 2545g
1004	1002	Backfill into Cellar?	1780-1850/1900	(1) 30g	Plastic Tube 17g

## APPENDIX 2

### Pottery

Peter Thompson

The evaluation recovered one white earthenware bowl base in Transfer Printed ware with Chinese style decoration dated c.1780-1850/1900.

## PLATES



Plate 1 Site, view west (DP 1)

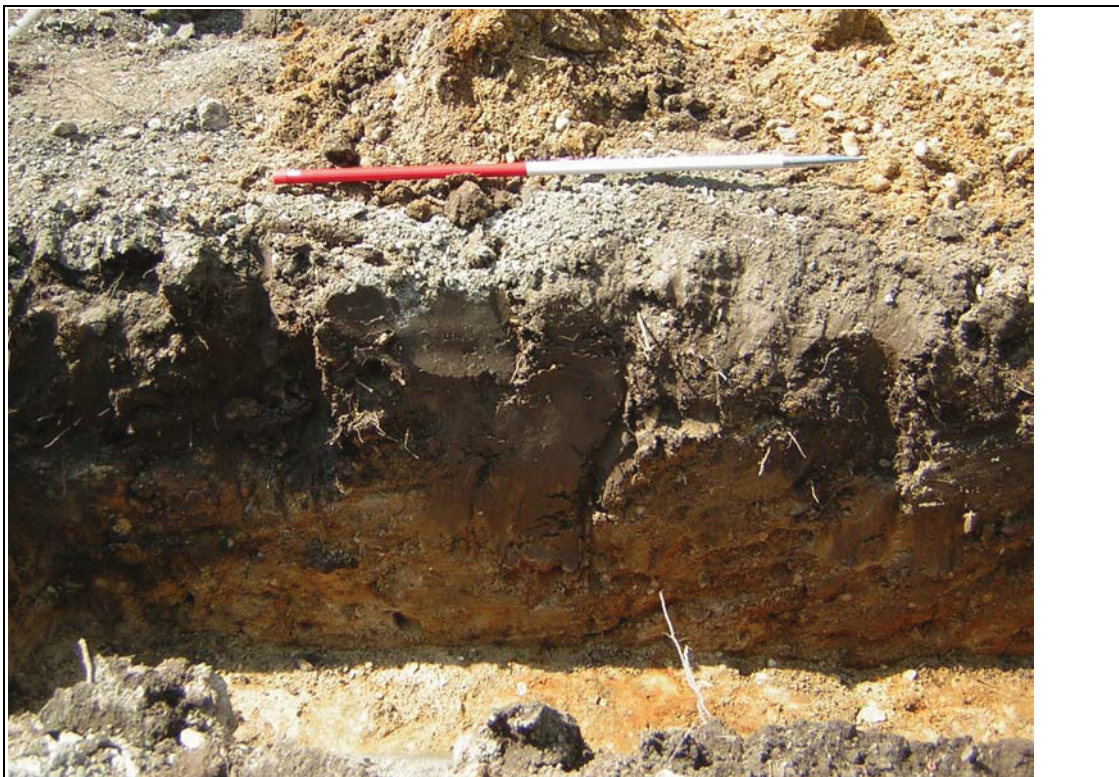

Plate 2 Sample section 1, North-east facing section (DP 2)



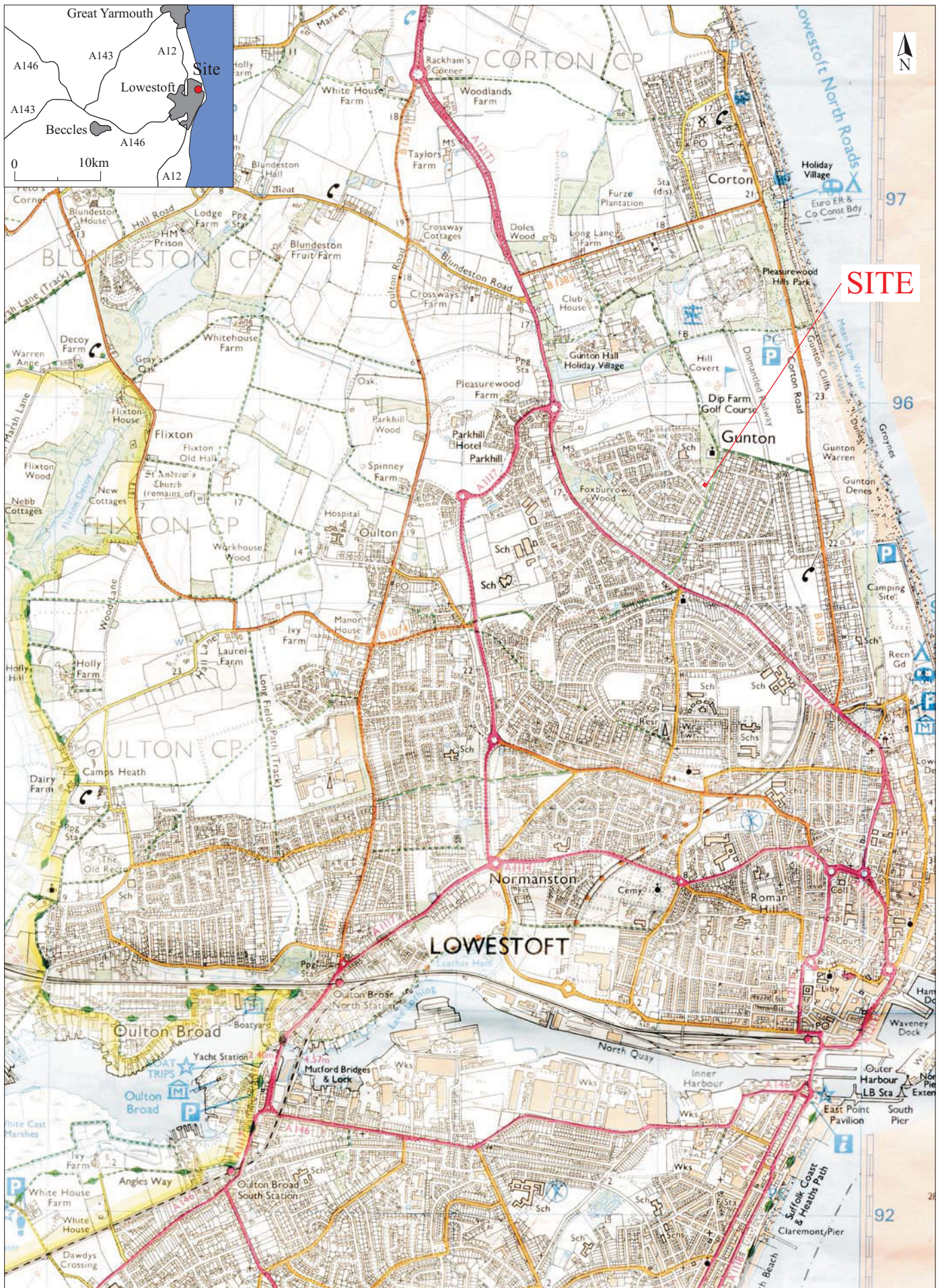

Plate 3 Sample section 2, South-east facing section (DP 3)



Plate 4 Sample section 3, North-west facing section (DP 4)





Reproduced from the 1999 Ordnance Survey 1:25000 map with the permission of Her Majesty's Stationery Office. Crown copyright Archaeological Solutions Ltd Licence number 100036680

Archaeological Solutions Ltd  
**Fig. 1 Site location plan**  
 Scale 1:25,000



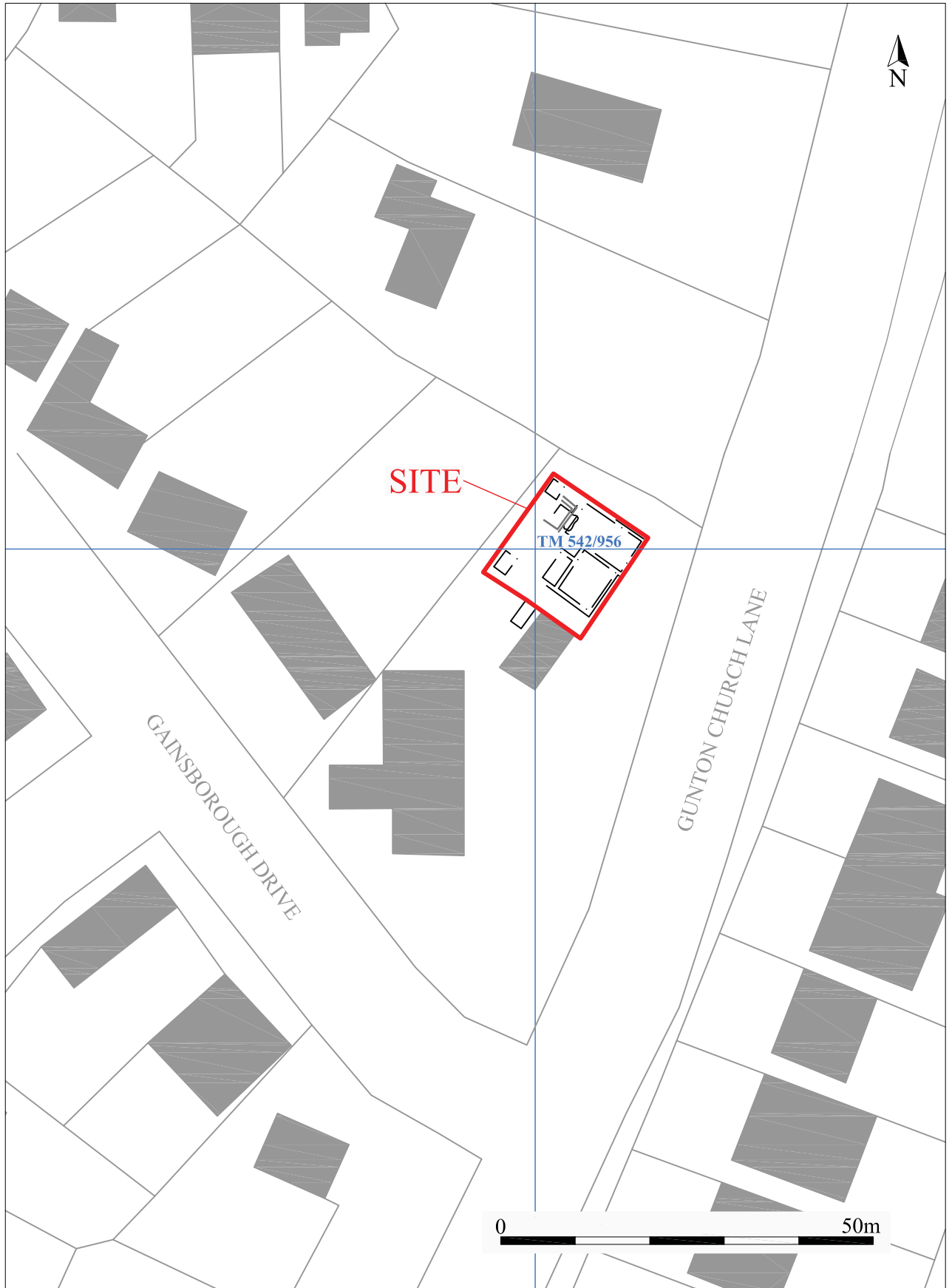

*Archaeological Solutions Ltd*  
**Fig. 2 Detailed site location plan**  
Scale 1:750

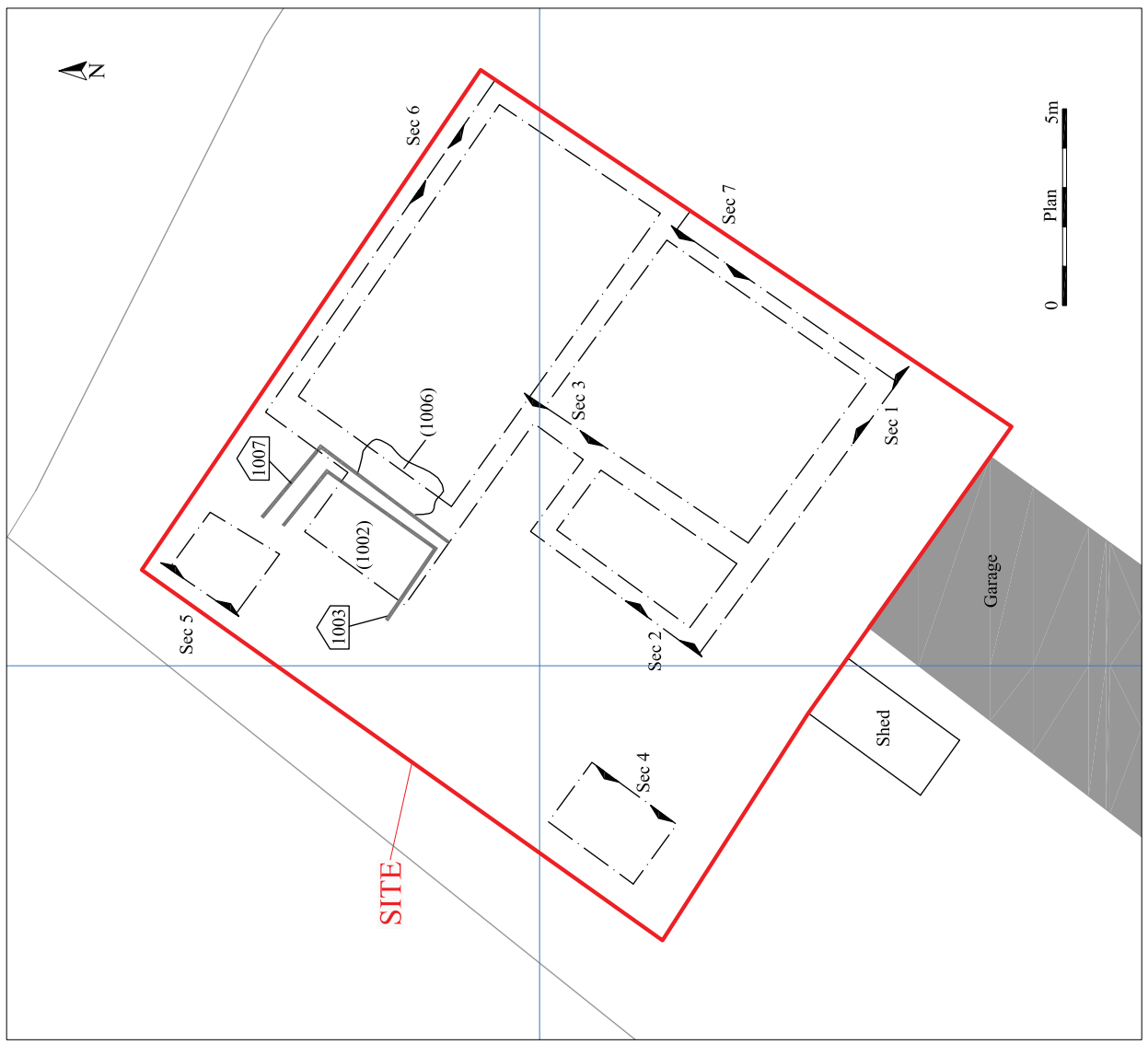
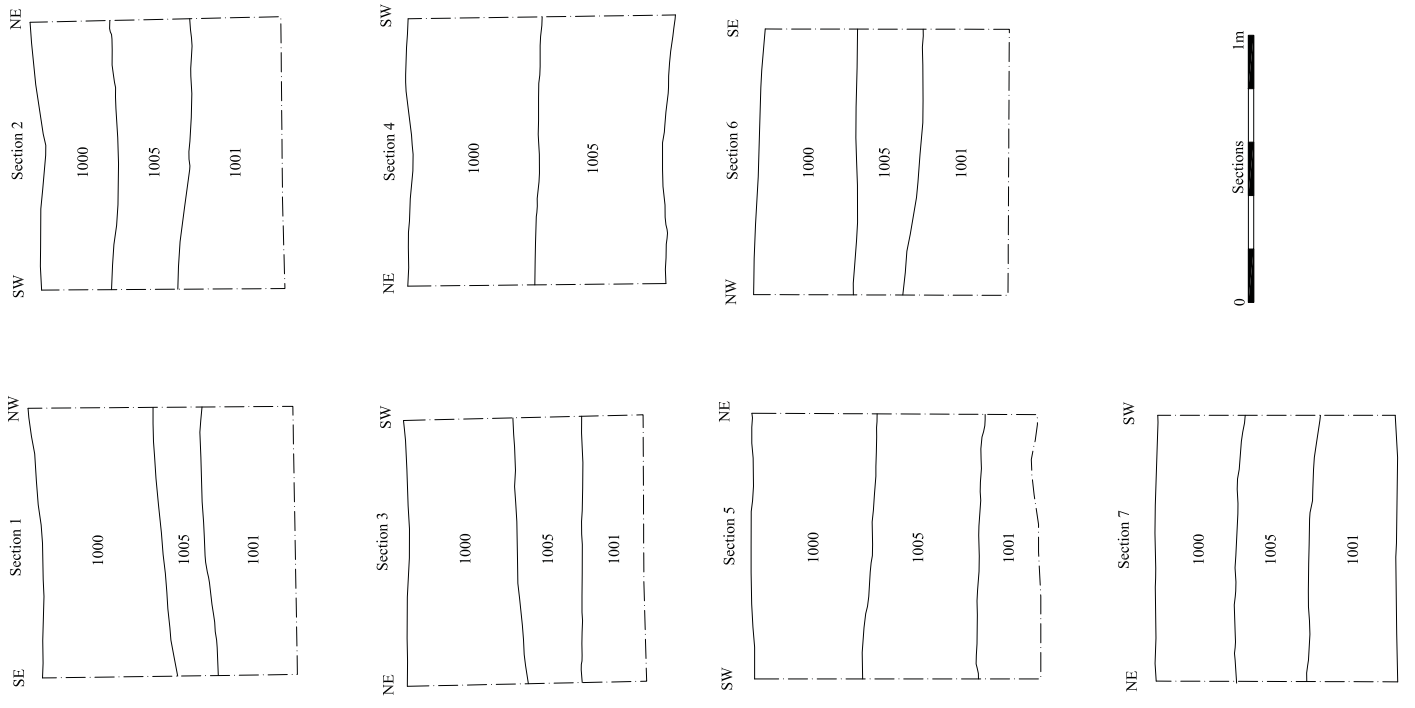

Archaeological Solutions Ltd  
**Fig. 3 Plans and sections**  
 Scale plan 1:125, sections 1:20

## PLATES



Plate 1 Site, view west (DP 1)

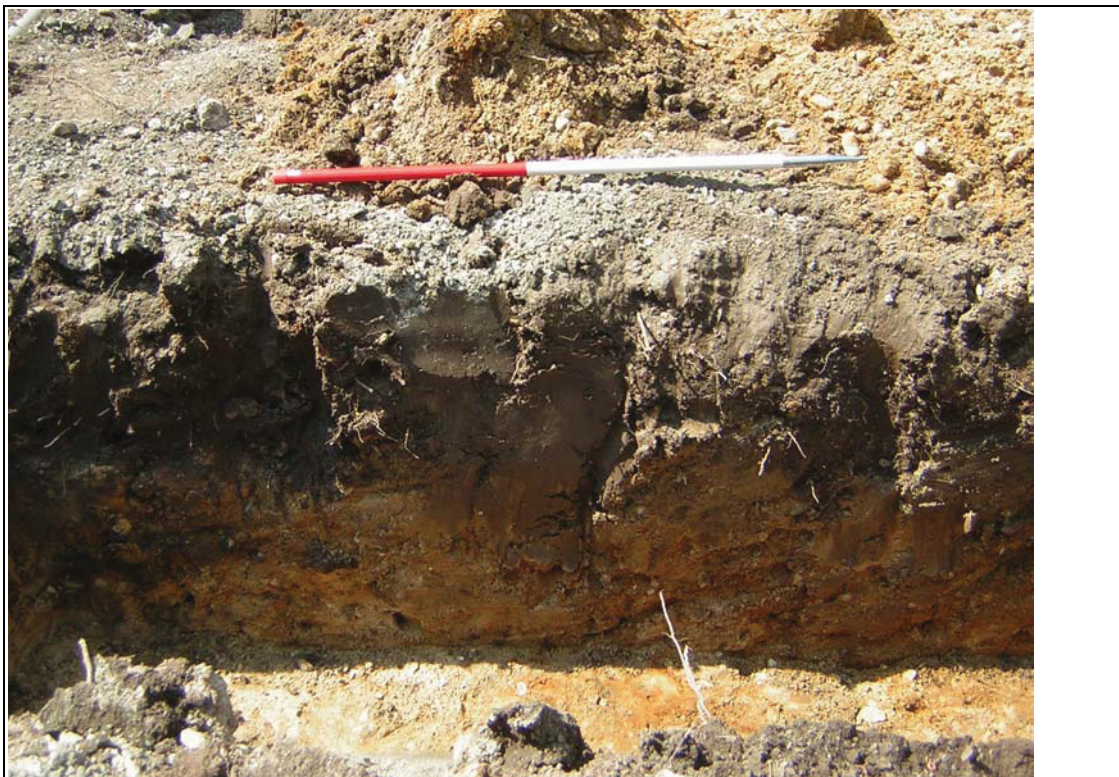

Plate 2 Sample section 1, North-east facing section (DP 2)



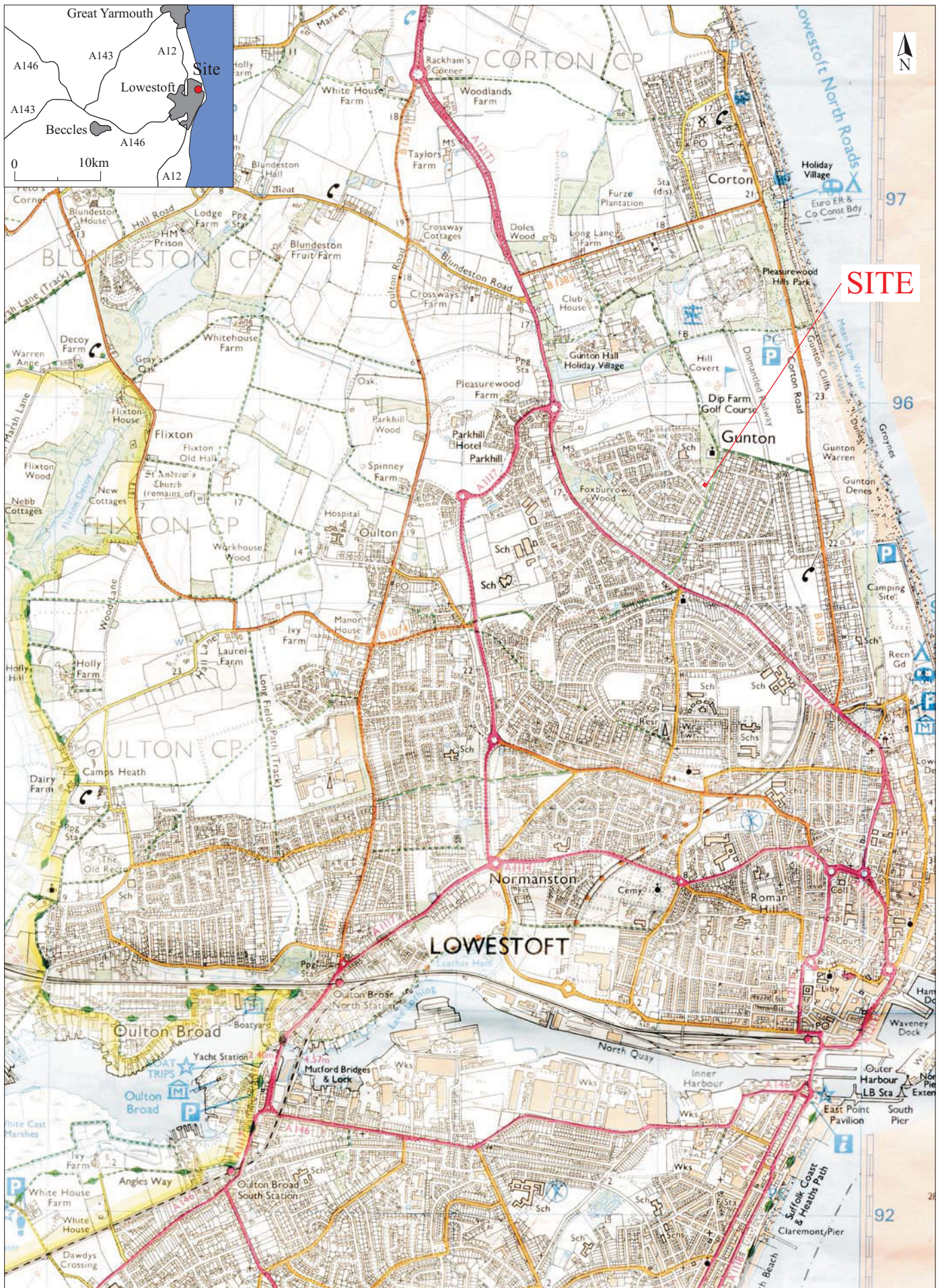

Plate 3 Sample section 2, South-east facing section (DP 3)



Plate 4 Sample section 3, North-west facing section (DP 4)





Reproduced from the 1999 Ordnance Survey 1:25000 map with the permission of Her Majesty's Stationery Office. Crown copyright Archaeological Solutions Ltd Licence number 100036680

Archaeological Solutions Ltd  
**Fig. 1 Site location plan**  
 Scale 1:25,000



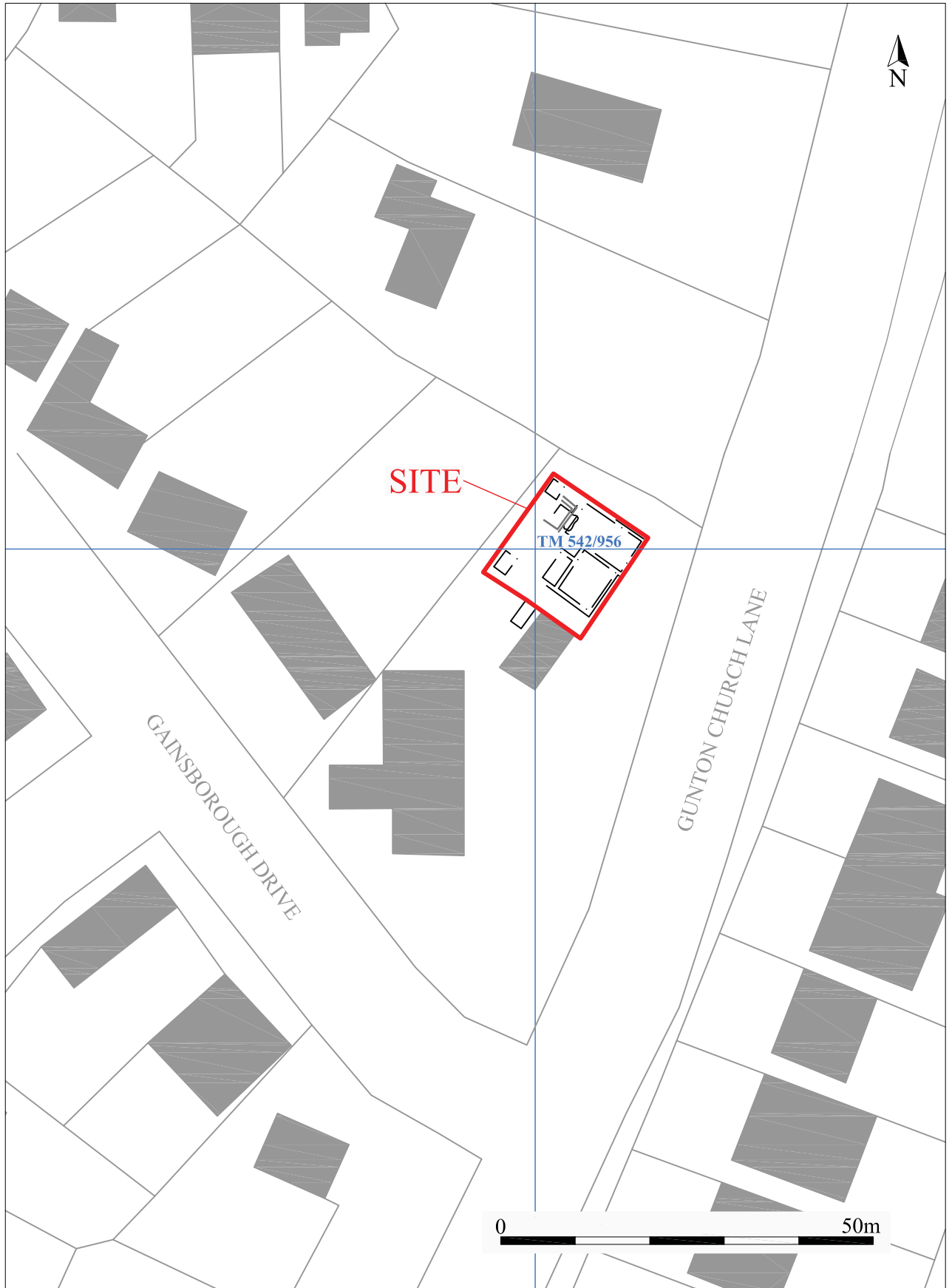

*Archaeological Solutions Ltd*  
**Fig. 2 Detailed site location plan**  
Scale 1:750

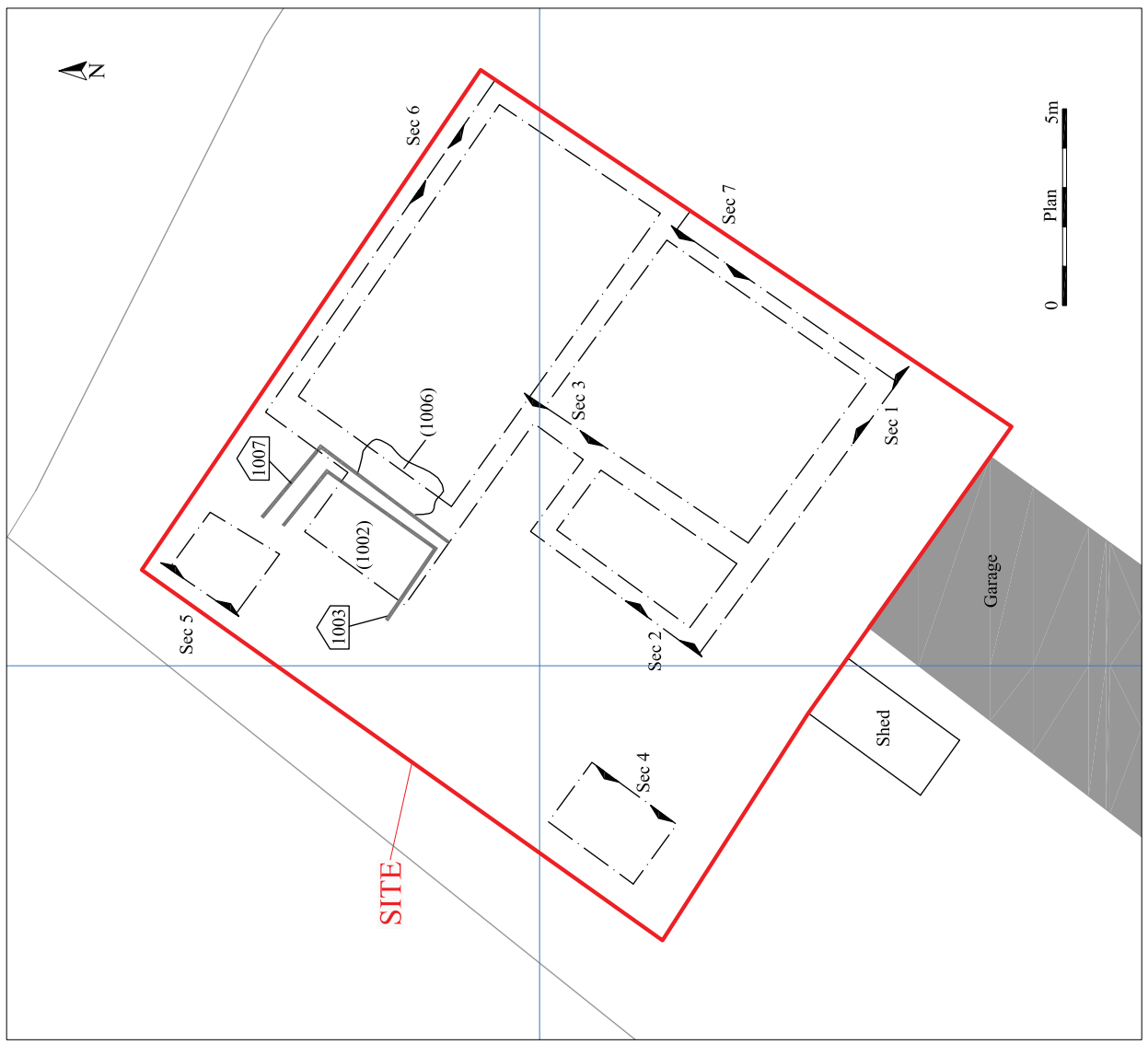
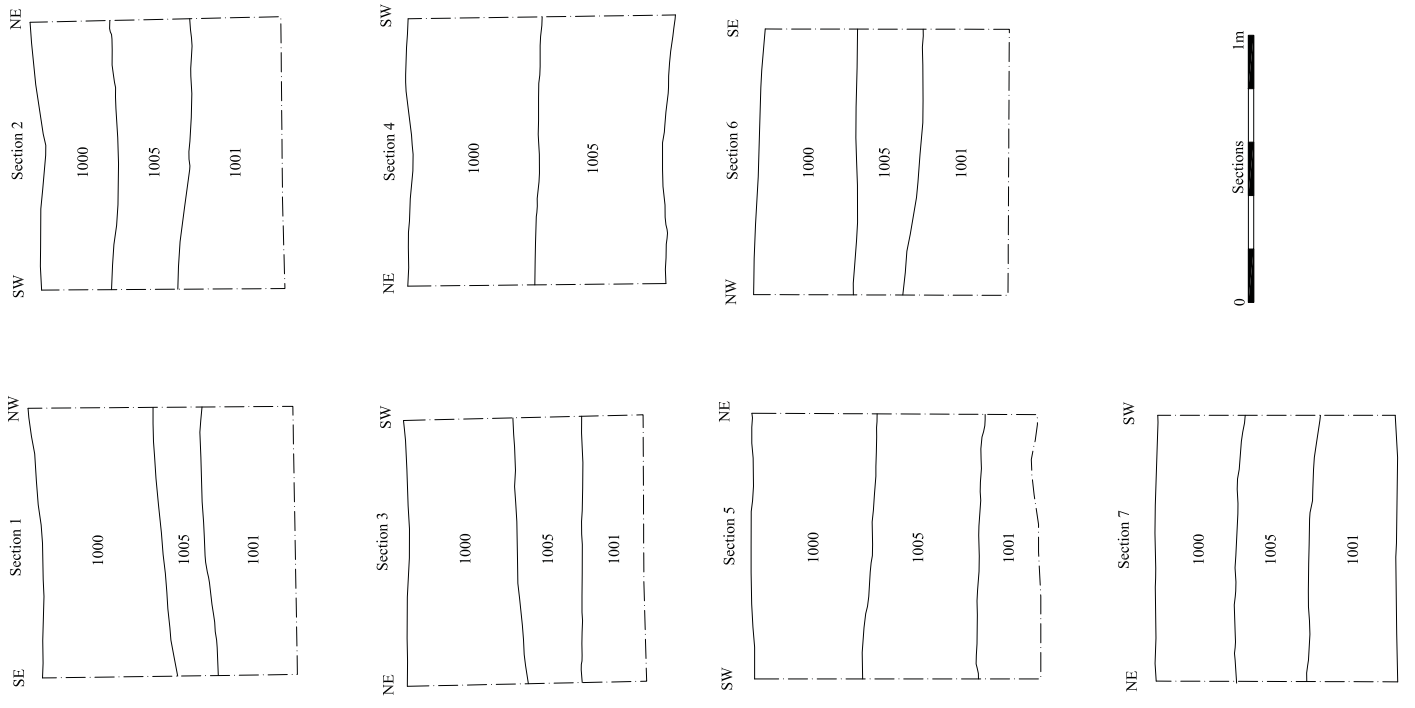

Archaeological Solutions Ltd  
**Fig. 3 Plans and sections**  
 Scale plan 1:125, sections 1:20