ARCHAEOLOGICAL SOLUTIONS LTD

**235 LONDON ROAD, STANWAY,
COLCHESTER, ESSEX, CO3 8PB**

ARCHAEOLOGICAL EVALUATION

Authors: Gareth Barlow (Fieldwork & report) Kate Higgs MA (Oxon.) (Background research)	
NGR: TL 9412 2434	Report No:5977
District: Colchester	Site Code: ECC4423
Approved: Claire Halpin MfA	Project No: 8197
	Date: 20 January 2020

This report is confidential to the client. Archaeological Solutions Ltd accepts no responsibility or liability to any third party to whom this report, or any part of it, is made known. Any such party relies upon this report entirely at their own risk. No part of this report may be reproduced by any means without permission.

Archaeological Solutions is an independent archaeological contractor providing the services which satisfy all archaeological requirements of planning applications, including:

Desk-based assessments and environmental impact assessments
Historic building recording and appraisals
Trial trench evaluations
Geophysical surveys
Archaeological monitoring and recording
Archaeological excavations
Post excavation analysis
Promotion and outreach
Specialist analysis

ARCHAEOLOGICAL SOLUTIONS LTD

Unit 6, Brunel Business Court, Eastern Way,
Bury St Edmunds IP32 7AJ
Tel 01284 765210

P I House, Rear of 23 Clifton Road, Shefford,
Bedfordshire, SG17 5AF
Tel: 01462 850483

e-mail: info@ascontracts.co.uk
www.archaeologicalsolutions.co.uk



twitter.com/ArchaeologicalS



www.facebook.com/ArchaeologicalSolutions



CONTENTS

OASIS SUMMARY SHEET

SUMMARY

- 1 INTRODUCTION***
- 2 DESCRIPTION OF THE SITE***
- 3 TOPOGRAPHY, GEOLOGY AND SOILS***
- 4 ARCHAEOLOGICAL AND HISTORICAL BACKGROUND***
- 5 METHODOLOGY***
- 6 DESCRIPTION OF RESULTS***
- 7 CONFIDENCE RATING***
- 8 DEPOSIT MODEL***
- 9 DISCUSSION***
- 10 CONCLUSION***

DEPOSITION OF THE ARCHIVE

ACKNOWLEDGEMENTS

BIBLIOGRAPHY

OASIS SUMMARY SHEET

Project details			
Project name	235 London Road, Stanway, Colchester, Essex, CO3 8PB		
<p><i>In January 2020 Archaeological Solutions Ltd (AS) carried out an archaeological evaluation on land at 235 London Road, Stanway, Colchester, Essex, CO3 8PB (NGR TL 9412 2434; Figs. 1 & 2). The evaluation was undertaken on compliance with a condition attached to planning approval for the proposed construction of four detached dwellings (Colchester Borough Council Planning Approval Ref. 190952). It was required by the LPA based on the advice of Colchester Borough Council Archaeological Advisor.</i></p> <p><i>The Colchester Historic Environment Record notes that the site lies within an area of archaeological interest, adjacent to the line of a former Roman road which shadows the line of London Road (HER Mon MCC8754). The site thus had potential for evidence of Roman roadside occupation associated with this route; and for medieval activity associated with settlement near to the parish church of St Albrights and historic routeway.</i></p> <p><i>The evaluation revealed no archaeological finds or features.</i></p>			
Project dates (fieldwork)	16 th January 2020		
Previous work (Y/N/?)	N	Future work	TBC
P. number	8197	Site code	ECC4423
Type of project	Archaeological evaluation		
Site status	None		
Current land use	Garden		
Planned development	Residential		
Main features (+dates)	Modern Services		
Significant finds (+dates)	-		
Project location			
County/ District/ Parish	Essex	Colchester	Stanway
HER/ SMR for area	Essex County Council Historic Environment Record		
Post code (if known)	CO3 8PB		
Area of site	c. 2,350m ²		
NGR	TL 9412 2434		
Height AOD (min/max)	c. 39m AOD		
Project creators			
Brief issued by	Historic Environment Advisor of Essex County Council (ECC HEA)		
Project supervisor/s (PO)	Gareth Barlow		
Funded by	GF Gordon Homes Ltd		
Full title	235 London Road, Stanway, Colchester, Essex, CO3 8PB. An Archaeological Evaluation		
Authors	Higgs, K.		
Report no.	5977		
Date (of report)	January 2020		

**235 LONDON ROAD, STANWAY,
COLCHESTER, ESSEX CO3 8PB**

ARCHAEOLOGICAL EVALUATION

SUMMARY

In January 2020 Archaeological Solutions Ltd (AS) carried out an archaeological evaluation on land at 235 London Road, Stanway, Colchester, Essex, CO3 8PB (NGR TL 9412 2434; Figs. 1 & 2). The evaluation was undertaken on compliance with a condition attached to planning approval for the proposed construction of four detached dwellings (Colchester Borough Council Planning Approval Ref. 190952). It was required by the LPA based on the advice of Colchester Borough Council Archaeological Advisor.

The Colchester Historic Environment Record notes that the site lies within an area of archaeological interest, adjacent to the line of a former Roman road which shadows the line of London Road (HER Mon MCC8754). The site thus had potential for evidence of Roman roadside occupation associated with this route; and for medieval activity associated with settlement near to the parish church of St Albrights and historic routeway.

The evaluation revealed no archaeological finds or features.

1 INTRODUCTION

1.1 In January 2020 Archaeological Solutions Ltd (AS) carried out an archaeological evaluation on land at 235 London Road, Stanway, Colchester, Essex, CO3 8PB (NGR TL 9412 2434; Figs. 1 & 2). The evaluation was undertaken on compliance with a condition attached to planning approval for the proposed construction of four detached dwellings (Colchester Borough Council Planning Approval Ref. 190952). It was required by the LPA based on the advice of Colchester Borough Council Archaeological Advisor.

1.2 The archaeological evaluation was carried out in accordance with a brief issued by Colchester Borough Council (CBC, *Brief for an Archaeological Trial Trenched Evaluation at 235 London Road, Stanway, Colchester, CO3 8PB*, Dr. Jess Tipper, dated 14th October 2019), and a specification compiled by AS (dated 18th October 2019). It followed the procedures outlined in the Chartered Institute for Archaeologists' *Standards and Guidance for an Archaeological Evaluation* (2014), and also adhered to the relevant sections of *Standards for Field Archaeology in the East of England* (Gurney 2003).

Planning Policy Context

1.3 The National Planning Policy Framework (NPPF 2019) states that those parts of the historic environment that have significance because of their historic, archaeological, architectural or artistic interest are heritage assets. The NPPF

aims to deliver sustainable development by ensuring that policies and decisions that concern the historic environment recognise that heritage assets are a non-renewable resource, take account of the wider social, cultural, economic and environmental benefits of heritage conservation, and recognise that intelligently managed change may sometimes be necessary if heritage assets are to be maintained for the long term. The NPPF requires applications to describe the significance of any heritage asset, including its setting that may be affected in proportion to the asset's importance and the potential impact of the proposal.

1.4 The NPPF aims to conserve England's heritage assets in a manner appropriate to their significance, with substantial harm to designated heritage assets (i.e. listed buildings, scheduled monuments) only permitted in exceptional circumstances when the public benefit of a proposal outweighs the conservation of the asset. The effect of proposals on non-designated heritage assets must be balanced against the scale of loss and significance of the asset, but non-designated heritage assets of demonstrably equivalent significance may be considered subject to the same policies as those that are designated. The NPPF states that opportunities to capture evidence from the historic environment, to record and advance the understanding of heritage assets and to make this publicly available is a requirement of development management. This opportunity should be taken in a manner proportionate to the significance of a heritage asset and to impact of the proposal, particularly where a heritage asset is to be lost.

2 DESCRIPTION OF THE SITE

2.1 The site lies within the village of Stanway, which lies within the district of Colchester and the county of Essex (Fig. 1). Stanway is situated at the western extent of Colchester and 5.2km to the west of its historic core. The site is on the southern frontage of the B1408 London Road, which runs through Stanway and follows the course of Roman Stane Street.

2.2 The site comprises two roughly rectangular plots of land, covering a total area of c. 2,350m² (Fig. 2). It comprises two garden plots associated with 235 London Road.

3 TOPOGRAPHY, GEOLOGY AND SOILS

3.1 The village of Stanway is situated within the valley of the Roman River, which flows north-west to south-eastwards 850m to the west of the site (Fig. 1). The site therefore lies upon a variable relief at approximately 39m AOD, with the surrounding relief sloping down to the west and towards the Roman River. The Stanway area lies upon a solid geology of London Clay, which is overlain by a drift geology of sand (BGS 2015). Soils of the area comprise those of the Wix Association, which are described as deep permeable, coarse loamy soils affected by groundwater (SSEW 1983).

4 ARCHAEOLOGICAL AND HISTORICAL BACKGROUND

Prehistoric

4.1 Relatively little is known about the prehistory of the Stanway area, but given its proximity to the fertile watercourse and valley of the Roman River, it is likely that the area was conducive to early exploitation and settlement. No prehistoric findspots are recorded in the vicinity of the site. Palaeolithic and Mesolithic flint implements as well as Neolithic artefacts, are recorded from Oldhouse Farm to the south-east (Clover 2015). A ploughed out Bronze Age barrow to the east of Wyvern Farm (HER 11939), and a Bronze Age cemetery at Chitts Hill further north-eastwards, are known.

Iron Age & Romano-British

4.2 The site is located along the southern frontage of the London Road and the course of Roman Stane Street (HERs MCC7518, MCC7619 & MCC8754). Stane Street was the Roman road running ultimately between *Verulamium* (St Albans) and *Camulodunum* (Colchester). There is only moderate evidence for Roman occupation of the area, much of which indicates a continuation of settlement throughout the Iron Age and Romano-British periods.

4.3 A notable Iron Age to Romano-British site is recorded at Gosbecks and Bellhouse Pit near Stanway (Clover 2015), and cropmarks to the south of Church Lane have revealed evidence of a middle Iron Age trackway and residual flint finds. A late Iron Age system of defensive dykes also existed to the west of Colchester, including Grymes Dyke located 2km to the east of the site. The extensive system enclosed the late Iron Age oppidum of *Camulodunum*, the use of which continued into the Roman period. Roman brick is recorded within the fabric of the parish church of St Albrights, which is 75m to the west of the site (HER MCC7629).

Anglo-Saxon

4.4 Place-name evidence suggests a Saxon origin for Stanway or *Stanwaegun*, which derives from 'at the Stone Ways' and refers to its location along Stane Street (Reaney 1969). In the 10th century, Stanway was part of a large estate held by the earldormen of Essex (Cooper 2001). By c. 1002 AD, Aelfflaed, widow of Ealdorman Byrhtnoth, directed that Stanway and 19 other estates should be bequeathed to King Ethelred after her death. The parish church of St Albrights, which stands 75m to the west of the site, is dedicated to St Ethelbert of East Anglia, who died AD 794. The present nave is of Saxon or Saxo-Norman date (HER MCC7630).

Medieval

4.5 At Domesday, both in 1066 and 1086, the manor of Stanway formed part of the lands of King William and boasted three mills (Morris 1983). It also contained two churches during the medieval period, comprising St Albrights and

the Church of All Saints, the remains of which stand further south-eastwards near Stanway Hall Farm. The village of Stanway was also noted as a very dispersed settlement, with settlement in the vicinity of the site focussed upon the Grade II* listed parish church of St Albright, which dates to the 12th century (HERs MCC4545 & MCC7631). The Grade II* listed Catchbells, which is an early 15th century and later timber-framed house, also stands on the London Road (HER MCC4532).

Post-medieval and later

4.6 Stanway remained a very dispersed and scattered settlement throughout the post-medieval and early modern periods. In 1790 the rector reported that there was no village or hamlet in the parish (Cooper 2001). The London Road was turnpiked in 1696, but by 1966 it was so busy, that its congestion led to the construction of the A12 bypass to the north of Stanway by 1971 (*ibid.*). The Grade II listed Rosemary, which also stands on the London Road, is an 18th century brick and timber-framed house (HER MCC4531).

The site

4.7 The site is located along the southern frontage of the London Road and the course of Roman Stane Street (HERs MCC7518, MCC7619 & MCC8754). Little is known about the history and development of the site and no relevant documents could be found in the Essex Record Office (ERO). Historic cartographic sources consistently depict the site as agricultural land throughout the early modern period.

4.8 By 1923 the 3rd edition Ordnance Survey map (Fig. 3) records that 235 London Road had been constructed between the two areas of the site and stood within its own plot of ground (#147a). In 1923 the site therefore consisted of two areas of garden associated with the early modern dwelling at No. 235 London Road.

5 METHODOLOGY

5.1 The CBC AA brief required trial trenches to be excavated based on a 5% sample of the site. Four trenches each 15m x 1.8m were excavated (Fig. 2).

5.2 The trenches were mechanically excavated using a 5 tonne mechanical 360° excavator with a toothless ditching bucket.

5.3 The archaeological evaluation comprised the inspection of the subsoil and natural deposits for archaeological features, the examination of spoil heaps and the recording of soil profiles. Encountered features and deposits were cleaned by hand and recorded using *pro forma* recording sheets, drawn to scale and photographed as appropriate. The excavated spoil was checked for finds.

6 DESCRIPTION OF RESULTS

Individual trench description is presented below:

Trench 1 (Figs. 2 & 4)

Sample section 1A 0.00 = 39.83m AOD		
0.00 – 0.31m	L1000	Topsoil. Friable, mid grey brown sandy silt with occasional medium sub-rounded flints.
0.31 – 0.49m	L1001	Subsoil. Firm, pale-mid yellow brown sandy silt with occasional medium sub-rounded flints.
0.49m+	L1002	Natural deposits. Friable, pale yellow brown silty sand with very frequent medium sub-rounded and rounded flints. Occasional patches of pale yellow brown clay silt.

Sample section 1B 0.00 = 39.00m AOD		
0.00 – 0.30m	L1000	Topsoil. As above.
0.30 – 0.53m	L1001	Subsoil. As above.
00.53m+	L1002	Natural deposits. As above.

Description: Trench 1 contained a modern drainage pipe. No archaeological features or finds were present.

Trench 2 (Figs. 2 & 4)

Sample section 2A 0.00 = 39.12m AOD		
0.00 – 0.30m	L1000	Topsoil. As Sample Section 1A.
0.30 – 0.54m	L1001	Subsoil. As Sample Section 1A.
0.54m+	L1002	Natural deposits. As Sample Section 1A.

Sample section 2B 0.00 = 39.20m AOD		
0.00 – 0.20m	L1003	Garden Surface. Friable, pale yellow grey silty sand and very frequent medium rounded flints.
0.20 – 0.34m	L1000	Topsoil. As Sample Section 1A.
0.34 – 0.76m	L1001	Subsoil. As Sample Section 1A.
0.76m+	L1002	Natural deposits. As Sample Section 1A.

Description: Trench 2 contained a modern drainage pipe. No archaeological features or finds were present.

Trench 3 (Fig. 2)

Sample section 3A 0.00 = 38.03m AOD		
0.00 – 0.36m	L1000	Topsoil. As Sample Section 1A.
0.36 – 0.72m	L1001	Subsoil. As Sample Section 1A.
0.72m+	L1002	Natural deposits. As Sample Section 1A.

Sample section 3B 0.00 = 38.06m AOD		
0.00 – 0.34m	L1000	Topsoil. As Sample Section 1A.
0.34 – 0.65m	L1001	Subsoil. As Sample Section 1A.
0.65m+	L1002	Natural deposits. As Sample Section 1A.

Description: Trench 3 contained no archaeological features or finds.

Trench 4 (Figs. 2 & 5)

Sample section 4A 0.00 = 39.57m AOD		
0.00 – 0.39m	L1000	Topsoil. As Sample Section 1A.
0.39 – 0.75m	L1001	Subsoil. As Sample Section 1A.
0.75m+	L1002	Natural deposits. As Sample Section 1A.

Sample section 4B 0.00 = 39.71m AOD		
0.00 – 0.35m	L1000	Topsoil. As Sample Section 1A.
0.35 – 0.67m	L1001	Subsoil. As Sample Section 1A.
0.67m+	L1002	Natural deposits. As Sample Section 1A.

Description: Trench 4 contained modern electricity and water services. No archaeological features or finds were present.

8 DEPOSIT MODEL

8.1 With the exception of the eastern end of Trench 2 the stratigraphy was uniform across the site. Uppermost was a 0.30m – 0.39m topsoil layer (L1000) of friable, mid grey brown sandy silt with occasional medium sub-rounded flints. Below L1000 was a 0.18m – 0.42m thick subsoil layer (L1001) of firm, pale-mid yellow brown sandy silt with occasional medium sub-rounded flints. The natural deposits (L1002) of friable, pale yellow brown silty sand with very frequent medium sub-rounded and rounded flints, and occasional patches of pale yellow brown clay silt, were encountered between 0.49m and 0.76m below the current ground surface.

8.2 At the eastern end of Trench 2 the topsoil (L1000) was overlain by a 0.20m thick layer (L1003) of friable, pale yellow grey silty sand and very frequent medium rounded flints. This was part of the landscaping of a formal garden.

9 DISCUSSION

9.1 The Colchester Historic Environment Record notes that the site lies within an area of archaeological interest, adjacent to the line of a former Roman road which shadows the line of London Road (HER Mon MCC8754). The site thus had potential for evidence of Roman roadside occupation associated with this route, and for medieval activity associated with settlement near to the parish church of St Albrights and the historic routeway.

9.2 The trial trenches revealed no archaeological features or finds. A subsoil 0.18m – 0.49m thick was present suggesting the site stratigraphy is intact and archaeological features, had they been present, would have been revealed.

DEPOSITION OF THE ARCHIVE

Archive records, with an inventory, will be deposited with Colchester and Ipswich Museum. The archive will be quantified, ordered, indexed, cross referenced and checked for internal consistency.

ACKNOWLEDGEMENTS

Archaeological Solutions would like to thank GF Gordon Homes for funding the works and for their assistance (in particular Mr Arran Gordon) and Piers of Burnt Orange Construction. AS is also grateful to Ms Sarah Threlfall of TMA Chartered Surveyors.

AS is also pleased to acknowledge the staff of the Essex Historic Environment Record, in particular Dr. Jess Tipper (CBC Archaeological Officer) for his input and advice.

AS would also like to thank the staff of the Essex Record Office (ERO), based in Chelmsford.

BIBLIOGRAPHY

British Geological Survey (BGS) 2015 *British Geological Survey, Geology of Britain Viewer*, <http://mapapps.bgs.ac.uk/geologyofbritain/home.html>

Chartered Institute for Archaeologists (CIfA) 2014 *Standards and Guidance for an Archaeological Evaluation*. CIfA, Reading

Clover, K. 2015 *Archaeological Evaluation Report Land at Wyvern Farm London Road, Stanway Near Colchester, Essex*. Archaeology South-East unpublished report No. 2015247

Cooper, J. 2001 *A History of the County of Essex*. Volume 10. Institute of Historical Research, London

Gurney, D. 2003 *Standards for Field Archaeology in the East of England*. East Anglian Archaeology Occasional Paper 14

Morris, J. 1983 *Domesday Book: Essex*. Phillimore & Co., Chichester

Reaney, P. H. 1969 *The Place-Names of Essex*. Cambridge University Press, Cambridge

Soil Survey of England and Wales (SSEW) 1983 *Soils of South East England (sheet 4)*. SSEW, Harpenden

Soil Survey of England and Wales (SSEW) 1983 *Soil Survey of England and Wales: Legend for the 1:250,000 Soil Map of England and Wales*. SSEW, Harpenden

OASIS DATA COLLECTION FORM: England

[List of Projects](#) | [Manage Projects](#) | [Search Projects](#) | [New project](#) | [Change your details](#) | [HER coverage](#) | [Change country](#) | [Log out](#)

Printable version

OASIS ID: archaeol7-381466

Project details

Project name	235 London Road, Stanway, Colchester, Essex, CO3 8PB (TT)
Short description of the project	In January 2020 Archaeological Solutions Ltd (AS) carried out an archaeological evaluation on land at 235 London Road, Stanway, Colchester, Essex, CO3 8PB (NGR TL 9412 2434; Figs. 1 and 2). The evaluation was undertaken on compliance with a condition attached to planning approval for the proposed construction of four detached dwellings (Colchester Borough Council Planning Approval Ref. 190952). It was required by the LPA based on the advice of Colchester Borough Council Archaeological Advisor. The Colchester Historic Environment Record notes that the site lies within an area of archaeological interest, adjacent to the line of a former Roman road which shadows the line of London Road (HER Mon MCC8754). The site thus had potential for evidence of Roman roadside occupation associated with this route; and for medieval activity associated with settlement near to the parish church of St Albrights and historic routeway. The evaluation revealed no archaeological finds or features.
Project dates	Start: 16-01-2020 End: 17-01-2020
Previous/future work	No / Not known
Any associated project reference codes	P8197 - Contracting Unit No.
Any associated project reference codes	ECC4423 - Sitecode
Type of project	Field evaluation
Site status	None
Current Land use	Other 15 - Other
Monument type	SERVICES Modern
Significant Finds	NONE None
Methods & techniques	"Targeted Trenches"
Development type	Urban residential (e.g. flats, houses, etc.)
Prompt	Planning condition
Position in the planning process	Not known / Not recorded

Project location

Country	England
Site location	ESSEX COLCHESTER STANWAY 235 London Road, Stanway, Colchester, Essex, CO3 8PB

Postcode CO3 8PB
 Study area 2350 Square metres
 Site coordinates TL 9412 2434 51.883257828656 0.820871694602 51 52 59 N 000 49 15 E Point
 Height OD / Depth Min: 39m Max: 39m

Project creators

Name of Organisation Archaeological Solutions Ltd
 Project brief originator ESCC
 Project design originator Jon Murray
 Project director/manager Jon Murray
 Project supervisor Archaeological Solutions Ltd

Project archives

Physical Archive Exists? No
 Digital Archive recipient Colchester and Ipswich Museum
 Digital Contents "none"
 Digital Media available "Database","Images raster / digital photography","Spreadsheets","Text"
 Paper Archive recipient Colchester and Ipswich Museum
 Paper Contents "none"
 Paper Media available "Context sheet","Drawing","Map","Photograph","Plan","Report","Section","Survey "

Project bibliography 1

Publication type Grey literature (unpublished document/manuscript)
 Title 235 London Road, Stanway, Colchester, Essex, CO3 8PB. An Archaeological Evaluation
 Author(s)/Editor(s) Higgs, K
 Other bibliographic details 5977
 Date 2020
 Issuer or publisher Archaeological Solutions
 Place of issue or publication Bury St Edmunds
 Entered by Hollie Wesson (info@ascontracts.co.uk)
 Entered on 20 January 2020

PHOTOGRAPHIC INDEX (P8197)



1
Ground being prepared for trench layout



2
General view of site looking north-west



3
Trench 1 looking south-west



4
Sample section 1A in Trench 1



5
Trench 2 looking north-east



6
Sample section 2A in Trench 2



7
Trench 3 looking south-east



8
Sample section 3A in Trench 3



9
Trench 4 looking north



10
Sample section 4A in Trench 4

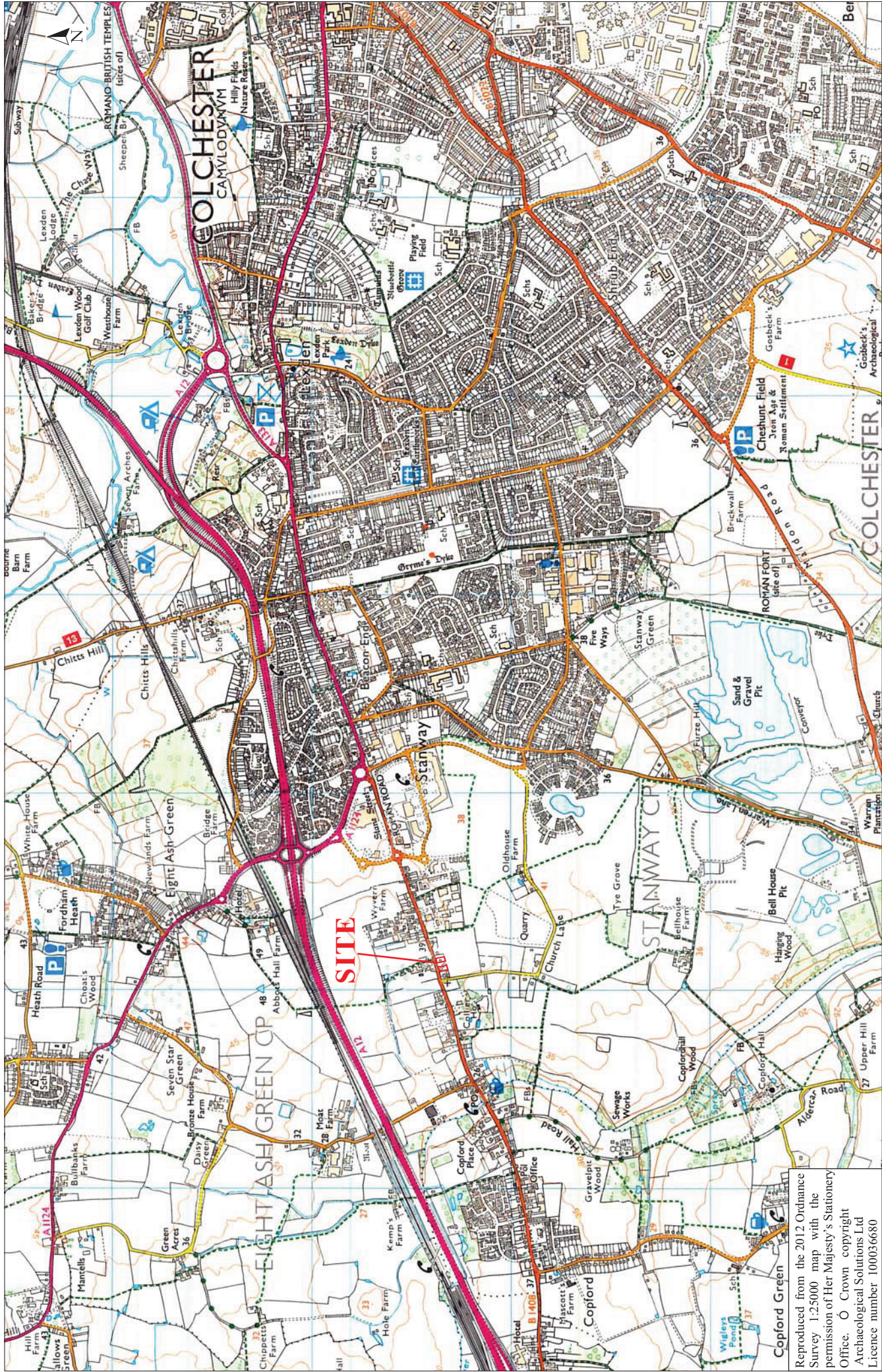

Reproduced from the 2012 Ordnance Survey 1:25000 map with the permission of Her Majesty's Stationery Office. © Crown copyright Archaeological Solutions Ltd Licence number 100036680

Archaeological Solutions Ltd

Fig. 1 Site location plan

Scale 1:25,000 at A4

235 London Road, Stanway, Colchester, Essex (P8197)

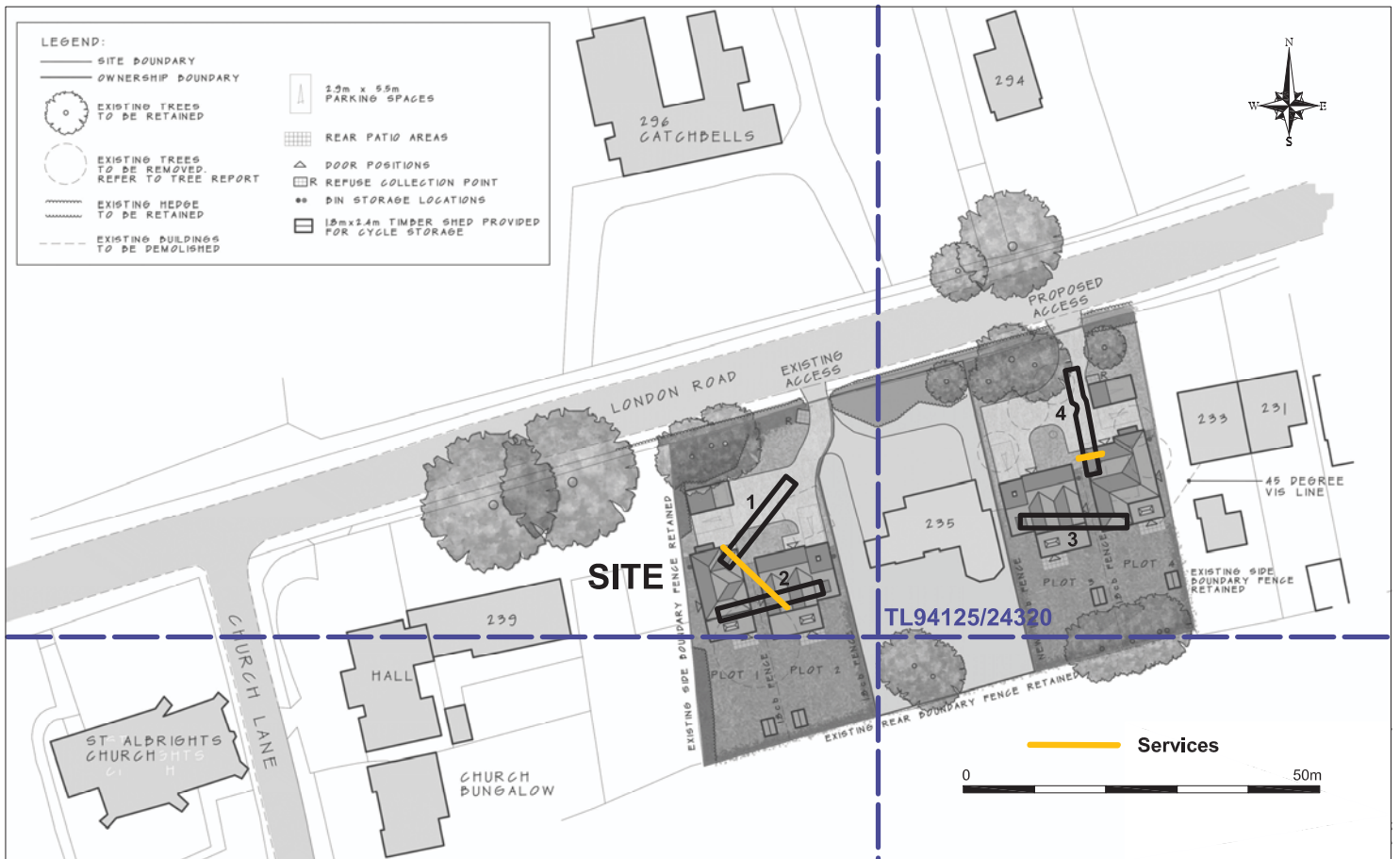

Archaeological Solutions Ltd

Fig. 2 Detailed site location plan

Scale 1:1000 at A4

235 London Road, Stanway, Colchester, Suffolk (P8197)

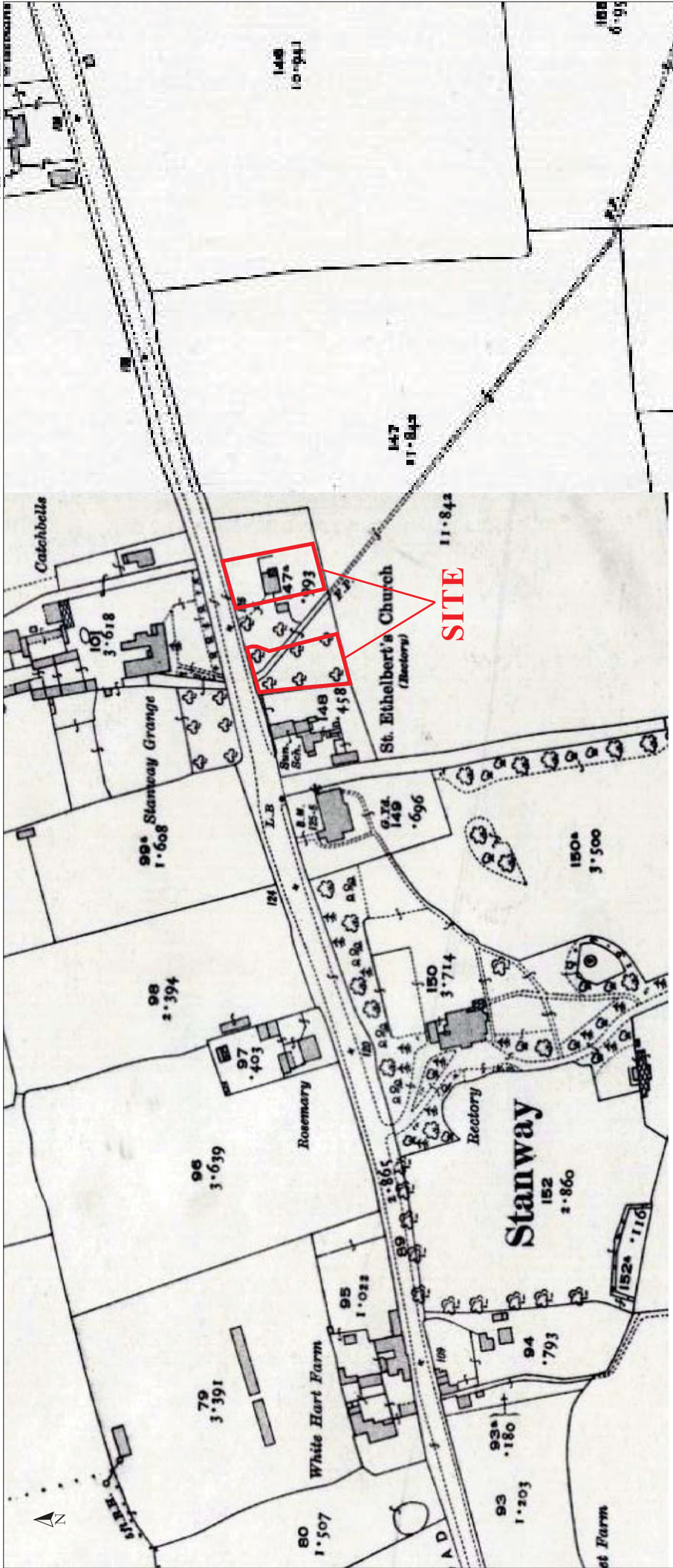

Reproduced from the 1923 Ordnance Survey 1 mile to 25" map with the permission of Her Majesty's Stationery Office. © Crown copyright Archaeological Solutions Ltd Licence number 100036680

Archaeological Solutions Ltd

Fig. 3 OS map, 1923

Not to scale

235 London Road, Stanway, Colchester, Essex (P8197)

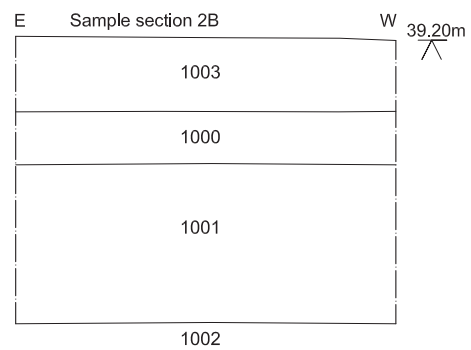
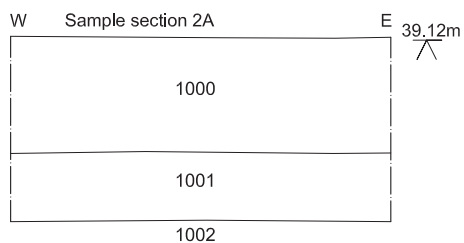
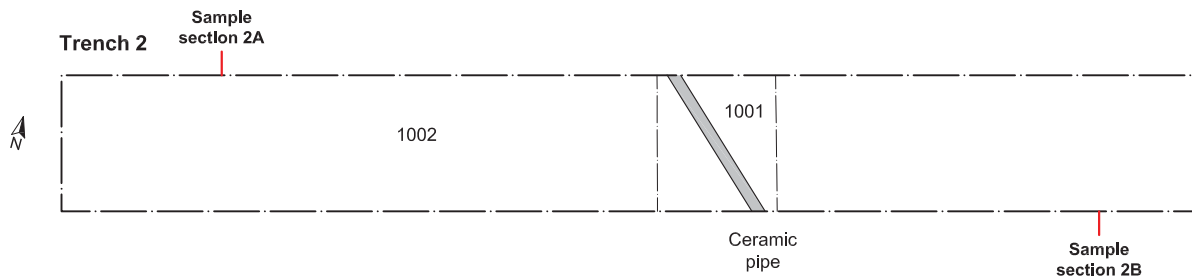
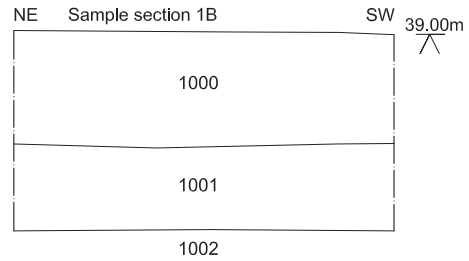
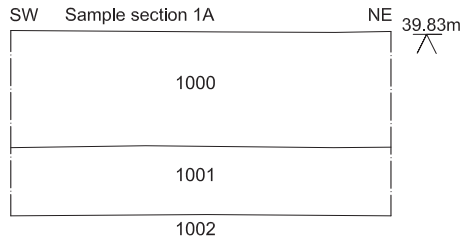
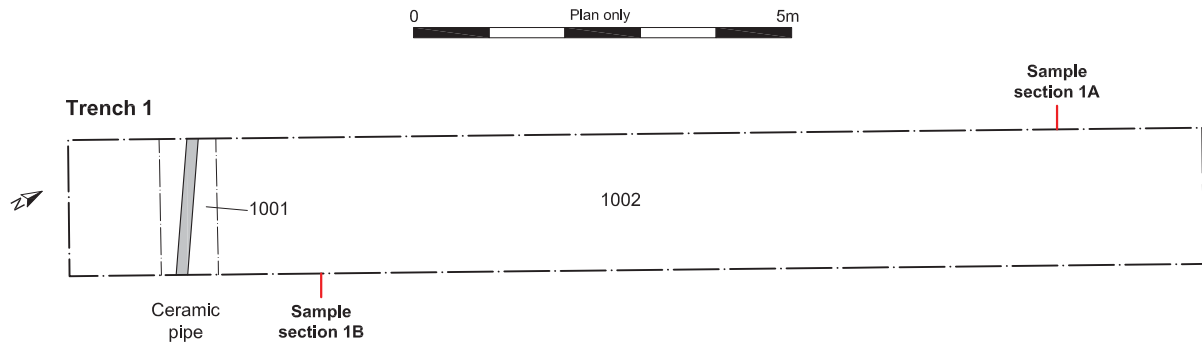

<i>Archaeological Solutions Ltd</i>
Fig. 4 Trench plans & sections
Scale Plans 1:100, sections 1:20 at A4
235 London Road, Stanway, Colchester, Suffolk (P8197)

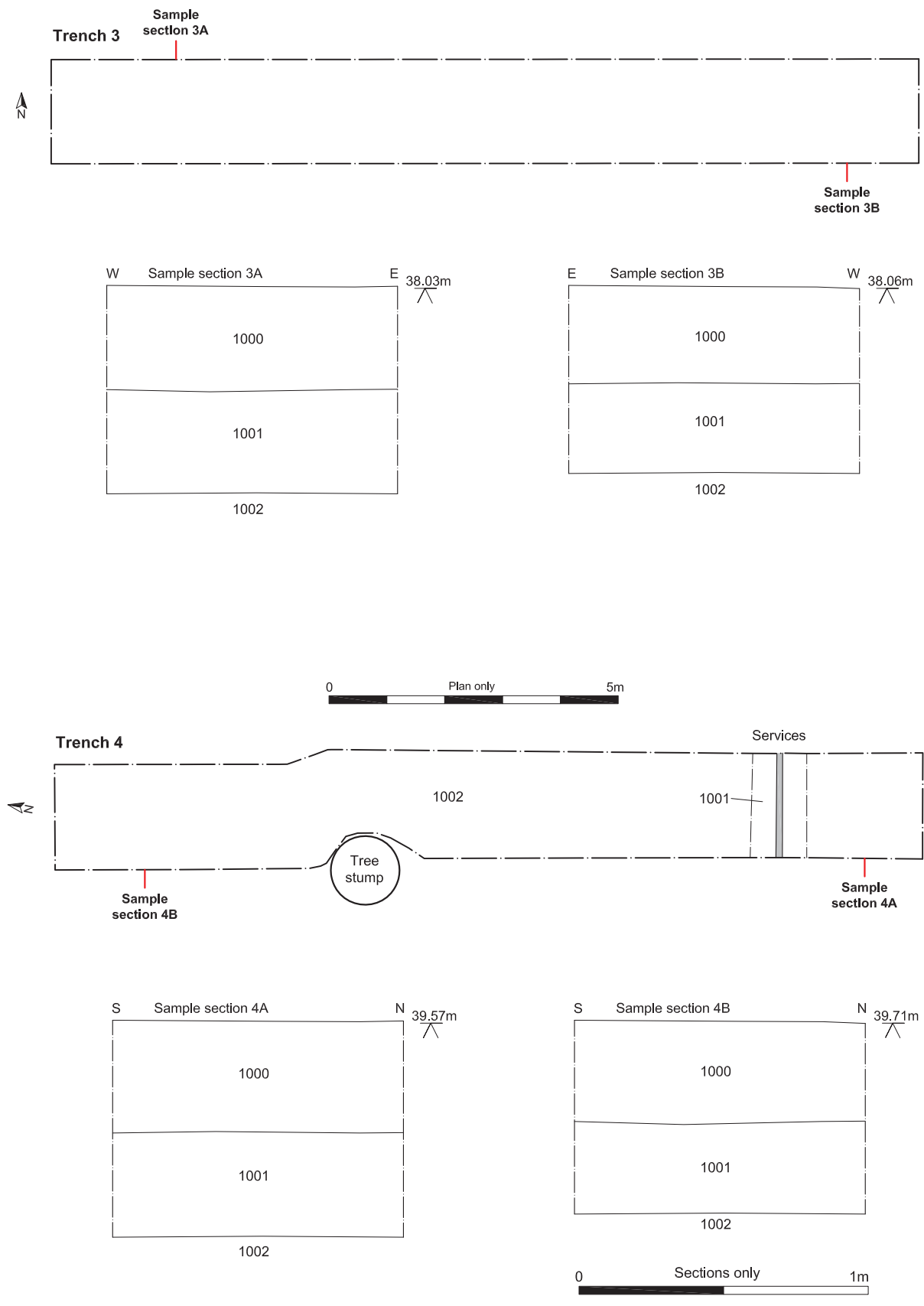

Archaeological Solutions Ltd

Fig. 5 Trench plans & sections

Scale Plan 1:100, sections 1:20 at A4

235 London Road, Stanway, Colchester, Suffolk (P8197)