

**13 & 15 BUNTINGFORD ROAD, PUCKERIDGE,
HERTFORDSHIRE**

**ARCHAEOLOGICAL MONITORING AND
RECORDING**

ARCHAEOLOGICAL SOLUTIONS LTD

**13 & 15 BUNTINGFORD ROAD,
PUCKERIDGE, HERTFORDSHIRE**

ARCHAEOLOGICAL MONITORING AND RECORDING

Authors: Martin Brook BA (Fieldwork & Report)	
NGR: TL 38650 23595 & TL 38670 23590	Report No. 3213
Parish: Standon	Site Code: AS 1177
Approved: Claire Halpin MIFA	Project No. P3313
Signed:	Date: November 2008

This report is confidential to the client. Archaeological Solutions Ltd accepts no responsibility or liability to any third party to whom this report, or any part of it, is made known. Any such party relies upon this report entirely at their own risk. No part of this report may be reproduced by any means without permission.

Archaeological Solutions Ltd, 98-100 Fore Street, Hertford, SG14 1AB.
Tel: 01992 558170 Fax: 01992 553359 E-mail: info@ascontracts.co.uk
Web: www.archeologicalsolutions.co.uk
Registered Number: 4702122

CONTENTS

OASIS SUMMARY SHEET

SUMMARY

- 1 INTRODUCTION**
- 2 DESCRIPTION OF THE SITE**
- 3 TOPOGRAPHY, GEOLOGY AND SOILS**
- 4 ARCHAEOLOGICAL AND HISTORICAL BACKGROUND**
- 5 METHODOLOGY**
- 6 DESCRIPTION OF RESULTS**
- 7 CONFIDENCE RATING**
- 8 DEPOSIT MODEL**
- 9 DISCUSSION**

ACKNOWLEDGEMENTS

DEPOSITION OF THE ARCHIVE

BIBLIOGRAPHY

APPENDIX 1

OASIS SUMMARY SHEET

Project details			
Project name	<i>13 & 15 Buntingford Road, Puckeridge</i>		
Project description (250 words) <i>In November 2008 Archaeological Solutions Ltd (AS) carried out a programme of archaeological monitoring and recording of groundworks associated with two residential extensions at 13 & 15 Buntingford Road, Puckeridge, Hertfordshire.</i> <i>The site lies within the area designated Area of Significance 94 on the EHDC local plan. The archaeological monitoring and recording revealed no archaeological features within the area subject to ground works.</i>			
Project dates (fieldwork)	<i>3rd – 5th November 2008</i>		
Previous work (Y/N/?)	<i>N</i>	Future work (Y/N/?)	<i>N</i>
P. number	<i>3133</i>	Site code	<i>AS 1177</i>
Type of project	<i>Archaeological Monitoring and Recording</i>		
Site status	<i>Scheduled Ancient Monument</i>		
Current land use	<i>Residential property</i>		
Planned development	<i>Residential extension</i>		
Main features (+dates)	<i>-</i>		
Significant finds (+dates)	<i>-</i>		
Project location			
County/ District/ Parish	<i>Hertfordshire</i>		
HER/ SMR for area	<i>Hertfordshire HER</i>		
Post code (if known)	<i>-</i>		
Area of site	<i>-</i>		
NGR	<i>TL 38650 23595</i>		
Height AOD (max/ min)	<i>71m AOD</i>		
Project creators			
Brief issued by	<i>Historic Environment Unit Hertfordshire County Council</i>		
Project supervisor/s (PO)	<i>Archaeological Solutions Ltd</i>		
Funded by	<i>SJ & DL Lane & M & R Gleadow</i>		
Full title	<i>13 & 15 Buntingford Road, Puckeridge Archaeological Monitoring and Recording</i>		
Authors	<i>Brook, M</i>		
Report no.	<i>3213</i>		
Date (of report)	<i>November 2008</i>		

13 & 15 BUNTINGFORD ROAD, PUCKERIDGE ARCHAEOLOGICAL MONITORING AND RECORDING

SUMMARY

In November 2008 Archaeological Solutions Ltd (AS) carried out a programme of archaeological monitoring and recording of groundworks associated with two residential extensions at 13 & 15 Buntingford Road, Puckeridge, Hertfordshire.

The site lies within the area designated Area of Significance 94 on the EHDC local plan. The archaeological monitoring and recording revealed no archaeological features within the area subject to ground works

1 INTRODUCTION

1.1 In November 2008 Archaeological Solutions Ltd (AS) carried out a programme of archaeological monitoring and recording of groundworks associated with the construction of a new single storey residential rear extension to both 13 & 15 Buntingford Road, Puckeridge, Hertfordshire (NGR TL 38670 23590) (Figs.1-2). The groundworks consisted of multiple foundation trenches being dug in the position of the future walls of the extension. The works were carried out simultaneously under close archaeological supervision. The programme of archaeological monitoring and recording was carried out in accordance with a brief issued by Hertfordshire County Council Historic Environment Unit (HCC HEU) dated 24th October 2008. The works were required in order to comply with a planning condition for archaeological investigation required as part of planning consent (EHDC Planning Ref. 3/08/1327/FP). The programme of works also complied with the document; Gurney *Standards for Field Archaeology in the East of England* (2003) *EAA Occasional Paper 14*, and the Institute of Field Archaeologists' (IFA) *Standard and Guidance for Archaeological Watching Briefs (revised 2001)*.

1.2 The project objectives as laid out in the specification were:

- To ensure the archaeological excavation and monitoring of all aspects of the development programme likely to affect buried archaeological remains;
- To secure adequate recording of any archaeological remains revealed by the development programme;
- To secure the full analysis and interpretation of the site archive and the appropriate publication of the project results, if required.
- To secure the analysis, long-term conservation and storage of the project archive.

1.3 The relevant planning policies which apply to the effect of development with regard to cultural heritage are Planning Policy Guidance Note 15 'Planning and the Historic Environment' (PPG15) and Planning Policy Guidance Note 16 'Archaeology and Planning' (PPG16) (Department of the Environment).

1.4 PPG16 (1990) is the national Planning Policy Guidance Note which applies to archaeology. It states that there should always be a presumption in favour of preserving nationally important archaeological remains *in situ*. However, when there is no overriding case for preservation, developers are required to fund opportunities for the recording and, where necessary, the excavation of the site. This condition is widely applied by local authorities.

1.5 PPG15 (1994) is the national Planning Policy Guidance Note which applies to the conservation of the historic environment by protecting the character and appearance of Conservation Areas and protecting listed buildings (of architectural or historical interest) from demolition and unsympathetic change and safeguarding their settings as far as is possible. This condition is also widely applied by local authorities.

2 DESCRIPTION OF THE SITE

2.1 The residential dwellings of 13 and 15 Buntingford Road lie on the western side of Buntingford Road immediately adjacent to the area of the Iron Age/Roman town which is Scheduled as an Ancient Monument. The houses are terraced and the ground level around them has been reduced. To the rear, the gardens lie almost 2m above the ground surface forming a raised gardening bed. The dwellings are situated on a slope which slopes gently downward to the east and toward the area designated as Area of Significance 94 on the EHDC local plan. The EHDC plan notes the presence of the Iron Age/Roman settlement and also evidence of a significant roman settlement to the south and south-east of the village and the later medieval village of Puckeridge.

3 TOPOGRAPHY, GEOLOGY AND SOILS

3.1 Puckeridge overlies a solid geology of upper chalk which contains pockets of London clay. This is in turn overlain by Melford type chalky till or boulder clay which is deep and well drained and can contain calcareous subsoils.

3.2 The site lies at a height of *c.* 71m AOD. Land to the east descends slightly in the direction of the valley of the river Rib, while to the west it climbs steadily, reaching a height of 115m AOD at Mentley Farm, *c.* 1km to the west.

4 ARCHAEOLOGICAL AND HISTORICAL BACKGROUND

4.1 The site lies within an area of archaeological potential, in the vicinity of the Iron Age/Romano-British town at Braughing/Puckeridge which is centred on Wickham Hill. The site lies within an area designated as Area of Archaeological Significance 94 on the EHDC local plan.

4.2 The Iron Age settlement (c. 20 BC – AD 40) consisted of many dispersed occupation areas forming a large trading centre. The Roman centre seems to have been informal without a planned road grid or large public buildings. With the volume of traffic passing along Stane Street and Ermine Street (which converge less than 200m east of the White Hart) and the evidence for production, it is likely that the Roman settlement served as a market centre. Based on the abundance of late Iron Age and Roman archaeology in its immediate surroundings, the site has considerable potential for similar remains. There is little evidence of post-Roman activity in Puckeridge until the 13th century, when the village began to rapidly grow in prosperity; it later became an important coaching stop on the London to Cambridge road, with numerous inns.

5 METHODOLOGY

5.1 The foundations for the proposed walls of the extensions were hand dug under close archaeological supervision. A mechanical excavator was not used as the location of the site and also the location of underlying services in the site area made the use of a mechanical excavator impractical. The monitoring and recording focused on all of the groundworks that were associated with the building of the new extension. The site was visited between the 3rd and 5th November 2008.

6 DESCRIPTION OF RESULTS

6.1 Four sample sections were recorded and the results are presented below.

1m Sample Section 1 (Fig 4; DP 1). Southern foundation trench, east facing. 0.00=70.70m	
0.00 – 0.06m	L1000. Concrete. Light greyish yellow, extremely compact.
0.06 – 0.15m	L1001. Made ground. Light greyish brown loose sandy clay with CBM and stone inclusions.
0.15m +	L1002. Natural. Light brownish orange sandy clay of firm consistency.

1m Sample Section 2 (Fig 4; DP4). Southern foundation trench, north facing. 0.00=70.70m	
0.00 – 0.18m	L1001. Made ground. As above.
0.18m +	L1002. Natural. As above.

1m Sample Section 3 (Fig 4). Northern foundation Trench. North-east facing. 0.00=70.72m	
0.00 – 0.17m	L1003. Made ground. Light yellowish orange sandy gravel.
0.17m +	L1002. Natural ground.

1m Sample Section 4 (Fig 4). Northern foundation Trench (DP 3). South-west facing. 0.00=70.72m	
0.00 – 0.16m	L1003. Made ground. As above.
0.16m +	L1002. Natural. As above.

Description: No archaeological features or finds were present.

7 CONFIDENCE RATING

7.1 It is not felt that any factors hindered the recognition of any archaeological features at the site.

8 DEPOSIT MODEL

8.1 The stratigraphy of the site consisted of a greyish yellow concrete (L1000), overlying a deposit of greyish brown sandy clay forming made ground (L1001), which in turn overlay the natural brownish orange sandy clay (L1002).

8.2 The made ground in the area of the proposed dining areas differed slightly from the rest of the site and consisted of yellowish orange sandy gravel (L1003).

9 DISCUSSION

9.1 Although there was potential on this site for revealing remains associated with the Iron Age and Roman settlement known in the surrounding area, no archaeology was present at the site. This is almost certainly due to the construction of the current dwellings which required the ground level to be reduced. No residual finds were recovered from any layers so it is impossible to say if there were indeed any features here before the site was developed.

ACKNOWLEDGEMENTS

Archaeological Solutions would like to thank SJ & DL Lane & M & R Gleadow for funding this project.

AS would also like to acknowledge the input and advice of Alison Tinniswood of HCC HEU

DEPOSITION OF ARCHIVE

An archive of all materials produced by the report has been created and listed. Copies of the final report will be lodged with the client, English Heritage, St. Albans City and District Council, the Hertfordshire Heritage Environment Record and the National Monuments Record, Swindon. The archive will be lodged with Verulamium Museum.

BIBLIOGRAPHY

Brown, N. & Glazebrook, J. (eds) 2000 *Research and Archaeology: a framework for the Eastern Counties*. East Anglian Archaeology Occasional Papers 8

Glazebrook, J. (ed) 1997 *Research and Archaeology: a framework for the Eastern Counties. 1: resource assessment*. East Anglian Archaeology Occasional Papers 3

Gurney, D. 2003, *Standards for Field Archaeology in the East of England*. East Anglian Archaeology Occasional Papers 14/ALGAO

Institute of Field Archaeologists, 1994 (revised 2001), *Standard and Guidance for Archaeological Watching Briefs*. IFA

Partridge, C. 1977 'Excavations at Puckeridge and Braughing 1975 – 79', *Hertfordshire Archaeology* 5, 22 - 109

Partridge, C. 1979, 'Excavations and fieldwork at Braughing 1968 – 73', *Hertfordshire Archaeology* 7, 28 – 132

Partridge, C. 1981, 'Skeleton Green; a late Iron Age and Romano – British site', *Britannia Monograph Series* 2

Partridge, C. 1982, 'Braughing, Wickham Kennels 1982', *Hertfordshire Archaeology* 8, 40 – 82.

Soil Survey of England and Wales 1983 *Legend for the 1:250,000 Soil Map of England and Wales* Harpenden

APPENDIX 1. HISTORIC ENVIRONMENT RECORD SUMMARY SHEET

Site name and address:	13 & 15 Buntingford Road, Puckeridge
County: Hertfordshire	District: East Herts
Village/Town: Puckeridge	Parish: Standon
Planning application reference:	3/08/1327/FP
Client name/address/tel:	SJ & DL Lane & M & R Gleadow, 13 & 15 Buntingford Road, Puckeridge
Nature of application:	Residential
Present land use:	Garden
Size of application area:	Size of area investigated:
NGR (8 figures):	TL 3867 2359
Site Code:	AS 1177
Site director/Organisation:	Archaeological Solutions Ltd
Type of work:	Archaeological Monitoring and Recording
Date of work:	3 rd to 5 th November 2008
Location of finds/Curating museum:	Hertford Museum
Related SMR Nos:	Periods represented: -
Relevant previous summaries/reports: -	-
Summary of fieldwork results:	<p>In November 2008 Archaeological Solutions Ltd (AS) carried out a programme of archaeological monitoring and recording of groundworks associated with two residential extensions at 13 & 15 Buntingford Road, Puckeridge, Hertfordshire.</p> <p>The site lies within the area designated Area of Significance 94 on the EHDC local plan. The archaeological monitoring and recording revealed no archaeological features within the area subject to ground works.</p>
Author of summary: Newton, A. A. S	Date of Summary: 02 December 2008

PHOTOGRAPHIC INDEX



DP 1. Sample Section 1. View West



DP 2. General shot of site. View south-east



DP 3. Northern foundation trench. View north-east



DP 4. Sample Section 2. View south

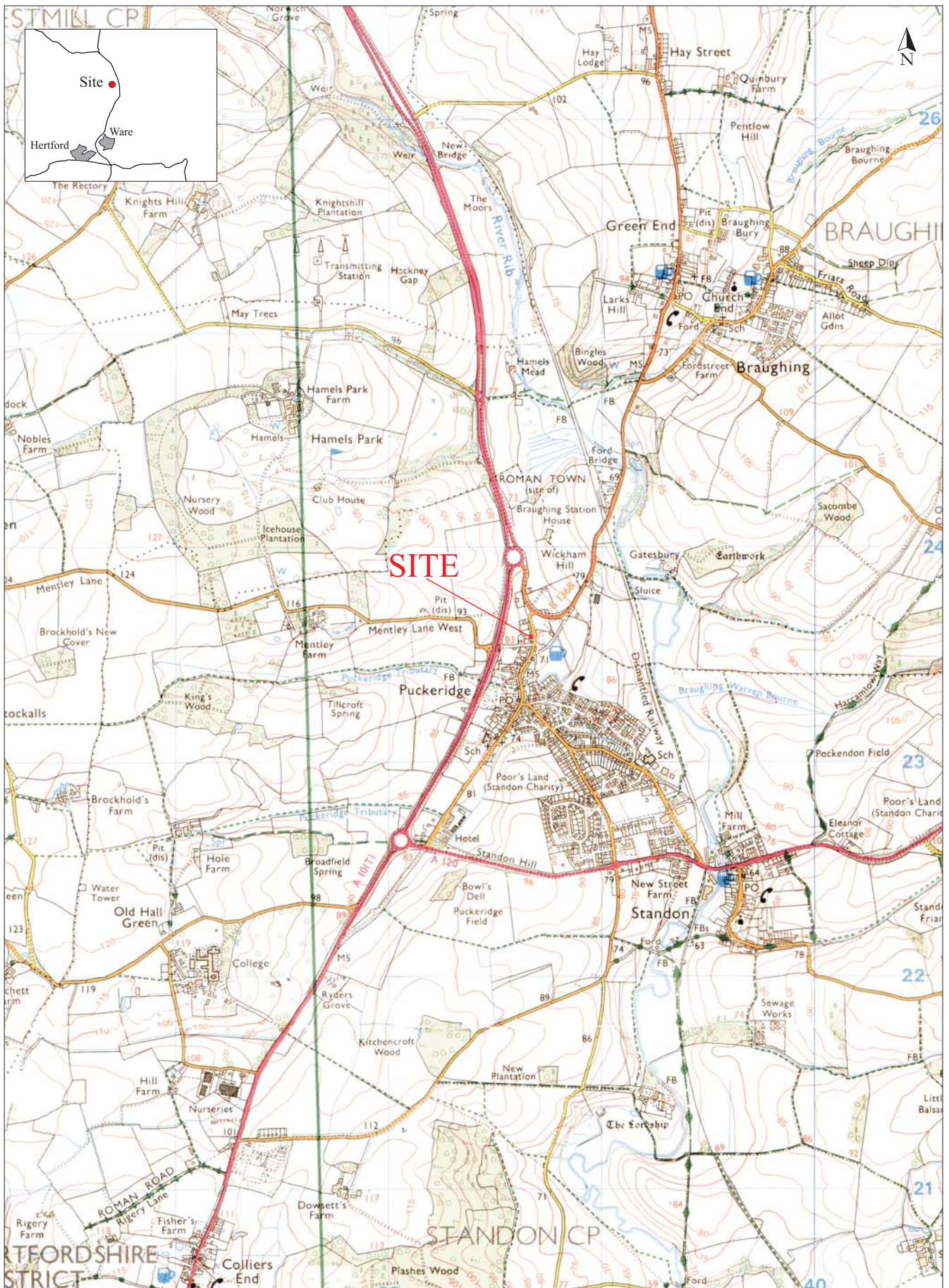

Reproduced from the 1999 Ordnance Survey 1:25000 map with the permission of Her Majesty's Stationery Office. © Crown copyright Archaeological Solutions Ltd Licence number 100036680

Archaeological Solutions Ltd
Fig. 1 Site location plan
 Scale 1:25,000 at A4

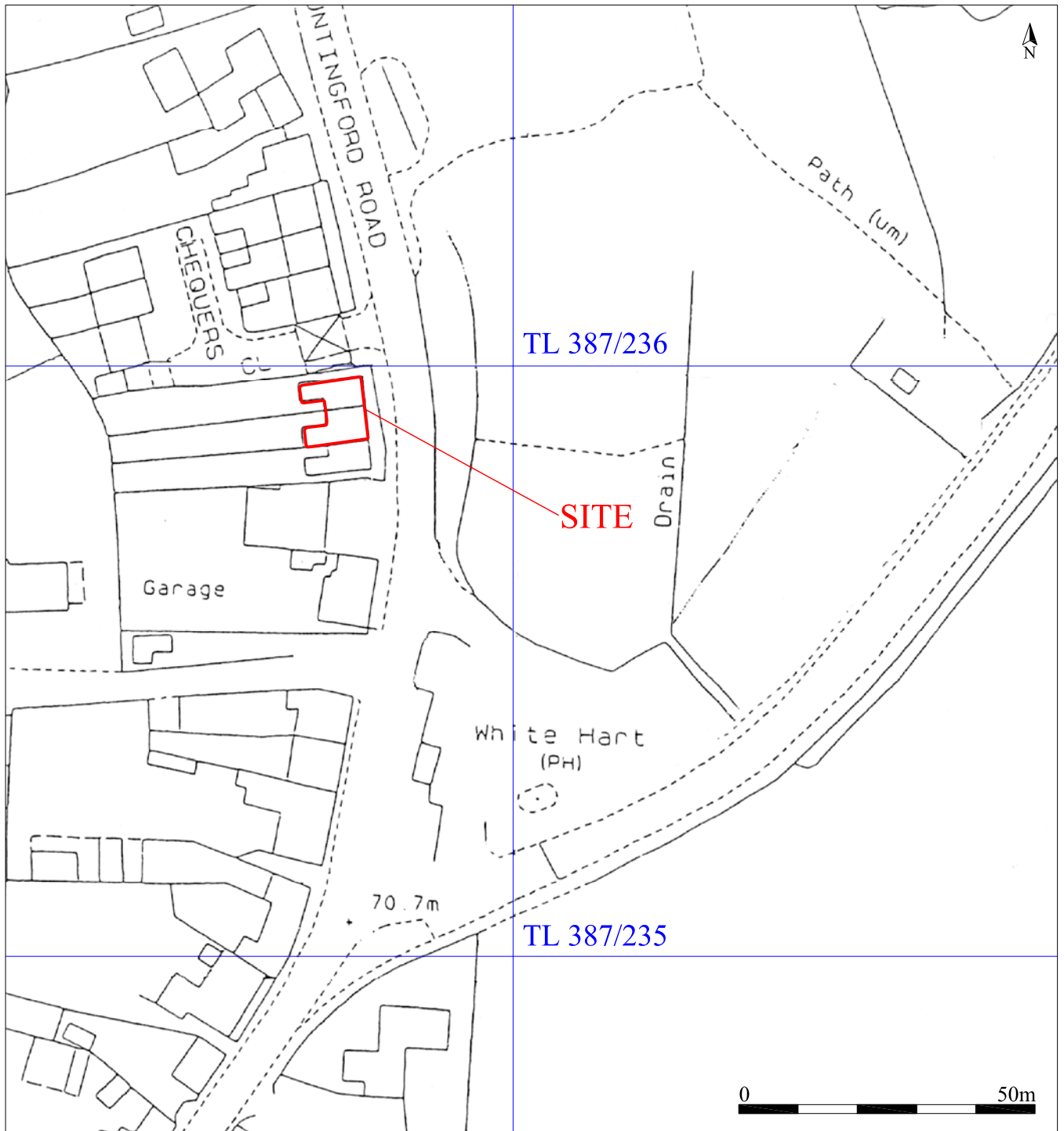

Reproduced from the 1999 Ordnance Survey 1:25000 map with the permission of Her Majesty's Stationery Office. Crown copyright Archaeological Solutions Ltd. Licence No. 100036680

Archaeological Solutions Ltd
Fig. 2 Detailed site location plan
 Scale 1:1000 at A4

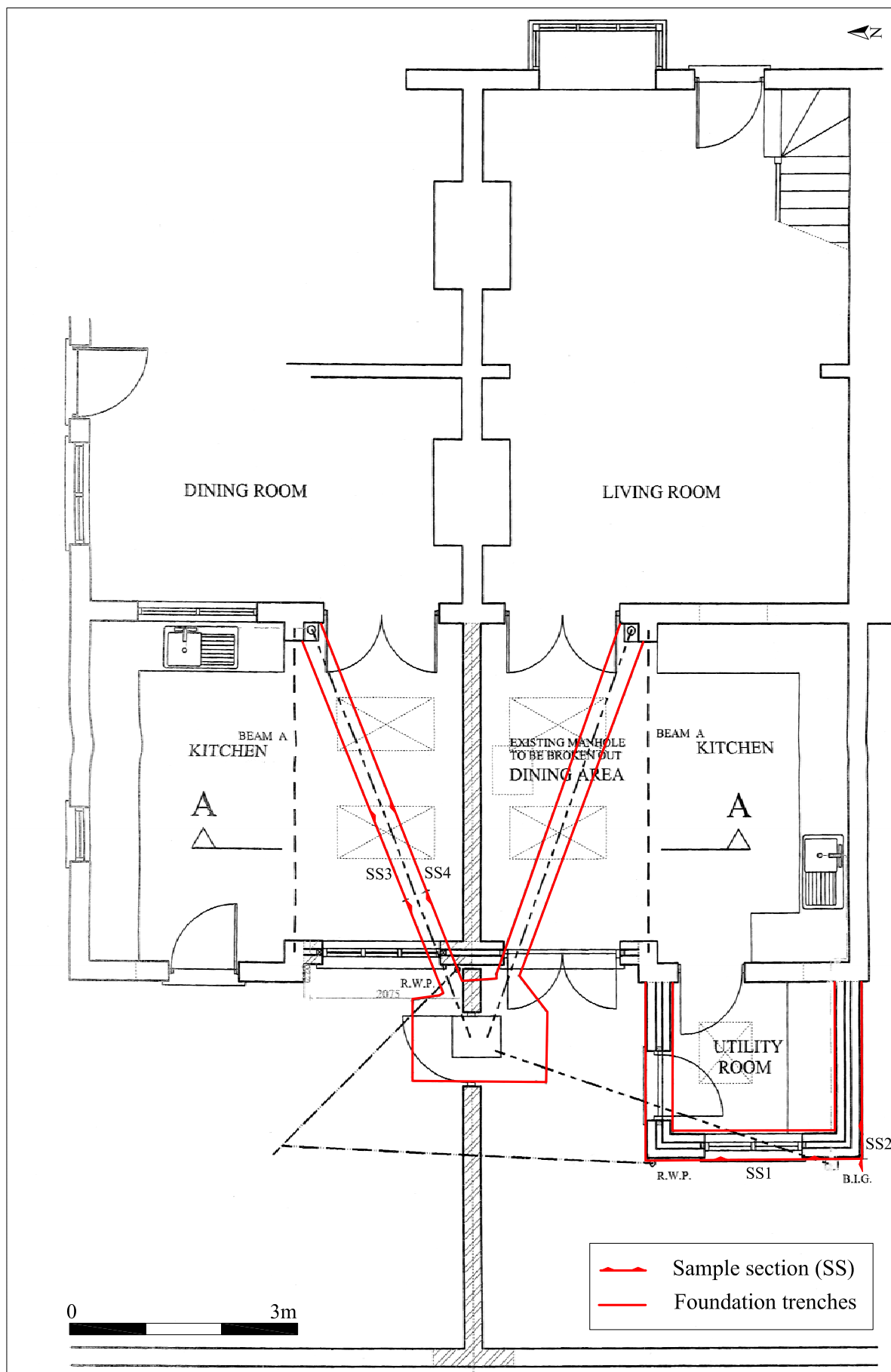

Archaeological Solutions Ltd
Fig. 3 Area of watching brief
 Scale 1:75 at A4

