

# LAND REAR OF MARIGOLDS, 64 HIGH STREET, OLD HARLOW, ESSEX

## AN ARCHAEOLOGICAL EVALUATION

Authors: Zbigniew Pozorski MA	
NGR: TL 4745 1159	Report No. 3518
District: Harlow	Site Code: HAHS 09
Approved: Claire Halpin MIFA	Project No. 3619
Signed:	Date: April 2010

98-100 Fore Street, Hertford SG14 1AB

Unit 6, Brunel Business Court, Eastern Way,  
Bury St Edmunds IP32 7AJ

Tel 01992 558170  
Fax 01992 553359

e-mail [info@ascontracts.co.uk](mailto:info@ascontracts.co.uk)  
[www.archaeologicalsolutions.co.uk](http://www.archaeologicalsolutions.co.uk)  
Registered Number: 4702122



Certificate No. FS 515590



INVESTOR IN PEOPLE

*This report is confidential to the client. Archaeological Solutions Ltd accepts no responsibility or liability to any third party to whom this report, or any part of it, is made known. Any such party relies upon this report entirely at their own risk. No part of this report may be reproduced by any means without permission.*

## **CONTENTS**

### ***OASIS SUMMARY SHEET***

#### ***SUMMARY***

- 1 INTRODUCTION**
- 2 DESCRIPTION OF THE SITE**
- 3 TOPOGRAPHY, GEOLOGY AND SOILS**
- 4 ARCHAEOLOGICAL AND HISTORICAL BACKGROUND**
- 5 METHODOLOGY**
- 6 DESCRIPTION OF RESULTS**
- 7 CONFIDENCE RATING**
- 8 DEPOSIT MODEL**
- 9 DISCUSSION**
- 10 DEPOSITION OF THE ARCHIVE**

#### ***ACKNOWLEDGEMENTS***

#### ***BIBLIOGRAPHY***

#### ***APPENDICES***

- 1 ESSEX HERITAGE AND CONSERVATION RECORD (EHCR)**

**OASIS SUMMARY SHEET**

<b>Project details</b>			
<b>Project name</b>	<i>Land Rear of Marigolds, 64 High Street, Old Harlow, Essex</i>		
<p><i>In April 2010 Archaeological Solutions (AS) carried an archaeological evaluation at land rear of Marigolds, 64 High Street, Old Harlow, Essex (NGR TL 4745 1159). The evaluation was commissioned by Mr Stephen Levy of EXE Property Developments, and was undertaken as part of a planning condition on approval of the construction of new single detached dwelling in the rear (southern) garden area.</i></p> <p><i>The site lies on the southern side of the High Street, Old Harlow, within the Old Harlow Conservation Area. It comprises a large 18<sup>th</sup> century Grade II listed house fronting the street and a large back garden where the new development is proposed. The site had a potential for medieval and post-medieval remains.</i></p> <p><i>In the event the evaluation revealed no archaeological features or finds.</i></p>			
Project dates (fieldwork)	<i>15<sup>th</sup> April 2010</i>		
Previous work (Y/N/?)	<i>Y</i>	Future work (Y/N/?)	<i>N</i>
P. number		Site code	
Type of project	<i>An Archaeological Evaluation</i>		
Site status	<i>Grade II listed house</i>		
Current land use	<i>Rear garden with swimming pool</i>		
Planned development	<i>Single detached dwelling</i>		
Main features (+dates)	<i>-</i>		
Significant finds (+dates)	<i>-</i>		
<b>Project location</b>			
County/ District/ Parish	<i>Essex</i>	<i>Harlow</i>	<i>Old Harlow</i>
HER/ SMR for area	<i>Essex HER</i>		
Post code (if known)	<i>CM17 0DR</i>		
Area of site	<i>c. 1800m<sup>2</sup></i>		
NGR	<i>TL 4745 1159</i>		
Height AOD (min/max)	<i>59/60.50m</i>		
<b>Project creators</b>			
Brief issued by	<i>ECC HEM</i>		
Project supervisor/s (PO)	<i>Zbigniew Pozorski</i>		
Funded by			
Full title	<i>Land Rear of Marigolds, 64 High Street, Old Harlow, Essex; An Archaeological Evaluation</i>		
Authors	<i>Pozorski, Z.</i>		
Report no.	<i>3518</i>		
Date (of report)	<i>April 2010</i>		

**LAND NORTH OF THE CLOCK HOUSE,  
HODDESDON ROAD, STANSTEAD ST MARGARETS,  
HERTFORDSHIRE**

**AN ARCHAEOLOGICAL EVALUATION**

**SUMMARY**

*In April 2010 Archaeological Solutions (AS) carried an archaeological evaluation at land rear of Marigolds, 64 High Street, Old Harlow, Essex (NGR TL 4745 1159). The evaluation was commissioned by Mr Stephen Levy of EXE Property Developments, and was undertaken as part of a planning condition on approval of the construction of new single detached dwelling in the rear (southern) garden area.*

*The site lies on the southern side of the High Street, Old Harlow, within the Old Harlow Conservation Area. It comprises a large 18<sup>th</sup> century Grade II listed house fronting the street and a large back garden where the new development is proposed. The site had a potential for medieval and post-medieval remains.*

*In the event the evaluation revealed no archaeological features or finds.*

**1 INTRODUCTION**

1.1 In April 2010 Archaeological Solutions (AS) carried an archaeological evaluation at land rear of Marigolds, 64 High Street, Old Harlow, Essex (NGR TL 4745 1159; Figs. 1 & 2). The evaluation was commissioned by Mr Stephen Levy of EXE Property Developments and was undertaken in compliance with a planning condition attached to planning permission for the construction of new single detached dwelling in the rear (southern) garden area (Harlow District Planning Ref. HW/PL/09/00261).

1.2 The evaluation was undertaken in accordance with a brief issued by Essex County Council Historic Environment Management (ECC HEM; dated 28/01/2010) and a written scheme of investigation (specification) prepared by AS (dated 03/02/2010) and approved by ECC HEM. The project conformed to the Institute for Archaeologists (IfA) *Code of Conduct Standard and Guidance for Archaeological Field Evaluation* (revised 2001), as well as the document *Standards for Field Archaeology in the East of England* (Gurney 2003).

1.3 The evaluation aimed to determine the location, extent, date, character, condition, significance and quality of any surviving archaeological remains liable to be threatened by the proposed development. Specific research aims for the programme were:

- to locate any evidence of medieval/post-medieval occupation, its nature and extent,
- to examine the relationship of any of this evidence of occupation in the context of the development of the historic town,
- to identify and record any medieval or post-medieval ribbon development.

### *Planning policy context*

1.4 The relevant planning policies which apply to the effect of development with regard to cultural heritage are Planning Policy Guidance Note 15 'Planning and the Historic Environment' (PPG15) and Planning Policy Guidance Note 16 'Archaeology and Planning' (PPG16) (Department of the Environment).

1.5 PPG16 (1990) is the national Planning Policy Guidance Note which applies to archaeology. It states that there should always be a presumption in favour of preserving nationally important archaeological remains *in situ*. However, when there is no overriding case for preservation, developers are required to fund opportunities for the recording and, where necessary, the excavation of the site. This condition is widely applied by local authorities.

1.6 PPG15 (1994) is the national Planning Policy Guidance Note which applies to conservation of the historic environment by protecting the character and appearance of Conservation Areas and protecting listed buildings (of architectural or historical interest) from demolition and unsympathetic change and safeguarding their settings as far as is possible. This condition is also widely applied by local authorities.

## **2 DESCRIPTION OF THE SITE**

2.1 The site is located in the Old Harlow, which lies to the immediate north east of Harlow New Town. Old Harlow is located within Harlow District of Essex County, and lies c. 0.5km to the east of the A414 road and c. 0.25km to the north of B183, Gilden Way. A railway line is located c. 1km to the north.

2.2 The site lies on the southern side of the High Street, Old Harlow within the Old Harlow Conservation Area. It is bounded to the east and west by neighbouring residential properties which front High Street. To the south east of the site a common is located. The site, in its north-western sector, is occupied by an 18<sup>th</sup> century Grade II listed house, Marigolds. The remaining part of the site fronting High Street is currently being developed. The proposed new house is situated in the southern part of the site within the large back garden. An existing swimming pool partially occupies the footprint of the proposed new dwelling.

### **3 TOPOGRAPHY, GEOLOGY AND SOILS**

3.1 The site is located to the south of valley of the river Stort and lies on relatively flat land at a height of c. 59-60m AOD, slightly rising to the south.

3.2 Soils in the vicinity are chalky tills of the Melford and Hanslope associations, described as deep, well drained fine or coarse loamy over clayey and fine loamy soils. The river alluvium to the immediate north, within Stort Valley, is of the Thames association and comprises stoneless, mainly calcareous clayey soils. The drift geology of the immediate area is Boulder Clay and glacial sand and gravel, with head deposits further east. The solid geology is London Clay, with a band of Upper Chalk locally (Soil Survey of England and Wales 1983).

### **4 ARCHAEOLOGICAL AND HISTORICAL BACKGROUND**

#### *Prehistoric*

4.1 A copper flat axe and an extensive late Bronze Age settlement in the town are recorded (Bedwin 1996). The Bronze Age settlement may include the earliest human cremation in the country, located in the centre of a pond barrow (Bedwin 1996). To the north-west of the present site lay a large temple. The latter became well-established in the Roman period but was originally constructed in the late pre-Roman Iron Age. Pre-Roman finds include a pit at the temple that contained the skull of a young adult, a bronze ring and an iron spear blade, dating to c.50 BC. It has been suggested that a prone burial at the temple is indicative of an execution or the discarding of an outcast (Bedwin 1996; Kemble 2001). To the south of the Old Town, at Church Langley, there is also evidence for activity ranging from the Palaeolithic to the early Iron Age (Medlycott 2000).

#### *Romano-British*

4.2 There is a considerable amount of evidence relating to Harlow's Roman past; the Roman town first grew in response to the foundation of a temple, in the north-western sector of modern Harlow. The temple was located on a hill which had previously been occupied by an Iron Age temple. A substantial area of occupation developed to the north and east of the temple during the Roman era, with evidence of masonry and timber buildings, an internal road pattern and manufacturing areas (Medlycott 1999).

4.3 The only extant monument dated to the Roman period is the temple hill. The plan of the temple is marked out in concrete, but no walls are visible. Three routes are known to have converged on the settlement; one ran south from the temple towards Epping, the second ran north-east from the river crossing and the third led north-west towards Braughing. It has been suggested that Old Road/Langley Lane may have been a Roman road. Harlow Mill would appear to be located close to the second of these roads,

that which ran north-east from the river crossing. Some traces of internal streets have been identified during excavations, but the results remain unpublished (Medlycott 1999).

### *Anglo-Saxon*

4.4 Three 5<sup>th</sup> to 6<sup>th</sup> century brooches have been discovered, suggesting that an early Saxon cemetery was positioned to the north of the modern town, in the valley of the river Lea. To the north of the temple site, early Saxon occupation is recognised by an earth-fast post structure, which lay above levels of Roman destruction, and has been interpreted as a sub-Roman individual or small group occupying the remains of a Roman structure (Bedwin 1996, 110).

### *Medieval, post-medieval and later*

4.5 Following settlement in the Roman period, Harlow developed at Harlowbury as a manorial centre, followed by the development of settlement at Churchgate during the later 11<sup>th</sup> century. Old Harlow, on the Dunmow-Hertford Road appears to have been a deliberate establishment by the dominant landowners, the Abbots of Bury St Edmunds, with the grant of a market and annual fair in 1218 (though a small settlement and market had been present in the reign of King Stephen). The settlement was centred on a row of properties on the southern side of Fore Street/High Street with the market place in front. As commonly happened, the market became infilled with further properties, with Midil Rowe on the north side and rows between Fore Street and Back Street.

4.6 It has been suggested that there was little use of the market place at Harlow prior to the 13<sup>th</sup> century (Andrews 1991), and the market was largely disbanded at the end of the 16<sup>th</sup> century, to continue only sporadically. At this time timber-framed buildings were probably built to replace the former market stalls with permanent structures. Archaeological excavations in Old Harlow have revealed evidence of 13<sup>th</sup> century structures on the north side of Market Street, identified by a series of post-holes. The structures were replaced by further timber-framed structures during the following century, interpreted as market stalls. Another building was later built on the same part of Market Street in the 17<sup>th</sup> century (Andrews 1991). The current site lies within an area of the medieval and post-medieval town.

4.7 An archaeological evaluation carried out by AS in 2009 in northern part of the site (Pozorski 2009) revealed the remains of the 19<sup>th</sup> century building that occupied this part of the site until its recent demolition. It also revealed a Victorian well and a more recent pumping chamber.

## **5 METHODOLOGY**

5.1 One trench was excavated using a mechanical 360° excavator fitted with a toothless ditching bucket (Fig. 2). The trench location was approved by

ECC HEM and was situated within the footprint of the proposed dwelling. The trench measured 12 x 1.60m.

6.2 Topsoil and undifferentiated overburden were mechanically excavated under close archaeological supervision. Exposed surfaces were cleaned by hand and examined for archaeological features. Deposits were recorded using *pro forma* recording sheets, drawn to scale, and photographed as appropriate. Excavated spoil was searched for finds and the trenches were scanned by a metal detector.

## 6 DESCRIPTION OF RESULTS

### Trench 1 (Fig. 2, DP 3-4)

<i>Sample section 1 (DP 5): E end, S facing</i>		
<i>0.00 = 60.21m AOD</i>		
0.00 – 0.10m	L2000	Topsoil. Mid to dark greyish brown, soft, sandy silt.
0.10 – 0.66m	L2001	Made ground. Mid greyish brown, compact, sandy silt with occasional CBM fragments.
0.66m +	L2002	Natural mid yellow, compact, clay with flint gravel.

<i>Sample section 2 (DP 6): W end, S facing</i>		
<i>0.00 = 60.26m AOD</i>		
0.00 – 0.09m	L2000	Topsoil. As above.
0.09 – 0.61m	L2001	Made ground. As above.
0.61m +	L2002	Natural clay. As above.

*Description:* No archaeological features or finds were present.

## 7 CONFIDENCE RATING

7.1 It is not felt that any factors inhibited the recognition of archaeological features or finds.

## 8 DEPOSIT MODEL

8.1 The site was commonly overlain by Topsoil L2000, a mid to dark greyish brown, soft, sandy silt (0.08 – 0.10m thick). The most substantial deposit encountered during the evaluation was a layer of made ground L2001. It was a mid greyish brown, compact, sandy silt with occasional early modern/modern CBM fragments and it measured 0.50 – 0.60m in thickness.

8.2 The natural clay, L2002, was present at 0.60 – 0.66m below existing ground level and comprised a mid yellow, compact, clay with flint gravel mostly accumulated on the top of the clay in irregular clusters.



## 9 DISCUSSION

9.1 The site had a potential for archaeological remains, in particular for the medieval and post-medieval remains related to the settlement of Old Harlow. There was also possibility of prehistoric and Roman remains to be present on the site.

9.2 In the event no archaeological features or finds were revealed. No indication of any previous development of the southern part of the site was identified. The layer of made ground (L2001) may have been created during early modern/modern landscaping works within the garden. No residual finds were recovered.

## 10 DEPOSITION OF THE ARCHIVE

10.1 Archive records, with an inventory, will be deposited with any donated finds from the site at Harlow Museum. The archive will be quantified, ordered, indexed, cross-referenced and checked for internal consistency.

## ACKNOWLEDGEMENTS

Archaeological Solutions would like to thank Mr Stephen Levy of EXE Property Developments for his co-operation and funding of the project, and for his assistance.

AS would also like to thank Mr Nick Gunn for his assistance.

AS is also pleased to acknowledge the input and advice of Mr Adam Garwood of Essex County Council Historic Environment Management.

## BIBLIOGRAPHY

Andrews, D., 1991, *An archaeological sequence at the edge of Old Harlow Marketplace*. In: *Essex Archaeology & History*

Bedwin, O. (ed.), 1996, *The Archaeology of Essex: Proceedings of the 1993 Writtle Conference*. EEC

British Geological Survey (BGS), 1978, *Legend for the 1:625,000 Geological map of the United Kingdom (solid geology)*; London. Mansfield

Gurney, D., 2003, *Standards for Field Archaeology in the East of England*, East Anglian Archaeology Occasional Papers 14/ALGAO

Institute of Field Archaeologists (IFA), 1994 (revised 2001), *Standard and Guidance for Archaeological Desk-Based Assessments*. IfA, Reading

Institute of Field Archaeologists, 1994, (revised 2001), *Standard and Guidance for Archaeological Field Evaluations*. IfA, Reading

Medlycott, M., 1999, *Harlow: Historic Town project Assessment Report*. ECC

Medlycott, M., 2000 *Prehistoric, Roman and post-medieval material from Harlow: investigations at Church Langley 1989-1994*. In: *Essex Archaeology & History* 31:33-93

Kemble, J., 2001, *Prehistoric and Roman Essex*. Tempus

Pozorski, Z., 2009, *Marigolds, 64 High Street, Old Harlow, Harlow, Essex. An Archaeological Evaluation*, AS Unpublished Report No. 3372

Soil Survey of England and Wales (SSEW), 1983, *Legend for the 1:250,000 Soil Map of England and Wales*. SSEW, Harpenden

## APPENDIX 1

## ESSEX HERITAGE AND CONSERVATION RECORD (EHCR)

EHCR	NGR TL	Description
<b>Prehistoric</b>		
3643	470 116	A few sherds of residual prehistoric pottery and a small number of Neolithic flint tools (scrapers and blades) were recovered in 1989 to the east of the church
9123	4717 1158	13 pieces of residual worked flint including cores, flakes and a rod fabricator. The latter is probably Mesolithic/early Neolithic, also a single rim sherds was found, probably from a simple flint-tempered coarse-ware bowl (not closely datable)
<b>Roman</b>		
9124	4717 1158	Roman brick and tile fragments, including a piece of combed box flue tile. Copper alloy objects consisted of a 3 <sup>rd</sup> century barbarous radiate, and a Hod Hill-type brooch. 6 pot sherds were recovered comprising a sandy grey ware, Hadham Oxidised Ware, and Samian (?South Gaulish)
<b>Medieval</b>		
3642	470 116	St Johns Church, some medieval pottery found to the east of the church in 1989
9122	471 115	Old Harlow – the medieval township of Harlow, now known as Old Harlow, grew up after the grant in 1218 of a Monday market and annual fair to abbot Hugh II of the Abbey of Bury St Edmunds, who held the manor of Harlowbury. The market place lies half a mile SE of Harlowbury, beside the junction of the north-south London to Epping to Newmarket Road, and the east-west Hertford to Dunmow road. The Rentals of 1302 and 1430 list 54 tenants in the market place. It is possible that an earlier market may have been held on this site during the reign of Stephen
9125	4717 1158	A sequence commenced with a structure built with earth-fast posts, datable to the 13 <sup>th</sup> century, which was succeeded by a more permanent building dating to the 13 <sup>th</sup> –14 <sup>th</sup> century
<b>Post-medieval</b>		
3617	470 116	Post-med finds made to the east and west of the church of St John the Baptist, 18 <sup>th</sup> and 19 <sup>th</sup> century pottery noted in sand pits, may reflect commercial sand extraction or backfilling
3641	4709 1162	Church of St John the Baptist, brick church built 1839-41 as a chapel of ease to the medieval church of St Mary the Virgin. In 1857 it became a parish church in its own right but in 1923 the two parishes were reunited. Made redundant in 1977
9126	4717 1158	A layer of gravel covering the entire site seems to represent a major renewal of the market surface c. 16 <sup>th</sup> –17 <sup>th</sup> century. On this was constructed a timber framed building which probably underwent several phases of reconstruction before being demolished in the 20 <sup>th</sup> century

## PHOTOGRAPHIC INDEX



DP 1. Marigolds, 64 High Street, Old Harlow, Essex. View S.



DP 2. Land rear of Marigolds. View NE.



DP 3. Trench 1. View SW.



DP 4. Trench 1. View W.



DP 5. Trench 1, E end. Sample section 1. View N.



DP 6. Trench 1, W end. Sample section 2. View N.

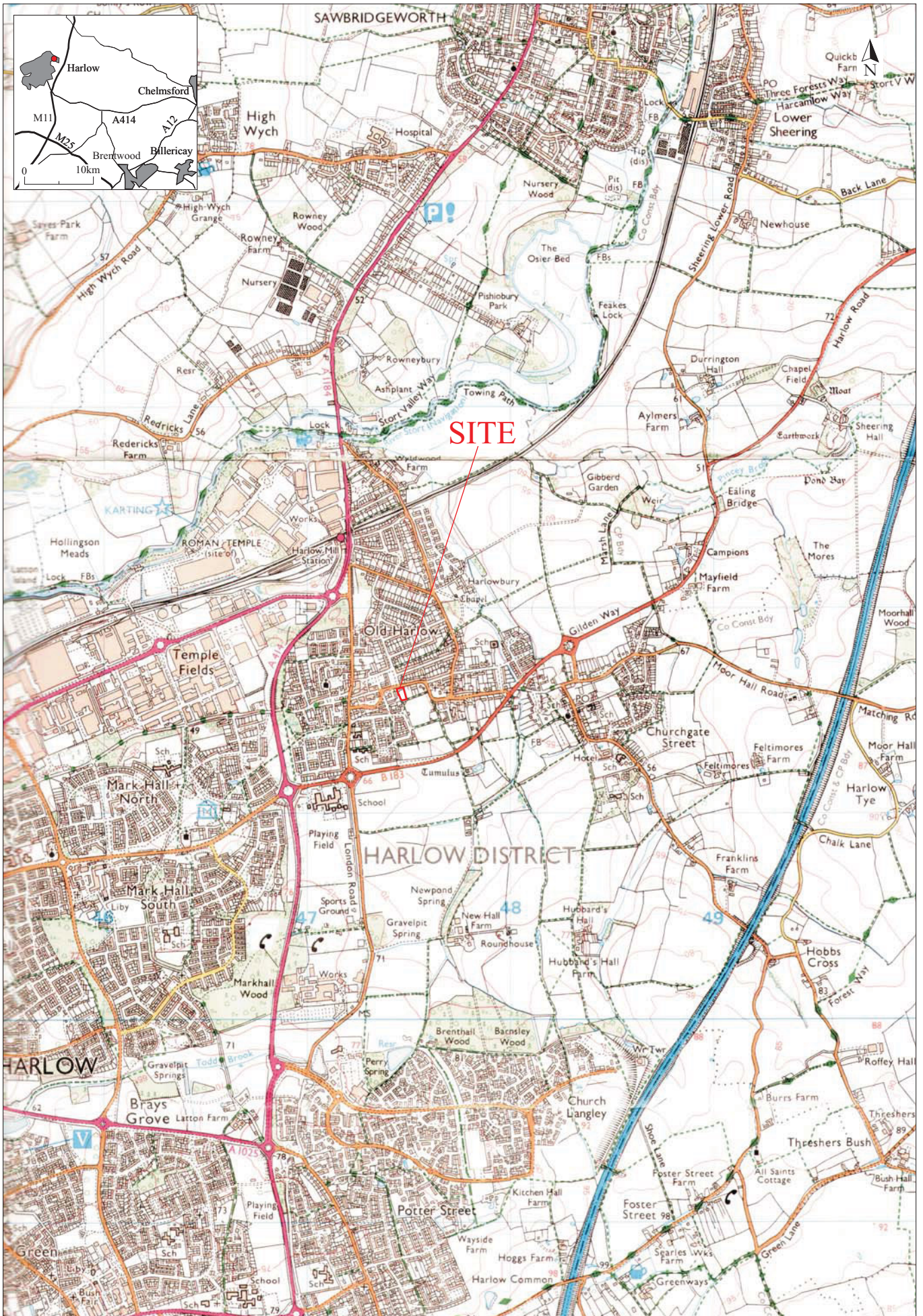

Reproduced from the 2000 Ordnance Survey 1:25000 map with the permission of Her Majesty's Stationery Office. © Crown copyright Archaeological Solutions Ltd Licence number 100036680

*Archaeological Solutions Ltd*  
**Fig. 1 Site location plan**  
 Scale 1:25,000 at A4

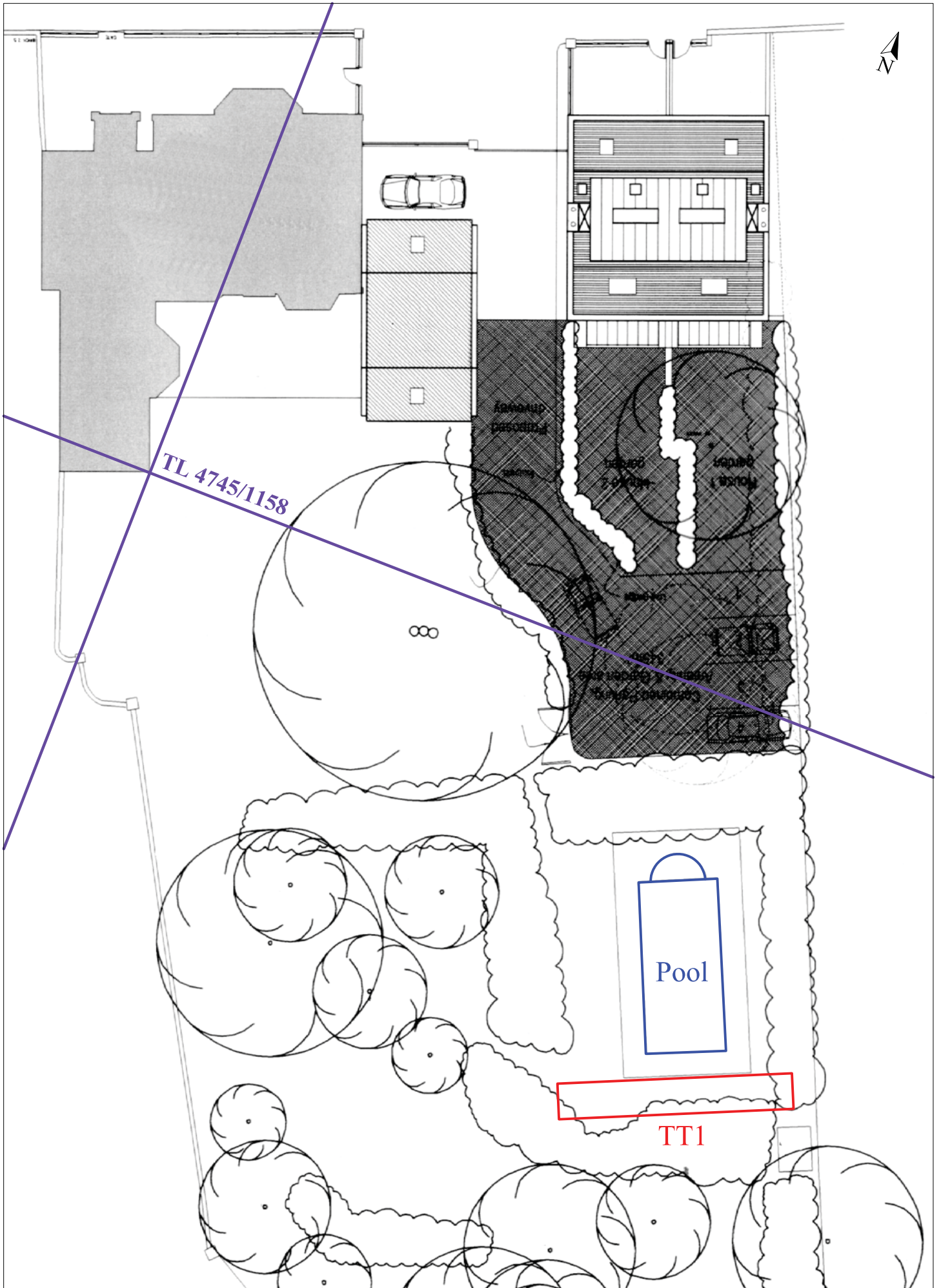

0 15m

Archaeological Solutions Ltd  
**Fig. 2 Trench location plan**  
 Scale 1:250 at A4

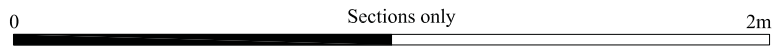
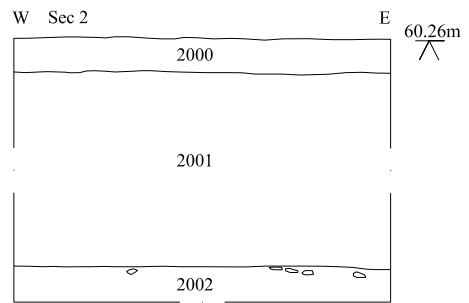
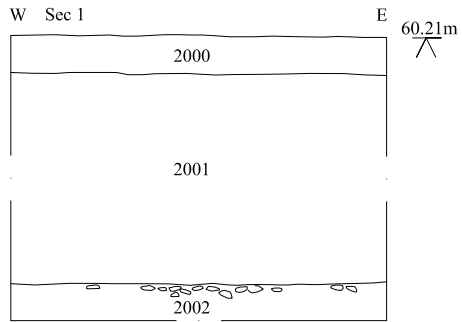

<i>Archaeological Solutions Ltd</i>
<b>Fig. 3 Sections</b>
Scale 1:50 at A4