

**T H A M E S      V A L L E Y**

**—ARCHAEOLOGICAL**

**S E R V I C E S**

**48 Highfield Lane, Maidenhead,  
Berkshire**

**Archaeological Watching Brief**

**by Andy Muddin**

**Site Code: 48HLM13/82**

**(SU 8651 7959)**

**New garage, 48 Highfield Lane,  
Maidenhead, Berkshire**

**An Archaeological Watching Brief**

**For Mr Mario Scozzari**

by Andrew Muddin

Thames Valley Archaeological Services Ltd

Site Code  
48HLM 13/82

**June 2013**

## Summary

**Site name:** 48 Highfield Lane, Maidenhead, Berkshire

**Grid reference:** SU 8651 7959

**Site activity:** Watching Brief

**Date and duration of project:** 6th June 2013

**Project manager:** Steve Ford

**Site supervisor:** Andrew Munding

**Site code:** 48HLM 13/82

**Area of site:** 27 sq m

**Summary of results:** The digging of new foundation trenches for a garage, were observed. No archaeological deposits were encountered nor artefacts recovered.

**Location and reference of archive:** The archive is presently held at Thames Valley Archaeological Services, Reading and will be deposited at an appropriate local depository in due course.

*This report may be copied for bona fide research or planning purposes without the explicit permission of the copyright holder. All TVAS unpublished fieldwork reports are available on our website:  
[www.tvas.co.uk/reports/reports.asp](http://www.tvas.co.uk/reports/reports.asp).*

Report edited/checked by: Steve Ford ✓ 07.06.13 Steve Preston ✓ 07.06.13
---

# **New Garage, 48 Highfield Lane, Maidenhead, Berkshire An Archaeological Watching Brief**

by Andrew Muddin

**Report 13/82**

## **Introduction**

This report documents the results of an archaeological watching brief carried out at 48 Highfield Lane, Maidenhead. SL6 3AU (SU 8651 7959) (Fig. 1). The work was commissioned by Mr Stuart Keen, Architect of SKD Design, on behalf of the homeowner, Mr Mario Scozzari.

Planning permission (app no. 12/02766/FUL) has been gained from the Royal Borough of Windsor and Maidenhead for the construction of a new garage to adjoin the annexe at the front of the site (Fig. .3). The consent is subject to a condition requiring the implementation of a watching brief to be carried out during groundworks for the new garage.

This is in accordance with the Department for Communities and Local Government's *National Planning Policy Framework* (NPPF 2012) and the Royal Borough's policies on archaeology. The work was carried out to a written scheme of investigation approved by Ms Fiona MacDonald, Principal Archaeologist for Berkshire Archaeology, advisers to the Royal Borough on matters pertaining to archaeology in the planning process. This specification was based on a brief prepared for the site also by Berkshire Archaeology (Jervis 2012). The fieldwork was undertaken by Andrew Muddin on 6th June 2013 and the site code is 48HLM 13/82.

The archive is presently held at Thames Valley Archaeological Services, Reading and will be deposited with an appropriate local depository in due course.

## **Location, topography and geology**

The site is located in the Cox Green suburb of Maidenhead, on the north east side of junction of Highfield Lane and St. Chads Road (Fig. 2). Cox Green lies to the south of the A4 (Bath Road), and is to the south west of the centre of Maidenhead. The site is a private residence with a detached annexe building, which does not appear of the modern Ordnance Survey map, to the south of the main house accessed by the main drive. The garage will attach to the northern side of this annexe. The underlying geology is Upper Chalk, capped by glacial silts and clays (BGS 1981). A grey silty clay and a brown clay was identified at the base of excavation representing natural geology and chalk, was only uncovered at the very foot of excavation of the eastern side. The site lies at a height of approximately 39m above Ordnance Datum (OD).

## **Archaeological background**

The archaeological potential of the site has been described in a brief for the project issued by Berkshire Archaeology (Jervis 2012). In summary, several areas have been identified in the Berkshire Historic Environment Record (HER), which shows that this part of Maidenhead is relatively rich in finds of Prehistoric and Roman date (Ford 1987). One in particular identifies Roman remains have been located 400m north east from the site. This site known as a winged corridor Roman Villa and was partially excavated in 1959 (Bennett 1962). Other evidence locates prehistoric remains, which includes Middle Bronze Age/Late Bronze Age pottery and flint being found at new development on the southern part of the Cox Green School site, 250m south west of the current site (McNicoll-Norbury 2008).

## **Objectives and methodology**

The purpose of the watching brief was to excavate and record any deposits affected by groundworks. This would include areas of all new footings. All drainage was to be connected at the south-west corner to existing drainage for the annexe. The brief specified that should any remains be uncovered, all efforts should be made to date, characterise, and mark their extents, and discuss their significance in relation to the nearby Roman and Prehistoric remains (Jervis 2012).

## **Results**

New footing trenches were dug measuring 4.5m by 6m long and 0.75m wide. All footing reached a maximum depth of 1m deep. A generally undisturbed lower stratigraphy was identified. Site overburden reach a depth of 0.4m which contained at least two modern drainage pipes and a telecoms cable. The southern pipe joined an existing soakaway on the south-west corner of the excavation (Fig. 3). Underlying this was an orange brown sandy silt, which contained no finds (Pl.2). This layer reached a depth of the west side of excavation to 0.8m and the east side 0.73m. Under this were natural geological deposits which comprised a grey silty clay which in turn overlay chalk which was only partially exposed at the very bottom of the eastern trench (Pl.1). No archaeological finds or deposits of interest were uncovered during the groundworks.

## **Conclusion**

Though in a location with the potential of uncovering Roman and Prehistoric deposits, No finds nor deposits of archaeological interest were revealed by the groundworks.

## **References**

- Bennett, C M, 1962, 'Cox Green Villa', *Berkshire Archaeo J* **60**, 62-91  
BGS, 1981, *British Geological Survey*, 1:50 000, Sheet 269, Solid and Drift Edition, Keyworth  
Ford, S, 1987, '*East Berkshire Archaeological Survey*', Berkshire County Council Dept Highways and Planning Occas Pap **1**, Reading  
Jervis, B, 2012, 'Quoins, 48 Highfield Lane, Maidenhead, brief for an Archaeological Watching Brief', Berkshire Archaeology Brief, Reading  
McNicol-Norbury, J, 2008. 'Holyport Manor School, Highfield Lane, Cox Green, Maidenhead, Berkshire, Phase B, an archaeological recording action', Thames Valley Archaeological Services rep 08/87b, Reading  
NPPF 2012, *National Planning Policy Framework*, Dept Communities and Local Govt, London

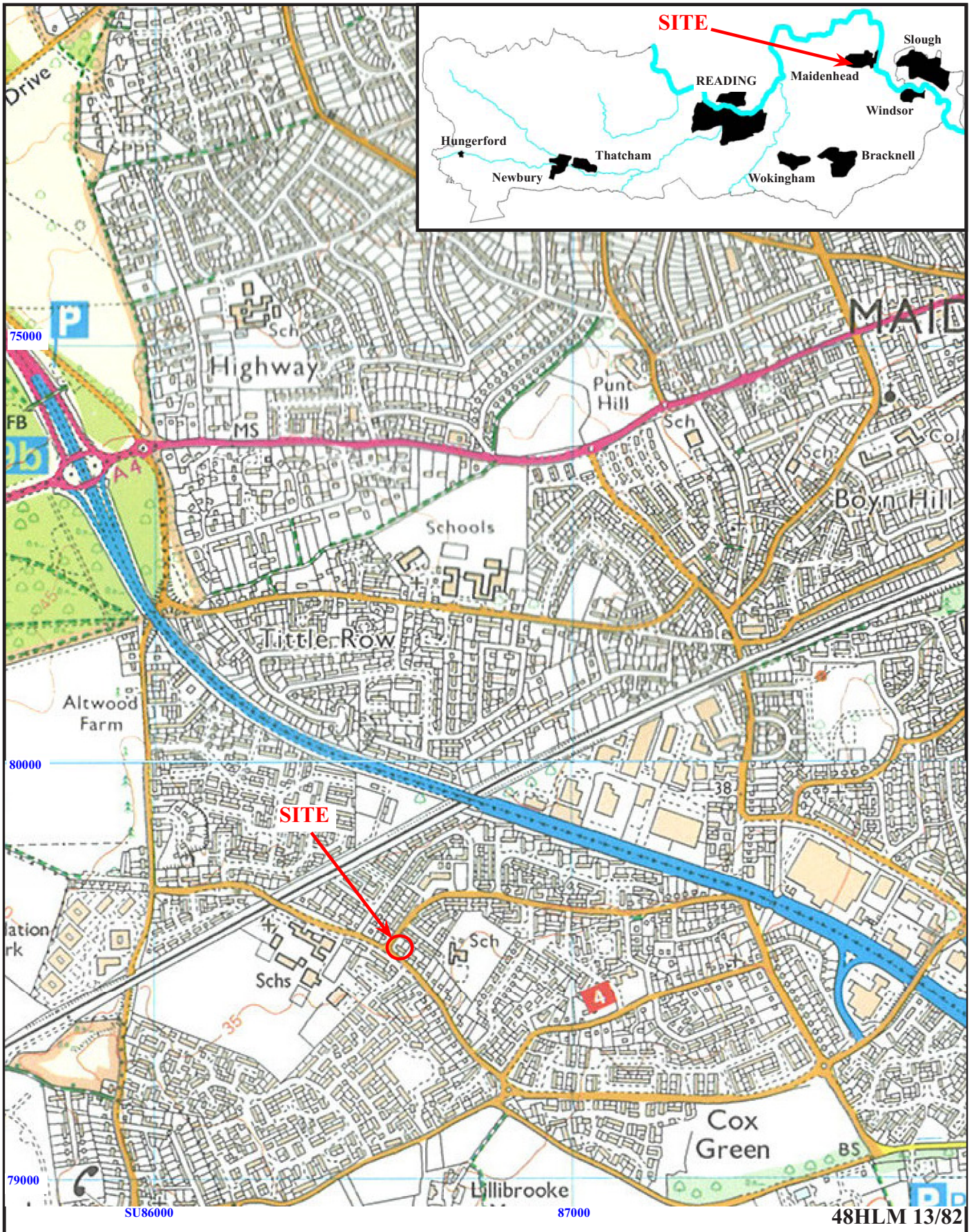

**48 Highfield Lane, Maidenhead,  
Berkshire, 2013**  
**Archaeological watching brief**

Figure 1. Location of site within Maidenhead and Berkshire.

Reproduced from Ordnance Survey Explorer 160 and 172 at 1:12500  
Ordnance Survey Licence 100025880

THAMES VALLEY  
ARCHAEOLOGICAL  
SERVICES

48HLM 13/82

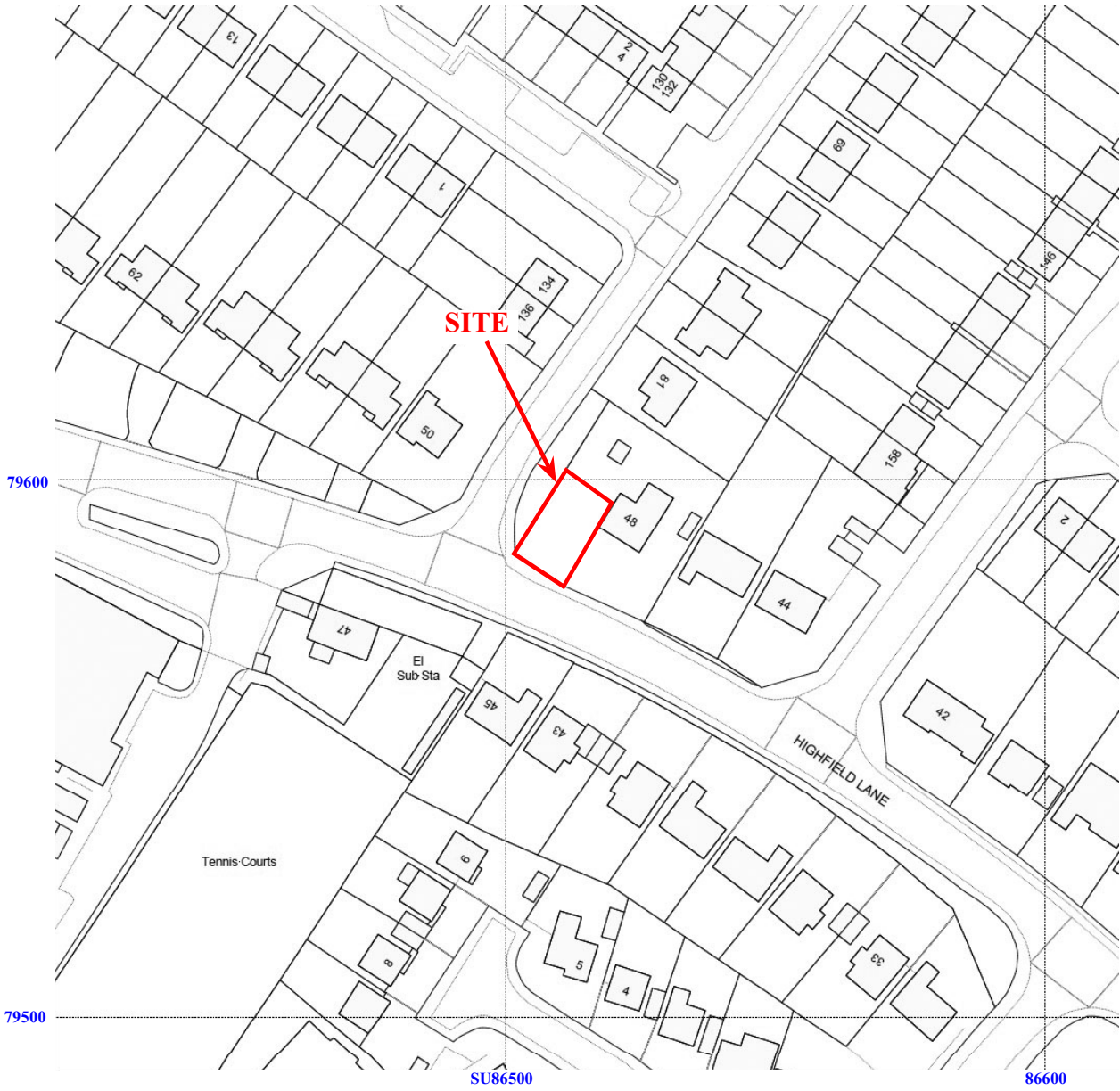

48HLM 13/82



**48 Highfield Lane, Maidenhead, Berkshire, 2013**  
**Archaeological watching brief**

Figure 2. Detailed location of site off Highfield Lane.

Reproduced from Ordnance Survey digital mapping under licence.  
 Crown copyright reserved. Scale: 1:1250

THAMES VALLEY  
 ARCHAEOLOGICAL  
 SERVICES



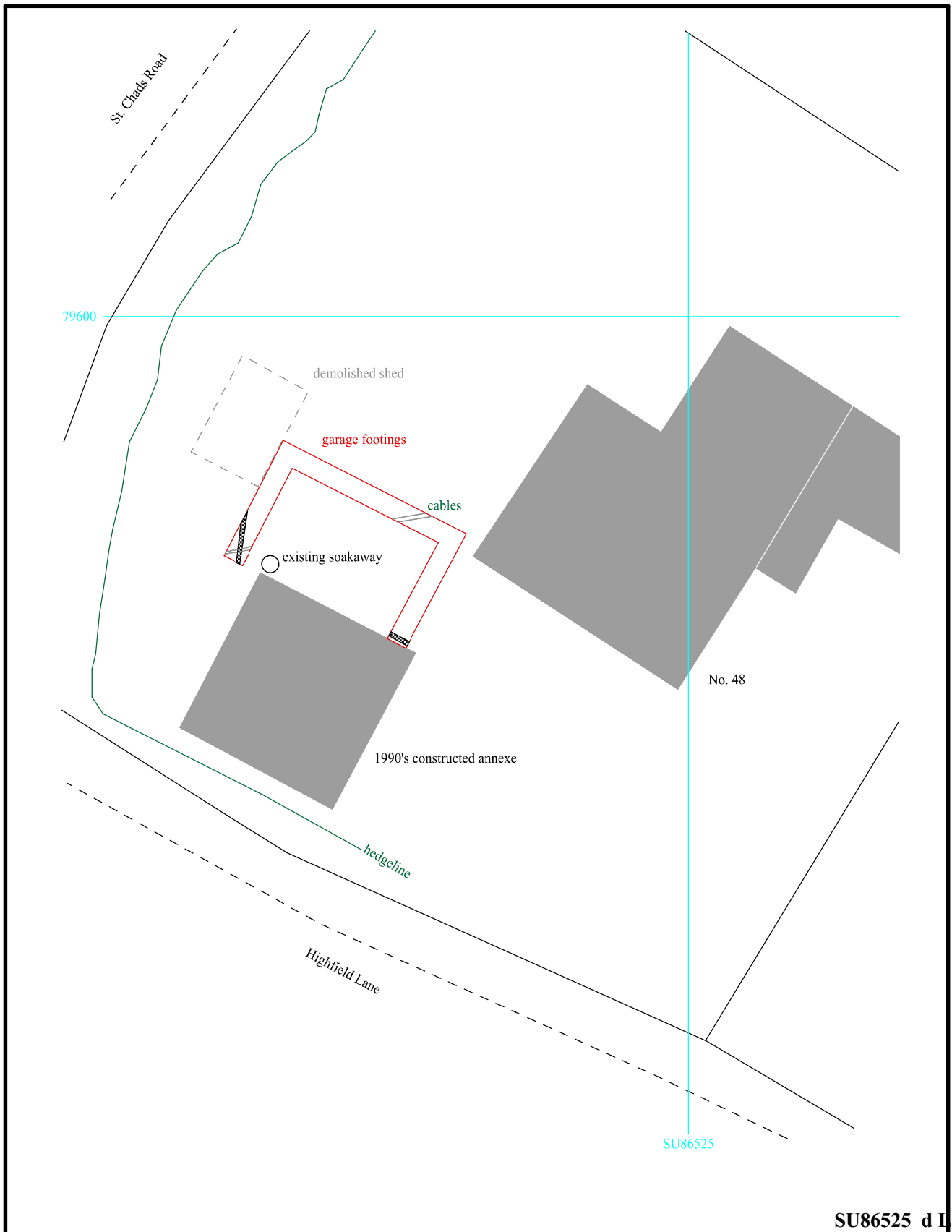

SU86525 d I



**48 Highfield Lane, Maidenhead,  
Berkshire, 2013**  
**Archaeological watching brief**

Figure 3. Location of observed area.



THAMES VALLEY  
ARCHAEOLOGICAL  
SERVICES

NW

SE

39maOD

Topsoil overburden

Orangey brown sandy silt (subsoil?)

Grey silt clay (Natural geology)

base of footing

48HLM 13/82

**48 Highfield Lane, Maidenhead,  
Berkshire, 2013  
Archaeological watching brief**

Figure 4. Representative sections.



THAMES VALLEY  
ARCHAEOLOGICAL  
SERVICES



Plate 1. Front of garage (eastern) footing under excavation.



Plate 2. Representative section, looking west, Scale: 1m.

48HLM 13/82

48 Highfield Lane, Maidenhead,  
Berkshire, 2013  
Archaeological watching brief  
Plates 1 and 2.

THAMES VALLEY  
ARCHAEOLOGICAL  
SERVICES

## TIME CHART

	<b>Calendar Years</b>
Modern _____	AD 1901
Victorian _____	AD 1837
Post Medieval _____	AD 1500
Medieval _____	AD 1066
Saxon _____	AD 410
Roman _____	AD 43
Iron Age _____	BC/AD 750 BC
Bronze Age: Late _____	1300 BC
Bronze Age: Middle _____	1700 BC
Bronze Age: Early _____	2100 BC
Neolithic: Late .....	3300 BC
Neolithic: Early .....	4300 BC
Mesolithic: Late .....	6000 BC
Mesolithic: Early .....	10000 BC
Palaeolithic: Upper .....	30000 BC
Palaeolithic: Middle .....	70000 BC
Palaeolithic: Lower .....	2,000,000 BC



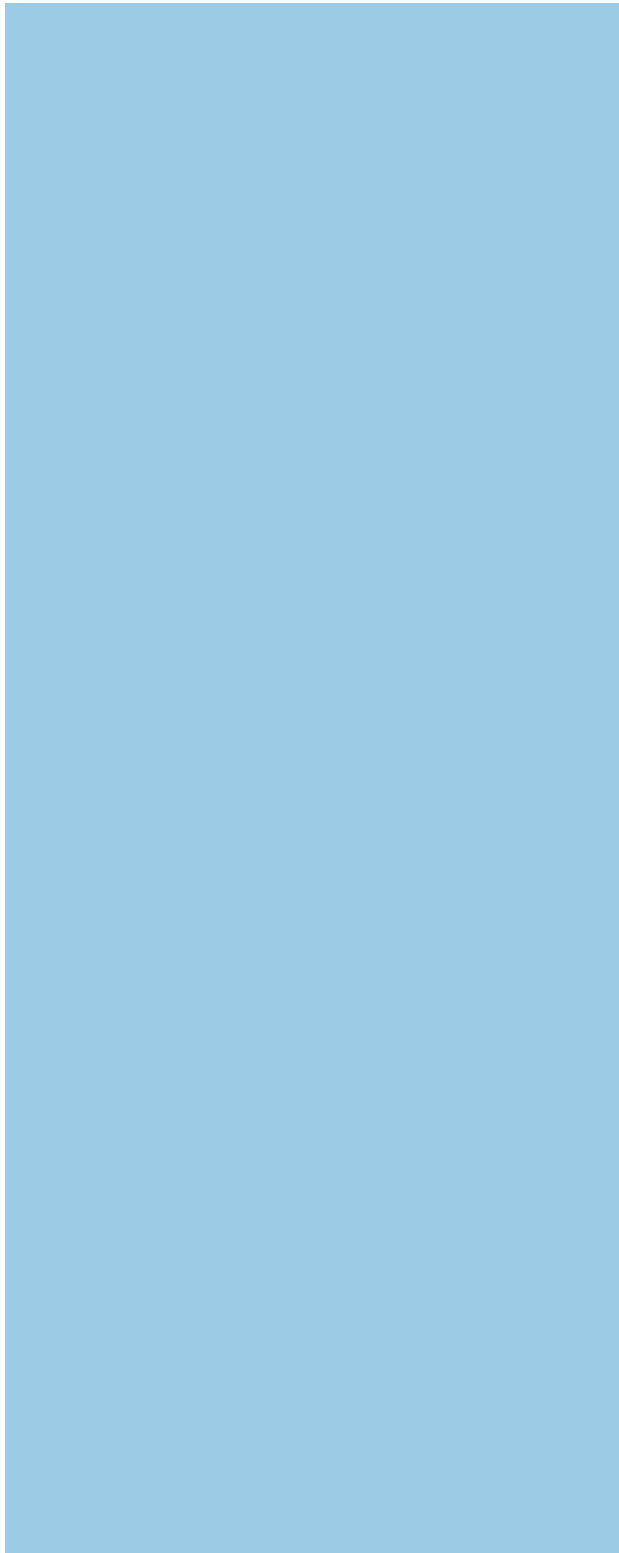
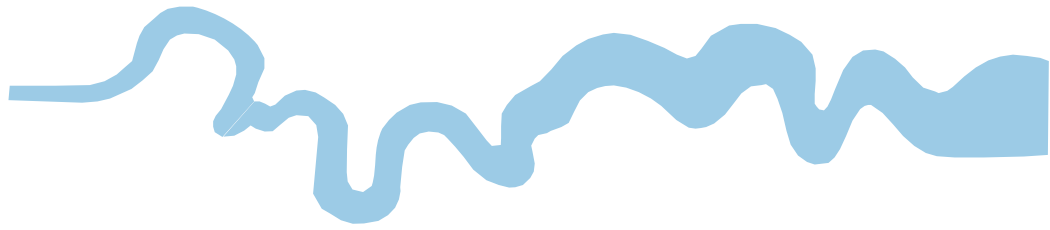

**Thames Valley Archaeological Services Ltd,  
47-49 De Beauvoir Road, Reading,  
Berkshire, RG1 5NR**

**Tel: 0118 9260552  
Fax: 0118 9260553  
Email: [tvas@tvas.co.uk](mailto:tvas@tvas.co.uk)  
Web: [www.tvas.co.uk](http://www.tvas.co.uk)**