

**Radical Club, 314a Fratton Road, Fratton,  
Portsmouth, Hampshire**

**An Archaeological Watching Brief  
For T Ware Developments Limited**

by Sean Wallis and Andrew Weale  
Thames Valley Archaeological Services Ltd

Site Code RFP 06/66

**January 2007**

## Summary

**Site name:** Radical Club, 314a Fratton Road, Fratton, Portsmouth, Hampshire

**Grid reference:** SU 65200 01075

**Site activity:** Watching Brief

**Date and duration of project:** 2nd – 7th November 2006

**Project manager:** Steve Ford

**Site supervisor:** Sean Wallis

**Site code:** RFP 06/66

**Summary of results:** No archaeologically relevant finds or features were seen.

**Monuments identified:** None.

**Location and reference of archive:** The archive is presently held at Thames Valley Archaeological Services, Reading and will be deposited at Portsmouth Museum in due course,

*This report may be copied for bona fide research or planning purposes without the explicit permission of the copyright holder*

Report edited/checked by:	Steve Ford✓ 12.01.07 Steve Preston✓ 12.01.07
---------------------------	---

**Radical Club, 314a Fratton Road, Fratton, Portsmouth, Hampshire.  
An Archaeological Watching Brief**

by Andrew Weale and Sean Wallis

**Report 06/66**

## **Introduction**

This report documents the results of an archaeological watching brief carried out at the Radical Club, 314a Fratton Road, Fratton, Portsmouth, Hampshire (SU 65200 01075) (Fig. 1). The work was commissioned by Mr Andy Howe of A and A Groundworks Limited, Unit R, Military Road, Fort Wallington Industrial Estate, Fareham, Hampshire, PO16 8TT.

Planning consent (A\*24996/AC) was granted by Portsmouth City Council to construct 2 two-storey buildings to form a terrace of three houses, and a terrace of one house and four flats within the grounds of the Radical Club. The site lies adjacent to Fratton Road, on the northern part of Fratton, on the north-eastern outskirts of Portsmouth. The consent was subject to a condition (5) relating to archaeology, requiring an archaeological watching brief to be carried out during ground disturbance.

This is in accordance with the Department of the Environment's Planning Policy Guidance, *Archaeology and Planning* (PPG16 1990), and the City's policies on archaeology. The field investigation was carried out to a specification approved by Ms Jenny Stevens (former) Archaeology and Events Officer with the Museums and Records Service, advisers to Portsmouth City Council on archaeology. The fieldwork was undertaken by Sean Wallis between 2nd June and 7th November 2006 and the site code is RFP 06/66.

The archive is presently held at Thames Valley Archaeological Services, Reading and will be deposited at Portsmouth Museum in due course.

## **Location, topography and geology**

The site is located in north-east Portsmouth, on land previously occupied by the Radical Club adjacent to Fratton Road (Fig. 2). It is bounded on three sides by existing buildings and extends over what was, prior to demolition for redevelopment, part of the Radical Club buildings. According to the geological survey map the site lies on the Aeolian Deposits ('Brickearth') (BGS 1946). The site slopes gently to the south and lies at a height of *c.* 7m above ordnance Datum.

## **Archaeological background**

The archaeological potential for the site derives from the fact that it lies on Portsea Island adjacent to one of the main north-south access roads onto the island and within an area from which medieval deposits have been previously recorded. Fratton Manor covered an area of the south central portion of Portsea Island and was documented in late Saxon times as *Frodingtune*. The manor is also documented in medieval times as Froddington and later called Fratton which was probably administered from Southwick Priory. In the Domesday Survey of Hampshire Fratton was recorded as the only Hampshire holding of William of Warenne and was assessed at 4 hides with a population of 12 (Munby 1982).

## **Objectives and methodology**

The purpose of the watching brief was to excavate and record any archaeological deposits affected by the groundworks. This was to include examination of all areas of intrusive groundworks, in particular any ground reduction, and the digging of foundation trenches and service runs.

## **Results**

Following removal of an existing concrete floor slab, the ground beam trenches were excavated in stages. For the eastern block (Fig. 3) the groundbeam trenches were 1.05m deep and 0.65m wide and encountered natural deposits of brickearth at a depth of approximately 0.4m below surface level. Above this was approximately 0.2m of buried topsoil with 0.2m of mixed demolition rubble and soil above it. For the western block (Fig. 3) the groundbeam trenches were 1.0m deep and 0.65m wide and encountered natural deposits of brickearth at a depth of approximately 0.6m below surface level. Above this again was approximately 0.2m of buried topsoil with 0.4m of mixed demolition rubble and soil above it (Fig. 4). The disturbance by previously existing footings and services increases in depth towards the west and south of the site reaching a maximum depth 0.9m on the southern most groundbeam trench of the western block.

Apart from modern service runs, no deposits of archaeological interest were observed.

## **Finds**

No finds of archaeological interest were recovered.

## **Conclusion**

In conclusion, no deposits of archaeological interest were observed nor artefacts recovered during the watching brief for the groundworks on this site.

## **References**

BGS, 1946, *British Geological Survey*, 1:50000, Sheet 216, Drift Edition, Keyworth  
PPG 16, 1990, *Archaeology and Planning*, Dept of the Environment Planning Policy Guidance 16, HMSO  
Munby, J (ed), 1982, *Hampshire Domesday Book*, Phillimore Chichester

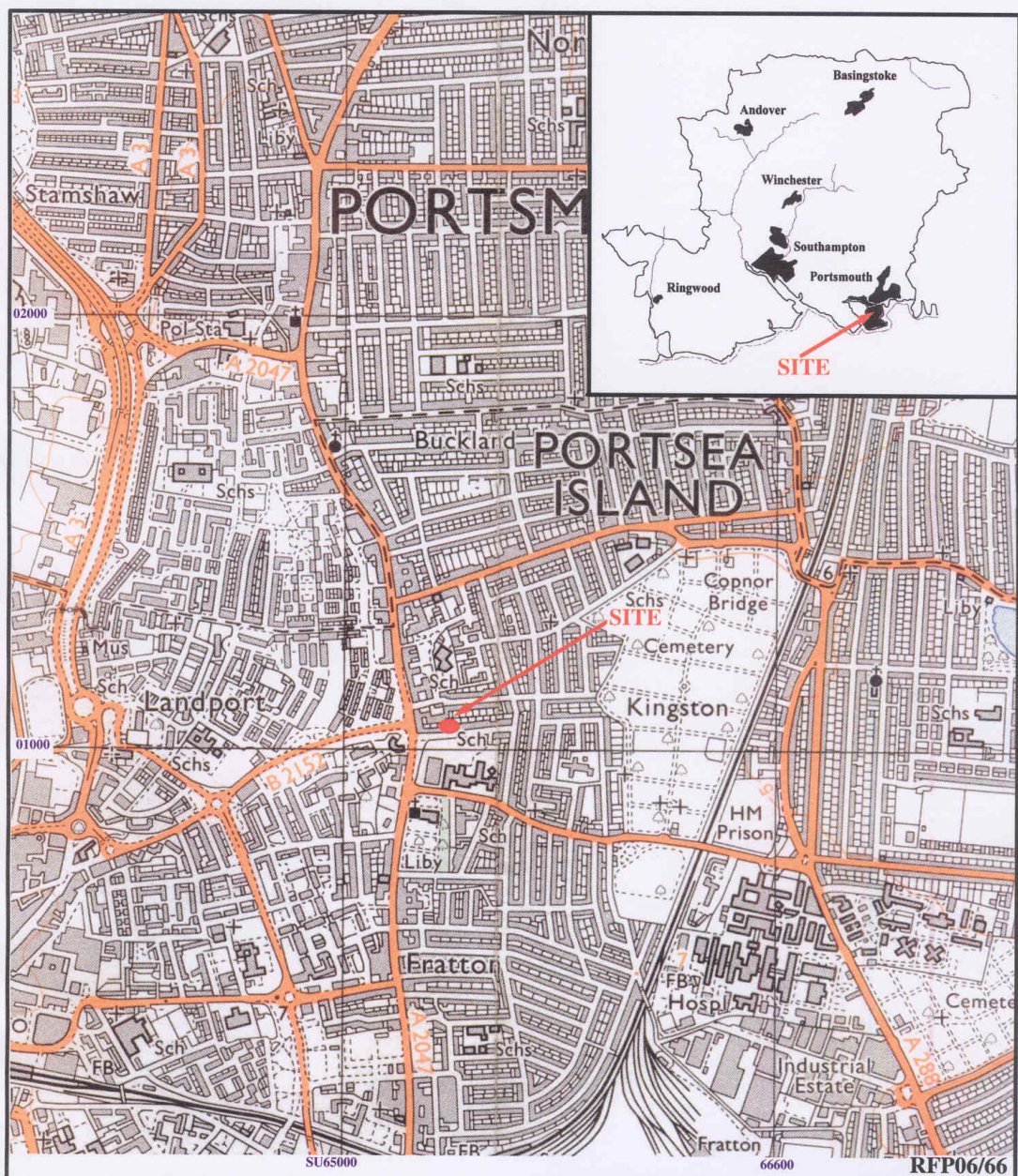

**Radical Club, 314a Fratton Road, Fratton,  
Portsmouth, Hampshire, 2006  
An Archaeological Watching Brief**

Figure 1. Location of site within Portsmouth and  
Hampshire.

Reproduced from Ordnance Survey Pathfinder 1304 SU60/70  
at 1:12500  
Ordnance Survey Licence 100025880

THAMES VALLEY  
ARCHAEOLOGICAL  
SERVICES





RFP06/66

**Radical Club, 314a Fratton Road, Fratton,  
Portsmouth, Hampshire, 2006  
An Archaeological Watching Brief**

Figure 2. Detailed location of site within Fratton.

Scale: 1:1250

T H A M E S   V A L L E Y  
ARCHAEOLOGICAL  
S E R V I C E S

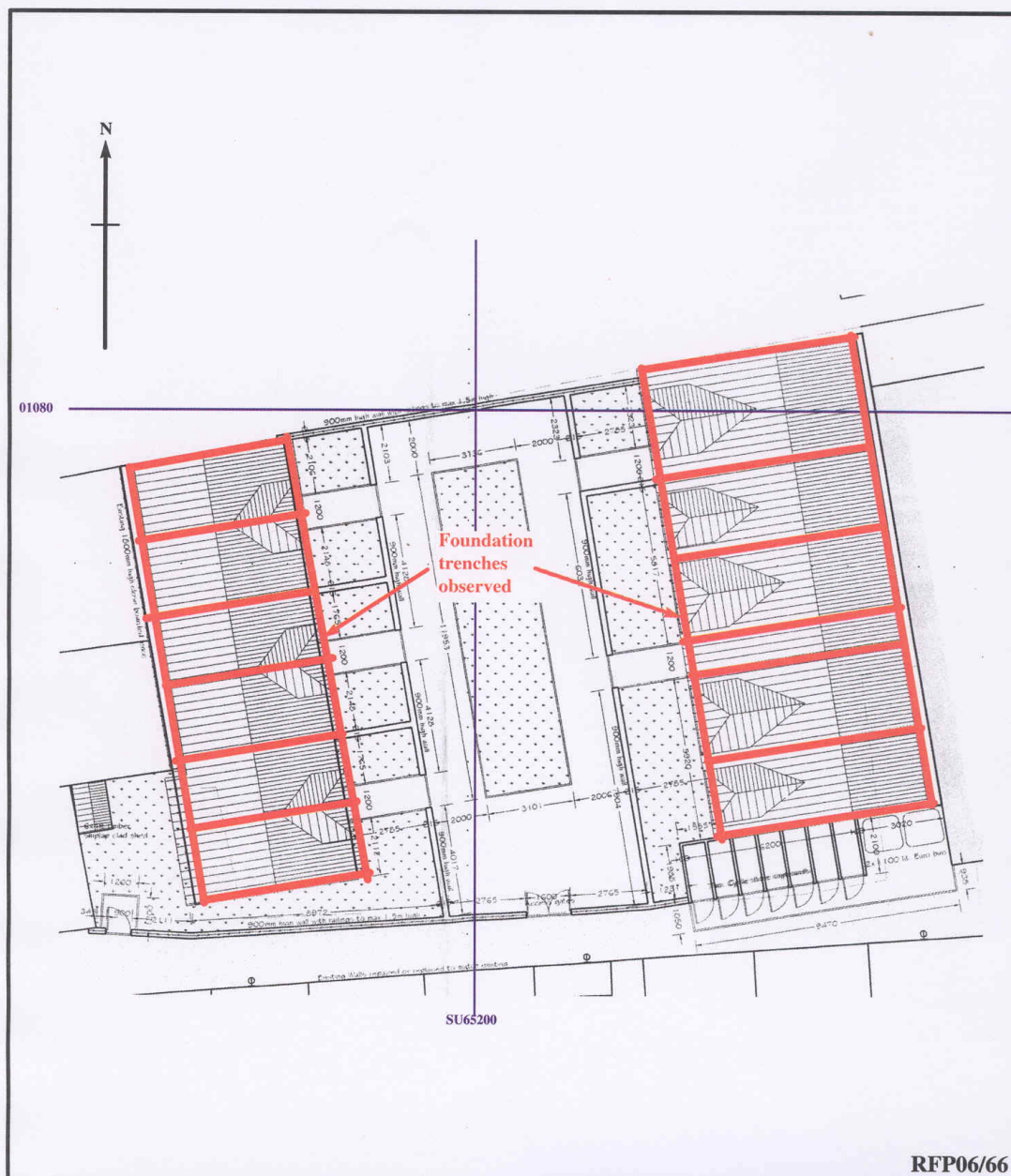

**Radical Club, 314a Fratton Road, Fratton,  
Portsmouth, Hampshire, 2006  
An Archaeological Watching Brief**

Figure 3. Areas observed in watching brief.

Scale: 1:200

THAMES VALLEY  
ARCHAEOLOGICAL  
SERVICES



## Radical Club, 314A Fratton Road, Fratton, Portsmouth, 2006

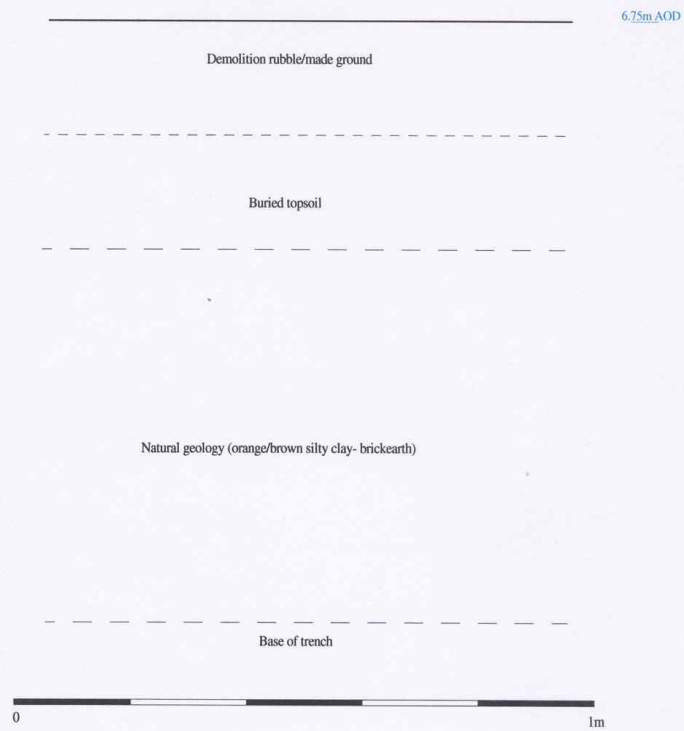

Figure 4. Representative section

RFP06/66