

T H A M E S V A L L E Y

ARCHAEOLOGICAL

S E R V I C E S

S O U T H

**Handford House, Lancing College,
Lancing, West Sussex**

Archaeological Watching Brief

by Sean Wallis

Site Code: LCL14/148

(TQ 1937 0665)

Handford House, Lancing College, Lancing, West Sussex

An Archaeological Watching Brief

For Lancing College

by Sean Wallis

Thames Valley Archaeological Services Ltd

Site Code LCL14/148

November 2015

Summary

Site name: Handford House, Lancing College, Lancing, West Sussex

Grid reference: TQ 1937 0665

Planning reference: SDNP/14/03867/FUL

Site activity: Watching Brief

Date and duration of project: 6th - 8th July 2015

Project manager: Sean Wallis

Site supervisor: Teresa Vieira

Site code: LCL14/148

Area of site: c. 475 sq m

Summary of results: The watching brief successfully investigated the part of the site which would be most affected by the construction of a new extension to Handford House. Although parts of the site had clearly been disturbed in the past, probably when the existing section of Handford House was built, a subsoil horizon did survive in much of the area which was initially stripped down to the natural geology. Despite this, no archaeological finds or features were recorded.

Monuments identified: None

Location and reference of archive: The archive is presently held at Thames Valley Archaeological Services, Reading and will be deposited with Worthing Museum in due course.

This report may be copied for bona fide research or planning purposes without the explicit permission of the copyright holder

Report edited/checked by: Steve Ford ✓ 03.11.15 Steve Preston ✓ 03.11.15

Handford House, Lancing College, Lancing, West Sussex An Archaeological Watching Brief

by Sean Wallis

Report 14/148b

Introduction

This report documents the results of an archaeological watching brief carried out at Handford House, Lancing College, Lancing, West Sussex (TQ 1937 0665) (Fig. 1). The work was commissioned by Mr Gavin Merryweather, Estates Bursar at Lancing College.

Planning permission (SDNP/14/03867/FUL) had been gained from the South Downs National Park Authority for the construction of a new extension to Handford House, along with various associated works including a new car park. The permission was subject to a standard condition (5) relating to archaeology and the historic environment, requiring the implementation of a programme of archaeological works.

As a consequence of the possibility of archaeological deposits on the site which may be damaged or destroyed by the planned building work, it was proposed to carry out a watching brief, as set out in the *National Planning Policy Framework* (NPPF 2012) and the National Park Authority's policies on archaeology and the historic environment. This approach had been recommended by Mr David Hopkins, the Hampshire County Archaeologist, who acts as archaeological adviser to the Authority for sites in West Sussex.

The watching brief was carried out in accordance with a written scheme of investigation approved by the Hampshire County Archaeologist. Where appropriate and relevant, the recommendations in *Sussex Archaeological Standards* (ESCC 2015) were to be followed. The fieldwork was undertaken by Teresa Vieira and Sean Wallis between 6th and 8th July 2015, and the site code is LCL14/148. The archive is presently held by Thames Valley Archaeological Services and will be deposited with Worthing Museum in due course.

Location, topography and geology

The site is located to the north-west of the main complex of buildings at Lancing College, immediately west of Handford House (Fig. 2). According to the British Geological Survey the site is positioned close to the point where the Culver (Tarrant) and Newhaven Chalk Formations meet, although it is possible that some overlying Clay-with-flints deposits may be present (BGS 2006). The presence of Clay-with-flints geology was also suggested by a recent soil investigation (Hemsley 2014) and was confirmed during the watching brief. The area to the west of Handford House lies at a height of approximately 50m above Ordnance Datum.

Archaeological background

The archaeological potential of the site has been considered in a recent desk-based assessment (Wallis 2014). In summary, the site lies in an area of moderate archaeological potential due to its location on the South Downs. Features dating from the prehistoric and Roman periods have been found during archaeological work on Lancing Down to the west of the site, whilst there have been a number of stray finds in the area dating from the Palaeolithic period onwards. A number of Saxon burials were recorded close to Hoe Court Farm, to the south-west of the site, in the first half of the 20th century.

Objectives and methodology

The aims of the watching brief were to excavate and record any archaeological deposits affected by the proposed groundworks. This was to involve the monitoring of ground reduction in respect of the new extension and car park. Where it was not possible or practicable to preserve archaeological remains *in-situ* the features were to be excavated by hand and fully recorded, to ensure their preservation by record. The watching brief was to be carried out in accordance with the relevant sections of Sussex Archaeological Standards (ESCC 2015) and the guidelines issued by the Chartered Institute for Archaeologists.

Results

The footprint of the new extension was initially stripped down to the top of the natural geology (Clay with Flints), under constant archaeological supervision. The stripped area measured 29m by 16.50m (Fig. 3: Pls 1–6). It was clear that the ground level immediately to the east had been heavily truncated when the existing part of Handford House was constructed. This earlier building work had probably affected the eastern part stripped area, as made ground deposits were recorded immediately above the natural geology in the east and south-east, suggesting that these areas had been stripped in the past. Elsewhere a subsoil horizon survived between the topsoil and natural geology, indicating that the area had not been significantly disturbed, although a fibre optic cable was noted in the northern part of the stripped area (Fig. 4). Despite this, no archaeological finds or features were recorded. In the undisturbed areas, the depth of topsoil and subsoil above the natural geology varied from between 0.36m in the north-east to 0.56m in the south-west. The natural geology consisted of light orange brown clay with flint inclusions. The amount of inclusions was far more dense in the western part of the stripped area, which reinforced the idea that the eastern part of the area had been truncated in the past.

Based on the results of monitoring the new extension, it was determined that the creation of the small new car park would be unlikely to affect any archaeological deposits, due to the relatively shallow ground reduction involved. As a result, the groundworks in this part of the site were not monitored.

Conclusion

The watching brief at this site successfully the area which would be most affected by the construction of a new extension. Despite the fact that much of the area had not been significantly disturbed in the past, no archaeological finds or features were recorded.

References

- BGS, 2006, *British Geological Survey*, 1:50,000, Sheet 318/333, Bedrock and Superficial Deposits Edition, Keyworth.
- Hemsley, 2014, 'Handford House, Lancing College, Lancing, West Sussex – Site investigation', Hemsley Consulting unpubl rep, Wivelsfield Green.
- ESCC, 2015, *Sussex Archaeological Standards*, East Sussex County Council, Lewes.
- NPPF, 2012, *National Planning Policy Framework*, Department of Communities and Local Government, London (TSO).
- Wallis, S, 2014, 'Lancing College, Lancing, West Sussex – an archaeological desk-based assessment', Thames Valley Archaeological Services unpubl rep **14/148**, Brighton.

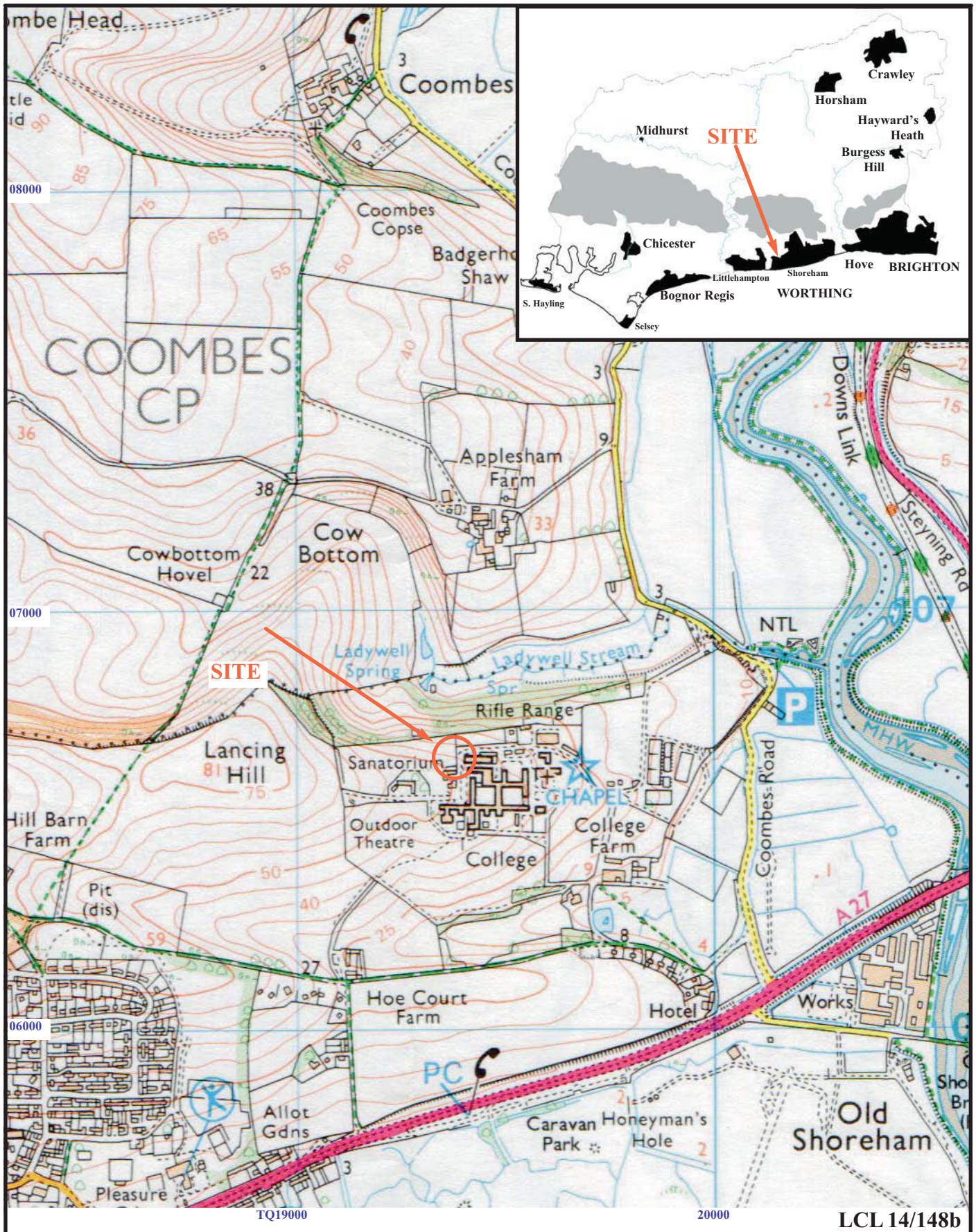

**Handford House, Lancing College,
Lancing, West Sussex, 2015
Archaeological Watching Brief**

Figure 1. Location of site within Lancing and West Sussex.

Reproduced from Ordnance Survey Explorer 122 at 1:12500.
Ordnance Survey Licence 100025880

THAMES VALLEY
ARCHAEOLOGICAL
SERVICES
SOUTH

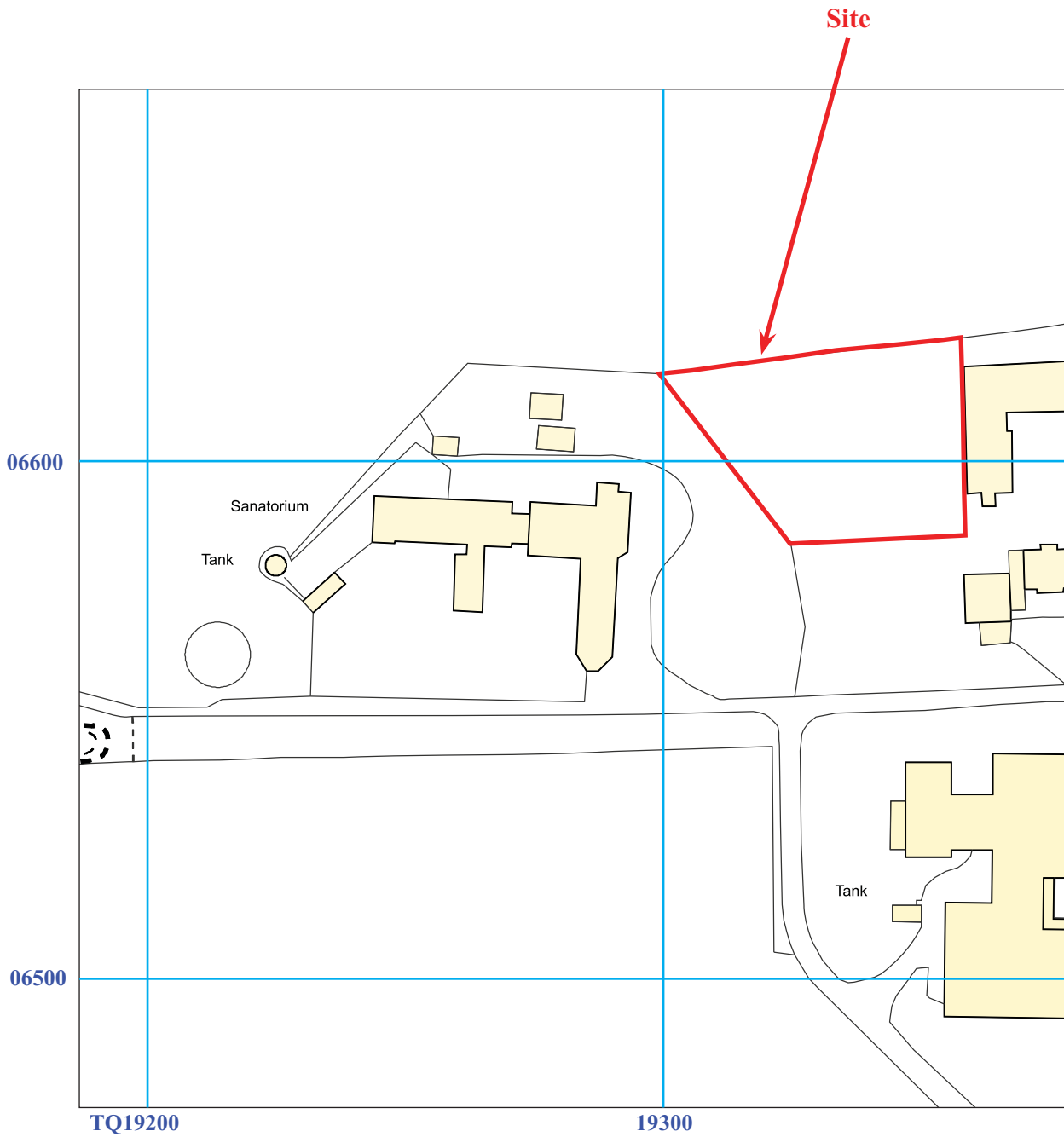

LCL 14/148b



**Handford House, Lancing College,
Lancing, West Sussex, 2015
Archaeological Watching Brief**
Figure 2. Detailed location of site.

Reproduced from Ordnance Survey digital mapping at 1:1250.
Crown Copyright Reserved.

THAMES VALLEY
ARCHAEOLOGICAL
SERVICES
SOUTH

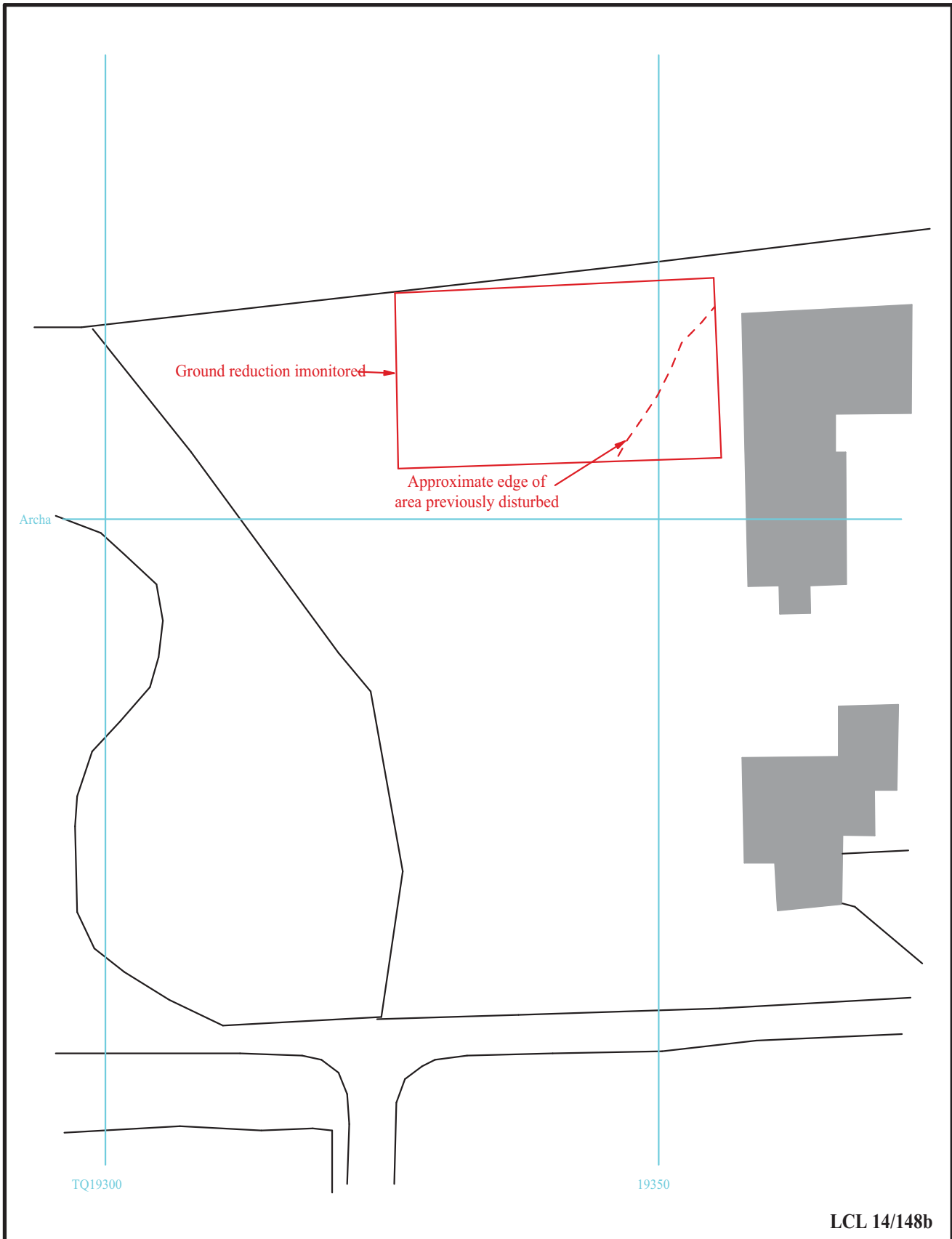

**Handford House, Lancing College,
Lancing, West Sussex, 2015
Archaeological Watching Brief**

Figure 3. Location of area monitored.



General stratigraphy observed during ground reduction (NE corner)

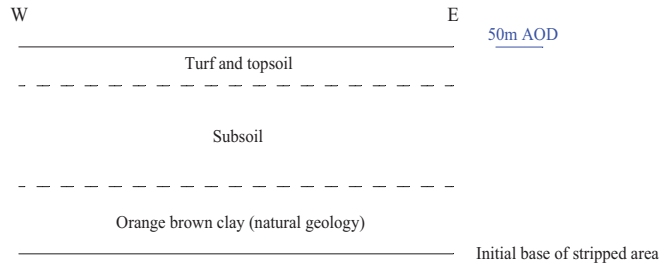

General stratigraphy observed during ground reduction (SE corner)

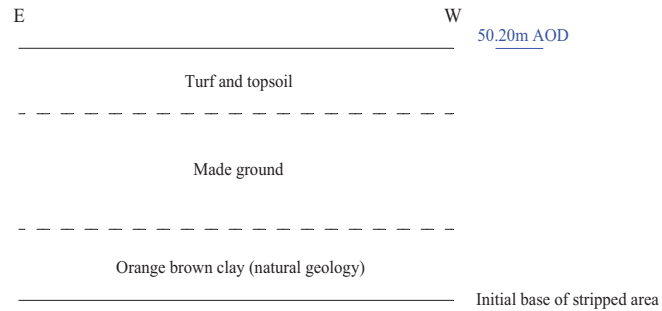

General stratigraphy observed during ground reduction (SW corner)

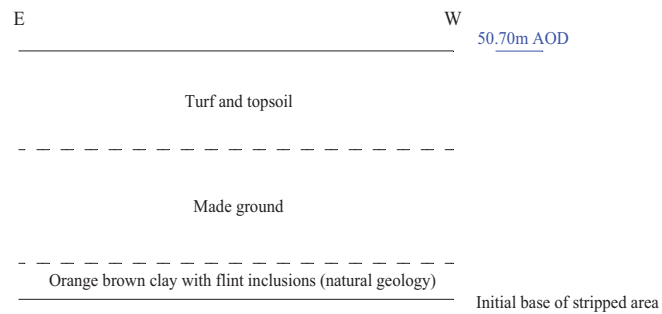

LCL 14/148b

**Handford House, Lancing College,
Lancing, West Sussex, 2015
Archaeological Watching Brief**

Figure 4. Sections.





Plate 1: General site view, looking north.



Plate 2: General site view, looking north-east.



Plate 3: General view of eastern part of site, looking north.



Plate 4: Stripped area, looking north.



Plate 5: Stripped area, looking north-west.



Plate 6: North-facing section.

LCL 14/148b

**Handford House, Lancing College,
Lancing, West Sussex, 2015
Archaeological Watching Brief**

THAMES VALLEY
ARCHAEOLOGICAL
SERVICES
SOUTH

TIME CHART

	Calendar Years
Modern _____	AD 1901
Victorian _____	AD 1837
Post Medieval _____	AD 1500
Medieval _____	AD 1066
Saxon _____	AD 410
Roman _____	AD 43
Iron Age _____	BC/AD 750 BC
Bronze Age: Late -----	1300 BC
Bronze Age: Middle -----	1700 BC
Bronze Age: Early -----	2100 BC
Neolithic: Late	3300 BC
Neolithic: Early	4300 BC
Mesolithic: Late	6000 BC
Mesolithic: Early	10000 BC
Palaeolithic: Upper	30000 BC
Palaeolithic: Middle	70000 BC
Palaeolithic: Lower	2,000,000 BC



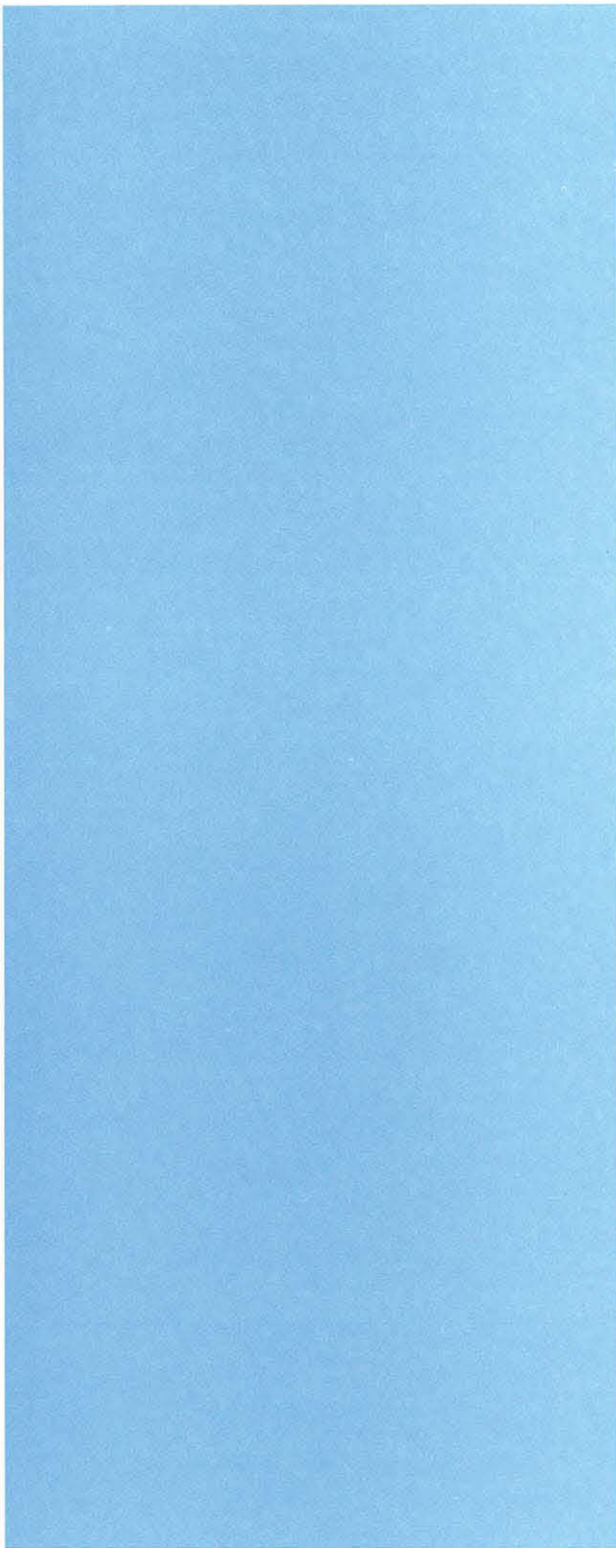
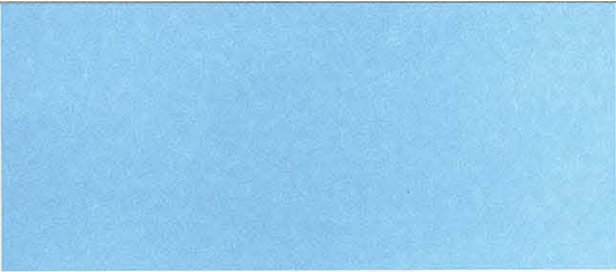

TVAS (South)
77a Hollingdean Terrace, Brighton
Sussex, BN1 7HB

Tel: 01273 554198
Fax: 01273 564043
Email: south@tvas.co.uk
Web: www.tvas.co.uk