

# **Wetherby, Charters Road, Sunningdale, Berkshire**

**An Archaeological Watching Brief**

**For Albion Capital**

by Simon Cass

Thames Valley Archaeological Services Ltd

Site Code WCS 07/02

**February 2007**

## Summary

**Site name:** Wetherby, Charters Road, Sunningdale, Berkshire.

**Grid reference:** SU 9481 6680

**Site activity:** Watching Brief

**Date and duration of project:** 15th-17th January 2007

**Project manager:** Steve Ford

**Site supervisor:** Simon Cass

**Site code:** WCS 07/02

**Area of site:** c. 900 sq m

**Summary of results:** No finds or deposits of archaeological relevance were encountered.

**Monuments identified:** None

**Location and reference of archive:** The archive is presently held at Thames Valley Archaeological Services, Reading and will be deposited at Reading Museum in due course.

*This report may be copied for bona fide research or planning purposes without the explicit permission of the copyright holder*

Report edited/checked by: Steve Ford ✓ 01.03.07 Steve Preston ✓ 02.03.07
---

# **Wetherby, Charters Road, Sunningdale, Berkshire, 2007 An Archaeological Watching Brief**

by Simon Cass

**Report 07/02**

## **Introduction**

This report documents the results of an archaeological watching brief carried out at Wetherby, Charters Road, Sunningdale, Berkshire (SU 9481 6680) (Fig. 1). The work was commissioned by Mr Richard Keat of Richard Keat Associates, High Street, Hartley Wintney, Hook, Hampshire, RG27 8NS on behalf of Albion Capital.

Planning permission ( App no 06/00015) has been granted by Royal Borough of Windsor and Maidenhead for the construction of a detached house and separate garage following demolition of the existing structure, subject to a condition relating to archaeology requiring the site to be investigated during intrusive groundworks.

This is in accordance with the Department of the Environment's Planning Policy Guidance, *Archaeology and Planning* (PPG16 1990), and the Borough's policies on archaeology. The field investigation was carried out to a specification approved by Ms Mary O'Donoghue, Archaeology Officer for Berkshire Archaeology, advisers to the Royal Borough in matters relating to archaeology. The fieldwork was undertaken by Simon Cass and Sean Wallis between 15th and 17th January 2007 and the site code is WCS 07/02.

The archive is presently held at Thames Valley Archaeological Services, Reading and will be deposited at Reading Museum in due course.

## **Location, topography and geology**

The site is located 200m south of the railway cutting at Broomhall, which is south of the centre of Sunningdale, and just north of the A30. The surrounding area is residential, with a school close by (Fig. 2). The solid geology in the area is Bagshot Beds but the site itself lies on a deposit of floodplain gravel (BGS 1981). Topographically it lies at the base of a small valley at a height of *c.* 50m AOD.

## **Archaeological background**

The site's archaeological potential stems from its location approximately 200m south-east of the projected route of the Roman road from Silchester to London (The Devils Highway). Other large Roman sites are known to be located adjacent to the road such as that at Wickham Bushes (Roberts and Leese 1933; Corney and Gaffney 1983; Ford 1987, 83) and it can be anticipated that similar roadside settlements existed elsewhere along the

route. There is an antiquarian's account of the finding a Roman mosaic floor with much brick and tile during construction of the nearby railway though the exact location of this is unclear (Hughes 1890). A medieval priory is recorded in the general area at Broomhill and several Bronze Age round barrows are present to the south.

## **Objectives and methodology**

The purpose of the watching brief was to excavate and record any archaeological deposits affected by the groundworks. This was to involve examination of all areas of intrusive groundworks, in particular any ground reduction, digging of foundation trenches for the house and garage and service runs as necessary.

## **Results**

The foundation trenches were all 0.7m wide and approximately 1.5m deep (Figs 3 and 4). The stratigraphy encountered within the house foundations was 0.45m of disturbed topsoil, mixed with hardcore and rubble from the previous buildings on site, sitting directly above the natural geology, a mid orange clayey sand and gravel with grey-green sandy layers visible. In some of the foundation trenches old sewerage pipework was visible at a depth of 0.55m, deep enough to truncate the natural gravel.

The foundation trenches for the detached garage were of similar depth and width to the house foundations and revealed a similar stratigraphy.

No service trenches were examined as those, such as drains, close to the new house were shallow and founded in the disturbed levels and eventually connected to the pre-existing service network for the earlier house.

No deposits of archaeological interest were observed.

## **Finds**

No finds were recovered from site, the only artefacts noted being of obviously modern date (brick and tile fragments, plastics, glass, etc).

## **Conclusion**

No find nor deposits of archaeological interest were observed during this watching brief.

## References

- BGS, 1981, *British Geological Survey*, 1:50000, Sheet 269, Solid and Drift Edition, Keyworth
- Corney, M and Gaffney V, 1983, 'Interim statement on excavations at Wickham Bushes, Easthampstead, Spring 1983', *Berkshire Archaeol Soc Fld Res Grp Newsl* **2**, no 2
- Ford, S, 1987, East Berkshire Archaeological Survey, *Berkshire County Council Dept Highways and Planning Occas Pap 1*, Reading.
- Hughes, G M, 1890, *History of Windsor Forest and Sunninghill and the Great Park*
- PPG 16, 1990, *Archaeology and Planning*, Dept of the Environment Planning Policy Guidance 16, HMSO
- Roberts, K A B and Leese, L, 1933, 'Wickham Bushes, a Roman settlement', *Berkshire, Buckinghamshire Oxfordshire Archaeol J*, **37**, 150–5



**Wetherby, Charters Road, Sunningdale,  
Berkshire, 2007**  
An archaeological watching brief

Figure 1. Location of site within Sunningdale and Berkshire.

Reproduced from Ordnance Survey Pathfinder 1189 SU86/96 at 1:12500.  
Ordnance Survey Licence 100025880

THAMES VALLEY

ARCHAEOLOGICAL

SERVICES



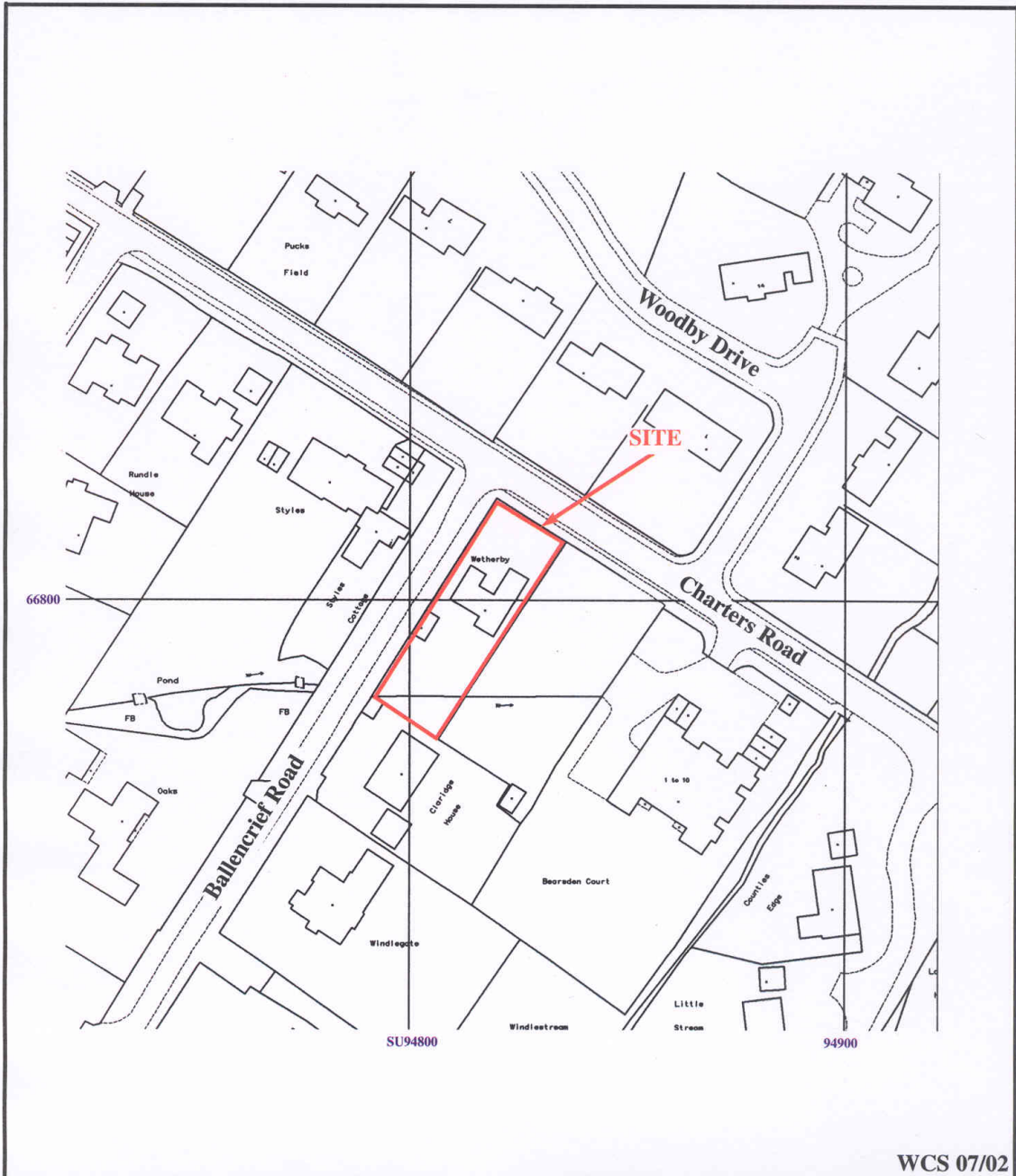

**Wetherby, Charters Road, Sunningdale,  
Berkshire, 2007**  
An archaeological watching brief

Figure 2. Detailed location of site on Charters Road.

Reproduced from Ordnance Survey Digital Mapping at 1:1250.

T H A M E S   V A L L E Y  
**ARCHAEOLOGICAL**  
 S E R V I C E S

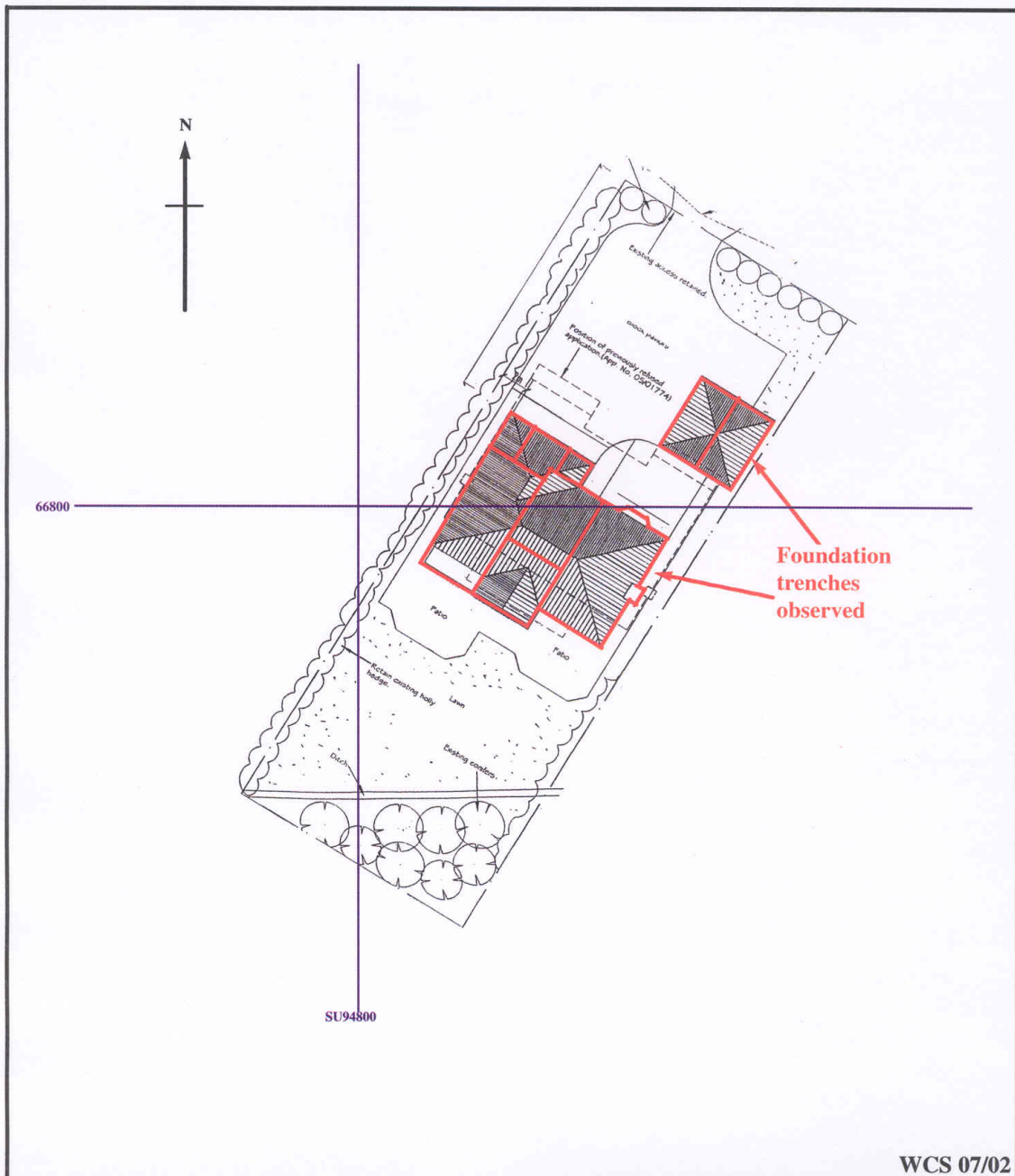

WCS 07/02

**Wetherby, Charters Road, Sunningdale,  
Berkshire, 2007**  
An archaeological watching brief

Figure 3. Location of new foundations within site.

Scale 1:400

T H A M E S   V A L L E Y

ARCHAEOLOGICAL

S E R V I C E S



# Wetherby, Charters Road, Sunningdale, Berkshire, 2007



Figure 4. Representative section of footing trench

WCS07/02