

T H A M E S V A L L E Y

ARCHAEOLOGICAL

S E R V I C E S

**Sunnybank, Ryall Road, Holly Green,
Upton upon Severn, Worcestershire**

Archaeological Excavation

by Genni Elliott and Luis Esteves

Site Code: RRU15/161

(SO 8621 4094)

**Sunnybank, Ryall Road, Holly Green,
Upton upon Severn, Worcestershire**

An Archaeological Excavation

For Andrew Josephs Associates

by Genni Elliott and Luis Esteves

Thames Valley Archaeological Services Ltd

Site Code RRU 15/161

January 2017

Summary

Site name: Sunnybank, Ryall Road, Holly Green, Upton upon Severn, Worcestershire

Grid reference: SO 8621 4094

Site activity: Archaeological Excavation

Date and duration of project: 29th February - 20th July 2016

Project manager: Steve Ford

Site supervisor: Luis Esteves

Site code: RRU 15/161

Area of site: 1.18 ha

Summary of results: A single undated ditch which shows no correlation to historic field boundaries shown on earlier maps was found.

Monuments identified: Ditch

Location and reference of archive: The archive is presently held at Thames Valley Archaeological Services, Reading and will be deposited with the Archaeology Data Service in due course.

*This report may be copied for bona fide research or planning purposes without the explicit permission of the copyright holder. All TVAS unpublished fieldwork reports are available on our website:
www.tvas.co.uk/reports/reports.asp.*

Report edited/checked by: Steve Ford ✓ 10.01.17 Steve Preston ✓ 10.01.17

Sunnybank, Ryall Road, Holly Green, Upton upon Severn, Worcestershire An Archaeological Excavation

by Genni Elliott and Luis Esteves

Report 15/161

Introduction

This report documents the results of an archaeological excavation carried out at Sunnybank, Ryall Road, Holly Green, Upton upon Severn, Worcestershire (SO 8621 4094) (Fig. 1). The work was commissioned by Mr Andy Josephs of Andrew Joseph Associates, 16 South Terrace, Sowerby, Thirsk, YO7 1RH. Planning permission (app no (MH/13/00706) has been gained from Malvern Hills District Council to build 25 new dwellings with associated infrastructure and open space. The consent includes a condition (17) relating to archaeology.

This is in accordance with the Department for Communities and Local Government's *National Planning Policy Framework* (NPPF 2012) and the District's policies on archaeology. The field investigation was carried out to a specification approved by Ms Aisling Nash, Historic Environment Advisor to Worcestershire County Council.

The fieldwork was undertaken by Kyle Beaverstock, Tim Dawson, Luis Esteves, Danielle Milbank, Jo Pine and David Sanchez between 29th February 2016 and 20th July 2016. The site code is RRU 15/161. The archive is presently held at Thames Valley Archaeological Services, Reading and will be deposited with the Archaeology Data Service in due course.

Location, topography and geology

The site is located within the village of Holly Green, on the east side of the River Severn, opposite the town of Upton upon Severn (Fig. 1). More specifically it is located within an irregularly shaped parcel of land on the east side of Ryall Road, just to the south-east of its junction with the A4104 (Fig. 2). Currently it is part of a larger field which is laid to pasture, located approximately 20m above Ordnance Datum. The underlying geology is complex in this area with three different types recorded in the vicinity of the field; Rugby Limestone Member (part of the Blue Lias Formation) above Twynning Mudstone Formation, whilst on the opposite side of the Ryall Road is recorded the Second (Worcester) River Terrace Deposit (BGS 1993). Upon excavation, Twynning Mudstone was found across the site.

Archaeological background

The archaeological potential of the site area had been highlighted in a brief produced by Worcestershire Archive and Archaeology Service (Glyde 2014) drawing on information collated in a cultural heritage assessment and geophysical survey (Josephs 2013). In summary the site lies within an area of modest archaeological potential, for pre-medieval periods as the site is overlain by ridge and furrow. A number of sites and finds are recorded nearby in the county Historic Environment Record. A ring ditch (levelled round barrow) and undated cropmarks are recorded to the north-east as is an enclosure of Roman date. Numerous finds of prehistoric and late date have been recorded by surface survey and metal detector survey. The geophysical survey (magnetometer) of the site itself showed little of archaeological interest, apart from confirmation of the location and extent of ridge and furrow cultivation and that the present field incorporates parts of earlier enclosures as shown on the 1807 enclosure map. It was concluded that the potential for buried remains of archaeological interest within the site was low.

Objectives and methodology

The purpose of the excavation was to:

- Excavate and record all archaeological deposits and features within the areas threatened by the proposed development;
- Produce relative and absolute dating and phasing for deposits and features recorded on the site;
- Establish the character of these deposits in attempt to define functional areas on the site such as industrial, domestic, etc; and
- Produce information on the economy and local environment and compare and contrast this with the results of other excavations in the region.

Specific research objectives to answer were:

- When was the site first utilised and when was it abandoned?
- What is the nature and origin of any archaeological deposits on the site?
- What is the palaeoenvironmental setting of the area?

The area proposed for excavation (1.18ha) was stripped of ploughsoil by a 360° digger fitted with a toothless bucket, down to the top archaeologically relevant layer (natural geology), under constant archaeological supervision. Features were to be cleaned by hand, excavated and sampled.

Results

The site was stripped as intended (Fig. 3; Pls 1 and 2), removing approximately 0.30m of topsoil above 0.90m of light yellowish brown, clay silt subsoil above the natural reddish brown mudstone.

A single ditch with terminus was found at the north end of the site, cut into the natural mudstone geology. The ditch was aligned south west-north east before it curved round to the east and met the site boundary. It was recorded for 33m and a total of six slots were dug through it (numbered 1-6 from the west end), with number 1 being the terminus (Fig. 4). The ditch was between 0.63-0.86m wide, with a narrower terminus (0.32m wide) and 0.13-0.34m deep with the terminus 0.04m deep. In general the ditch had gently sloping sides and a slightly rounded base (Pl. 3), only slot 5 had a more 'v-shaped' profile (Fig. 5; Pl. 4).

The ditch contained a single fill, variously numbered 52-57, of a light reddish brown, silty clay with occasional small stone inclusions. No finds were recovered during excavation or from sieving of bulk soil samples.

Conclusion

A single undated ditch was identified during the fieldwork. A comparison with historic maps shows no correlation between mapped field boundaries and this ditch, nor was any cropmark evident in this location on aerial photographs. The geophysical survey did not detect a corresponding anomaly. There is no reason to suggest it is of any great antiquity: it may simply be a short-lived modern feature which was not in use long enough to be mapped.

References

- BGS, 1993, *British Geological Survey*, 1:50 000, Sheet 199, Solid and Drift Edition, Keyworth
- Glyde, M 2014 *Requirements for a Programme of Archaeological Works at Ryall Road, Holly Green, Upton upon Severn*, Worcestershire County Archaeological Service HER ref WSM 24362
- Josephs, A, 2013, Sunnybank, Ryall Road, Holly Green, Upton upon Severn, Worcestershire, Cultural Heritage Assessment, Andrew Josephs Associates, Sowerby
- NPPF 2012, *National Planning Policy Framework*, Dept Communities and Local Govt, London

APPENDIX 1: Feature details

<i>Cut</i>	<i>Fill (s)</i>	<i>Type</i>	<i>Date</i>	<i>Dating evidence</i>
	50	Topsoil (deposit)		
	51	Subsoil (deposit)		
1	52	Ditch terminus	Undated	
2	53	Ditch	Undated	
3	54	Ditch	Undated	
4	55	Ditch	Undated	
5	56	Ditch	Undated	
6	57	Ditch	Undated	

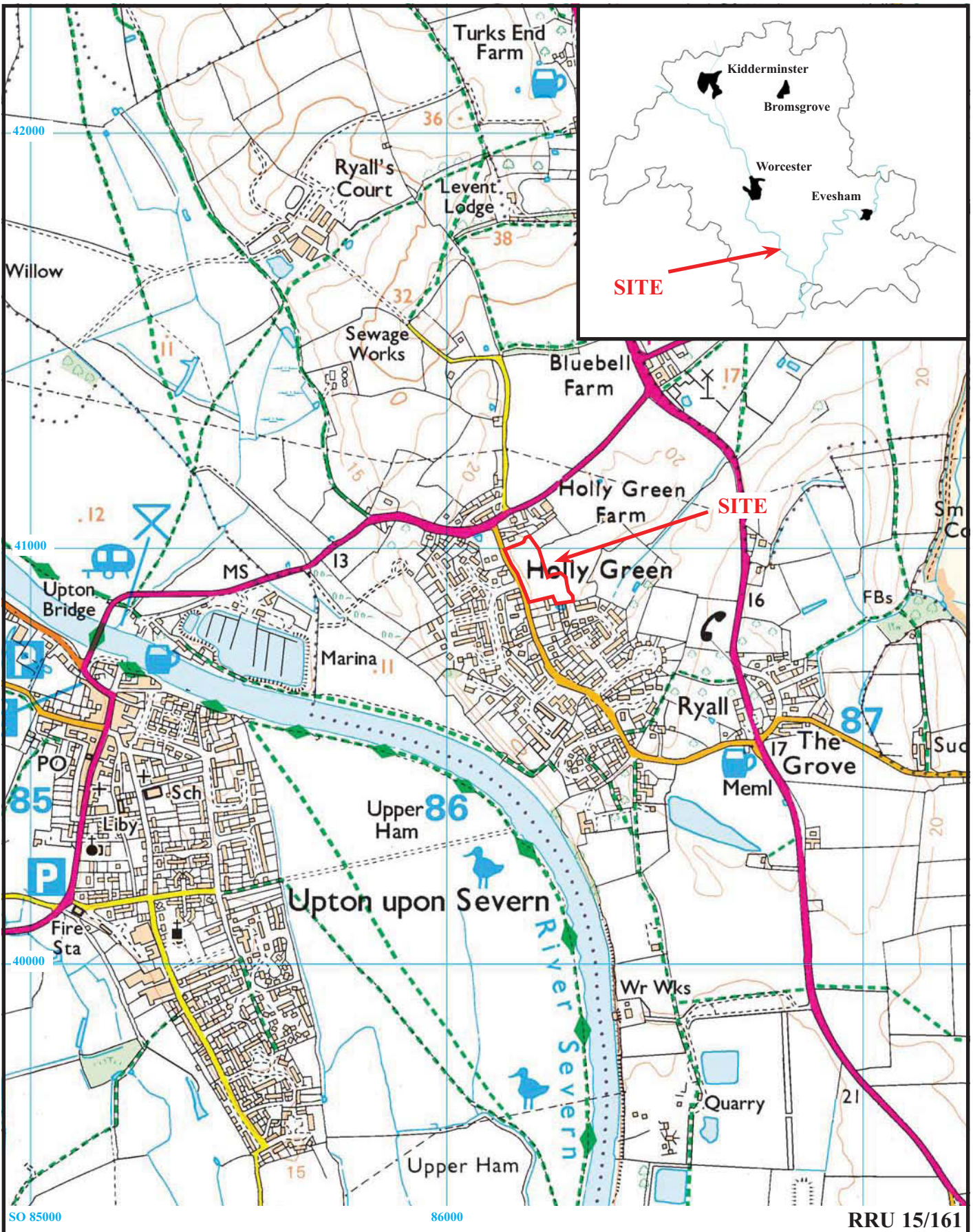

**Sunnybank, Ryall Road, Holly Green, Upton upon Severn
Worcestershire, 2017
Archaeological Excavation**

Figure 1. Location of site within Upton upon Severn and
Worcestershire.

Reproduced from Ordnance Survey Explorer 190 at 1:12500
Ordnance Survey Licence 100025880

THAMES VALLEY
ARCHAEOLOGICAL
SERVICES

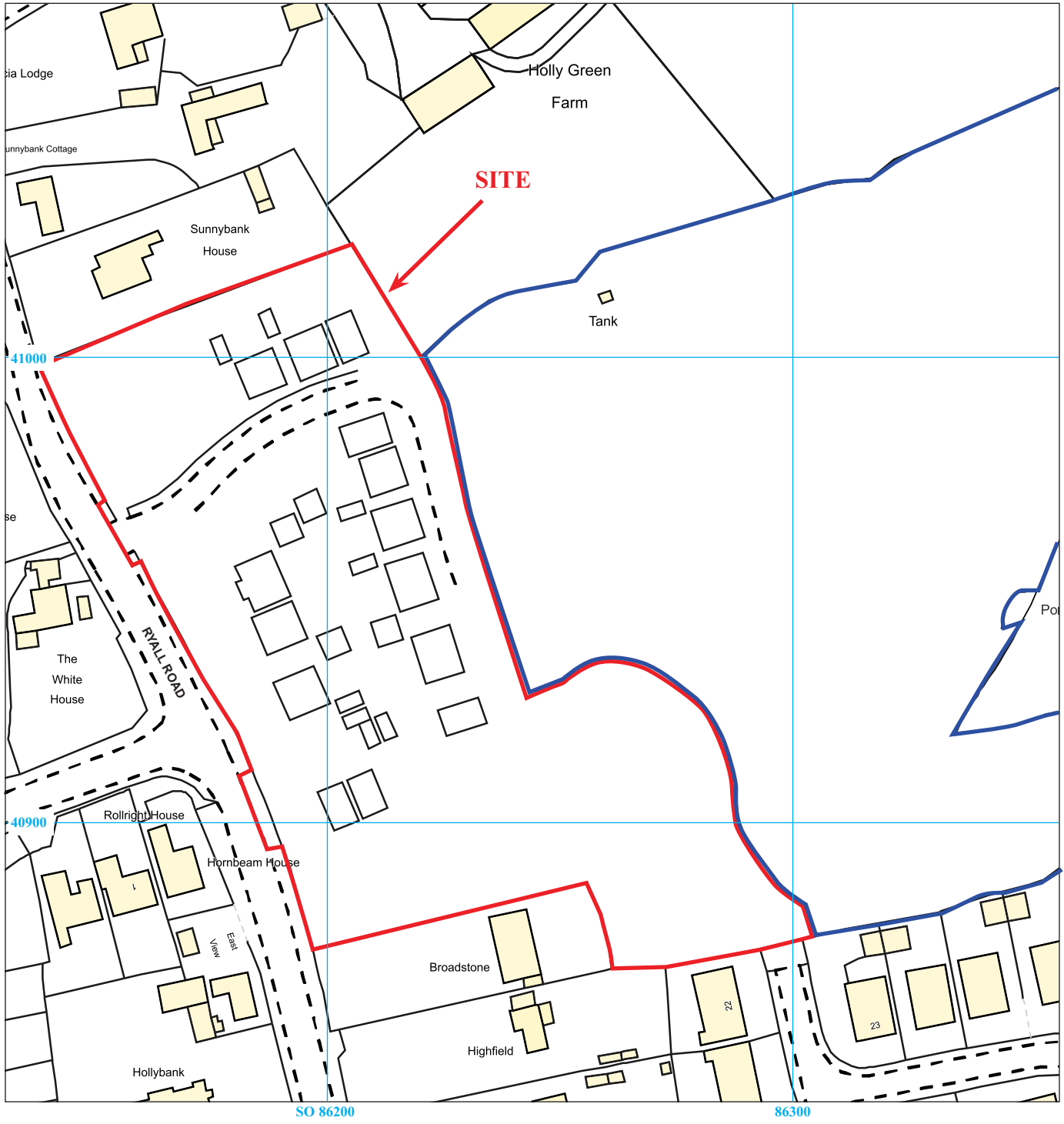

RRU 15/161



**Sunnybank, Ryall Road, Holly Green, Upton upon Severn
Worcestershire, 2017
Archaeological Excavation**

Figure 2. Detailed location of site off Ryall Road.

Reproduced from Ordnance Survey Digital Mapping under licence.
Crown copyright reserved. Scale 1:1250



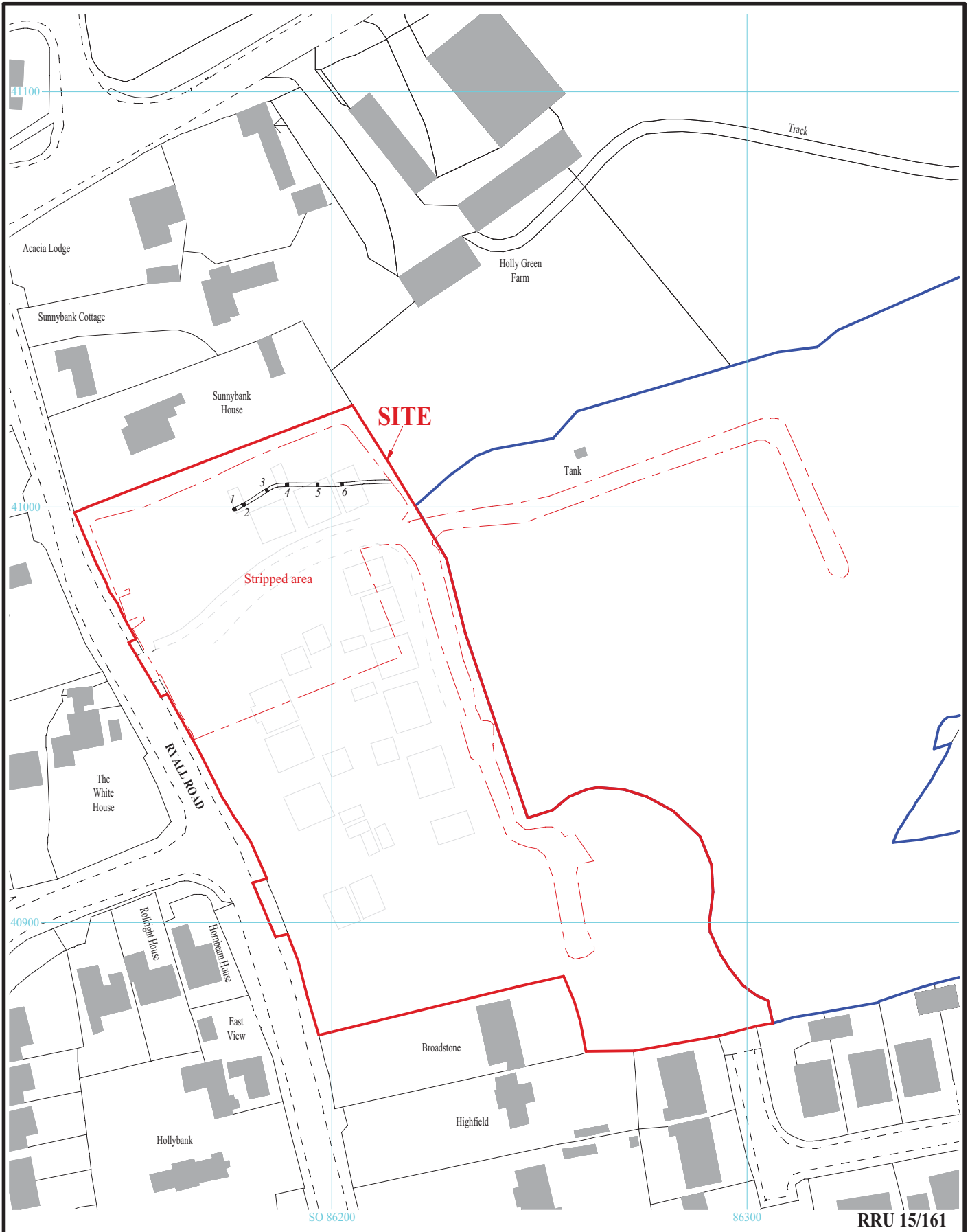

RRU 15/161

**Sunnybank, Ryall Road, Holly Green, Upton upon Severn,
Worcestershire, 2017
Archaeological Excavation**

Figure 3. Plan of areas observed.



THAMES VALLEY
ARCHAEOLOGICAL
SERVICES

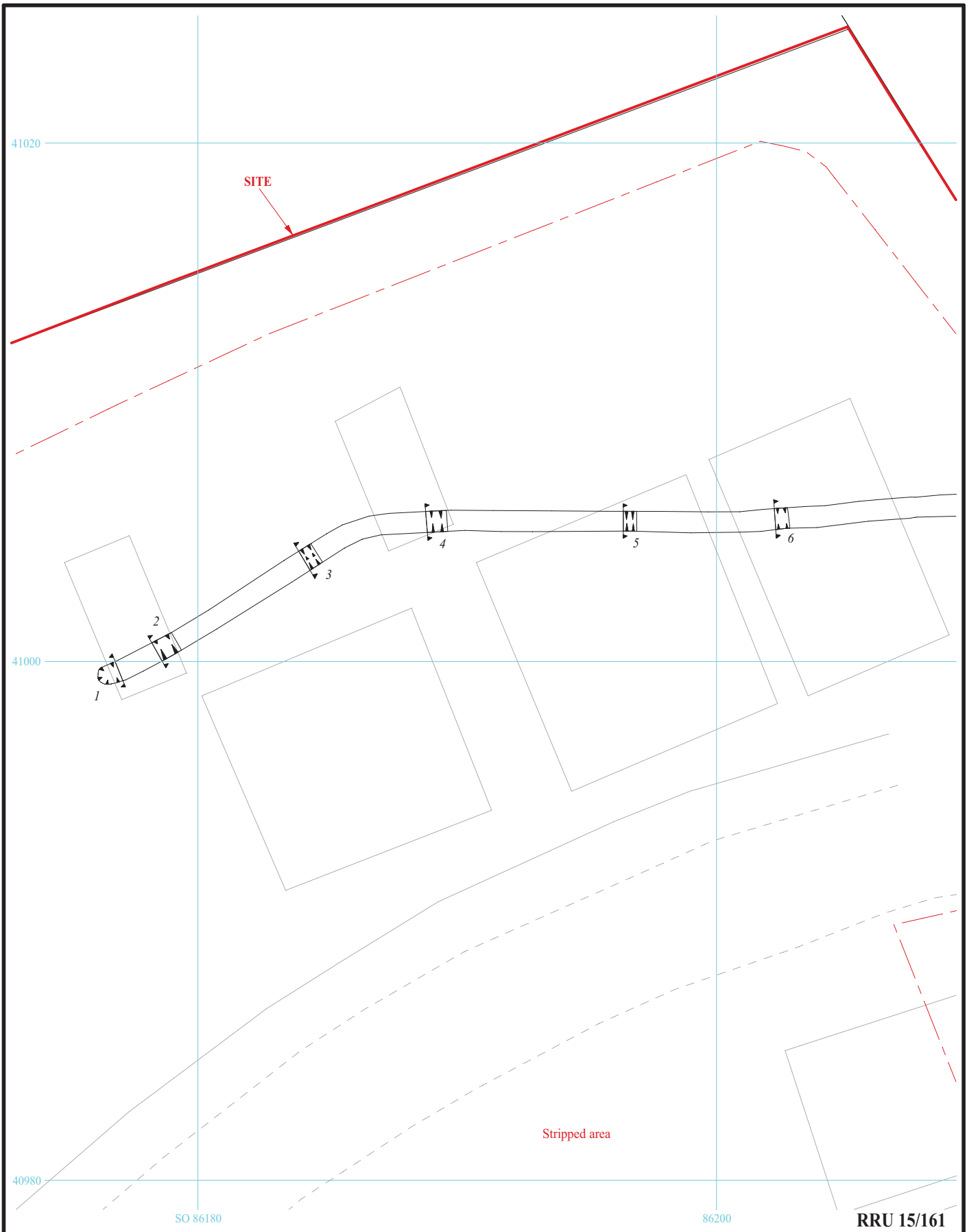

RRU 15/161

**Sunnybank, Ryall Road, Holly Green, Upton upon Severn,
Worcestershire, 2017
Archaeological Excavation**

Figure 4. Detail plan.



THAMES VALLEY
ARCHAEOLOGICAL
SERVICES

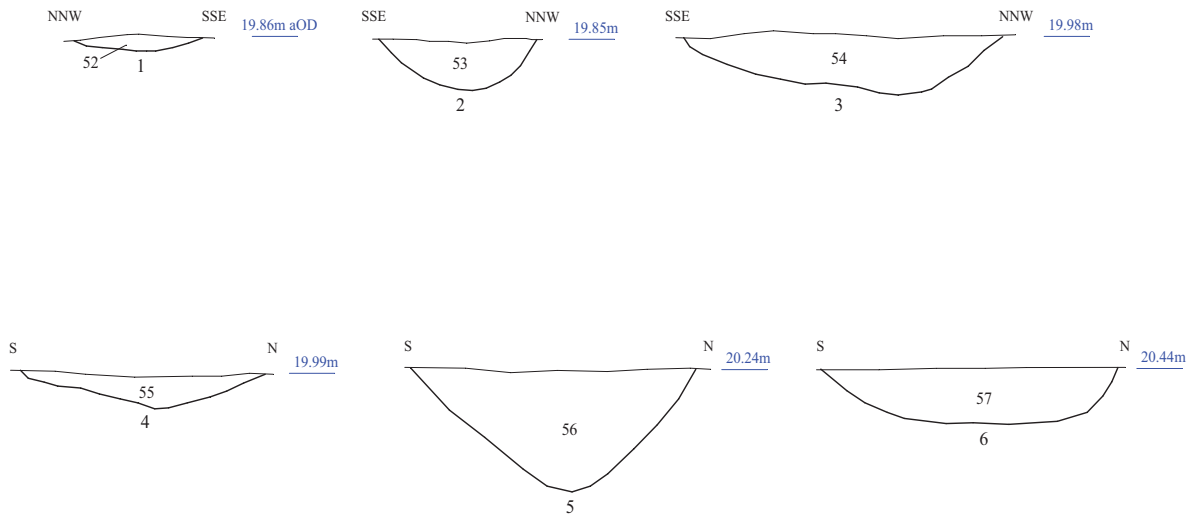

RRU 15/161

Sunnybank, Ryall Road, Holly Green, Upton upon Severn,
Worcestershire, 2017
Archaeological Excavation

Figure 5. Ditch sections.



THAMES VALLEY
ARCHAEOLOGICAL
SERVICES



Plate 1. Roadway strip, looking south. Scales: 2m and 0.3m.



Plate 2. Housing area strip, looking south-west. Scales: 2m and 1m.

RRU 15/161

Sunnybank, Ryall Road, Holly Green, Upton upon Severn
Worcestershire, 2017
Archaeological Excavation
Plates 1 - 2.

THAMES VALLEY
ARCHAEOLOGICAL
SERVICES



Plate 3. Ditch found in housing area strip, looking west.

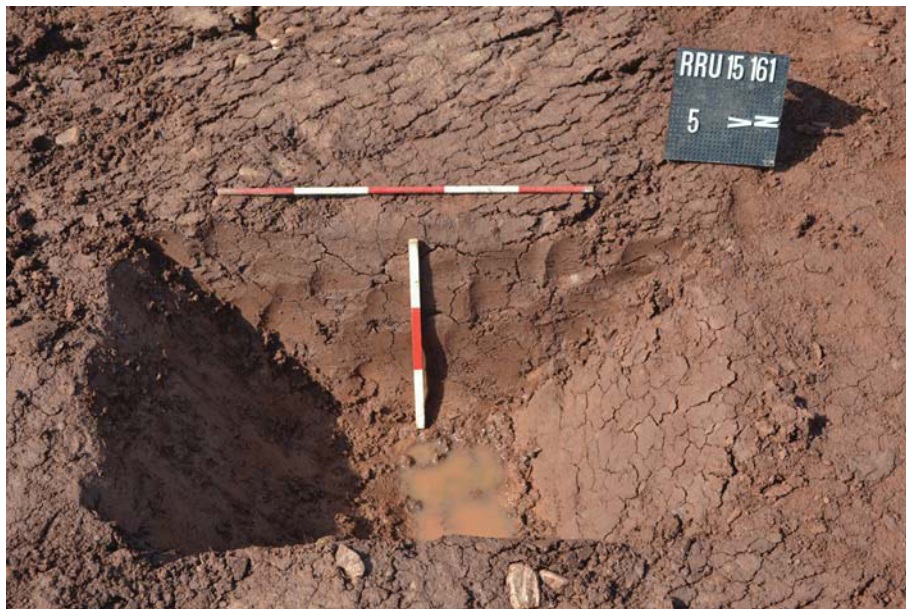

Plate 4. Ditch slot 5, looking west. Scales: 0.5m and 0.3m.

RRU 15/161

Sunnybank, Ryall Road, Holly Green, Upton upon Severn
Worcestershire, 2017
Archaeological Excavation
Plates 3 - 4.

THAMES VALLEY
ARCHAEOLOGICAL
SERVICES

TIME CHART

	Calendar Years
Modern _____	AD 1901
Victorian _____	AD 1837
Post Medieval _____	AD 1500
Medieval _____	AD 1066
Saxon _____	AD 410
Roman _____	AD 43
Iron Age _____	BC/AD 750 BC
Bronze Age: Late -----	1300 BC
Bronze Age: Middle -----	1700 BC
Bronze Age: Early -----	2100 BC
Neolithic: Late	3300 BC
Neolithic: Early	4300 BC
Mesolithic: Late	6000 BC
Mesolithic: Early	10000 BC
Palaeolithic: Upper	30000 BC
Palaeolithic: Middle	70000 BC
Palaeolithic: Lower	2,000,000 BC



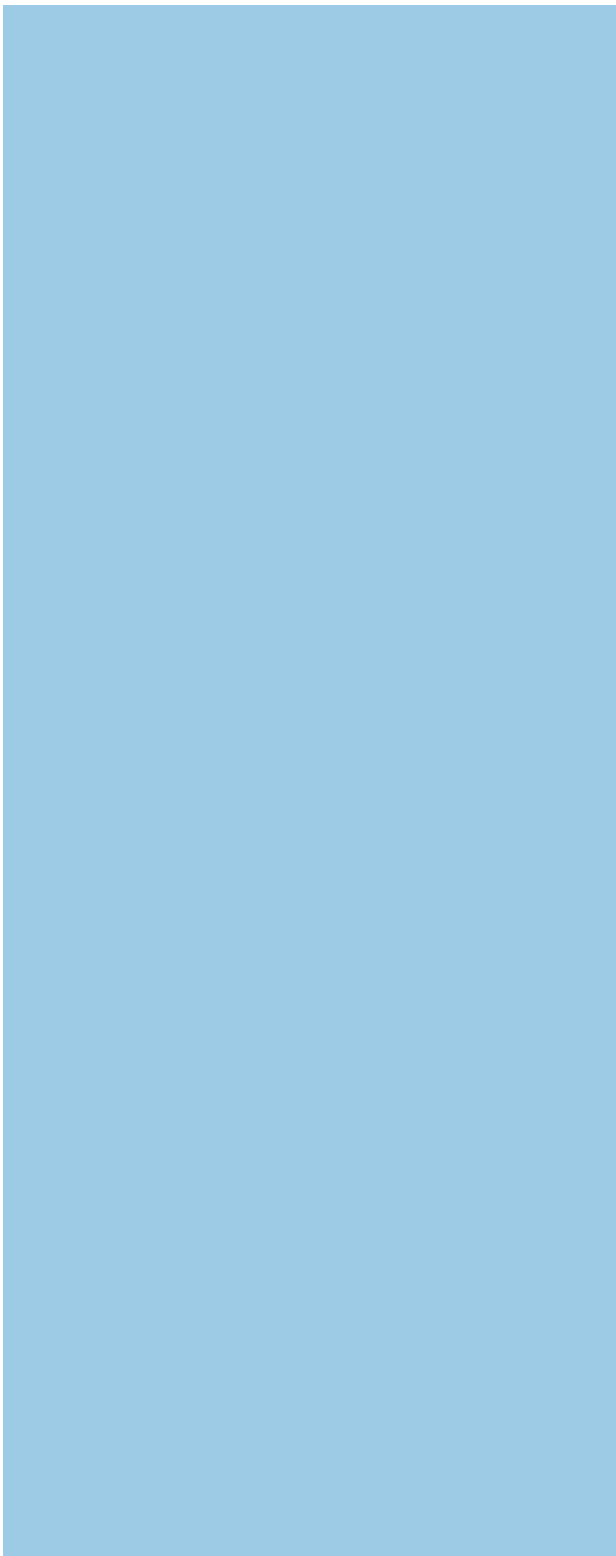
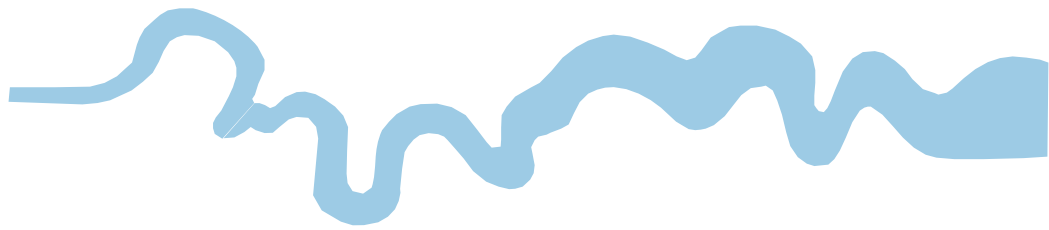

**Thames Valley Archaeological Services Ltd,
47-49 De Beauvoir Road, Reading,
Berkshire, RG1 5NR**

**Tel: 0118 9260552
Fax: 0118 9260553
Email: tvas@tvas.co.uk
Web: www.tvas.co.uk**